

Let's build the

# Millie Wall Light

SKU 15801

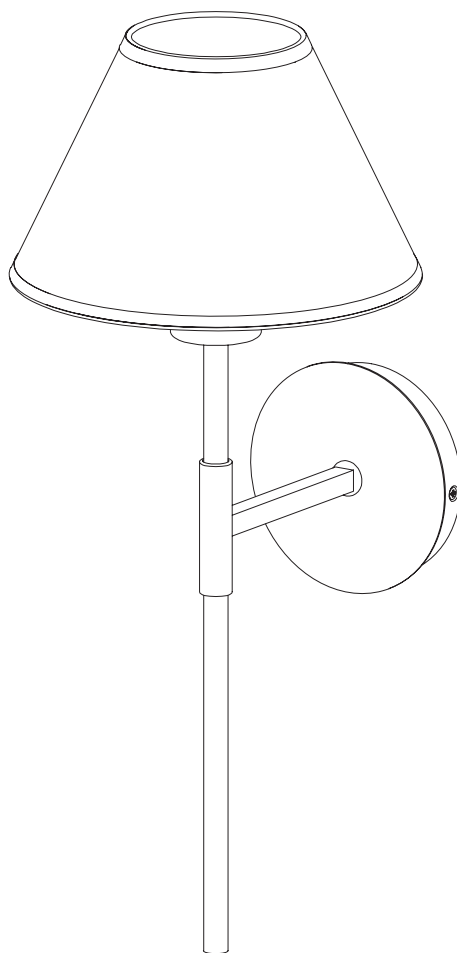

**Scan me!**

Free Lifetime  
Warranty

nathan james

23-0418

# Ok, let's get rolling

This should be easy, just follow our instructions and you will be back to Netflix in no time.

## Estimated time for assembly



45:00

## What you need

- Your favorite snack or energy bar (Save the bubbly for once your fixture is safely installed!)
- Use the packaging carton as a working surface to prevent product damage during assembly
- Phillips head screwdriver
- 1/4" Drill Bit
- Pencil

Toll-free at 1-866-619-1004  
Help@nathanjames.com  
Nathanjames.com/help

## What's included

Description		Qty
1	Fixture	1
2	Stem (6")	1
3	Stem (12")	1
4	Stem (12")	1
5	Fixture Stem	1
6	Shade	1
A	M3.5*35mm Screws	3
B	Wall Anchors	3
C	Mounting Plate (for Plug-in)	1
D	M4*15mm Screw	2
E	M4*26mm Screw	2
F	Plastic Plug	1
G	Mounting Plate (for Hardwire)	1
H	Wire Nut	1
I	Wrench	1

**Scan me!**

Free Lifetime  
Warranty



# Safety first, fun later

## Safe use of this product starts with you.

Use this light fixture responsibly with the primary concern for your safety. Follow assembly instructions carefully and inspect product upon receipt and each use.

Nathan James and its parent companies cannot be held legally responsible for any injuries or death resulted from failure to follow instructions or improper use of this product.

## Do not modify the structure of this product in any way.

Our products have been tested to meet specific safety measures as they were originally intended to be sold. Any modifications will present the risk of creating significant safety issues which Nathan James will not be responsible for.

## Proper use

- DO NOT** use for commercial purposes
- DO NOT** leave spilled liquid on fixture
- DO NOT** use light fixture if damaged
- DO NOT** make temporary repairs
- DO NOT** use outdoors



### WARNING

Inspect the wire insulation for any cuts, abrasions, or exposed copper that may have occurred during shipping. If there is a defect in the wire, do not attempt installation. Please reach out to our Customer Happiness team at [help@nathanjames.com](mailto:help@nathanjames.com) or 1-866-619-1004



### WARNING: RISK OF ELECTRIC SHOCK

Before starting the installation, disconnect the power by turning off the circuit breaker or by removing the appropriate fuse at the fuse box. Turning the power off at the switch is NOT SUFFICIENT to prevent electrical shock. PLEASE CONSULT A QUALIFIED ELECTRICIAN IF YOU HAVE ANY ELECTRICAL QUESTIONS.

# The goods

1

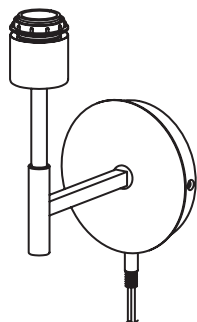

2



3



4



5



6

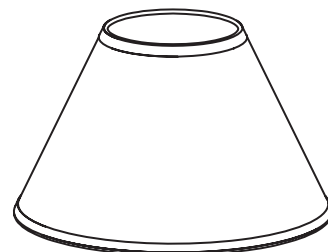

A



B

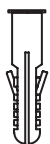

C

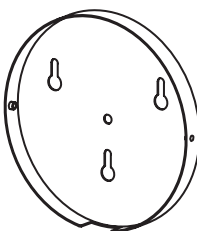

D



E



F



G

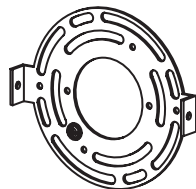

H



I

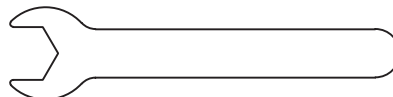

## IMPORTANT

1. Do not tighten bolts / screws completely until all bolts / screws are lined up and inserted into holes.
2. Do not over tighten screws and bolts to avoid stripping.
3. Please use hand tools to assemble this product. Do not use power tools.

## Pre-Installation

- Read all instructions prior to beginning assembly.
- To avoid damaging this product, assemble it on a soft, non-abrasive surface such as carpet or cardboard.
- Keep the receipt and these instructions for proof of purchase.
- Suggested Bulb: A19 LED 60 Watt Equivalent | E26 Medium Base | Dimmable
- Fixture Max Wattage: 60W

## Plug-in option

The following steps 1–19 are intended for wall mounted plug-in use only. Skip ahead to page 20 for directions on how to hardwire this light into your existing electrical box.

## Step 1

Let's get this thing fired up! Or should we say, lit?  
Thread the Fixture Stem (5) into place on the Fixture (1).

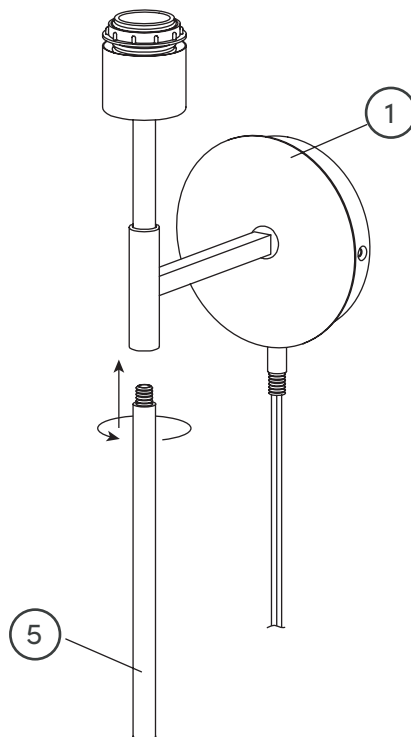

## Step 2

Separate Mounting Plate (C) from Fixture (1) by removing the M4\*15mm Screws (D).

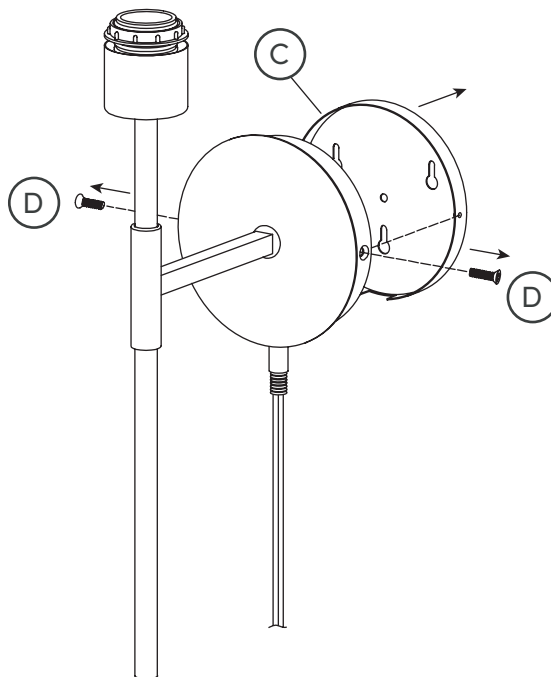

## Step 3

Remove the wires that run to the plug from each wire connector component in order to allow the cord to be released out of the bottom of the fixture.

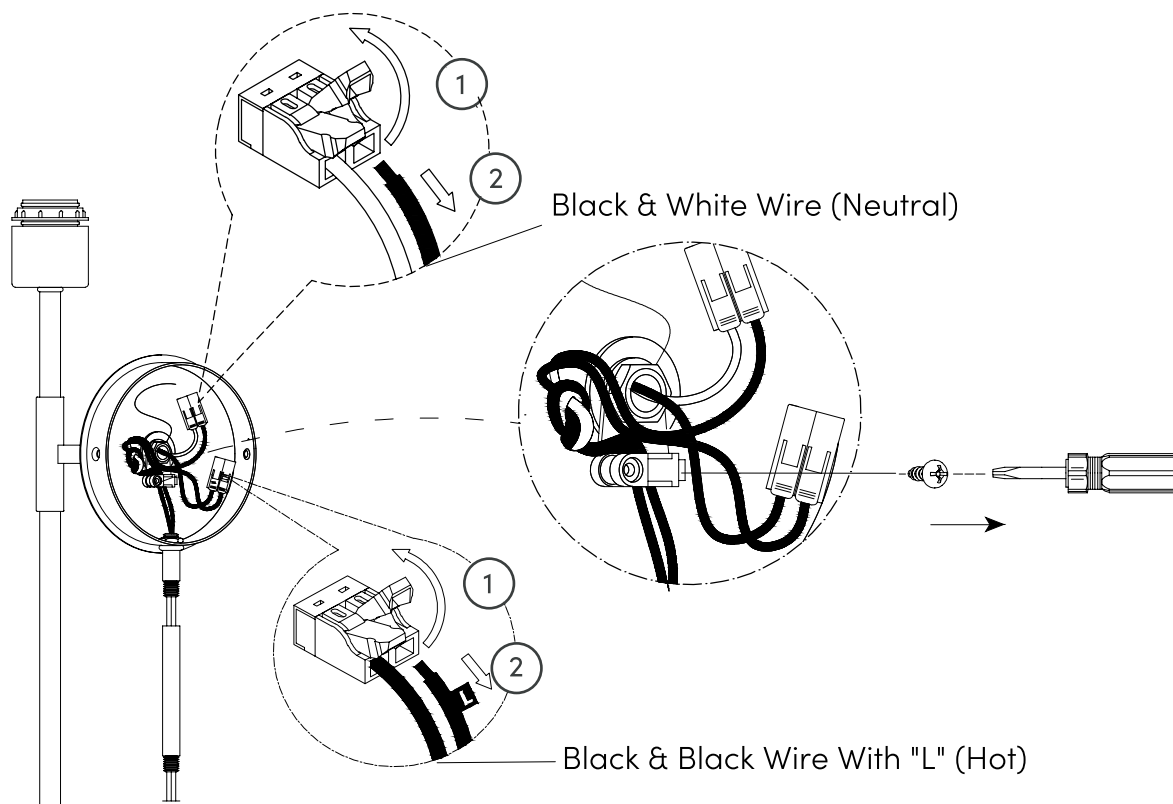

# Step 4

Untie knot in the cord.

P.S. We aren't judging you if  
you've already pulled out your  
snack. Ours was eaten by Step 2.

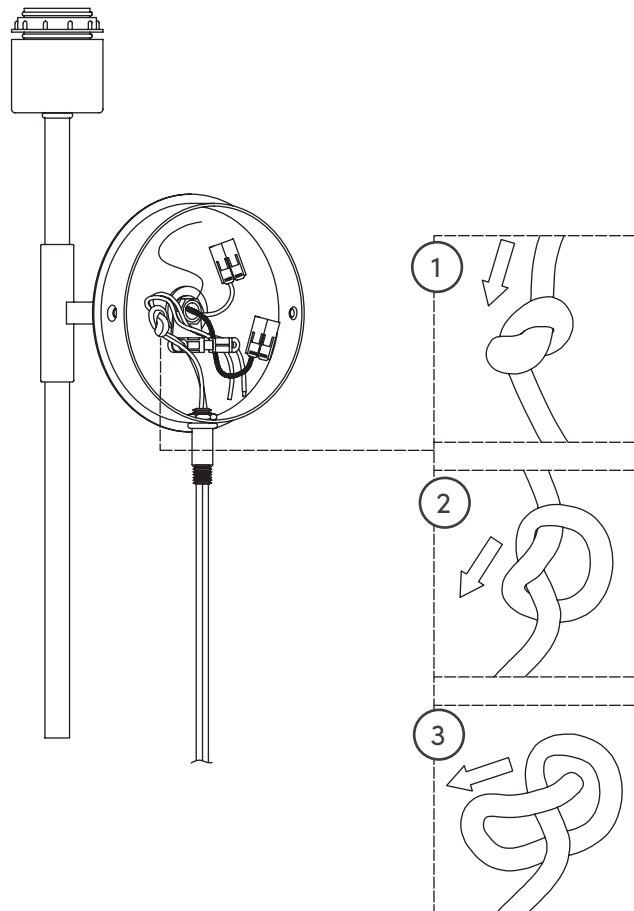

# Step 5

Remove the cord from out of the bottom of the Fixture.

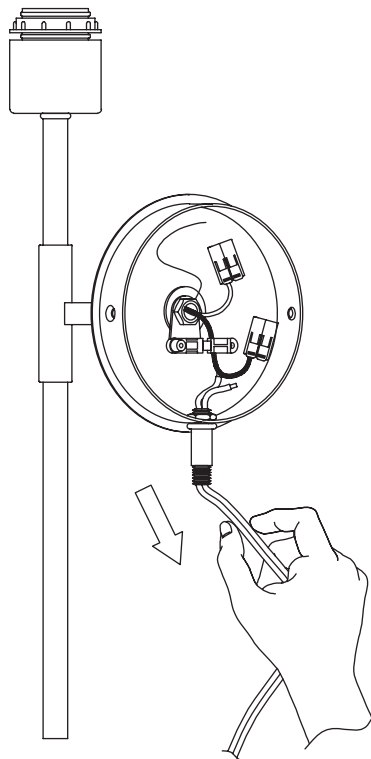



# Step 6

Decide your decorative cord stem desired length. See possible configurations below!

Then, pass the cord through each of the selected decorative cord stem components.

12" cord: (4)

18" cord: (2) (4)

24" cord: (3) (4)

30" cord: (2) (3) (4)

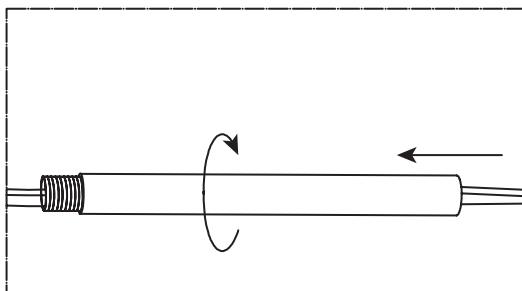
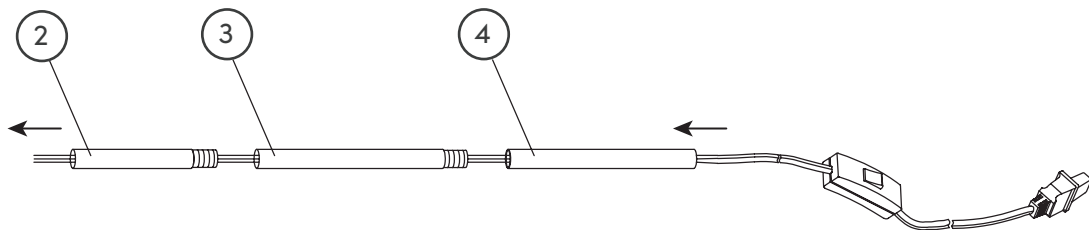
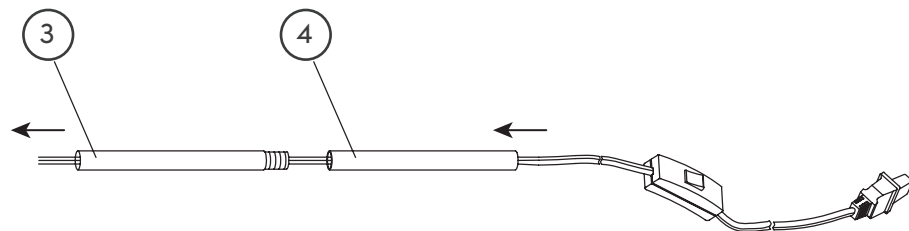
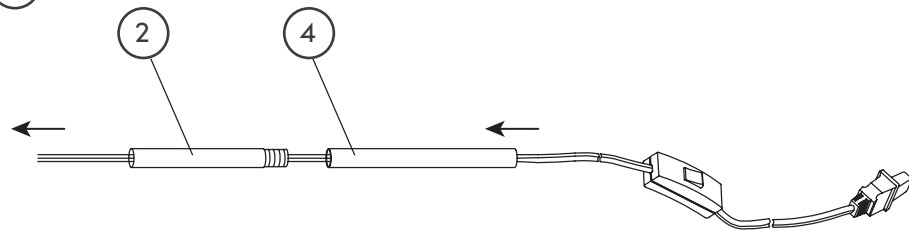
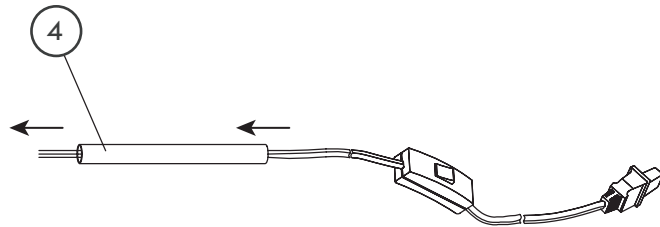

## Helpful tip:

Rotating the tube while threading the cord through will make things go a little more smoothly.

# Step 7

Thread the cord back into the Fixture (1).

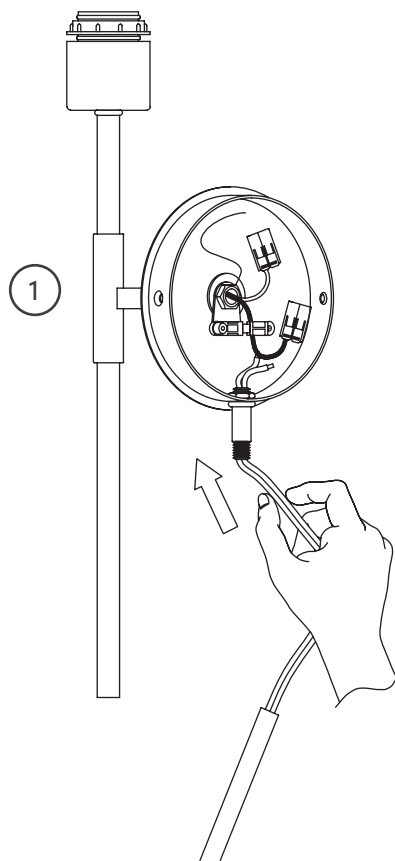

# Step 8

At this point, it is helpful to tie a knot on the inside of the Fixture (1), at the desired length, to prevent the cord from falling out during the rest of the assembly process.

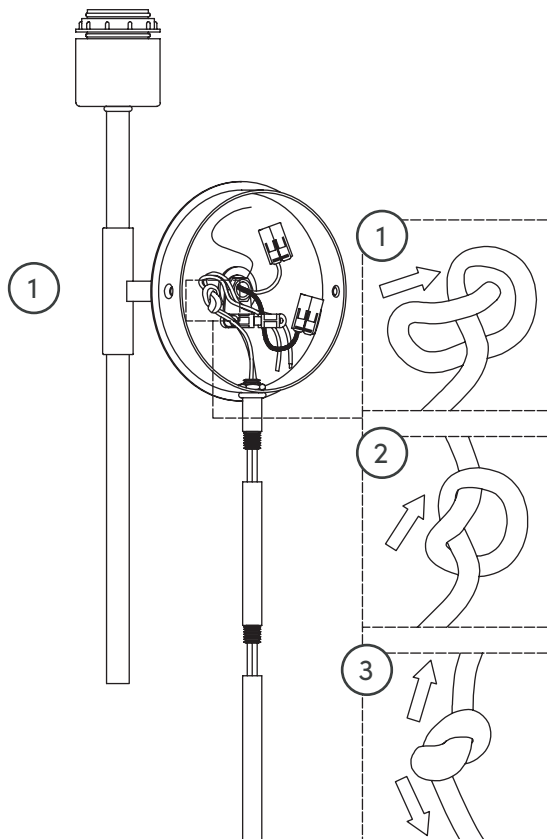

# Step 9

Using the pre-attached wire connectors in the Fixture (1), insert the Black (Neutral) wire into the connector with the White wire.

Insert the Black (Hot) wire into the connector with the Black wire.

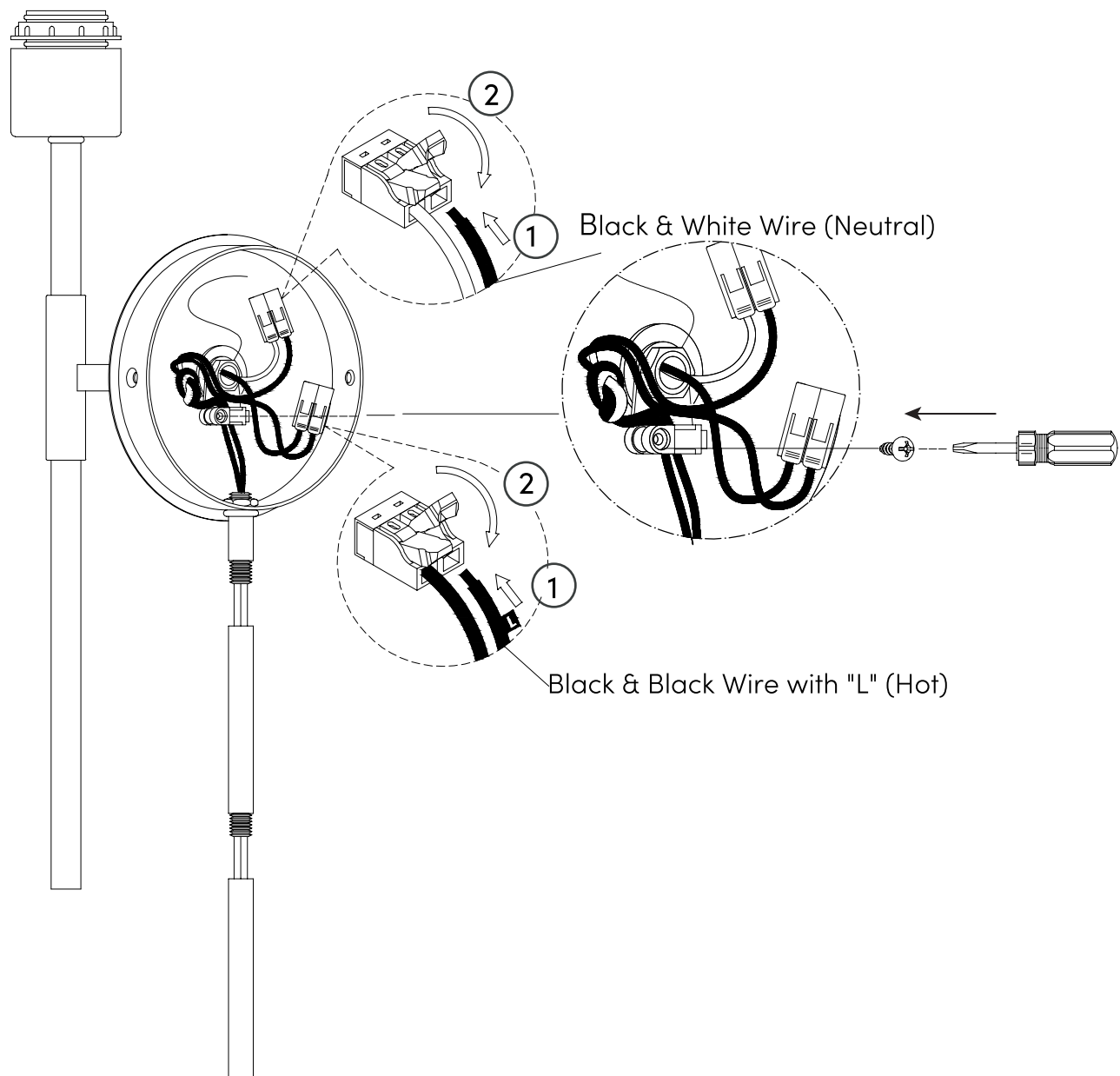

# Step 10

Thread the decorative cord stem components (from Step 6) together before finally attaching them to the bottom of the Fixture (1).

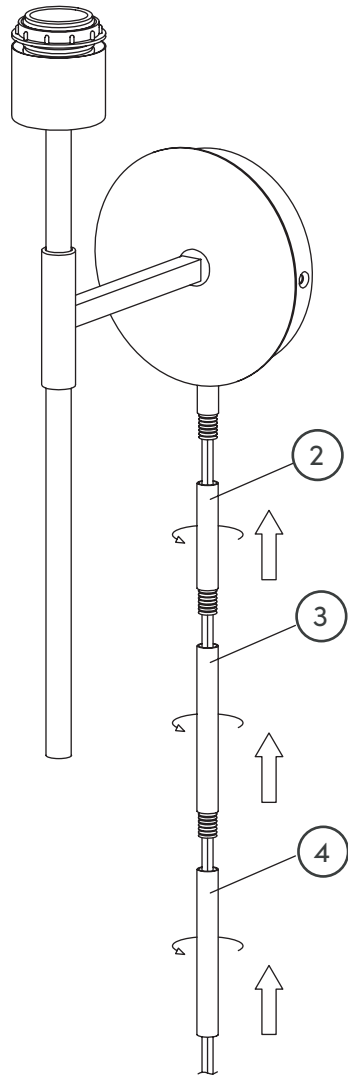

# Step 11

Place the Mounting Plate (C) in the desired location on your wall. Use the holes as a guide to mark where you will drill the holes for the wall anchors.

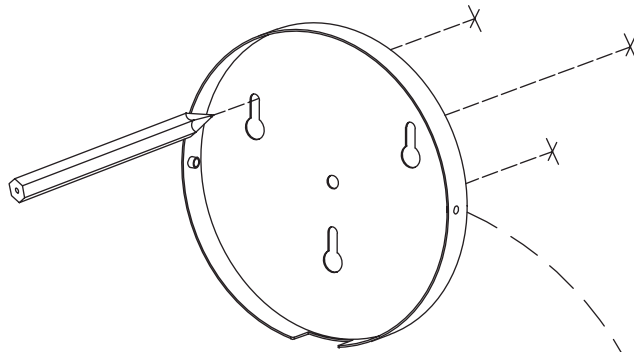

Double check to make sure that everything is level!

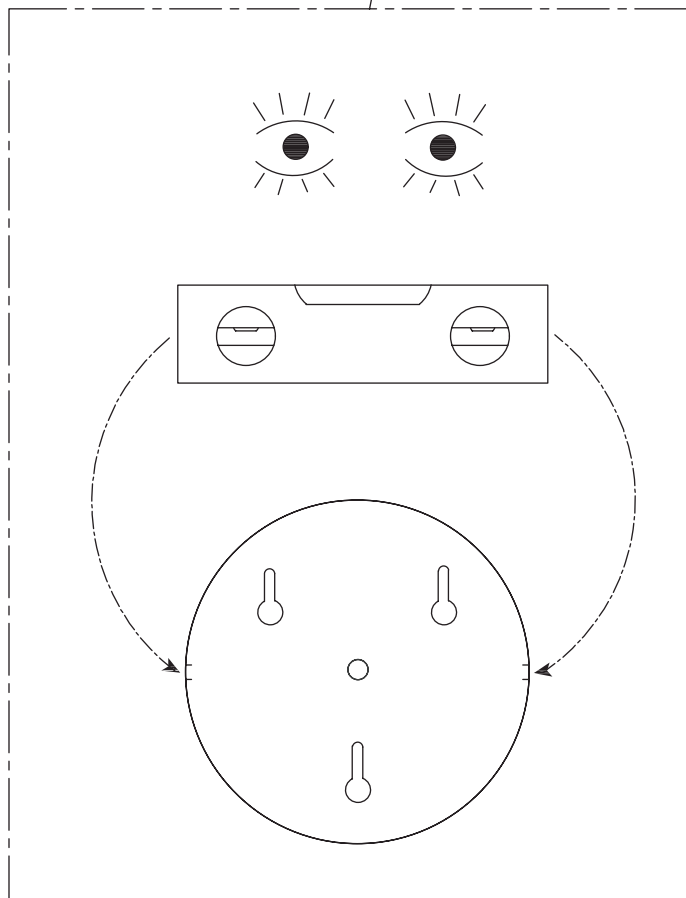

# Step 12

Using a 1/4" (or 6mm) Drill Bit, drill your holes for the wall anchors to be placed in.

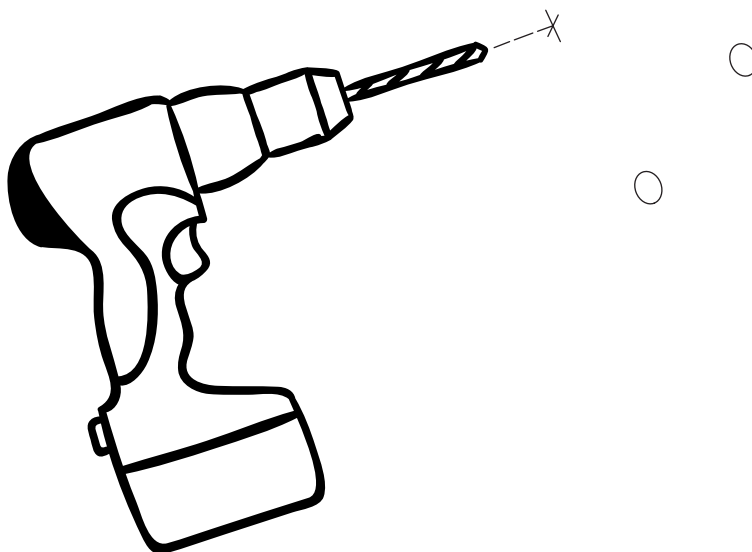

# Step 13

Insert the Wall Anchors (B) into the drilled holes.

If you encounter some resistance, feel free to use something to slightly tap them into place.

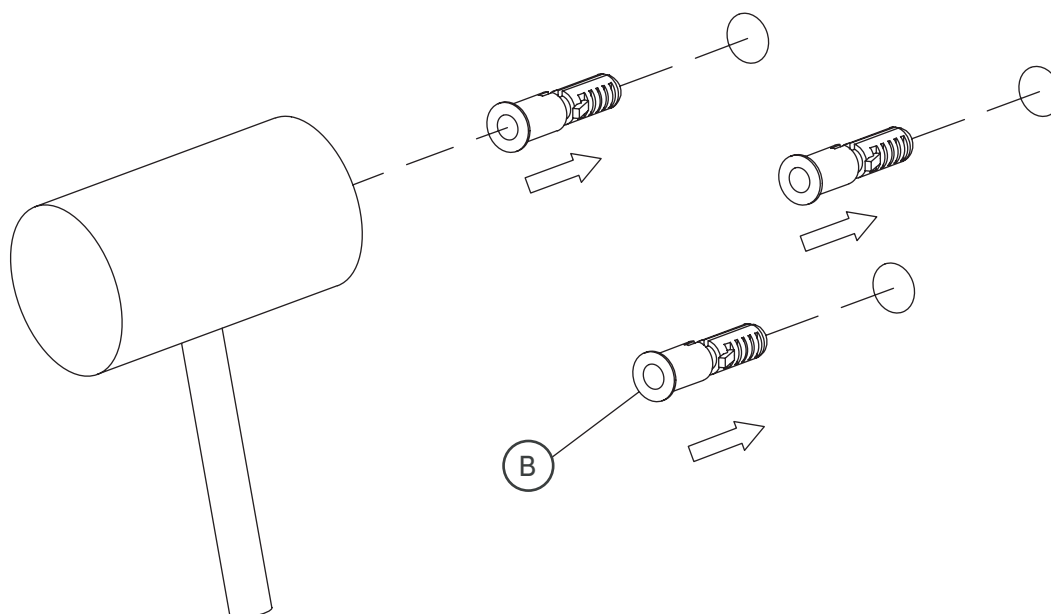

# Step 14

Mount the Mounting Plate (C)  
to the wall by screwing the  
M3.5\*35mm Screws (A) into  
the wall anchors.

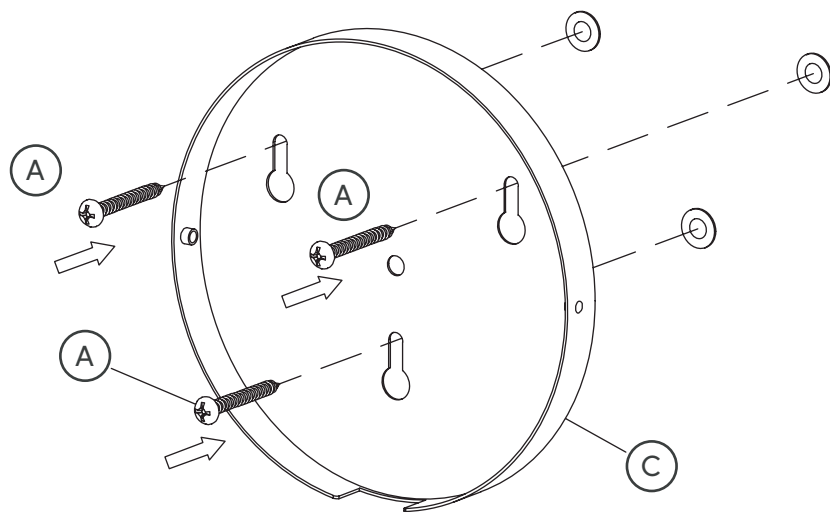

# Step 15

Secure the Fixture (1) to the Mounting Plate (C) using the M4\*15mm Screws (D).

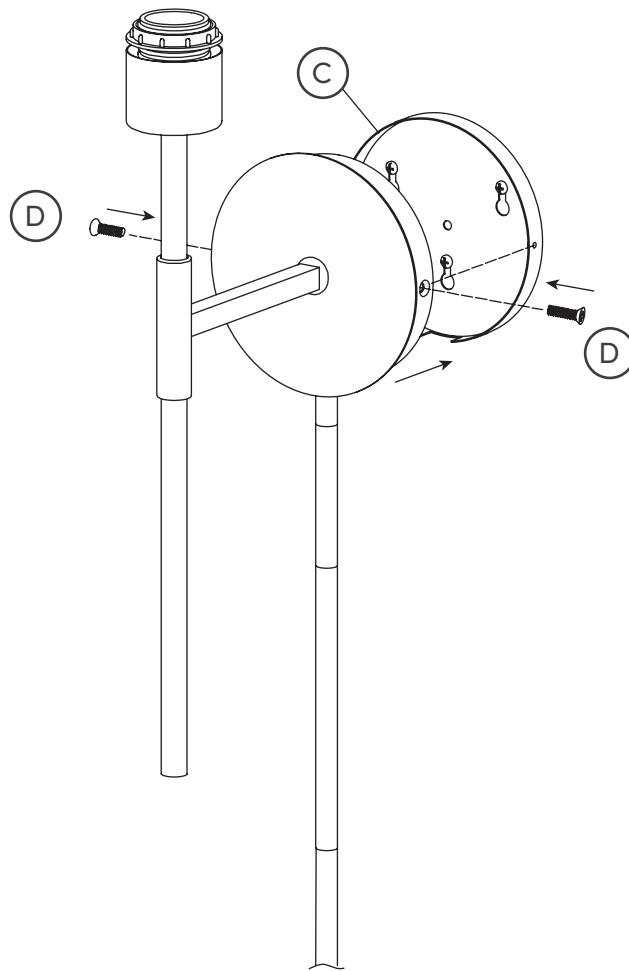



# Step 16

Remove the Shade Collar fitting from the socket by unthreading it from the Fixture's (1) socket.

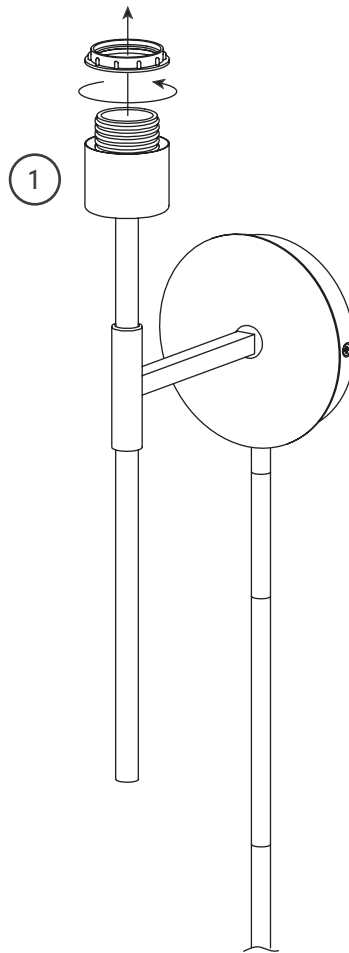

# Step 17

Time for the finishing touches!  
Install the Shade (6) by  
setting it in place with the  
Shade Collar Fitting that you  
removed in Step 16.

Thread the Collar Fitting back  
onto the socket with the Shade  
(6) sandwiched between the  
Collar Fitting and socket.

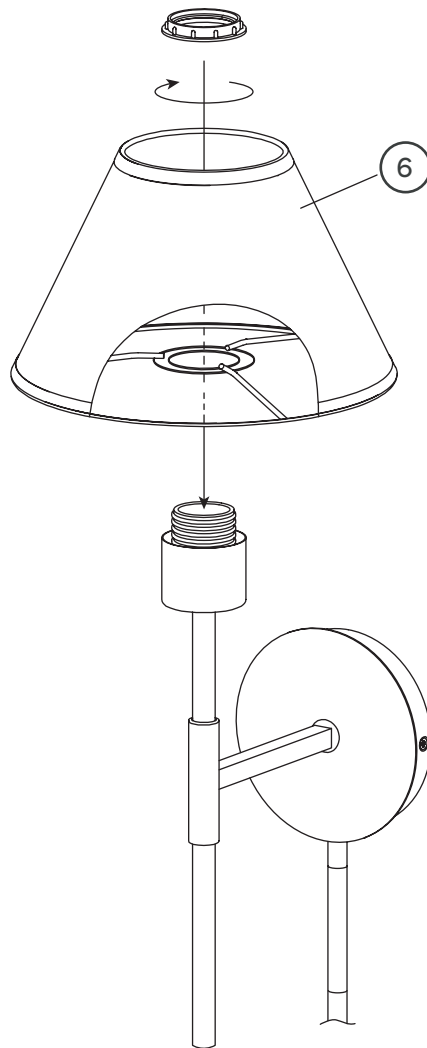

# Step 18

Last, but not least, secure one bulb (not included) into the Fixture (1) and hurray! Assembly is complete! That wasn't so bad, was it?

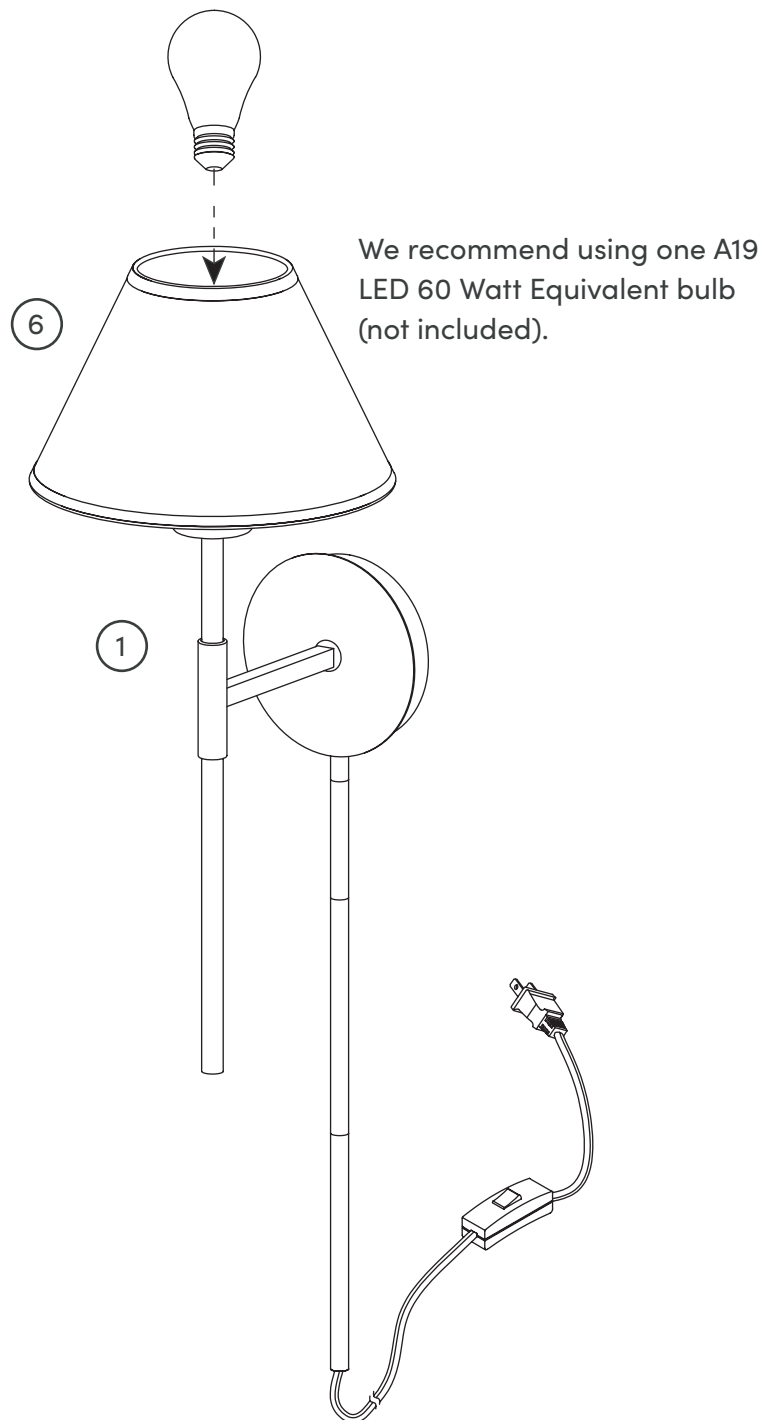

# Hardwired option

The following steps 1–14 are intended for hardwire mounting to your existing electrical box. Skip back to page 5 for directions on how to mount this light on your wall as a plug-in light.

## Step 1

Let's get this thing fired up! Or should we say, lit?

Thread the Fixture Stem (5) into place on the Fixture (1).

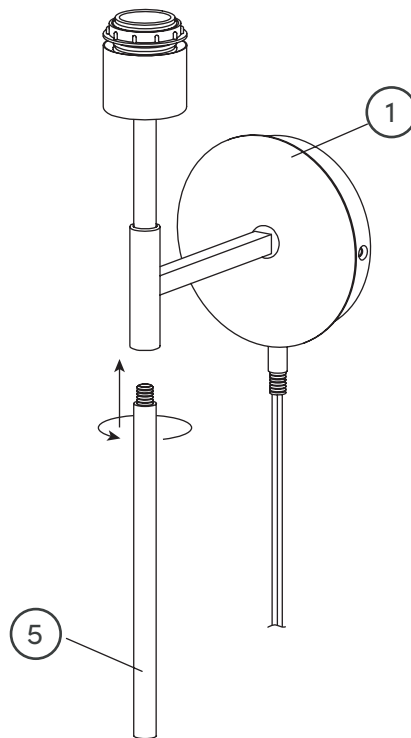

## Step 2

Separate Mounting Plate (C) from Fixture (1) by removing the M4\*15mm Screws (D).

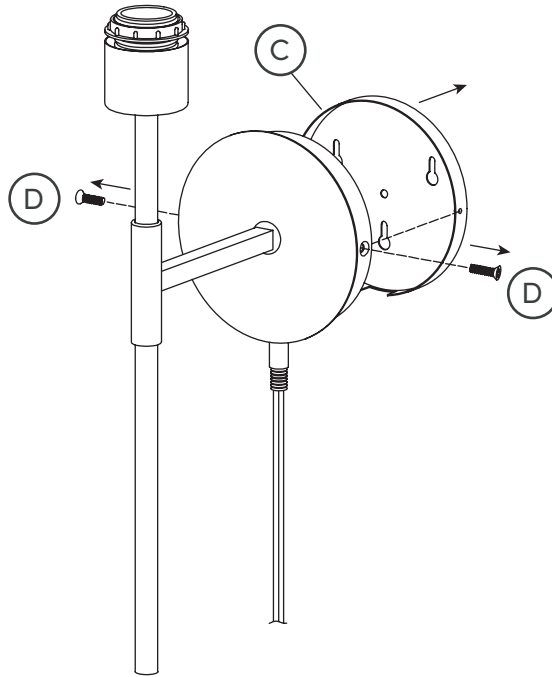

## Step 3

Remove the wires that run to the plug from each wire connector component in order to allow the cord to be released out of the bottom of the fixture.

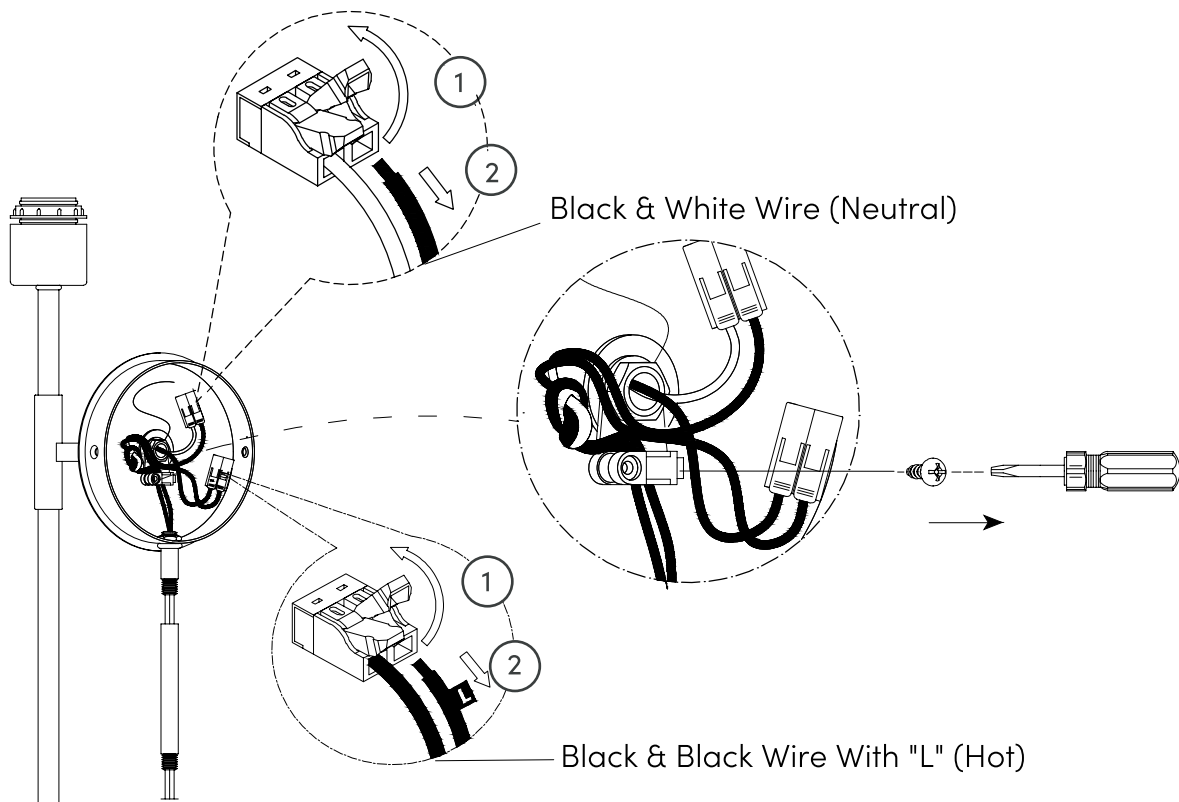

# Step 4

Untie the knot in the cord. Easy  
as 1, 2, 3!

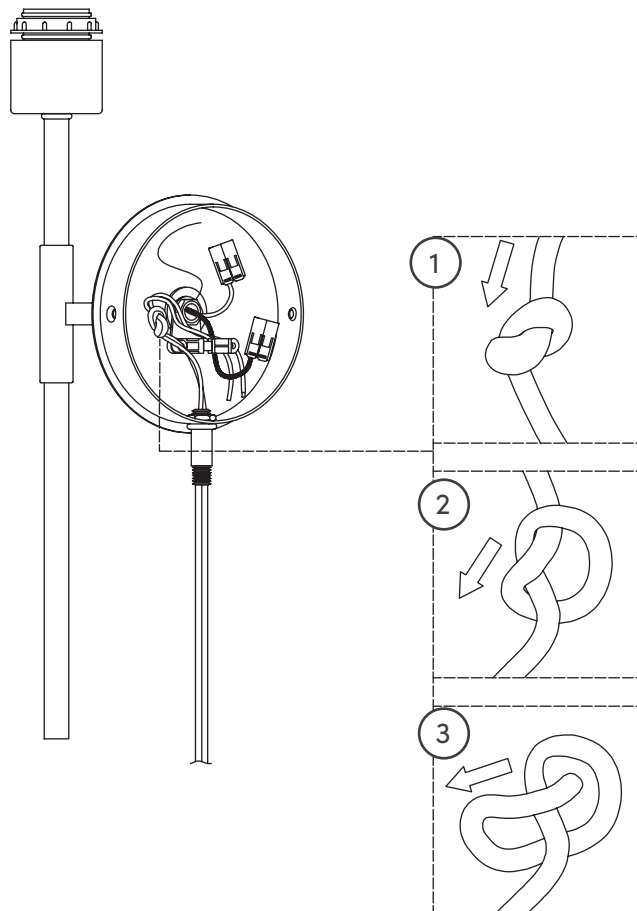

# Step 5

Remove the cord from out of the bottom of the Fixture (1).

P.S. We aren't judging you if you've already pulled out your snack. Ours was eaten by Step 2.

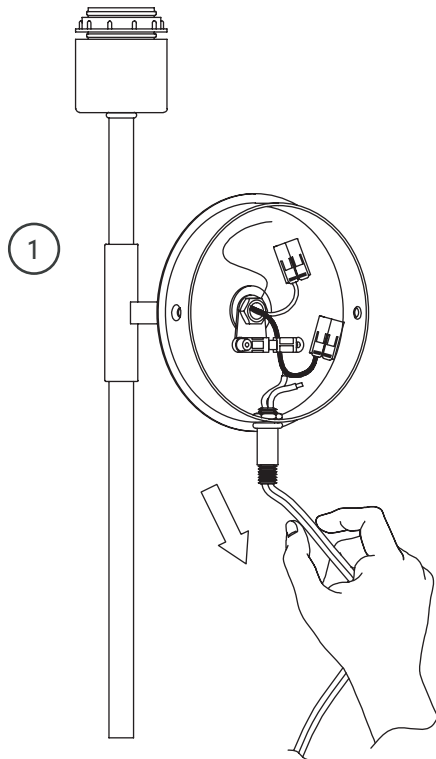

# Step 6

Using the provided wrench, remove the small stem from the bottom of the Fixture (1).

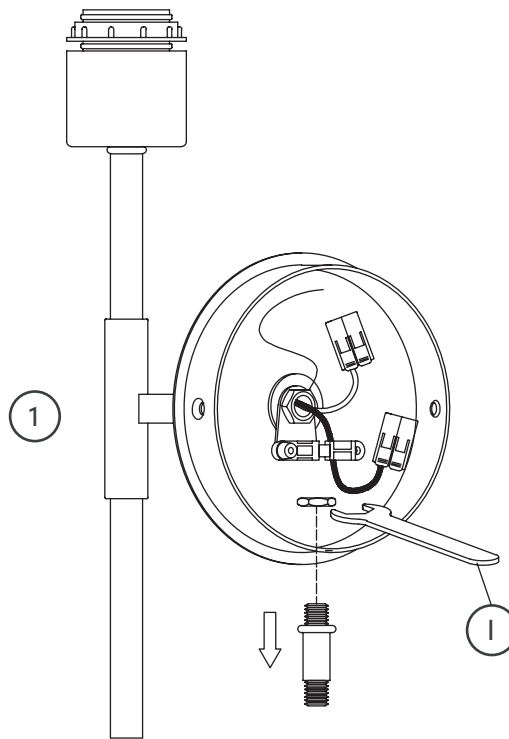

# Step 7

Place the plastic plug inside the hole in the bottom of the Fixture (1) that the small stem filled originally.

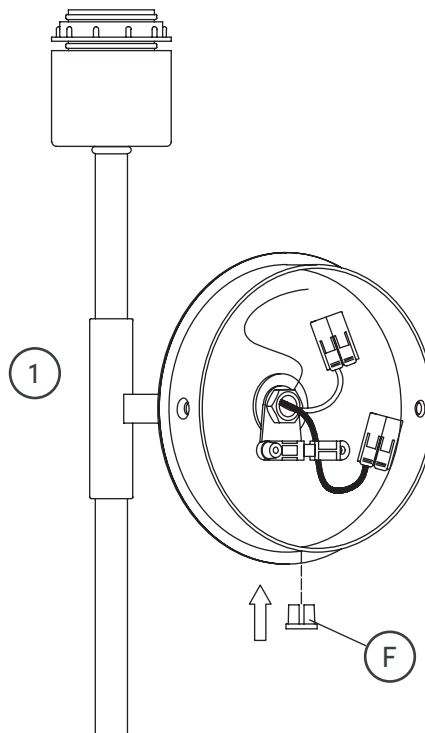



# Step 8

Mount the Mounting Plate (G)  
to the Electrical Box.

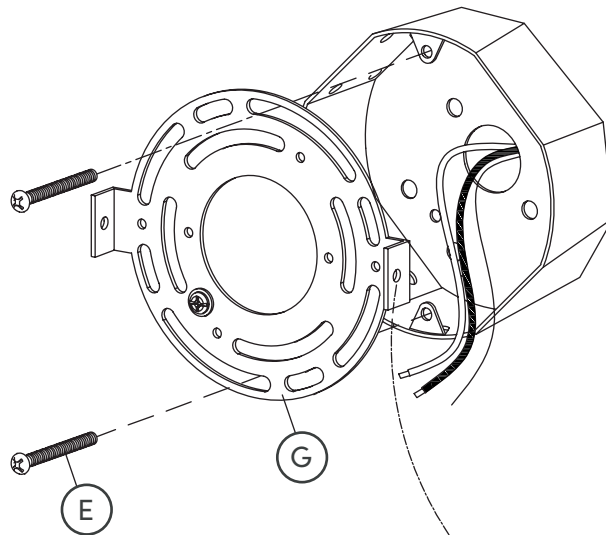

Double check that  
everything is level!



Note: Be sure that you are only making the connections to a 120V 60Hz AC circuit. If you do not have a pre-existing electrical box, we strongly advise using a certified electrician.

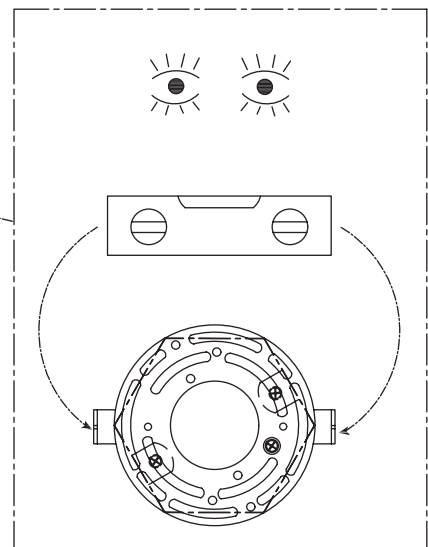

# Step 9

First, wrap the ground wire from the Fixture (1) around the grounding screw on the Mounting Plate (G) and then secure it in place by tightening the grounding screw.

Next, use the Wire Nut (H) to join the ground wires from the Fixture (1) and from the Electrical Box.

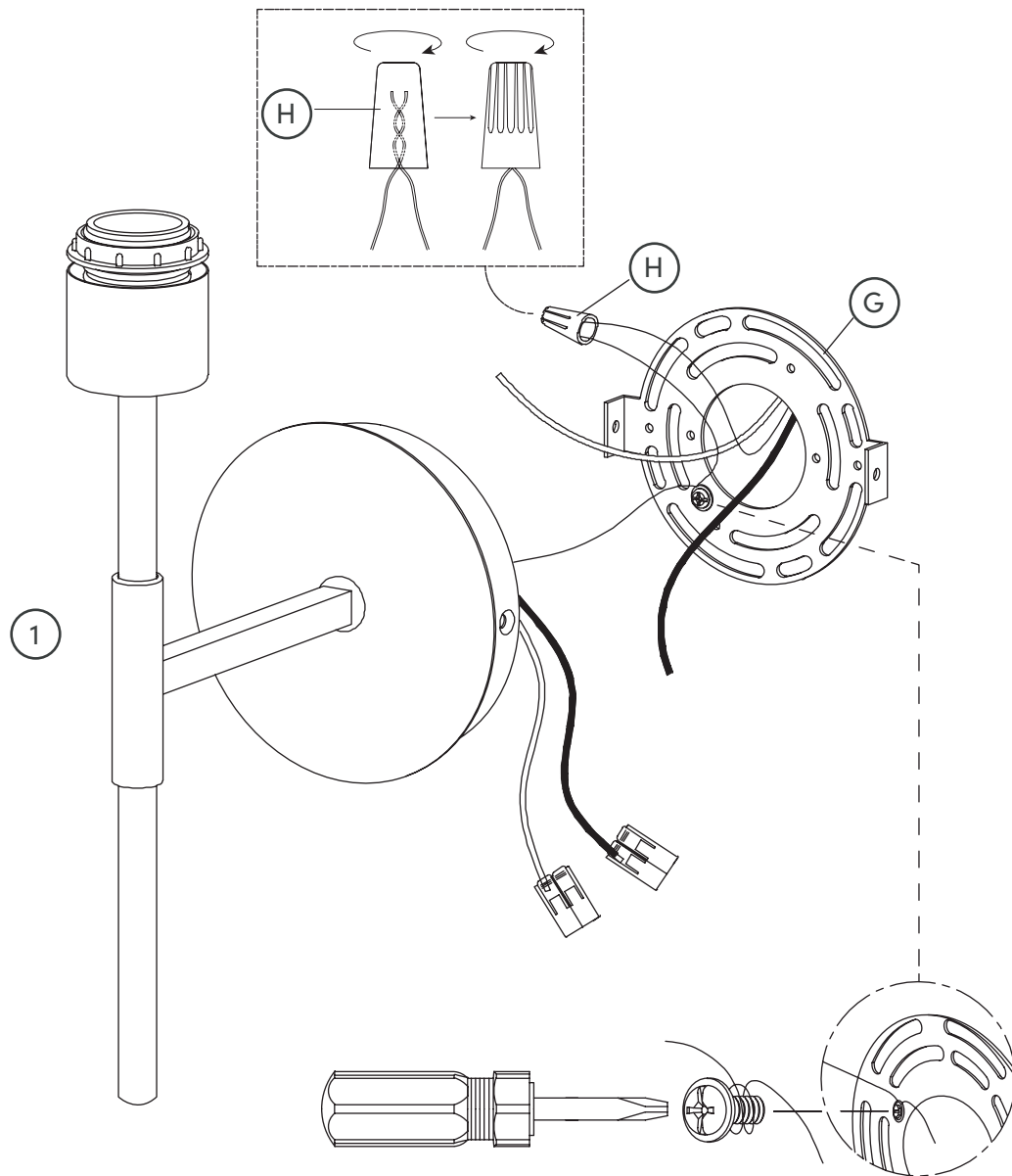

# Step 10

Using the pre-attached wire connectors in the Fixture (1), insert the White (Neutral) wire into the connector with the White wire. Insert the Black (Hot) wire into the connector with the Black wire.

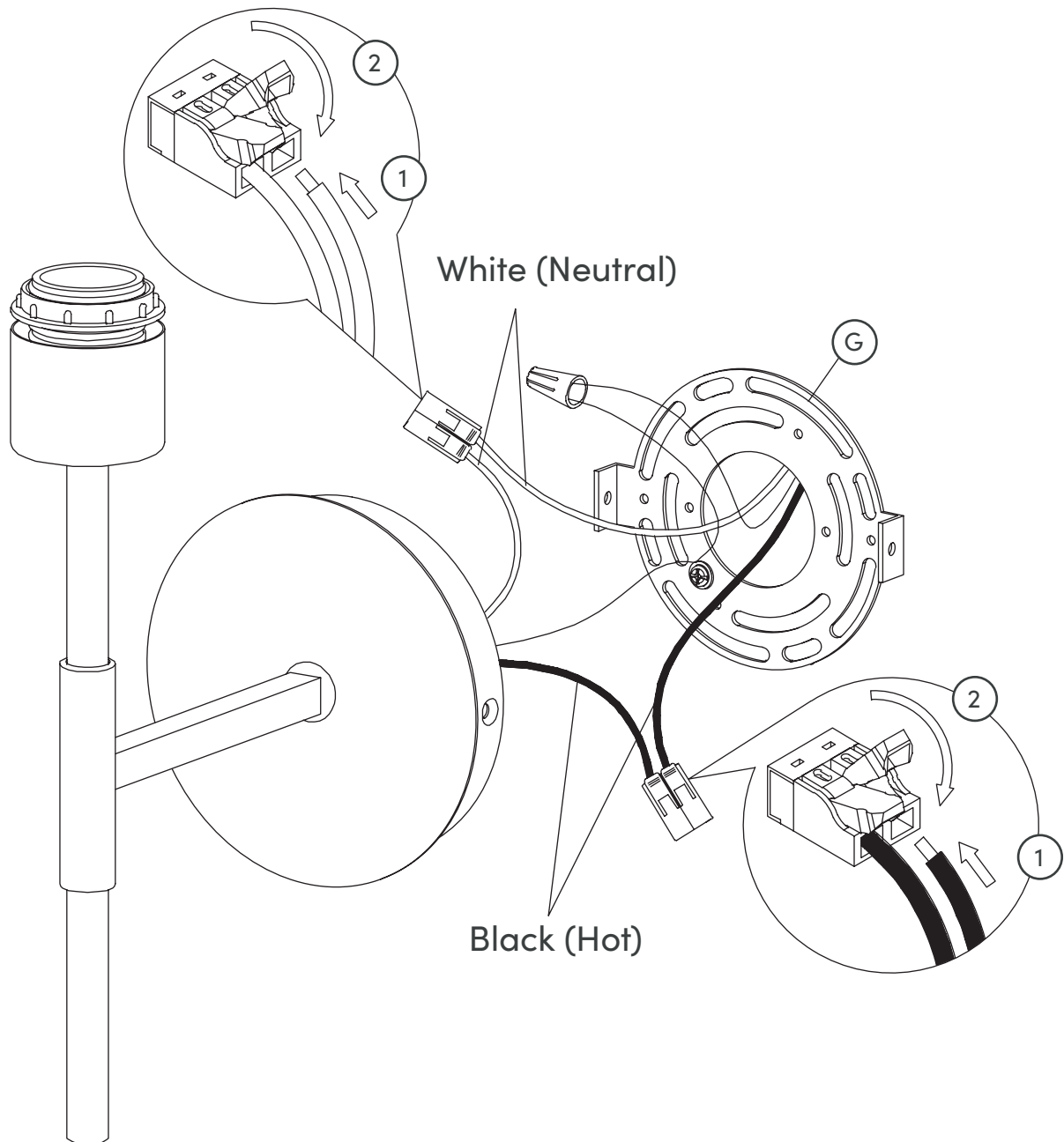

# Step 11

Secure the Fixture (1) to the  
Mounting Plate (G).

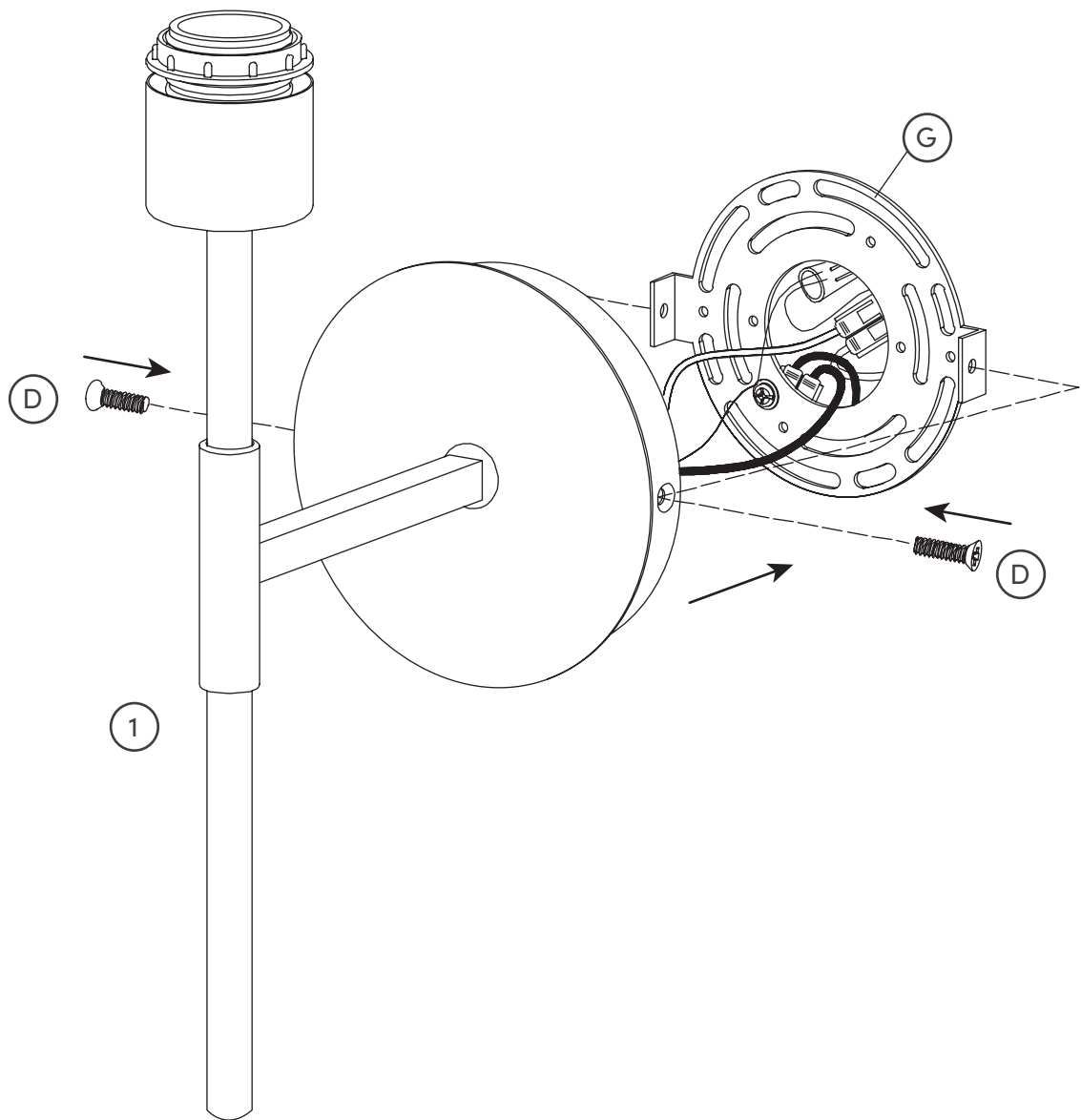

# Step 12

Remove the Shade Collar Fitting from the socket by unthreading it from the Fixture's (1) socket.

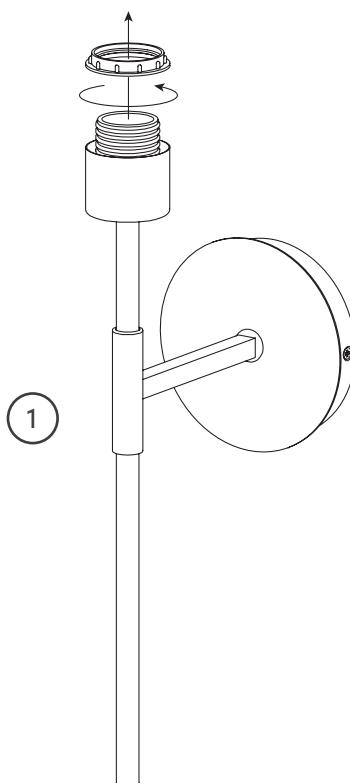

# Step 13

Time for the finishing touches! First, install the Shade (6) by setting it in place with the Shade Collar Fitting that you removed in Step 12.

Thread the Collar Fitting back onto the socket with the shade sandwiched between the Collar Fitting and the socket.

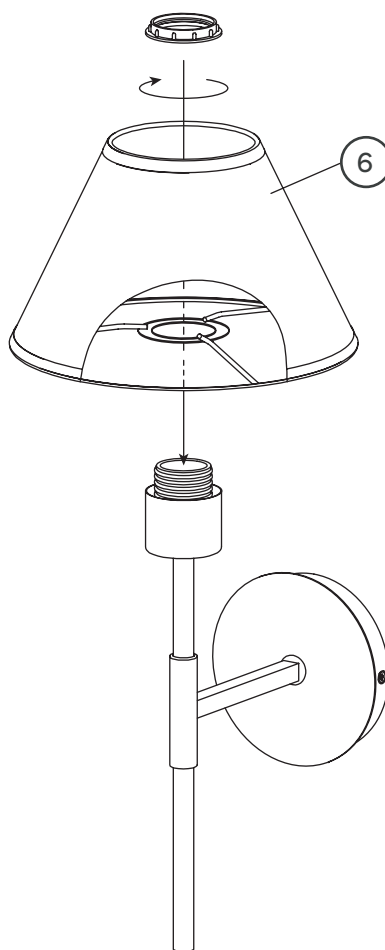

# Step 14

Last, but not least, secure one bulb (not included) into the Fixture (1) and hurray! Assembly is complete! That wasn't so bad, was it?

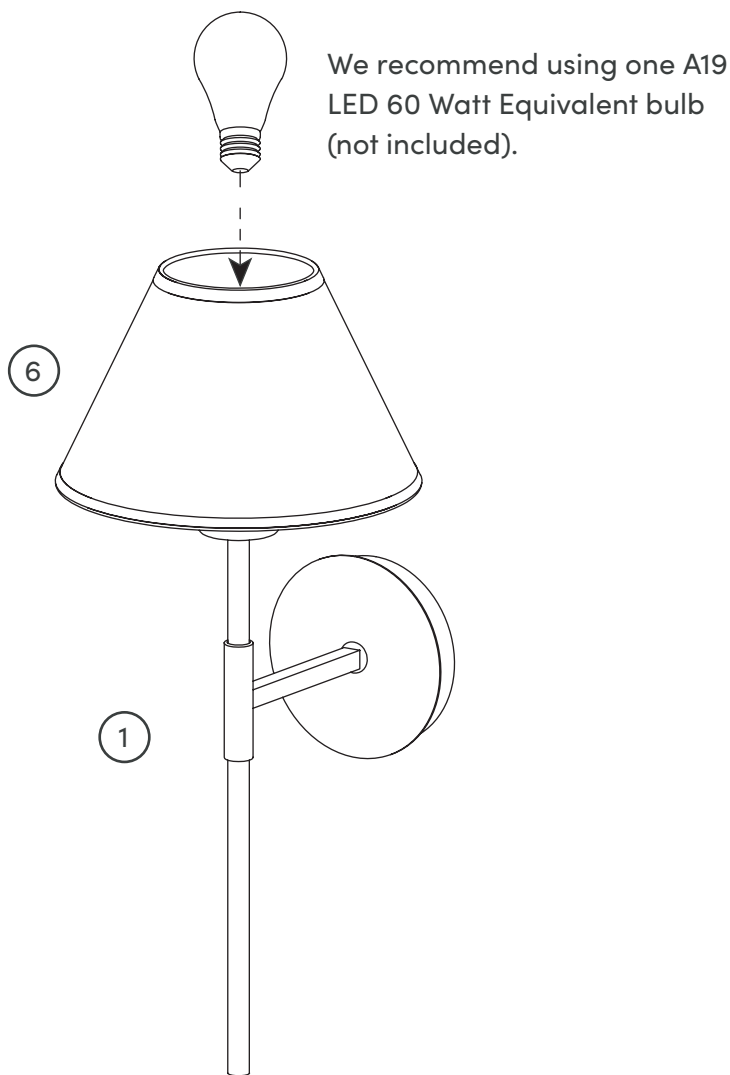

## Troubleshooting

Problem	Possible Causes	Solutions
The bulb will not light.	The bulb is burned out.	Replace the light bulb.
	The power is off.	Ensure the power supply is on.
	The circuit breaker is off.	Ensure the circuit breaker is in the ON position.
The fuse blows or circuit breaker blows when the light is turned on.	There is an exposed wire.	Discontinue use of the light. Contact a qualified electrician or reach out to our Customer Happiness team at <a href="mailto:help@nathanjames.com">help@nathanjames.com</a> or 1-866-619-1004.

# Questions? Don't worry, we've got the answers

## **What other light bulbs can fit in this light?**

The bulb must not be greater than the max wattage for the fixture. It must match the base size, and the diameter of any area of the bulb should be less than diameter of any area of shade, so that it can fit.

## **Can I use an LED light bulb?**

Yes, so long that the base size matches and the diameter of any area of bulb is less than diameter of any area of shade, so that it can fit.

## **Is this UL/ETL certified?**

Yes, all our products are either UL or ETL.

## **Do I need an electrician to set up the hardwire?**

We recommend using a certified electrician for all hardwiring, although all of our fixtures can be set up without an electrician, as long as you are replacing an existing fixture or have an existing junction box ready for a fixture installation. ENSURE POWER IS OFF WHEN INSTALLING. For all new constructions, please use a certified electrician.

## **Can I retrofit this hard-wired to a plug-in or vice-versa?**

Yes, a plug-in fixture can be turned into a hardwire fixture and a hardwire fixture can become a plug-in fixture. For many products we will provide all the necessary hardware to make these changes, if not, you will need to purchase the necessary hardware.

## **Is this light compatible outside North America?**

Our lighting is only warranted in Canada and the United States.

## **What do I do if the product is not working?**

Try a different light bulb and confirm proper installation.

## **Can these lights work on a dimmer?**

Dimmability is related to the light bulb and the wall switch, not the light fixture. All our hardwire fixtures are compatible with dimmable light bulbs. We recommend using a dimmer switch, as it extends the life of the bulb and allows for energy saving and great ambiance. If using a LED bulb, please ensure both your LED bulb and dimmer switch are compatible.

## **Can I use the fixture outdoors?**

No, this product was not designed to be used outdoors.

# No heartburn, when we handle the return

Give us a call **1-866-619-1004** or shoot us a message at **help@nathanjames.com** we will issue you a free replacement with **zero hassle**.

## Our way



Give us a call

---



Replacement

---



You

## Their way



Re-package item

---



Schedule pick up

---



Track package

---



Replacement

---



You

We really don't want you to go through the hassle of re-packaging your item and sending it back, because let's be honest...nobody has time for that.



# We are only in business if you're happy

For starters, thanks for being you.

☎ Toll-free at 1-866-619-1004

✉ Help@nathanjames.com

🌐 NathanJames.com/help

We do our best to ensure your product arrives without any problems, but occasionally mistakes happen—as humans we are imperfect beings. In the event that a part is damaged or missing, we will be more than happy to provide you with replacement part(s) for free.

## Warranty

This product comes with a lifetime warranty from the date of purchase. Please use your phone to scan the QR code to register your product or visit <https://goo.gl/i9dk3q>

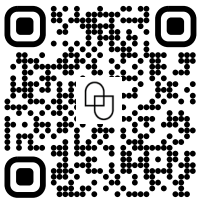

## Did we do alright? Please spread the love!

If you are happy with your product, tell your friends and family about us or even better leave us a review online. Spreading the word gives us the opportunity to make more people happy and keep our prices low for your next purchase.

*Brooklyn Burdon*

Founder, Nathan James