

ASSEMBLY INSTRUCTION FOR ACME FURNITURE

MODEL # BD00650

Thank you for purchasing the quality product. Be sure to check all packing material carefully for small parts which may have come loose inside the carton during shipment. Separate, identify and count all parts and metal hardware. Compare with all parts list to be sure all parts are present. If any part(s) are missing or damaged, please contact your local furniture dealer. For efficient and speedy service, please indicate the model number and code letter of part(s) needed.

WARNING

Injury may result from tipping furniture

This restraint is not a substitute for proper adult supervision.

This restraint may provide protection against tipping furniture.

Do not allow children to climb on furniture.

Failure to detach this restraint before moving furniture may result in injury and damage.

THIS BAG IS NOT A TOY

"WARNING - TO AVOID DANGER OF SUFFOCATION, KEEP THIS BAG AWAY FROM BABIES AND SMALL CHILDREN. DO NOT USE IN CRIBS, BEDS, CARRIAGES OR PLAY PENS. THIS BAG IS NOT A TOY."

KNOT BAG BEFORE THROWING AWAY.

ANTI TIPING KIT INSTALLATION INSTRUCTIONS

1. Attach the bracket to the back top rail of the furniture using the 18mm screw provided through the small hole.
2. Locate the other bracket on the wall 50mm below the bracket on the unit. Care should be taken to ensure that this is securely fastened to the wall. The best method of fixing will depend upon the construction of the wall. Please note we do not supply fittings for this purpose as the type of fixing required will vary depending upon your wall.
3. Place the furniture into position so both mounting brackets are vertically in line.
4. Lace the end of the restraint strap through the larger hole in each mounting bracket. Bring both ends together and slide the flat end through the locking end and draw it through until all slack is removed.
5. Confirm that the strap is securely laced and locked.

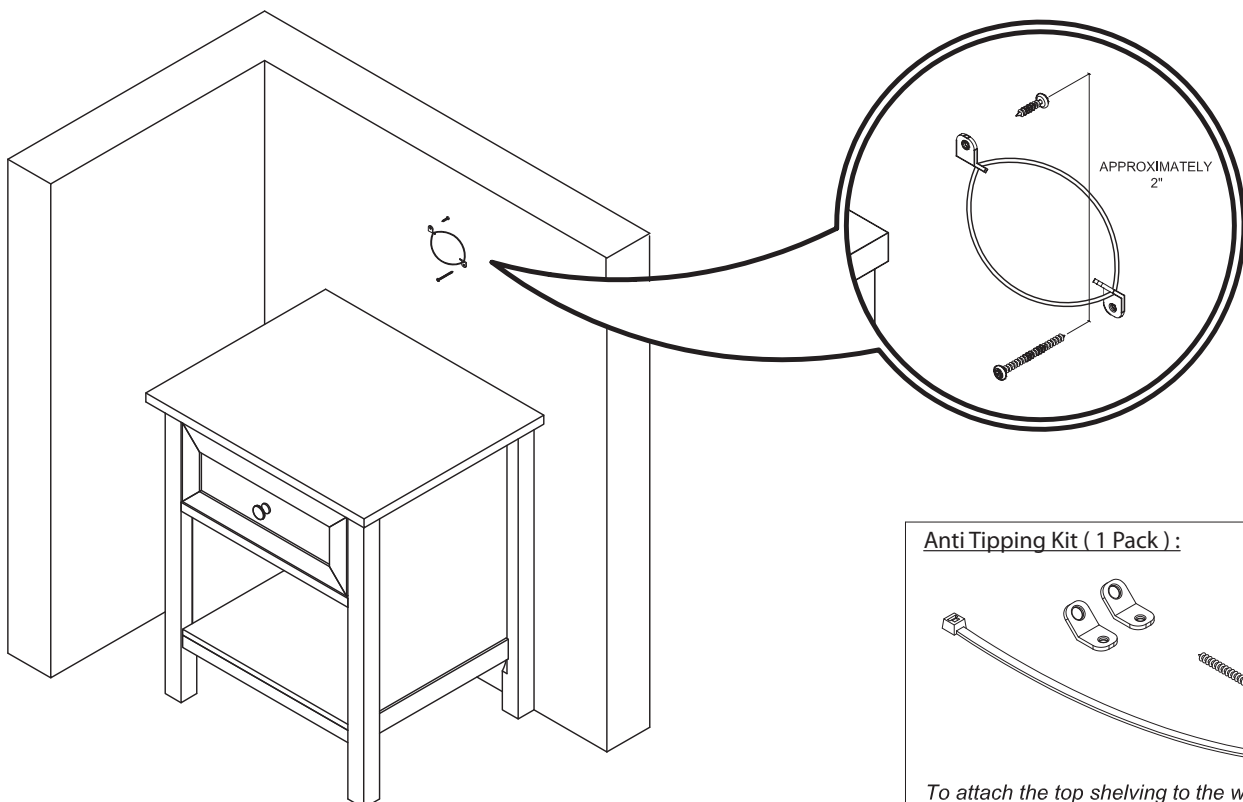

Anti Tipping Kit (1 Pack) :

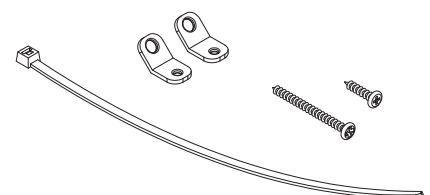

To attach the top shelving to the wall for added safety.