

ASSEMBLY INSTRUCTIONS

DRESSER



Thank you for purchasing the product. Please take time to read and follow the instruction below. Check that you have all parts and hardware before assembly. Parts apparently missing are often found in the packing materials. If you do not have all the parts listed, have your dealer contact us and they will be sent to you immediately.



It is recommended to install protective pads under all legs and supports to avoid damage or scratches when placing furniture on a wood floor or other hard surface, and to limit indentation and prevent discoloration if placing on carpet.

PART LIST			
NO	SKETCH	DESCRIPTION	QTY
1		DRESSER / BUREAU	1 PC
2		BUN FOOT / PIED	4 PCS
3		CENTER SUPPORT LEG / PIED	1 PC

HARDWARE LIST			
NO	DESCRIPTION	SKETCH	QTY
A	TIPPING RESTRAINT		1 SET

** SCREWDRIVER (NOT PROVIDED) /
TOURNEVIS (NON INCLUS)



STEP 1

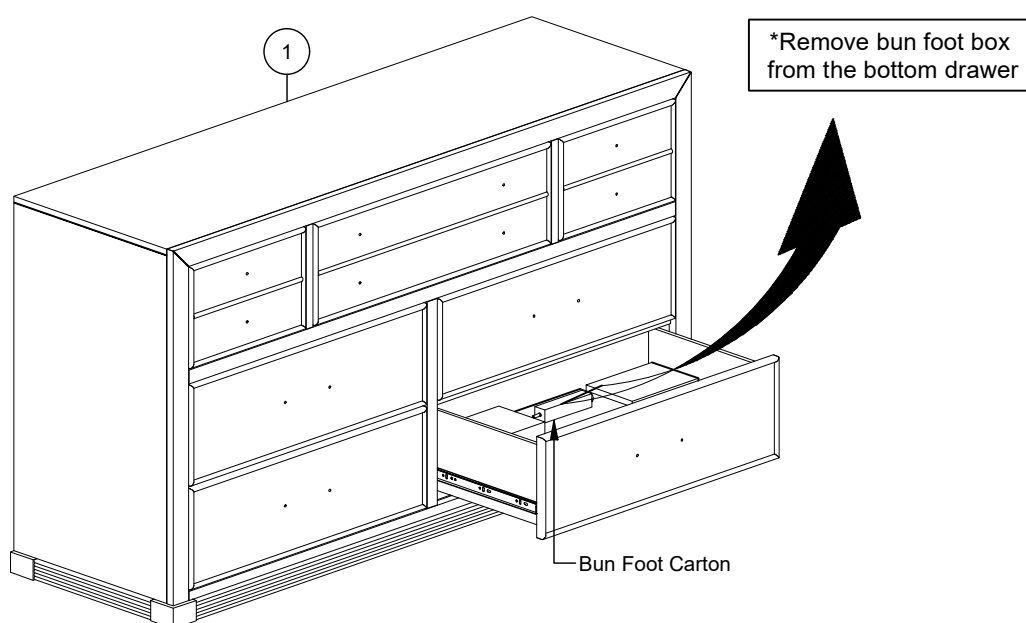

STEP 2

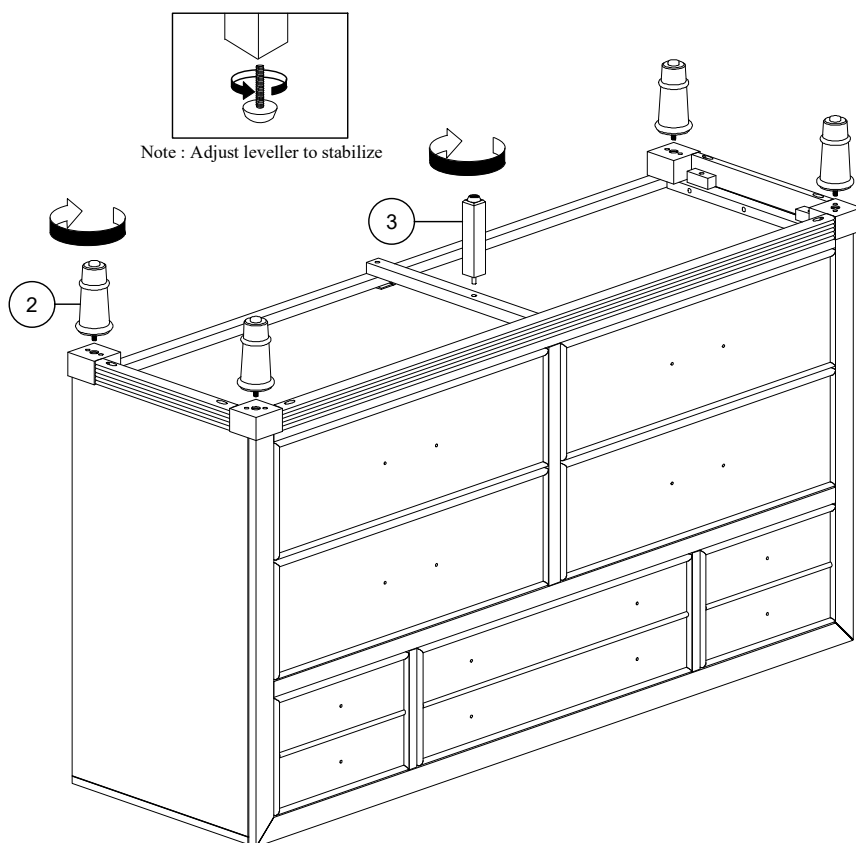

STEP 3

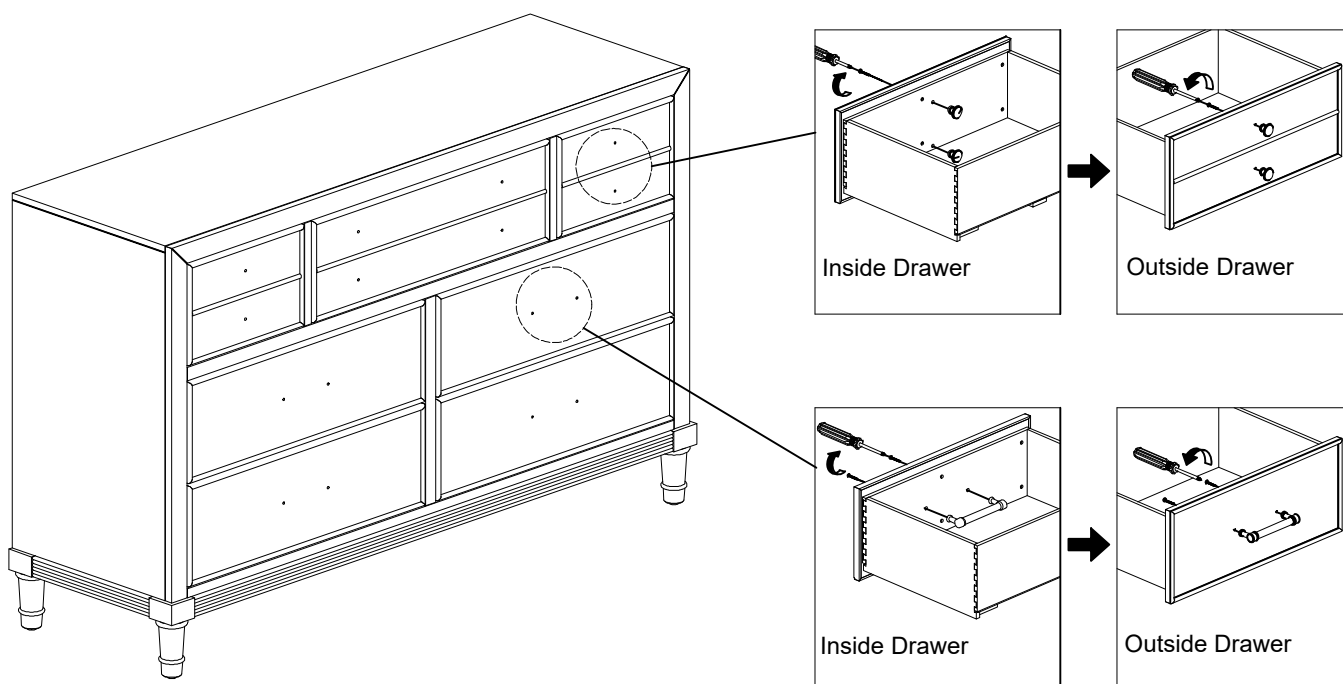

STEP 4

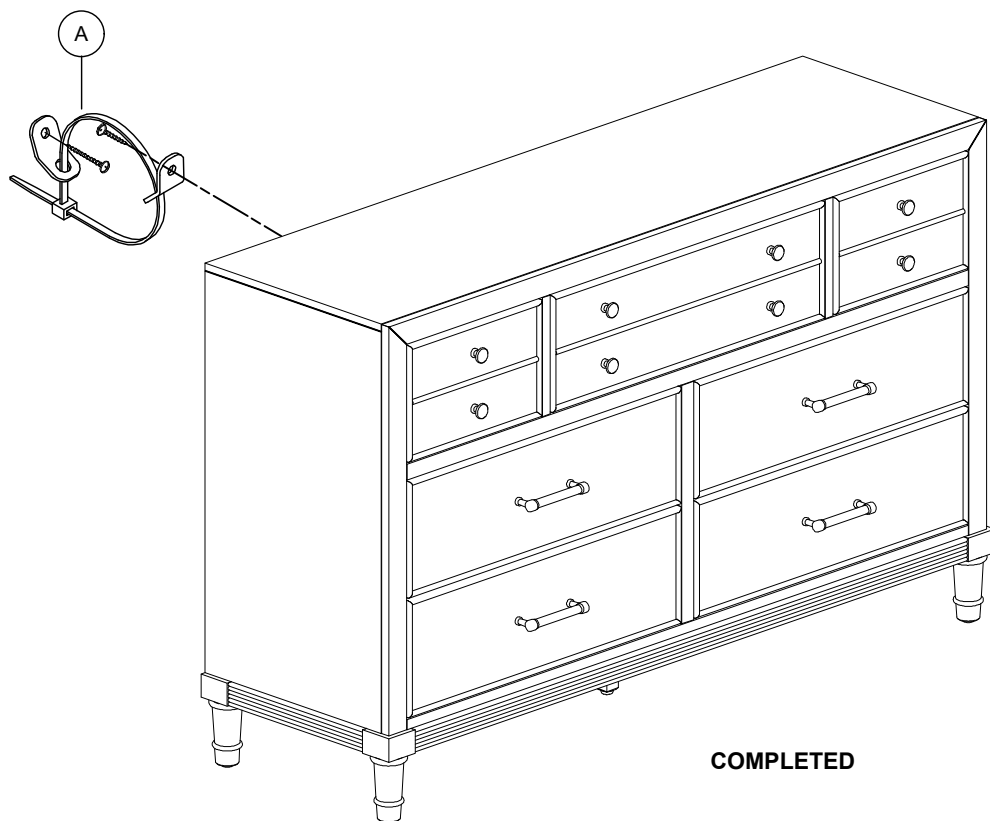

NOTE

Tipping restraint hardware kit is included with this product. Refer to installation instruction in the hardware pack.

*Anti-tipping hardware pack is at the back panel.

*