

---

---

# 11' Round Offset Umbrella With Resin Base

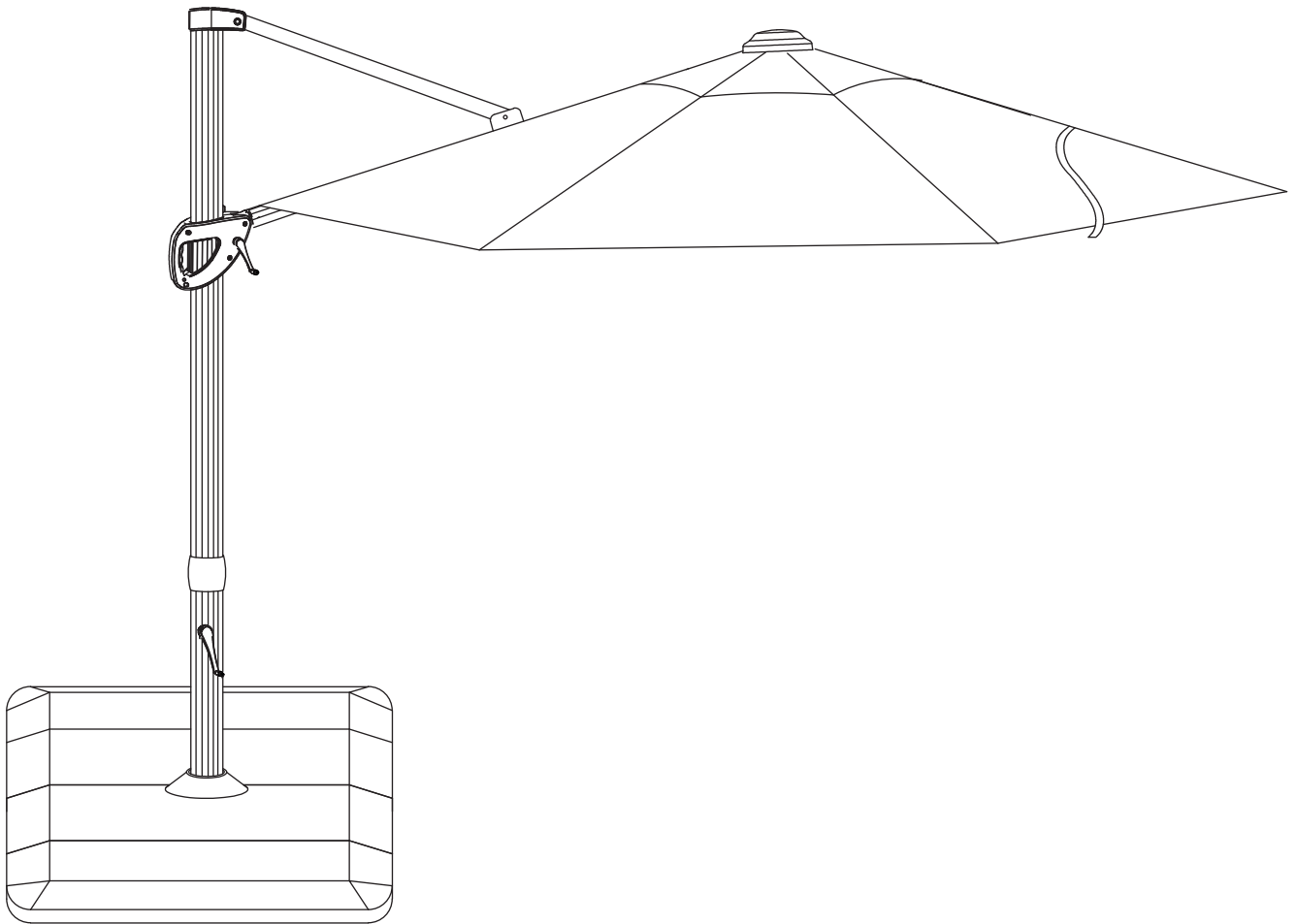

Professional Service Team: **[Savingmall@aliyun.com](mailto:Savingmall@aliyun.com)**  
If need any other assistance, Please feel free to  
contact us. we are always here at your service:)

User Manual

---

---

## General Guidelines

- Please read the following instructions carefully and use the product accordingly.
- Please keep this manual and hand it over when you transfer the product.
- This summary may not include every detail of all variations and considered steps. Please contact us when further information and help are needed.

## Notes

- Personal injury and/or damage to the product may occur if products are used outside of their intended purposes and/or if products have been changed/modified from their original design. The product must be assembled and used in accordance with the provisions of the manual. The seller does not assume any responsibility or liability with respect to any damage caused by incorrect assembly or improper use.
- Carefully check accessories when opening the package. If anything is missing or damaged, please contact us immediately.
- This parasol is only used for shading and decoration purposes.
- Store the parasol in a dry, sheltered place, such as a garage or basement during high winds, rainy days, and the off-season.
- Never force your parasol open. Umbrella mechanics should open gently and easily.
- Do not use sharp tools or equipment such as a knife or scissors when removing the protective material, as it may damage the product.

## Warnings

- Keep children away when assembling the product. Small parts are included in the package; they may be fatal if swallowed or inhaled.
- To avoid the potential dangers of suffocation, please keep all parts and packaging (film, plastic bags, foam, etc.) away from babies and children.
- Keep the parasol away from fire; do not use it during extreme cold and heat, and severe weather like rainy, windy, snowy days, and hailstorms, etc.
- If the crank becomes too hard to crank, check to see if the rope has come off the pulley. If you continue to turn the crank, the rope or crank handle could break.
- To prevent damage to the canopy, open the umbrella facing the opposite direction that the wind is blowing.

## Daily Maintenance

- Clean the canopy with a soft cloth moistened with a neutral detergent. Store it after completely drying, which will help reduce the growth of mold.
- Do not machine wash, do not dry.
- Do not iron.



# Contents

Package Contents . . . . . 3

Preparation . . . . . 4

Hardware Contents . . . . . 4

Assembly . . . . . 5-6

Operation . . . . . 7-8

Care and Maintenance . . . . . 9

## Package Contents

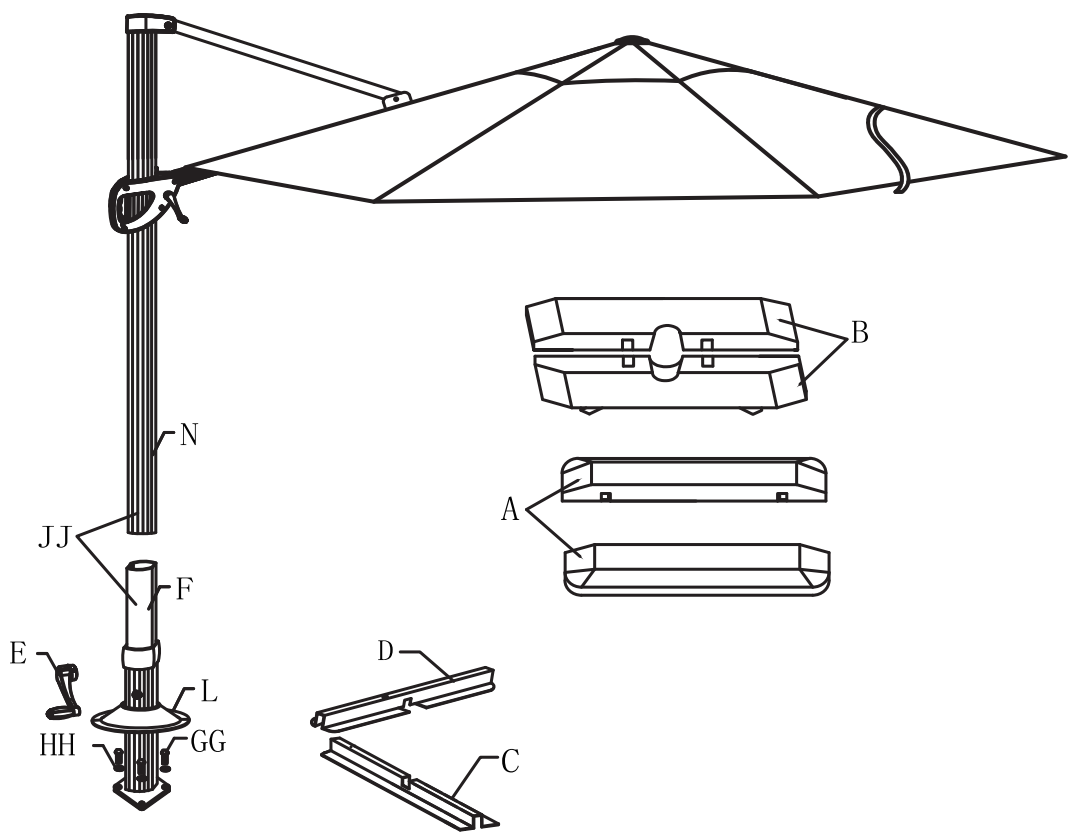

Part	Description	Quantity
A	Blow Molded Base Outside (with cap (M))	2
B	Blow Molded Base Inside (with cap (M))	2
C	Lower Cross Leg	1
D	Upper Cross Leg	1
F	Holder Pole (with handle E and support cup L)	1
CAN	Canopy (on the Umbrella Frame)	1
N	Umbrella Frame (with canopy)	1

## Preparation

**CAUTION:** Do not use sharp tools to remove the protective material, as it may damage the product.

Before assembling make sure all parts are present. Compare parts with package contents list and hardware contents list. If any part is missing or damaged, do not attempt to assemble the product.

Tools required for Assembly: Wrench and Phillips-head screwdriver (not included)

## Hardware Contents

GG



HH



JJ

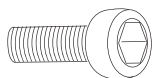

KK



Part	Description	Quantity
GG	Hex Bolt (M10 - 1.5x20)	4
HH	Washer (M10)	4
JJ	Hex Bolt (M8)	2
KK	Hexagon Wrench M8	1

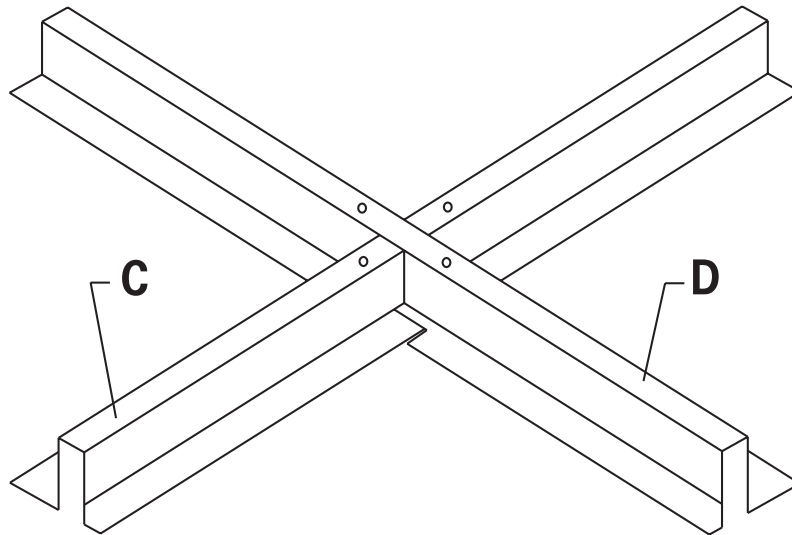

**Step 1:** Place Lower Cross Leg (C) on the ground, line up notches and place Upper Cross Leg (D) over the Lower Cross Leg (C)

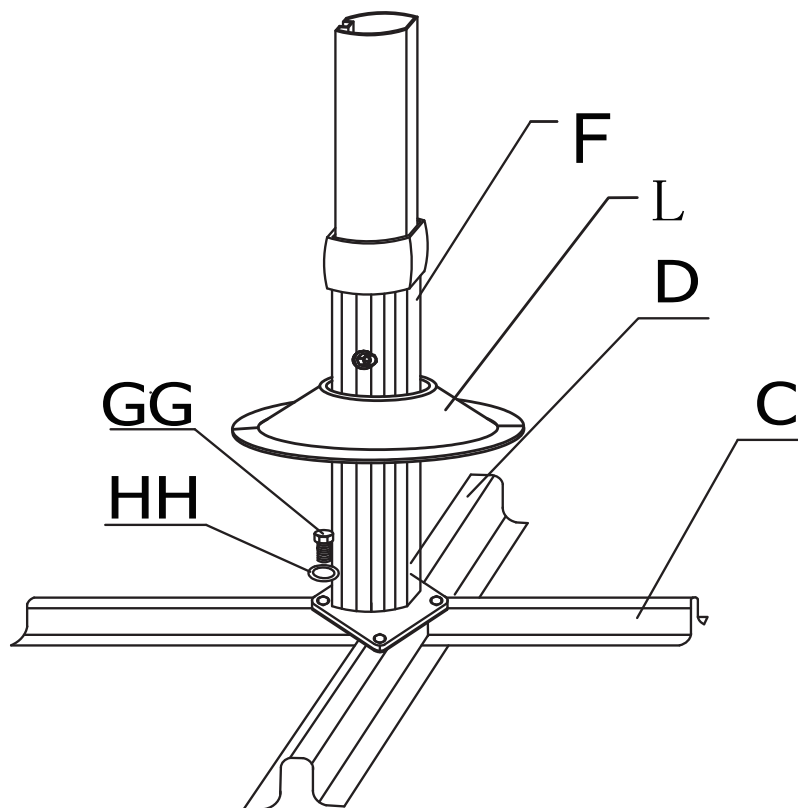

**Step 2:** Attach the Holder Pole (F) to the base by using the Bolts (GG) and Washers (HH), hand tighten only. Adjust the Holder Pole (F) to be sure it is positioned correctly on the base and finally tighten all bolts. Be careful not to over tighten.

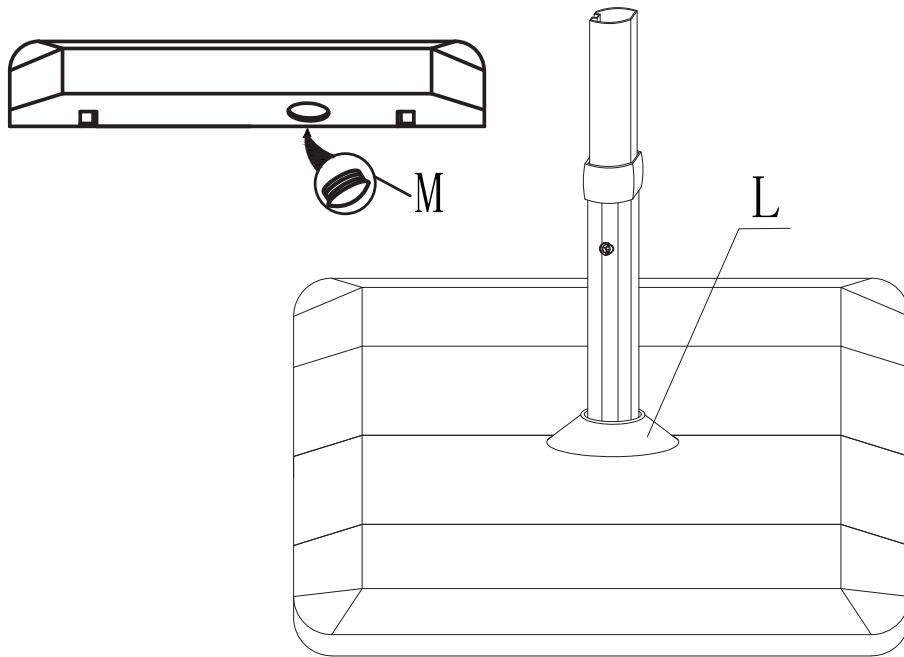

**Step 3:** Place Blow Molded Base (A & B) on the cross bar assembly and fill with sand and water, cover with caps (M). Place Pole Support Cup (L) onto Holder Pole (F) and lay on top of Blow Molded Base (B).

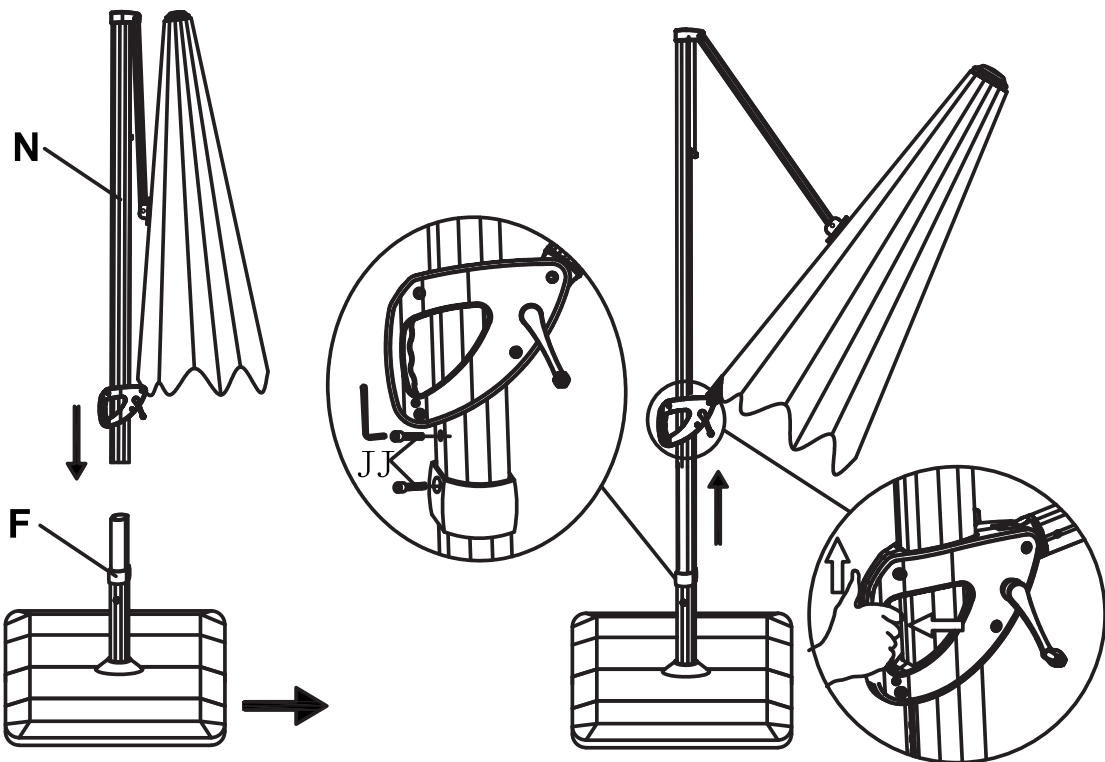

**Step 4:** Insert Umbrella Frame with Canopy (N) into the Holder Pole (F). Slide the holder pole collar onto the holder pole at the same time. Tighten the two Hex Bolts (JJ) into the holder pole to secure the umbrella.

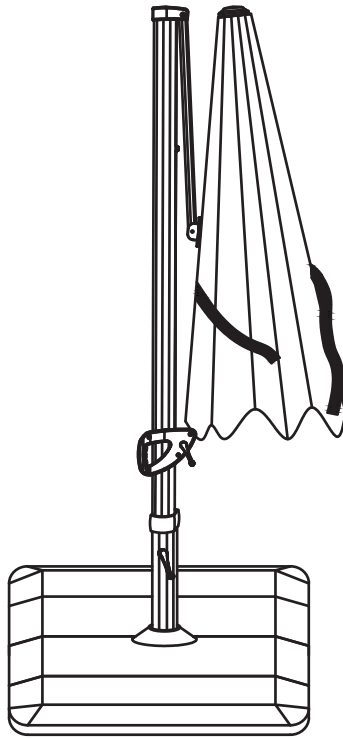

**Step 1:** Unfasten the storage straps around the canopy

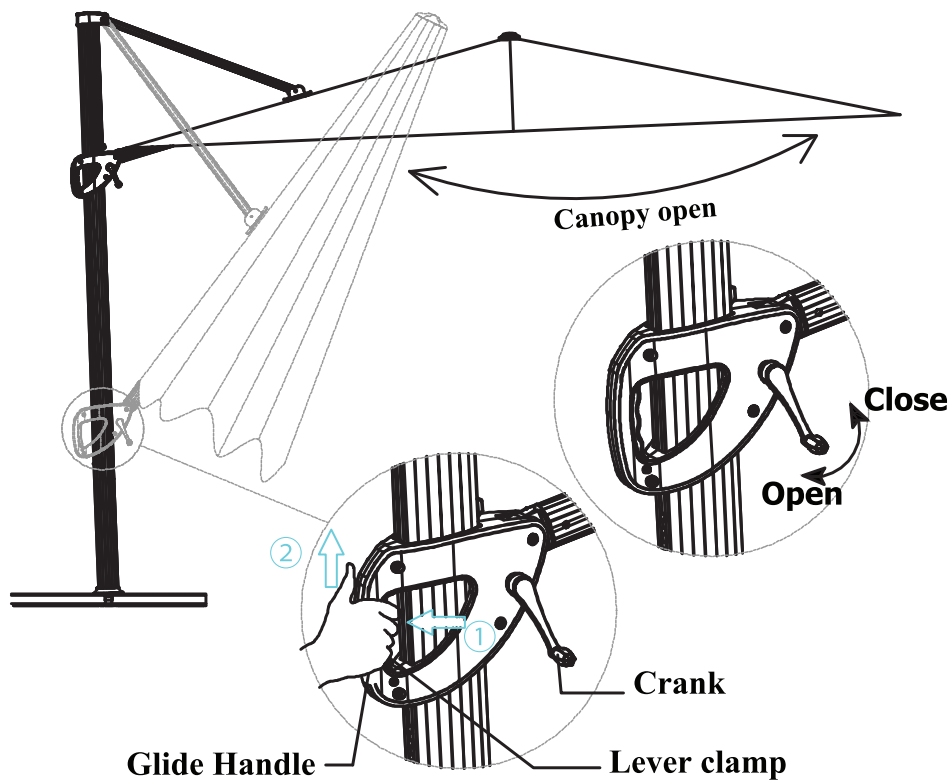

**Step 2:** To open the umbrella, squeeze the Glide Handle and grip together and slide up or down the pole to achieve the desired tilting angle. Release the grip to lock into place. To open the canopy, turn the crank handle clockwise until the canopy is fully open.

Canopy position  
adjusting

Rotates  
360°

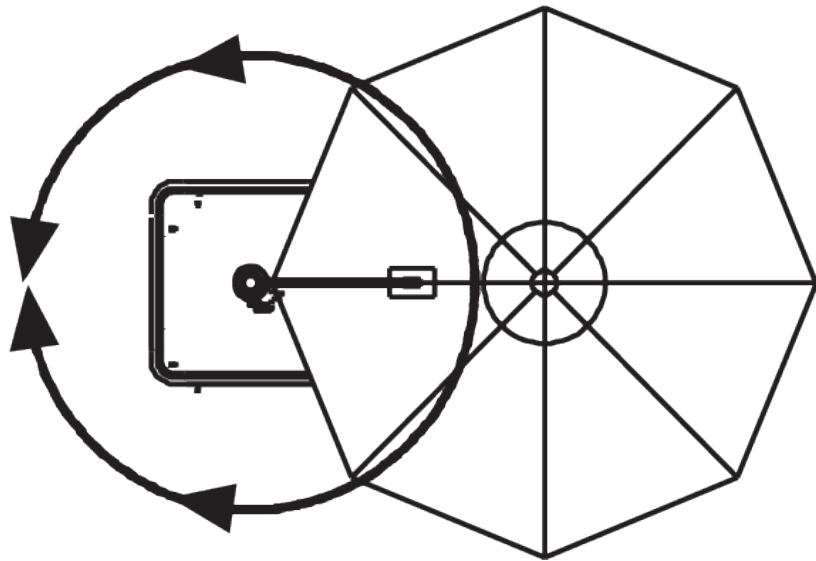

**Step 3:** The multiple position canopy can rotate 360° around the axis of the main pole to offer the shade on your expected area around the umbrella.

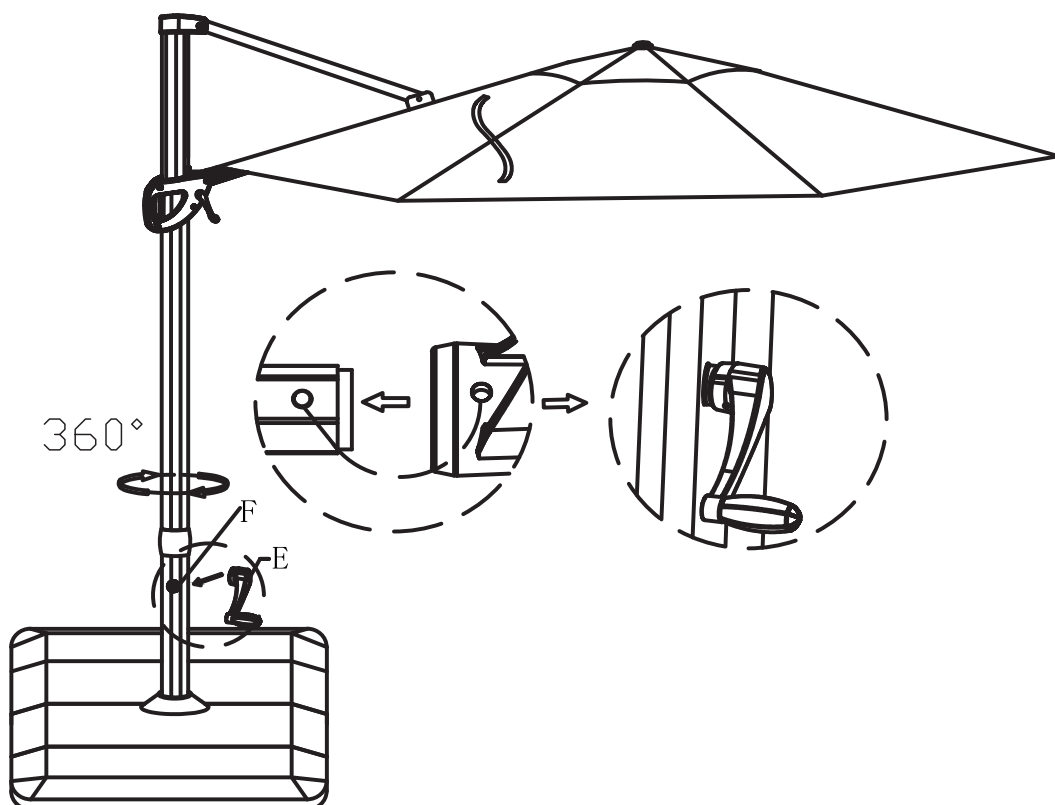

**Step 4:** To rotate umbrella, insert the crank handle (E) into holder pole (F) and turn to desired position.

---

## Care and Maintenance

---

- Simply clean the umbrella canopy with a soft brush and mild detergent.
- Do not machine wash.
- Do not iron.
- Air dry the canopy thoroughly before storing for extended periods of time.
- Make sure the canopy is completely open during drying process to prevent shrinkage.

## Warnings and Cautions

---



**DANGER:** Keep children out of the assembly area during assembly.



**WARNING:** Do not use the umbrella during periods of high winds and rain as this may result in personal injury and/or damage.



**WARNING:** Be sure to secure and/or weight the base of the umbrella.



**WARNING:** Always take the umbrella down when not in use.



**WARNING:** To prevent damage to the canopy, open the umbrella facing the opposite direction that the wind is blowing.

**IMPORTANT:** If the crank becomes too hard to crank, check to see if the rope has come off the pulley. If you continue to turn the crank, the rope or crank handle could break.

**IMPORTANT:** Placement of the umbrella over or near a swimming pool can cause premature fading of the canopy. This is not covered under our warranty.