

ASSEMBLY INSTRUCTIONS

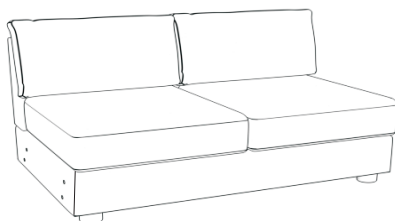

PARTS LIST

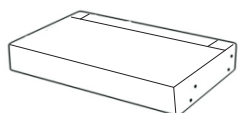

A

x1



B

x1



D

Leg

x4



5

x2

Open up Velcro of Non-Woven Fabric cover
on the bottom of the seat frame to remove **seat cushions,**
Back cushions and **legs**

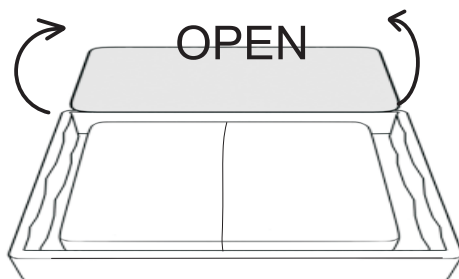

2-SEAT ASSEMBLY INSTRUCTION

Step1

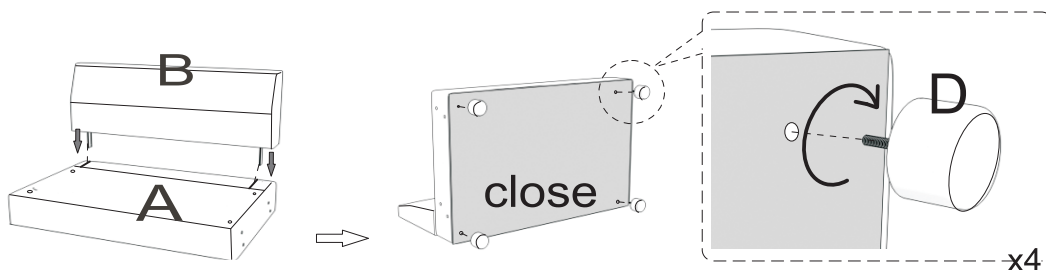

81803-LS

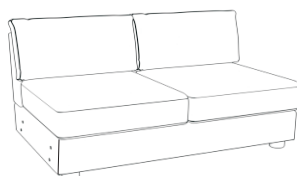

ASSEMBLY INSTRUCTIONS

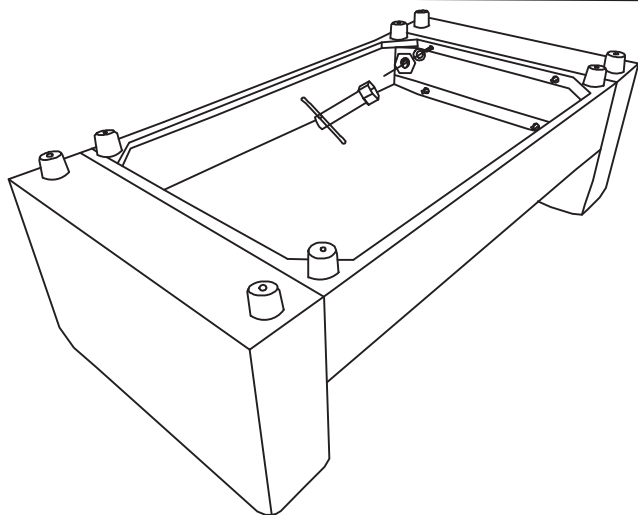
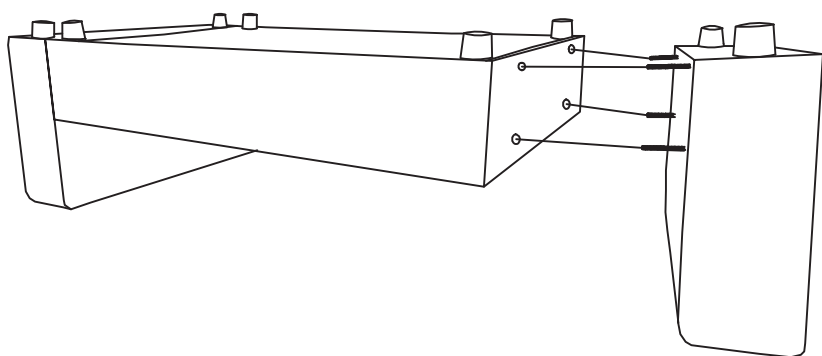
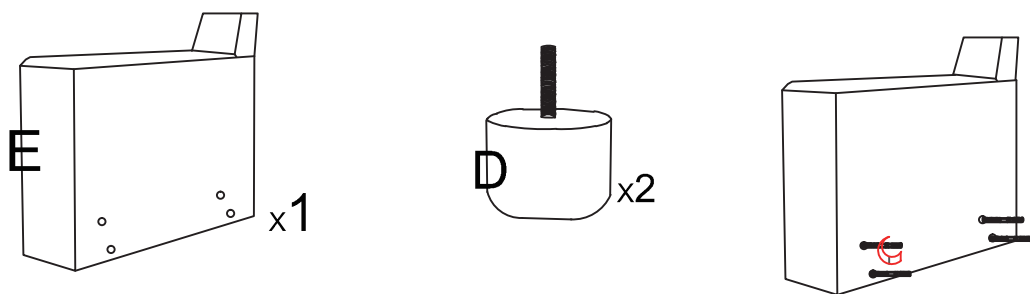

1

x4



2

x4



3

x4

4

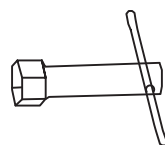

x1