

ITEM NO.:21303BK

FIXTURE ASSEMBLY STEPS:

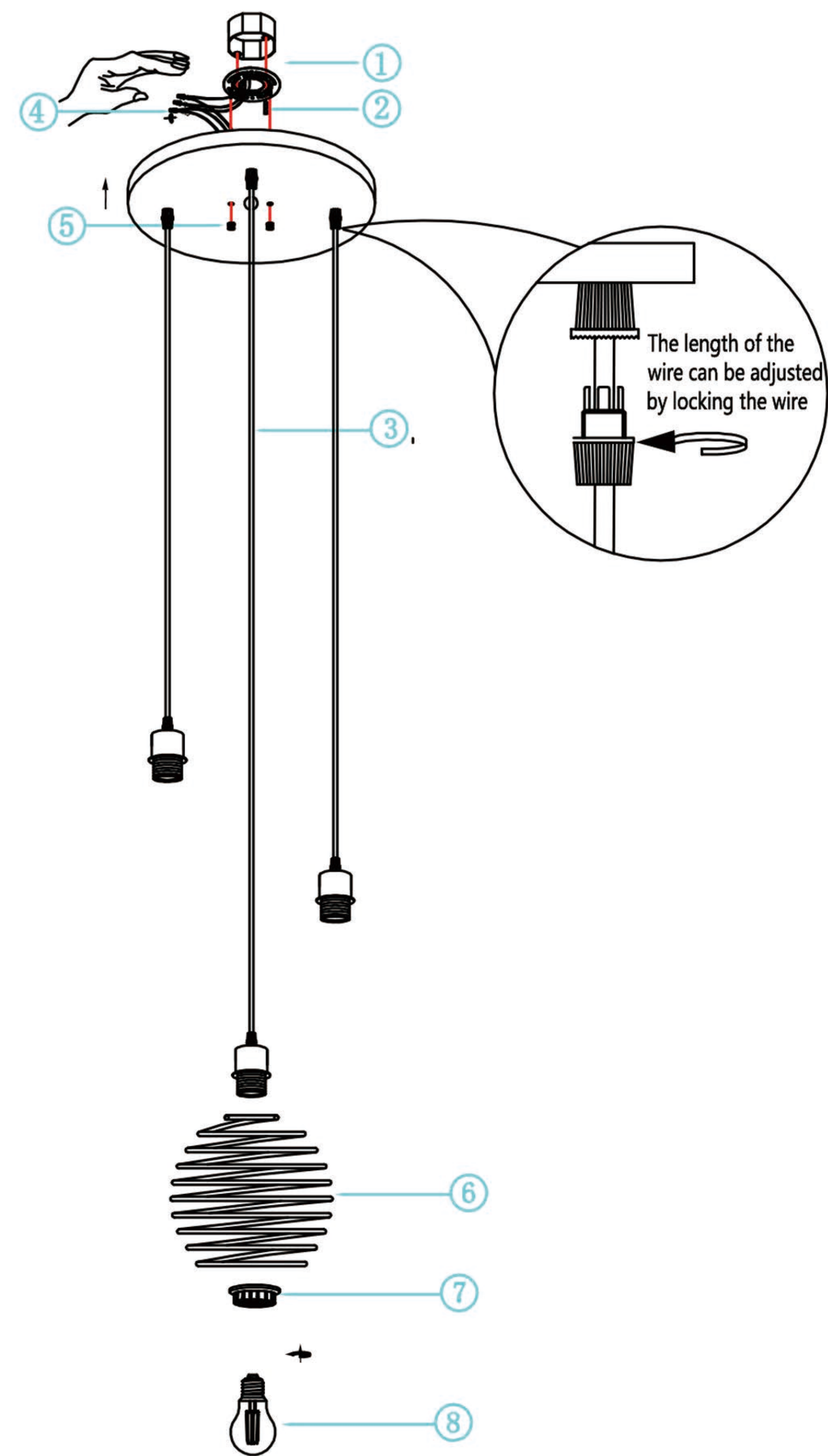

DESCRIPTION	PICTURE	CODE	QTY
Mounting Bar + Screw + Canopy Cap		1 / 5	1 SET
Mounting Box Screw		2	2 PCS
P3 Wiring Cap		4	3 PCS
Lamp body part		3	1 SET
Lron wire hood		6	3 PCS

WARNING - if any Special Control Devlces are used with this Fixture,Follow the instructions Carefully to assure fun compliance With N.E.C. requirements. if there are any questions, contact a Qualified Electrical Contractor.

CAUTION - All glass is fragile,use care when handling Glass component(s) and or Lamp(s).

WARNING - This product contains chemicals known to the State of Califomia to cause cancer, birth defects and /or other reproductive harm. Thoroughly wash hands after installing. handling. cleaning,or otherwise touching this product

CANOPY MOUNTING & WIRE CONNECTION ASSEMBLY STEPS:

Attach(N),(P) to achieve overall desired length.  
 Una (N),(P)para lograr la longitud deseada.  
 Joignez(N),(P)pour obtenir la Longueur voulue.

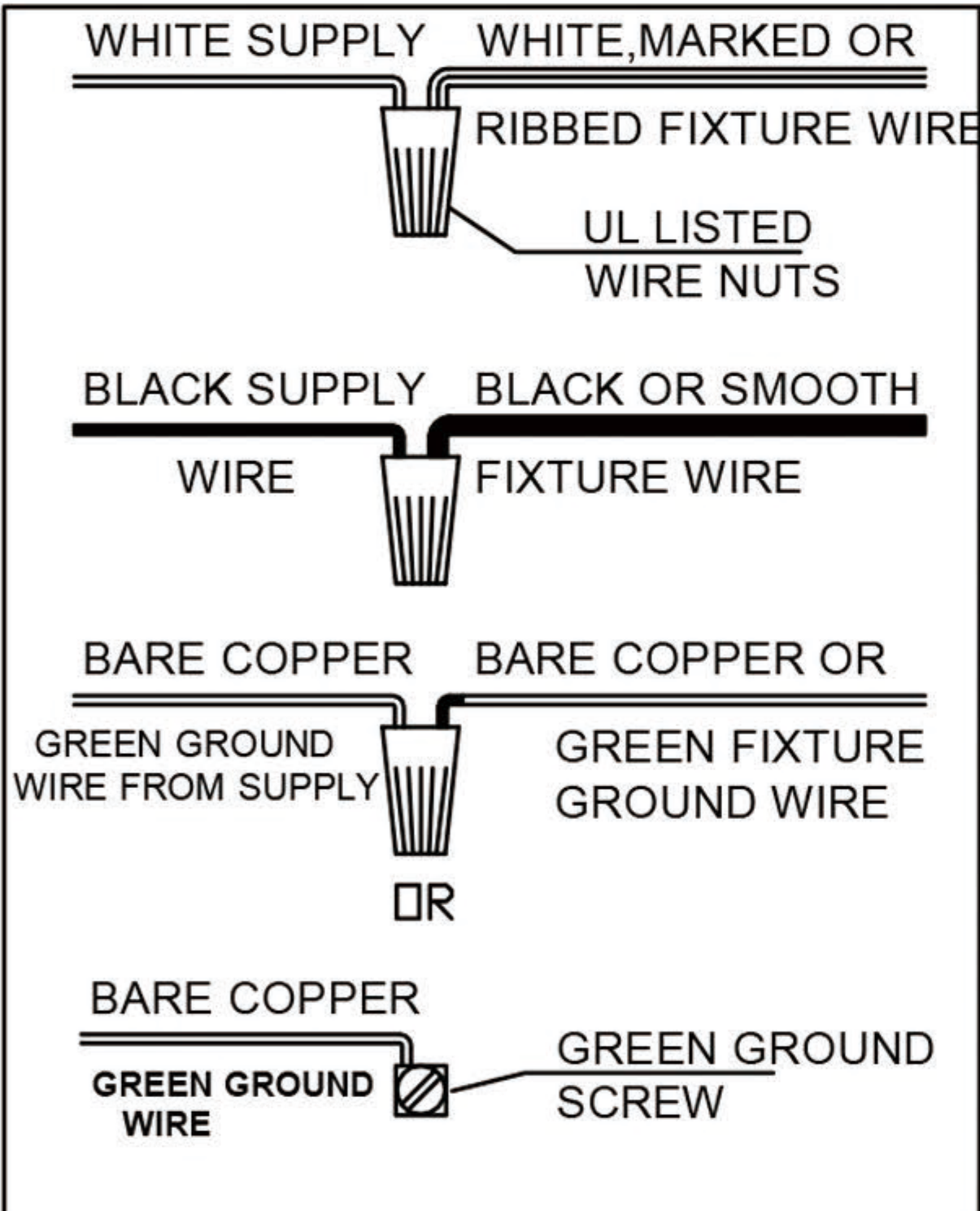

FIXTURE ASSEMBLY STEPS:



ITEM NO.:21303BK

110-120V / 60Hz  
 E26 3\*MAX 60W TYPE A  
 (Do not contain light bulb)

1. AC110~120V,50~60Hz.The Max lamps power is 60W TYPE A Bulb.
2. Avoid to scratch the surface of lighting and the wires when install it.
3. Printed on the wire : SPT-1/20288 or SPT-2 and other parameters of the line for the positive pole (Connect "L"), The wire without mark is the negative pole (Connect "N"), Ground cables are connected to ground cables (Connect "⊕"), (L- L,N-N,⊕- ⊕).
4. Don't install it to the ceiling before it's completely dry, thesurrounding around must be ventilated and dry.
5. Keep away from the acid, basicity objects and gases, clean withsoft cloth, water washing is not allowed.
6. Be careful when you install glass lamp shade.
7. The lighting must be installed by professional electrician and used indoor only.
8. Please keep attention to cut off the power supply when installing, cleaning, and replacing bulb.