

Thank you for your purchase!

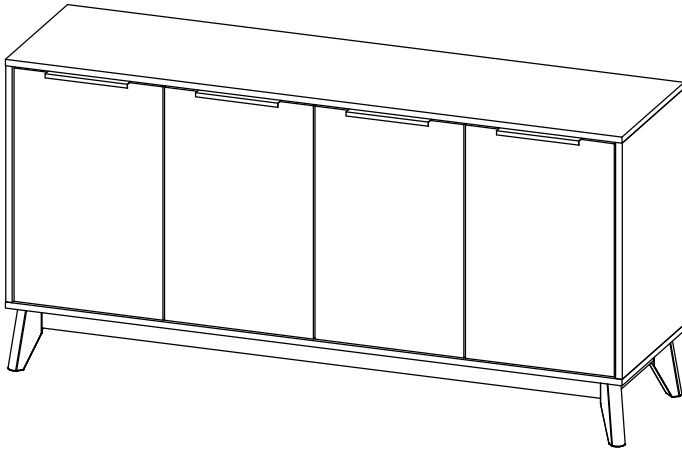

4 Door Buffet

ASSEMBLY INSTRUCTIONS

Before You Begin:

Please identify all component parts and hardware pieces required before you begin. Carefully remove all of the components from the packaging and set aside for assembly. Assemble on a soft surface to prevent scratching during assembly.

Caution:

Tighten all components securely before use. Failure to do so may result in personal injury.

DO NOT use any sharp objects to open plastic wrapped components as damage to product or components may result.

Warning:

CHOKING HAZARD - Small Parts. Adult Assembly Required.

DO NOT ALLOW CHILDREN TO CLIMB ON FURNITURE

Serious or fatal injuries can occur from furniture tipping over. You must install Tipping Restraint Hardware (where included) to help prevent the unit from tipping and causing accidental injury, instability, death or damage. The tipping restraint is intended only as a safety measure, it is not a substitute for proper adult supervision.

To help prevent furniture from tipping over it must be permanently attached to the wall. Anti-Tip Safety Wall Straps suitable for the unit weight and wall materials (if not included) should be purchased and installed.

Customer Service Email: CustomerExperience@belnick.com | Phone: 866-552-2810
EM-0372-WAL-GG

Have a Question/Concern?

Quality products and first-class customer service are the cornerstone of long-lasting consumer relationships. We strive toward excellence in all we do and want you to be completely satisfied with your purchase.

Please contact our exceptional Customer Experience Agents at the email address or phone number shown below to assist you with any product questions or issues before requesting a return.

We look forward to serving you in a friendly, efficient manner to resolve any issues you may have.

Customer Service Email: CustomerExperience@belnick.com

Customer Service Phone: 866-552-2810

For warranty information, please visit www.belnick.com

PART AND HARDWARE

PART LIST		QTY
1	TOP PANEL	1 PC
2	BOTTOM PANEL	1 PC
3	LEFT SIDE PANEL	1 PC
4	RIGHT SIDE PANEL	1 PC
5	CENTER PANEL	1 PC
6	BACK BRACE	1 PC
7	BACK PANEL	1 PC
8	LEFT SHELF PANEL	1 PC
9	RIGHT SHELF PANEL	1 PC
10	LEFT DOOR PANEL	1 PC
11	RIGHT DOOR PANEL	1 PC
12	LEFT CENTER DOOR PANEL	1 PC
13	RIGHT CENTER DOOR PANEL	1 PC
14	CABINET LEG	4 PCS

SELF-PREPARED TOOLS: Tools below are NOT included in package.



SCREWDRIVER



HAMMER



POWER DRILL

HARDWARE			
A	CAM LOCK	A1 A2 A3	8 SETS
B	M8 X 30MM WOOD DOWEL		12 PCS
C	M6 X 50MM HEX WOOD SCREW		8 PCS
D	ALLEN WRENCH M4		1 PC
E	M3.5 X 16MM SCREW		48 PCS
F	M3 X 12MM SCREW		8 PCS
G	HEX SCREW M6 x 70		8 PCS
H	LOCK WASHER M6		8 PCS
I	FLAT WASHER M6		8 PCS
J	METAL SHELF SUPPORT		8 PCS
K	EM 0071 DOOR HANDLE		4 PCS
L	BRACKET WITH SCREW	L1 L2	8 SETS
M	SOFT CLOSE 5/8 HINGES		4 PCS
N	SOFT CLOSE 7/8 HINGES		4 PCS
O	ANTI-TIP HARDWARE	O1 O2 O3 O4 O5	2 SETS
P	5/8 PVC NAIL-IN FLOOR GLIDE		4 PCS

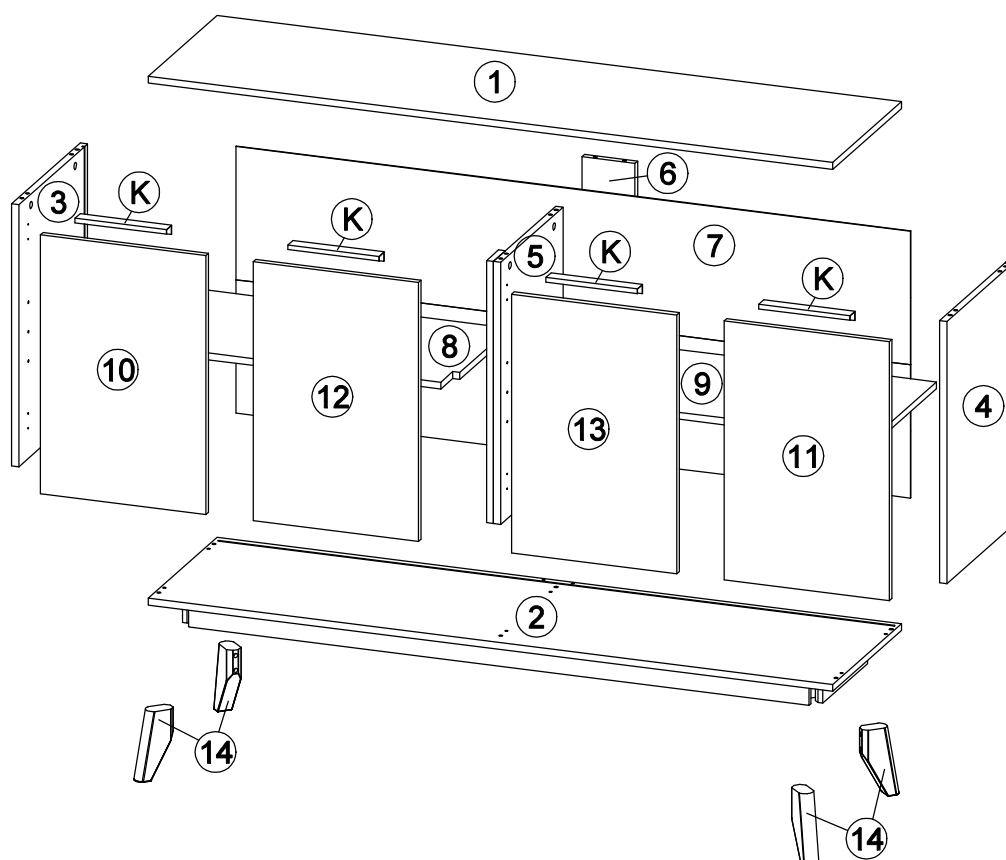

STEP 1

- Insert (8) Male Camlocks (Part **A2**) into the underside of Top Panel (Part 1).
- Tighten using a Phillips Screwdriver.

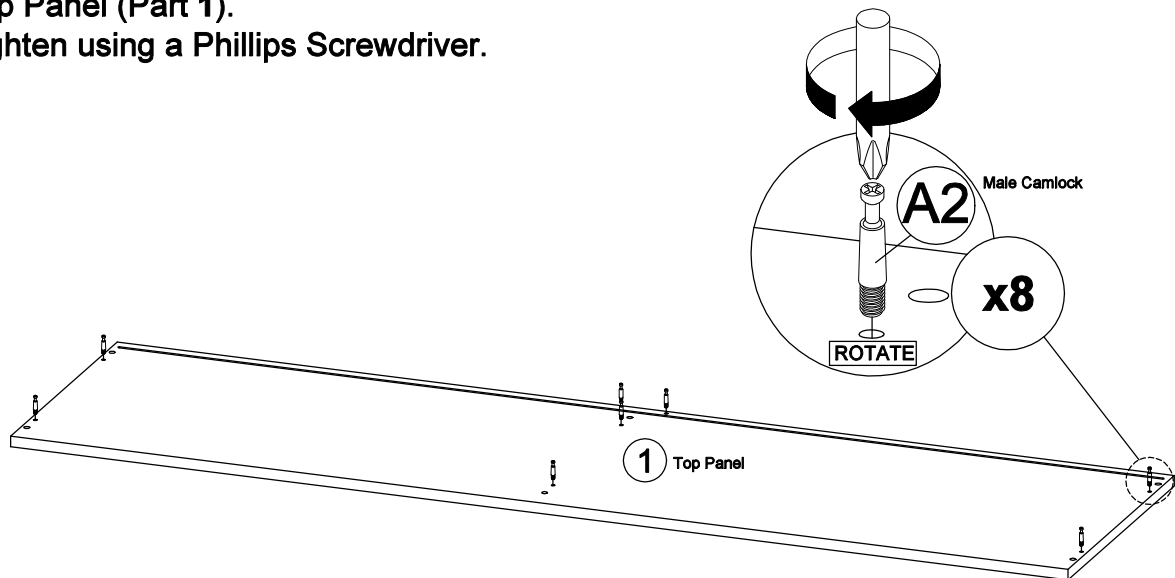

STEP 2

- Insert (2) Female Camlocks (Part **A1**) into the Back Brace (Part 6).

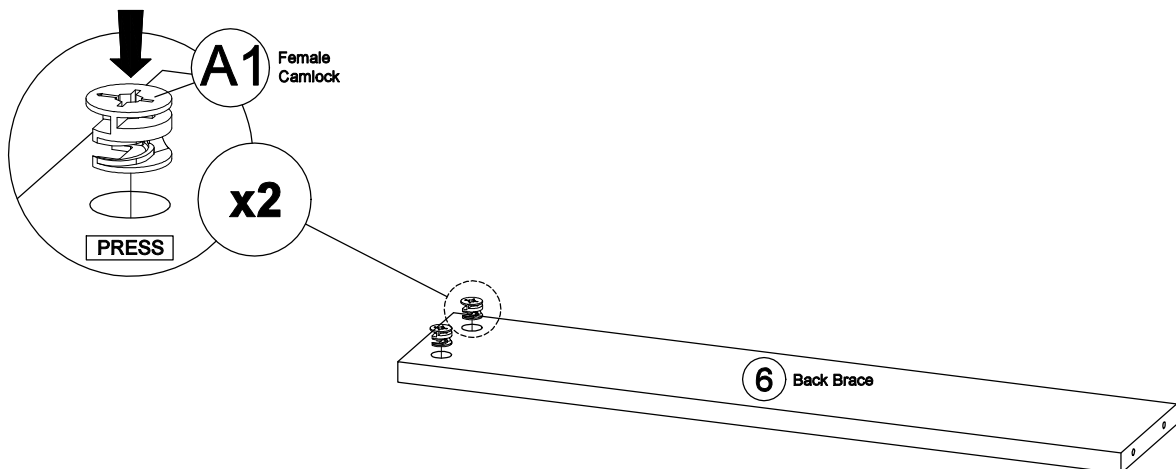

* Ensure the arrows on Female Camlocks **A1** point towards outer receiver holes.

STEP 3

- Insert (2) Female Camlocks (Part **A1**) into the Left Side Panel (Part **3**).
- Insert (4) Wood Dowels (Part **B**) into outer holes of Left Side Panel (Part **3**).

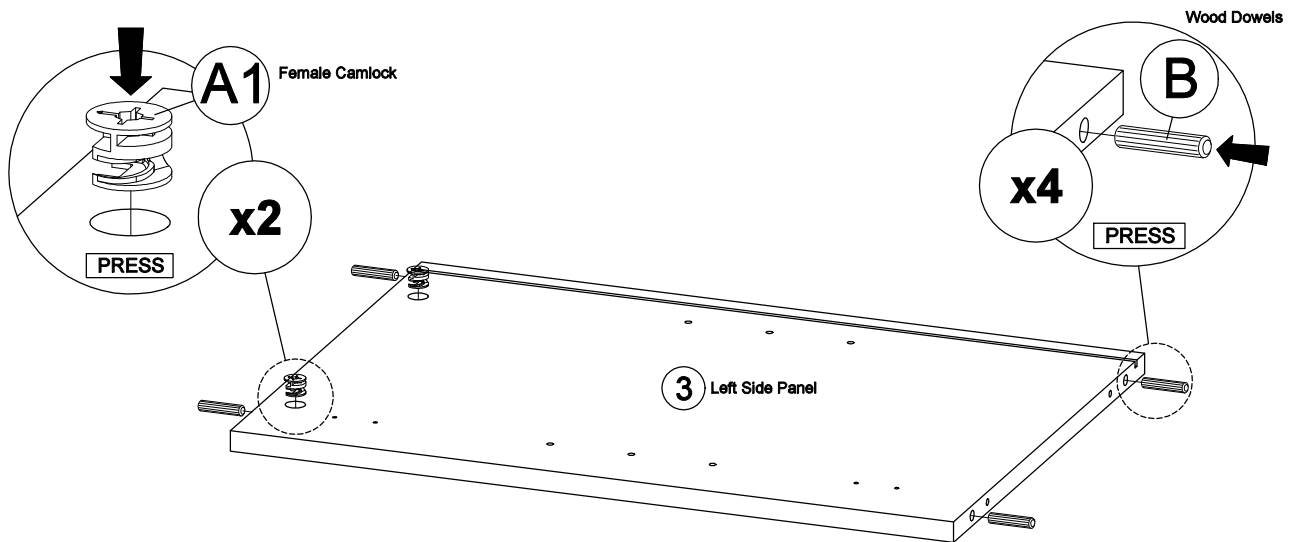

* Ensure the arrows on Female Camlocks **A1** point towards outer receiver holes.

STEP 4

- Insert (2) Female Camlocks (Part **A1**) into Right Side Panel (Part **4**).
- Insert (4) Wood Dowels (Part **B**) into outer holes of Right Side Panel (Part **4**).

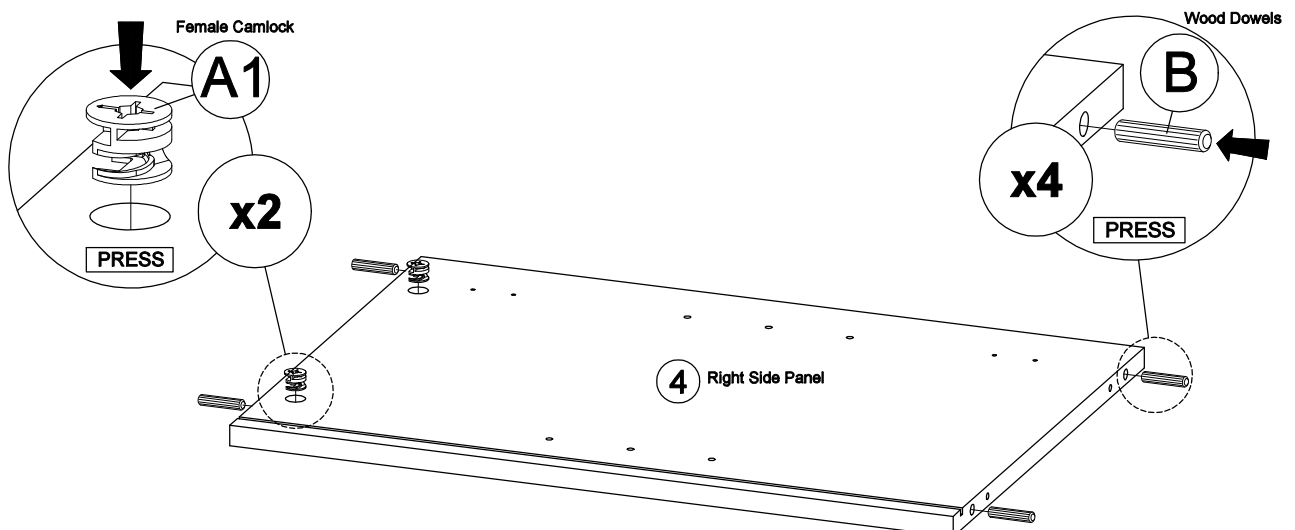

* Ensure the arrows on Female Camlocks **A1** point towards outer receiver holes.

STEP 5

- Insert (2) Female Camlocks (Part **A1**) into Center Panel (Part 5).
- Insert (4) Wood Dowels (Part **B**) into outer holes of Center Panel (Part 5).

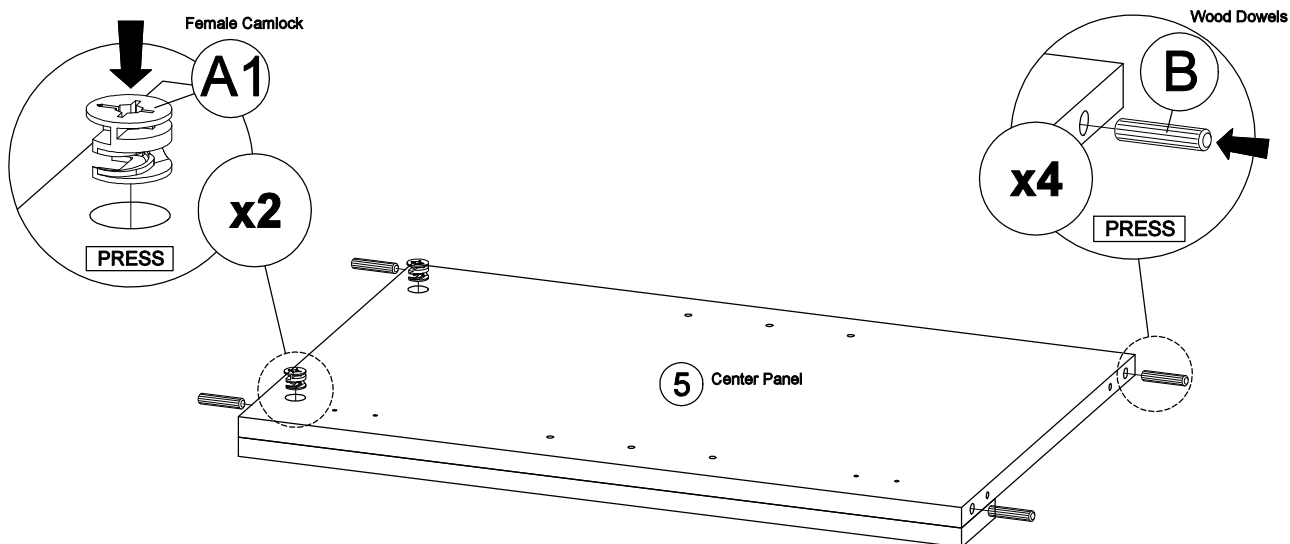

* Ensure the arrows on Female Camlocks **A1** point towards outer receiver holes.

STEP 6

- Attach panels (3), (4), (5) and (6) to underside of Top Panel (Part 1).
- Tighten Female Camlocks (Part **A2**) using a Phillips Screwdriver.
- Attach (8) Cap Covers (Part **A3**).

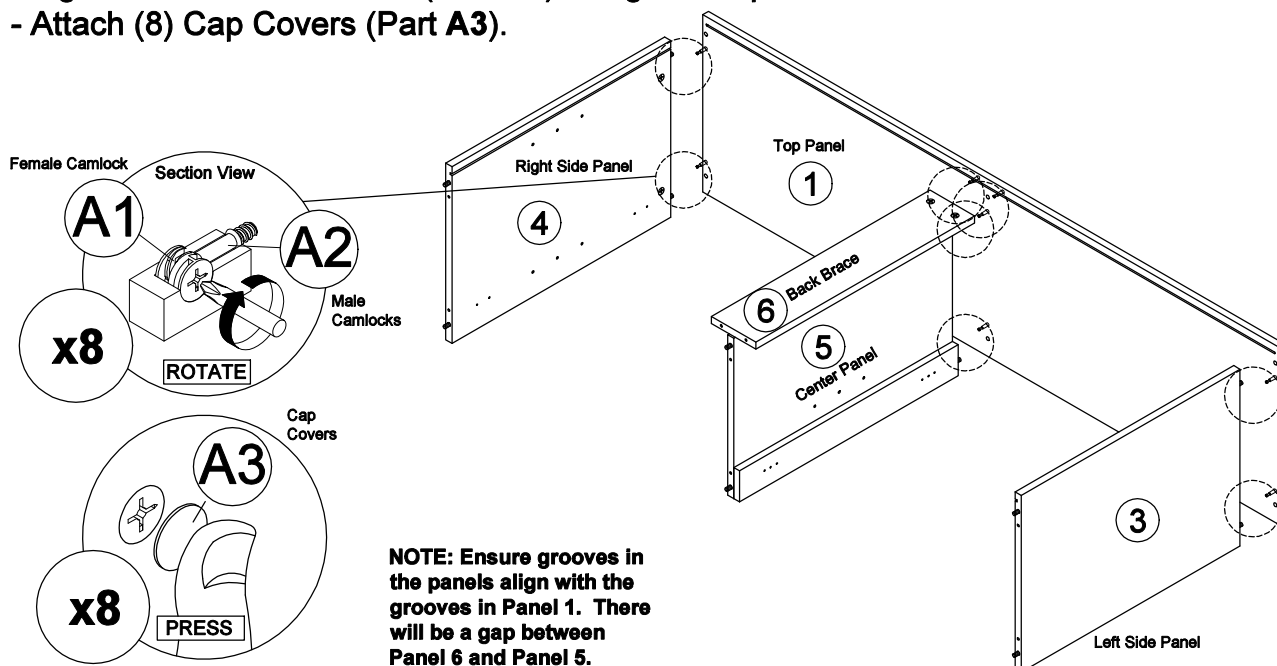

* In this step Female Camlock **A1**, Male Camlock **A2** and Wood Dowels **B** are pre-inserted.

STEP 7

- Insert Back Panel (Part 7) into the grooves in Left Side Panel (Part 3), Right Side Panel (Part 4), and the Top Panel (Part 1).

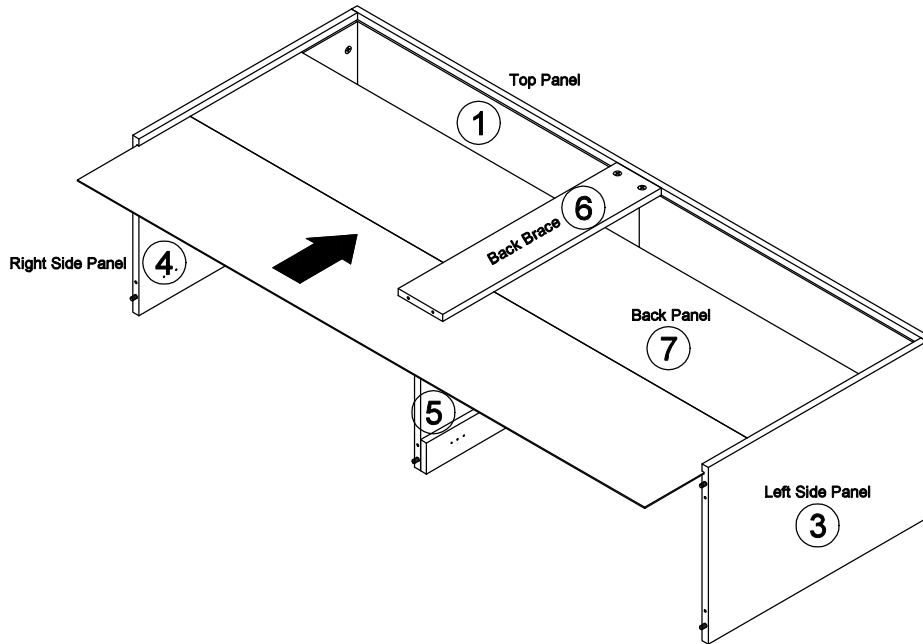

STEP 8

- Attach Bottom Panel (Part 2) to assembled frame using (8) M6 x 50mm Hex Wood Screws (Part C).
- Tighten using Allen Wrench M4 (Part D)

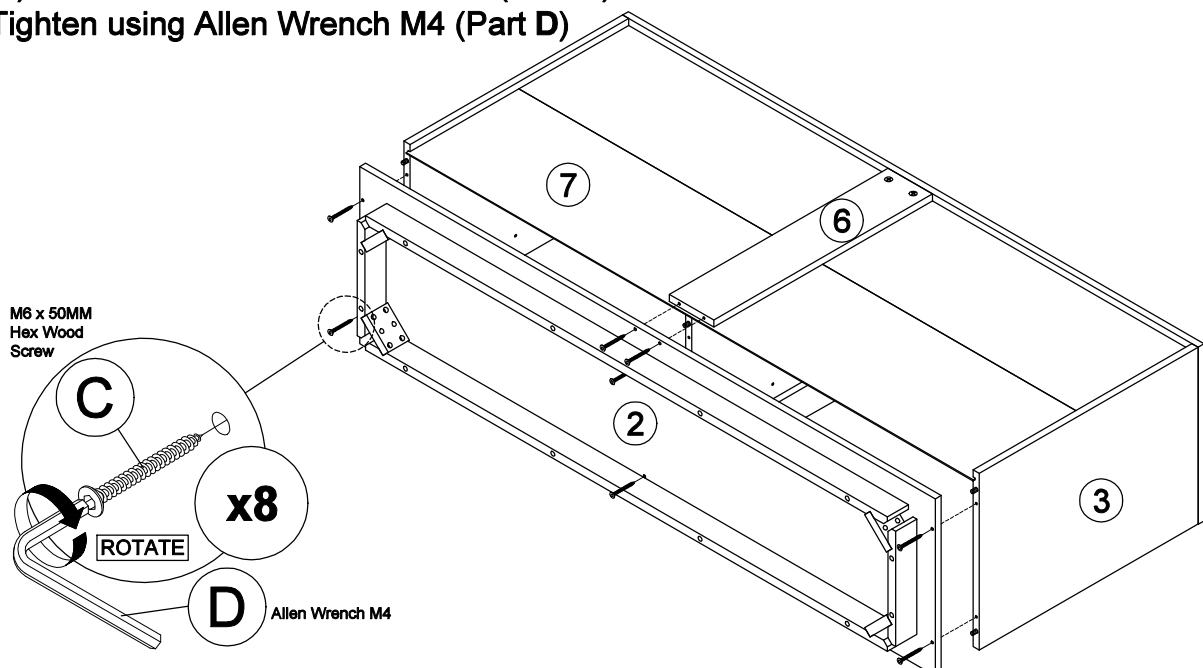
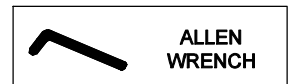

* In this step Wood Dowels B are pre-inserted.

STEP 9

- Attach (4) Cabinet Legs (Part 14) using (8) Hex Screws M6 x 70 (Part G), (8) Lock Washers M6 (Part H) and (8) Flat Washers M6 (Part I).
- Tighten using Allen Wrench M4 (Part D).

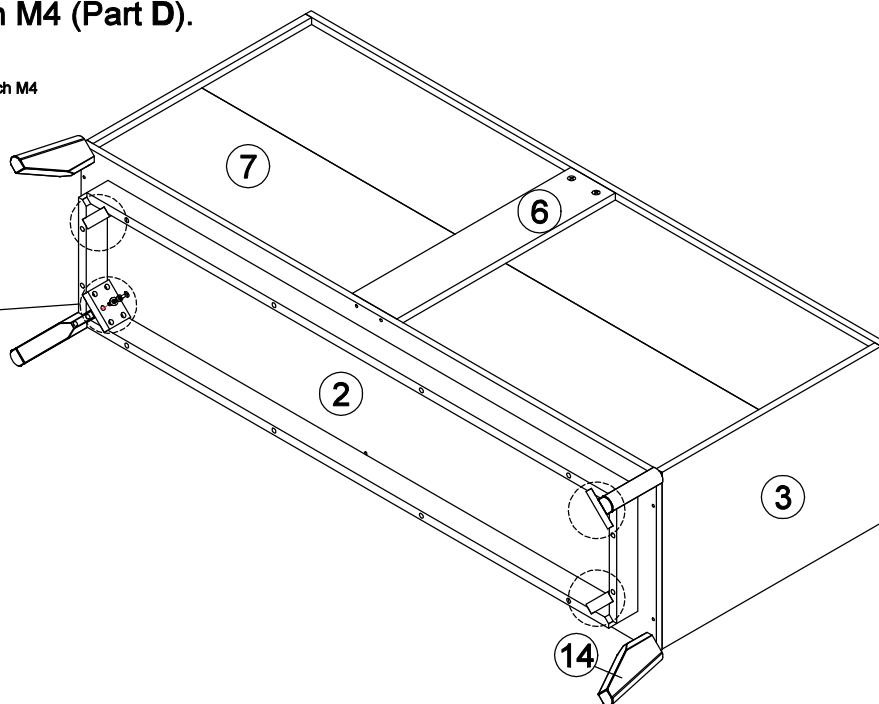
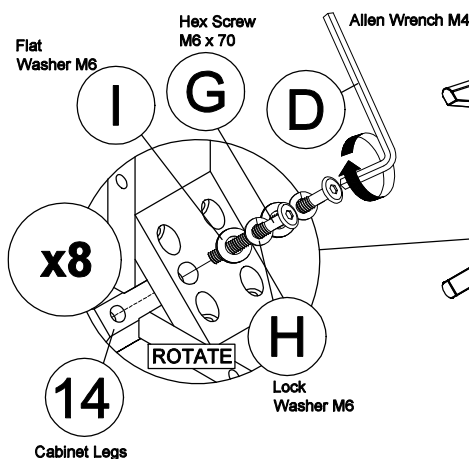
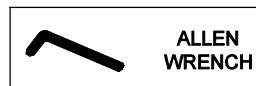

STEP 10

- Attach (8) Brackets (Part L1) to the Back Panel (Part 7) as shown using included Screws (Part L2).
- Using a Hammer, gently tap 5/8 PVC Nail-In Floor Glides (Part P) into the bottom of the Cabinet Legs (Part 14).

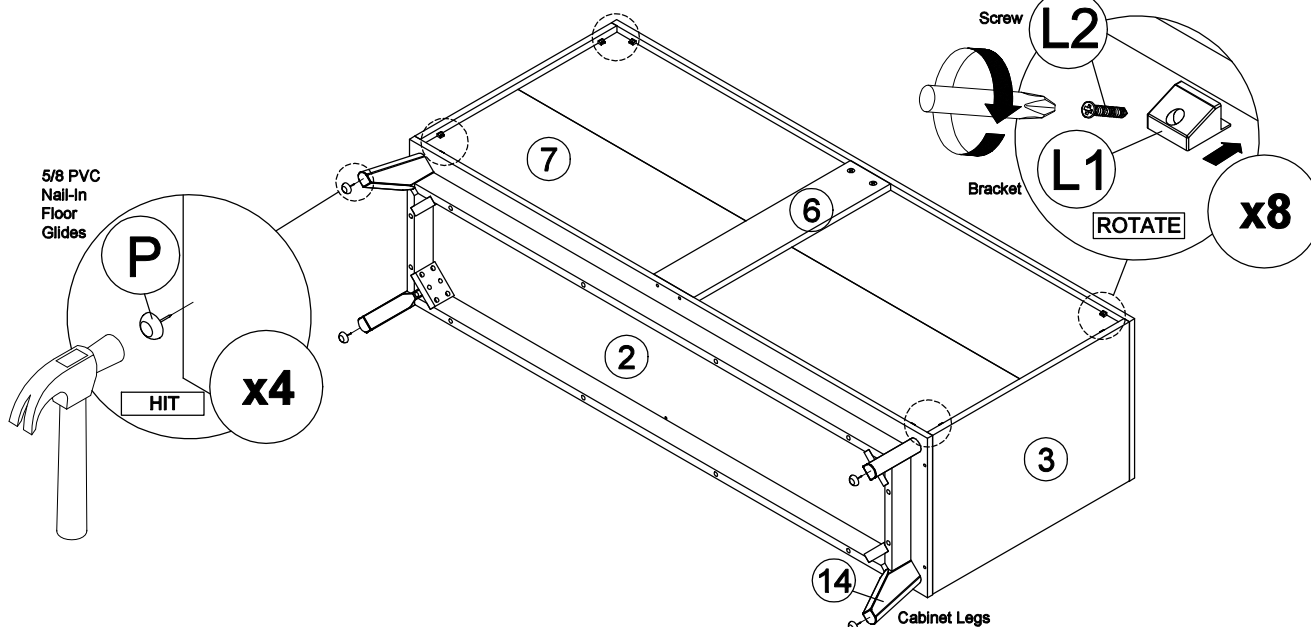

STEP 11

- Insert (8) Metal Shelf Supports (Part J) into the holes in Left Side Panel (Part 3), Right Side Panel (Part 4), and Center Panel (Part 5).

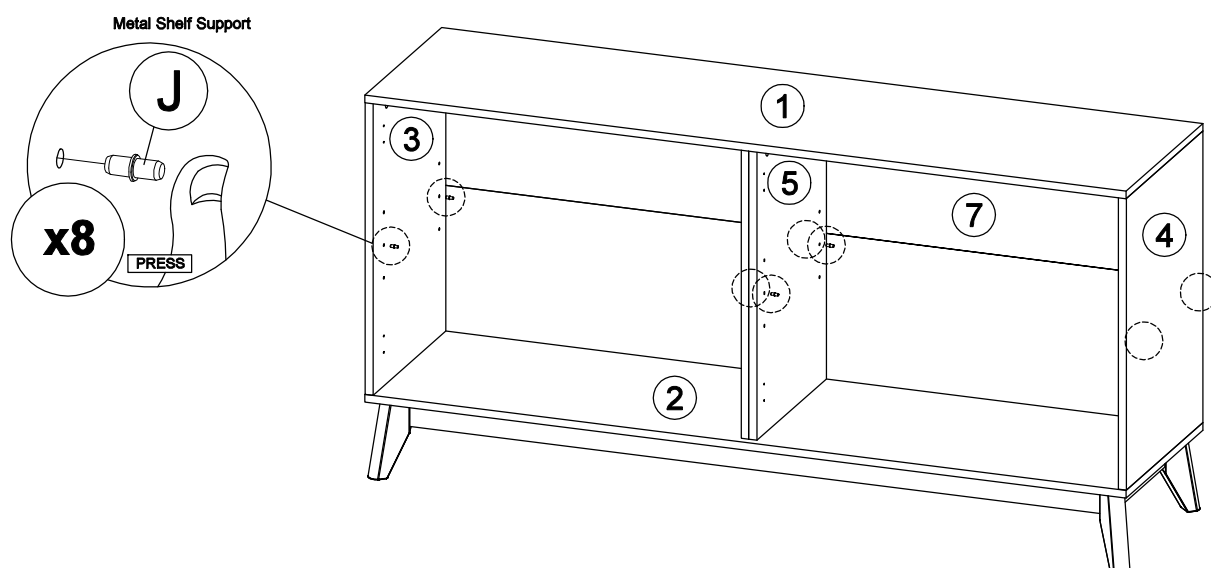

STEP 12

- Insert Left Shelf Panel (Part 8) and Right Shelf Panel (Part 9) into the assembled cabinet to rest on the Metal Shelf Supports.

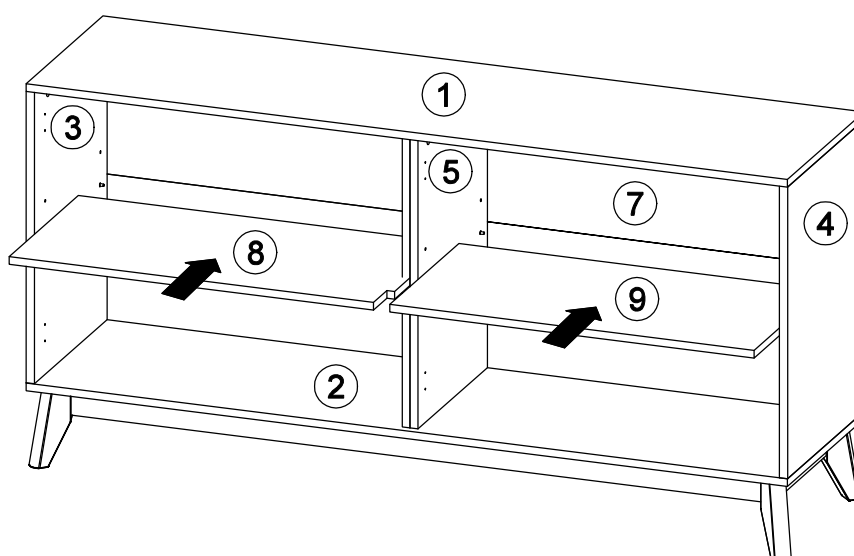

STEP 13

- Attach (4) Soft Close 5/8 Hinges (Part **M**) to Left Center Door Panel (Part 12) and Right Center Door Panel (Part 13) using (8) M3.5 x 16 MM Screws (Part **E**).
- Attach (2) EM 0071 Door Handles (Part **K**) to Door Panels using (4) M3 x 12MM Screws (Part **F**).

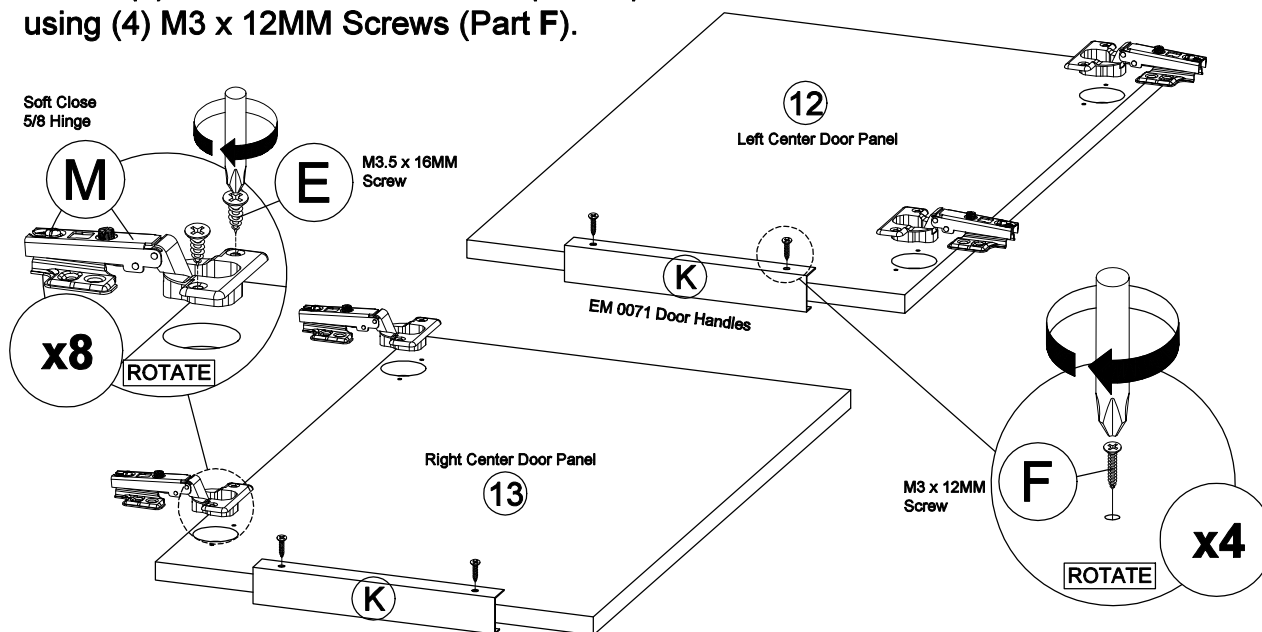

STEP 14

- Attach the other side of the Soft Close 5/8 Hinges (Part **M**) on the Center Doors to inside of Center Panel (Part 5) using (16) M3.5 x 16MM Screws (Part **E**).
- Tighten or loosen screws to adjust the door position for a proper fit.

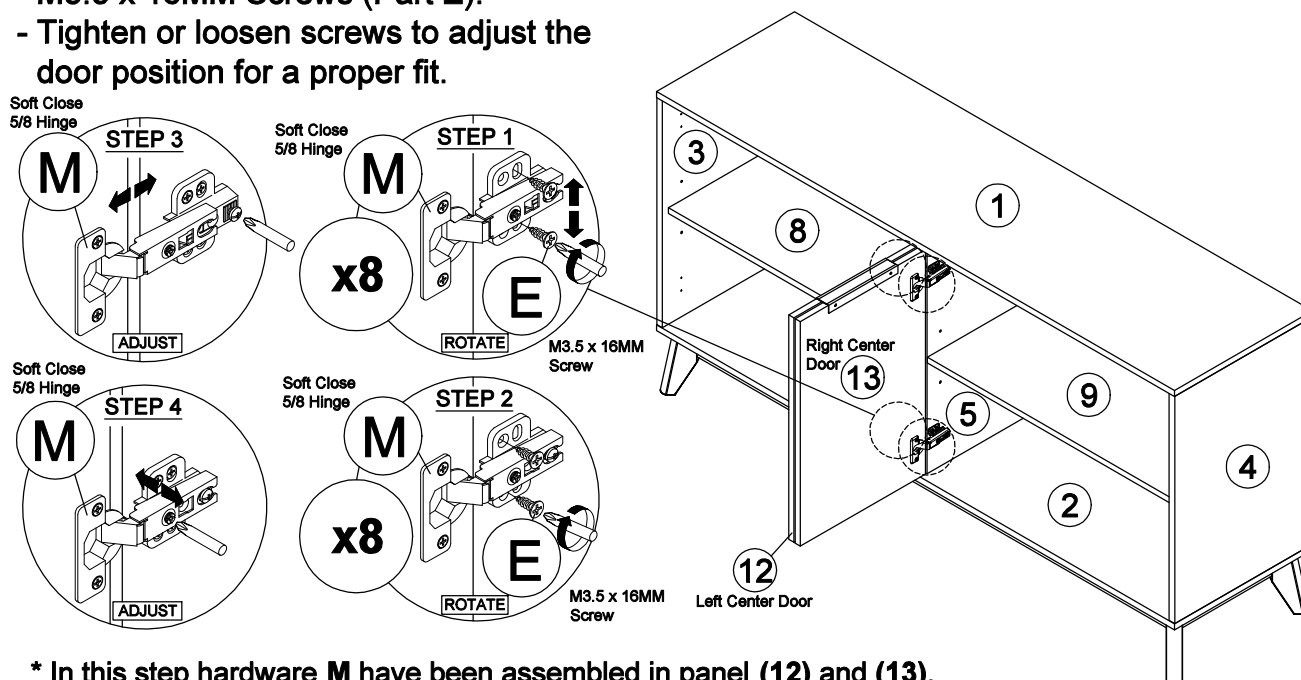

* In this step hardware **M** have been assembled in panel (12) and (13).

STEP 15

- Attach (4) Soft Close 7/8 Hinges (Part N) to Left Door Panel (Part 10) and Right Door Panel (Part 11) using (8) M3.5 x 16 MM Screws (Part E).
- Attach (2) EM 0071 Door Handles (Part K) to Door Panels using (4) M3 x 12MM Screws (Part F).

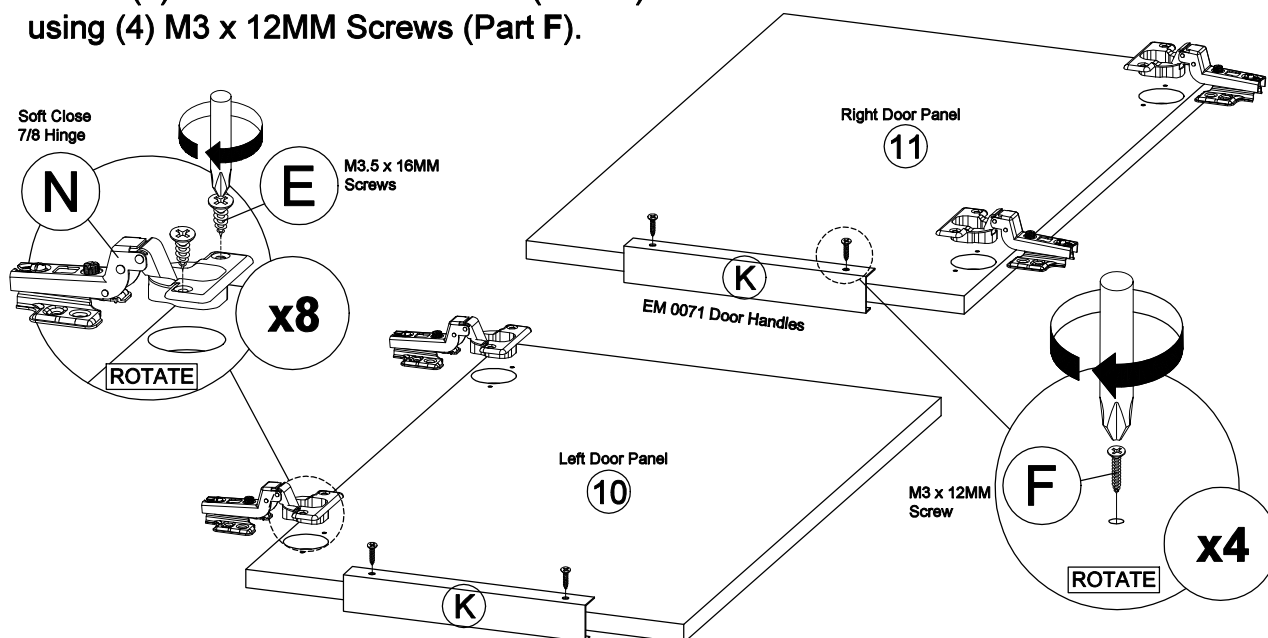

STEP 16

- Attach the other side of the Soft Close 7/8 Hinges (Part N) on the Doors to inside of Left Side Panel (Part 3) and Right Side Panel (Part 4) using (16) M3.5 x 16MM Screws (Part E).
- Tighten or loosen screws to adjust the door position for a proper fit.

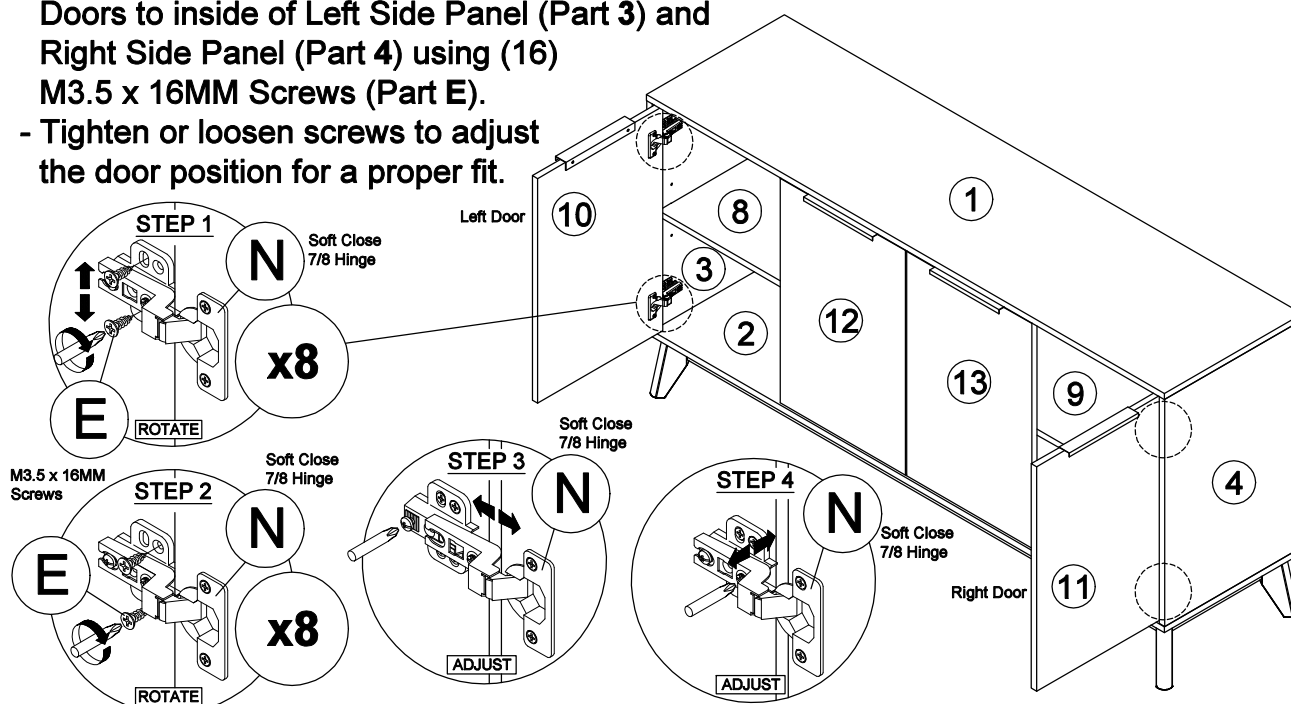

* In this step hardware N have been assembled in panel (10) and (11).

STEP 17

- Assemble (2) anti-tip hardware Wall Bracket (Part O1) into Top Panel (Part 1) by using anti-tip hardware Screw (Part O2).

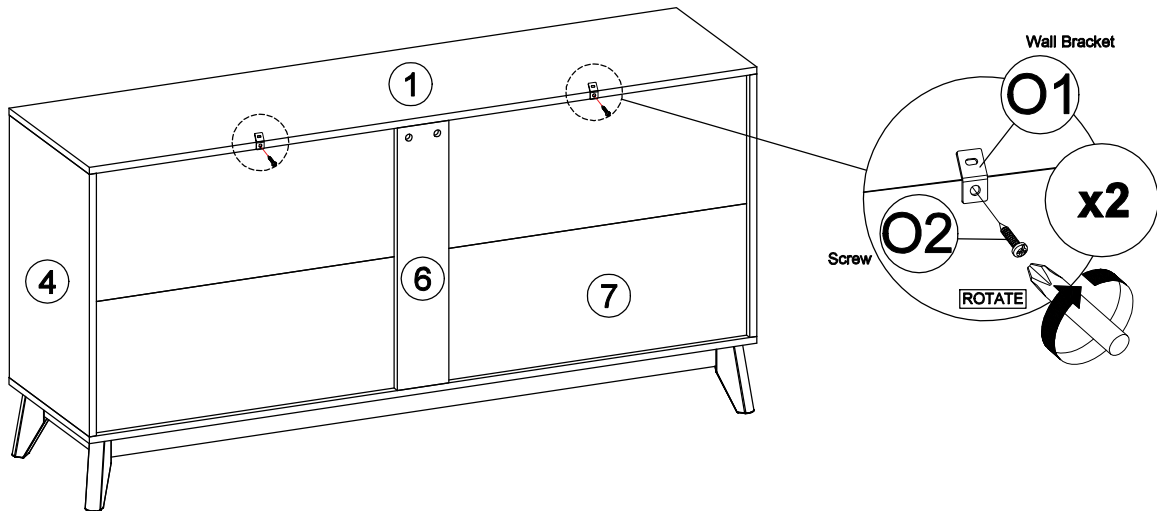

STEP 18

- Mark the wall and use a power drill (not included) to drill a hole in the wall.
- Gently tap (2) Wall Anchors (Part O3) into the holes.

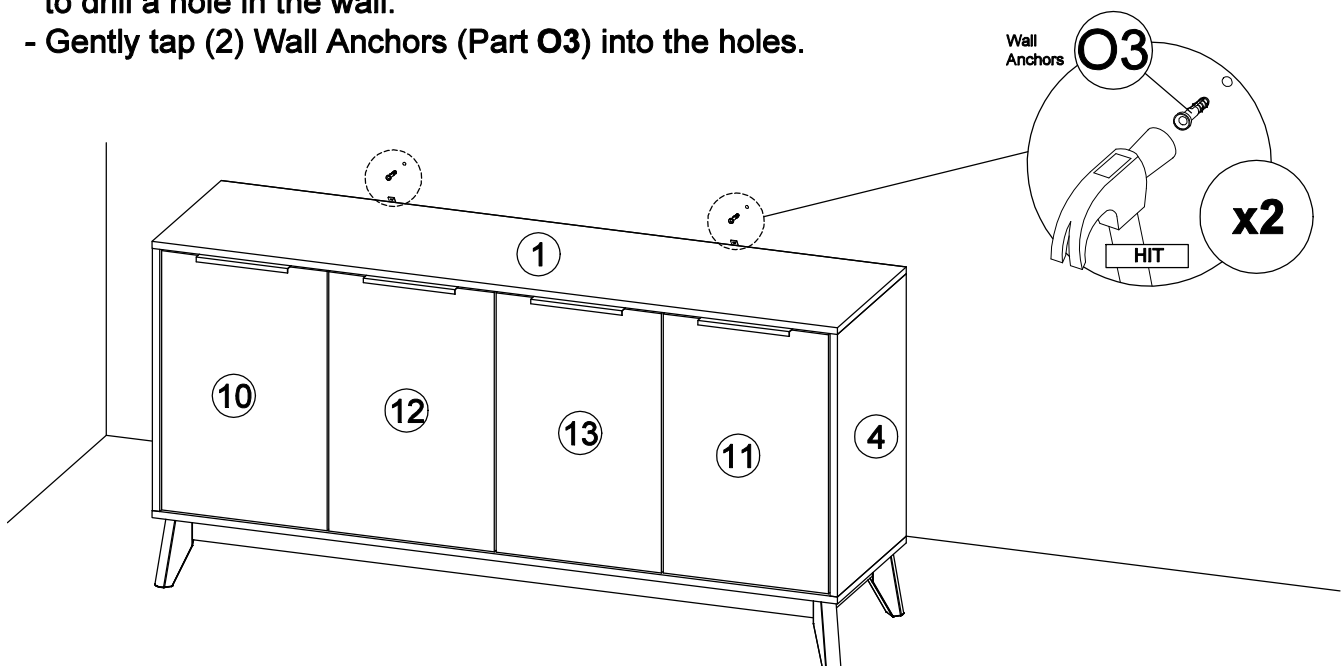

STEP 19

- Insert the included screws (Part **O4**) through the Wall Bracket (Part **O1**) into the Wall Anchor (Part **O3**).
- Tighten using a Phillips Screwdriver

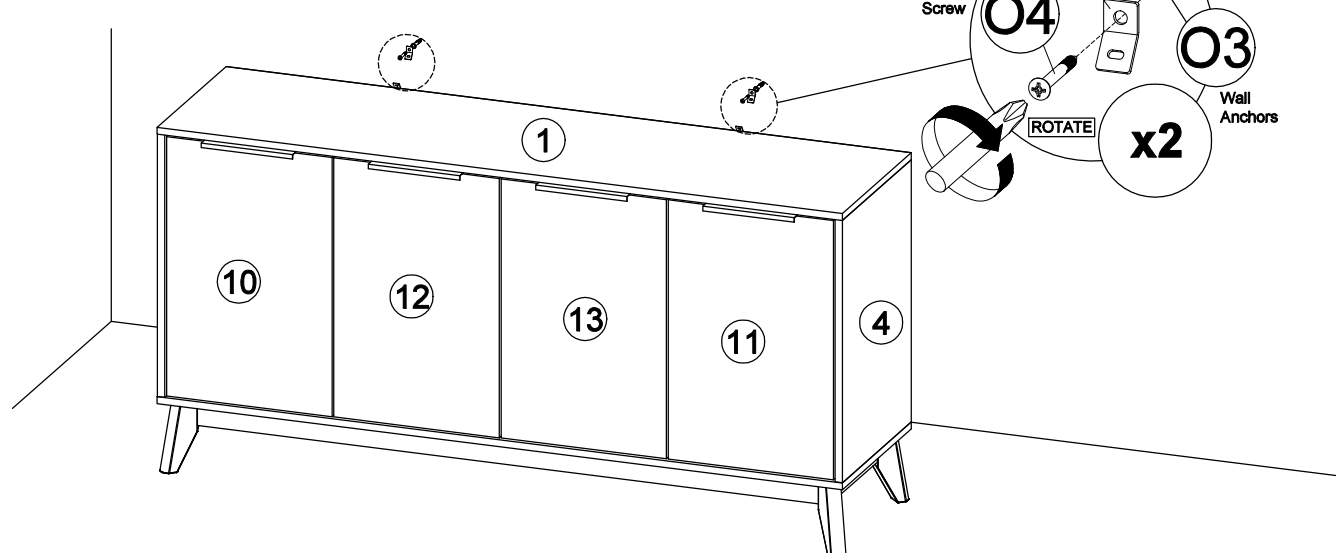

STEP 20

- Thread the included Zip Ties (Part **O5**) through the Wall Brackets (Part **O1**) on the back of the cabinet and in the wall.
- Pull until tight.

