

ASSEMBLY INSTRUCTIONS



CAUTION

◆ Inspect the wire insulation for any cuts, abrasions, or exposed copper that may have resulted during shipping. If there is a defect in the wire, do not attempt installation.

◆ Before starting installation of this fixture or removal of a previous fixture, disconnect the power by turning off the circuit breaker or by removing the fuse at the fuse box.

TOOLS REQUIRED



Ladder



Safety glasses



Electrical tape



Phillips screwdriver



Flat blade screwdriver



Pliers

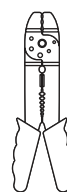

Wire strippers

HARDWARE INCLUDED

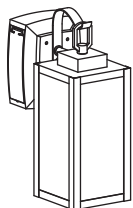

Fixture

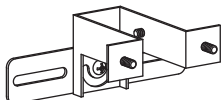

Mounting Unit



Ball Nuts



Rubber Rings



Mounting Screws



Wire Nuts

***PARTS SHOWN MAY DIFFER SLIGHTLY PER LIGHT FIXTURE**

EXPLODED PARTS

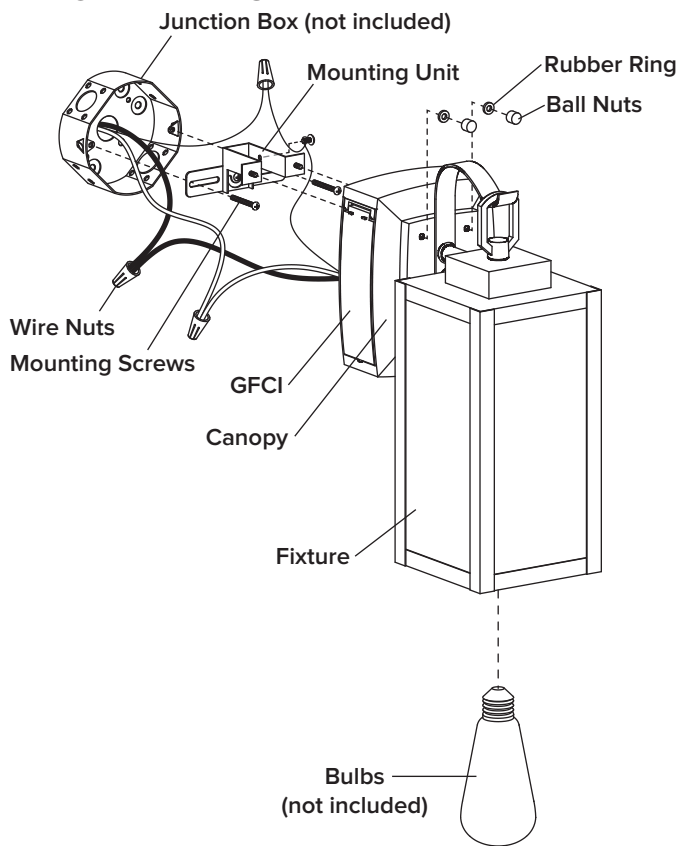

INSTALLATION

STEP 1

Unscrew the **ball nuts**, and remove the **rubber rings**. Detach the **mounting unit** from the back side of the **canopy**.

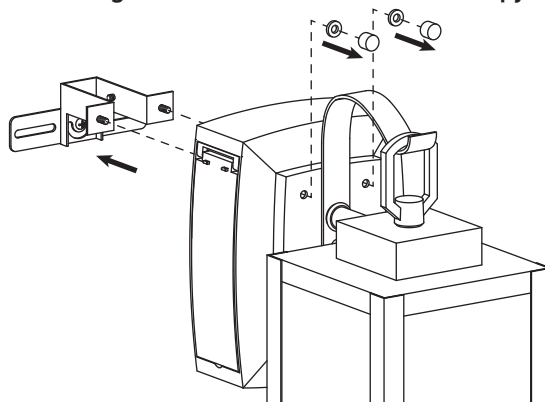

STEP 2

Attach the **mounting unit** to the junction box (not included) using **mounting screws**.

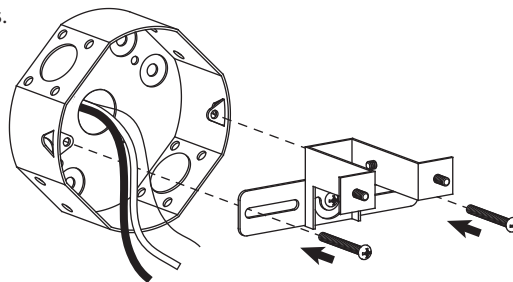

STEP 3

Make the electrical connection from the junction box (not included) to the **fixture**. Connect the ground wire to the **mounting unit** using the preinstalled green ground screw. Next, connect the positive, negative and ground wires with the supplied **wire nuts**. Secure with electrical tape.

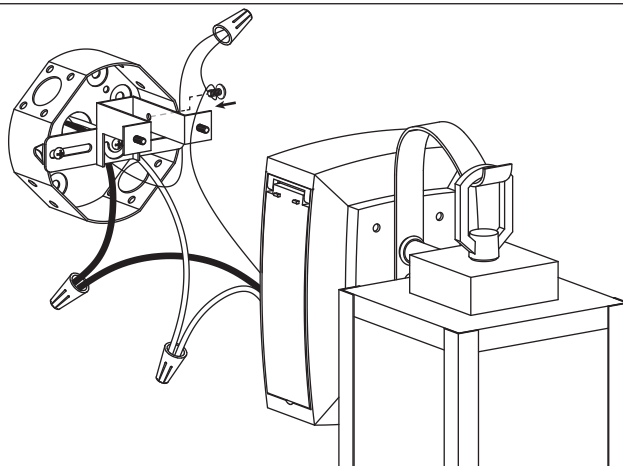
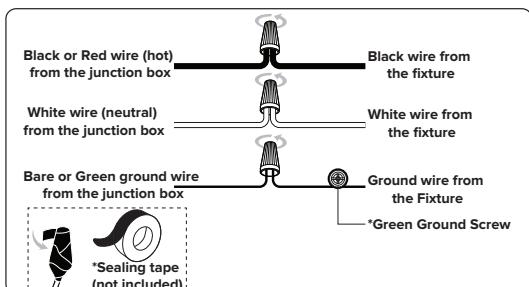

ASSEMBLY INSTRUCTIONS (INSTALLATION)

STEP 4

Attach the **fixture** to the **mounting unit** through screw holes as shown, and secure it with **rubber rings** and **ball nuts**.

NOTICE: After the installation, caulk upper and two sides of the mounting surface. Leave bottom uncaulked for drainage of any water that might have seeped into the canopy.

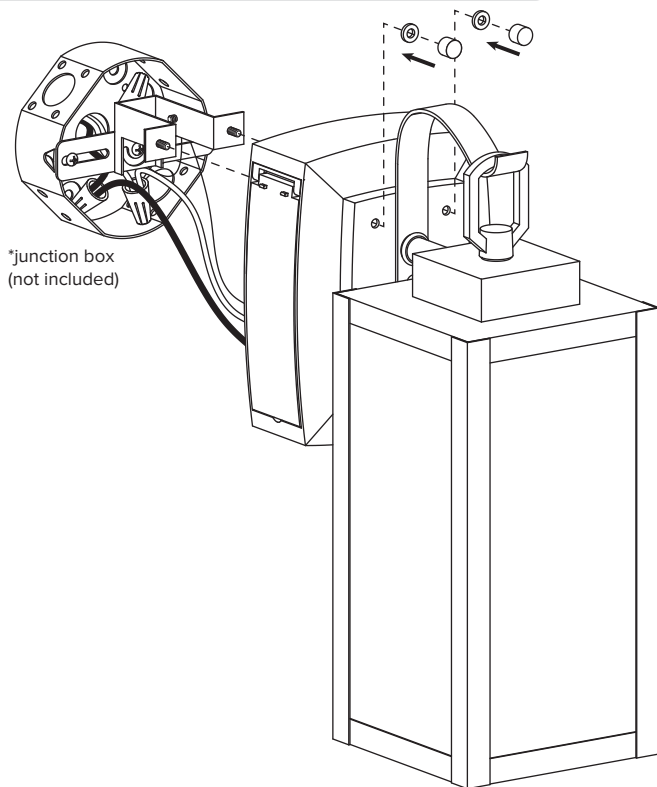

STEP 5

Install bulbs (not included).

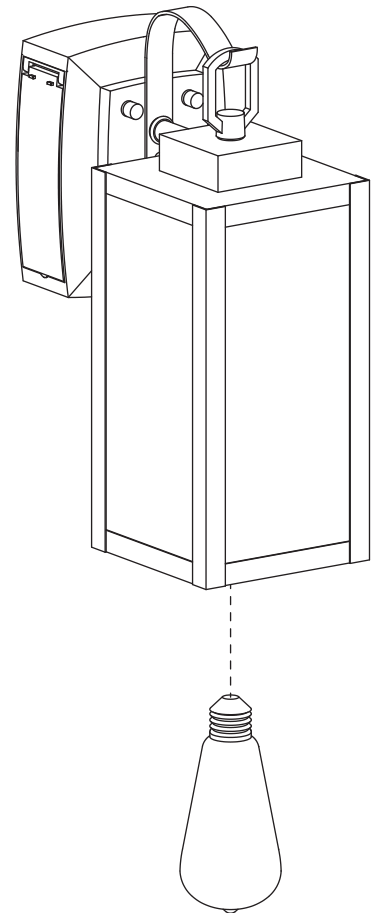

STEP 6

Turn on the power and check operation.



WARNING

In order to avoid water accumulation in GFCI box on rainy days, always keep the GFCI box closed.

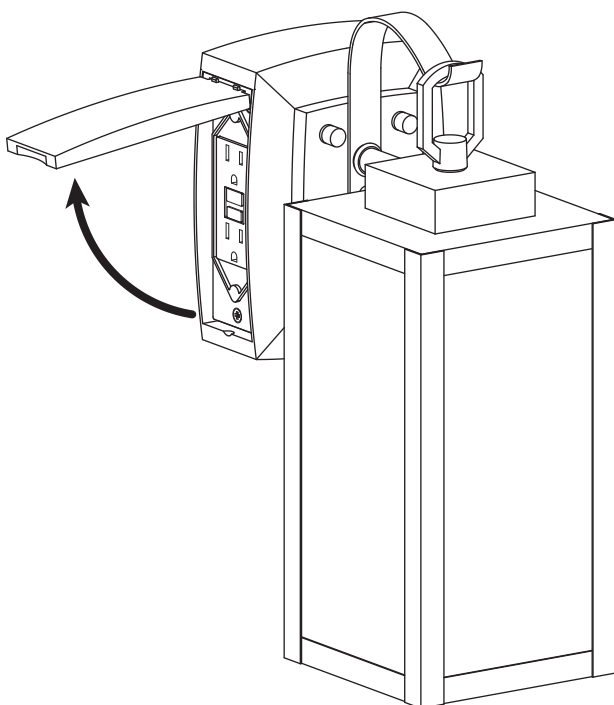

OPERATING INSTRUCTIONS

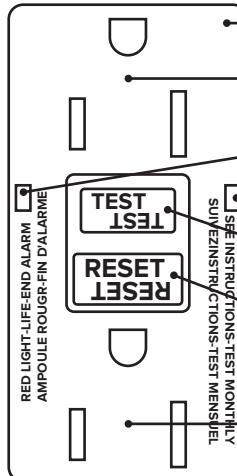

GFCI

OUTLET

RED LIGHT-LIFEEND ALARM (Red)

INDICATOR LIGHT (Green)

TEST BUTTON

RESET BUTTON

OUTLET

● TEST BUTTON

Press the TEST button to test the device, which will stop the flow of electricity, and the RESET button will pop out.

● RESET BUTTON

Press the RESET button fully to restore the power, the green indicator LED will be on.

● END-OF-LIFE MONITORING FUNCTION

The GFCI includes an end-of-life monitoring function. Once the GFCI been correctly wired and powered, the red Led will flash one time within 5 Secs, and the internal self-testing circuit will operate every 1~10 minutes. When the GFCI display an alarm during its operation, the Red light will turn on immediately, and it will no longer provide a ground fault circuit protection, reminding the user that the GFCI is end of life and must be replaced.

● ADDITIONAL NOTE

Press the TEST button (then RESET button) monthly to ensure a proper operation, if the Green LED goes off when tripped, it means that the GFCI can still offer a ground fault circuit protection.