

ASSEMBLY INSTRUCTIONS

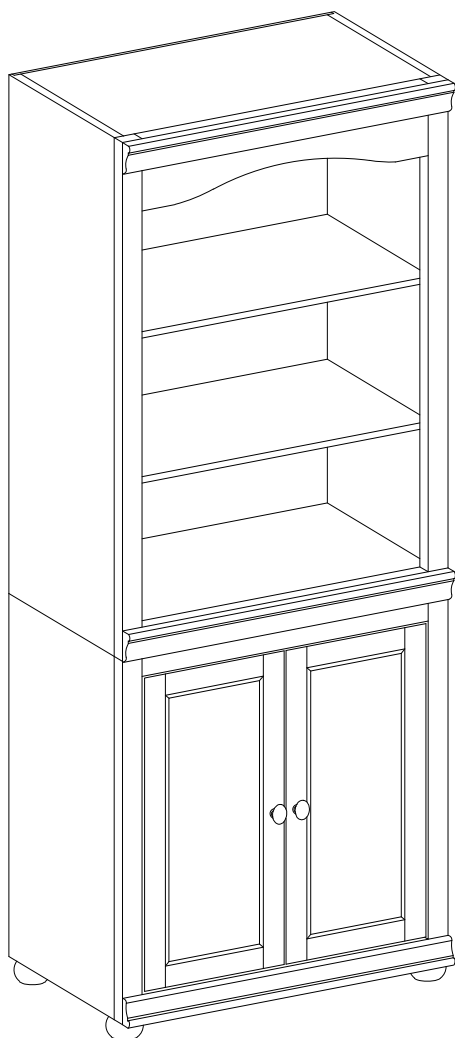

TOOLS REQUIRED



Allen Wrench

(Included)



Phillips
Screwdriver

(Not Included)



2 - People
Recommended

ASSEMBLY RATING



EASY —————> DIFFICULT

The Assembly Rating is a 5-point system showing the level of effort needed to assemble a specific product.



CHECK BEFORE STARTING

☐

Are you missing anything?

Double-check all parts, hardware and accessories listed are all accounted for.

☐

Check out our Quick Tips!

We recommend reviewing the pre-assembly handouts. Even experts need a refresher now and then!

☐

Should we send any replacements?

Are there any irregularities or flaws in the parts? We can send replacements!

☐

Prep Time!

Please review the assembly instructions and all diagrams prior to assembling.

PRE ASSEMBLY INTRODUCTION

We understand building ready-to-assemble furniture can be a challenging experience for some. To help avoid confusion, we have provided some helpful tips that may speed up the process.



Teamwork

ALWAYS have at least two people to help with transporting and assembling the product to avoid potential injury and/or damage.



Suitable Location

Assembling near the area of the intended location is highly recommended.



Sufficient Space

Make sure you have enough space to move around during the assembly.



Avoid Scratches

Use cardboard, blankets or a carpeted area while assembling furniture to prevent to prevent scratches and damages.



Flat Surface

Make sure the furniture rests on a flat and level surface with each leg evenly touching the floor.

ASSEMBLY AND CARE ADVICE



**FAILURE TO FOLLOW THE GUIDELINES BELOW MAY
RESULT IN INJURY AND/OR PROPERTY DAMAGE.**



Position each part correctly
and insert screws or bolts into
their respective holes.

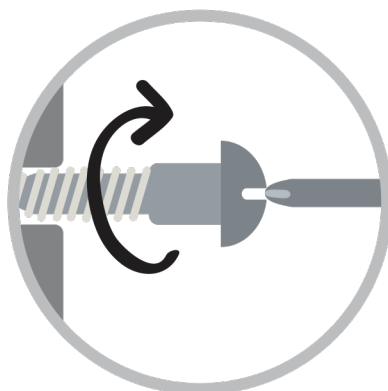

Turn clockwise to tighten and
only tighten when step is
completed or when instructed
to do so.



Use the appropriate hand tools
or power tools for assembly.
Select steps, such as tightening
screws and/or bolts, may require
hand tools to avoid causing
damage during assembly.



Save the instructions and store
any supplied tools for later
maintenance.

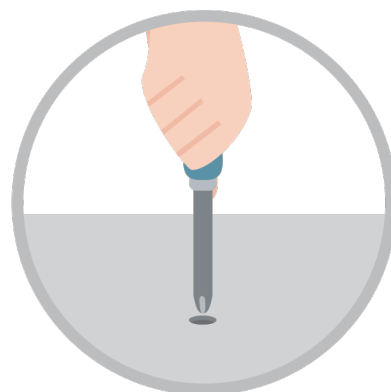

After two weeks, check and
tighten any loose hardware and
repeat again every six months
thereafter.

IT IS THE USER'S RESPONSIBILITY TO MAINTAIN THE FURNITURE. THE HARDWARE MAY LOOSEN OVER TIME AND MAY CAUSE THE FURNITURE TO BE WOBBLY AND UNABLE TO SUPPORT ITS INTENDED WEIGHT CAPACITY. THIS MAY LEAD TO COLLAPSE AND MAY CAUSE SERIOUS INJURY.

BOOKCASE

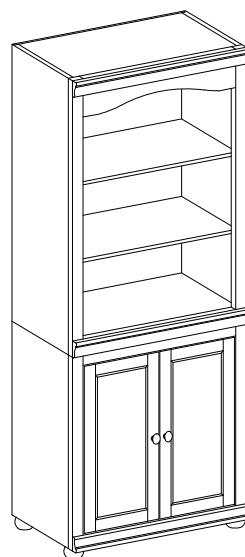
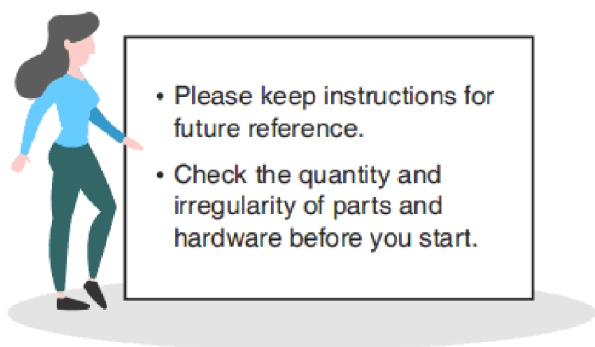

PARTS

#1 1pc

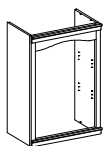

Hutch

#2 1pc

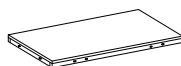

Top Panel

#3 1pc



Bottom Panel

#4 1pc

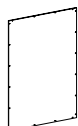

Back Panel

#5 3pcs



Active shelf

#6 1pc

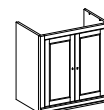

Cabinet

#7 1pc

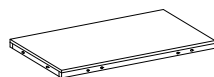

Cabinet
Bottom Panel

#8 1pc



Cabinet
Back Panel

#9 4pcs



Leg

HARDWARE

#A 22pcs



Bolt Ø1/4" x 1-3/8"

#B 22pcs



Lock washer Ø1/4"

#C 22pcs



Flat Washer
Ø5/16" x 19mm

#D 1pc

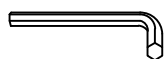

Allen Wrench 4mm

#E 6pcs



Wood Dowel Ø8 x 3/4"

#F 36pcs



Wood Screw #3 x 15mm

#G 12pcs



Shelf Pin

#H 1set



Anti-tip Skit

#I 2pcs

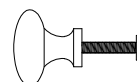

Handle

#J 12pcs



Wood Screw #3 x 12mm

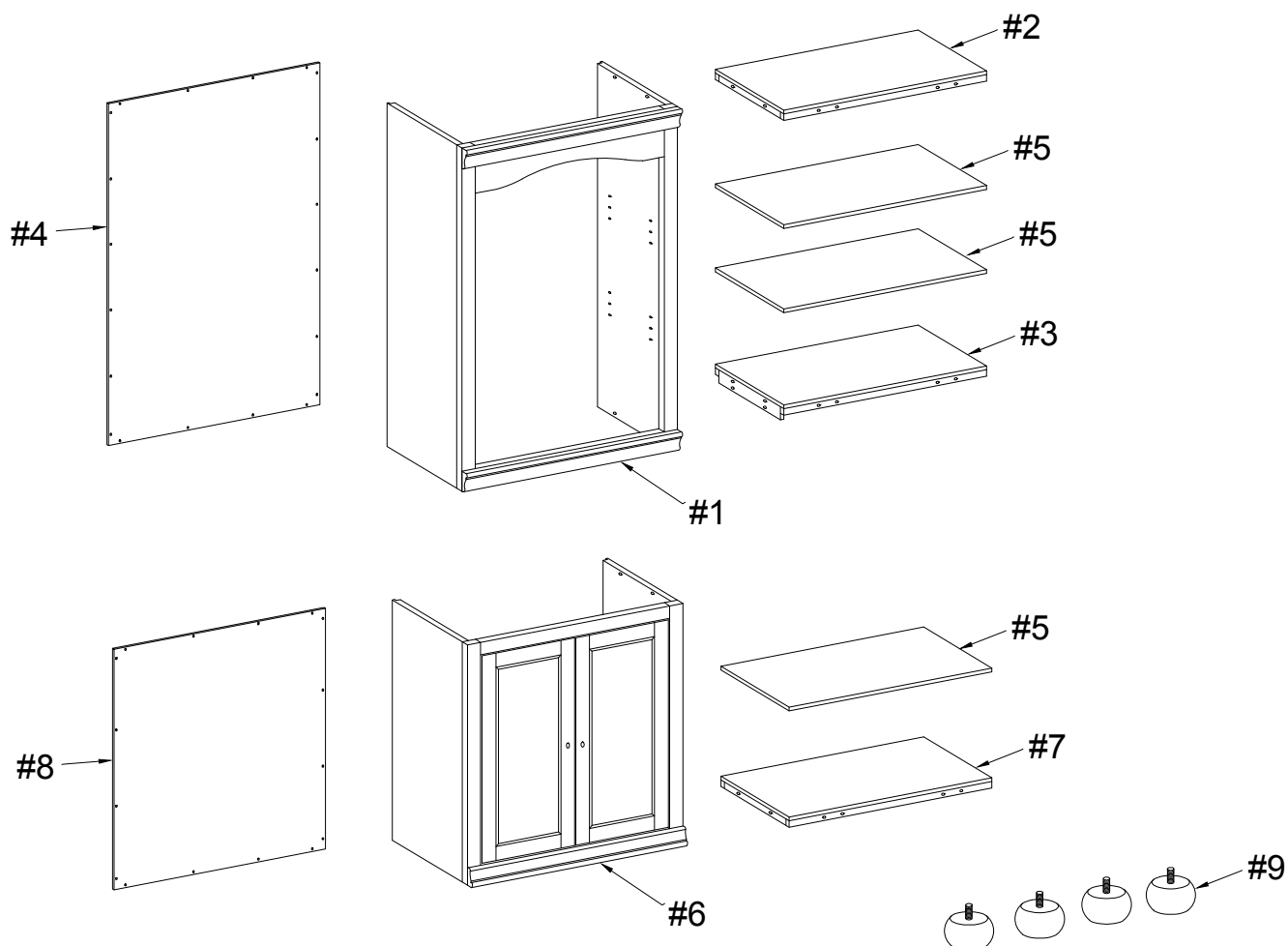

ASSEMBLY INSTRUCTIONS

1

Part #1 x1pc

Part #6 x1pc

Open Hutch (#1)
and Cabinet (#6)

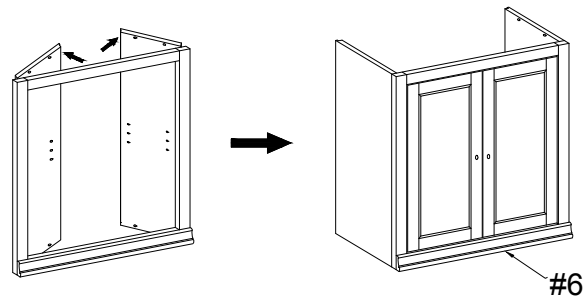
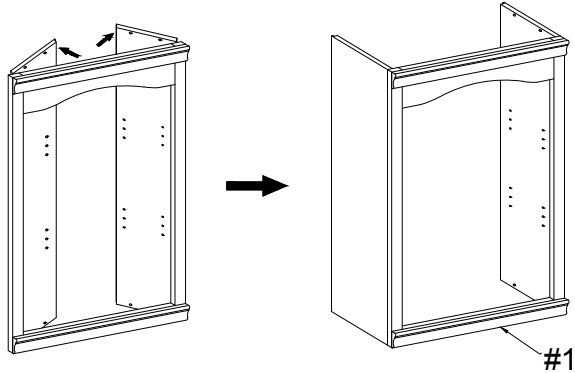

2

Part #2 x1pc

Part #3 x1pc

Part #7 x1pc

Hardware #A x6pcs

Hardware #B x6pcs

Hardware #C x6pcs

Hardware #E x6pcs

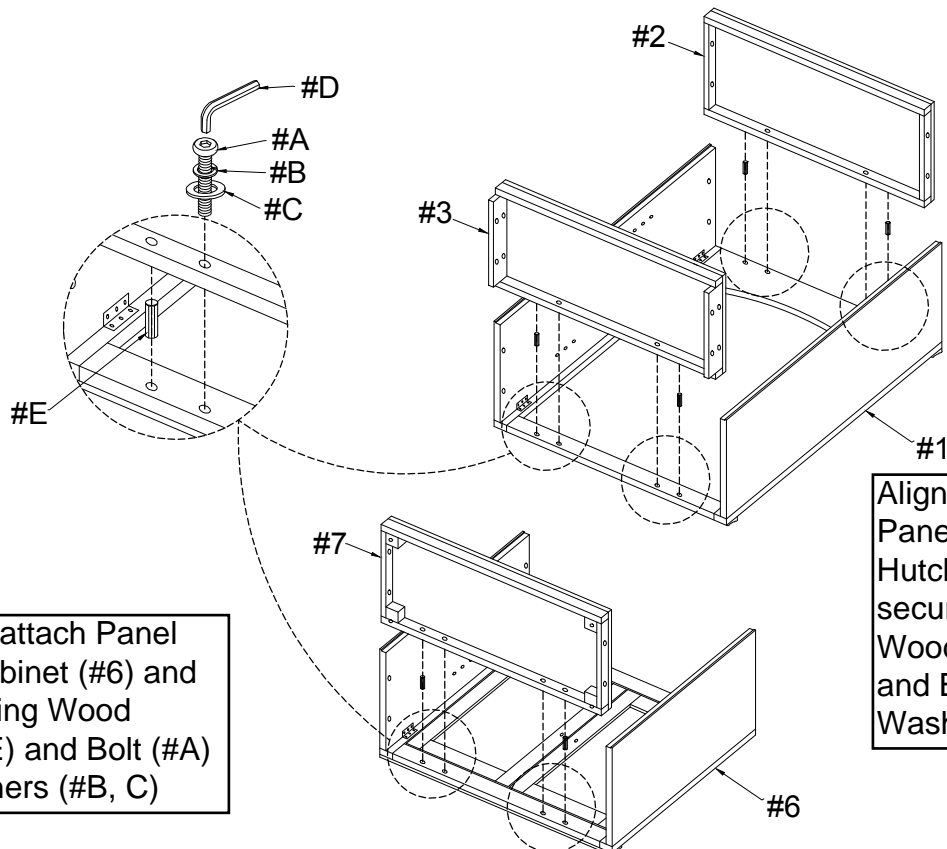

Align and attach Panel
(#7) to Cabinet (#6) and
secure using Wood
Dowel (#E) and Bolt (#A)
with Washers (#B, C)

Align and attach
Panels (#2, 3) to
Hutch (#1) and
secure using
Wood Dowel (#E)
and Bolt (#A) with
Washers (#B, C)

ASSEMBLY INSTRUCTIONS

3

Hardware **#A** x12pcs

Hardware **#B** x12pcs

Hardware **#C** x12pcs

Secure Cabinet (#6)
and Hutch (#1) by
using Bolt (#A) with
Washers (#B, C)

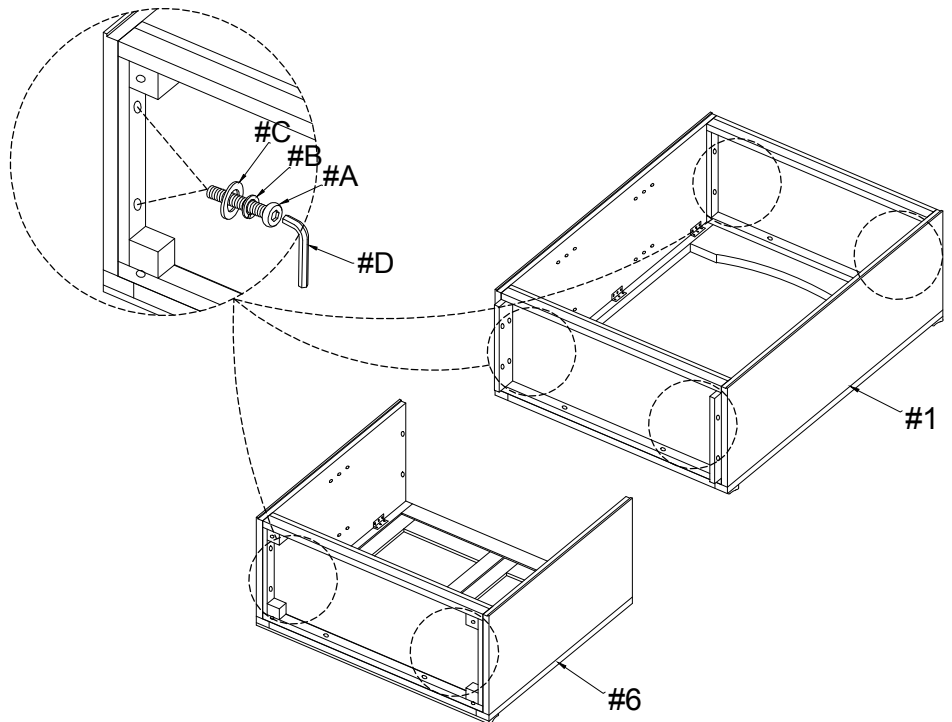

4

Hardware **#A** x4pcs

Hardware **#B** x4pcs

Hardware **#C** x4pcs

Attach Cabinet (#6)
unto Hutch (#1) by
using Bolt (#A) with
Washers (#B, C)

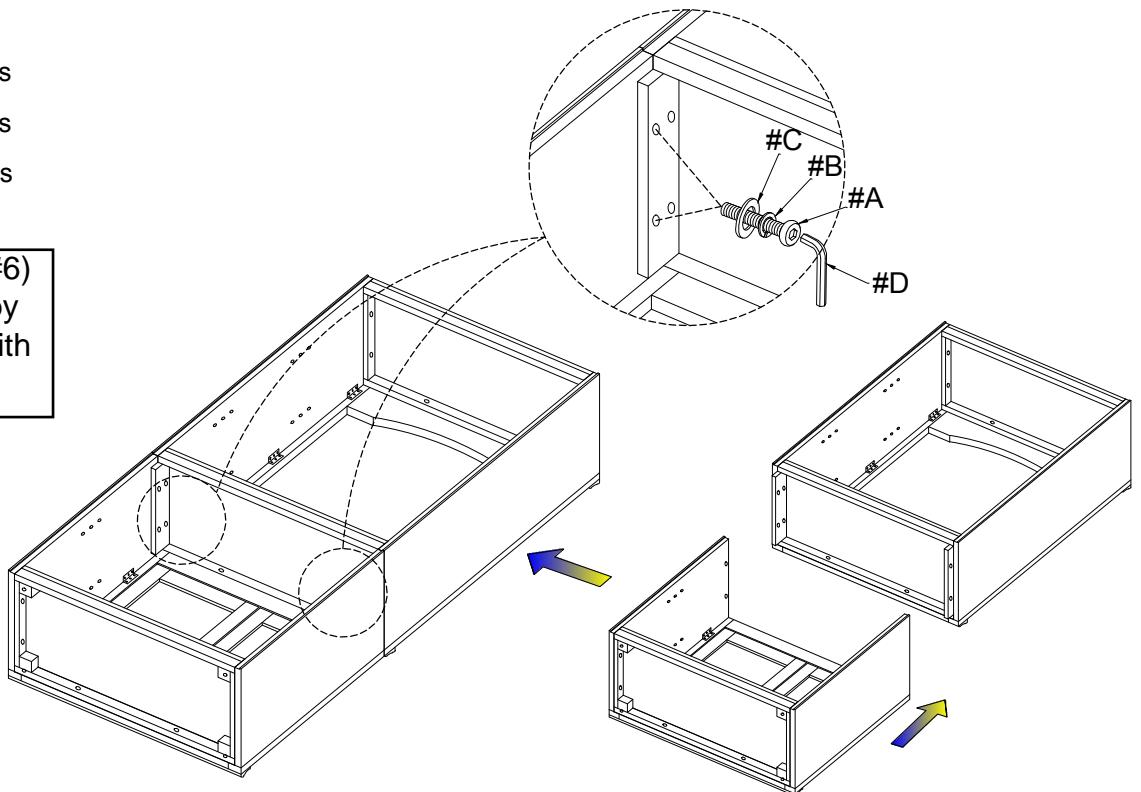

ASSEMBLY INSTRUCTIONS

5

- Part #4 x1pc
- Part #8 x1pc
- Part #9 x4pc
- Hardware #F x36pcs

Align and attach Panels (#4, 8) using Wood Screw (#F)

Screw Leg (#9) unto Cabinet (#6)

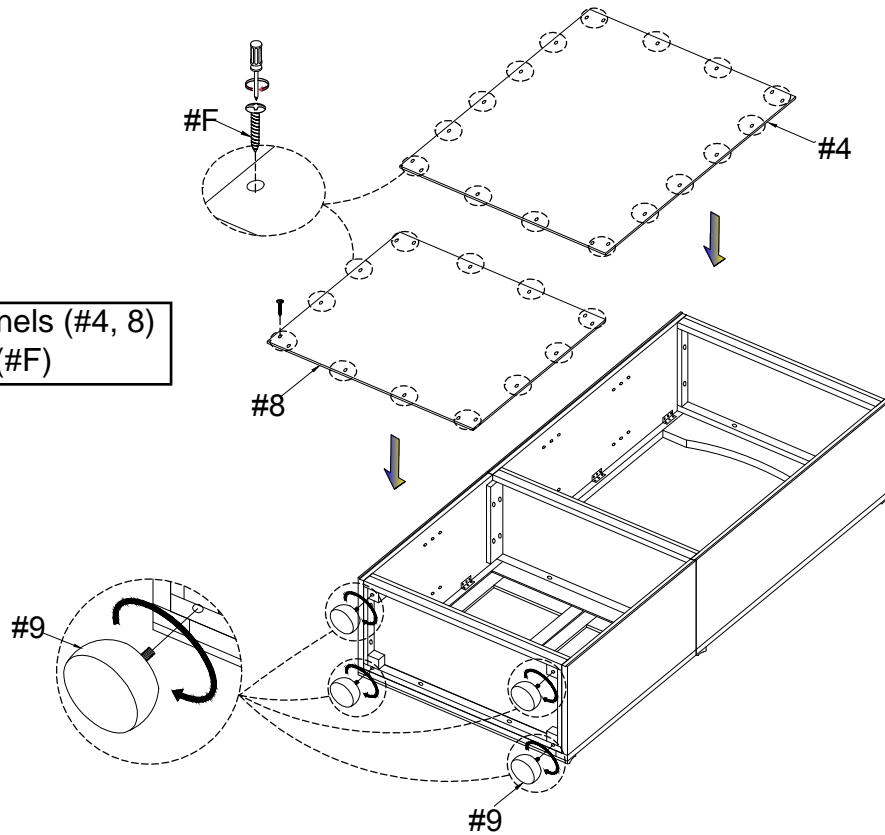

6

- Part #5 x3pcs
- Hardware #G x12pcs
- Hardware #I x2pcs
- Hardware #J x12pcs

Place Shelf Pin (#G) unto Hutch (#1) and Cabinet (#6). Then, using Screw (#J), secure Active Shelf (#5) on it

Attach Handle (#I) to Cabinet (#6)

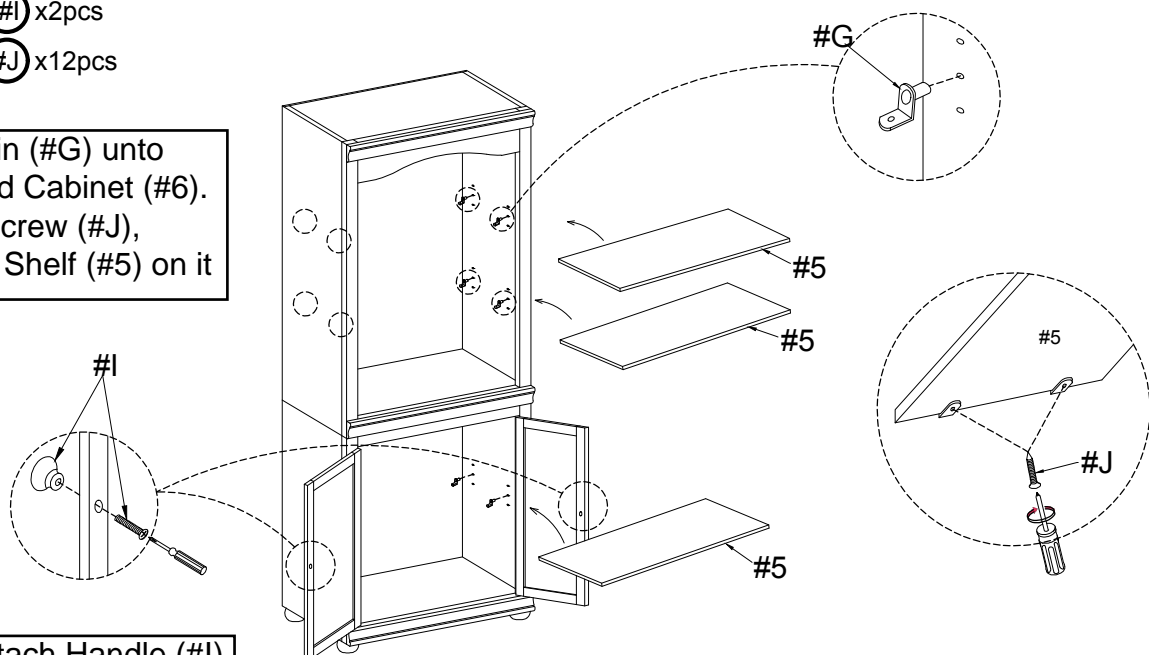

ASSEMBLY INSTRUCTIONS

7

Hardware  x1set

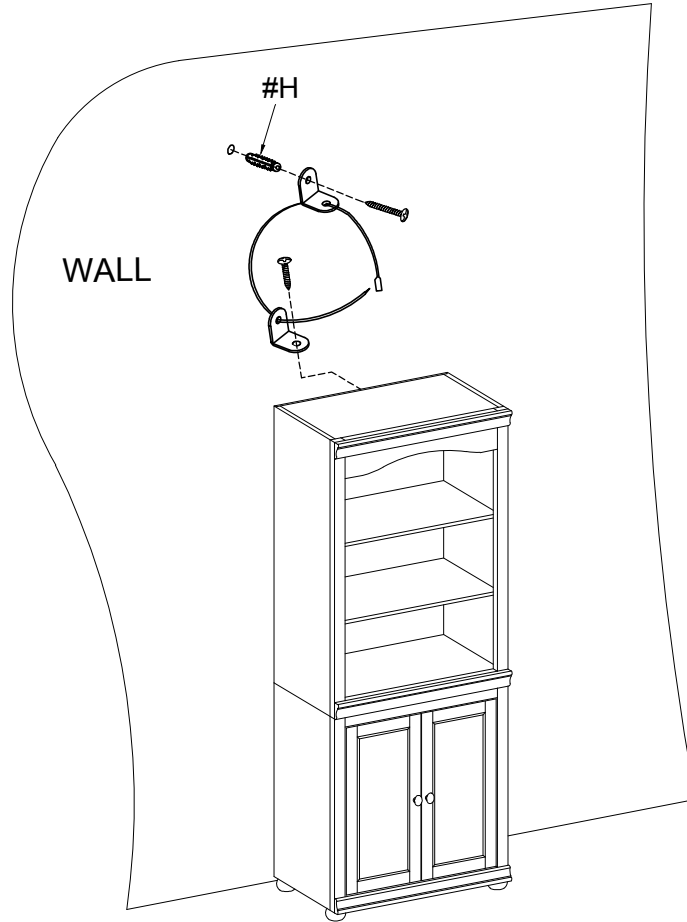

8

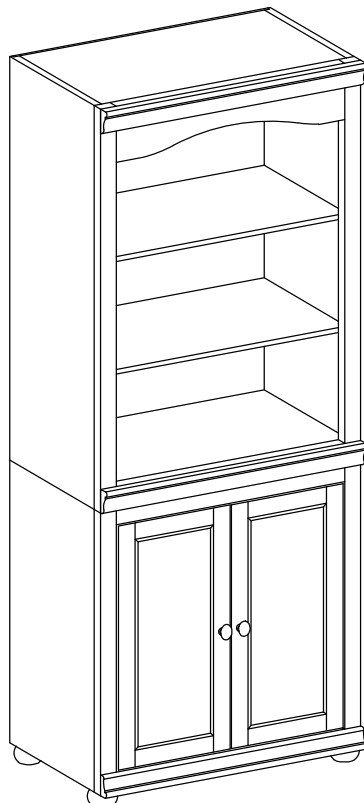

ASSEMBLY COMPLETED



Please ensure the furniture rests on an even and flat surface. If the product wobbles or feels loose, double-check all bolts and/or screws are properly tightened and secured.



Keep this handy!

Please retain this instruction manual and any order-related information for future reference.



Lift, don't drag!

To avoid damage to product please always LIFT the product when transporting or adjusting the placement.

ASSEMBLY INSTRUCTIONS

Wall Mounting and Fixing



EXPANSION WALL ANCHOR

Our provided expansion wall anchors are only suitable for masonry walls, such as drywall, plaster or concrete, and are best for holding lightweight items or for anti-tip prevention. If you are unsure of the correct wall anchor to use with the product, please request professional guidance. Liability for product damage or failure due to using the incorrect anchors will fall on the installer.

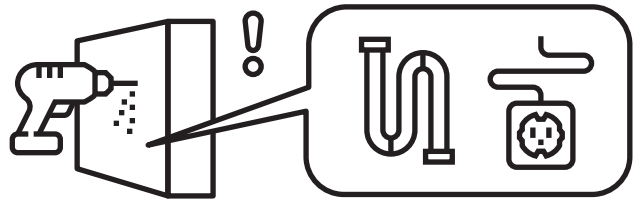

CHECK BEFORE PROCEEDING

Prior to drilling or hammering, please check for wires or pipes. We recommend using a stud finder to locate a stud, which will offer more appropriate resistance and hold more weight.

QUICK TIPS

1. If unsure of the proper size, always choose a larger screw and wall anchor.

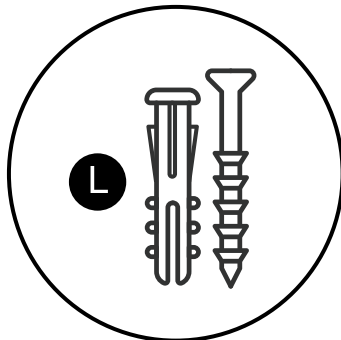

2. Match the drill bit to the wall anchor and hole size.

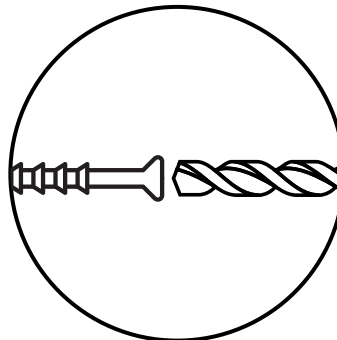

3. Only drill horizontally. Do not force the drill or enlarge the hole for the wall anchor.

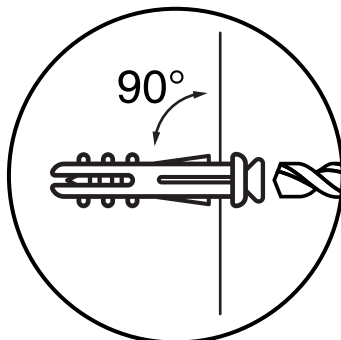

4. Take extra care when drilling into high walls or ceramic tiles. Wall anchors should be a tight fit for the hole. Never use wall anchors in ceilings.

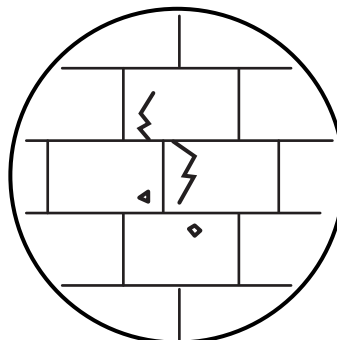

MAINTENANCE



We recommend a yearly check to see if the wall anchor or screw has loosened. If so, please remove the existing wall anchor and screw, and use a new anchor.