

ASSEMBLY INSTRUCTIONS

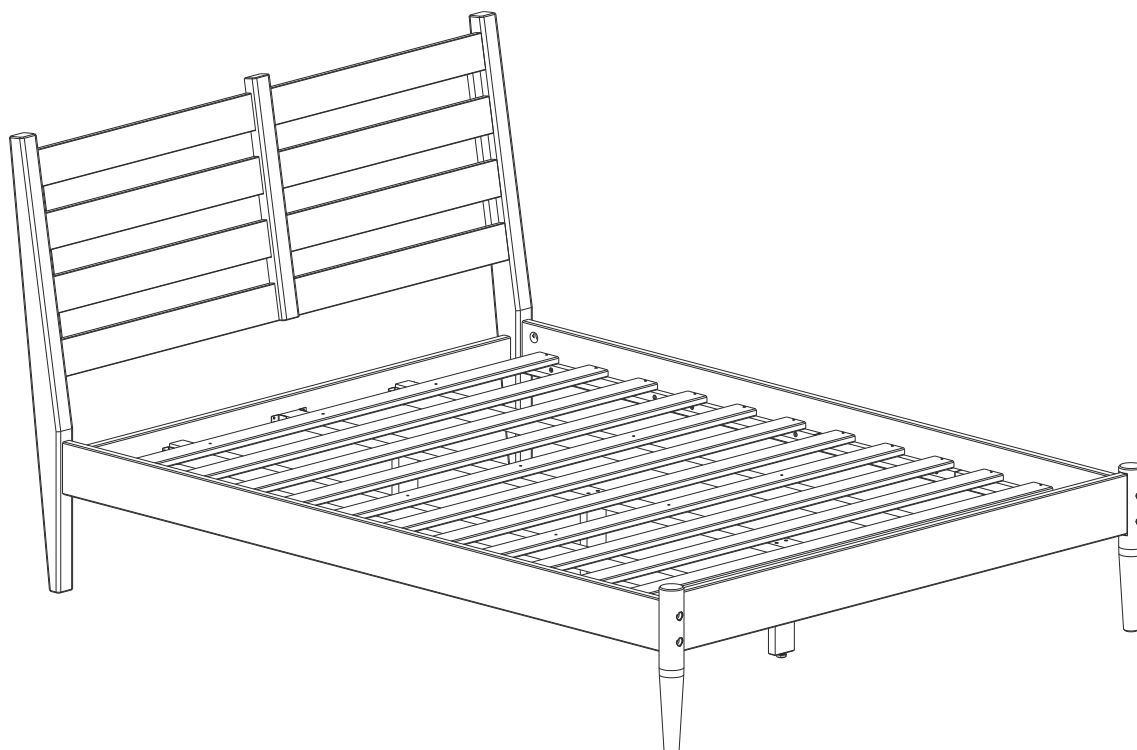

Mid-Century Slat Bed - Queen Size

01:20 Hs

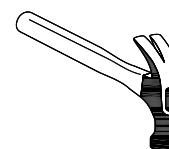
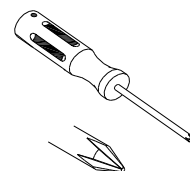
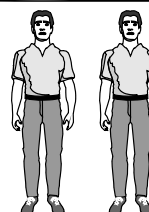

HARDWARE INCLUDED

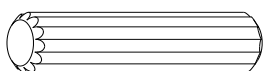

A - 10,0x50 Wood Dowel
Qty. 20

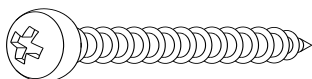

B - 4,0x40 Screw
Qty. 8



C - 3,5x16 Screw
Qty. 40

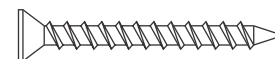

D - 3,5x30 Screw
Qty. 36



E - Screw Nut
Qty. 08

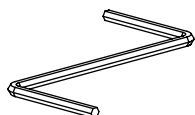

F - Allen Key
Qty. 01

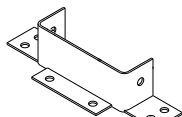

G - Support Bar
Qty. 02

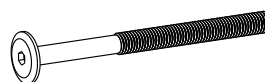

H - 1/4x100 Screw
Qty. 08

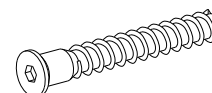

I - 7,0x50 Screw
Qty. 06

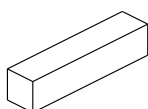

**J - Bed Frame
Separator 98mm**
Qty. 02

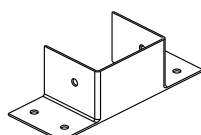

K - Support Bar
Qty. 04

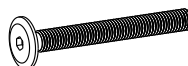

L - 1/4x50 Screw
Qty. 08



**M - Wood Hole
Cover - Qty. 04**

PARTS INCLUDED

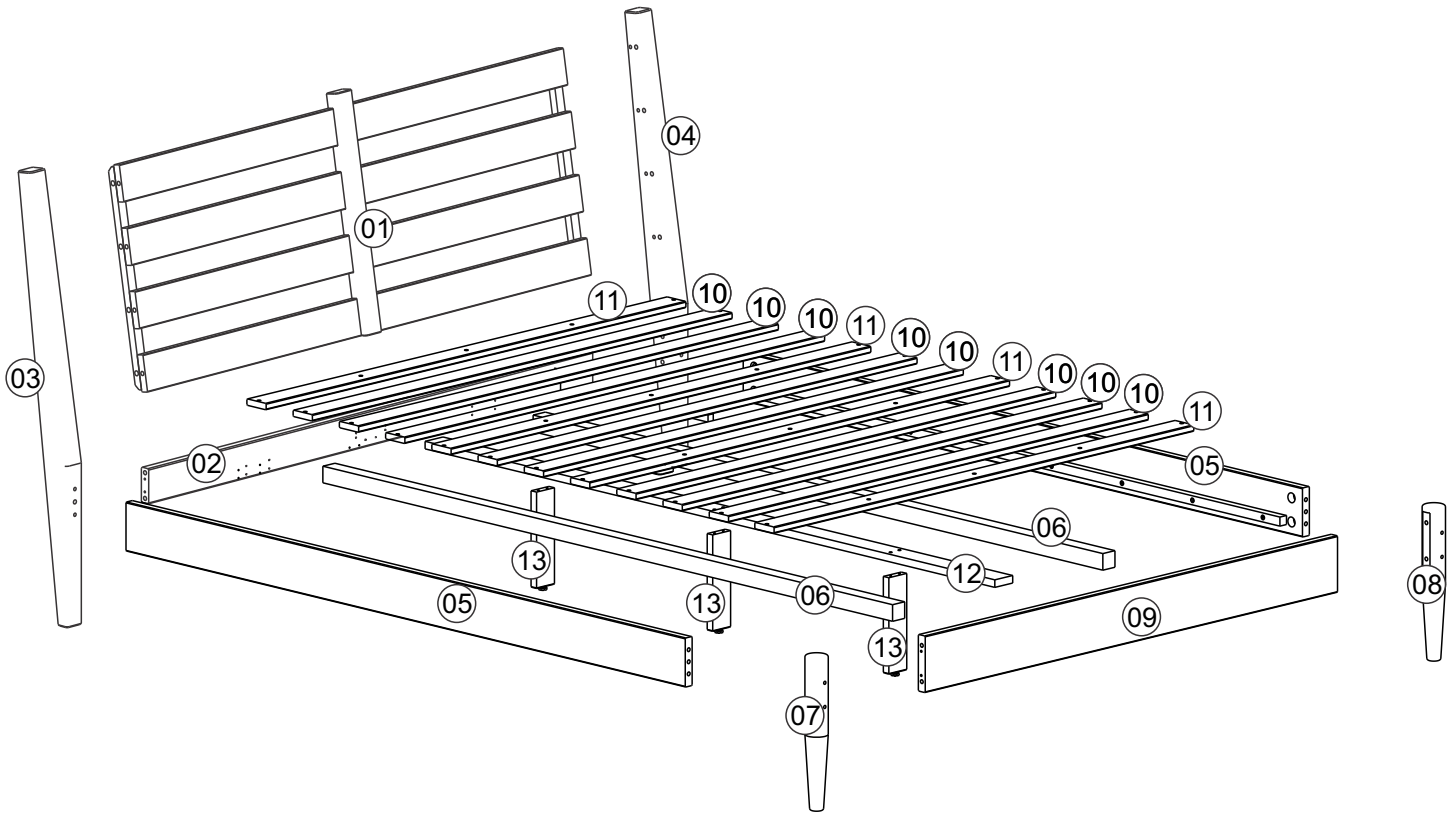

STEP 1

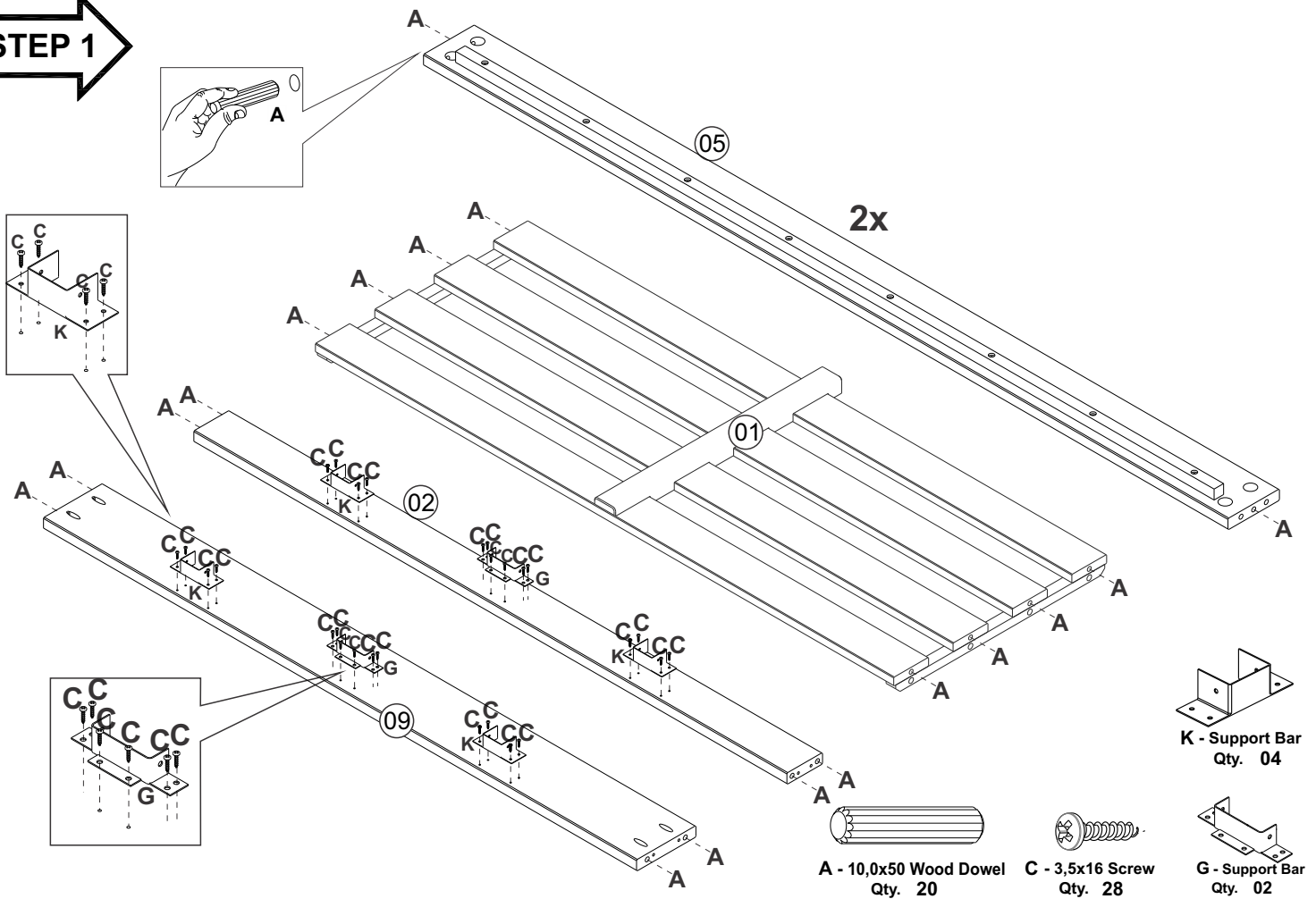

STEP 2

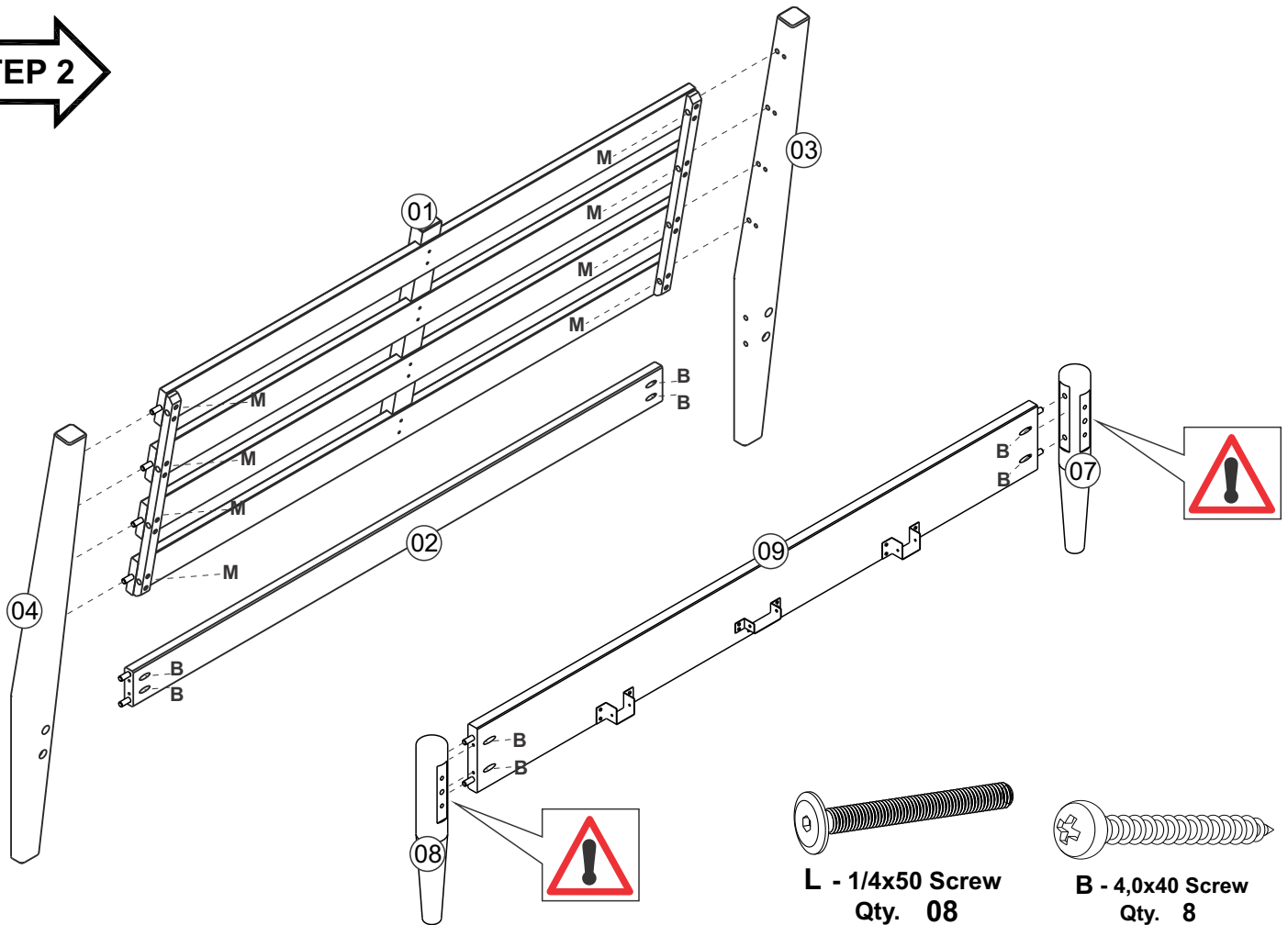

STEP 3

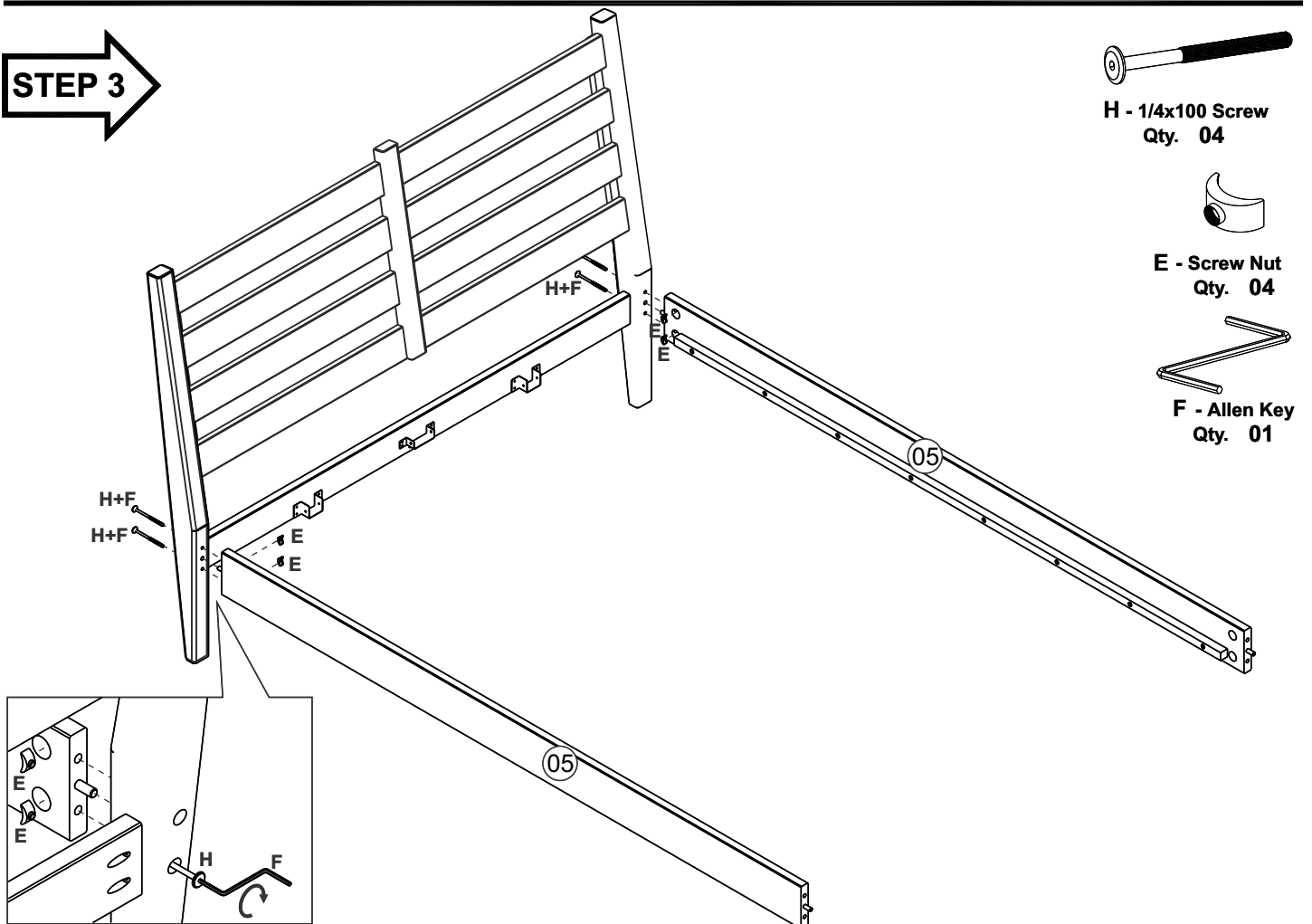

STEP 4

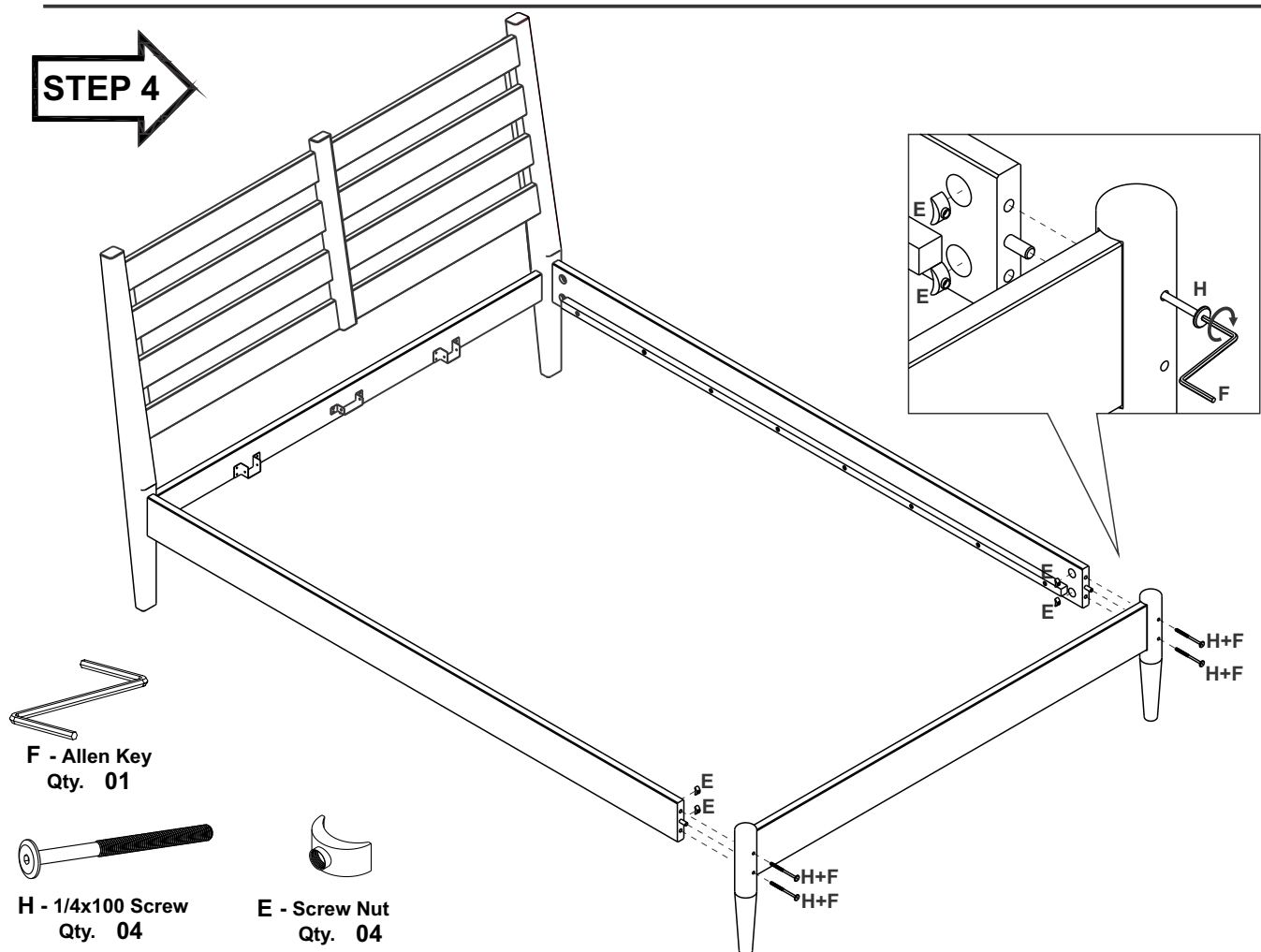

STEP 5

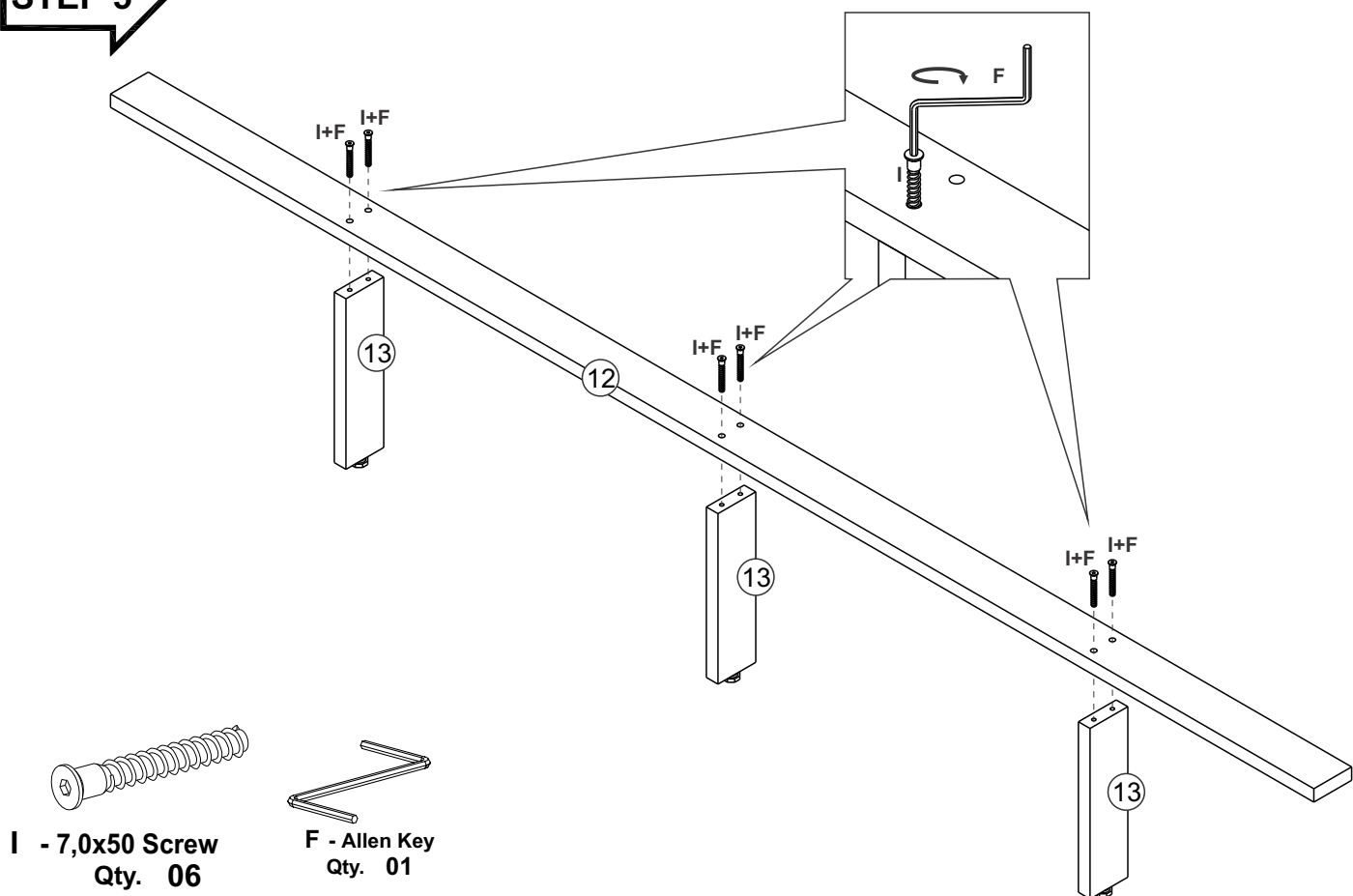

STEP 6

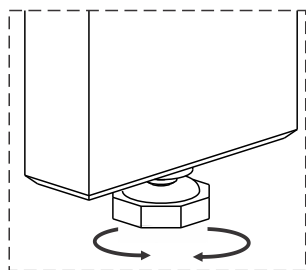
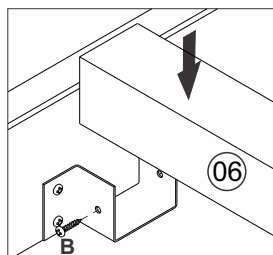

C - 3,5x16 Screw
Qty. 12

STEP 7

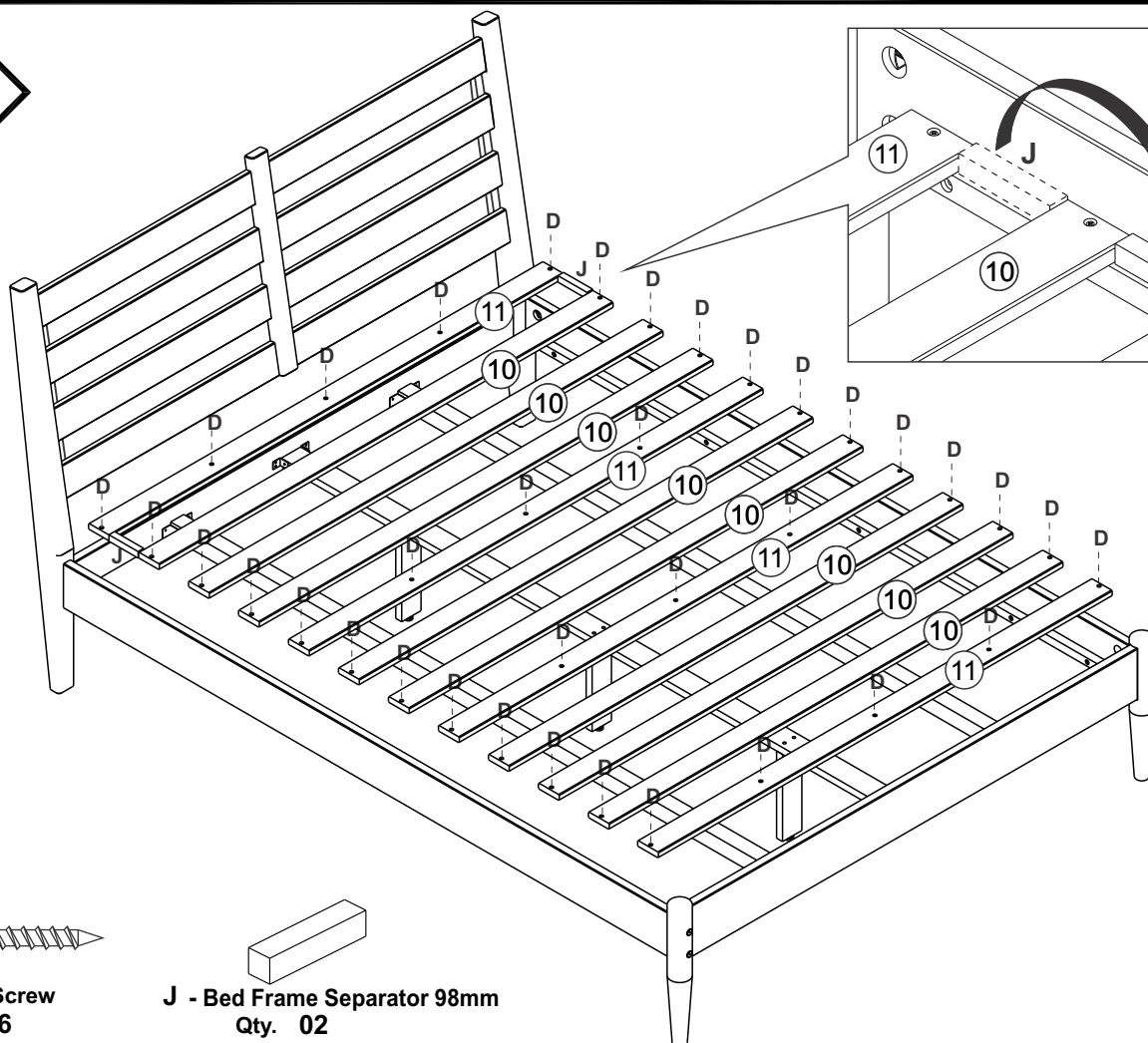
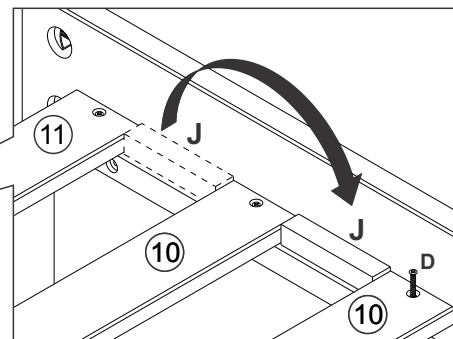

D - 3,5x30 Screw
Qty. 36

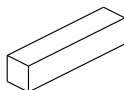

J - Bed Frame Separator 98mm
Qty. 02

STEP 8

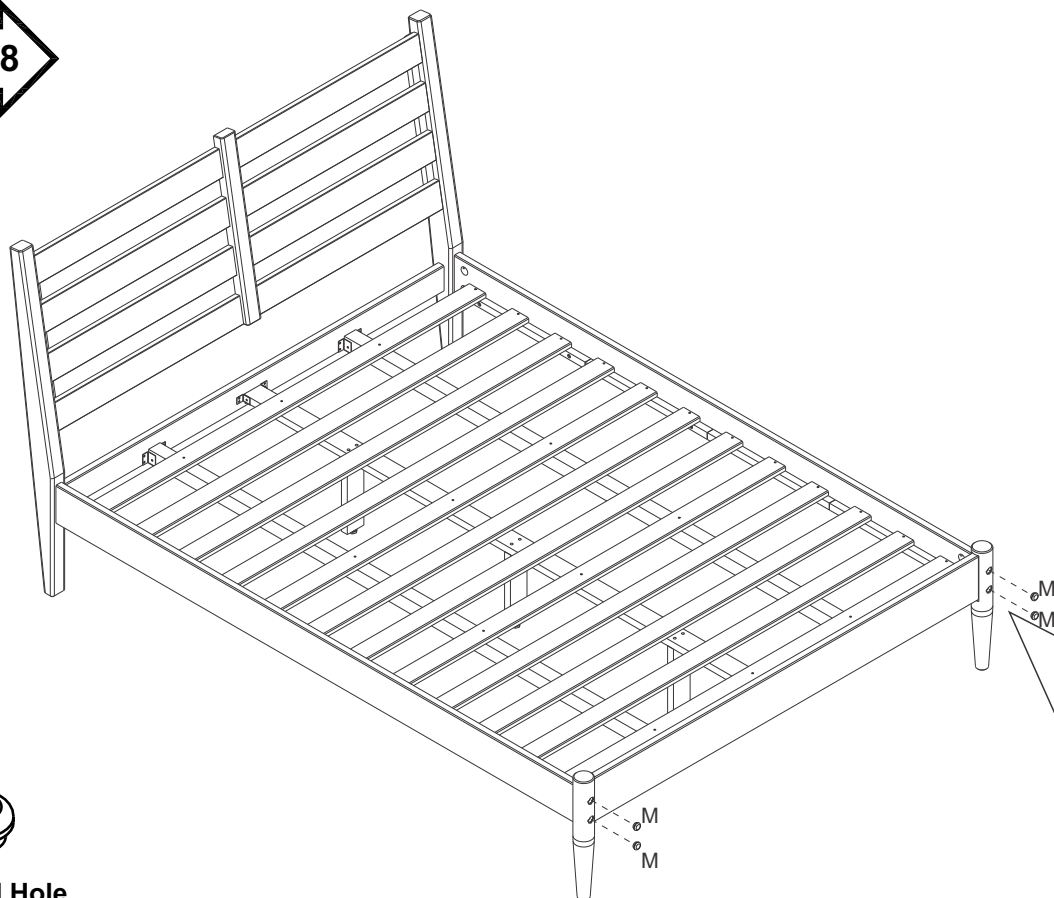

**M - Wood Hole
Cover - Qty. 04**

