



# WIDESPREAD FAUCET INSTALLATION

## BEFORE YOU BEGIN

We recommend consulting a professional if you are unfamiliar with installing plumbing fixtures. Signature Hardware accepts no liability for any damage to the faucet, plumbing, sink, counter top, or for personal injury during installation.

Observe all local plumbing and building codes.

Unpack and inspect the faucet for damage. If any damage is found, contact our Customer Relations team

## GETTING STARTED

- Ensure that you have gathered all the required materials that are needed for the installation.
- For these instructions, it is assumed that the old faucet has been completely removed and any necessary repairs or modifications to the water supply have been completed.

## TOOLS AND MATERIALS:



Plumbers  
Tape



Thread  
Sealant



Phillips  
Screwdriver



Adjustable  
Wrench



Small  
Bucket



Basin  
Wrench

## INSTALLATION

1. Ensure that the water supply below your sink is completely shut off by turning the shutoff valves all the way to the right.

**Tip:** Place a small bucket below your workspace to catch any water that may drip during the installation process.

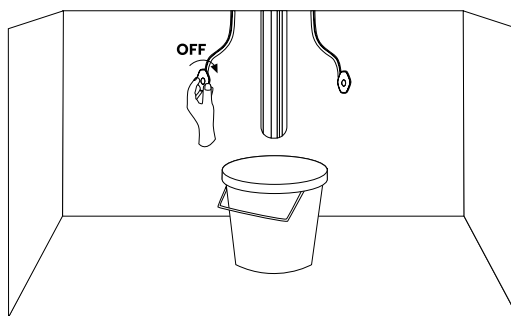

2. The size of counter basin's hole as above.

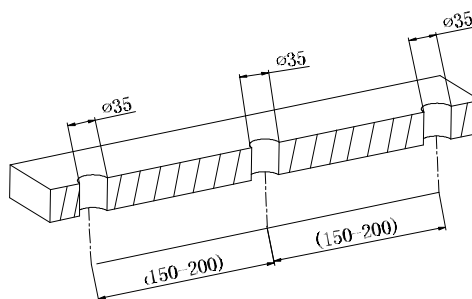

3. Slide the washer (O-ring) to faucet base. Insert the new faucet through sink.

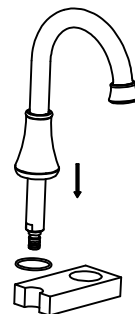



4、 Prepare to install the underneath receiver. Install washer on nut and tee joint.

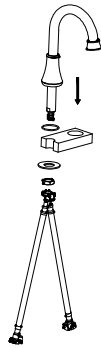

5、 Insert rubber washer, then insert trident joint. Tighten trident and align with valve. Tighten coupling nut and insert trident.

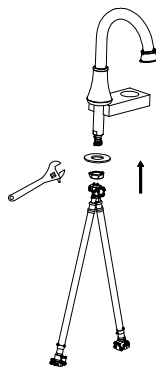

6、 Insert hot and cold water handles through the hole. Put on fitting accessories in correct order.

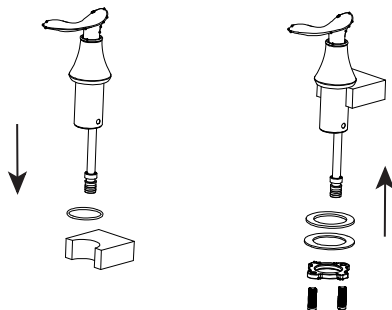

7、 Tighten the handles.

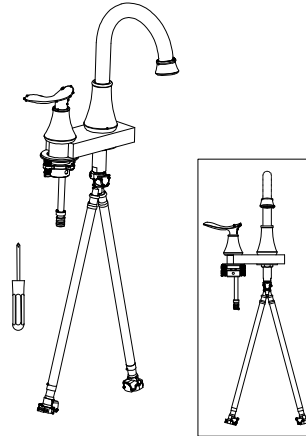

8、 Connect and tighten the hoses with hot and cold Water supplies. Turn on Water supplies, turn the handle, flush the hot and cold water for 1 minute.

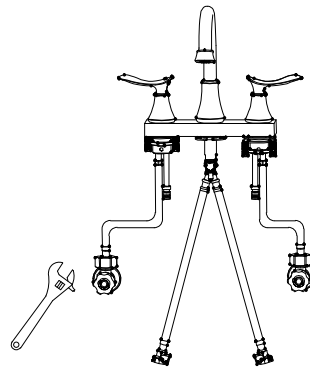

9、 Connect and tighten the hoses.

