



Liberty Furniture
INDUSTRIES, INC

ASSEMBLY INSTRUCTION

ITEM#: 417-BR30

DESCRIPTION: 6 DRAWER DRESSER

Thank you for purchasing this quality product. Be sure to check all packing material carefully for small parts, which may have come loose inside the carton during shipment. Identify and count all parts and compare with the parts list below.

FINISH ASSEMBLY

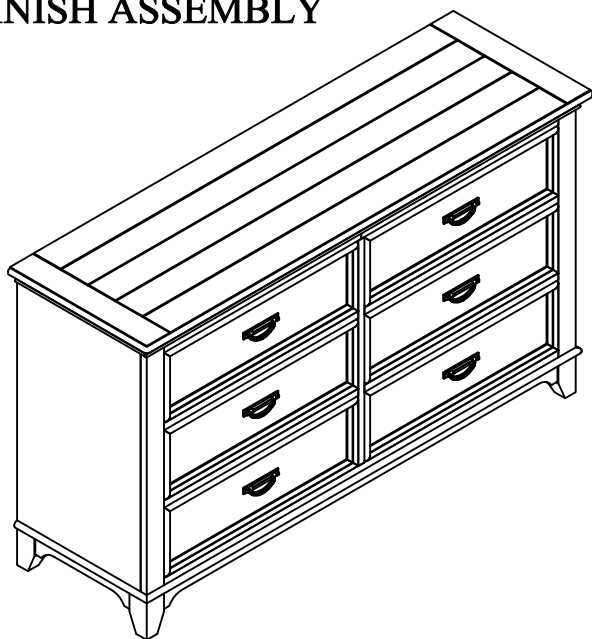

PARTS LIST

| NO | DRAWING | DESCRIPTION | Q'TY |
|----|---------|-------------|------|
| 1 | | Dresser | 1 |
| 2 | | Leg | 4 |
| 3 | | Support Leg | 1 |

HARDWARE LIST

| NO | DRAWING | DESCRIPTION | Q'TY |
|----|---------|----------------------------|------|
| A | | Bolt Ø5/16"-18*50mm(L) | 8 |
| B | | Spring Washer Ø5/16"*Ø13mm | 8 |
| C | | Flat Washer Ø5/16"*Ø19mm | 8 |
| D | | Allen Key 4mm | 1 |
| E | | Tipping Restraint | 2 |

STEP 1

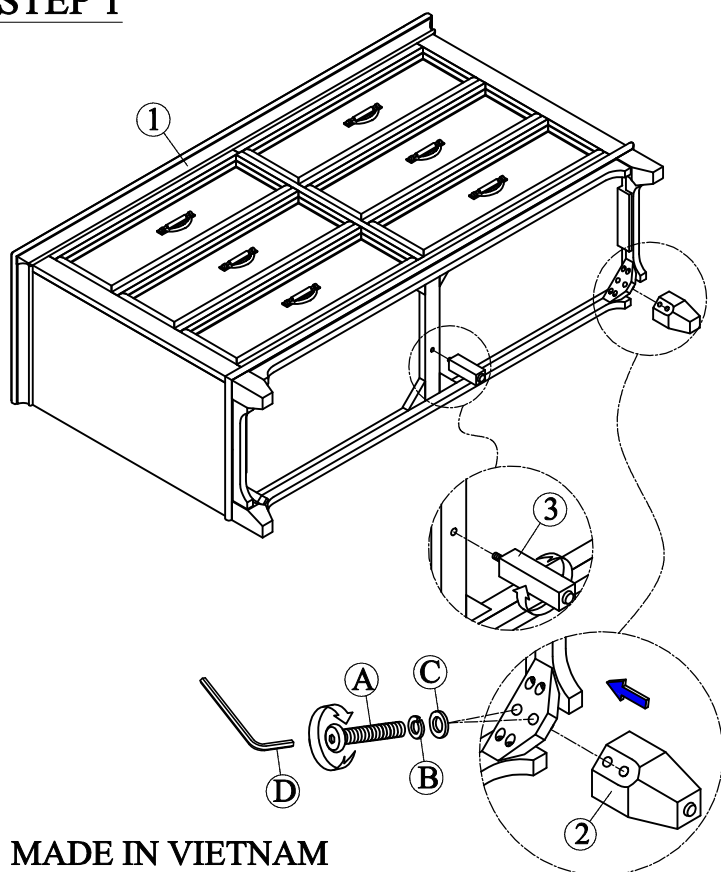

STEP 2

