

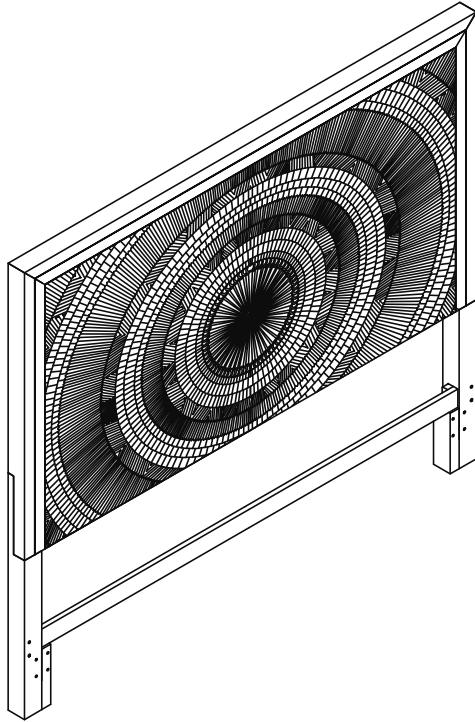

**ITEM# : 902-BR15**

**DESCRIPTION: KING DECORATIVE PANEL HEADBOARD**

Thank you for purchasing this quality product. Be sure to check all packing material carefully for small parts which may have come loose inside the carton during shipment. Identify and count all parts and compare with the parts list below:



PARTS LIST			
NO.	DRAWING	DESCRIPTION	Q'TY
1		HEADBOARD	1PC
2		LEFT LEG	1PC
3		RIGHT LEG	1PC
4		STRETCHER	1PC
HARDWARE LIST			
NO.			Q'TY
A		BOLT $\phi 5/16"$ -18*1-3/8"	2 PCS
		LOCK WASHER $\phi 5/16"$	2 PCS
		FLAT WASHER $\phi 5/16"$ *19*2mm	2 PCS
B		BOLT $\phi 5/16"$ -18*2"	6 PCS
		LOCK WASHER $\phi 5/16"$	6 PCS
		FLAT WASHER $\phi 5/16"$ *19*2mm	6 PCS
C		ALLEN WRENCH 5mm	1PC

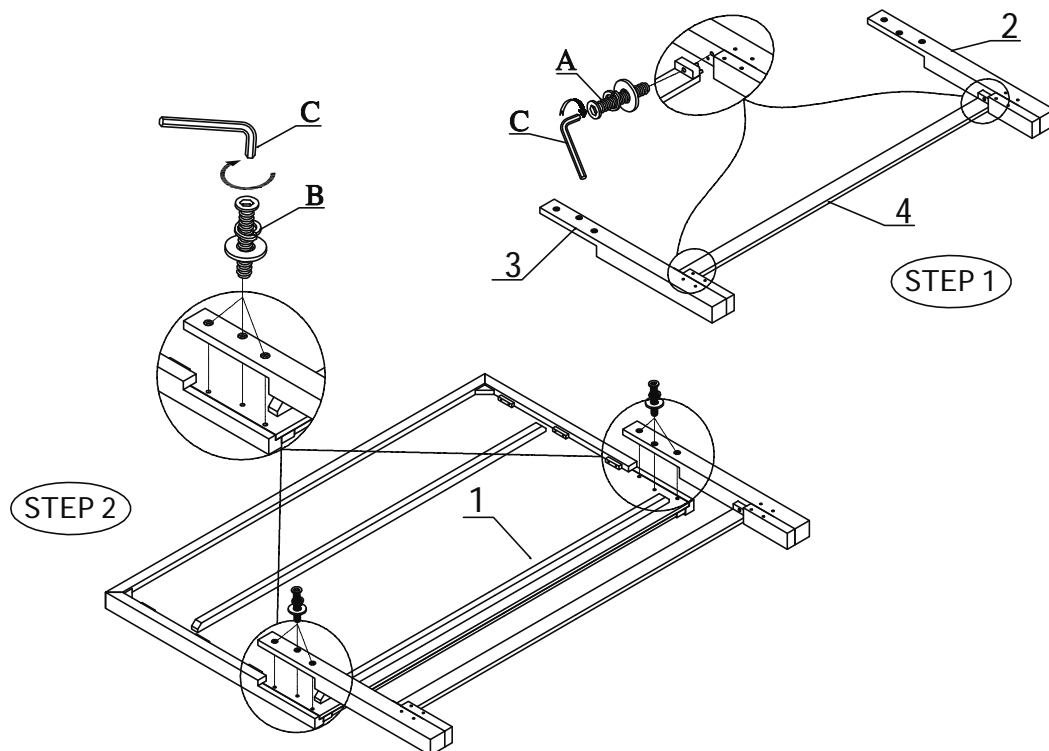



**Liberty Furniture**  
INDUSTRIES, INC

# LIBERTY FURNITURE

## ASSEMBLY INSTRUCTION

**ITEM# :** 902-BR15  
902-BR16  
902-BR90

**DESCRIPTION :** KING DECORATIVE PANEL HEADBOARD  
KING PANEL FOOTBOARD  
PANEL BED RAILS

Thank you for purchasing this quality product. Be sure to check all packing material carefully for small parts which may have come loose inside the carton during shipment. Identify and count all parts and compare with the parts list below:

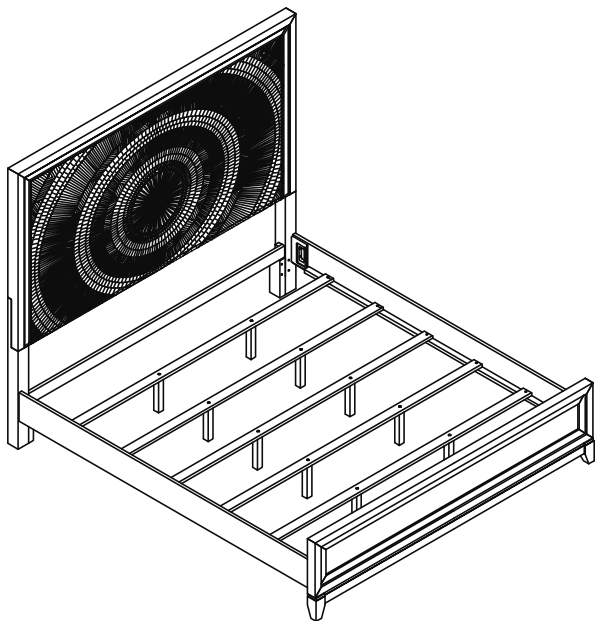

PARTS LIST			
NO.	DRAWING	DESCRIPTION	Q'TY
1		HEADBOARD	1PC
2		FOOTBOARD	1PC
3		SIDE RAIL	2PCS
4		SLAT	5PCS
5		SUPPORT LEG	10PCS
NO.	DRAWING	HARDWARE LIST	Q'TY
A		BOLT $\phi 5/16"$ -18*3-1/2"	8 PCS
B		FLAT WASHER $\phi 5/16"$ *16*2mm	8 PCS
C		LOCK WASHER $\phi 5/16"$	8 PCS
D		HEX NUT $\phi 5/16"$	8PCS
E		OPEN WRENCH $\phi 5/16"$	1PC
F		SCREW M4 x 25mm	10PCS

