



LIBERTY FURNITURE

ASSEMBLY INSTRUCTION

ITEM # 361-BR15/361W-BR15

DESCRIPTION: KING MANSION HEADBOARD

Thank you for purchasing this quality product. Be sure to check all packing materials carefully for small parts which may have come loose inside the carton during shipment. Identify and count all parts and compare with the parts list Below.

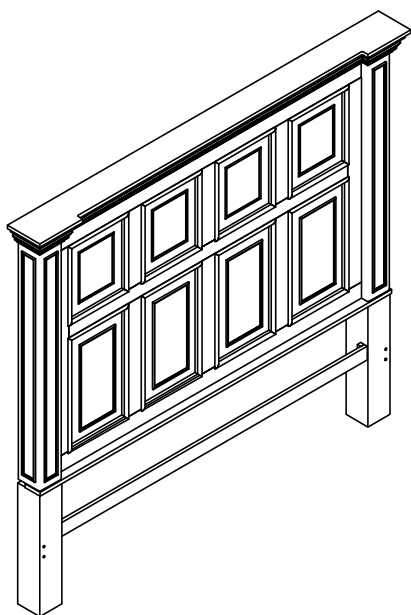

Complete Assembly

PARTS LIST

NO.	DRAWING	DESCRIPTION	Q'TY
A		Headboard	1
B		Right Leg	1
C		Left Leg	1
D		Stretcher	1

HARDWARE LIST

NO.	DRAWING	HARDWARE	Q'TY
1		Bolt Ø5/16**38mm(L)	2
2		Bolt Ø5/16**51mm(L)	6
3		Spring Washer Ø5/16**12mm	8
4		Flat Washer Ø5/16**19mm	8
5		Allen Key 4mm	1

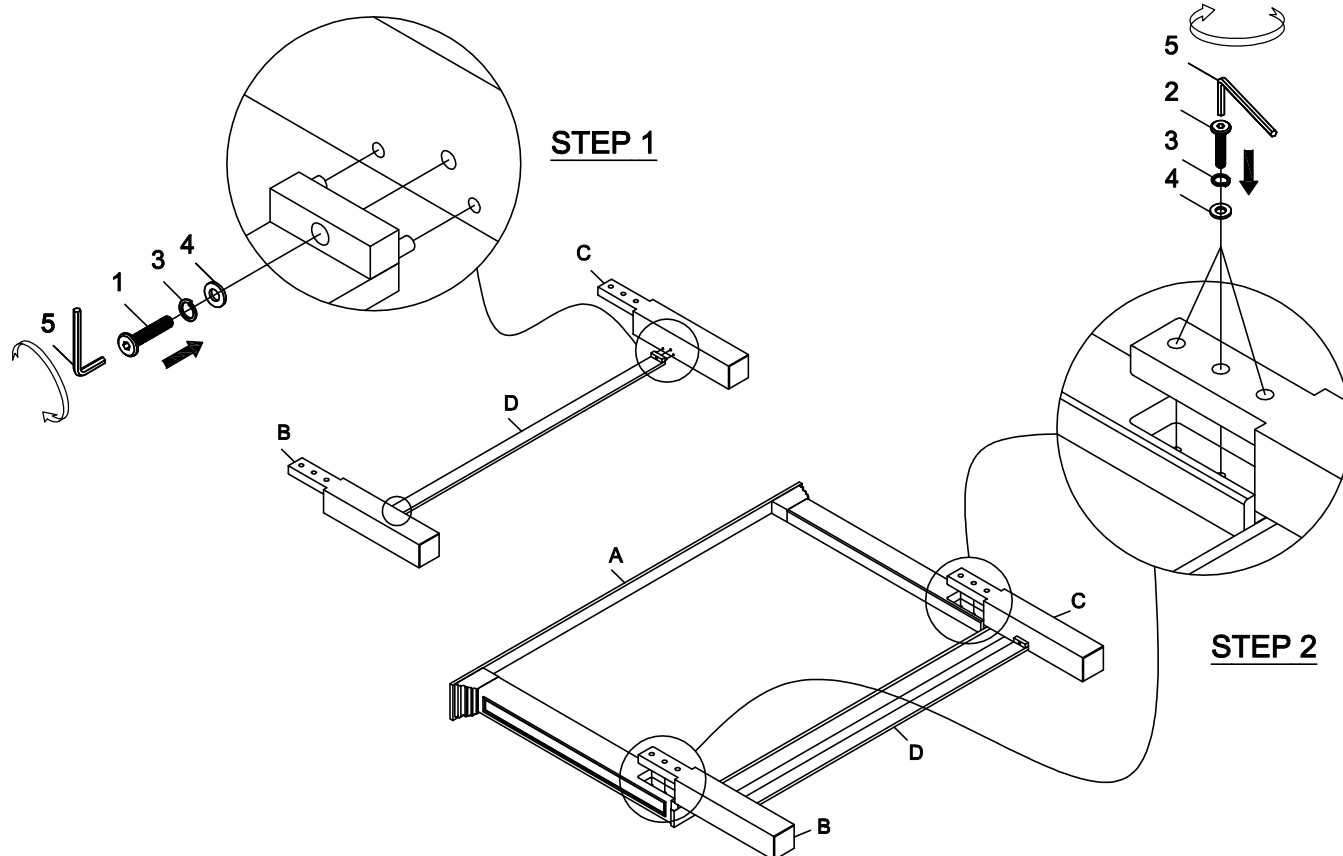



Liberty Furniture
INDUSTRIES, INC

LIBERTY FURNITURE

ASSEMBLY INSTRUCTION

361-BR15/361W-BR15

ITEM # 361-BR16/361W-BR16

361-BR90C/361W-BR90C

DESCRIPTION:

KING MANSION HEADBOARD

KING MANSION FOOTBOARD

CALIKING PANEL BED RAILS

Thank you for purchasing this quality product. Be sure to check all packing materials carefully for small parts which may have come loose inside the carton during shipment. Identify and count all parts and compare with the parts list Below.

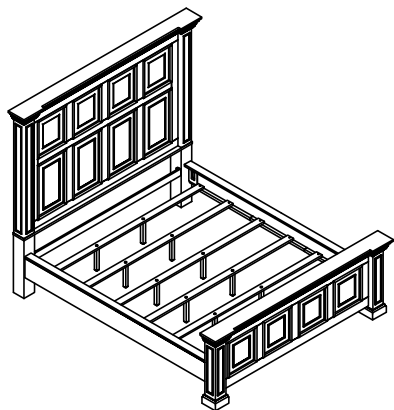

Complete Assembly

PARTS LIST

NO.	DRAWING	DESCRIPTION	Q'TY
A		Headboard	1
B		Footboard	1
C		Side rails	2
D		Slat	5
E		Slat support	10

HARDWARE LIST

NO.	DRAWING	HARDWARE	Q'TY
1		Hanger Bolt Ø5/16**18*70mm(L)	8
2		Flat Washer Ø5/16**19mm	8
3		Spring Washer Ø5/16**12mm	8
4		Hexagon Nut Ø5/16**12*10mm(L)	8
5		Allen Wrench 12*90mm(L)	1
6		Screw Ø8*25mm(L)	10

