

ASSEMBLY INSTRUCTION

Item No. : SF-267PU-CH

PACKAGE LIST

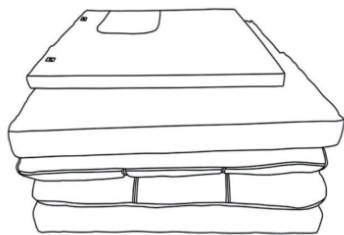

(A)*2
Futon Body



(B)*4
Side Legs

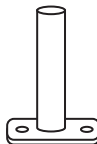

(C)*2
Middle Legs



(D) *8
Bolts
M10*25MM

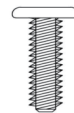

(E)*4
Bolts
M10*35MM



(F)*1
Wrench
6MM

Step 1:

Turn the futon body(A) upside down, place the 2 holes with white cardboard on each cushion facing the center of the futon close together. Take out the legs and hardware in the fabric zipper pocket on the underside of the sofa bed.

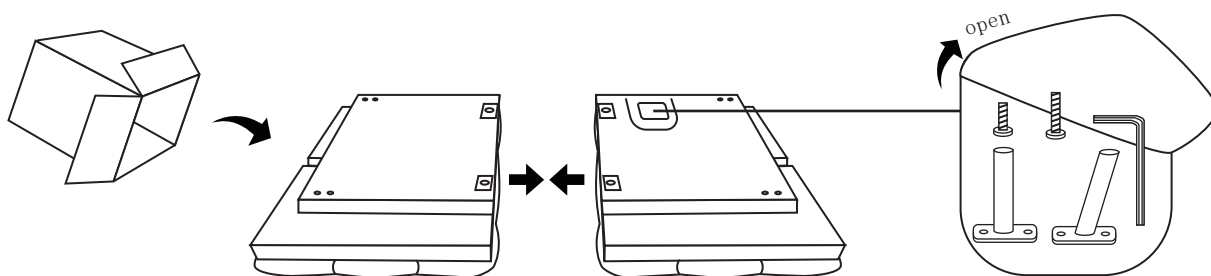

Step 2:

1. Attach the Middle Leg(C)*2 to the Futon Body (A) with Four Bolts(E)*4, using the Wrench(F).
2. Attach the Side Leg(B)*4 to the Futon Body (A) with Eight Bolt(D)*8, using the Wrench(F)

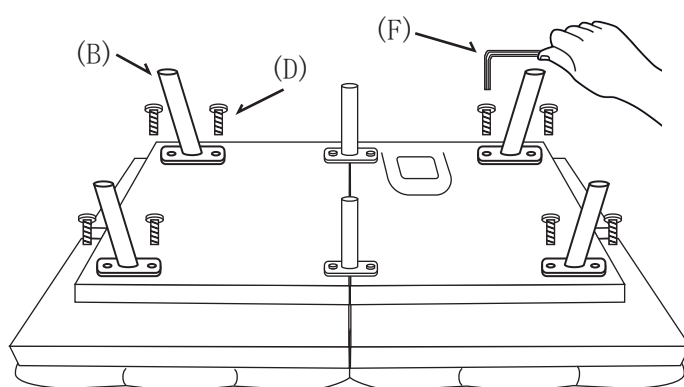
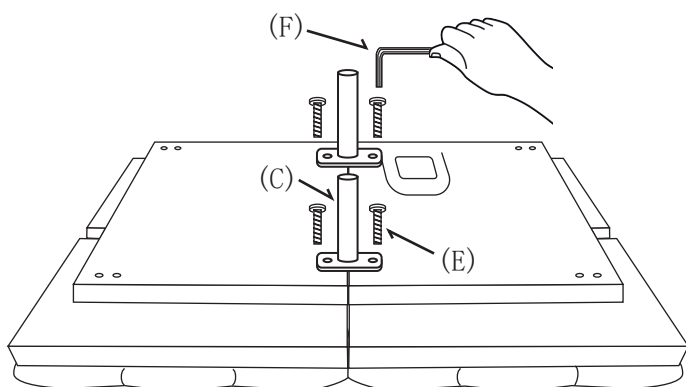

Step 3:

Flip the Futon over so it is supported on its legs, the assembly is complete.

NOTE: Leaving the sofa for 24 hours after unpacking to help the cushions to rebound to its original shape.

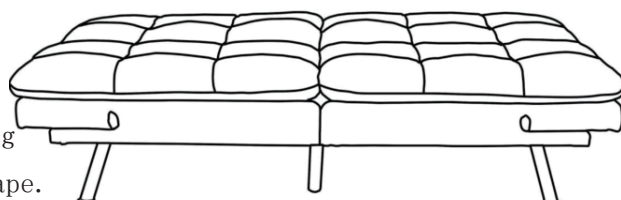

INSTRUCTIONS FOR USE

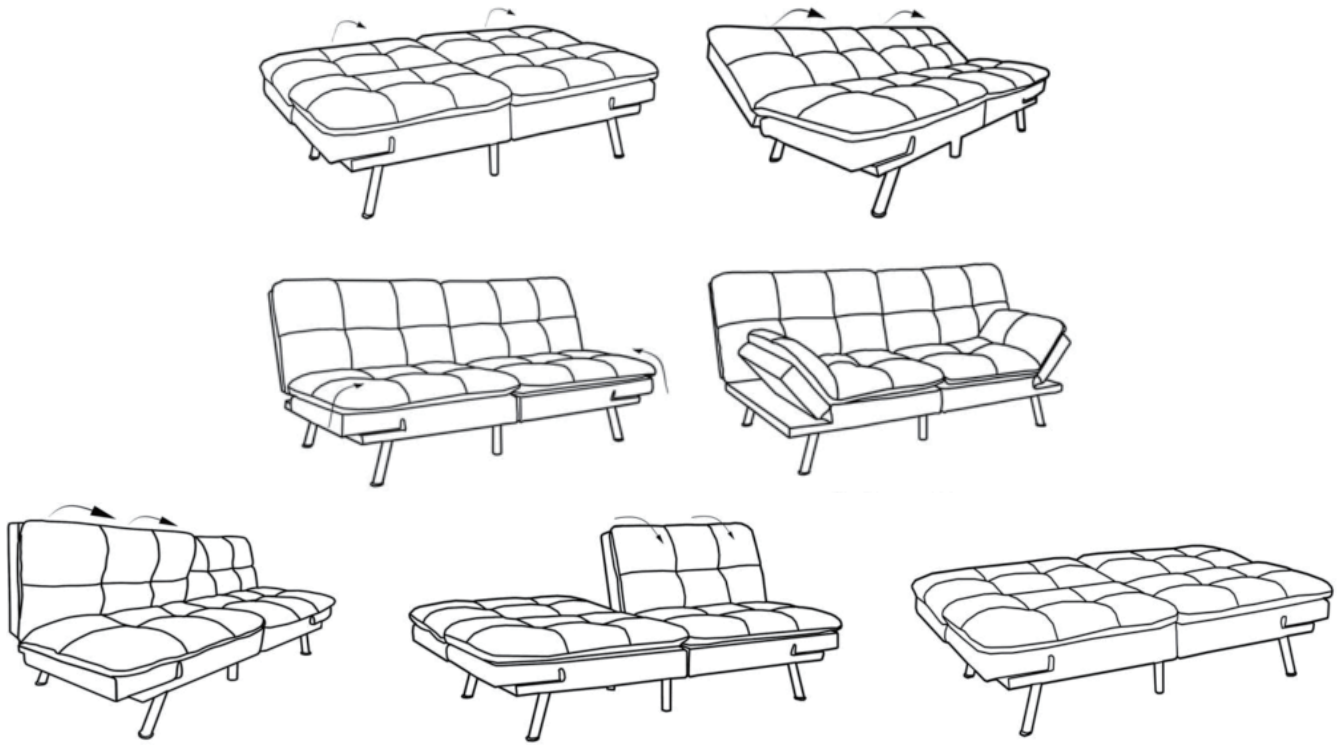

2 YEARS WARRANTY

service@vipclub.app

Within 30 days of item arrival, please register with your order ID to initiate your 2 Years Warranty and Lifetime Support. Any information received will be treated confidentially and only used for warranty activation.

QUESTIONS? CONTACT US:

service@vipclub.app

770-298-8947

If in any case, you are not 100% happy with the item received, would you please contact us first and give us a chance to make it right for you? All of our products are covered by warranty and we will do our best to address any of your concerns. We are dedicated to your 100% satisfaction with your order.