



Liberty Furniture
INDUSTRIES, INC

LIBERTY FURNITURE

ASSEMBLY INSTRUCTION

ITEM#: 779/879/979 - HO147/HO135

DESCRIPTION : BUCHING LATERAL FILE CABINET
BUCHING LATERAL FILE HUTCH

Thank you for purchasing this quality product. Be sure to check all packing material carefully for small Hardware which may have come loose inside the carton during shipment. Identify and count all Hardware and compare with the Hardware List Below.

Parts List		
No.	Description	Qty.
①	Cabinet	1 Pc
②	Hutch	1 Pc
③	Metal Bar	2 Pcs
④	Key	2 Set

Assembly Hardware Pack			
⑤			
No.	Description	Hardware	Qty.
①	JCBC Screw Ø1/4" x 20mm		4 Pcs
②	Spring Washer Ø1/4"		4 Pcs
③	Flat Washer Ø1/4" x 19mm		4 Pcs
④	Allen Key M4		1 Pc
⑤	Bracket		2 Pcs
⑥	Tipping Restraint		1 Set

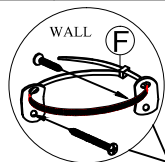

STEP 2

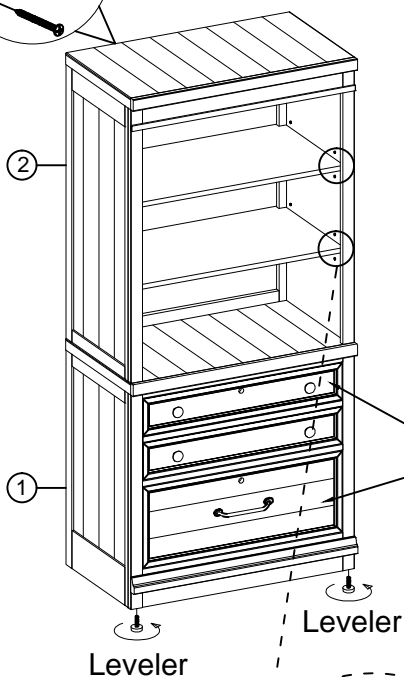

STEP 4

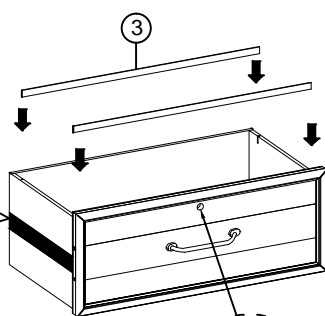

Key

STEP 3

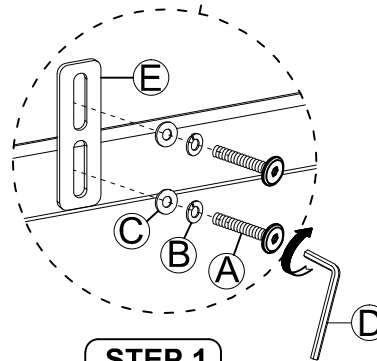
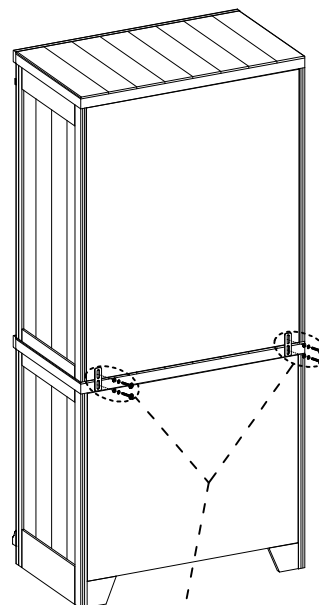
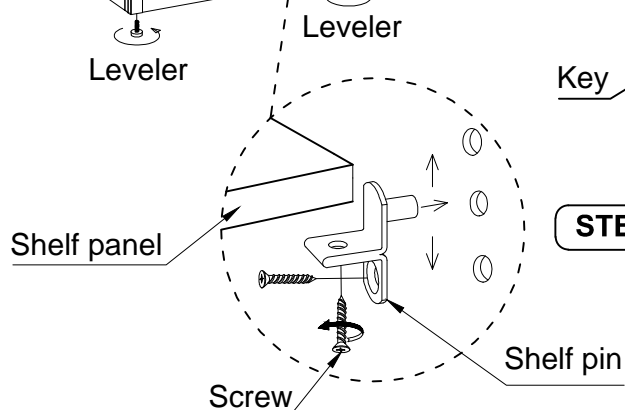

STEP 1



Liberty Furniture
INDUSTRIES, INC

LIBERTY FURNITURE

ASSEMBLY INSTRUCTION

ITEM#: 779/879/979 - HO147/HO135

DESCRIPTION : BUCHING LATERAL FILE CABINET
BUCHING LATERAL FILE HUTCH

DRAWER REMOVAL GUIDANCE

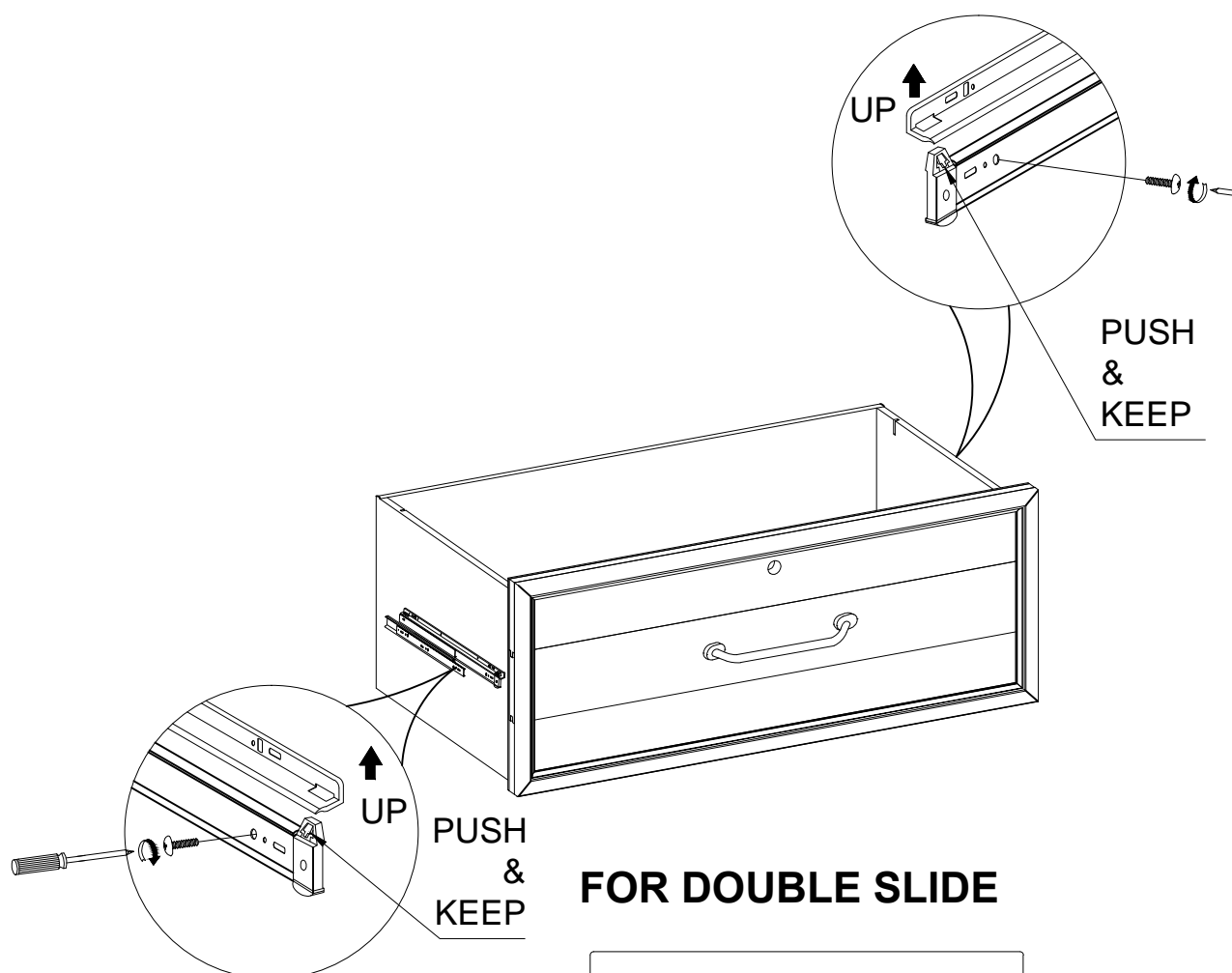

FOR DOUBLE SLIDE

Remove the screw on the bottom
slide away push the plastic button
inside then pull the drawer out