

User's Manual

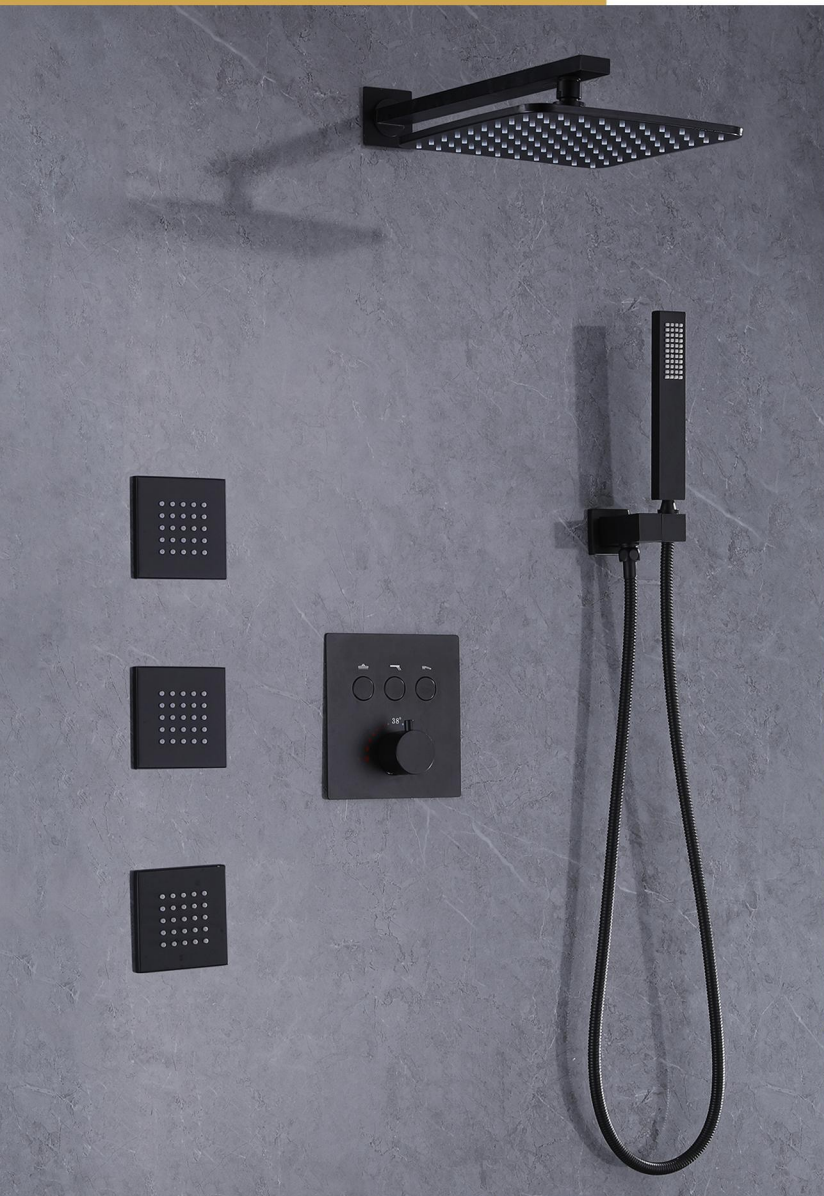

Installation Manual

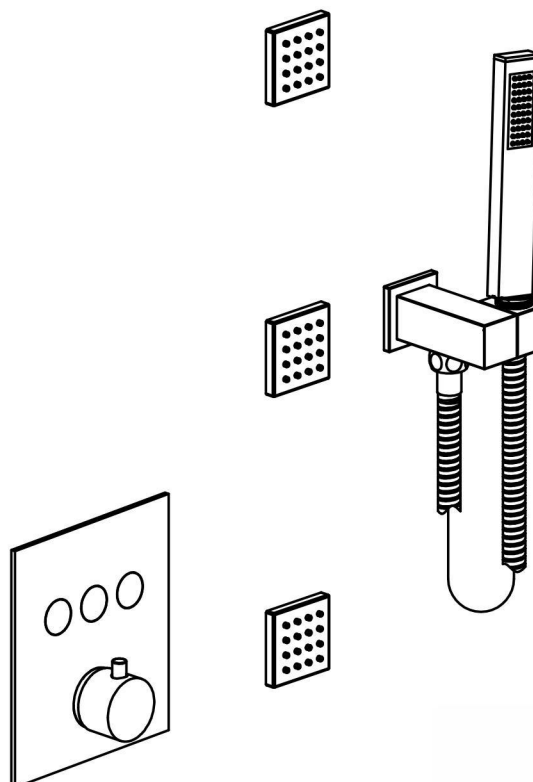
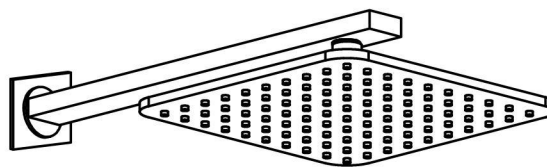

<div style="text-align: center;">IAPMO RESEARCH AND TESTING, INC.</div> <div style="text-align: center;">5001 East Philadelphia Street, Ontario, California 91761-2816 • USA • 909-472-4100 • 909-472-4100 • www.iapmo.org</div>		
<div style="text-align: center;"></div>	<div style="text-align: center;"></div>	<div style="text-align: center;"></div>
<div style="text-align: left; margin-left: 40px;"> C</div> <div style="text-align: center;"><h1>CERTIFICATE OF LISTING</h1></div>		
<p><small>IAPMO Research and Testing, Inc., in a product certification early trade mark and requests samples from the applicant's stock from the market of a continuous or semi-continuous nature to test and certify under contract. This activity is required every twelve consecutive months of the supplier's factory and warehouses, as well as the acceptance of the Supplier's Quality Assurance System. This listing is dependent on the conditions set forth in the Characteristics Name card and is subject to change without notice. The listing is valid only if the product conforms to the published acceptance by IAPMO Research and Testing, Inc.</small></p>		
This certificate is not evidence of current listing. To verify listing status, visit the IAPMO R&T Product Listing Directory at pid.iapmo.org		
Effective Date:	November 2019	Valid After: November 2024
Product:	Fiberglass Fitting Fittings	File No. 10033
Issued To:	Aqua Delivery Co., Ltd 1315-13th Aoi Road International Convention Sanitary City, S2800 Foshan, China	
Identification:	Fiberglass supply fittings complying with this Standard shall be marked with the manufacturer's recognized name, trademark, or other mark or, in the case of private labeling, the name, trademark or other mark of the customer for whom the fitting was manufactured. The marking shall be accomplished by use of a permanent mark or by placing a permanent label on the product. Packagings on plumbing supply fittings shall be visible after installation.	
	Single-handle, single-control, and automatic temperature mixing bath and shower valves shall have identifiable temperature control settings in which the settings are indicated by words ("cold," "warm," "hot," etc.), by numbers, or graphically.	
	Packagings shall be marked with the manufacturer's name, trademark, or other mark as well as the model number, or, in the case of private	
<div style="text-align: right;"> Chairman, Product Certification Group</div>		<div style="text-align: right;"> CEO, The IAPMO Group</div>
<div style="text-align: right;"></div>		
<p><small>This listing period is based upon the last date of the month indicated on the Effective Date until First Audit Dates occur. Any change in material, manufacturing process, handling or design without notice that violates the approval of the Product Certification Committee, or any violation of non-compliance with applicable codes and standards or of another jurisdiction, may be deemed sufficient cause for termination of this listing. Periodic re-evaluation by the IAPMO Research and Testing, Inc. is required. In addition, the performance of IAPMO Research and Testing, Inc. Any alteration of this contract must be granted in accordance with this document. This document shall be reproduced as-is only.</small></p>		

IAPMO RESEARCH AND TESTING, INC.
5001 East Philadelphia Street, Ontario, California 91761-2816 • USA • 909-472-4104 • 909-472-4244 • www.iapmorg.com

C 

CERTIFICATE OF LISTING

IAPMO Research and Testing, Inc. is a product certification body and shall not require samples taken for a supplier's stock from the number of a certificate of listing. It is hereby acknowledged that this listing is not a warranty, approval, or endorsement of the quality, performance, or safety of the product or the product's history and performance as well as the equipment of the supplier's facility. Listing is subject to the conditions set forth in the applicable standards and shall be subject to periodic re-evaluation, or any modification, or suspension or termination by IAPMO Research and Testing, Inc. at the product manufacturer's expense by adhering to IAPMO's procedures.

This certificate is not evidence of current listing. To verify listing status, visit the IAPMO RPT Product Listing Directory at pid.iapmo.org

Effective Date: March 2019

Valid After: March 2024

Product: Plumbing Fixture Fittings - Components

File No. NCR-9703

Issued To: Nibbelo Washi Castings Technology Co., Ltd.
Xiaohu Street, Chuzhou
Fenghuo, NINGBO 315139
China

Identification: Each fitting component will bear permanent legible markings to identify the manufacturer. This marking shall be the trade name, trademark, or other mark known to identify the manufacturer. The product shall also bear all other markings required by the standard. The marking shall be applied so as to be visible after installation. The product or packaging shall also bear the UPC® certification mark along with the term "COMPONENT" above.

Characteristics: Plumbing fixture fitting components to be installed in accordance with the manufacturer's instructions and the requirements of the latest edition of the Uniform Plumbing Code.

Products listed on this certificate have been tested by an IAPMO RPT recognized laboratory. This recognition has been granted based upon the laboratory's compliance to the applicable requirements of ISO/IEC 17025.

Products are in compliance with the following code(s):
Uniform Plumbing Code (UPC®)

Chairman, Product Certification Committee



CEO, The IAPMO Group

This listing is based upon all data on file at the time of testing on the Effective Date and IAPMO Group agrees. Any change in material, manufacturing process, listing or design without having first obtained the approval of IAPMO Research and Testing, Inc. or any written or non-written approval with appropriate test data and/or other substantiation may be deemed subject to revocation at the listing. IAPMO Research and Testing, Inc. reserves the right to conduct random or other periodic re-evaluation of the product. IAPMO Research and Testing, Inc. disclaims any liability for any consequences resulting from the use of this listing. The use of this listing is not a warranty, approval, or endorsement of the quality, performance, or safety of the product or the product's history and performance as well as the equipment of the supplier's facility. Listing is subject to the conditions set forth in the applicable standards and shall be subject to periodic re-evaluation, or any modification, or suspension or termination by IAPMO Research and Testing, Inc. at the product manufacturer's expense by adhering to IAPMO's procedures.

BEFORE INSTALLATION

Usage

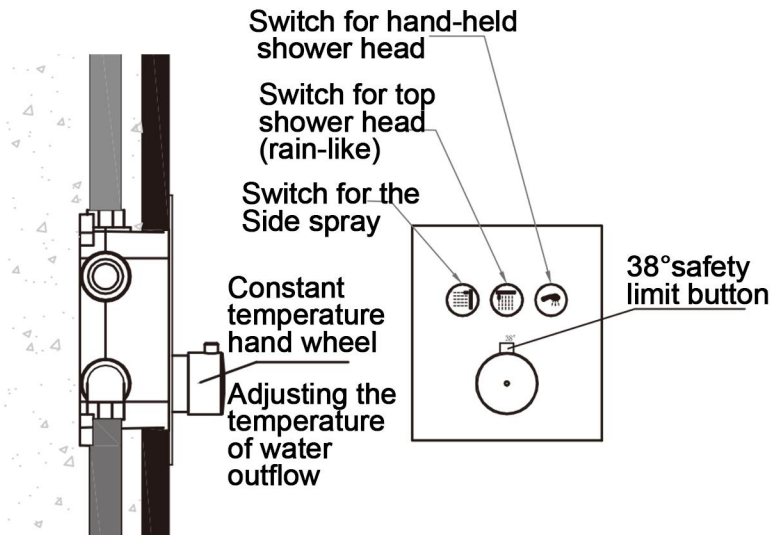
As shown in the right, the water outflow can be turned on or off independently by the switch button, and the water temperature can be adjusted by the constant temperature hand wheel on the right.



Notes

- 1. The valve core of the main body has been tested and adjusted by the manufacturer. Please do not disassemble and install it by yourself.
- 2. Hot water temperature 55-80°C/131-176°F (recommended 65°C/149°F), cold water temperature 5-29°C/41-84.2°F (recommended 15°C/59°F).
- 3. Cold water should be connected to the main body on the side marked with "C", and hot water on the side marked with "H". Revered connection is strictly prohibited. The water pressure at the cold and hot water inlet should not vary too much (pressure difference between the two ends ≤ 20%).
- 4. The working water pressure of the valve core is 0.1-0.5 MPa (including the pressure of cold or hot water). Working water pressure of 0.3 MPa is recommended to use. A pressure reducing valve should be installed on the pipeline when the working water pressure exceeds 0.5 MPa.
- 5. The temperature displayed on the constant temperature handwheel is adjusted under the specific water temperature condition in the factory. The product may be different as the working water temperature changes. The difference of ± 2°C/35.6°F is normal. If there is large difference, it should be adjusted by professional personnel.

Piping Diagram

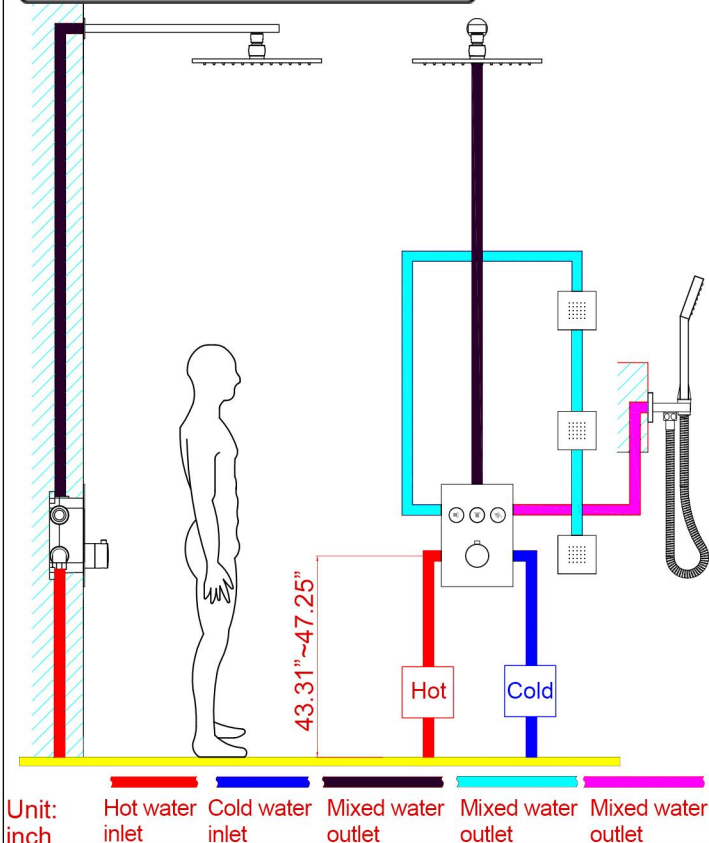

Installation of Main Body
Parts list

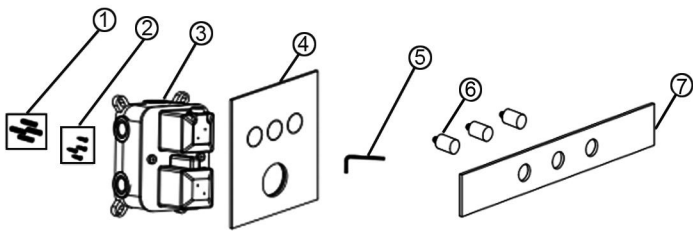

NO.	Name	Quantity
1	Expansible colloidal particle	4
2	Self-tapping screw	4
3	Pre-embedded main body	1
4	Decorative panel	1
5	2.5mm hexagon wrench	1
6	Extension rod	3
7	Locating plate	1

INSTALL THE SHOWER VALVE BODY

This product has been inspected and debugged by the factory to the best condition. Please do not disassemble and assemble it yourself.

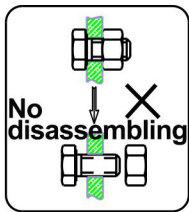

Before installing the product, please be sure to remove sundries and sludge from the water pipe to prevent sundries from blocking the product.



1. According to the basic size of the product (with reference to the figure above), the pre-embedded grooves of main body, inlets of hot and cold water and mixed water outlets and joints should be excavated.

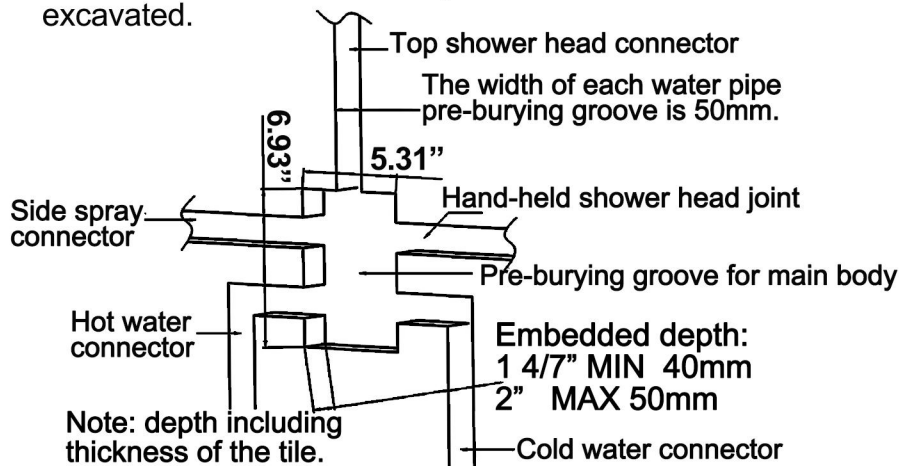

2. Drill four 6-mm holes with percussion drill according to the product size.

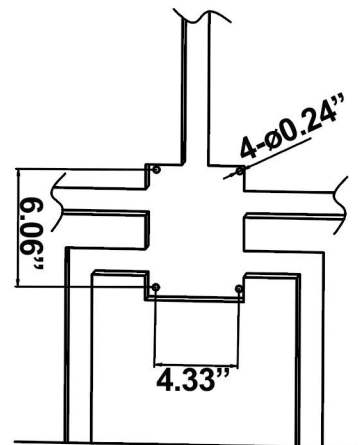

3. Drive 4 expansible colloidal particles into the drilled holes with hammer.

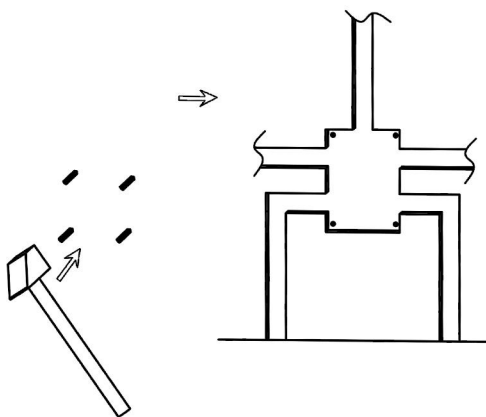

4. Each pipe should be linked and connected to water to confirm there is no leakage.

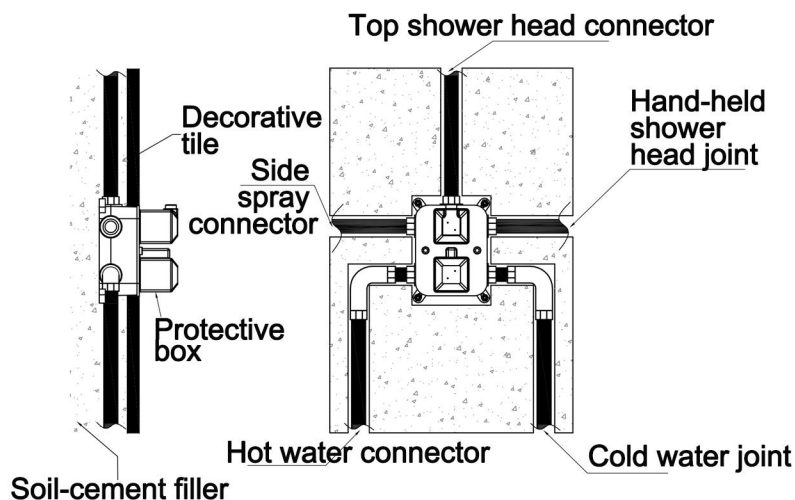

5. Adjust the pre-embedded main body to the horizontal line and fix the main body on the wall with four self-tapping screw and a cross screwdriver. Seal the pipeline with cement filler.

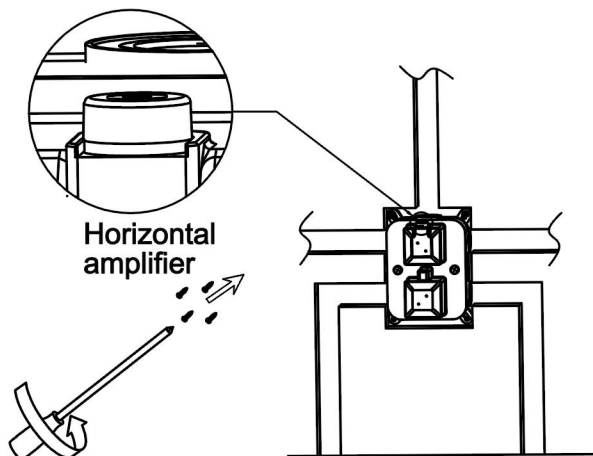

6. Loosen the two M5 screws on the sheath counterclockwise with a cross screwdriver and remove the sheath.

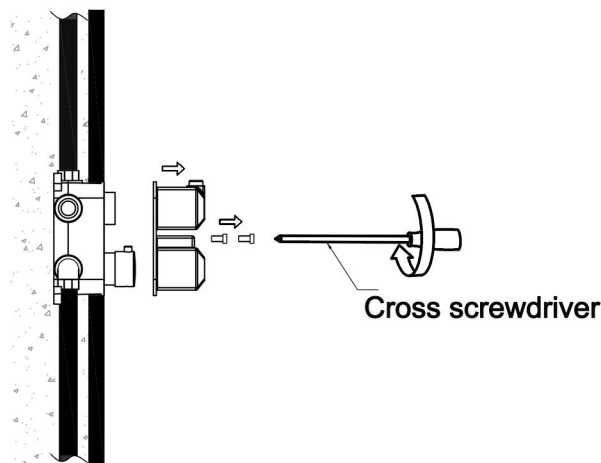

INSTALL THE SHOWER VALVE BODY

7. First, take out the color button of the constant temperature handwheel; then loosen the main body of the handwheel counterclockwise with the 2.5-mm hexagon wrench, and unload it. Do not rotate the constant temperature handwheel when taking it out. Ensure that the button of the constant temperature handwheel is aligned with the 38-degree line on the panel.

8. Tighten the three extension rods on the valve core with button; then put the positioning plate on the surface of wall; cut off the redundant part by cutting machine or the blade along the outer plane of the extension rod of positioning plate; finally, remove the positioning plate again (as shown in the figure).

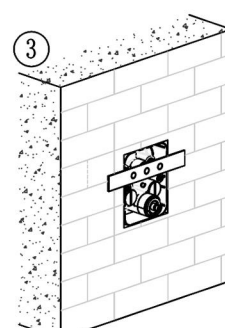
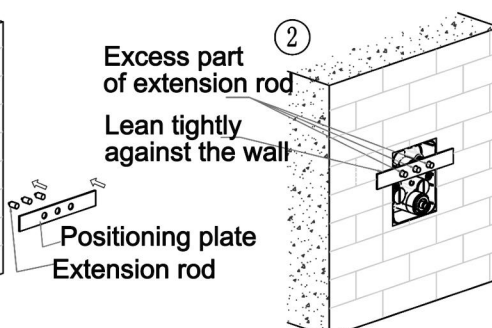
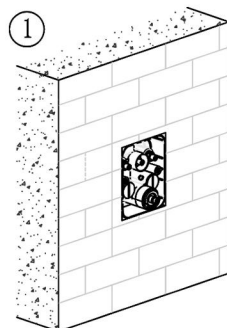
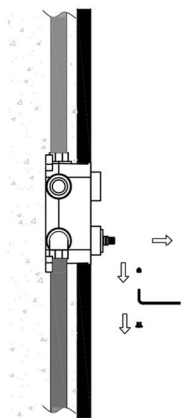

9. Install the panel on the main body in a balanced manner.

10. Install the parts of the constant temperature handwheel on the main body in the opposite direction of unloading. (please ensure that the valve core does not rotate when installing the constant temperature hand wheel and the direction of the button is aligned with the direction of the outlet pipe.)

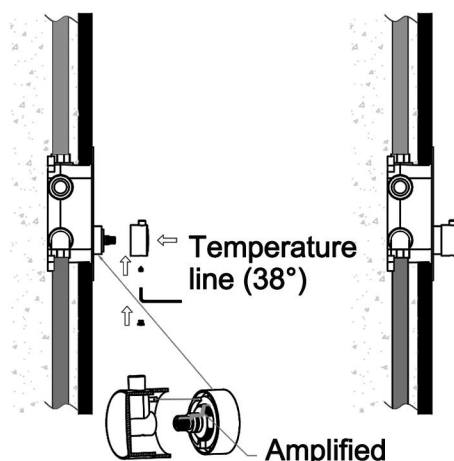
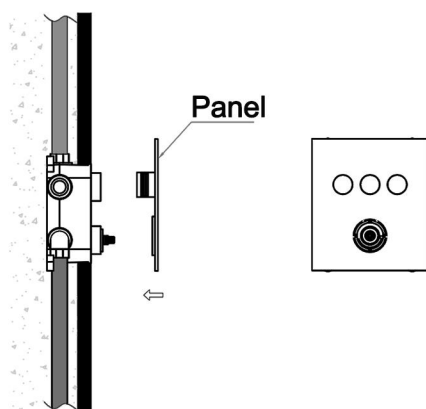

INSTALLATION OF THE HAND SHOWER

1. Wrap the PTFE tape on the 1/2 thread of the stand for shower head.

2. Screw the stand for shower head clockwise on the outlet hole of the water outlet.

3. Connect the water outlet of the stand for shower head with the tube of shower head, and put the hand-held shower head in the stand.

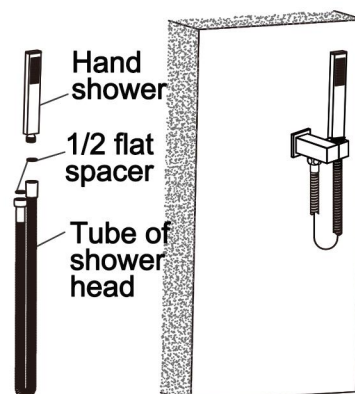
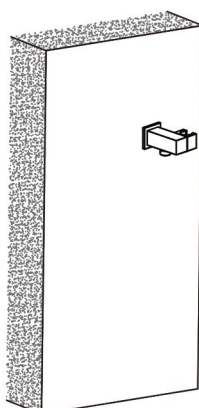
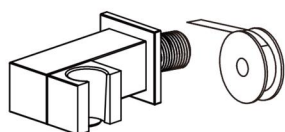

INSTALLATION OF RAIN SHOWER HEAD

1. Wrap the PTFE tape on the 1/2 thread of the rain shower head outlet pipe.

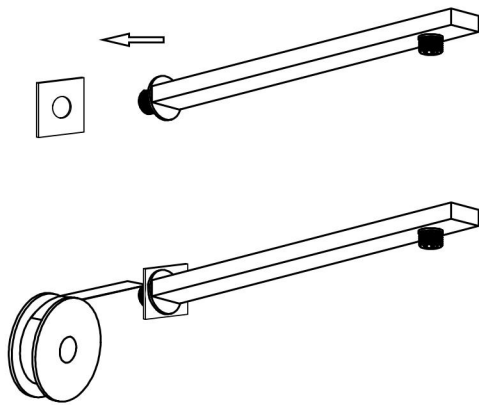

2. Tighten the rain shower head outlet pipe clockwise to the rain shower head outlet hole.

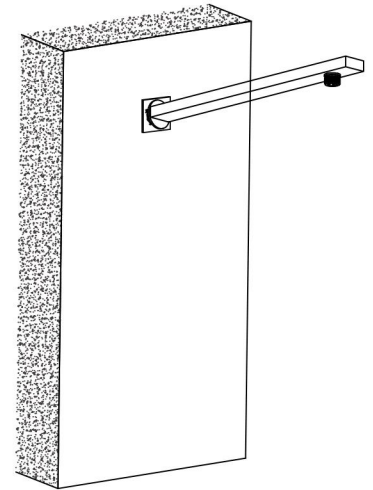

3. Tighten the rain shower head clockwise on the 1/2 thread of the rain shower head outlet pipe.

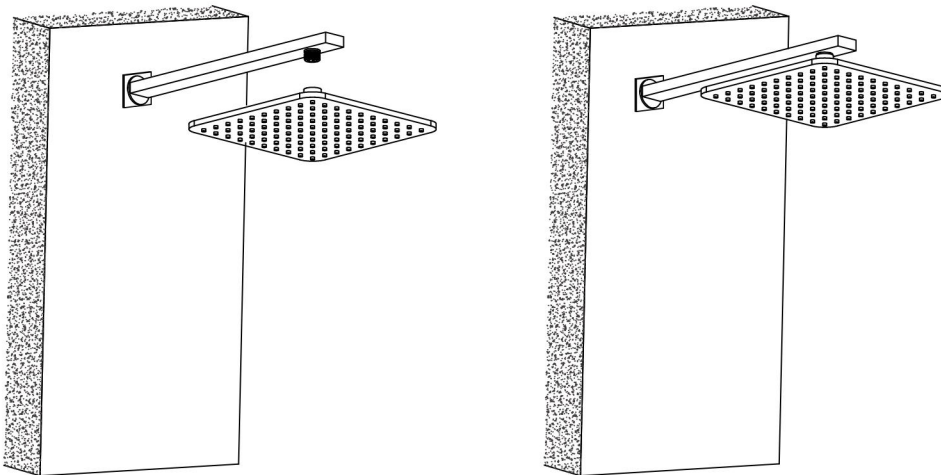

INSTALLATION OF SIDE SPRAY

1. Use a hexagonal wrench to turn counterclockwise to remove the 1/2 threaded joint.

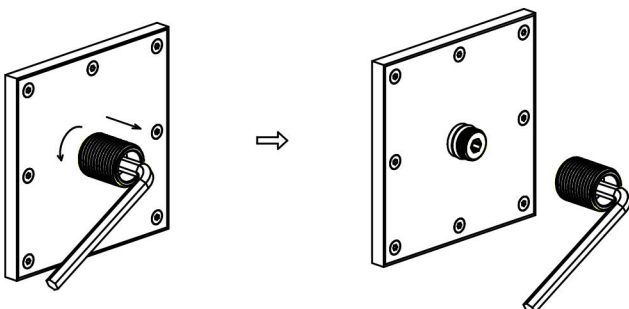

2. Wrap the PTFE tape on the 1/2 threaded joint.

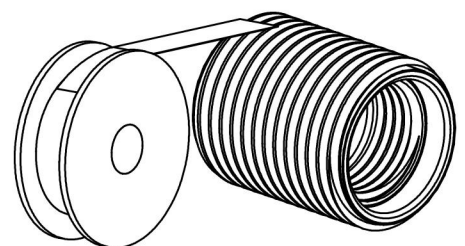

INSTALLATION OF SIDE SPRAY

3. Use a hexagonal wrench to rotate clockwise to install the 1/2 threaded joint on the wall side spray joint. (Note: The 1/2 threaded joint has an internal threaded end facing outward).

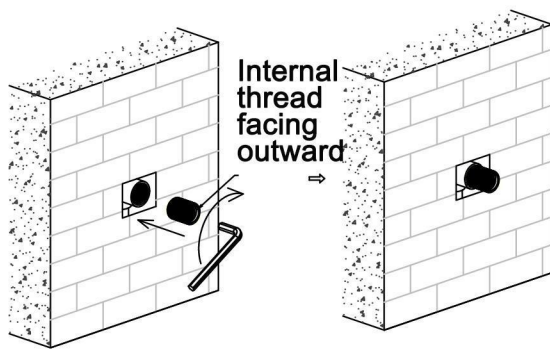

4. Rotate the side nozzle clockwise and tighten it on the 1/2 threaded joint.

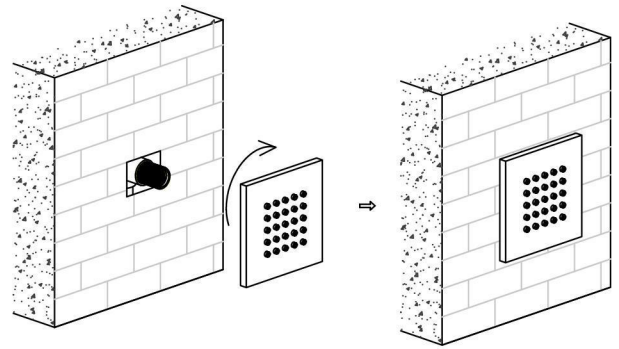

5. Install the remaining side sprinklers according to the previous steps.

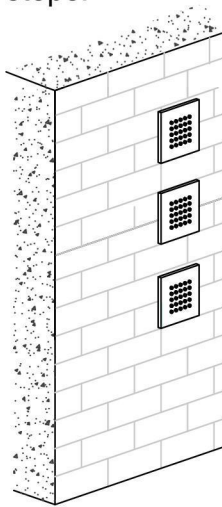

CLEANING CARE

1. To keep the surface of the product clean and bright, please wash it frequently:

- A. Rinse with water and dry with soft cotton cloth;
- B. Do not use abrasive detergent, emery cloth and sandpaper;
- C. Do not use any acid cleaner, polish, soap, coarse detergent, abrasive polish.

2. When the water outflow is reduced or the temperature is difficult to adjust, please follow the following steps to remove the impurities on the filter screen: (as shown above)

- A. Disassemble the inlet parts on both sides of the main body with tools;
- B. Brush the impurities attached to the filter screen on the backwater-proof inlet;
- C. Reinstall the parts sequentially, and then open the supply of cold and hot water on the body part.

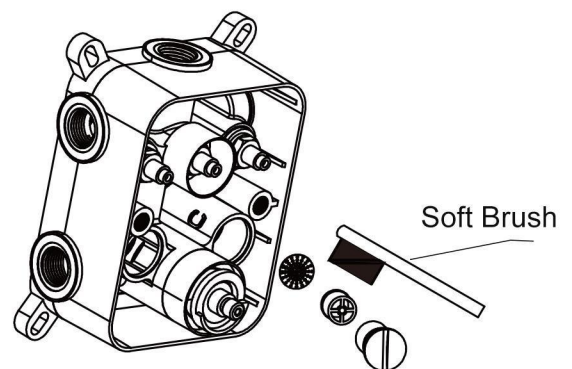

Product size

