

# Low Loft Bed with Ladder

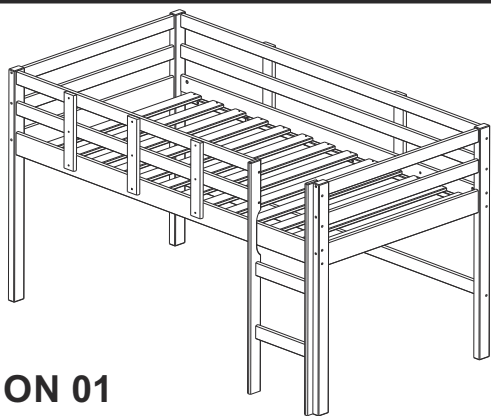

**OPTION 01**

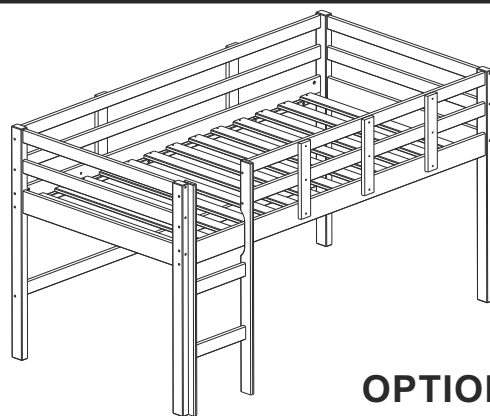

**OPTION 02**

## Assembly Instructions

Product Dimensions:  
78" L x 43" D x 43.25" H

Please take a moment to read through the entire instruction booklet before assembly to familiarize yourself with this product. Once you feel ready to start, follow the instructions step by step and this should make this process as easy as we could make it for you.

# WARNING CAUTION

## ADULT ASSEMBLY REQUIRED

### CHOKING HAZARD

- This product includes small parts, sharp points and sharp edges in its unassembled state. Keep unassembled parts away from children under 3 years of age, and animals.

### STRANGULATION HAZARD

- Never attach or hang items to any part of the bookcase that is not designed for use with the bookcase; for example, but not limited to hooks, belts, and jump ropes.

### SAFETYWARNINGS

- Follow the information on the warnings appearing on the loft bed end structure and on the carton. Do not remove warning label from bed.
- Do not allow children under 3 years of age to use the bookcase.
- Do not use substitute parts. Contact the manufacturer or dealer for replacement parts.

### FURNITURE TIP-OVER HAZARD

Children have died from furniture tip-over.

To reduce the risk of furniture tip-over:

- ALWAYS install tip-over restraint especially if used by a wall or in the open.
- NEVER put a TV on this product
- NEVER allow children to stand, climb or hang on drawers, doors, or shelves.
- NEVER open more than one drawer at a time.
- ALWAYS place heaviest items in lowest drawers.



### PARENTAL SUPERVISION IS REQUIRED

- This Kids product is intended for child use age 3+.
- Parents or Guardians should supervise use under the intended age specifically regarding children that may have access to it and climb on the unit.
- Do not allow horseplay on, under, or behind the unit and prohibit jumping on the bookcase.
- If used improperly, your bookcase may be pulled over or fall, creating risk of injury or damage. Children should not be permitted to climb or pull on the bookcase.

### USE, MAINTENANCE & ASSEMBLY

- Periodically check and ensure that the components are in their proper position, free from damage, and that all connectors are tight.
- Use on level surfaces only. Assemble on a soft level surface to avoid damage to unit or floor.
- Do not use this item if any components are missing or damaged.
- Do not use substitute parts. Contact the manufacturer or dealer for replacement parts.
- Only clean using damp cloth and mild detergent, do not use bleach or abrasive cleaners.
- Check you have all components and tools listed on page 4
- Do not stand or put weight on this product during assembly, this could cause damage.
- Remove all hardware from the plastic bags and separate them into groups.
- Assemble the item as close to its final position (in the same room) as possible.
- Certain assembly steps may be easier with 2 people.
- Dispose of all packaging carefully and responsibly.
- We do not recommend power screwdrivers. Only use hand screwdrivers to prevent damage to unit.

Enfants morts suite au basculement d'un meuble.

Afin de limiter le risque de basculement de meuble:

- TOUJOURS utiliser les fixations anti-basculement.
- NE JAMAIS installer de TV sur ce produit.
- NE JAMAIS laisser d'enfants se tenir debout sur les tiroirs, portes ou étagères, y grimper ou s'y suspendre.
- NE JAMAIS ouvrir plus d'un tiroir à la fois.
- TOUJOURS placer les choses les plus lourdes dans les tiroirs du bas.

Han muerto niños por el vuelco de muebles.

Para limitar el riesgo de vuelco de los muebles:

- Utilizar SIEMPRE las fijaciones antivuelco que suministran.
- NUNCA instalar un TV sobre este producto.
- NUNCA permitir que los niños se pongan de pie, trepen o se cuelguen de los cajones, puertas o baldas.
- NUNCA abrir más de un cajón a la vez.
- Colocar los objetos más pesados en los cajones inferiores.

# ASSEMBLY AT A GLANCE

Please take a moment to read through the whole instruction booklet before assembly to familiarize yourself with this product. Once you feel ready to start, follow the instructions step by step and this should make this process as easy as we could make it for you.

Due to the number of parts involved assembly can take a few hours so set aside between 2 and 3 hours to assemble this without rushing.

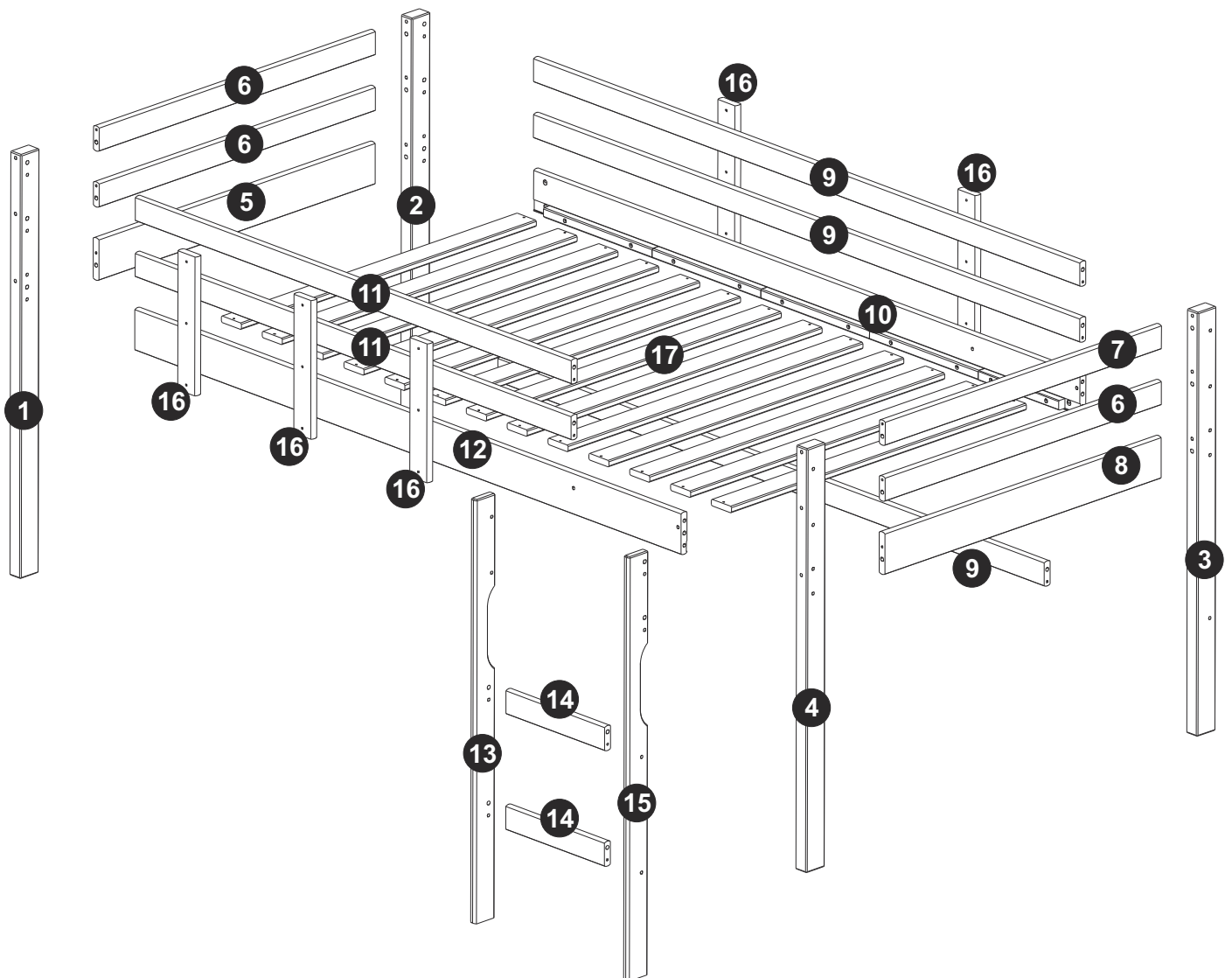

This drawing is to give you an overall idea only of how this assembly will go together and does not replace the assembly instructions.

# COMPONENT PARTS

Please check that you have all the parts listed below

\*Note: follow the setup of  
of Option 1 for ladder right  
configuration or Option 2  
for ladder left configuration.

Each leg is unique.

1. Leg x1
2. Leg x1
3. Leg x1
4. Leg x1
5. Headboard x1
6. End Rails x3
7. End Rails x1
8. Footboard x1
9. No ladder side rails x3
10. Ladder side rails x1
11. Right ladder rail x2
12. Ladder side board x1
13. Left ladder rail x1
14. Ladder rung x2
15. Right ladder rail x1
16. Rail support x5
17. Bed slats x13

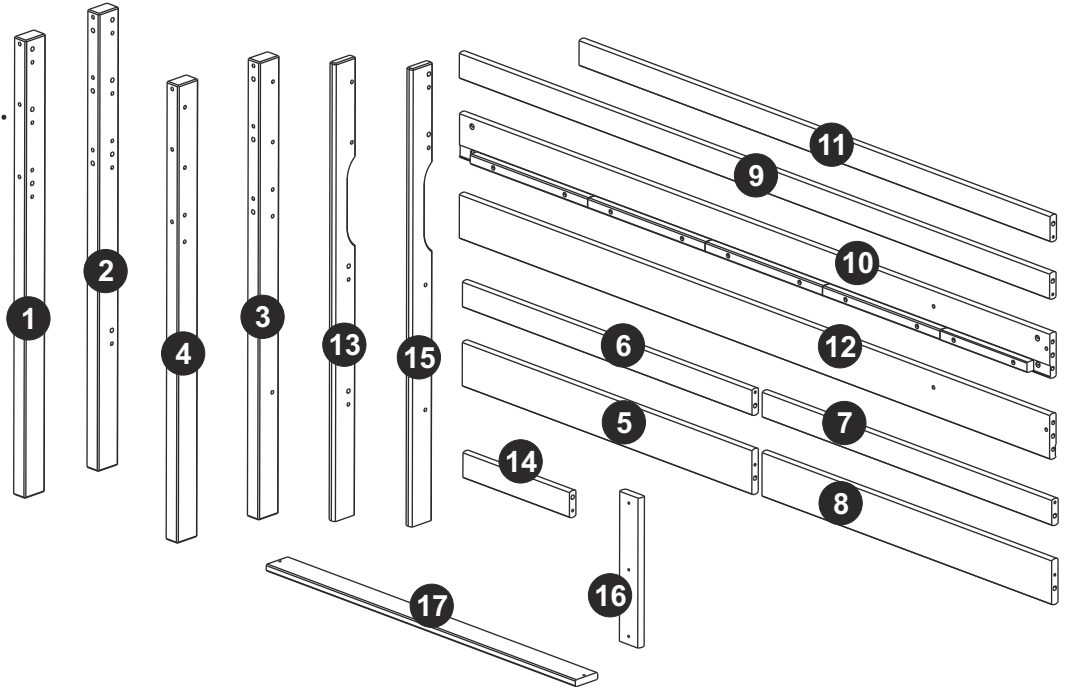

## ASSEMBLY HARDWARE

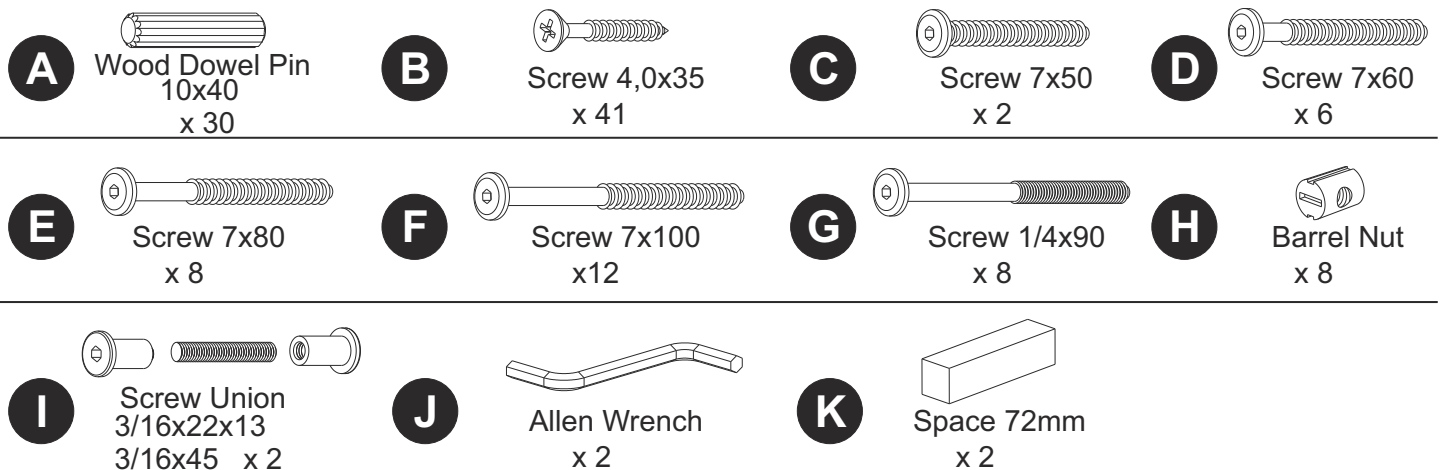

## TOOLS REQUIRED

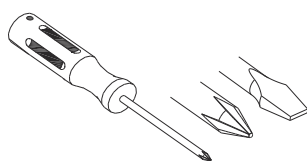

Phillips Screwdriver  
(Medium)

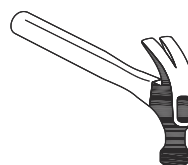

Hammer  
(not included)

# ASSEMBLY INSTRUCTIONS

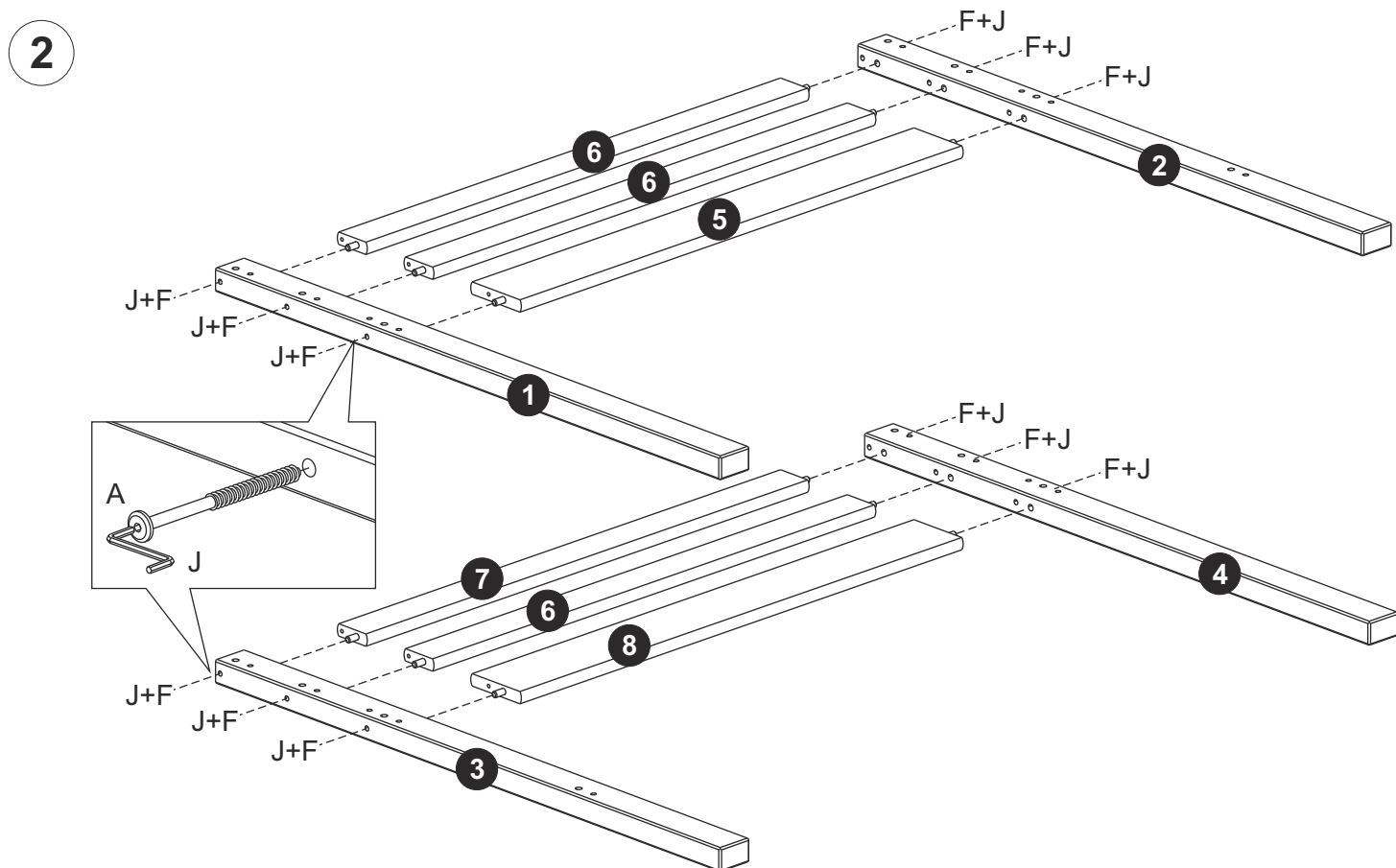
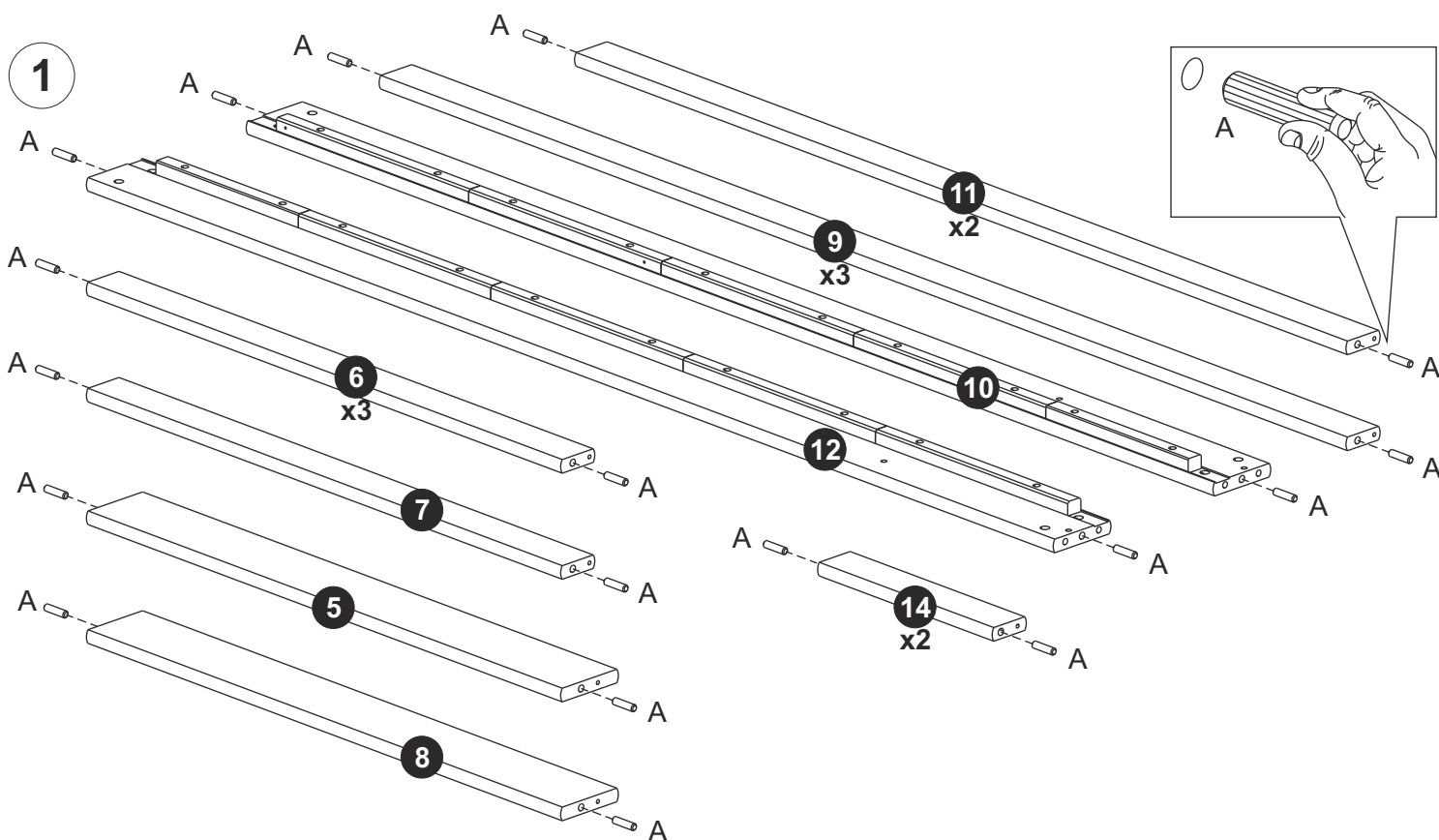

# 3

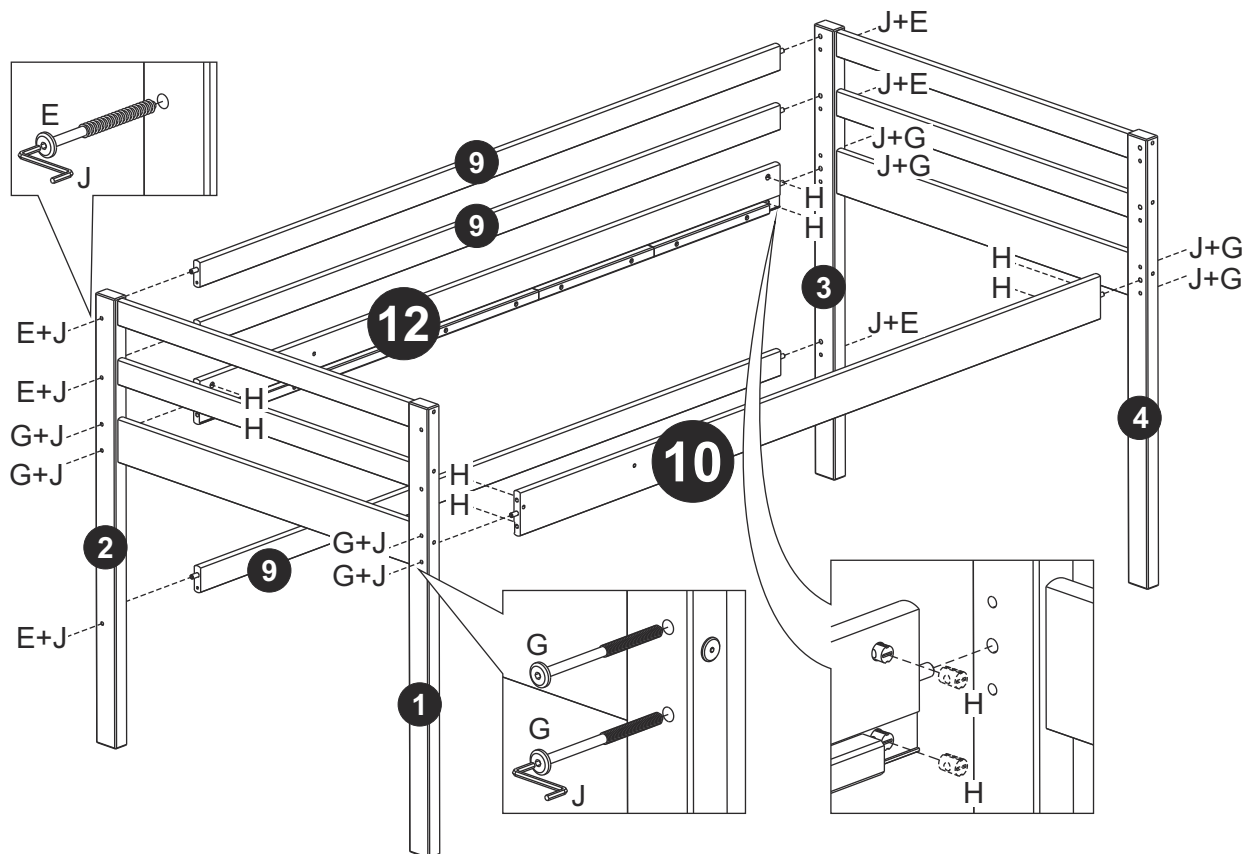

# ASSEMBLY INSTRUCTIONS

## OPTION 01

4

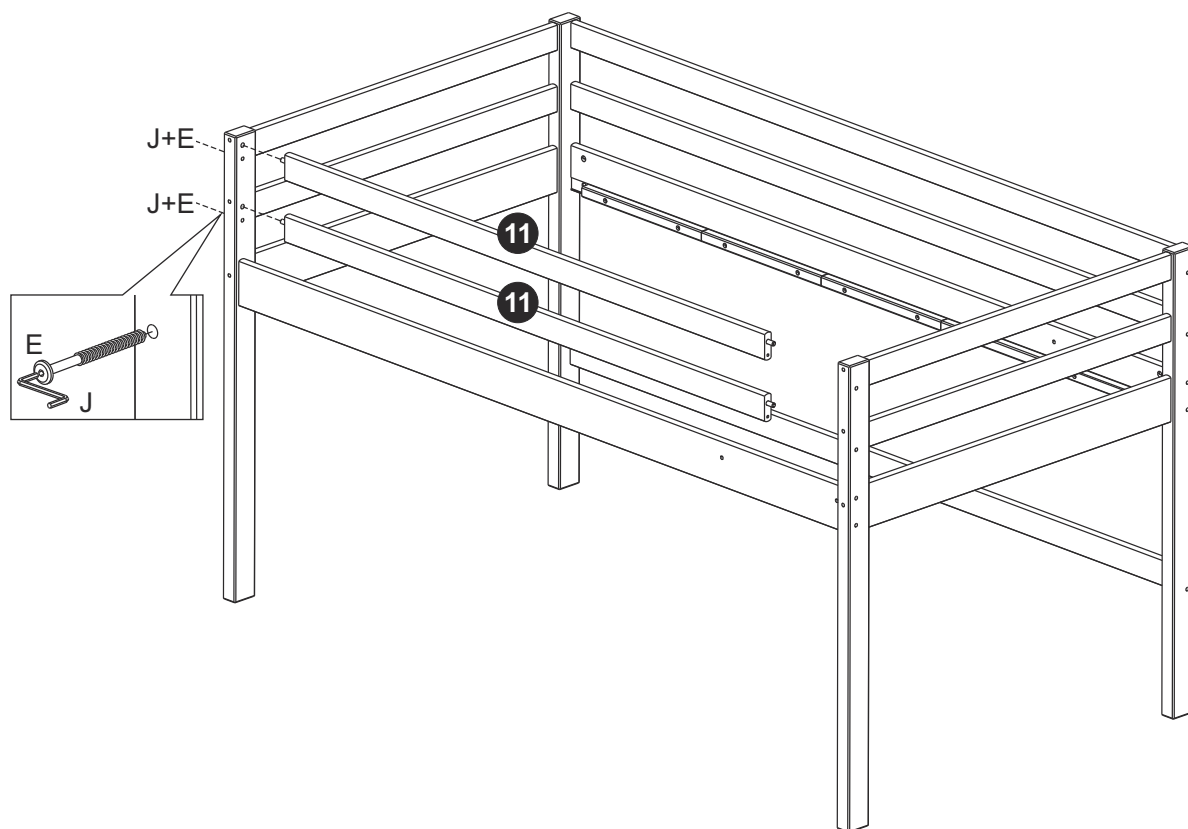

## OPTION 02

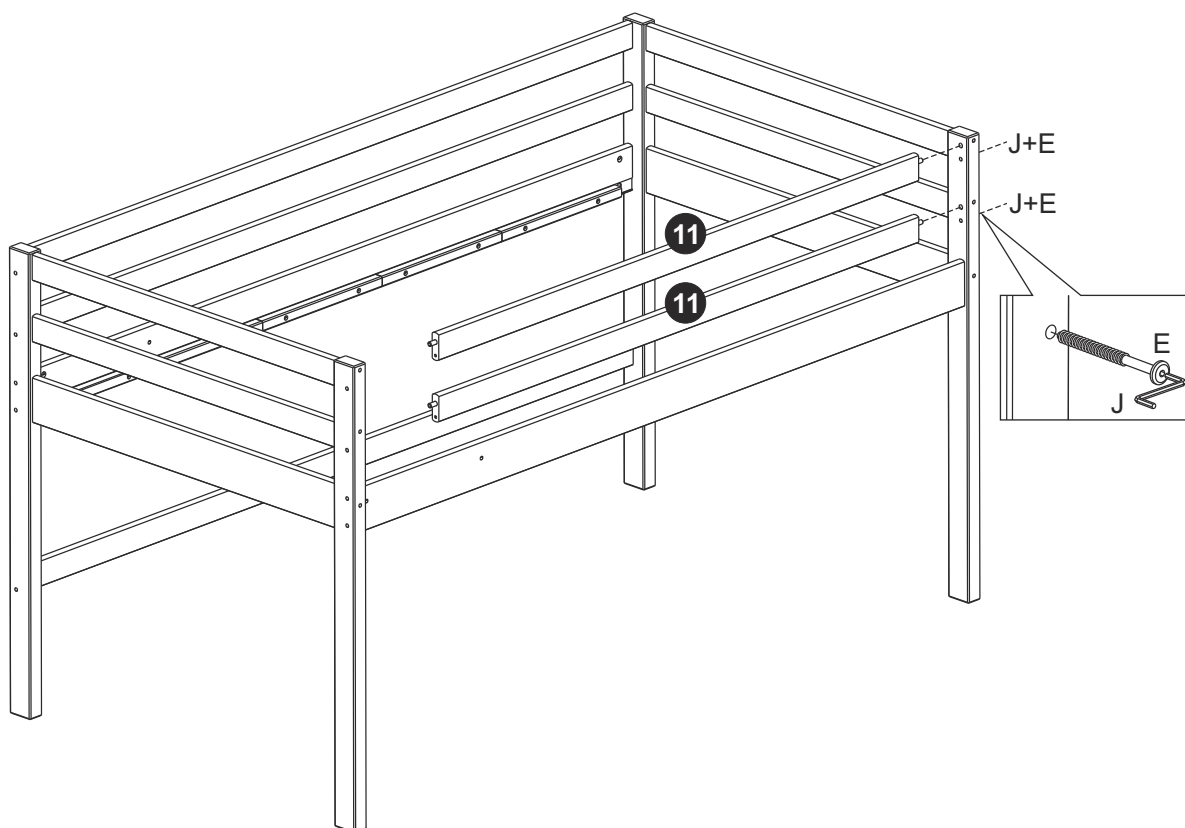

# ASSEMBLY INSTRUCTIONS

5

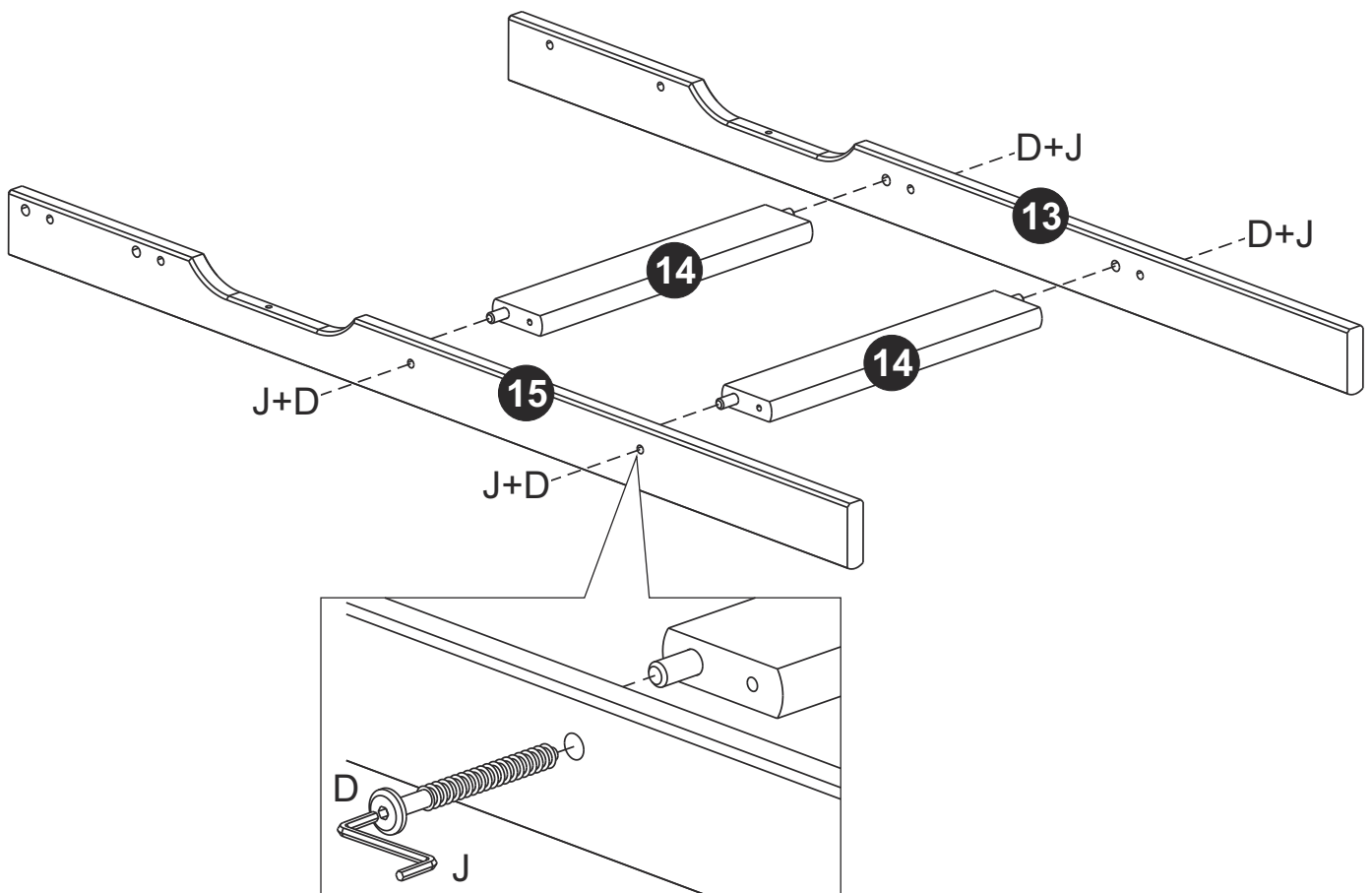

# ASSEMBLY INSTRUCTIONS

## OPTION 01

6

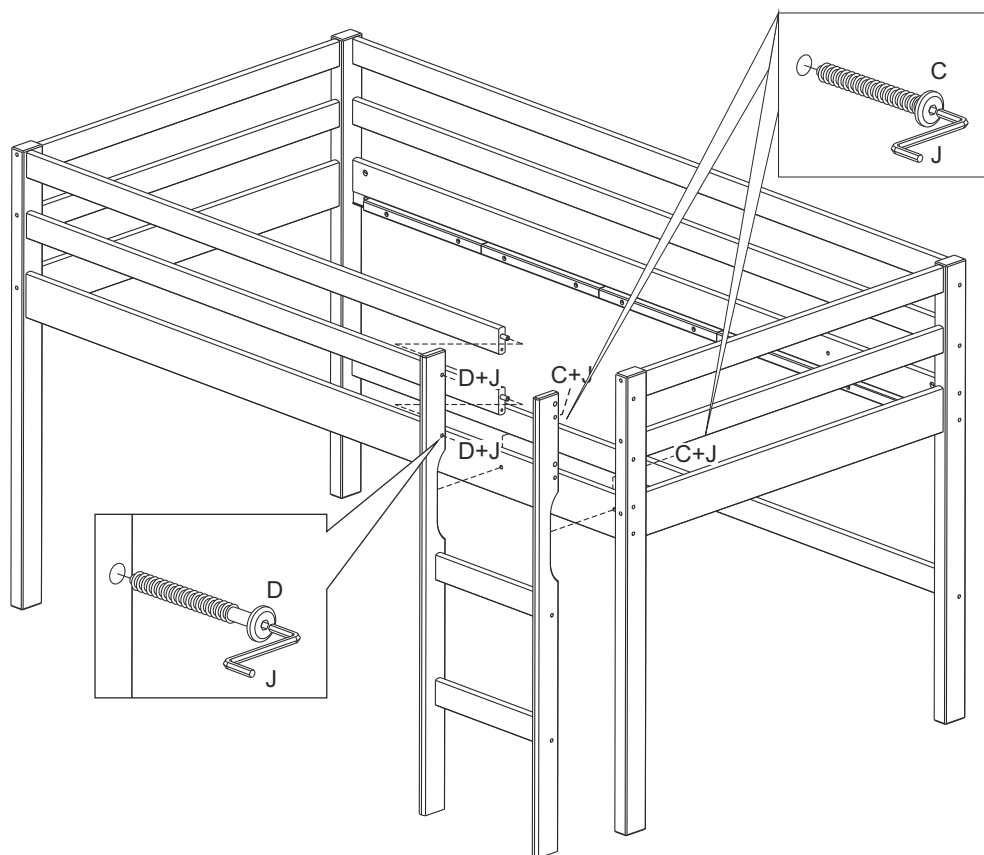

## OPTION 02

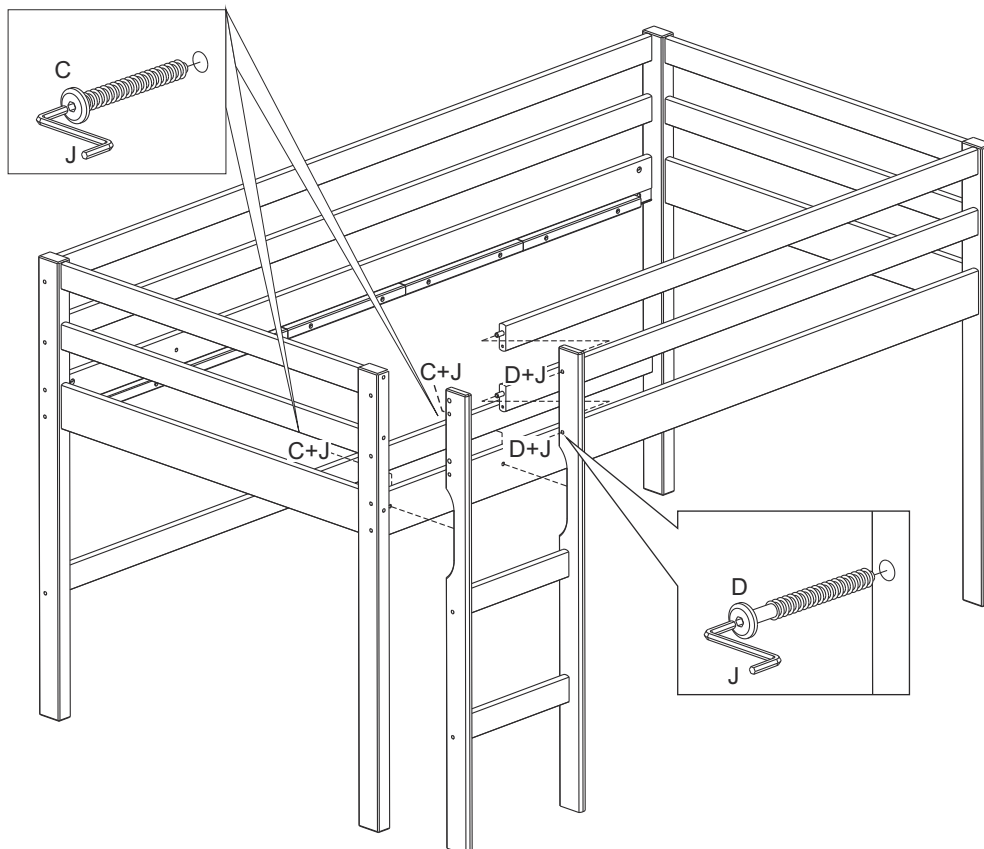

# ASSEMBLY INSTRUCTIONS

## OPTION 01

7

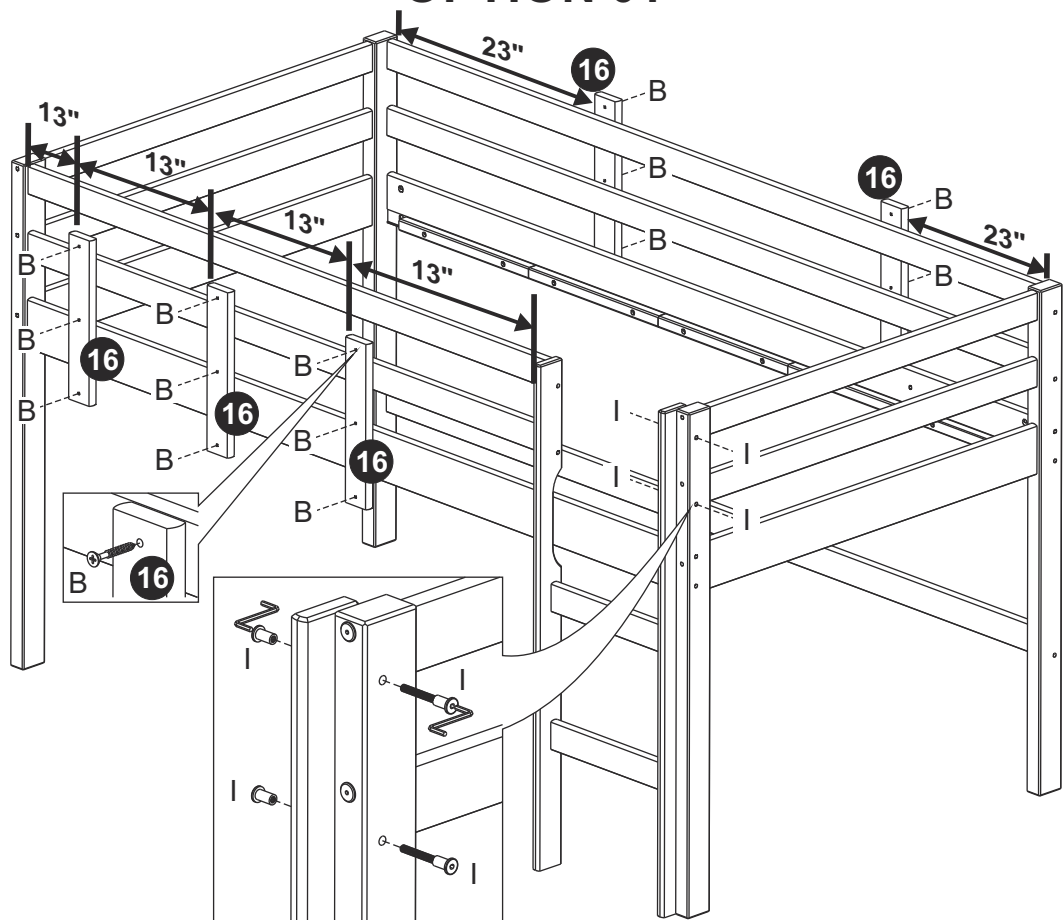

**BED FRAME ASSEMBLY COMPLETE**

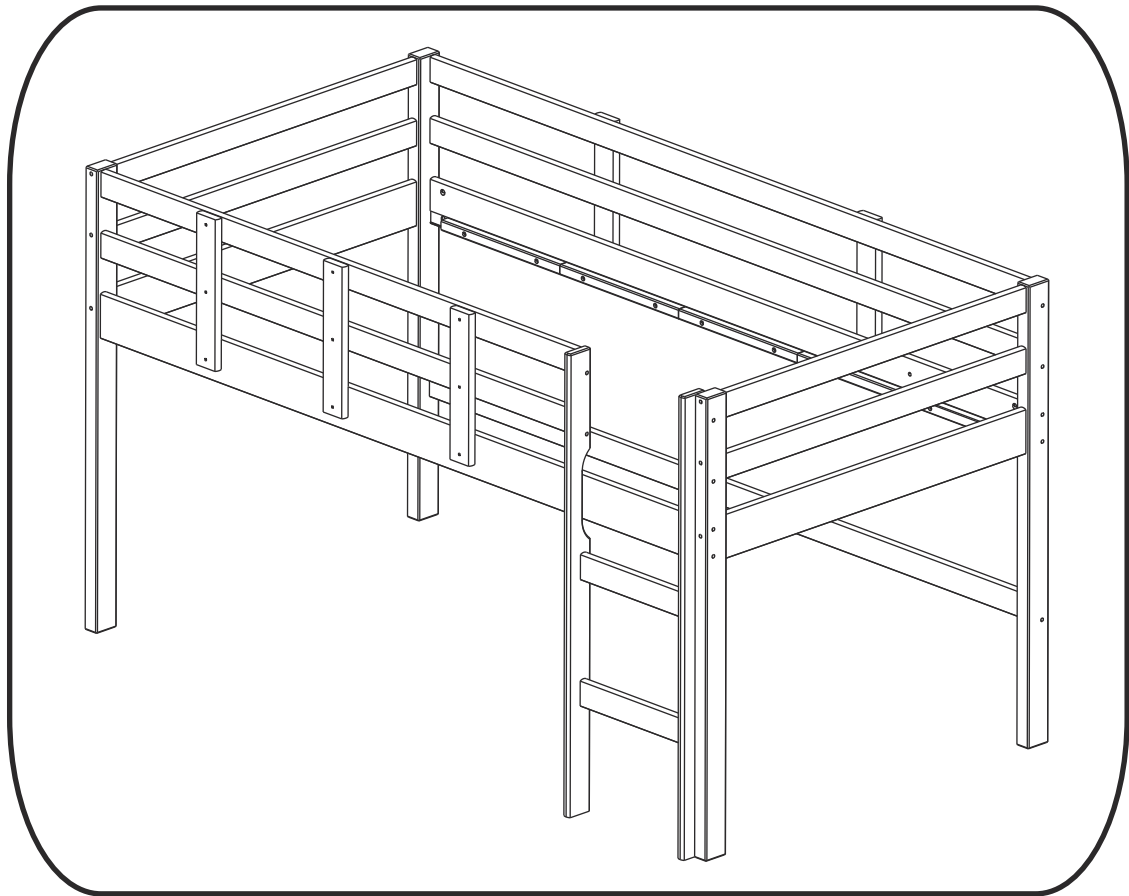

# ASSEMBLY INSTRUCTIONS

## OPTION 02

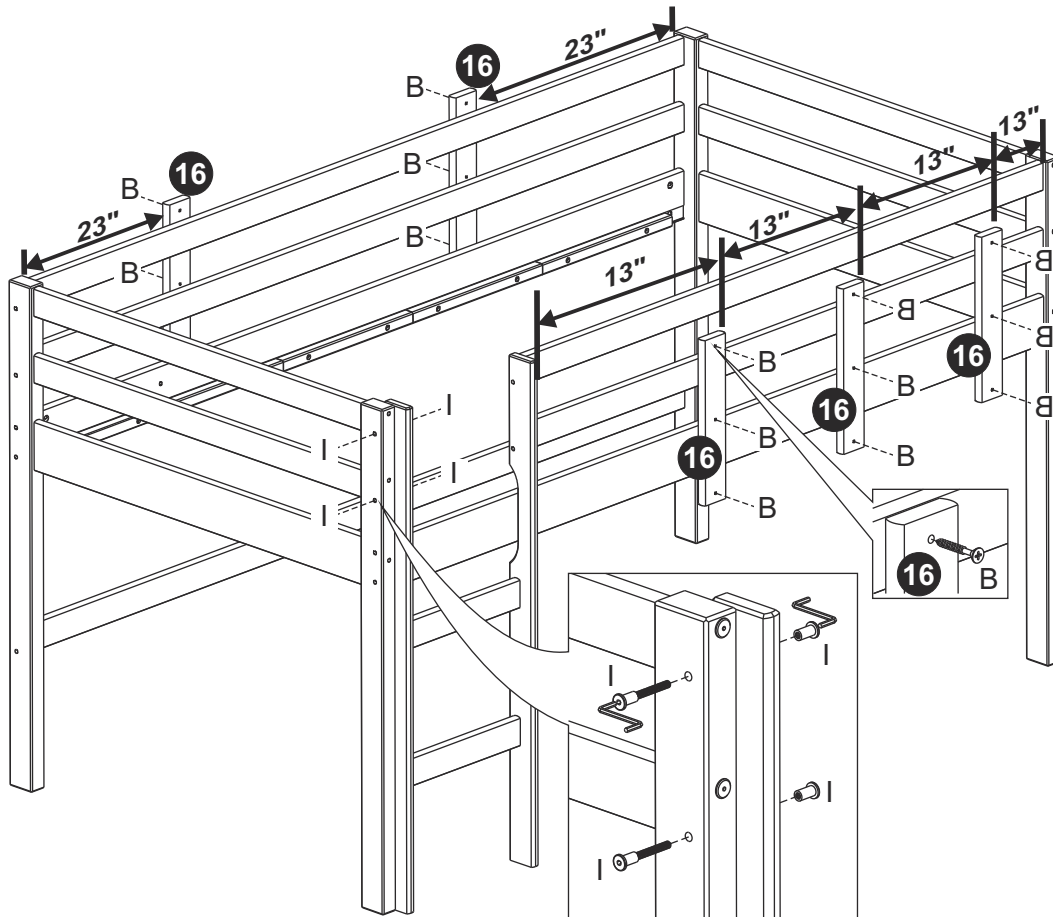

**BED FRAME ASSEMBLY COMPLETE**

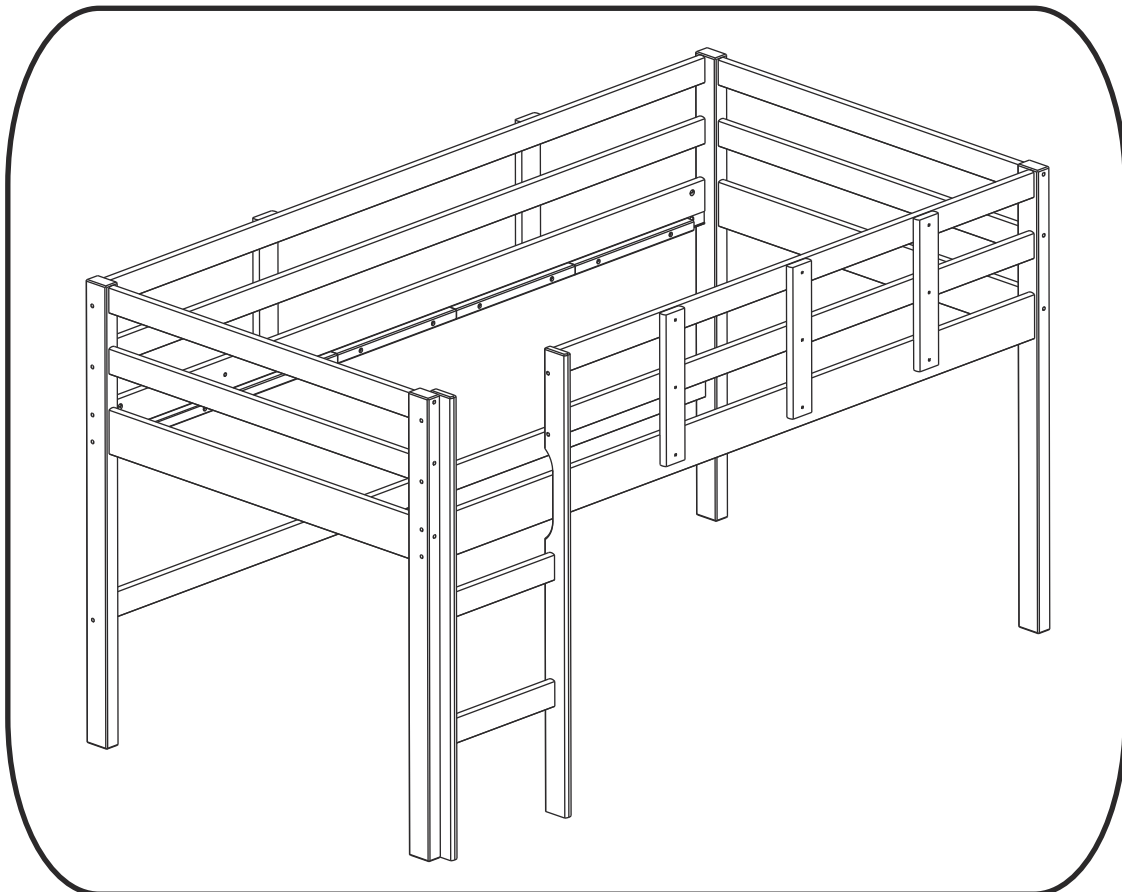

# ASSEMBLY INSTRUCTIONS

## OPTION 01

8

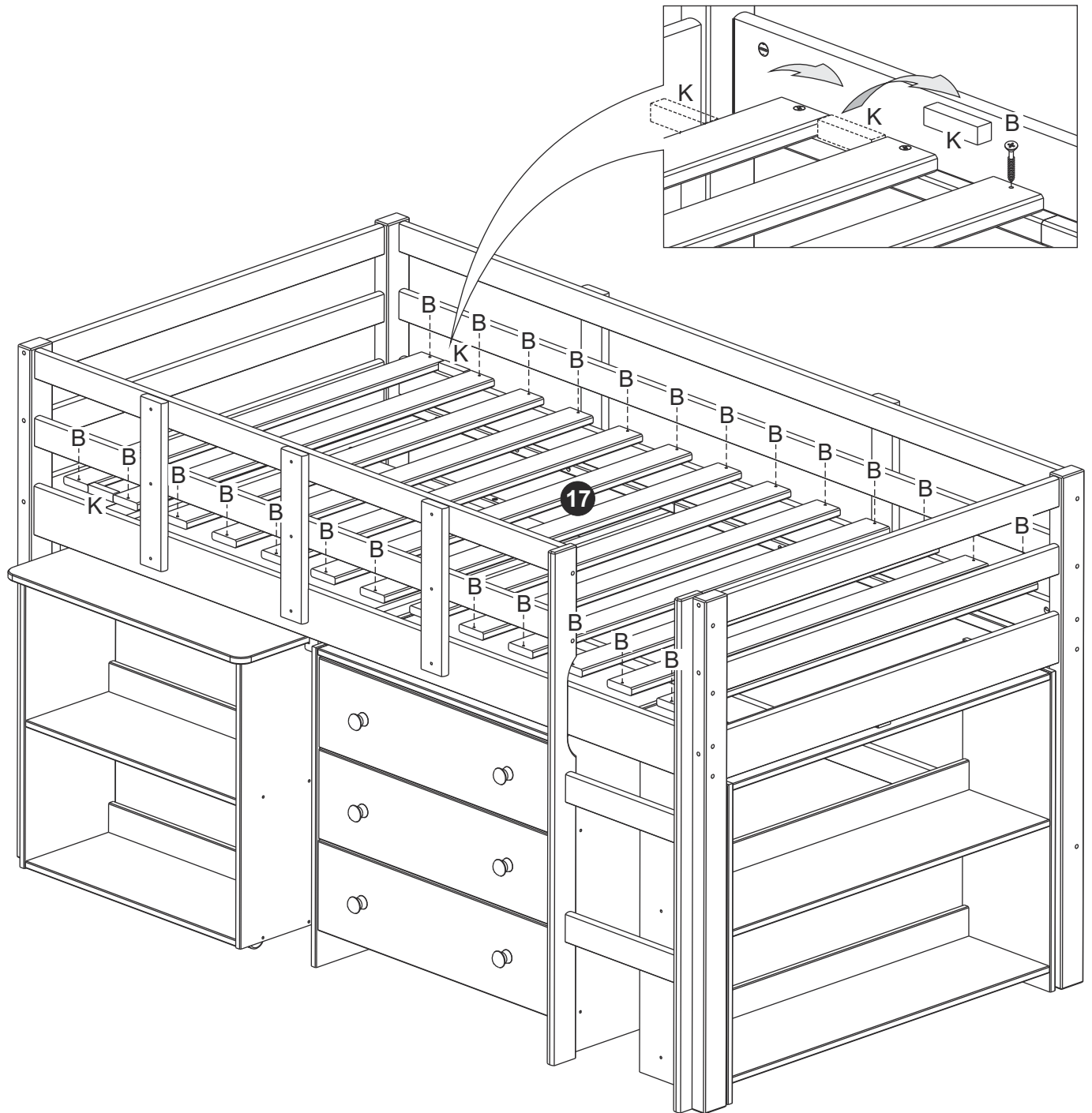

# ASSEMBLY INSTRUCTIONS

## OPTION 02

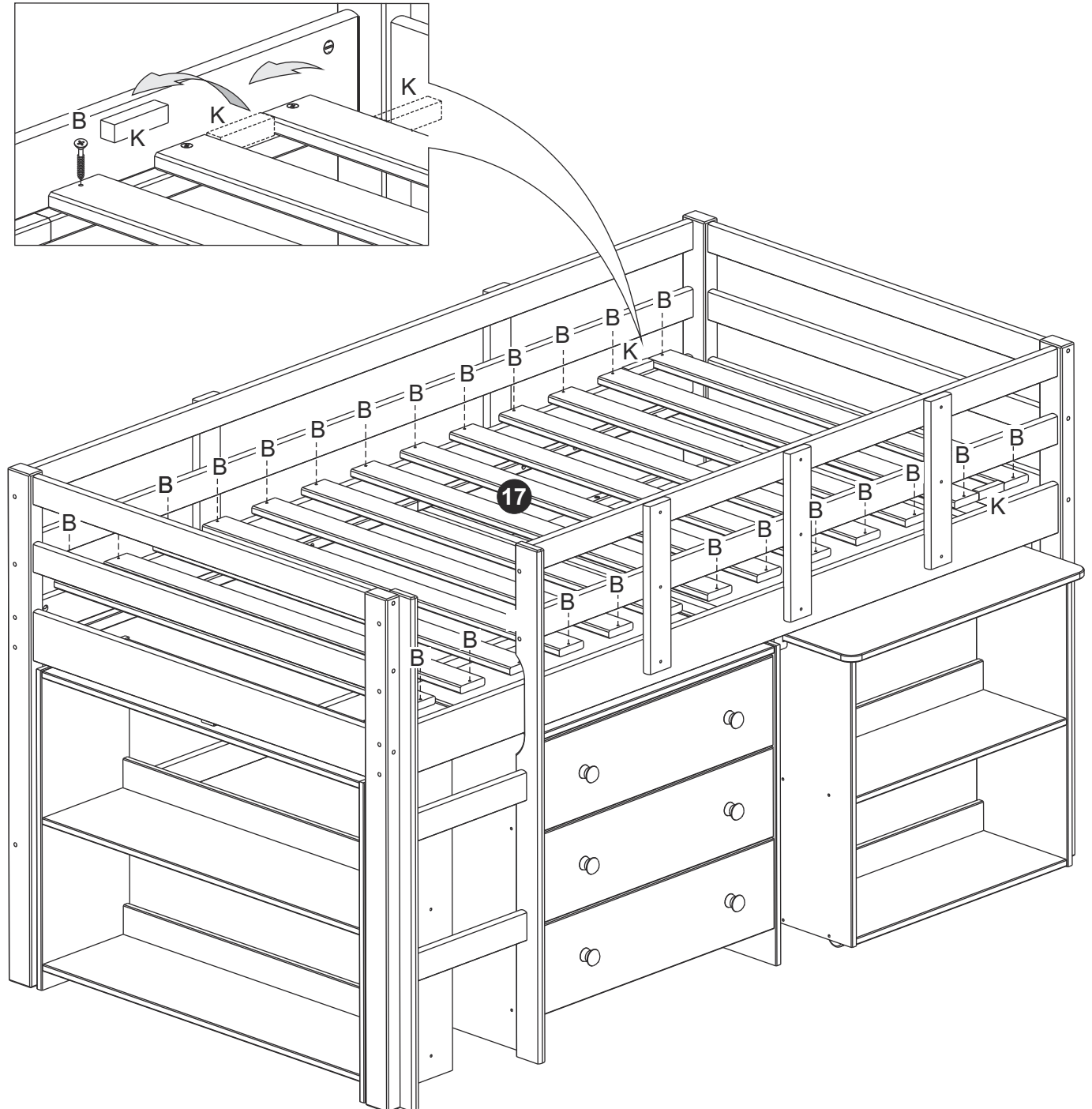

## ASSEMBLY COMPLETE

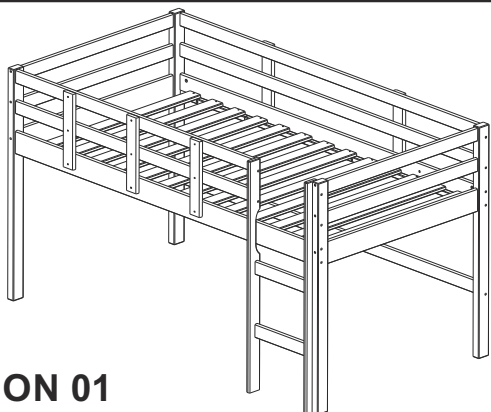

**OPTION 01**

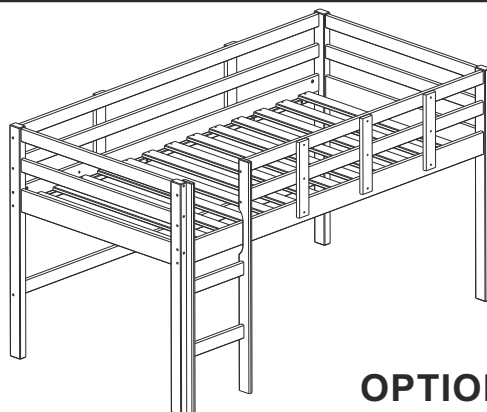

**OPTION 02**

**CONGRATULATIONS, YOUR KIDS  
LOW LOFT BED WITH LADDER IS COMPLETE!**

# Low Loft Bed - 3 Drawer Chest

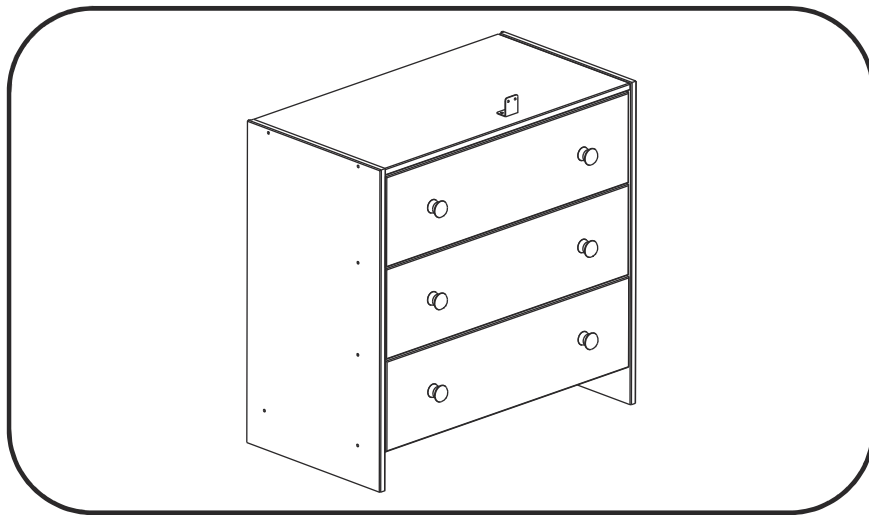

## Assembly Instructions

Product Dimensions:  
28" L x 15" D x 27" H

Please take a moment to read through the entire instruction booklet before assembly to familiarize yourself with this product. Once you feel ready to start, follow the instructions step by step and this should make this process as easy as we could make it for you.

# WARNING CAUTION

## ADULT ASSEMBLY REQUIRED

### CHOKING HAZARD

- This product includes small parts, sharp points and sharp edges in its unassembled state. Keep unassembled parts away from children under 3 years of age, and animals.

### STRANGULATION HAZARD

- Never attach or hang items to any part of the bookcase that is not designed for use with the bookcase; for example, but not limited to hooks, belts, and jump ropes.

### SAFETY WARNINGS

- Follow the information on the warnings appearing on the loft bed end structure and on the carton. Do not remove warning label from bed.
- Do not allow children under 3 years of age to use the bookcase.
- Do not use substitute parts. Contact the manufacturer or dealer for replacement parts.

### FURNITURE TIP-OVER HAZARD

#### Children have died from furniture tip-over.

To reduce the risk of furniture tip-over:

- ALWAYS install tip-over restraint especially if used by a wall or in the open.
- NEVER put a TV on this product
- NEVER allow children to stand, climb or hang on drawers, doors, or shelves.
- NEVER open more than one drawer at a time.
- ALWAYS place heaviest items in lowest drawers.



### PARENTAL SUPERVISION IS REQUIRED

- This Kids product is intended for child use age 3+.
- Parents or Guardians should supervise use under the intended age specifically regarding children that may have access to it and climb on the unit.
- Do not allow horseplay on, under, or behind the unit and prohibit jumping on the bookcase.
- If used improperly, your bookcase may be pulled over or fall, creating risk of injury or damage. Children should not be permitted to climb or pull on the bookcase.

### USE, MAINTENANCE & ASSEMBLY

- Periodically check and ensure that the components are in their proper position, free from damage, and that all connectors are tight.
- Use on level surfaces only. Assemble on a soft level surface to avoid damage to unit or floor.
- Do not use this item if any components are missing or damaged.
- Do not use substitute parts. Contact the manufacturer or dealer for replacement parts.
- Only clean using damp cloth and mild detergent, do not use bleach or abrasive cleaners.
- Check you have all components and tools listed on page 4
- Do not stand or put weight on this product during assembly, this could cause damage.
- Remove all hardware from the plastic bags and separate them into groups.
- Assemble the item as close to its final position (in the same room) as possible.
- Certain assembly steps may be easier with 2 people.
- Dispose of all packaging carefully and responsibly.
- We do not recommend power screwdrivers. Only use hand screwdrivers to prevent damage to unit.

#### Enfants morts suite au basculement d'un meuble.

Afin de limiter le risque de basculement de meuble:

- TOUJOURS utiliser les fixations anti-basculement.
- NE JAMAIS installer de TV sur ce produit.
- NE JAMAIS laisser d'enfants se tenir debout sur les tiroirs, portes ou étagères, y grimper ou s'y suspendre.
- NE JAMAIS ouvrir plus d'un tiroir à la fois.
- TOUJOURS placer les choses les plus lourdes dans les tiroirs du bas.

#### Han muerto niños por el vuelco de muebles.

Para limitar el riesgo de vuelco de los muebles:

- Utilizar SIEMPRE las fijaciones antivuelco que suministran.
- NUNCA instalar un TV sobre este producto.
- NUNCA permitir que los niños se pongan de pie, trepen o se cuelguen de los cajones, puertas o baldas.
- NUNCA abrir más de un cajón a la vez.
- Colocar los objetos más pesados en los cajones inferiores.

# ASSEMBLY AT A GLANCE

Please take a moment to read through the whole instruction booklet before assembly to familiarize yourself with this product. Once you feel ready to start, follow the instructions step by step and this should make this process as easy as we could make it for you.

Due to the number of parts involved assembly can take a few hours so set aside between 2 and 3 hours to assemble this without rushing.

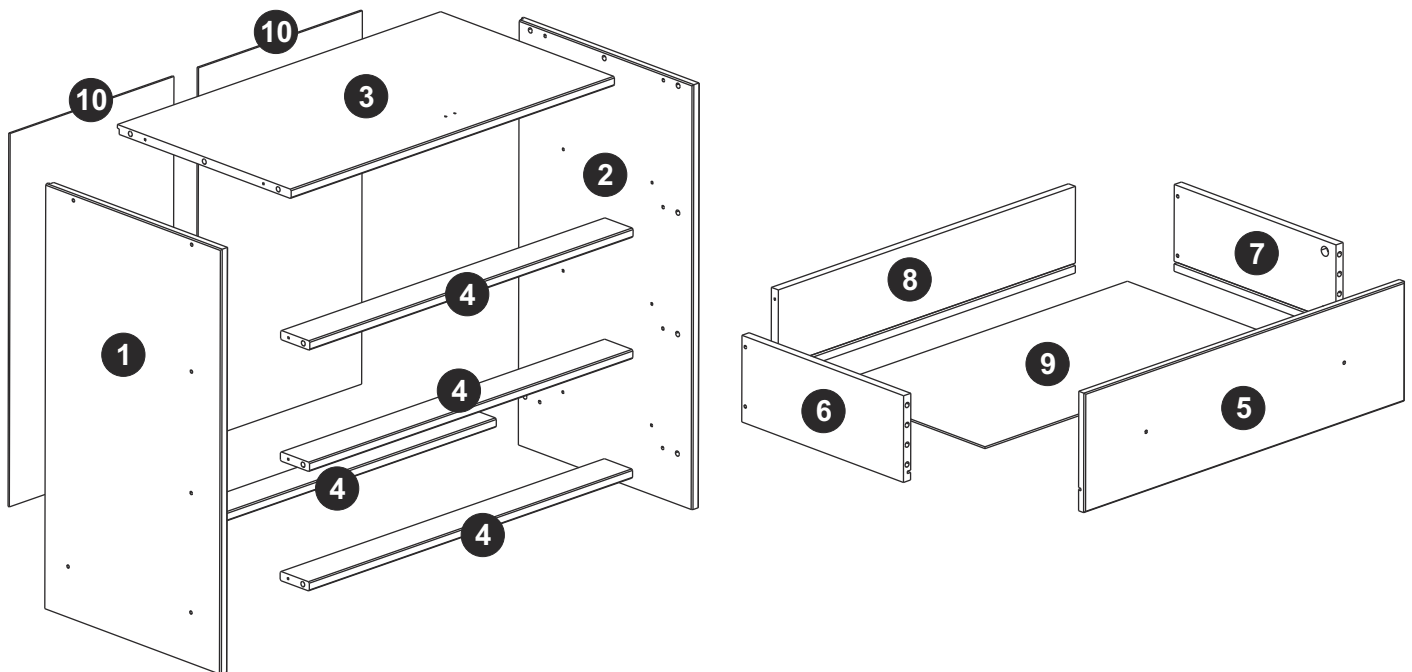

This drawing is to give you an overall idea only of how this assembly will go together and does not replace the assembly instructions.

# COMPONENT PARTS

Please check that you have all the parts listed below

\*Note: follow the setup of  
of Option 1 for ladder right  
configuration or Option 2  
for ladder left configuration.

Each leg is unique.

1. Left panel x1
2. Right panel x1
3. Top x1
4. Shelf support x4
5. Drawer front x3
6. Drawer left side x3
7. Drawer right side x3
8. Drawer back x3
9. Drawer bottom x3
10. Chest back x2

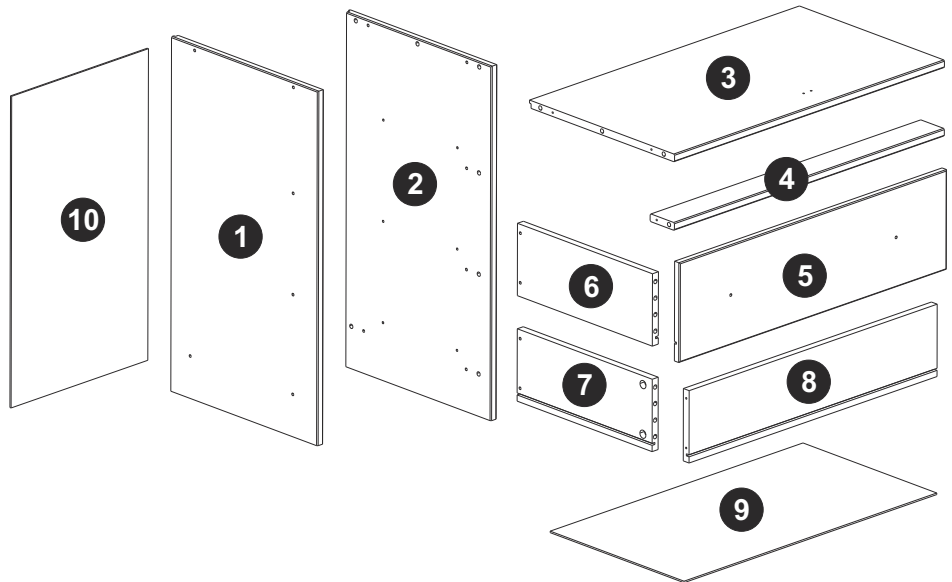

## ASSEMBLY HARDWARE

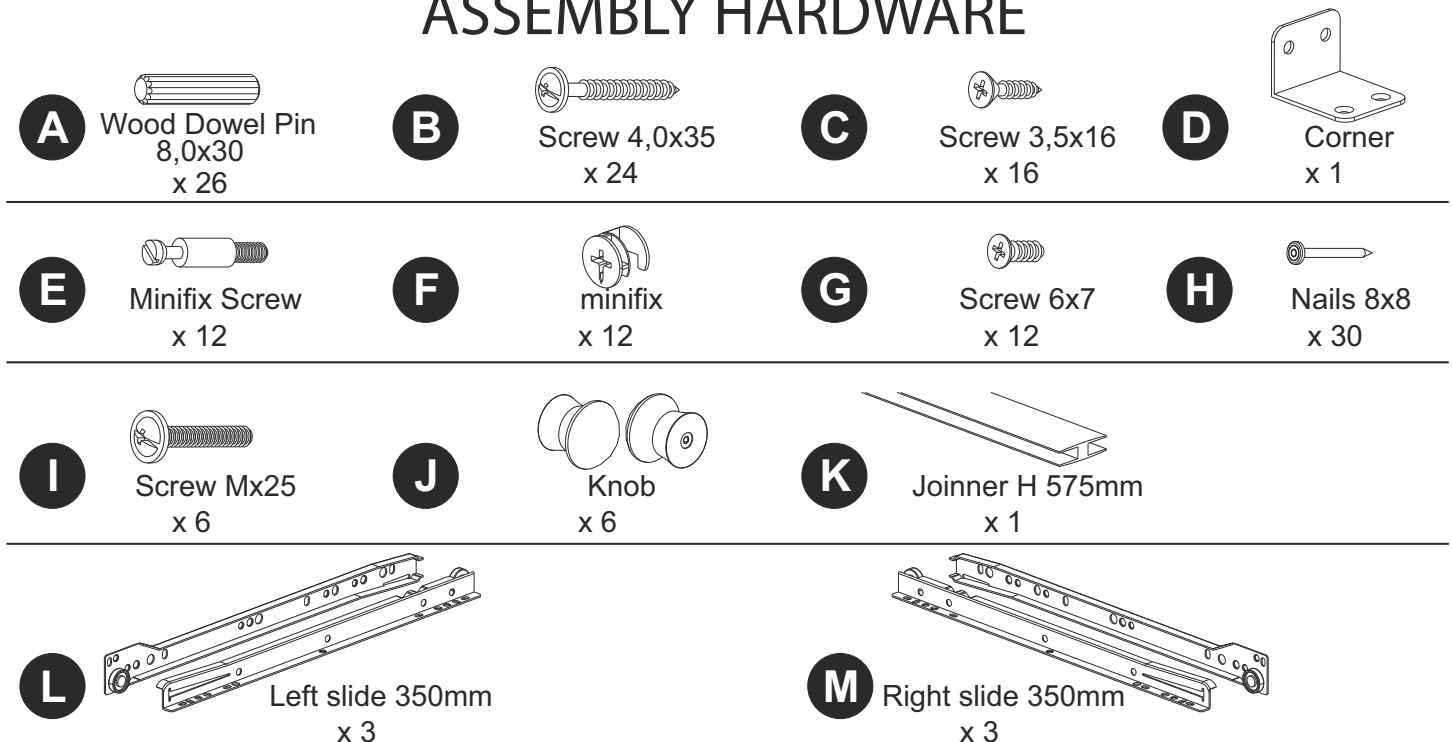

## TOOLS REQUIRED

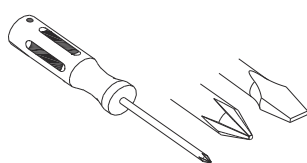

Phillips Screwdriver  
(Medium)

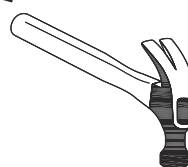

Hammer  
(not included)

# ASSEMBLY INSTRUCTIONS

1

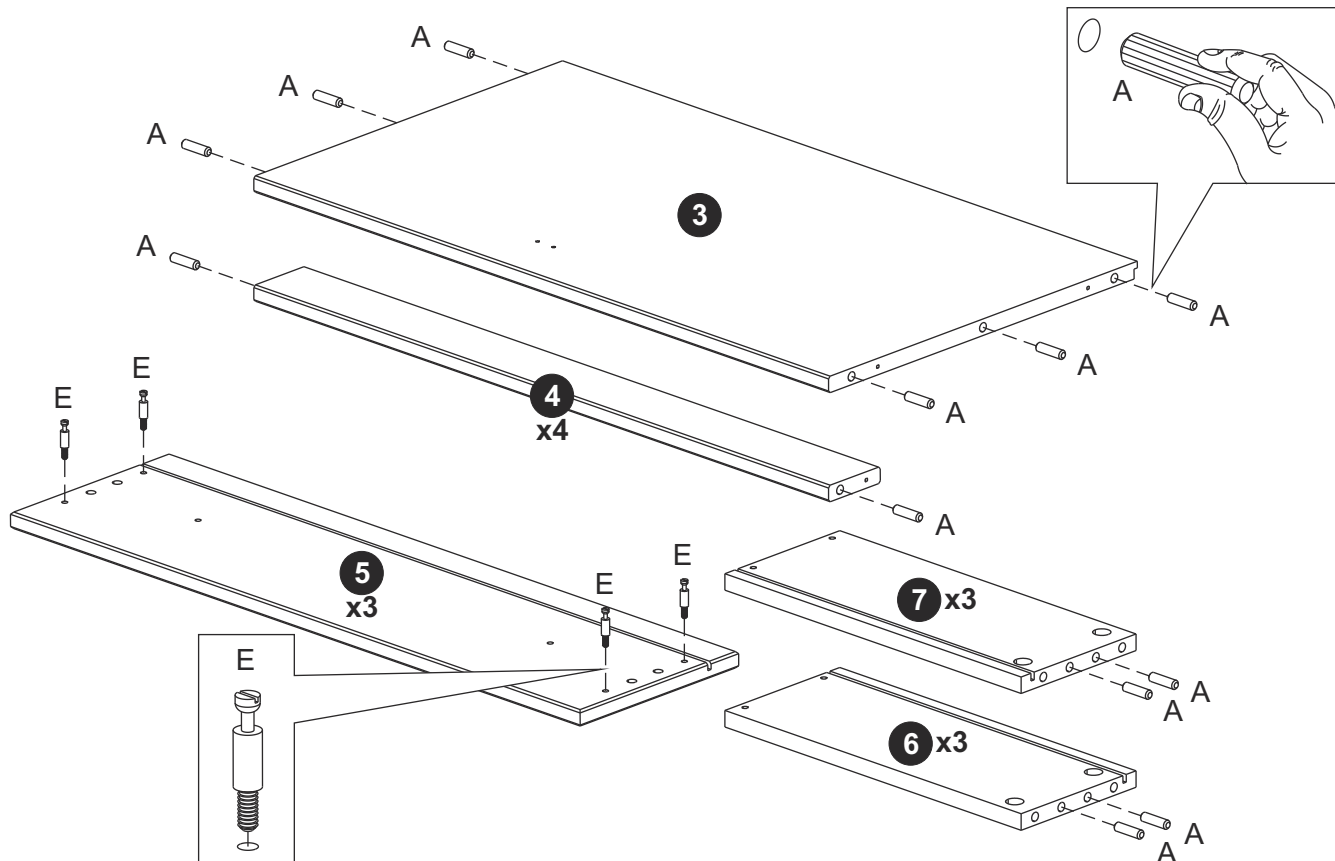

2

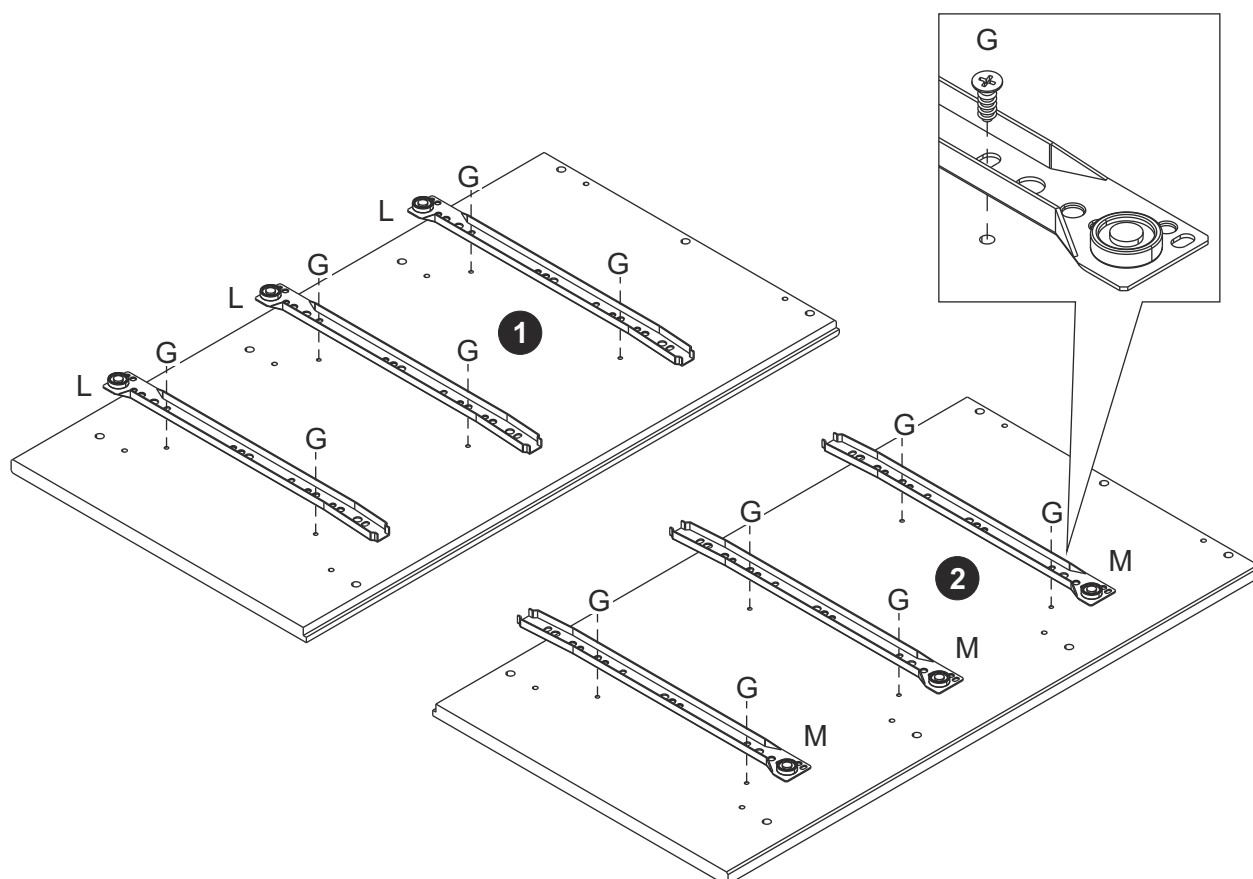

# ASSEMBLY INSTRUCTIONS

3

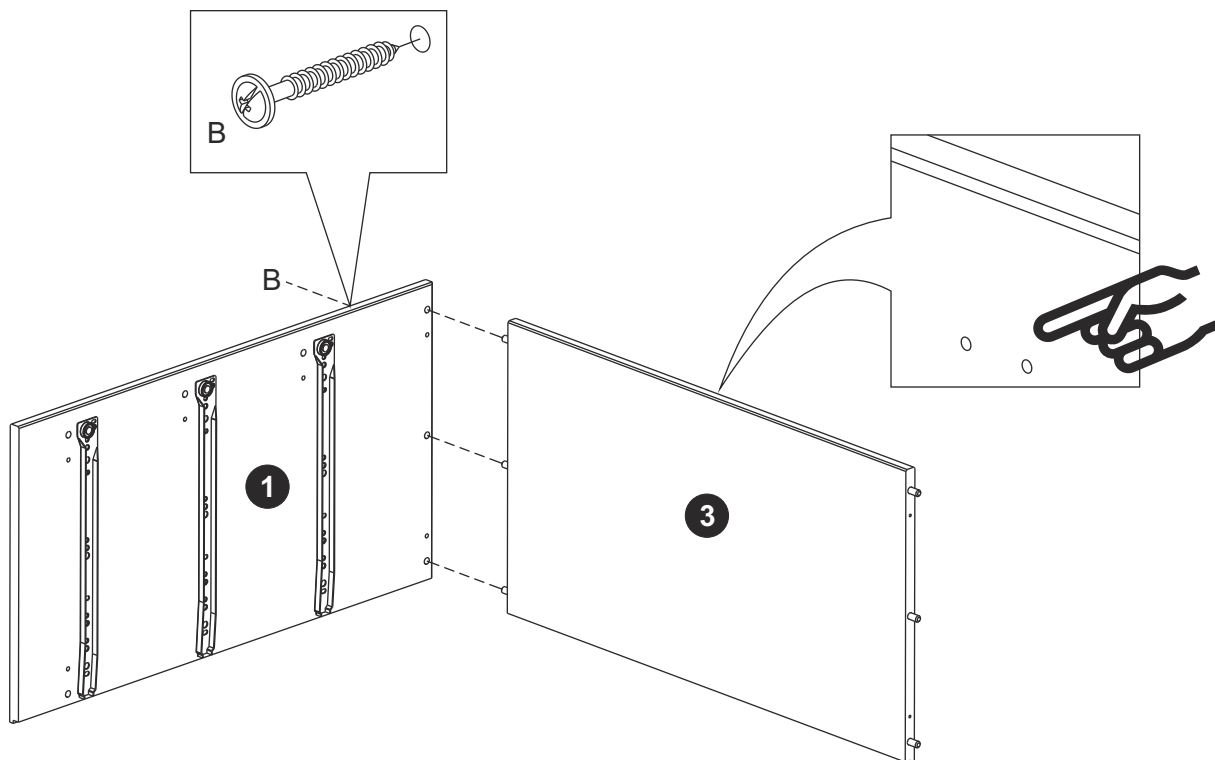

4

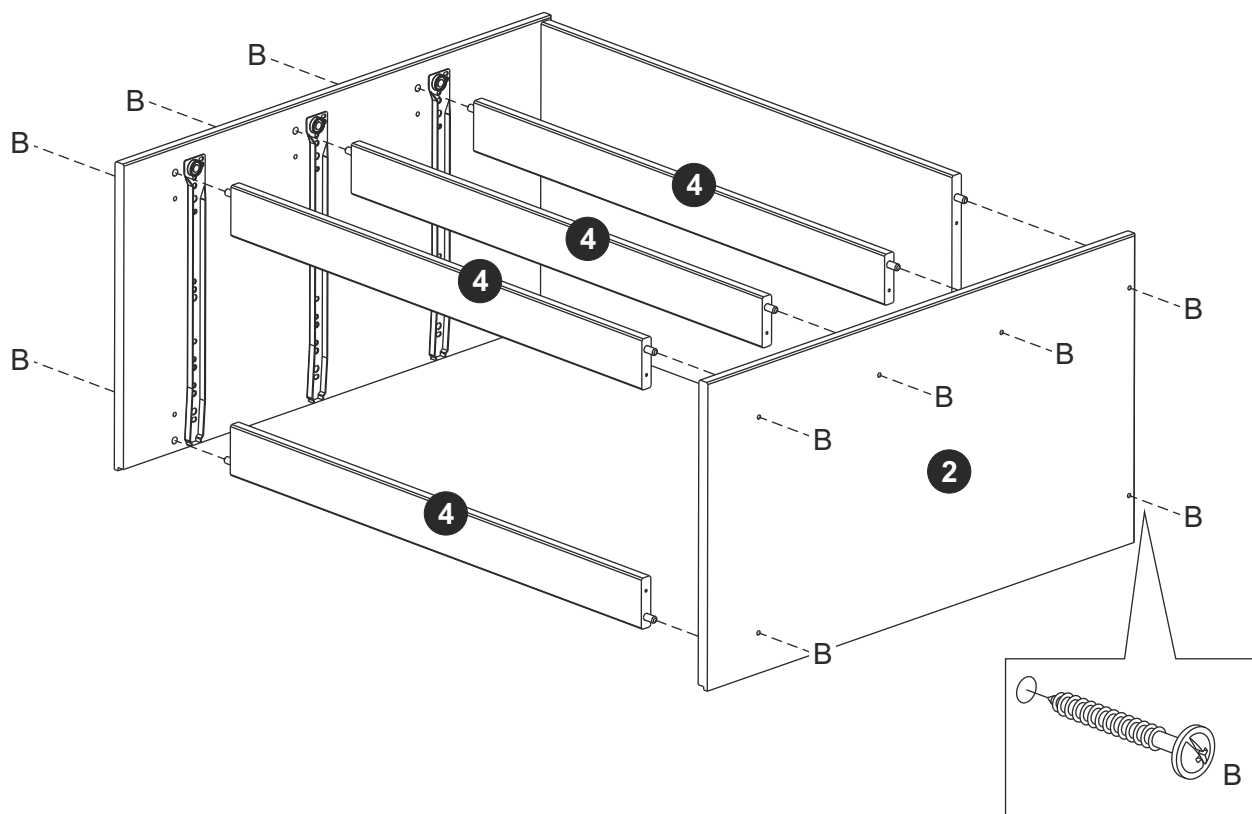

# ASSEMBLY INSTRUCTIONS

5

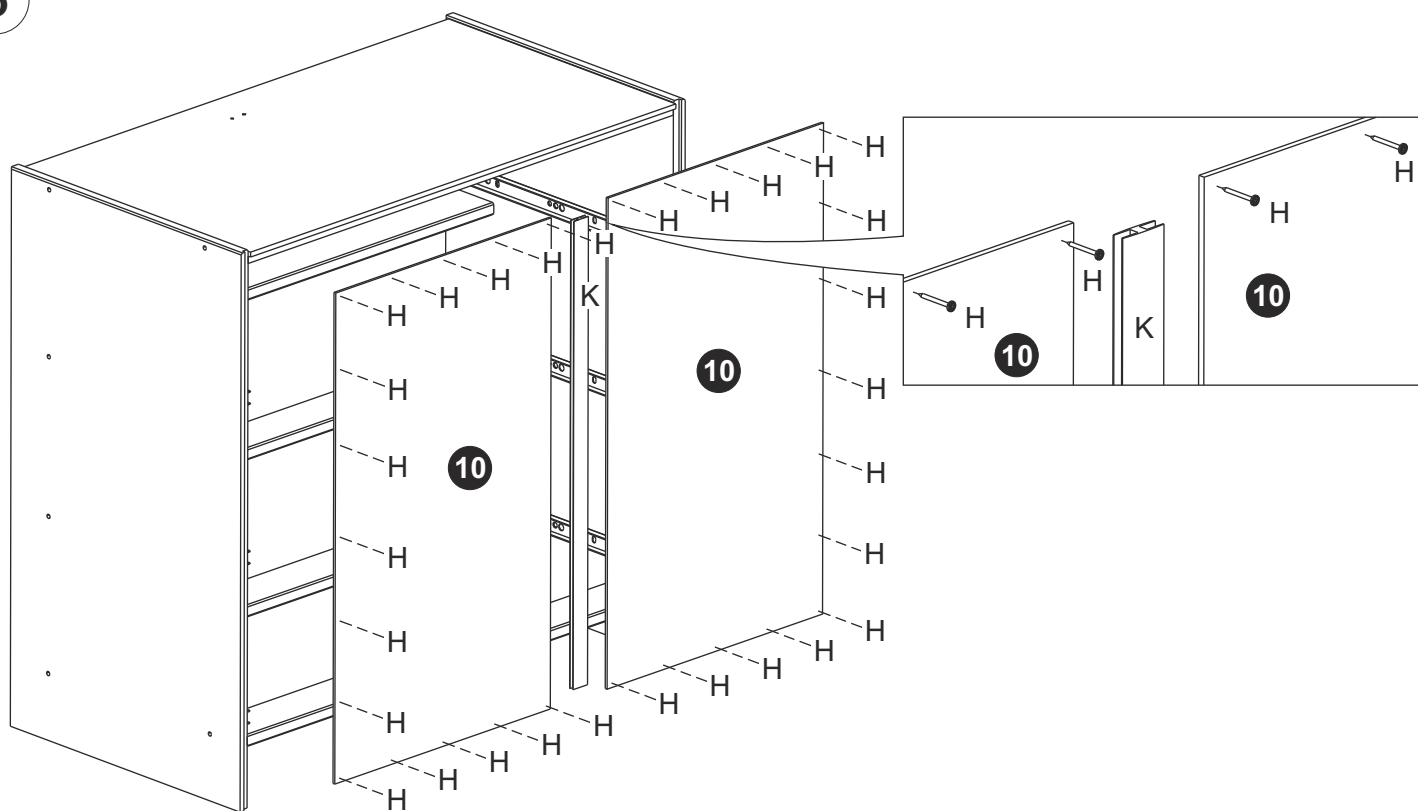

6

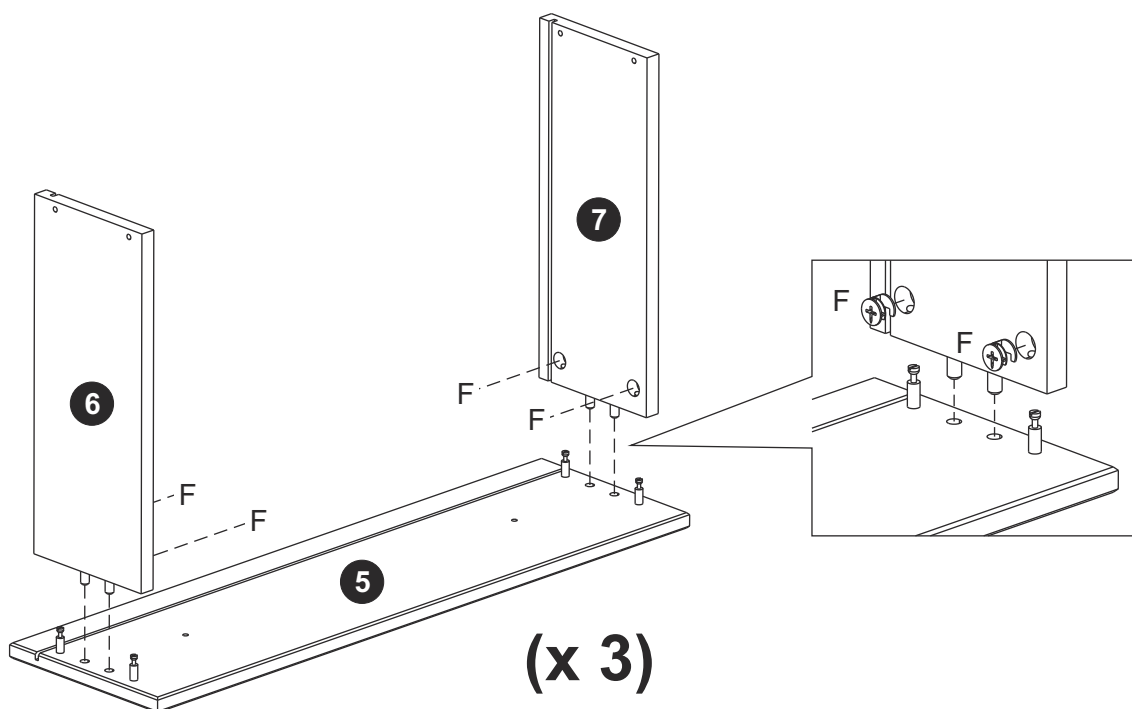

# ASSEMBLY INSTRUCTIONS

7

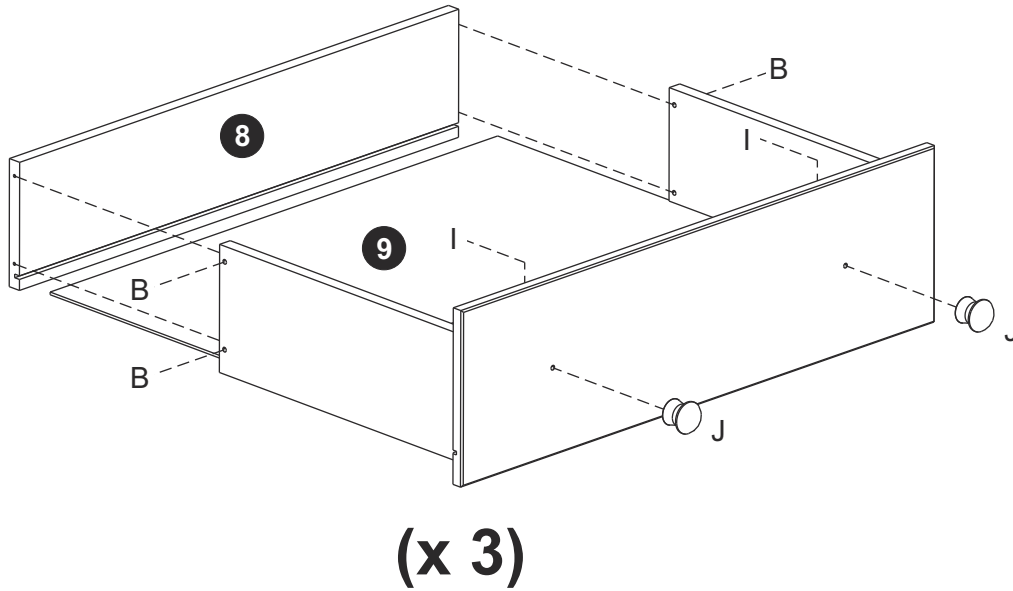

8

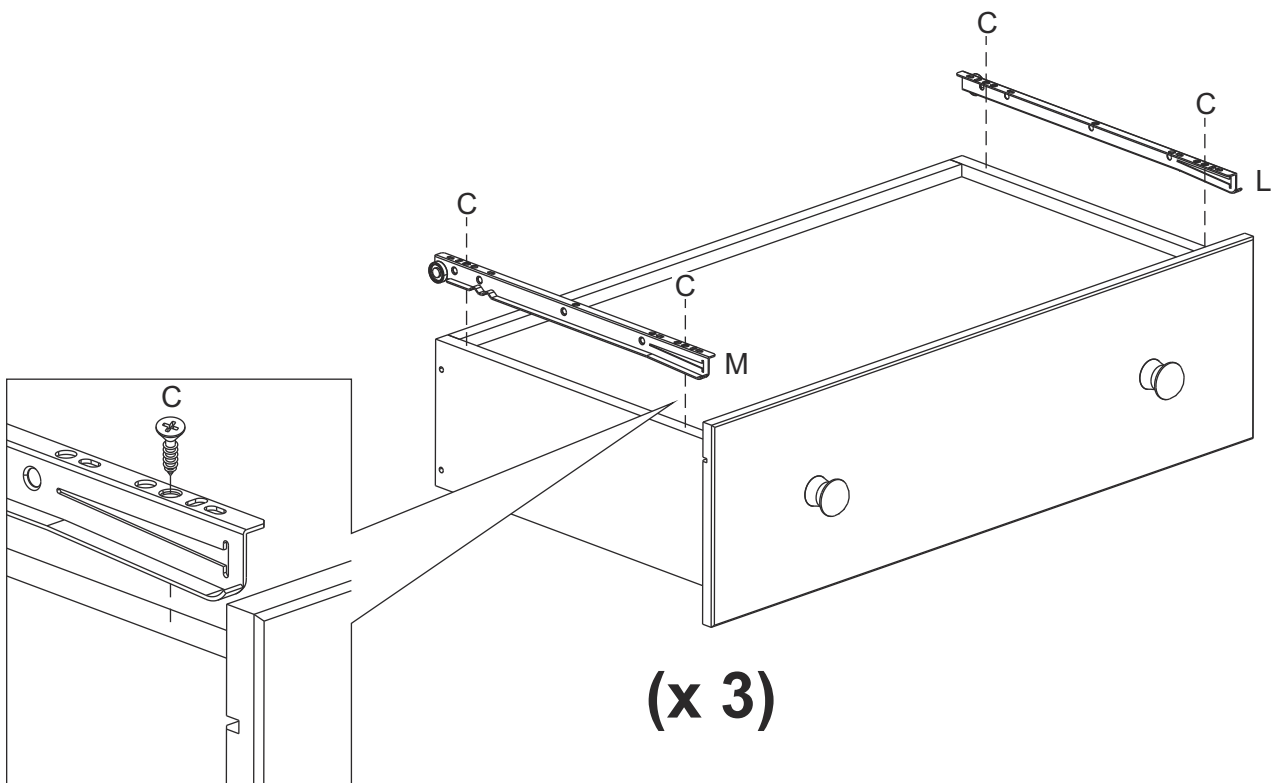

# ASSEMBLY INSTRUCTIONS

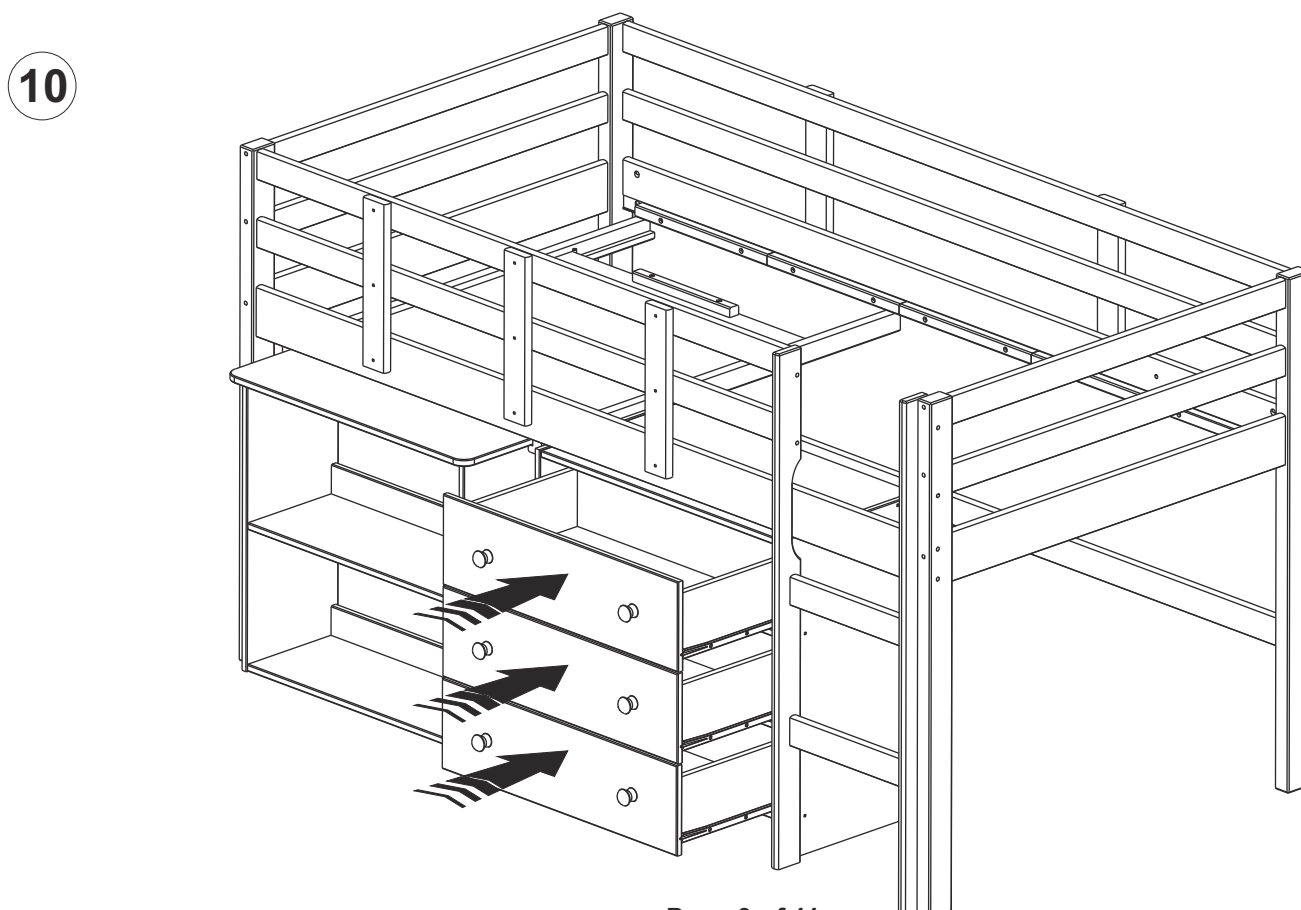
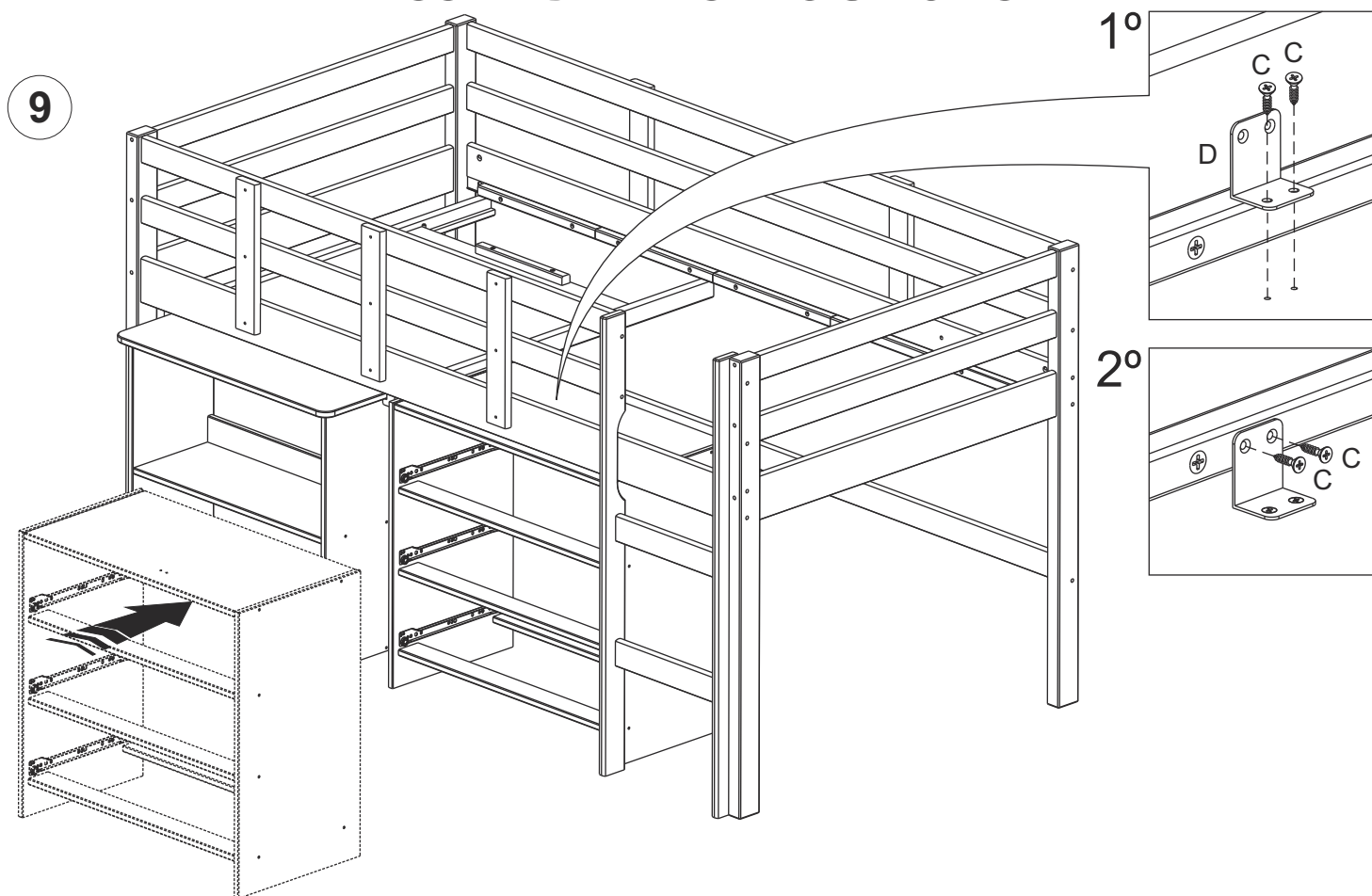

# CHEST ASSEMBLY COMPLETE

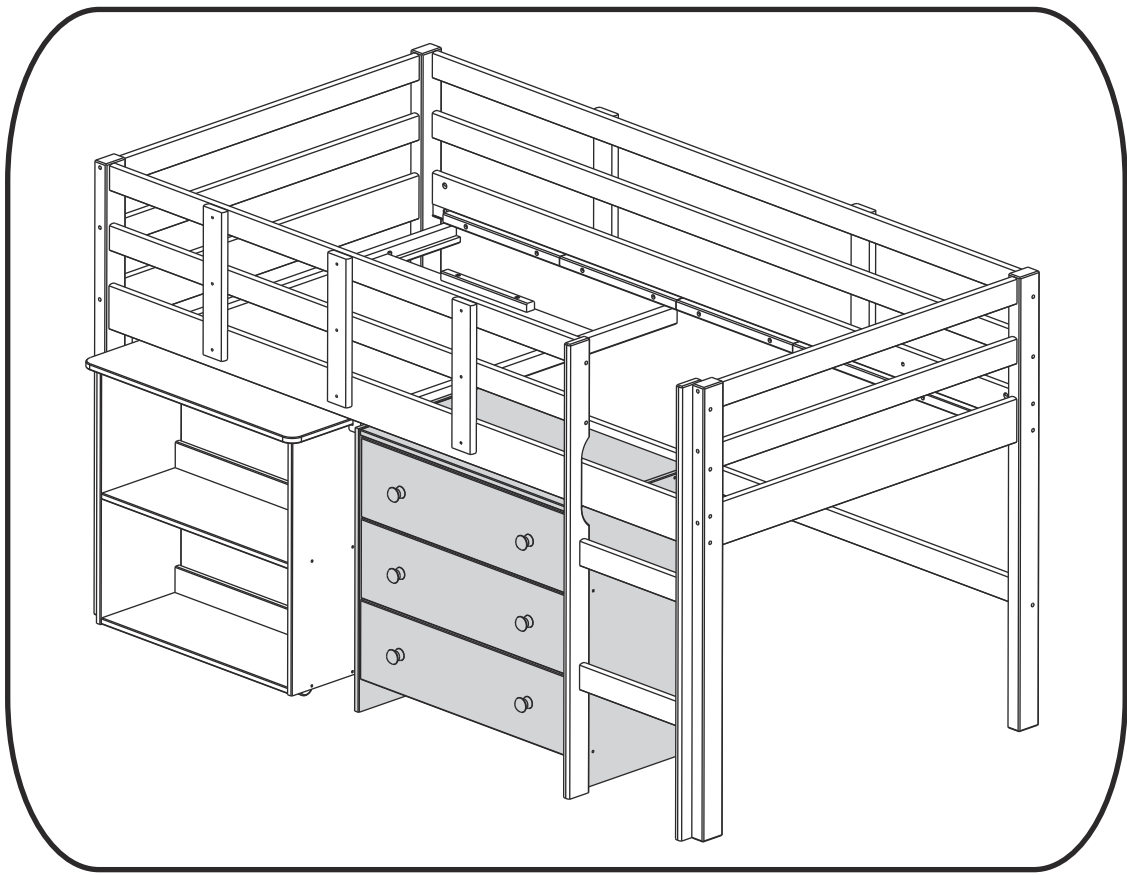

**ASSEMBLY COMPLETE**

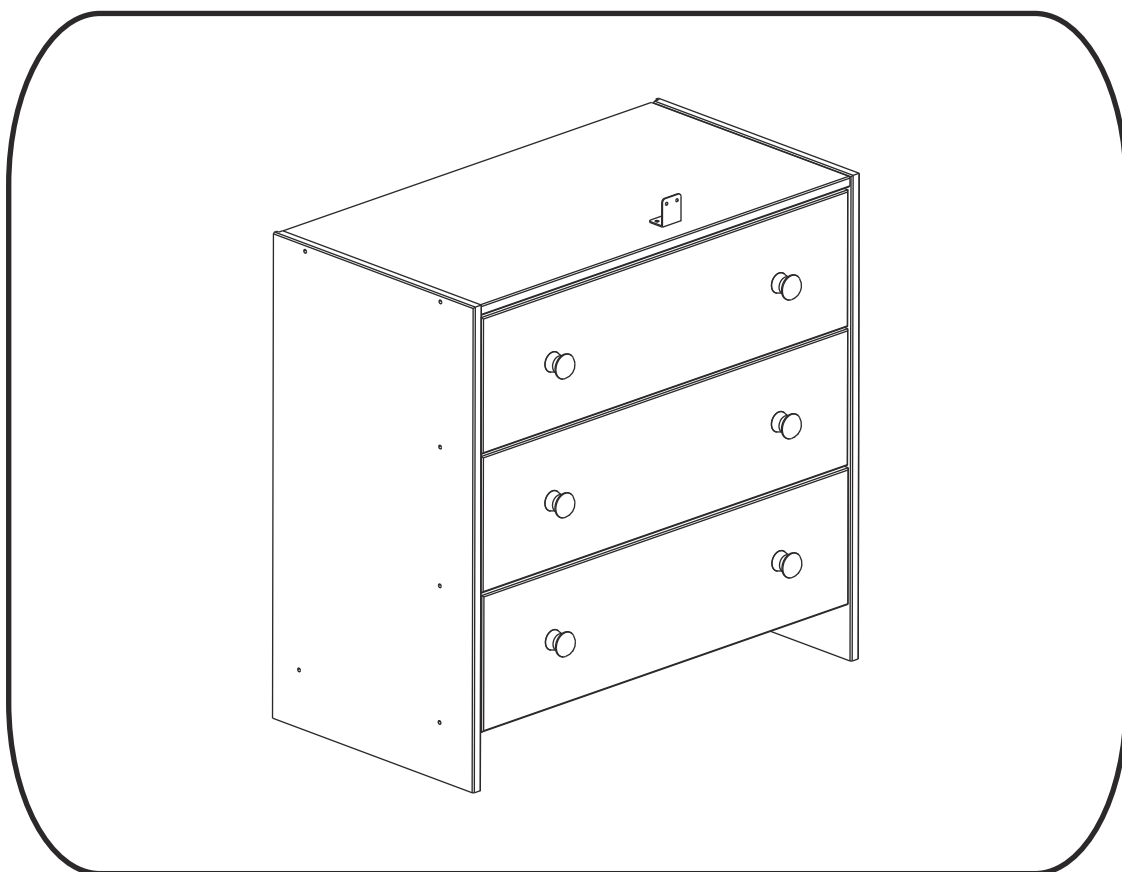

**CONGRATULATIONS, YOUR KIDS  
LOW LOFT BED WITH LADDER IS COMPLETE!**

# Low Loft Bed - Hide-a-Desk

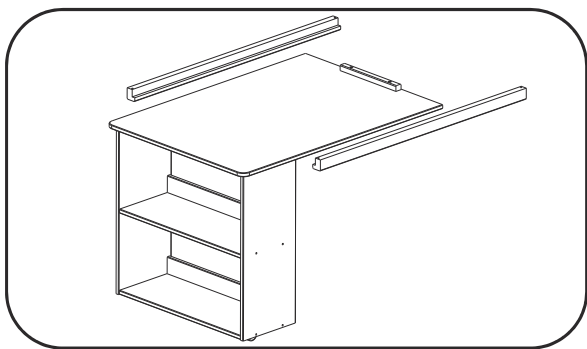

Assembly Instructions

Product Dimensions:  
38" L x 27" D x 27 2/8" H

# Low Loft Bed - Bookcase

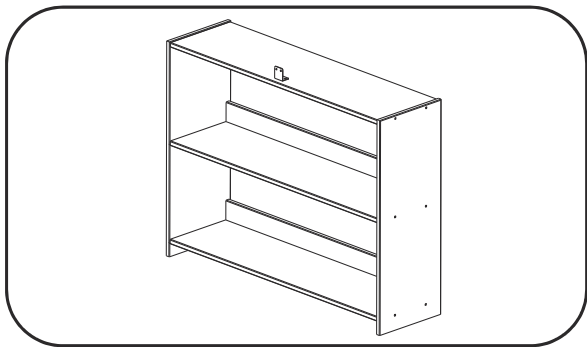

Assembly Instructions

Product Dimensions:  
36" L x 10" D x 27" H

Please take a moment to read through the entire instruction booklet before assembly to familiarize yourself with this product. Once you feel ready to start, follow the instructions step by step and this should make this process as easy as we could make it for you.

# WARNING CAUTION

## ADULT ASSEMBLY REQUIRED

### CHOKING HAZARD

- This product includes small parts, sharp points and sharp edges in its unassembled state. Keep unassembled parts away from children under 3 years of age, and animals.

### STRANGULATION HAZARD

- Never attach or hang items to any part of the bookcase that is not designed for use with the bookcase; for example, but not limited to hooks, belts, and jump ropes.

### SAFETY WARNINGS

- Follow the information on the warnings appearing on the loft bed end structure and on the carton. Do not remove warning label from bed.
- Do not allow children under 3 years of age to use the bookcase.
- Do not use substitute parts. Contact the manufacturer or dealer for replacement parts.

### FURNITURE TIP-OVER HAZARD

**Children have died from furniture tip-over.**

To reduce the risk of furniture tip-over:

- ALWAYS install tip-over restraint especially if used by a wall or in the open.
- NEVER put a TV on this product
- NEVER allow children to stand, climb or hang on drawers, doors, or shelves.
- NEVER open more than one drawer at a time.
- ALWAYS place heaviest items in lowest drawers.



### PARENTAL SUPERVISION IS REQUIRED

- This Kids product is intended for child use age 3+.
- Parents or Guardians should supervise use under the intended age specifically regarding children that may have access to it and climb on the unit.
- Do not allow horseplay on, under, or behind the unit and prohibit jumping on the bookcase.
- If used improperly, your bookcase may be pulled over or fall, creating risk of injury or damage. Children should not be permitted to climb or pull on the bookcase.

### USE, MAINTENANCE & ASSEMBLY

- Periodically check and ensure that the components are in their proper position, free from damage, and that all connectors are tight.
- Use on level surfaces only. Assemble on a soft level surface to avoid damage to unit or floor.
- Do not use this item if any components are missing or damaged.
- Do not use substitute parts. Contact the manufacturer or dealer for replacement parts.
- Only clean using damp cloth and mild detergent, do not use bleach or abrasive cleaners.
- Check you have all components and tools listed on page 4
- Do not stand or put weight on this product during assembly, this could cause damage.
- Remove all hardware from the plastic bags and separate them into groups.
- Assemble the item as close to its final position (in the same room) as possible.
- Certain assembly steps may be easier with 2 people.
- Dispose of all packaging carefully and responsibly.
- We do not recommend power screwdrivers. Only use hand screwdrivers to prevent damage to unit.

#### Enfants morts suite au basculement d'un meuble.

Afin de limiter le risque de basculement de meuble:

- TOUJOURS utiliser les fixations anti-basculement.
- NE JAMAIS installer de TV sur ce produit.
- NE JAMAIS laisser d'enfants se tenir debout sur les tiroirs, portes ou étagères, y grimper ou s'y suspendre.
- NE JAMAIS ouvrir plus d'un tiroir à la fois.
- TOUJOURS placer les choses les plus lourdes dans les tiroirs du bas.

#### Han muerto niños por el vuelco de muebles.

Para limitar el riesgo de vuelco de los muebles:

- Utilizar SIEMPRE las fijaciones antivuelco que suministran.
- NUNCA instalar un TV sobre este producto.
- NUNCA permitir que los niños se pongan de pie, trepen o se cuelguen de los cajones, puertas o baldas.
- NUNCA abrir mas de un cajón a la vez.
- Colocar los objetos mas pesados en los cajones inferiores.

# DESK COMPONENT PARTS

Please check that you have all the parts listed below

---

\*Note: follow the setup of  
of Option 1 for ladder right  
configuration or Option 2  
for ladder left configuration.

Each leg is unique.

1. Side panel x2
2. Shelf x2
3. Back support x2
4. Desk shelf support x2
5. Desk top x1
6. Desk support x1
7. Slide x2
8. Rear slide stopper x1

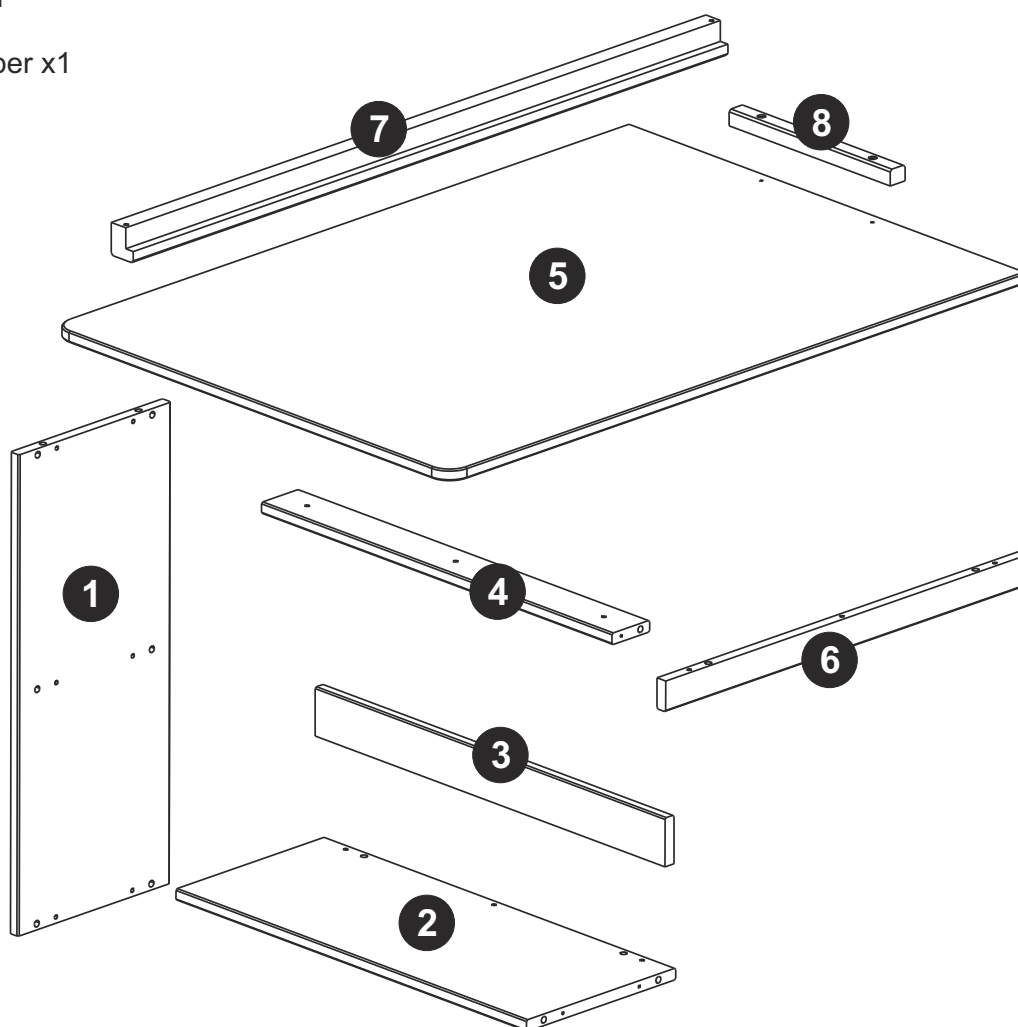



## ASSEMBLY HARDWARE

**A**   
Wood Dowel Pin  
8,0x30  
x 44

**B**   
Screw 4,0x35  
x 39

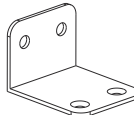
**C**   
Screw 3,5x12  
x 12

**D**   
Corner  
x 1

**E**   
Screw 4,0x25  
x 6

**F**   
Screw 4,0x30  
x 2

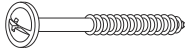
**G**   
Screw 4,0x50  
x 4

**H**   
Caster  
x 2

## TOOLS REQUIRED

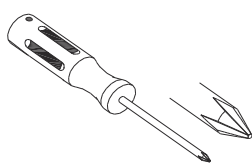

Phillips Screwdriver  
(Medium)

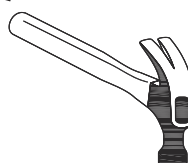

Hammer  
(not included)

NOTE: SKIP TO PAGE 10 FOR PARTS  
AND HARDWARE FOR THE BOOKCASE

# ASSEMBLY AT A GLANCE

Please take a moment to read through the whole instruction booklet before assembly to familiarize yourself with this product. Once you feel ready to start, follow the instructions step by step and this should make this process as easy as we could make it for you.

Due to the number of the parts involved  
assembly can take a few hours  
so set aside approximately 1 hour  
to assemble this without rushing.

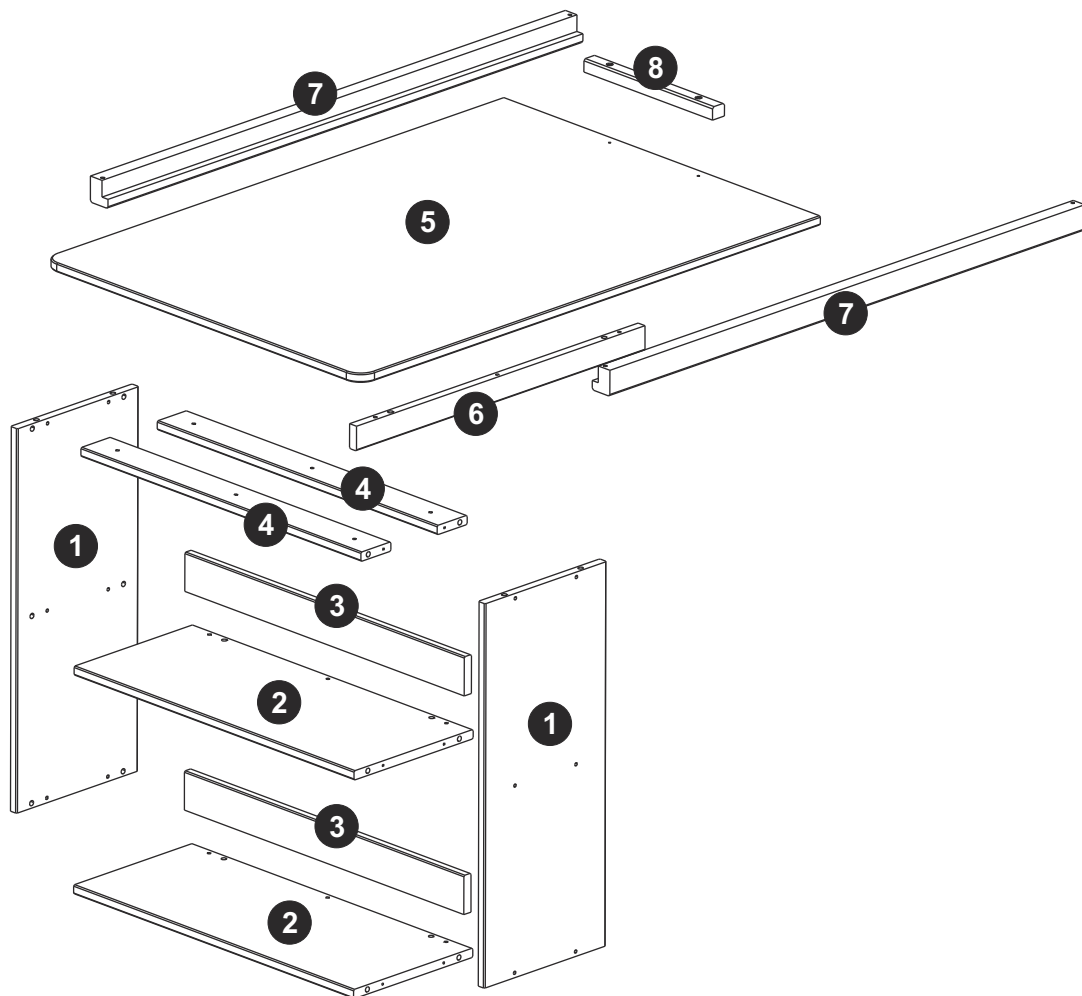

This drawing is to give you an overall idea only of how this assembly will go together and does not replace the assembly instructions.

# ASSEMBLY INSTRUCTIONS

1

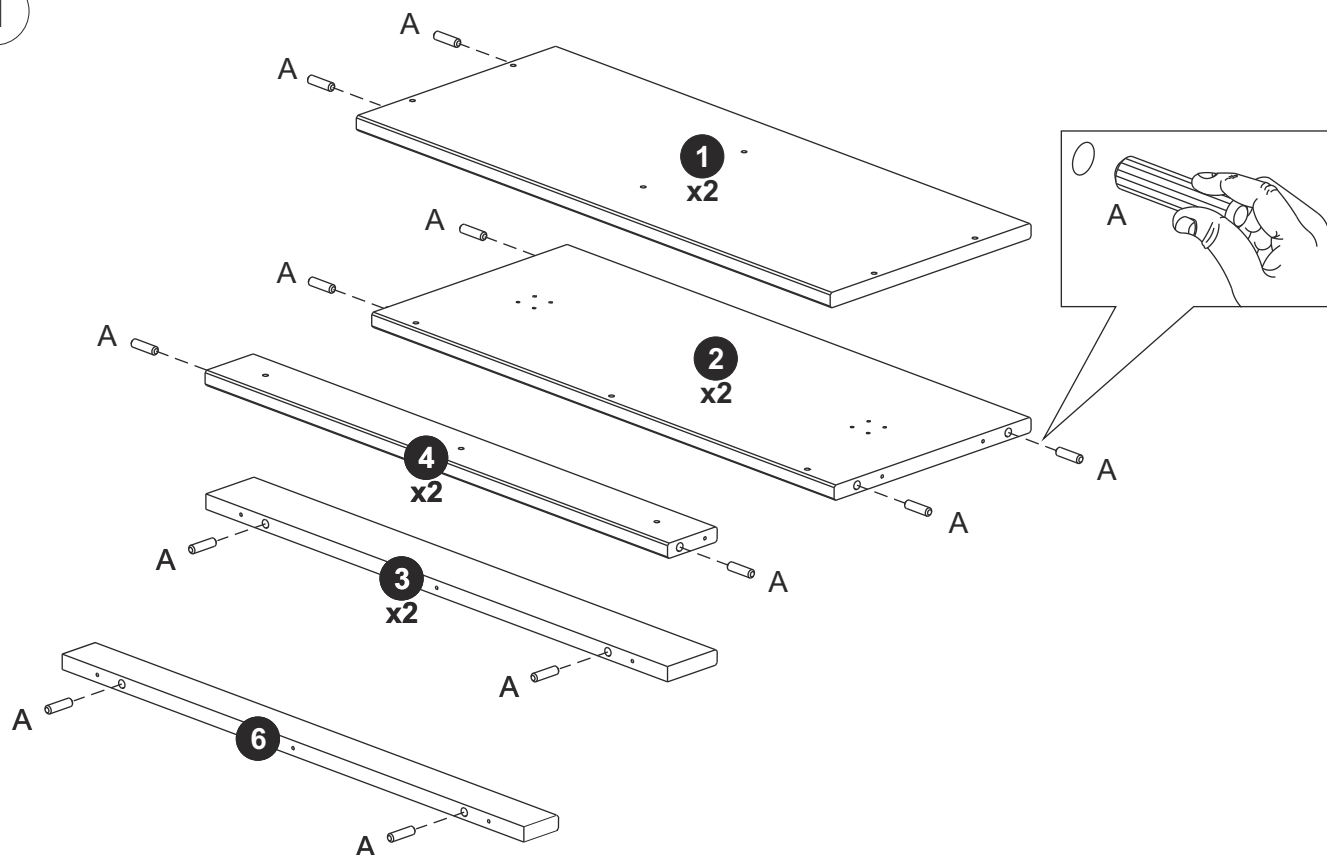

2

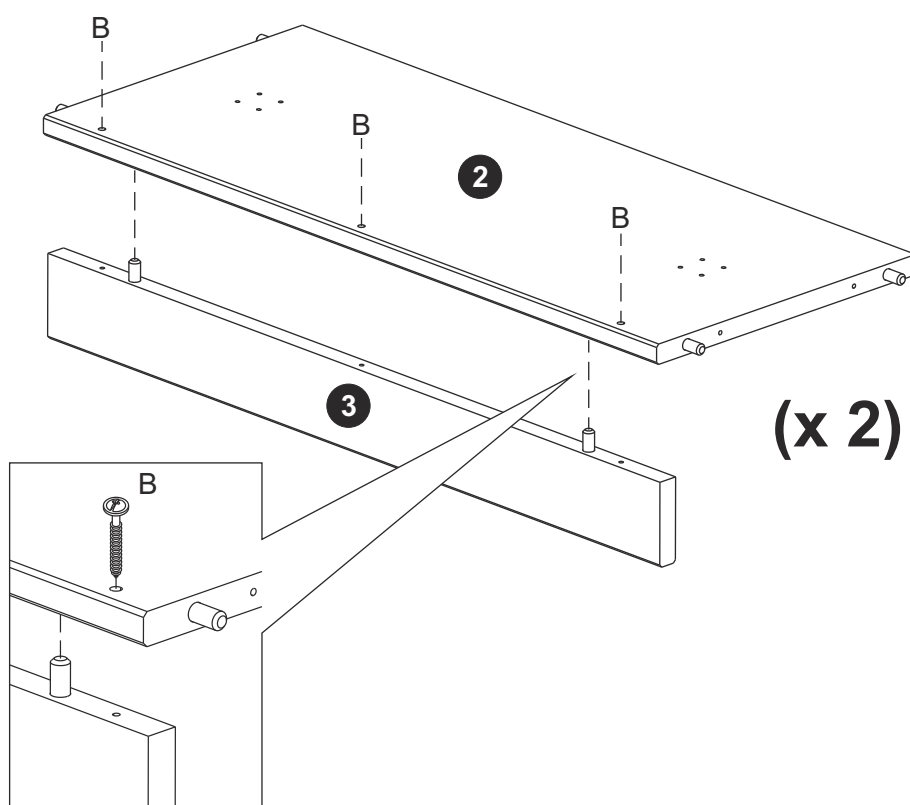

# ASSEMBLY INSTRUCTIONS

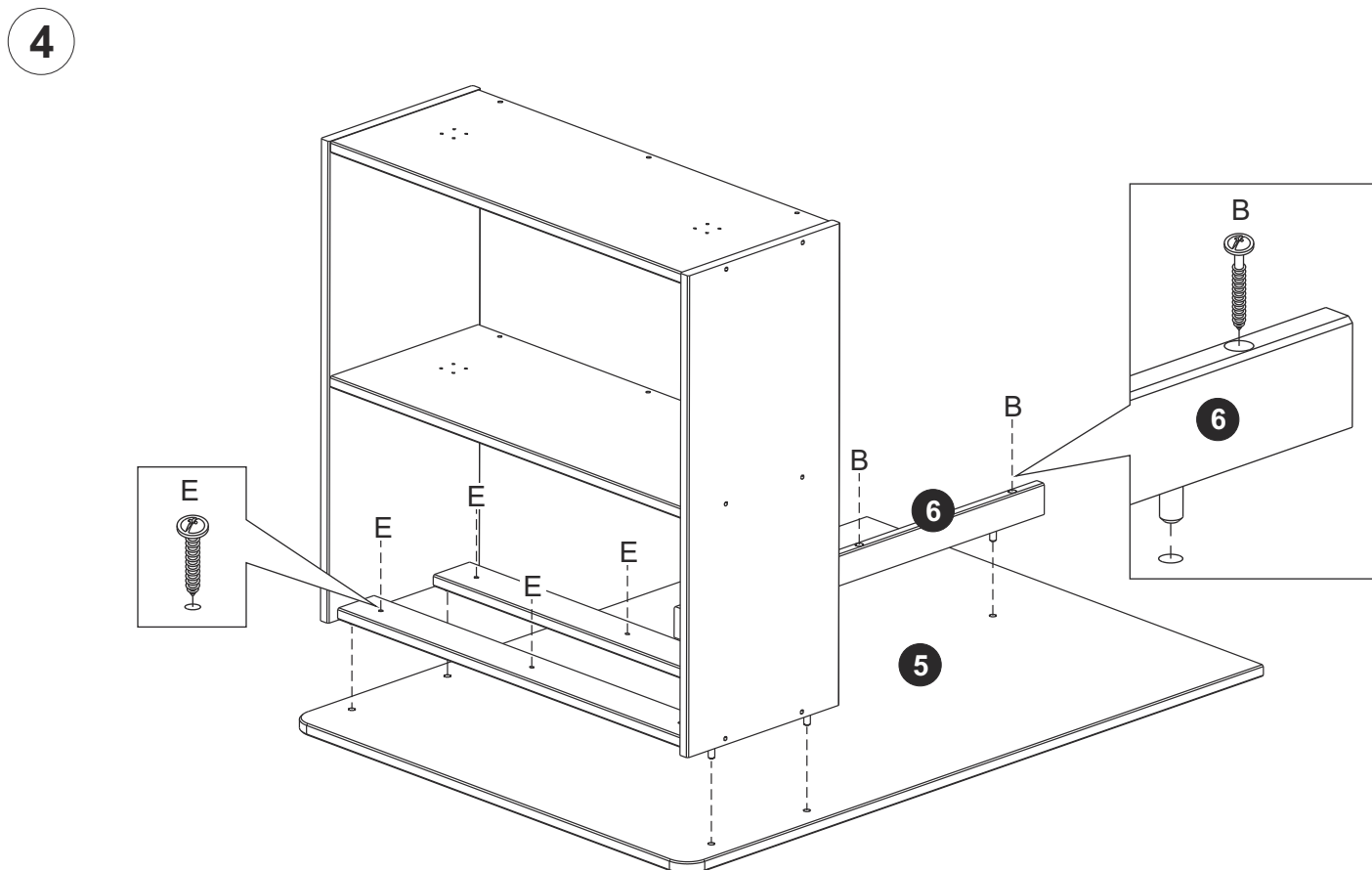
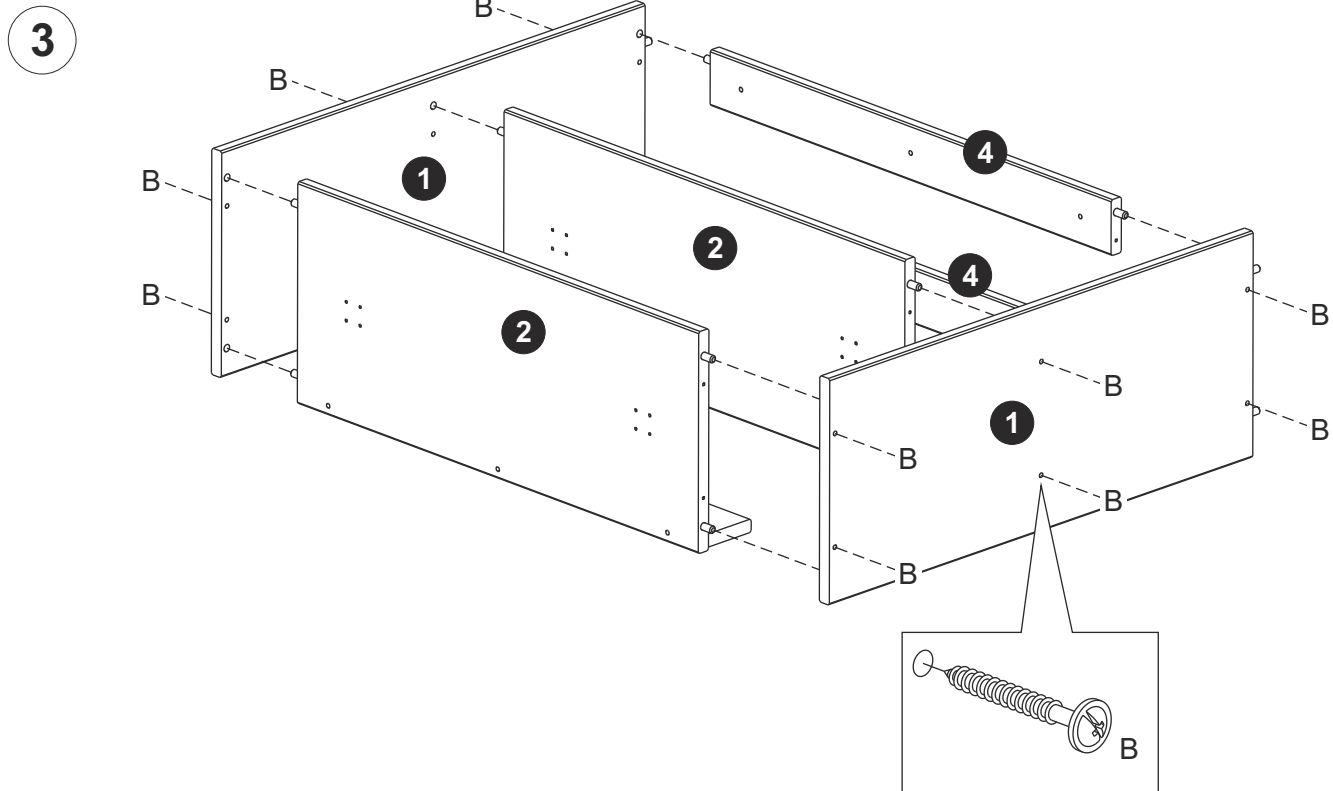

# ASSEMBLY INSTRUCTIONS

5

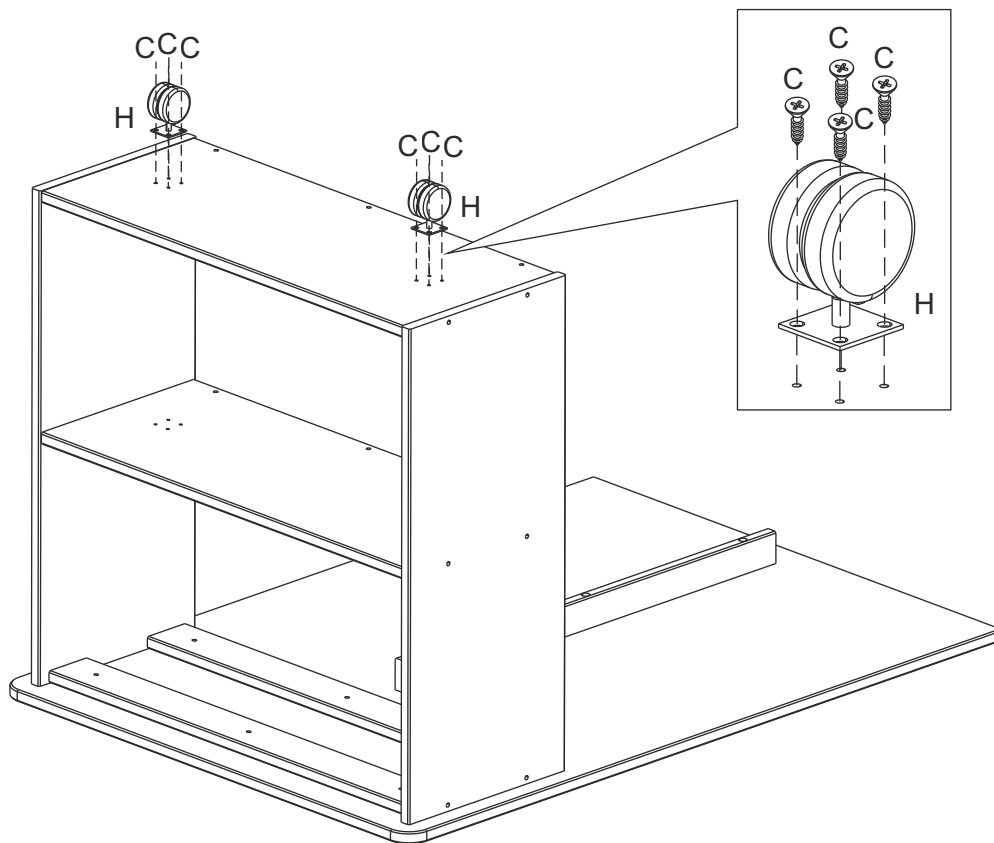

6

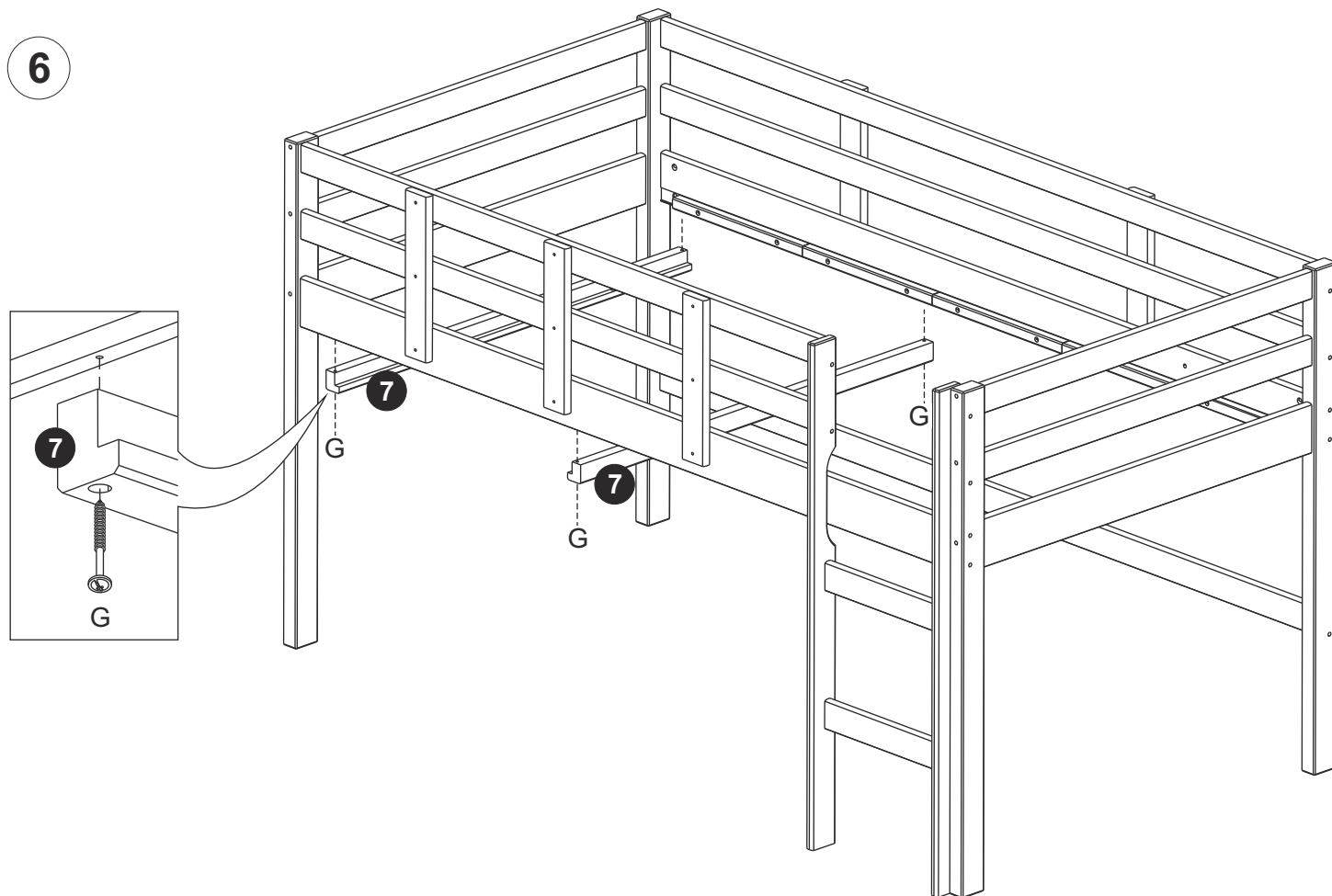

# ASSEMBLY INSTRUCTIONS

7

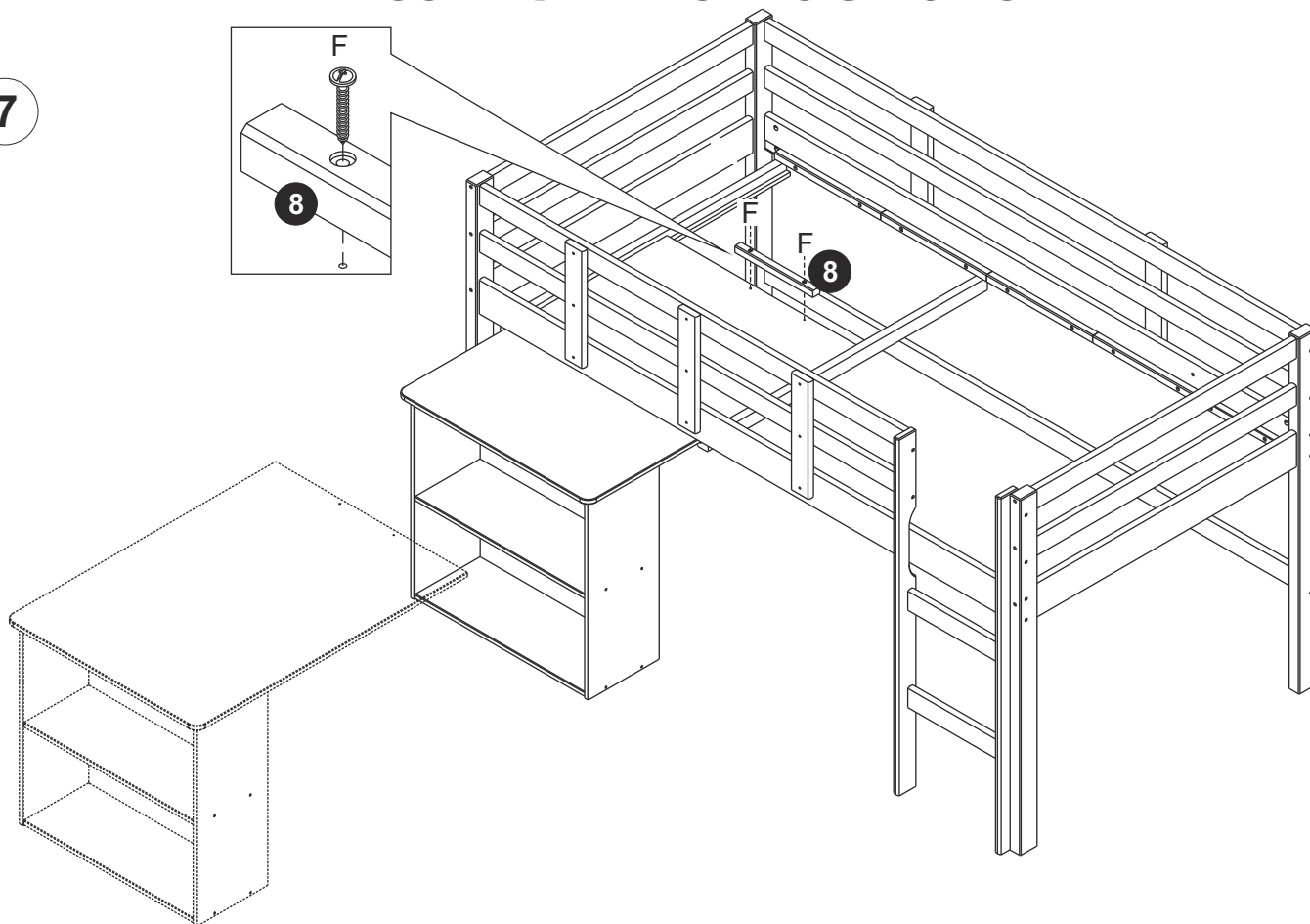

## DESK ASSEMBLY COMPLETE

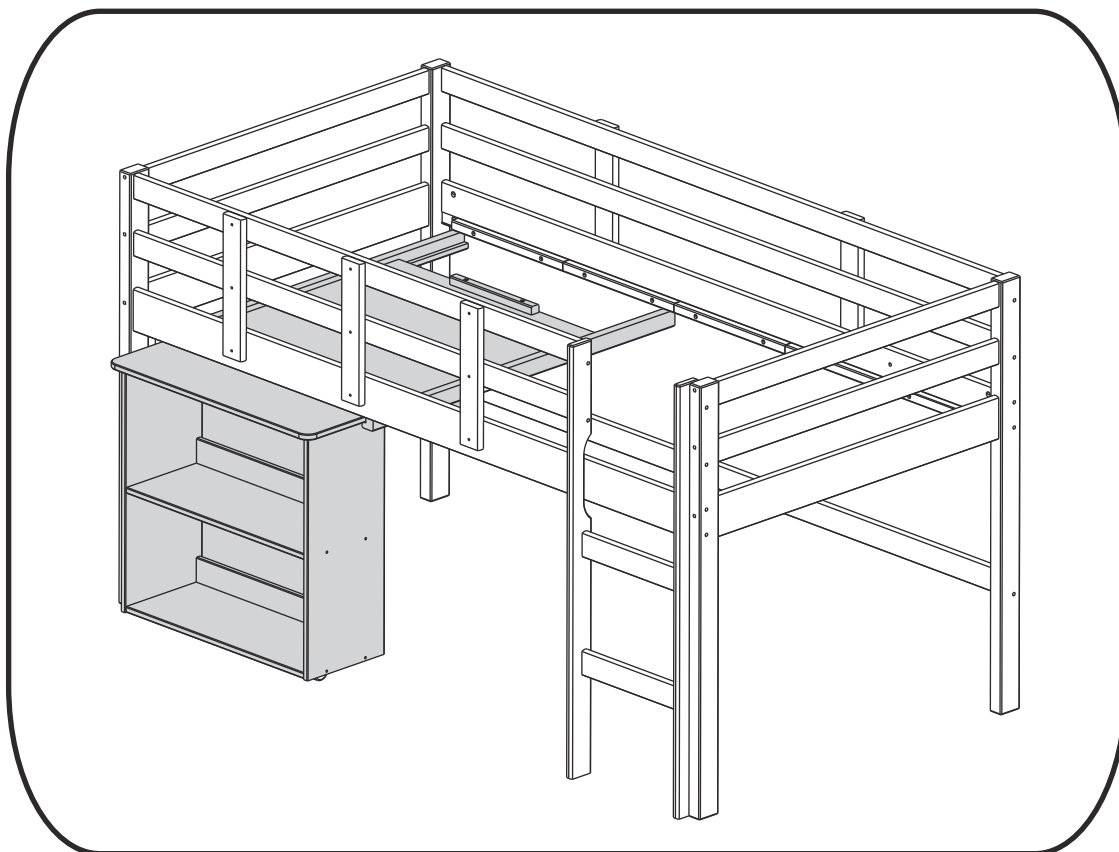

# BOOKCASE COMPONENT PARTS

Please check that you have all the parts listed below

---

\*Note: follow the setup of  
of Option 1 for ladder right  
configuration or Option 2  
for ladder left configuration.

Each leg is unique.

- 10. Side panel x2
- 11. Shelf x2
- 12. Back support x2
- 13. Top shelf x1

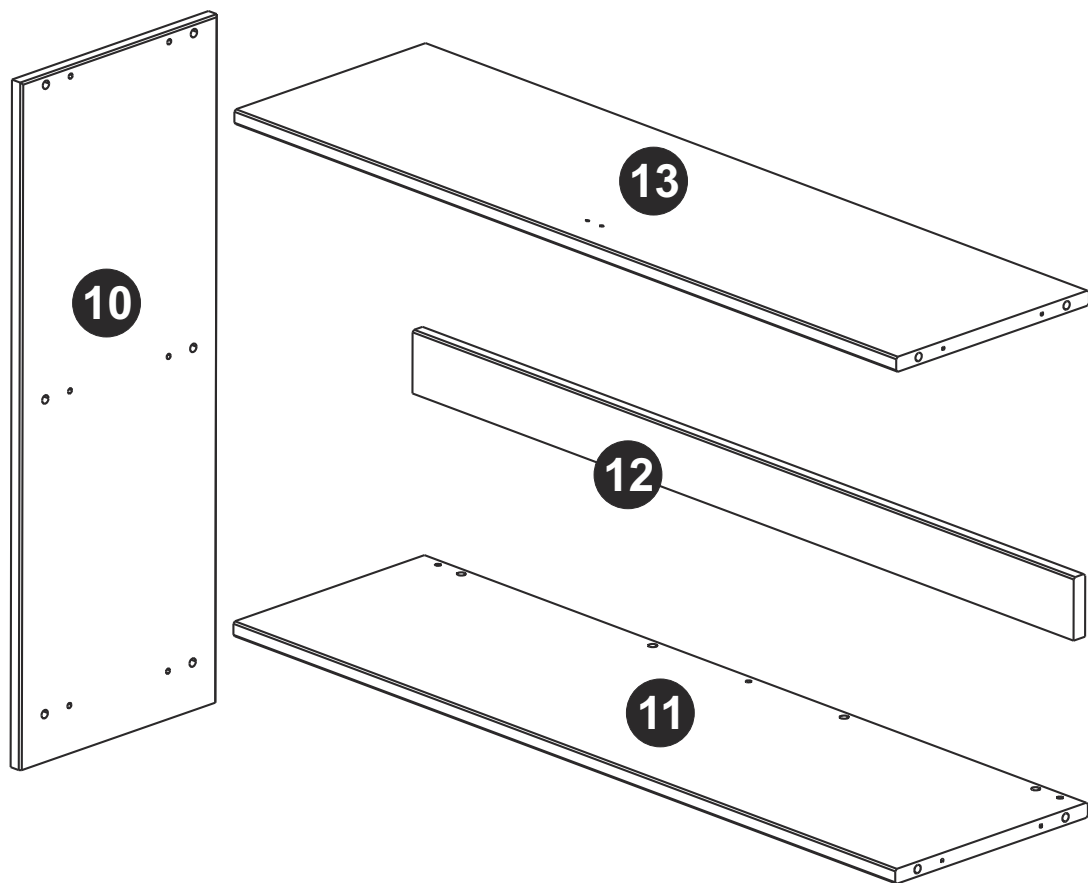

## ASSEMBLY HARDWARE

**A**



Wood Dowel Pin  
8,0x30  
x 18

**B**



Screw 4,0x35  
x 15

**C**



Screw 3,5x12  
x 4

**D**

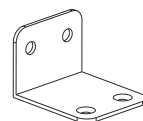

Corner  
x 1

## TOOLS REQUIRED

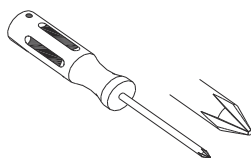

Phillips Screwdriver  
(Medium)

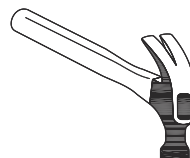

Hammer  
(not included)

**NOTE: RETURN TO PAGE 3 FOR PARTS  
AND HARDWARE FOR THE DESK**

# ASSEMBLY AT A GLANCE

Please take a moment to read through the whole instruction booklet before assembly to familiarize yourself with this product. Once you feel ready to start, follow the instructions step by step and this should make this process as easy as we could make it for you.

Due to the number of the parts involved  
assembly can take a few hours  
so set aside approximately 30 minutes  
to assemble this without rushing.

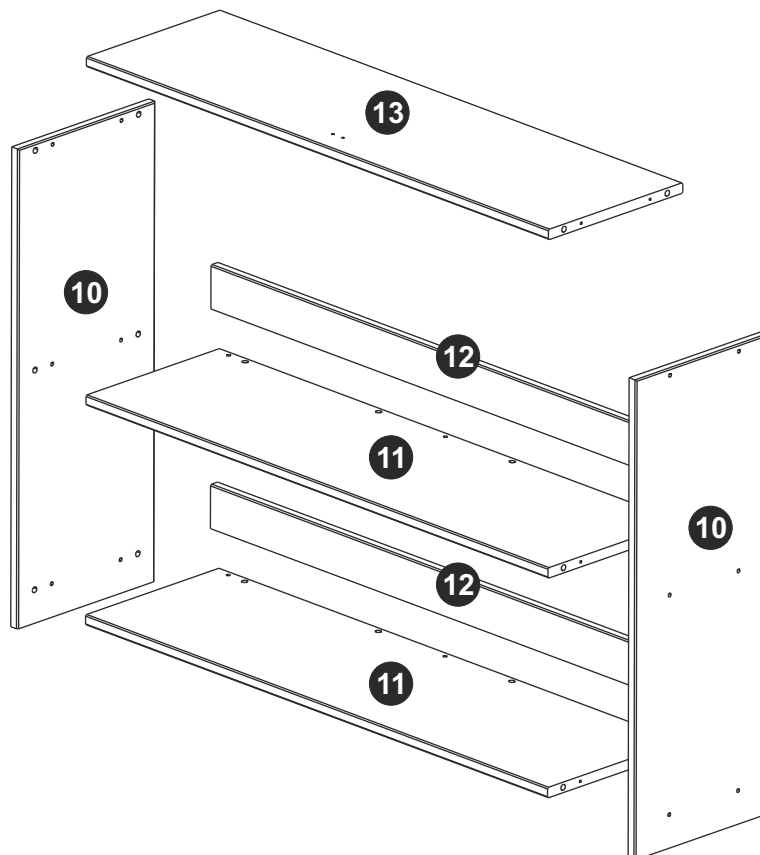

This drawing is to give you an overall idea only of how this assembly will go together and does not replace the assembly instructions.

# ASSEMBLY INSTRUCTIONS

1

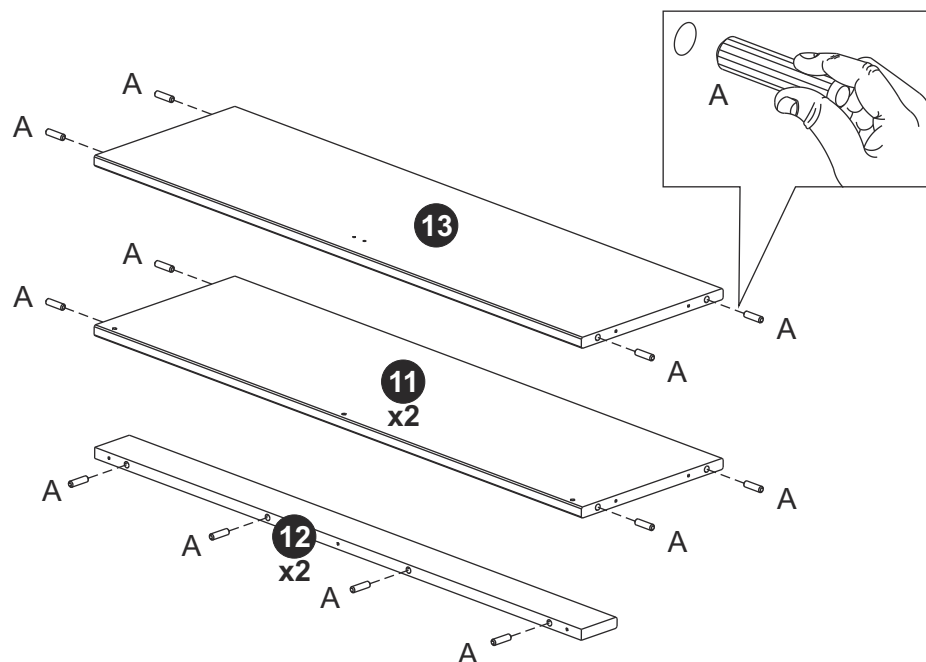

2

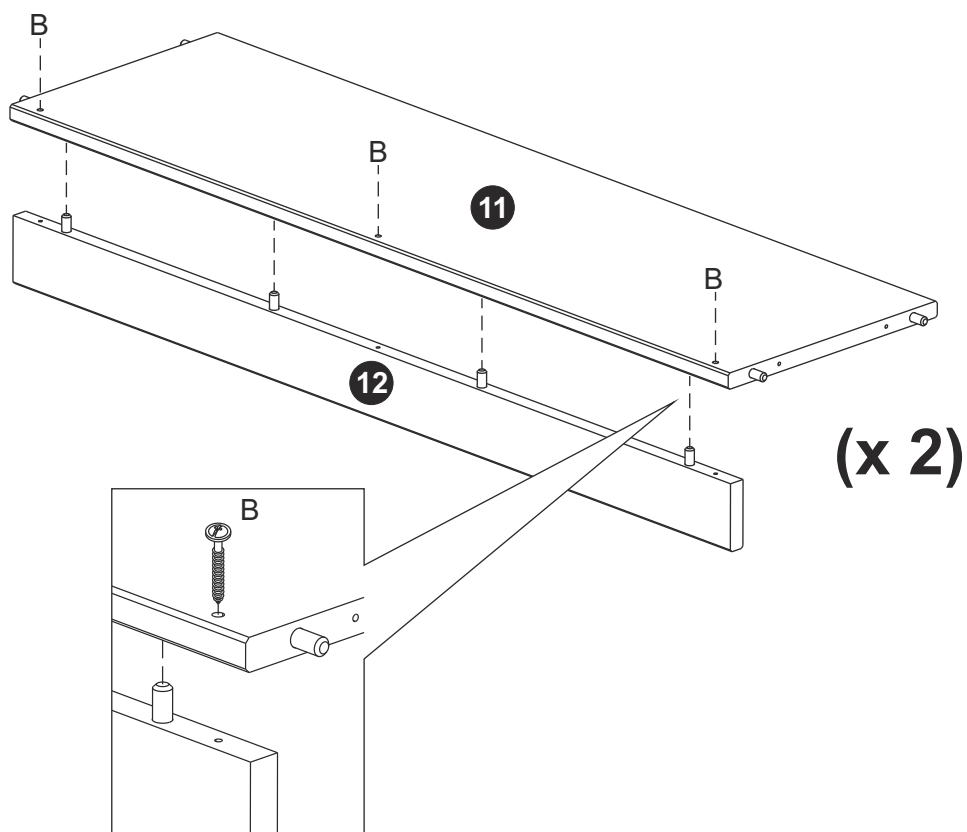

# ASSEMBLY INSTRUCTIONS

3

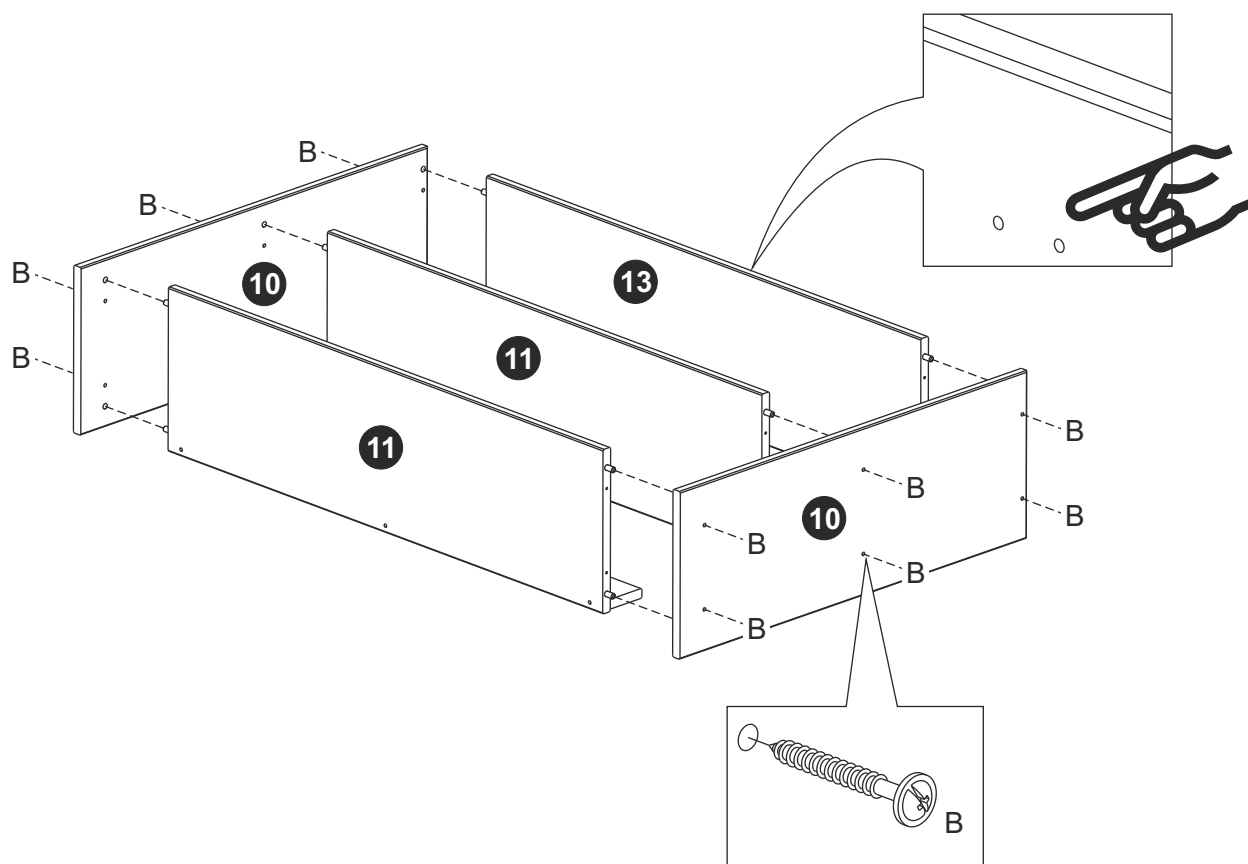

4

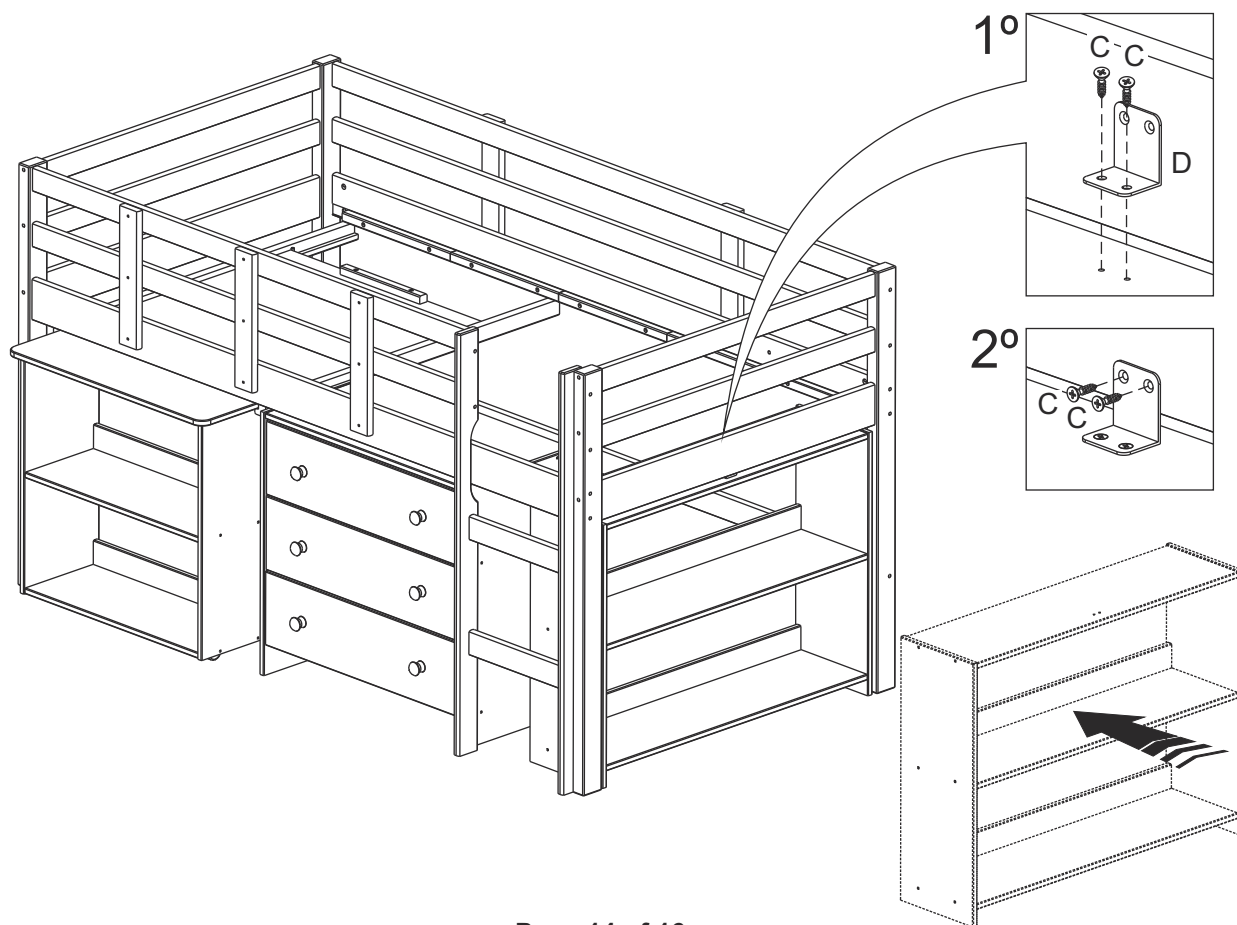

# BOOKCASE ASSEMBLY COMPLETE

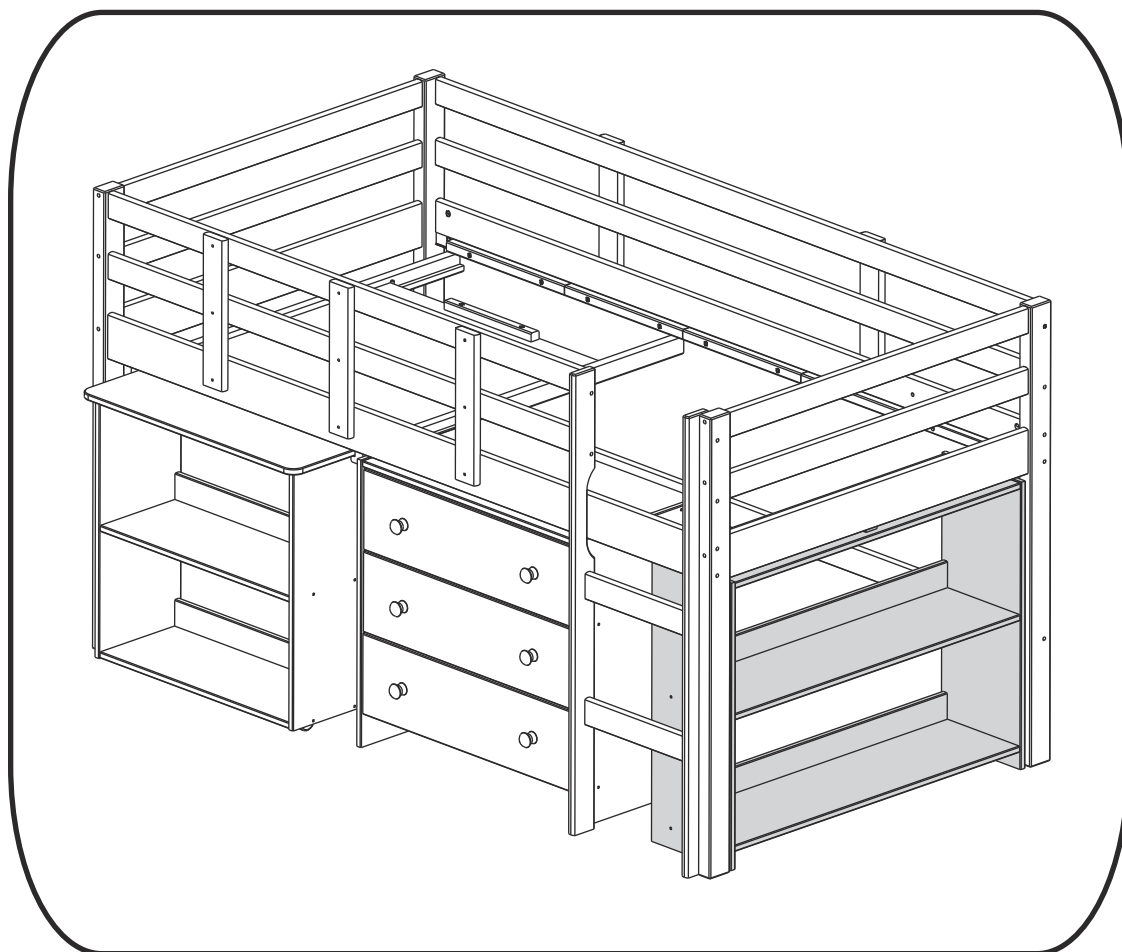

# ASSEMBLY COMPLETE

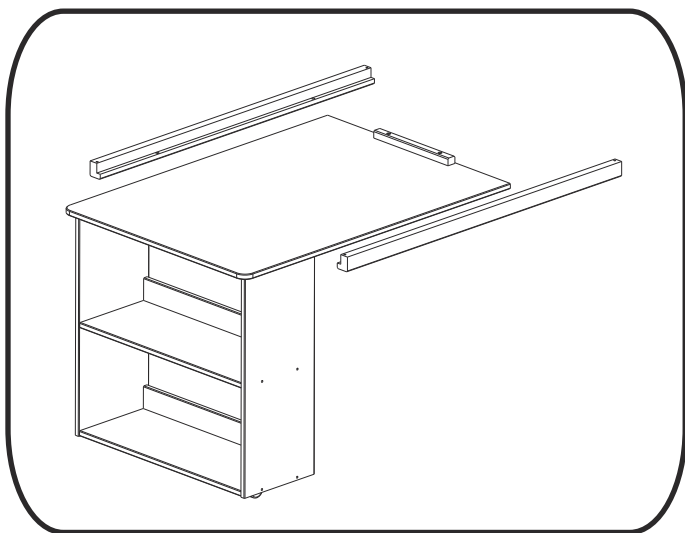

**CONGRATULATIONS, YOUR KIDS  
LOW LOFT BED WITH LADDER IS COMPLETE!**

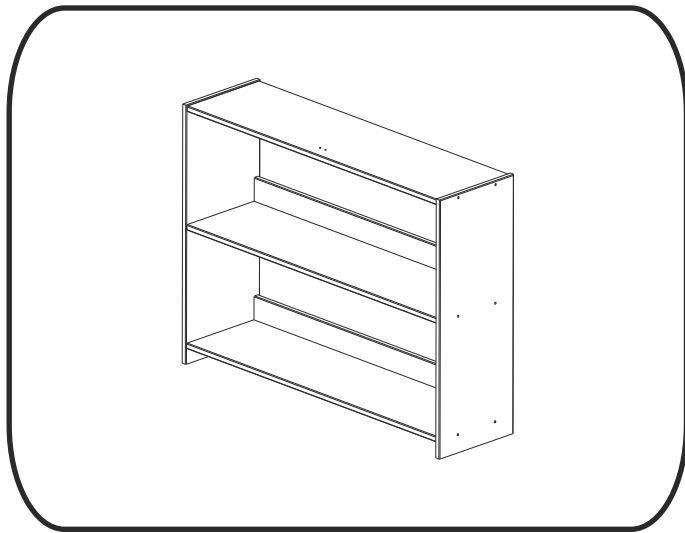

**CONGRATULATIONS, YOUR KIDS  
LOW LOFT BED WITH LADDER IS COMPLETE!**