

FULL / QUEEN / KING BED ASSEMBLY INSTRUCTIONS

BOX #1:

A. HEADBOARD 1 PC

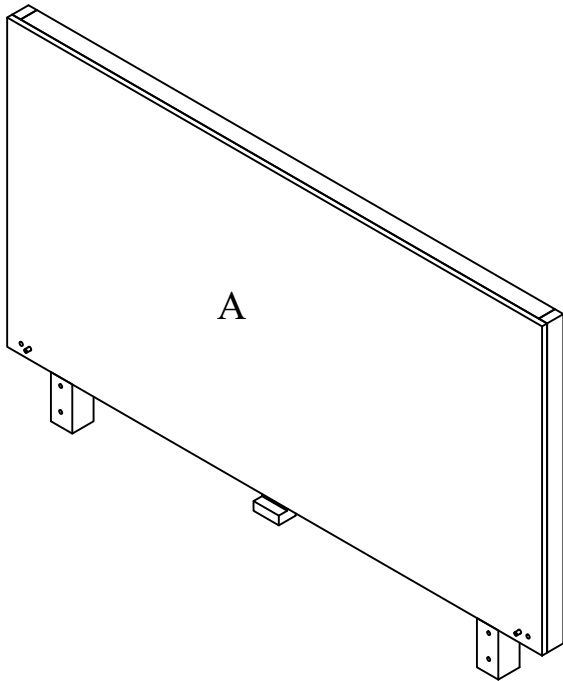

BOX #3:

D. SIDE RAIL 2 PCS

E. CENTER SLAT SUPPORT 1 PC

F. SUPPORT LEG 3 PCS

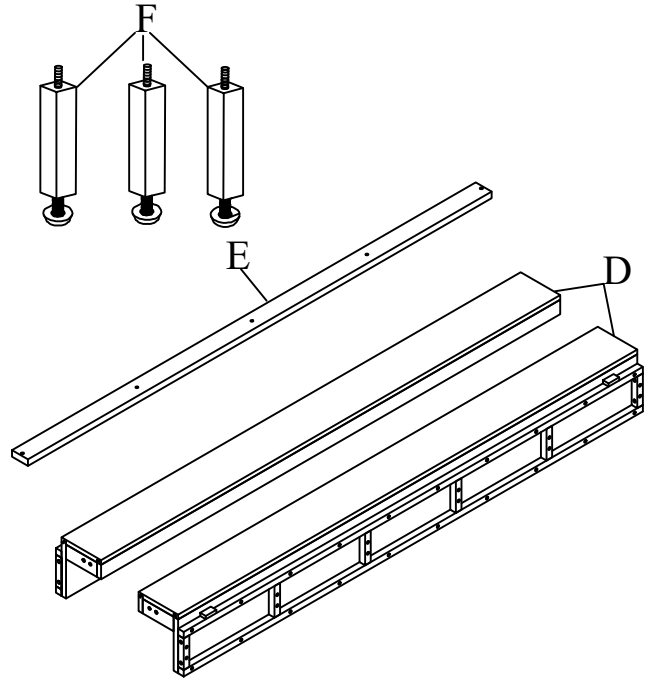

BOX #2:

B. FOOTBOARD 1 PC

C. SLAT ROLL 1 SET

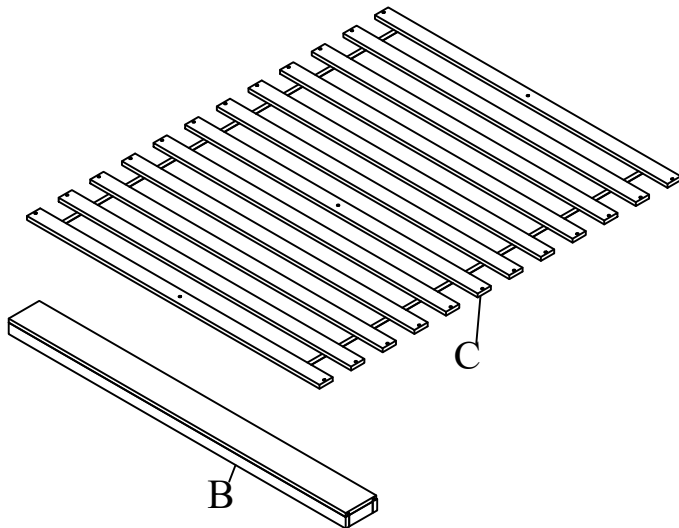

HARDWARE PACKED IN BOX #2

1	ALLEN BOLT (M8X90)		2 PCS
2	ALLEN BOLT (M8X40)		10 PCS
3	SPRING WASHER (M8X13)		12 PCS
4	FLAT WASHER (M8X16)		12 PCS
5	WOOD SCREW (M4X30)		6 PCS
6	ALLEN KEY		1 PC

TOOL REQUIRED
PHILLIPS HEAD SCREW DRIVER
(NOT PROVIDED)

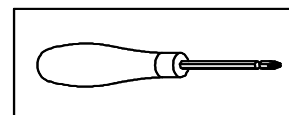

MELBOURNE BED FULLY ASSEMBLED

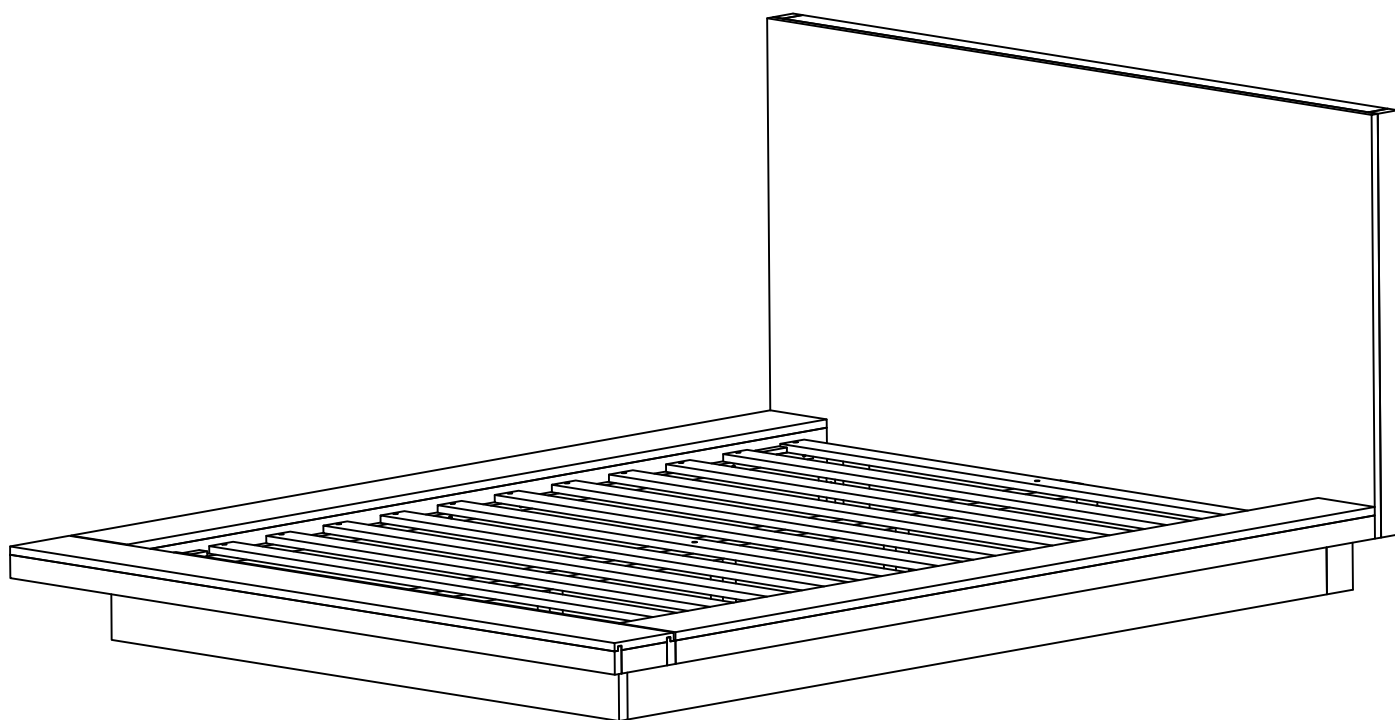

STEP 1:

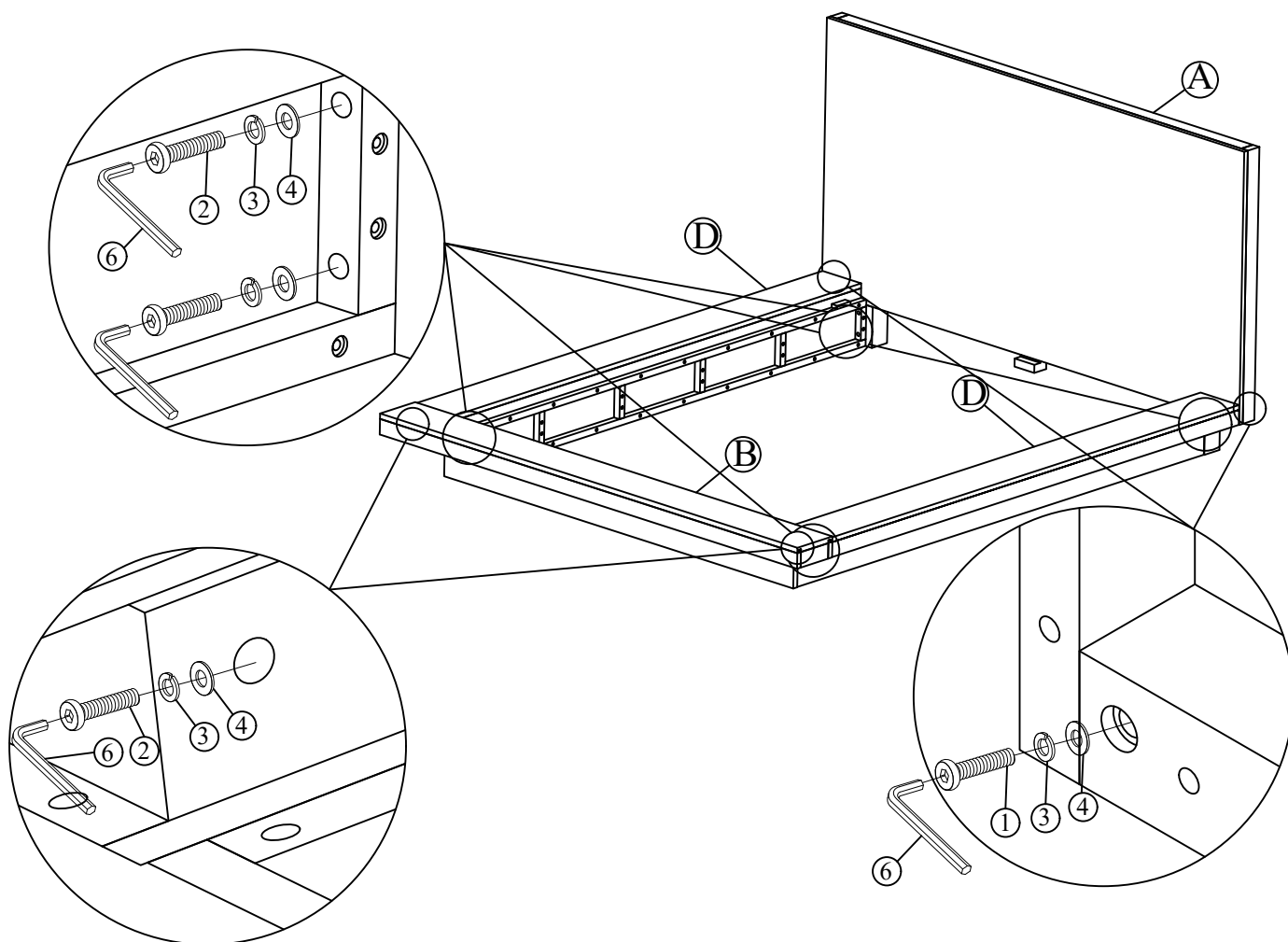

STEP 2:

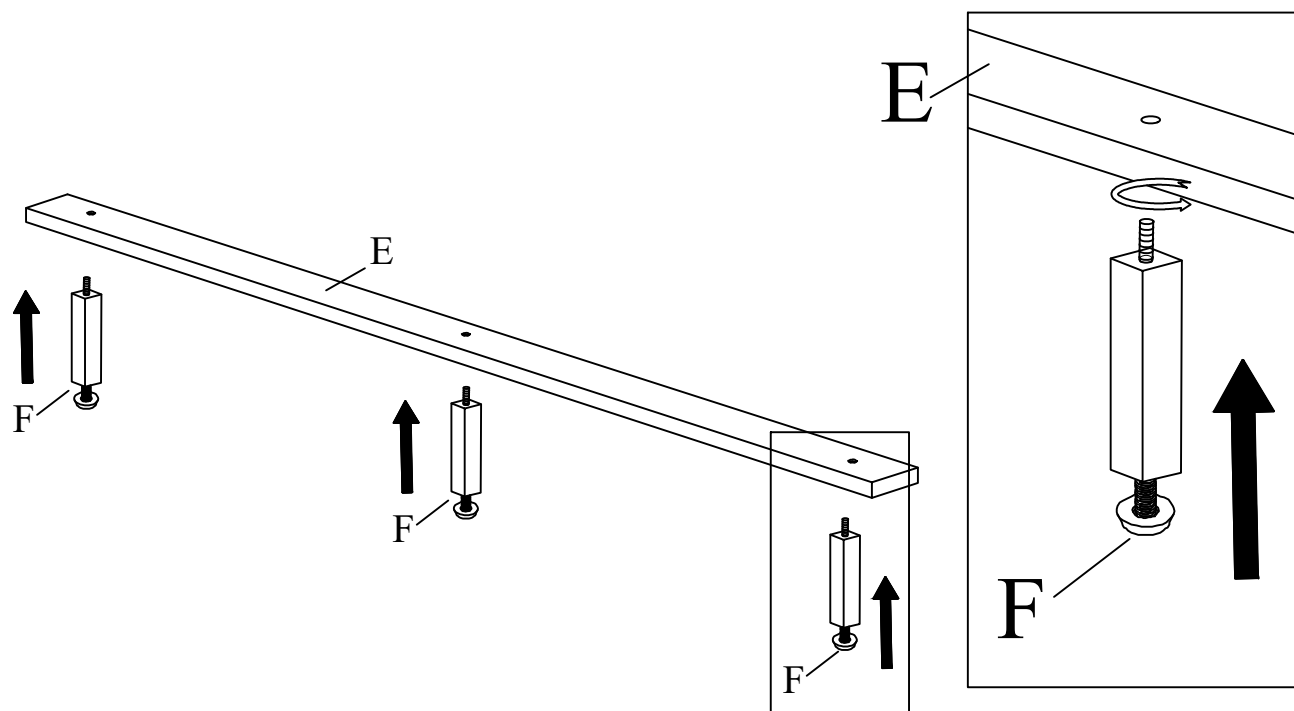

STEP 3:

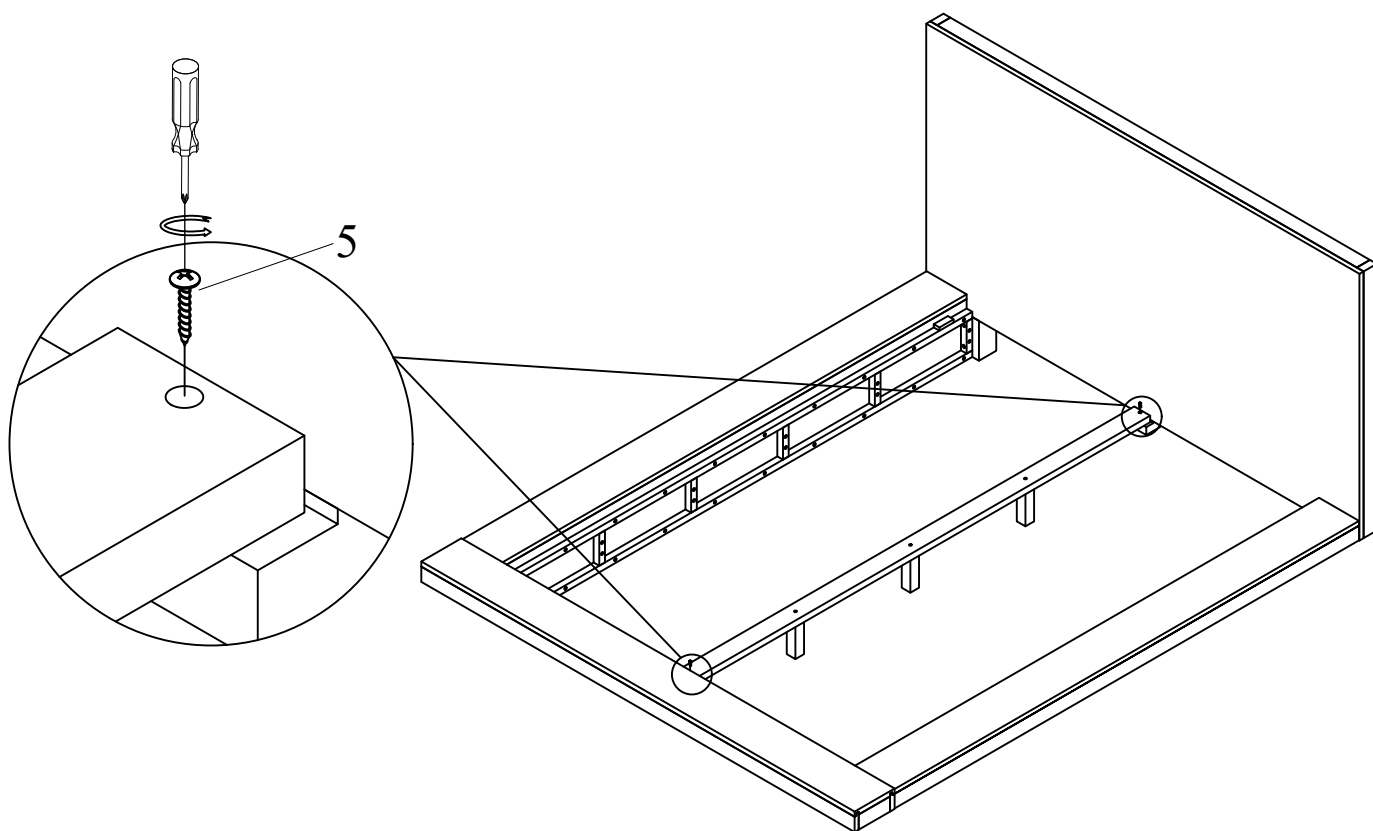

STEP 4:

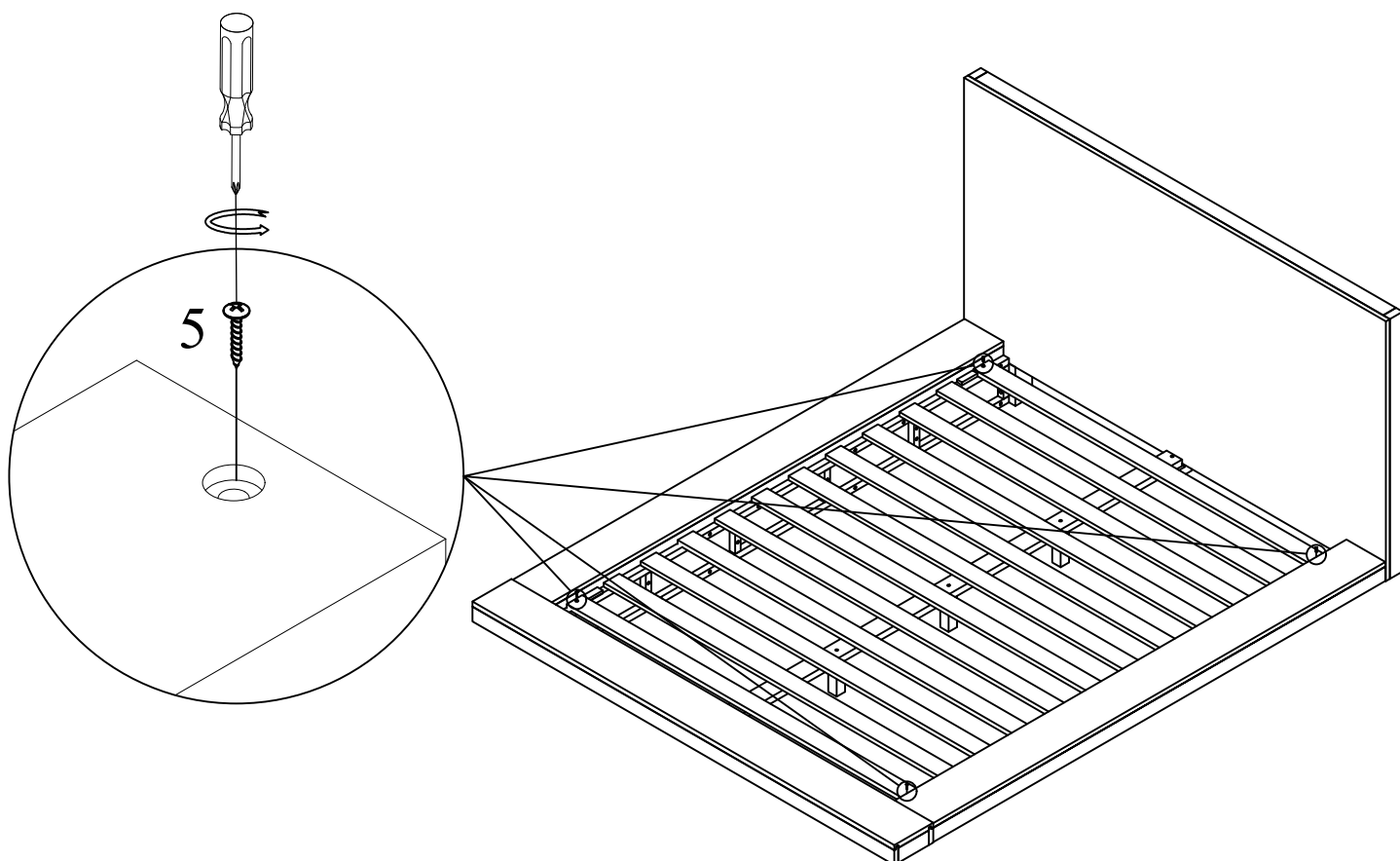

ASSEMBLY COMPLETE

INSTRUCTIONS FOR ADJUSTING LEVELER :

POSITION THE BED IN YOUR
SPACE AND LOCATE THE
LEVELER UNDER EACH SUPPORT
LEG. TURN THE LEVELER
COUNTER-CLOCKWISE TO
EXTEND THE LEVELER AND
CLOCKWISE TO RETRACT IT.

ADJUST EACH LEVELER UNTIL
EACH SUPPORT LEG IS APPLYING
EQUAL, UPWARD PRESSURE ON
THE SUPPORT SLAT.

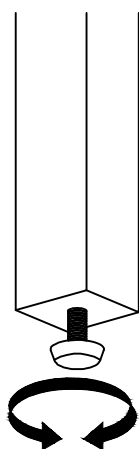

MAINTENANCE INSTRUCTIONS:

REMOVE YOUR MATTRESS, AND BOX
SPRING IF APPLICABLE, BEFORE
MOVING YOUR BED.

LIFT YOUR BED WHEN MOVING IT;
DRAGGING CAN DAMAGE THE
SUPPORT LEGS.

RE-ADJUST THE LEVELERS AFTER
MOVING YOUR BED.