

CARE AND MAINTENANCE

Always use felt pads under all articles to prevent discoloration or softening of the lacquer. Plastic and rubber bases on items can discolor wood. Wipe up spills immediately and avoid common hazards such as hot dishes, harsh solvents and abrasives. Cleaning should be done with a soft lint free cotton cloth dampened with water or furniture polish. On highly used surfaces we recommend applying a quality paste wax which should be used on a regular basis to provide additional protection from scratches and spills. How often you apply the wax depends on how much wear the furniture receives.

NOTICE

- * Please make sure that you have all parts indicated before you begin assembly of this item
- * This item should be assembled on a soft surface to prevent scratching the finish during assembly
- * This item may require periodic tightening

Part List and Hardware List

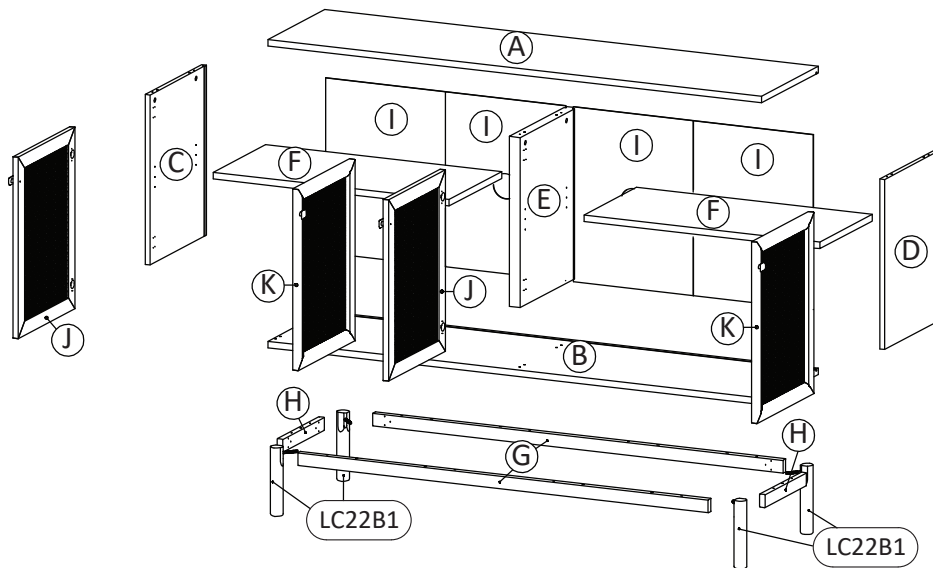

 ø 6 x 35 mm HW7x8	 ø 15 mm HW8x24	 ø 8 x 30 mm HW9x4	 M 7 x 50 mm HW10x4	 L 4 HW11x1	 M 6.4 x 53 mm HW12x16
 M 3.5 x 15.5 mm HW19x14	 M 4 x 16 mm HW14x4	 M 4 x 25 mm HW21x2	 HW22x2	 M 4.5 x 12.5 mm HW23x4	 5003 HW US11x1
 HW BC410x4	 HW HS26Ax8				

SAFAVIEH

FURNITURE

Model# MED9611

Product Dimensions: 63.1"W x 16.3"D x 31.7"H

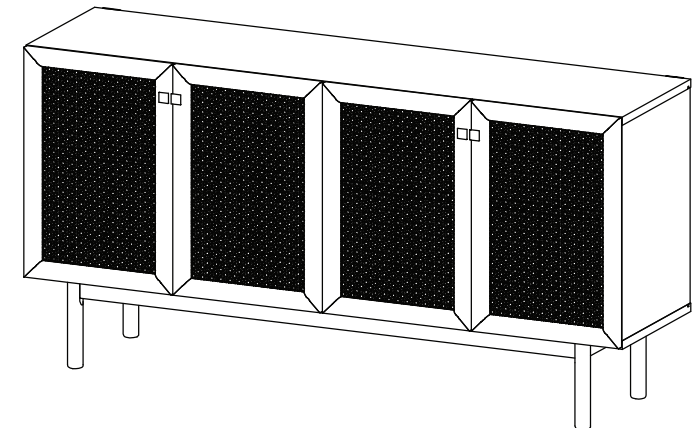

WARNING :
WEIGHT CAPACITY: 68 LBS.
DO NOT STAND ON TV STAND

Part List & HW for Multi-Box Items

Piece	Description	Qty	Carton Call
A	Top Board	1	2 of 2
B	Bottom Board	1	2 of 2
C	Side Board Left	1	2 of 2
D	Side Board Right	1	2 of 2
E	Centre Board	1	1 of 2
F	Adjustable Shelf	2	1 of 2
G	Bottom Skirt 1	2	2 of 2
H	Bottom Skirt 2	2	2 of 2
I	Back Board	4	2 of 2
J	Frame Door Left	2	1 of 2
K	Frame Door Right	2	1 of 2
LC22B1	Leg	4	1 of 2

Piece	Description	Qty	Carton Call
HW1	Cambolt	6	1 of 2
HW2	CamLock	6	1 of 2
HW3	Dowel	22	1 of 2
HW4	Screw M 7 x 50 mm	6	1 of 2
HW5	Allen Key	1	1 of 2
HW6	Screw M 6.4 x 53 mm	12	1 of 2
HW7	Shelf Support	8	1 of 2
HW8	Screw M 4 x 16 mm	24	1 of 2
HW9	Nut	4	1 of 2
HW10	Spring Washer	4	1 of 2
HW11	Wrench	1	1 of 2
HW12	Wedge	16	1 of 2
HW13	Screw M 3.5 x 15.5 mm	20	1 of 2
HW14	Handle	4	1 of 2
HW15	Screw M 4 x 25 mm	4	1 of 2
HW16	List Joint	2	2 of 2
HW17	Screw M 4.5 x 12.5 mm	48	1 of 2
HW18	Fisher	4	1 of 2
HW19	Screw M 6 x 12.5 mm	14	1 of 2
HW20	Screw Cover	4	1 of 2
HW21	Screw Cap	2	1 of 2
HW22	Tip Protector	2	1 of 2
HW23	Screw M 3.5 x 32 mm	4	1 of 2
HW US11	Anti Deflection Bar	1	2 of 2
HW BC410	Corner Brace	4	1 of 2
HW HS26A	Hinge	8	1 of 2

PREPARATION

Before beginning assembly of product, make sure all parts are present. Compare parts with package contents list and hardware contents list.

If any part is missing or damaged, do not attempt to assemble the product.

Estimated Assembly Time: 60 minutes.

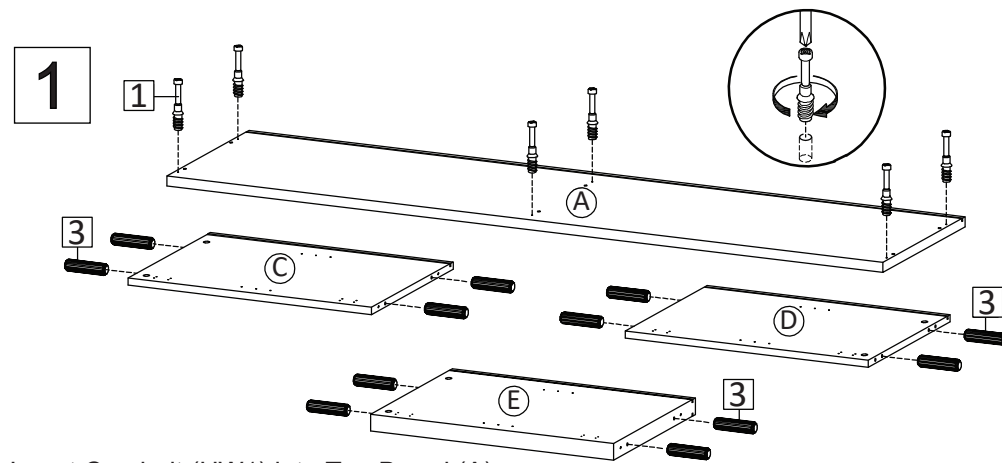

Insert Cambolt (HW1) into Top Board (A)
Insert Dowel (HW3) into Center Board (E) ,
Side Board Left (C) and Side Board Right (D)

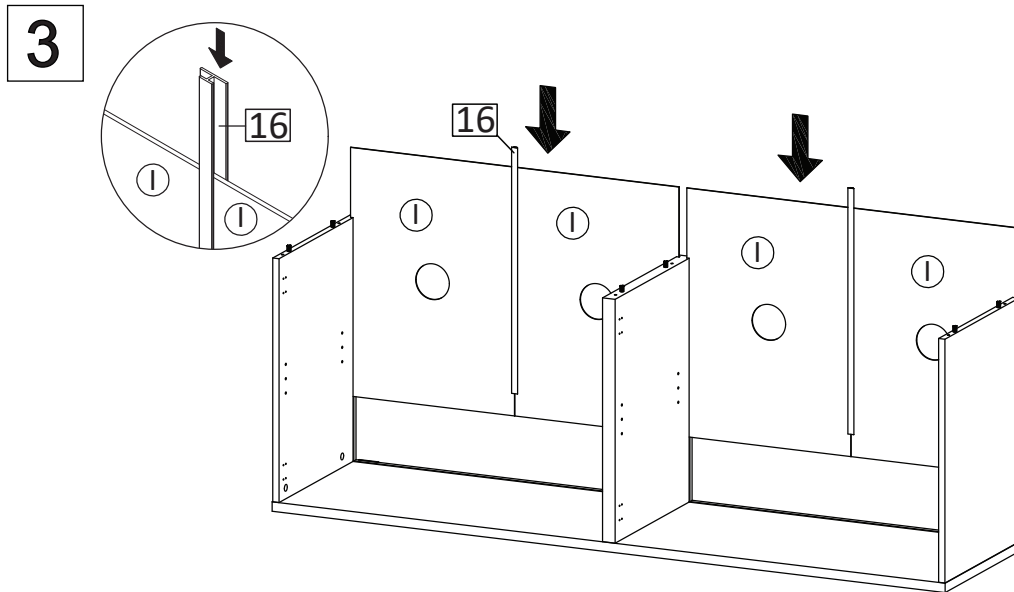

Insert Backboard (I) as figure and slide in the List Joint (HW16) in between two backboard.

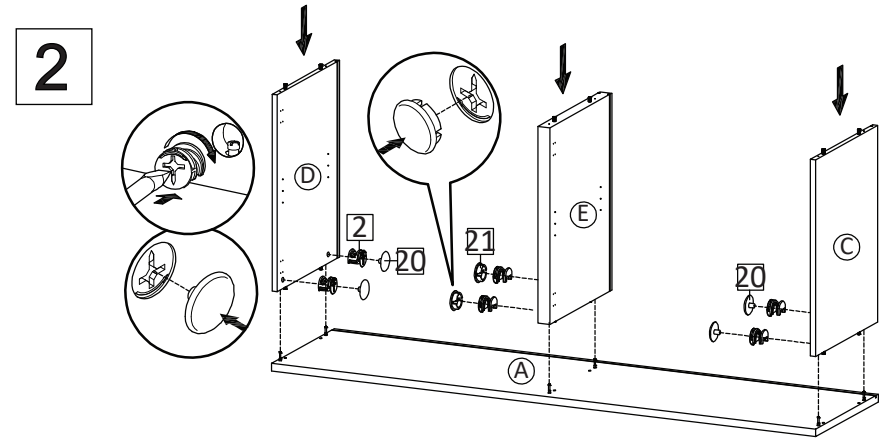

Attach Side Board Left (C) , Side Board Right (D), Center Board E
into Top Board (A). Insert Camlock (HW2) then tighten using screwdriver.
Put Screw Cover (HW20) over the screw on Side Boards (C) & (D),
and put Screw Cap (HW21) over the screw on Center Board (E).

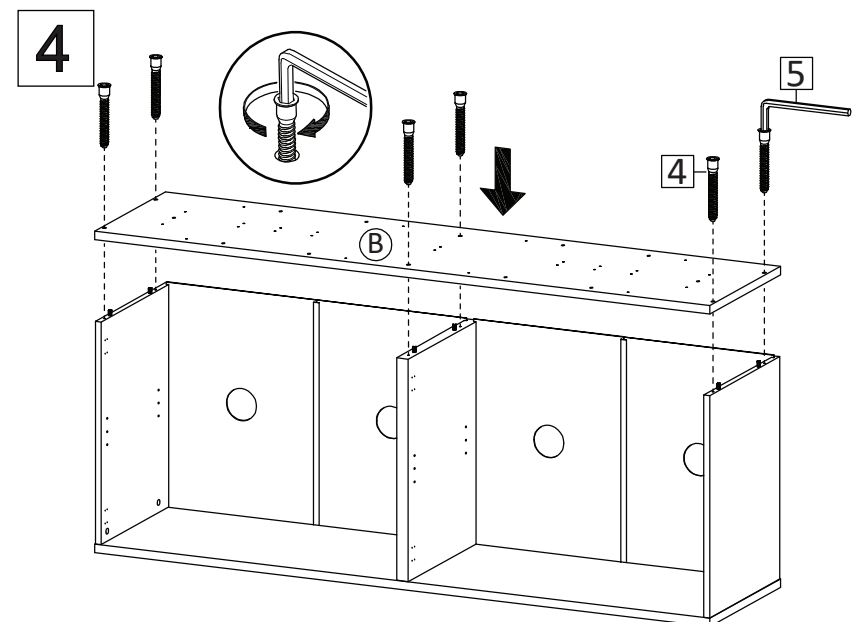

Put Bottom Board (B) and secure with Screw M7x50 (HW4) ,
tighten screws using Allen Key (HW5)

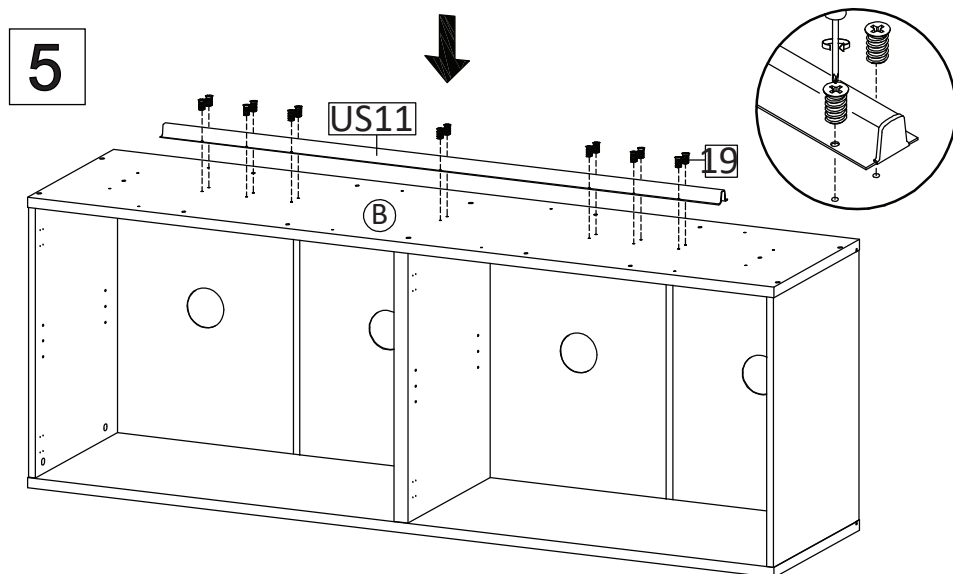

Place Anti Deflection Metal Bar (HW US11) ,
secure with screw M6x12,5 (HW19) using screwdriver.

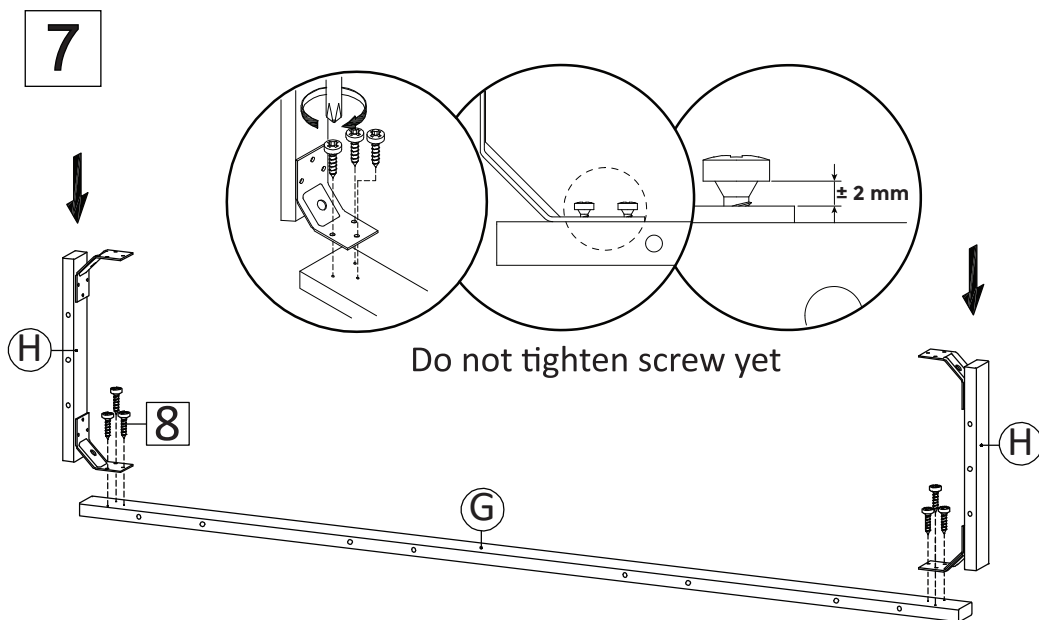

Combine the Bottom Skirt 2 from step 6 with Bottom skirt 1 (G),
using Screw M4x16 (HW8). Do not overtight screw yet, leave around 2mm gap.

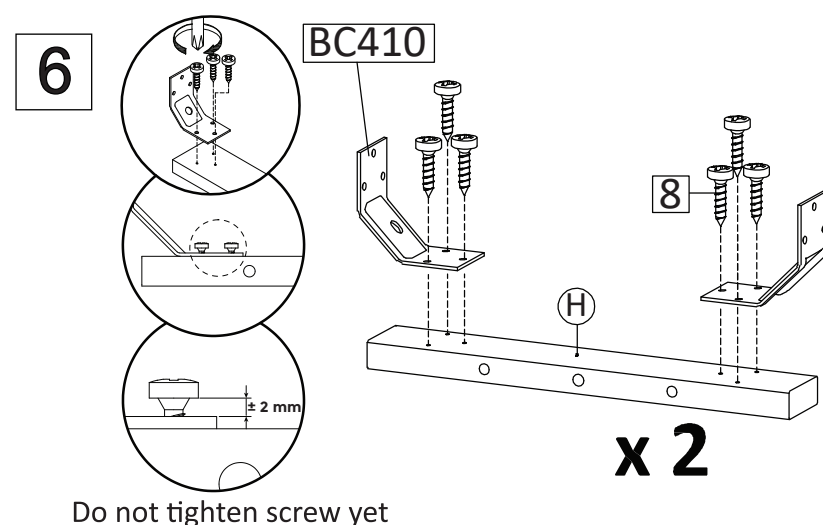

Do not tighten screw yet

Now let's combine the bottom skirt. Start with installing Corner Brace (HW BC410)
into Bottom Skirt 2 (H) using Screw M4x16 (HW8). Do not overtight screw yet,
leave around 2mm gap.

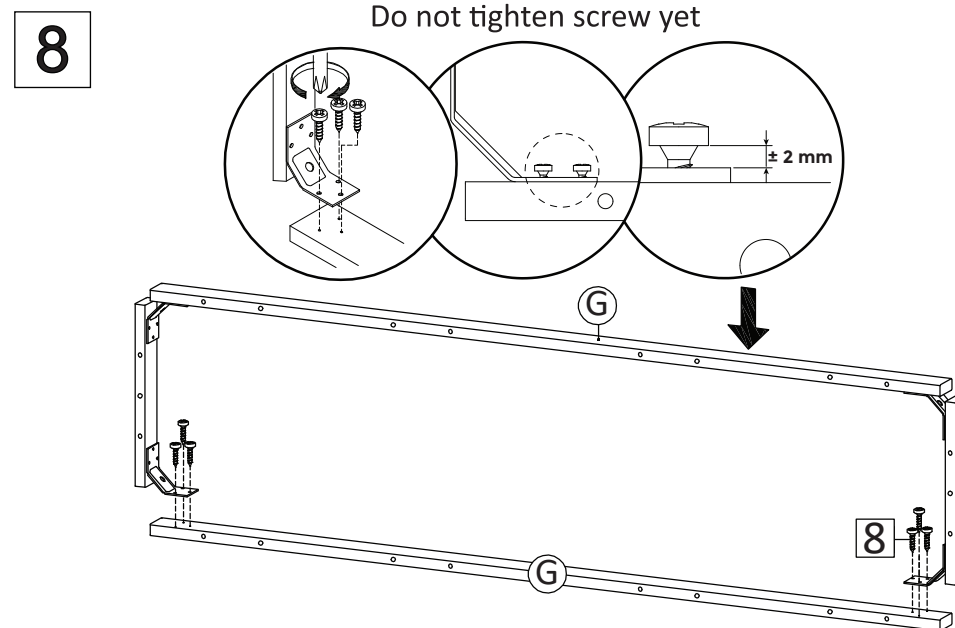

Combine components from step 7 with remaining Bottom skirt 1 (G),
using Screw M4x16 (HW8). Do not overtight screw yet, leave around 2mm gap.

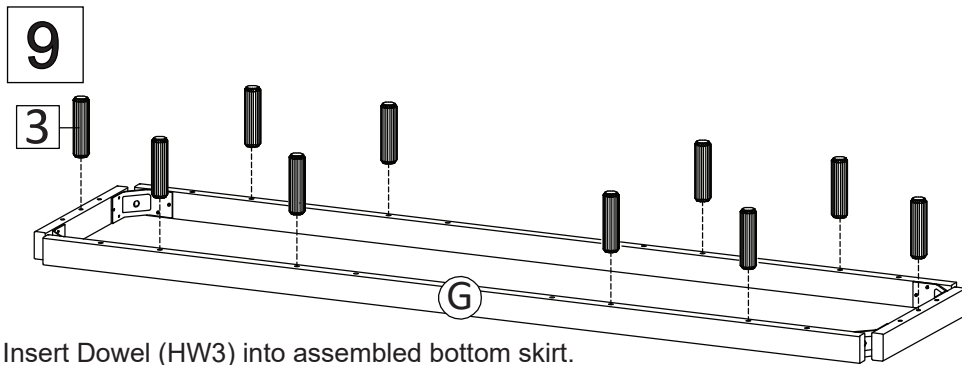

Insert Dowel (HW3) into assembled bottom skirt.

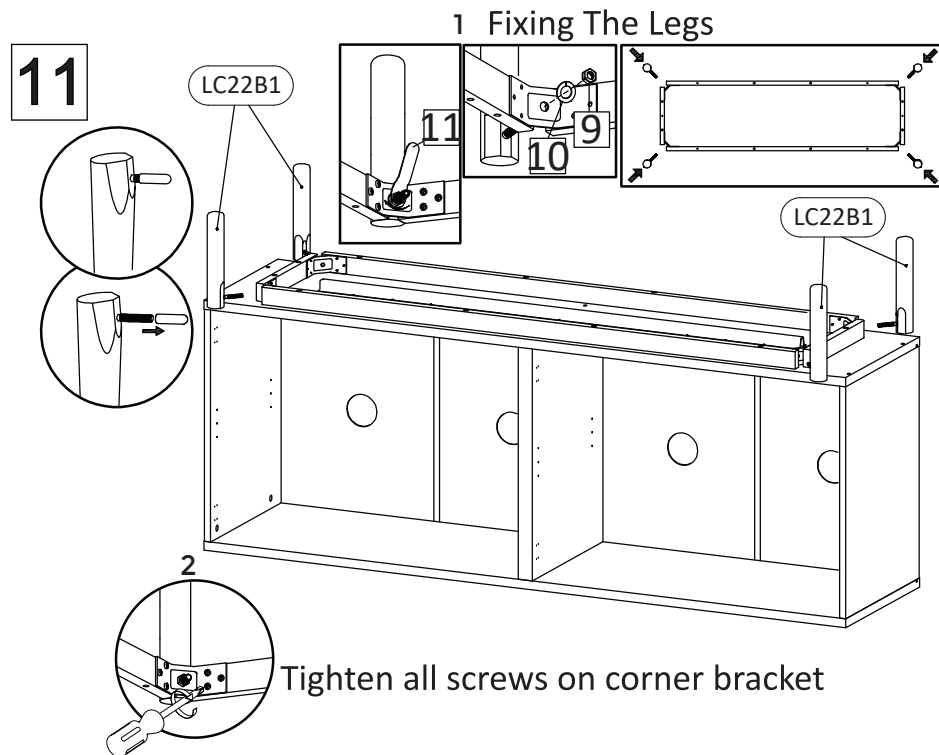

Remove plastic cap from Legs. Insert the bolt of the Leg (LC22B1) into hole of corner brace as shown in figure. Insert Spring Washer (HW10) first into the hanger bolt of leg, then followed by Nut (HW9), tighten all the nuts using provided Wrench (HW11). Ensure that all legs has been tightened, then continue with tightened all screws on the corner brace.

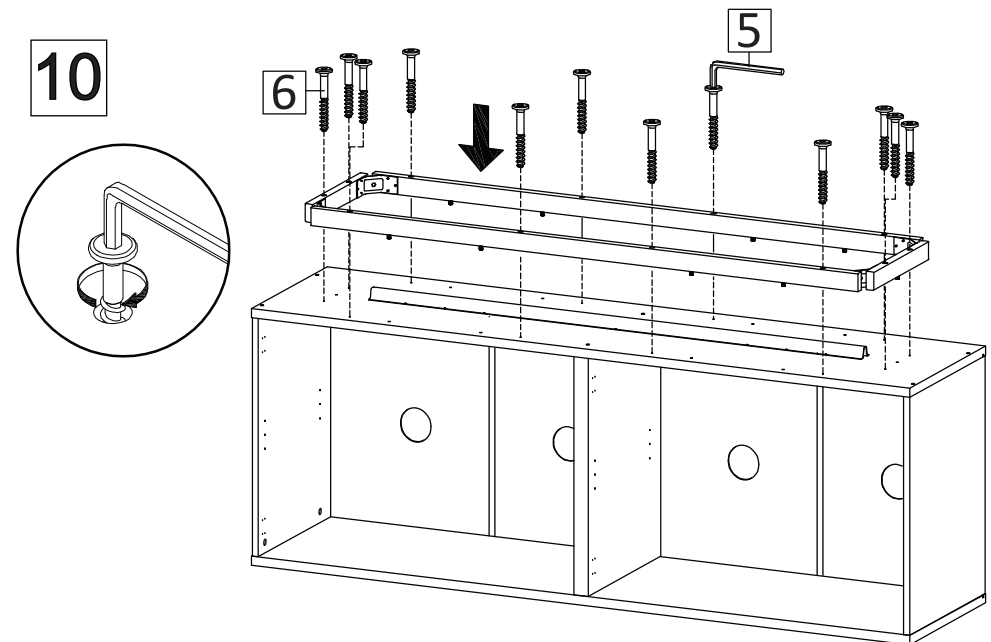

Bring the assembled bottom skirt and insert into Bottom Board of the cabinet.
Secure with Screw M6.4 x 53 using Allen Key (HW5)

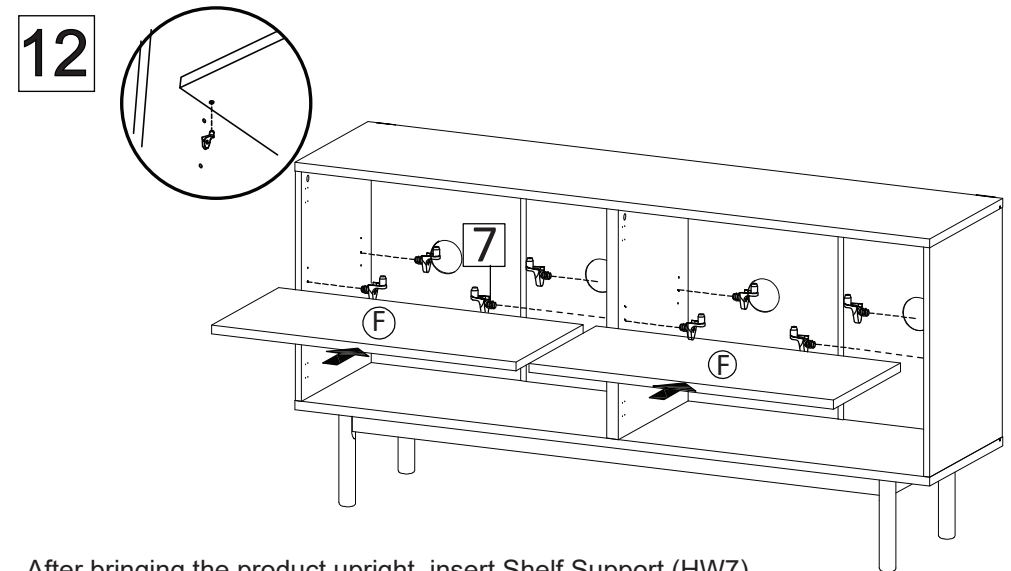

After bringing the product upright, insert Shelf Support (HW7) into the holes on Sideboard & Centerboard, on the desired level. Then place the Adjustable Shelf (F) by inserting the hole on the shelf into the shelf support

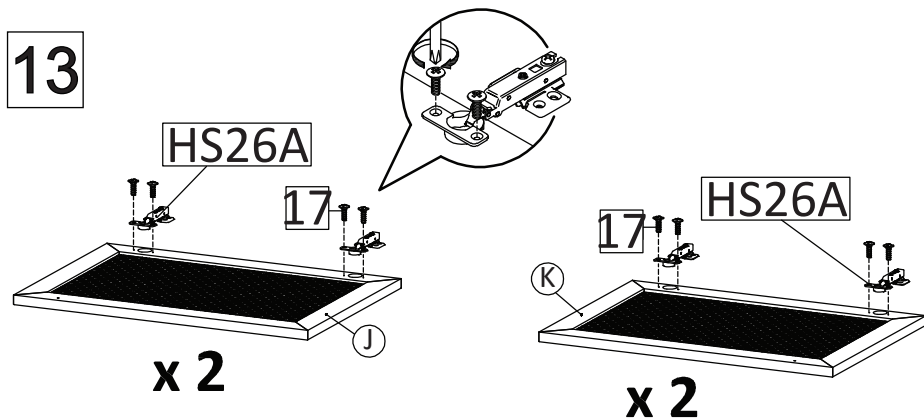

Insert Hinge (HW HS26A) into pre-hole in Frame Door Left (J) and Frame Door Right (K). Secure with Screw M4.5 x 12.5 (HW17).

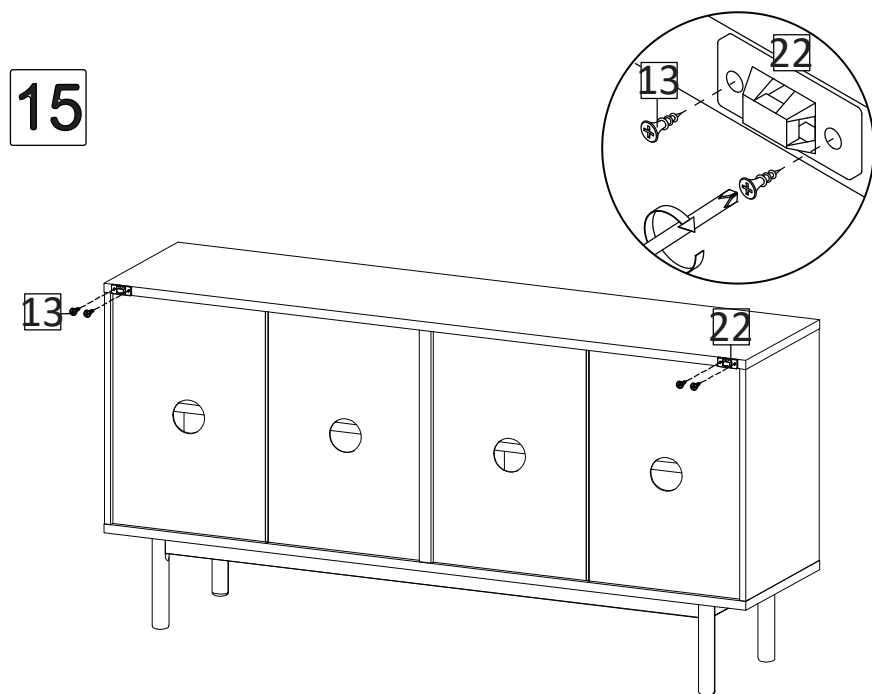

Attach Tip Protector (HW22) into back of Top Board using Screw M3.5x15.5.

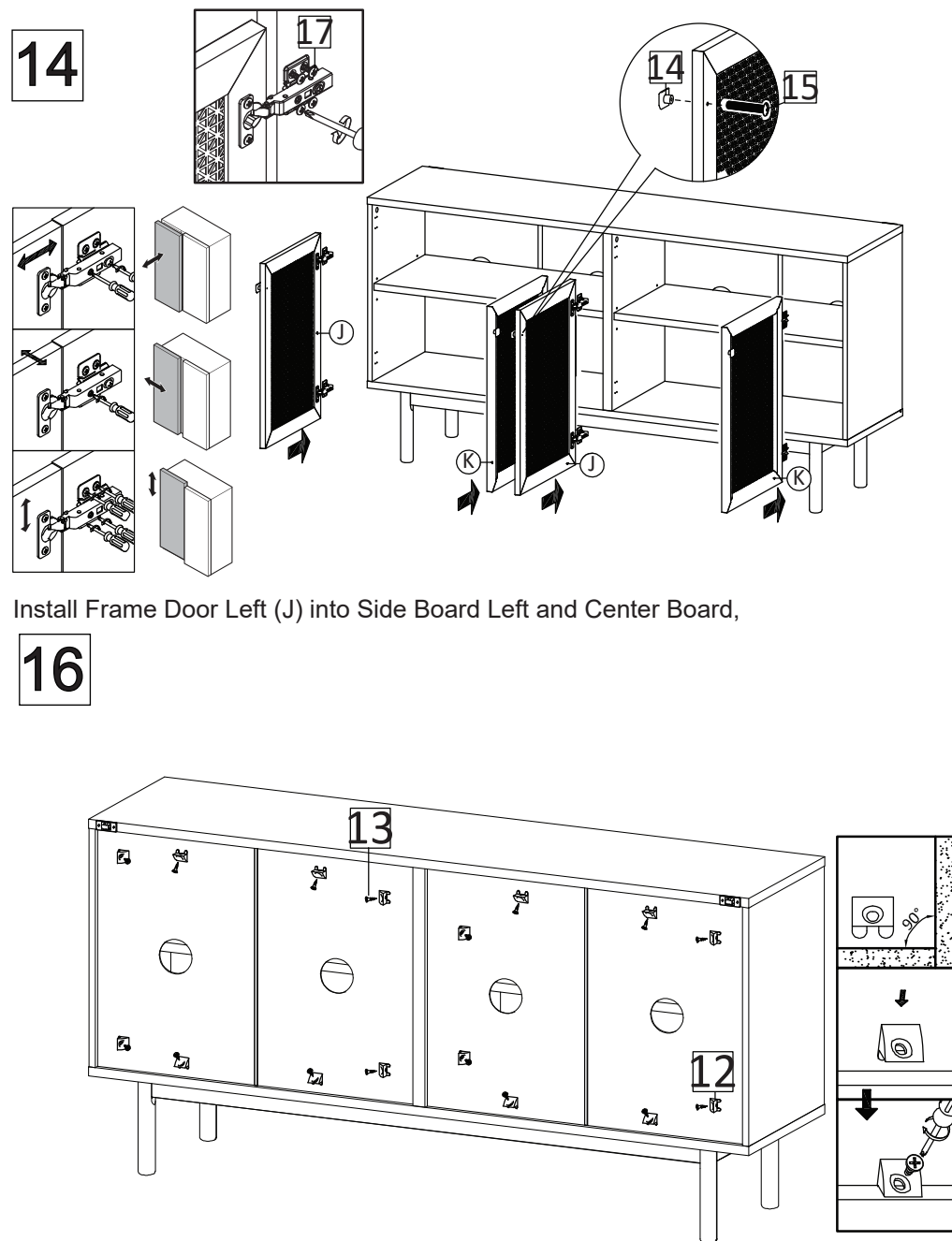

Install Frame Door Left (J) into Side Board Left and Center Board,

Use Wedge (HW12), Screw M 3.5 x15.5 (HW13) to tighten the back of media stand by using screwdriver.

17

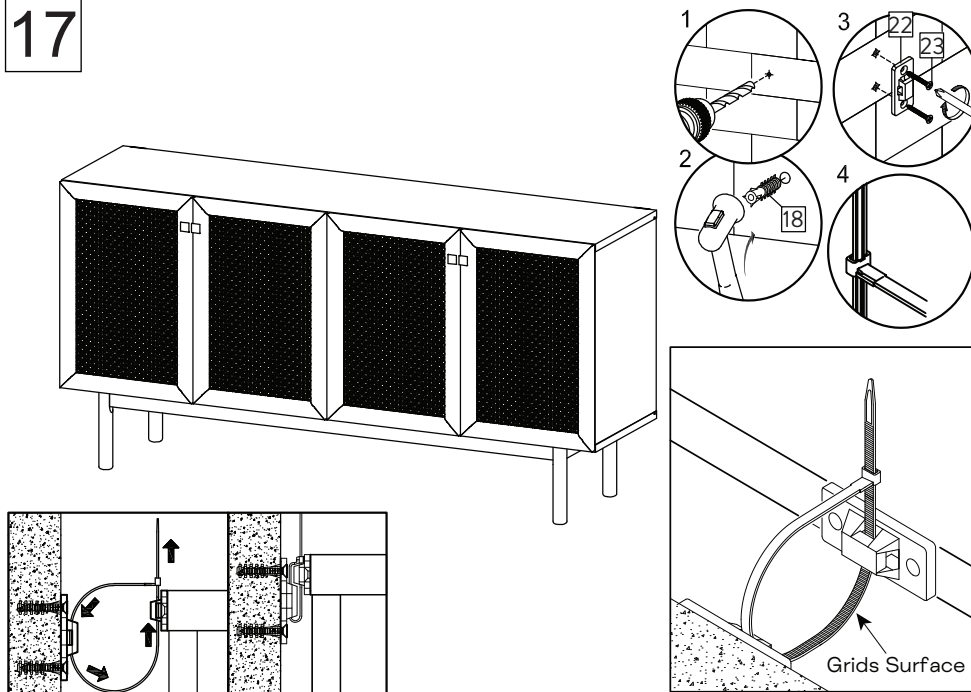

18

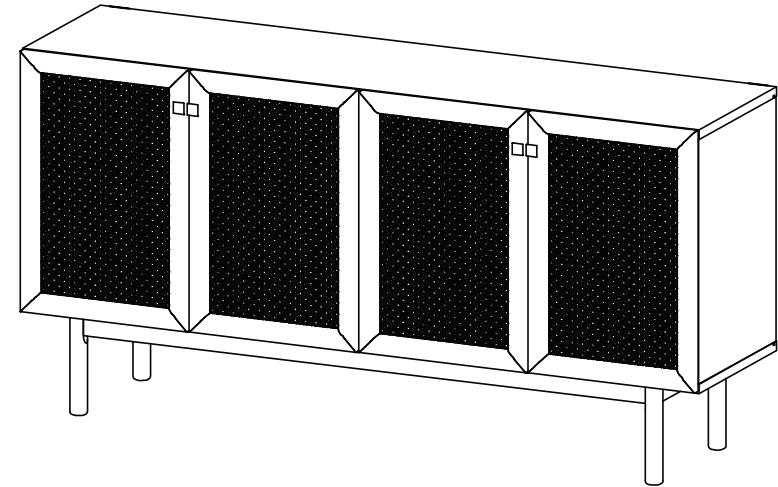

The unit needs to be secured against wall using tip anti tip kit.

Please Consult your local hardware store to get advice of appropriate screw and fischer according to your wall type. Drill pre-holes on wall as shown in fig(2) for the tip protector. Repeat the step with same distance of both tip protector attached in step 15.

Insert fischer to each hole on the wall using hammer.

Secure the Tip Protector (HW22) using Screw M3.5x32mm (HW23).

Make a loop by inserting the provided Fastener / Cable ties into both tip protector on wall and on backside of product, with the grids surface facing inside of loop.

Fasten the cable ties until position of product as close as possible to wall.

Repeat on the other side.

HOW TO ADJUST HINGES

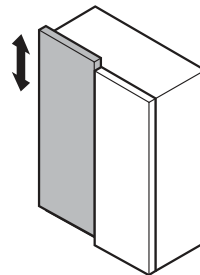
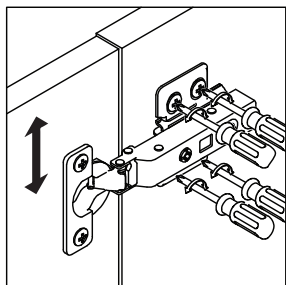
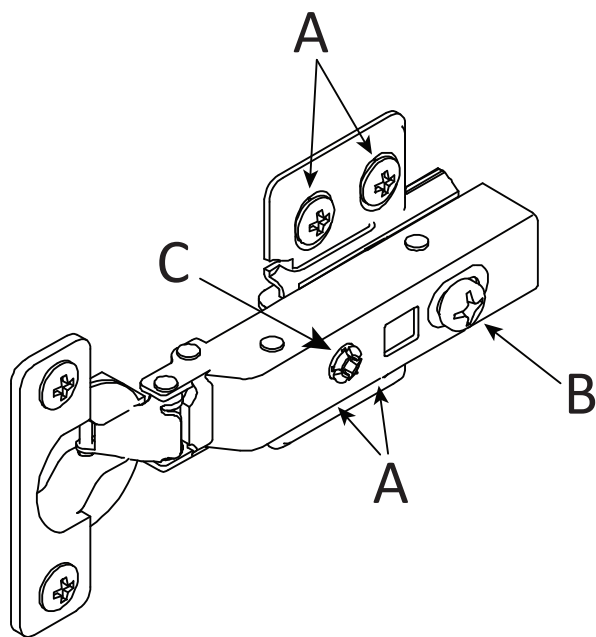

To adjust the vertical height.

Loosen the four screws "A" on both hinges. Two of them are usually in slotted holes which allows you to adjust up or down by few mm. Then tighten back up.

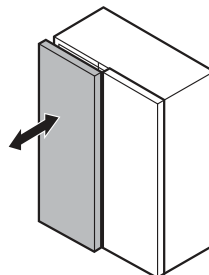
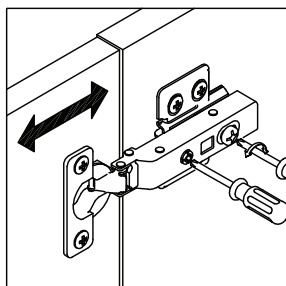

To adjust depth.

Loosen screw "B" and adjust door, if the door can not be adjusted, please loosen screw "C", then try again. Tighten screw "B" and "C".

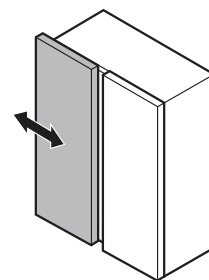
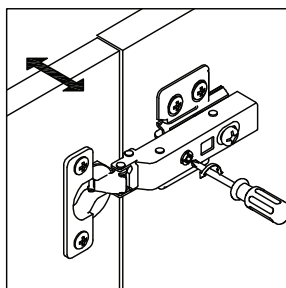

To adjust side ways.

Turning the screw "C" on BOTH hinges on each door.