

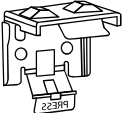

CORDLESS BAMBOO SHADE INSTALLATION INSTRUCTIONS

CHECK COMPONENTS

Shade Width Size	 Mounting Bracket	 Screw	 Anchor
Up to 35in.	2	4	4

PREPARE NECESSARY TOOLS

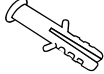
- Screw Driver	- Measuring Tape
- Pencil	- Drill / Drill Bits
- Hammer	- Ladder

STEP 1 – DETERMINE INSIDE / CEILING, FLUSH, WALL or OUTSIDE MOUNT

Inside/Ceiling or Flush Mount

(A minimum 1 inch depth is required or 2 inches depth for flush mounts.)

1. Position brackets approximately 2 inches from the ends of the headrail.
2. Mark the bracket locations upward through the holes with a pencil.
3. Use the screws and anchors in the top bracket holes to attach your brackets.

Step 1

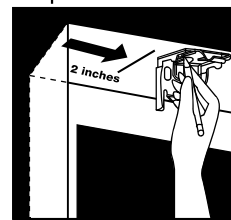

Step 2

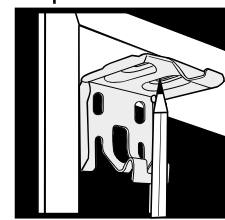

Step 3

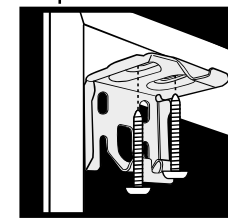

Wall or Outside Mount

(A minimum 1/2 inch flat wall space is necessary)

1. Position brackets approximately 2 inches from the ends of the headrail. If your shade had a third bracket provided, position middle brackets to align with pre-drilled holes in the headrail.
2. Mark the bracket locations through the rear holes with a pencil.
3. Use the screws and anchors in the rear bracket holes to attach your brackets.

Step 1

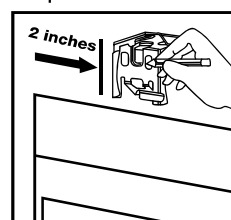

Step 2

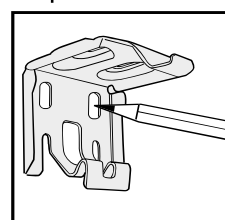

Step 3

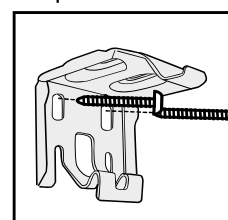

STEP 2 – ATTACHING SUPPORT RODS

Swing the support rods into the square brackets that are attached to the back of shade. Snap on place by pressing firmly and click support rods together.

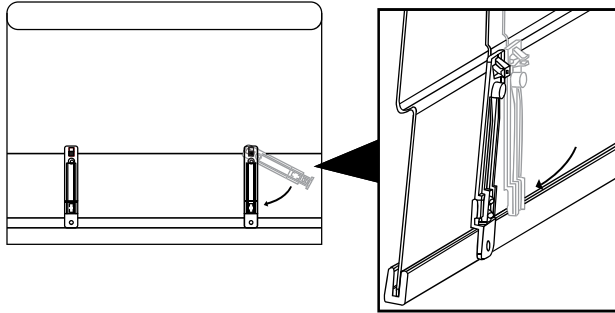

STEP 3 – MOUNTING THE SHADE

1. Attach front lip of the headrail into the front hook of each mounting bracket.
2. Rotate and push headrail back into the mounting brackets until it clicks into place.

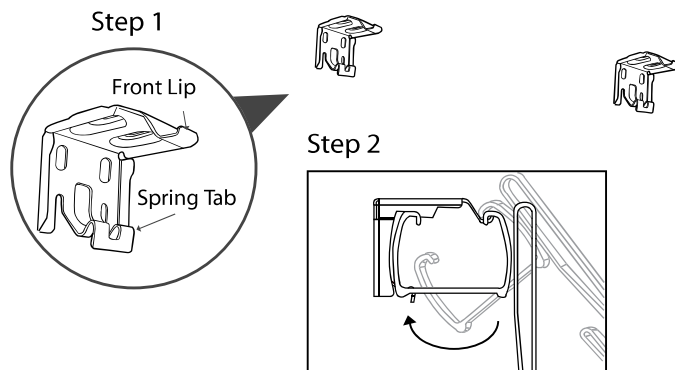

STEP 4 – HOW TO OPERATE

To Lower The Shade:

Grip the bottom rail and slowly pull straight down.

To Raise the Shade:

Put one hand at the bottom rail (palm facing up) and lift slowly until the desired height is reached.

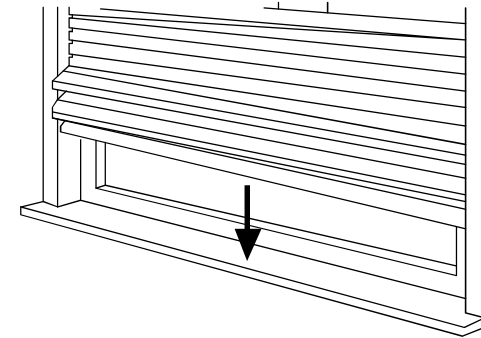

Important Note:

Always push and pull at the center of the shade to assure that the bottom of the shade remains even (i.e. parallel to the top of the shade). If the shade becomes uneven, slowly pull it all the way down, and then lift to the desired position. If your shade is stuck, carefully look at the back of your shade and untangle any cords that appear tangled.

CLEANING and CARE

To clean your shade, use a feather duster, microfiber cloth or vacuum lightly using the soft brush attachment.

Do not use any harsh chemicals or water to clean, natural bamboo wood material will be damaged over time from excessive moisture.