

ASSEMBLY INSTRUCTIONS

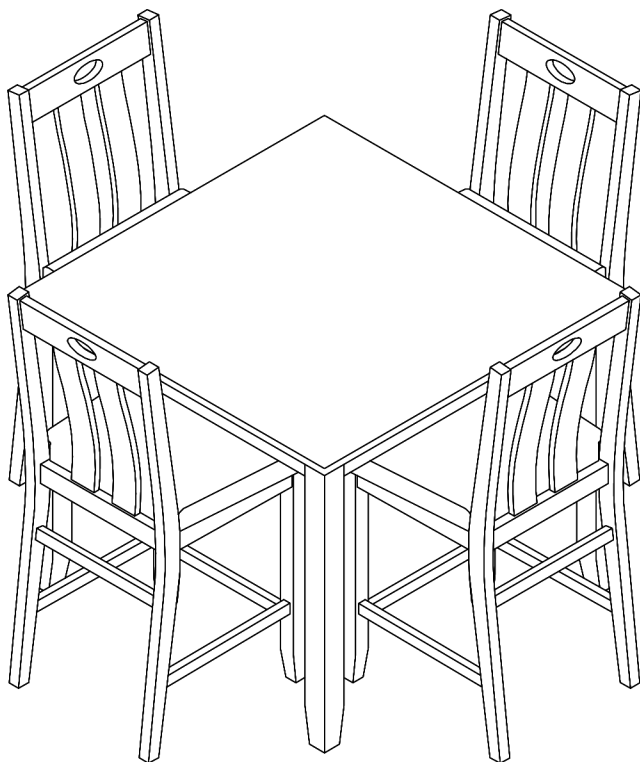

TOOLS REQUIRED



Allen Wrench

(Included)



**Phillips
Screwdriver**

(Not Included)

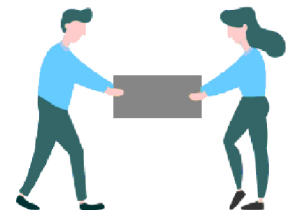

**2 - People
Recommended**

ASSEMBLY RATING



EASY —————> DIFFICULT

The Assembly Rating is a 5-point system showing the level of effort needed to assemble a specific product.



CHECK BEFORE STARTING

☐

Are you missing anything?

Double-check all parts, hardware and accessories listed are all accounted for.

☐

Check out our Quick Tips!

We recommend reviewing the pre-assembly handouts. Even experts need a refresher now and then!

☐

Should we send any replacements?

Are there any irregularities or flaws in the parts? We can send replacements!

☐

Prep Time!

Please review the assembly instructions and all diagrams prior to assembling.

PRE ASSEMBLY INTRODUCTION

We understand building ready-to-assemble furniture can be a challenging experience for some. To help avoid confusion, we have provided some helpful tips that may speed up the process.

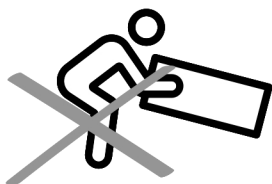

Teamwork

ALWAYS have at least two people to help with transporting and assembling the product to avoid potential injury and/or damage.

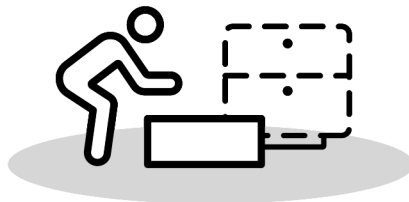
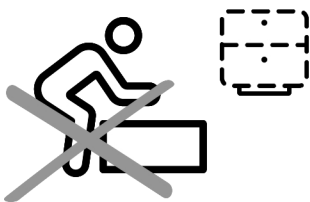

Suitable Location

Assembling near the area of the intended location is highly recommended.



Sufficient Space

Make sure you have enough space to move around during the assembly.

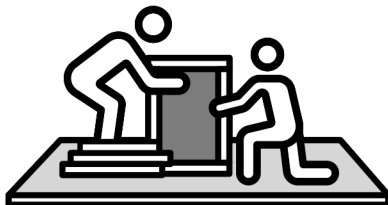

Avoid Scratches

Use cardboard, blankets or a carpeted area while assembling furniture to prevent to prevent scratches and damages.

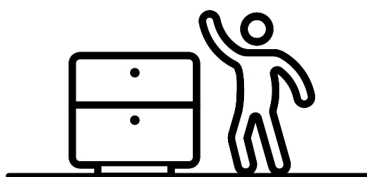
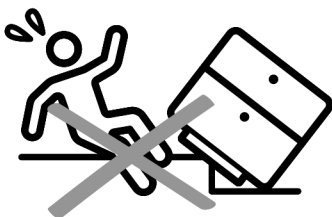

Flat Surface

Make sure the furniture rests on a flat and level surface with each leg evenly touching the floor.

ASSEMBLY AND CARE ADVICE



**FAILURE TO FOLLOW THE GUIDELINES BELOW MAY
RESULT IN INJURY AND/OR PROPERTY DAMAGE.**



Position each part correctly
and insert screws or bolts into
their respective holes.

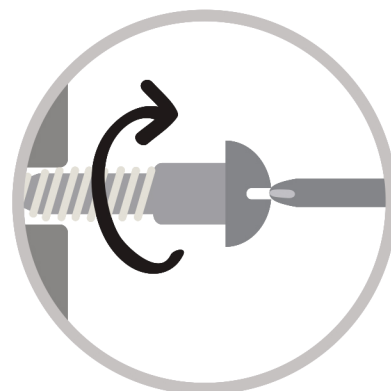

Turn clockwise to tighten and
only tighten when step is
completed or when instructed
to do so.



Use the appropriate hand tools
or power tools for assembly.
Select steps, such as tightening
screws and/or bolts, may require
hand tools to avoid causing
damage during assembly.



Save the instructions and store
any supplied tools for later
maintenance.

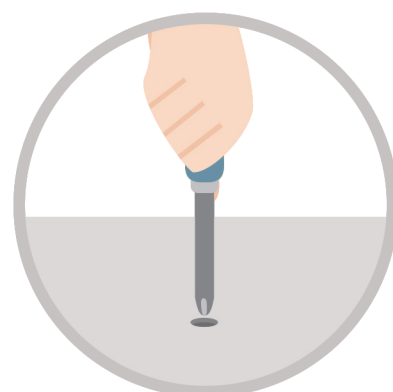

After two weeks, check and
tighten any loose hardware and
repeat again every six months
thereafter.

IT IS THE USER'S RESPONSIBILITY TO MAINTAIN THE FURNITURE. THE HARDWARE MAY LOOSEN OVER TIME AND MAY CAUSE THE FURNITURE TO BE WOBBLY AND UNABLE TO SUPPORT ITS INTENDED WEIGHT CAPACITY. THIS MAY LEAD TO COLLAPSE AND MAY CAUSE SERIOUS INJURY.

TABLE



- Please keep instructions for future reference.
- Check the quantity and irregularity of parts and hardware before you start.

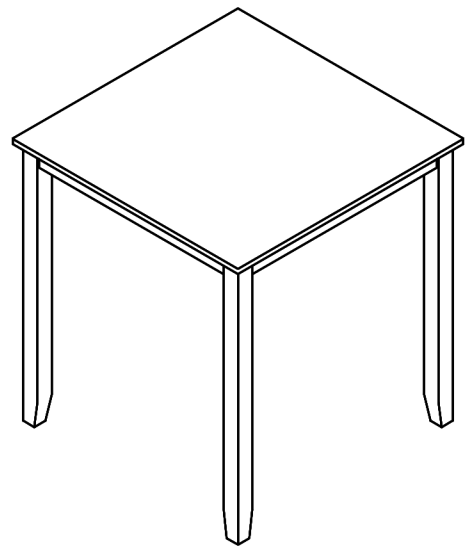

PARTS

#1 1pc

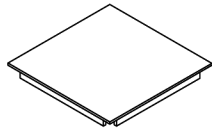
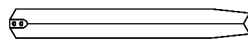

Table Top

#2 4pcs



Leg

HARDWARE

#A 8pcs



Bolt Ø5/16" x 2-3/8"

#B 8pcs



Lock Washer 5/16"

#C 8pcs



Flat Washer 5/16" x19mm

#D 1pc



Allen Wrench 4mm

Exploded View

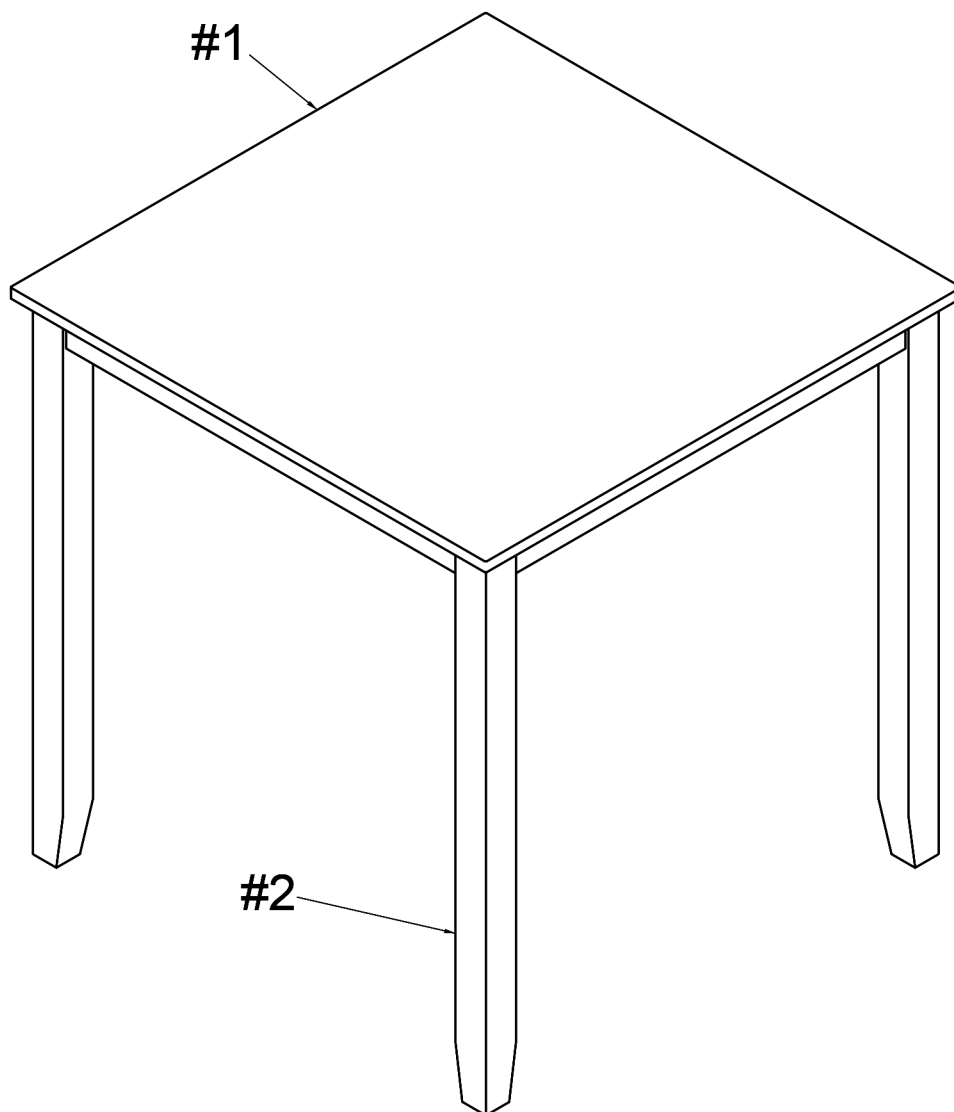

ASSEMBLY INSTRUCTIONS

1

Part #1 x1pc

Part #2 x4pcs

Hardware #A x8pcs

Hardware #B x8pcs

Hardware #C x8pcs

Align Legs (#2) to the Table Top (#1). Secure using Bolts (#A) with washers (#B, #C).

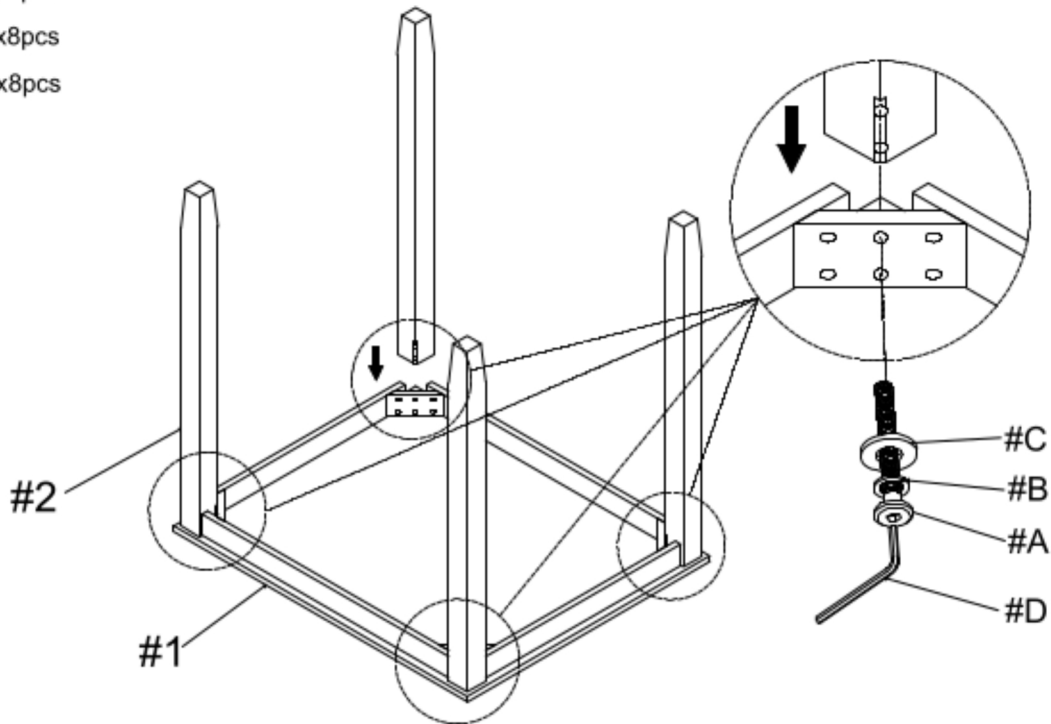

2

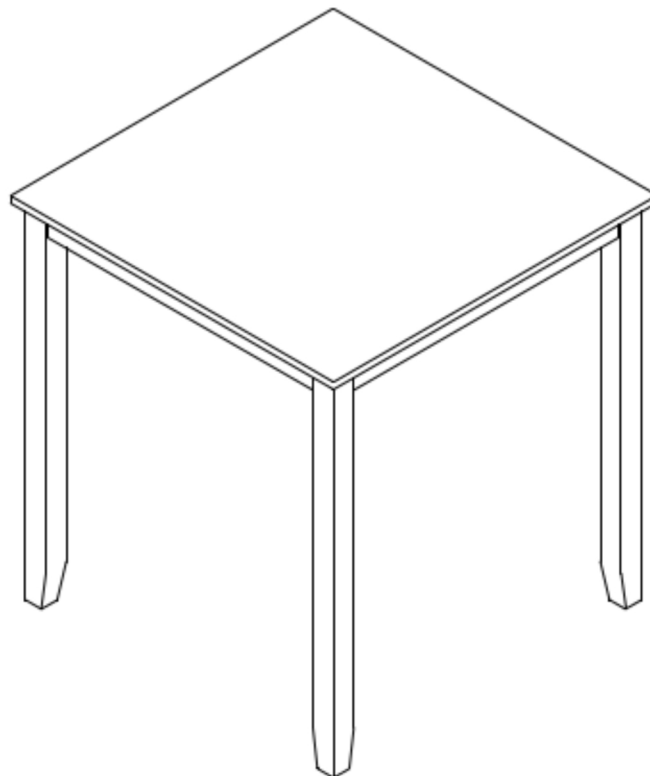

PUB CHAIR

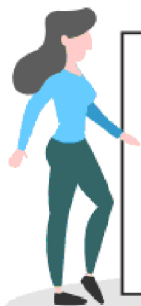

- Please keep instructions for future reference.
- Check the quantity and irregularity of parts and hardware before you start.

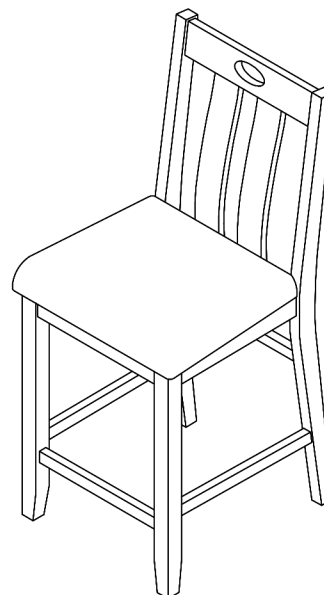

PARTS

#1 1pc x4

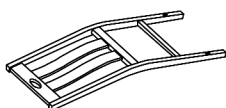

Chair Back

#2 1pc x4

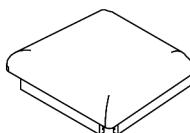

Cushion Seat

#3 2pcs x4



Front Leg (L&R)

#4 2pcs x4

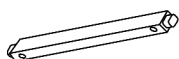

Side Stretcher(L&R)

#5 1pc x4

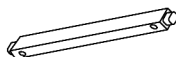

Front Stretcher

HARDWARE

#A 2pcs x4



Bolt
Ø1/4" x 1-1/2"

#B 4pcs x4



Bolt
Ø1/4" x 2-3/8"

#C 4pcs x4



Bolt
Ø1/4" x 3"

#D 10pcs x4



Lock Washer
Ø1/4"

#E 10pcs x4



Flat Washer
Ø1/4" x19mm

#F 1pc x4



Allen Wrench 4mm

#G 6pcs x4

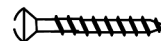

Screw #4x38mm

Exploded View

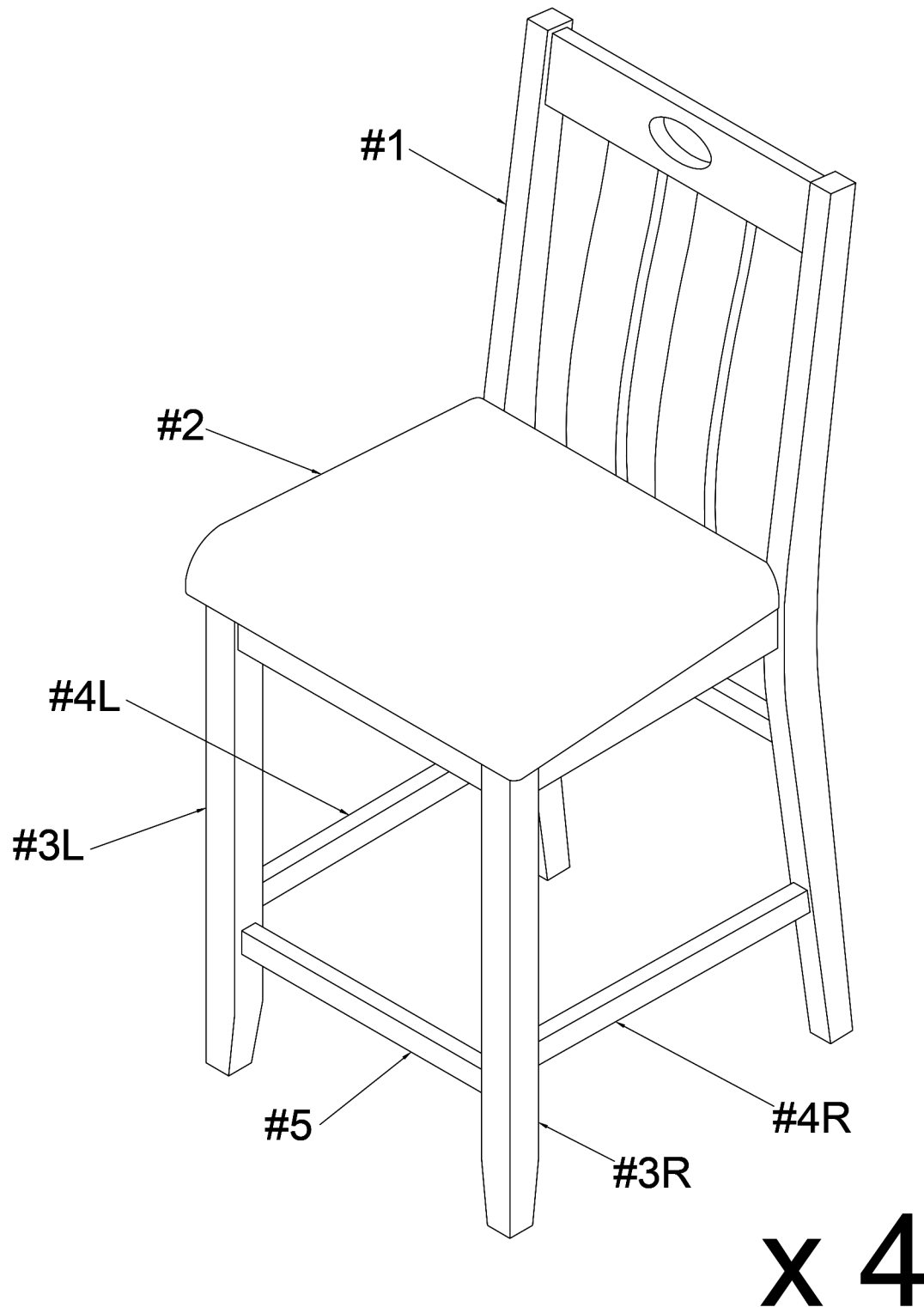

ASSEMBLY INSTRUCTIONS

1

Part **#1** x1pc

Part **#2** x1pc

Hardware **#A** x2pcs

Hardware **#D** x2pcs

Hardware **#E** x2pcs

Align Cushion Seat (#2) to the Chair Back (#1).
Secure center using Bolts (#A) with washers
(#D,E).

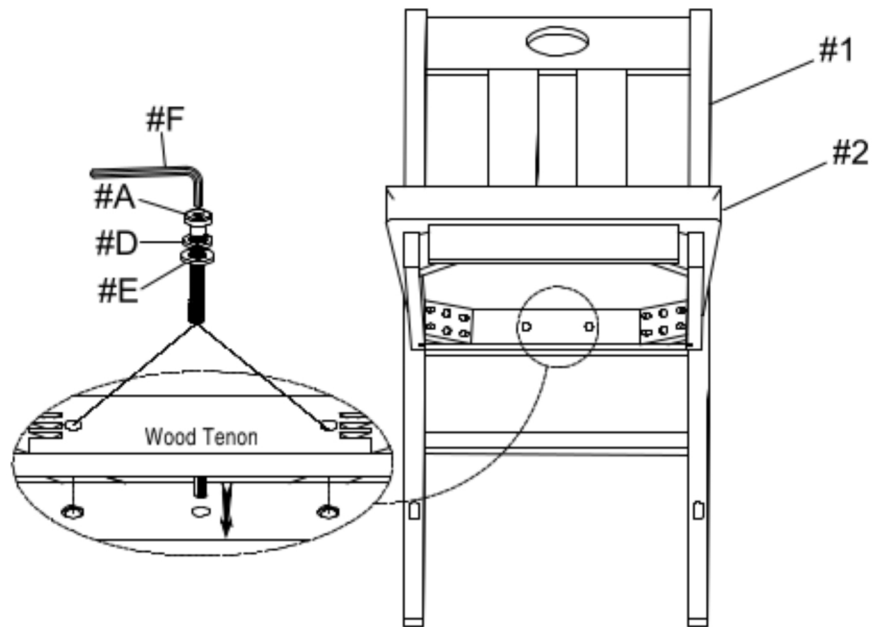

2

Hardware **#C** x4pcs

Hardware **#D** x4pcs

Hardware **#E** x4pcs

Secure the corners of the Cushion Seat
(#2) to the Chair back (#1) using bolts (#C)
with washers (#D,E).

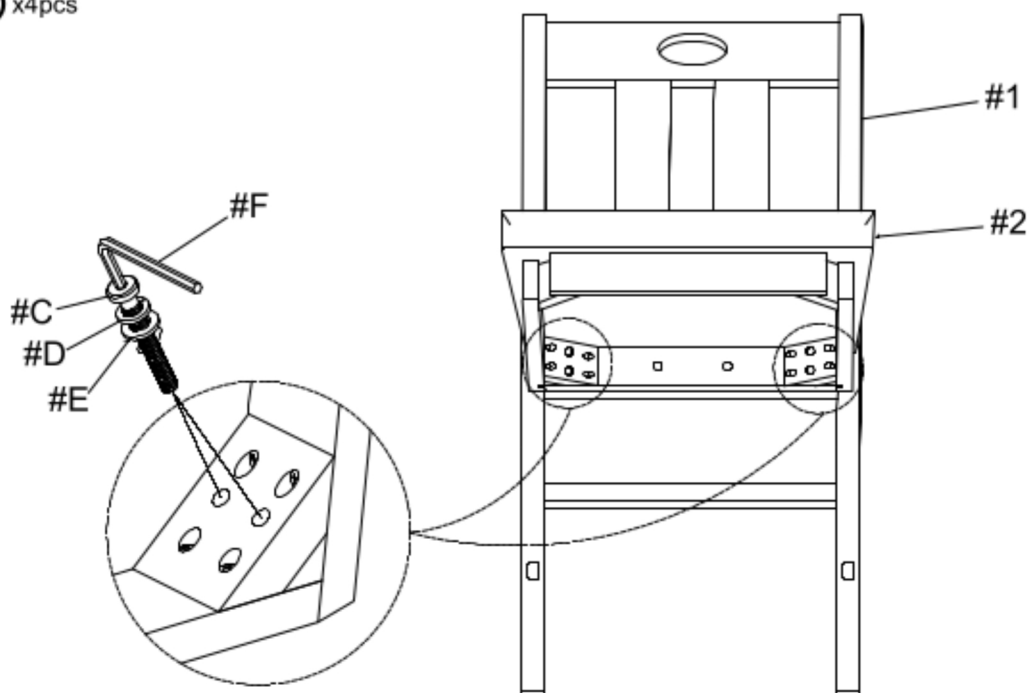

ASSEMBLY INSTRUCTIONS

3

Part #3 x2pcs

Part #4 x2pcs

Part #5 x1pc

Hardware #B x4pcs

Hardware #D x4pcs

Hardware #E x4pcs

Align the Side stretcher (#4) and Front Stretcher (#5) to the Chair Back (#1) and Front Legs (#3). Secure Front legs onto the Cushion Seat (#2) using bolts (#B) with washers (#D,E).

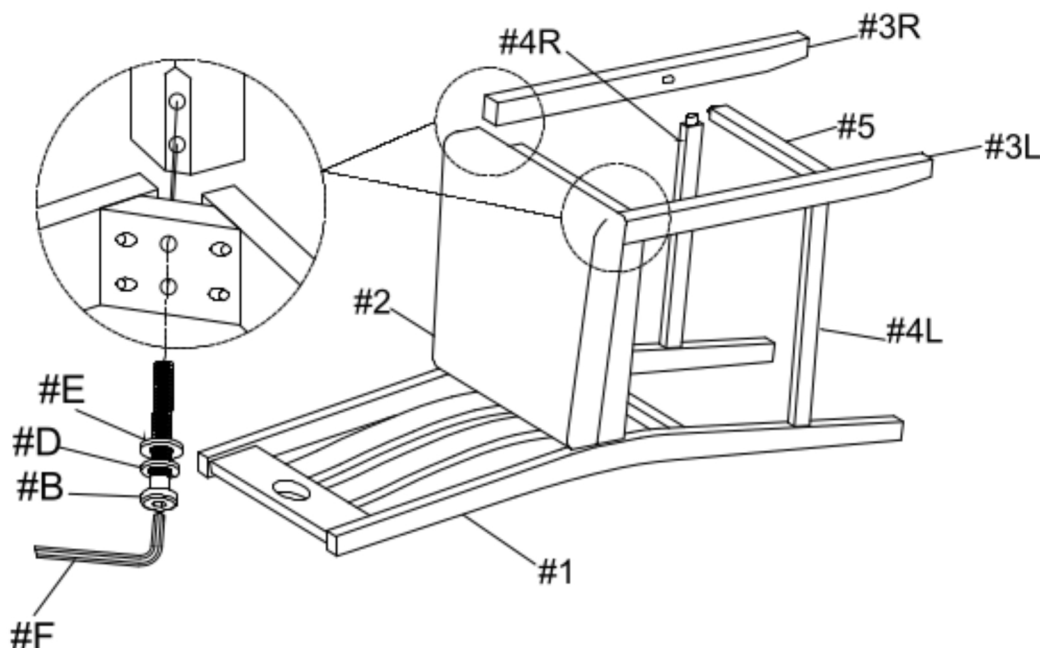

4

Hardware #G x6pcs

Secure Side Stretchers (#4) and Front Stretcher (#5) to the legs with screw (#G).

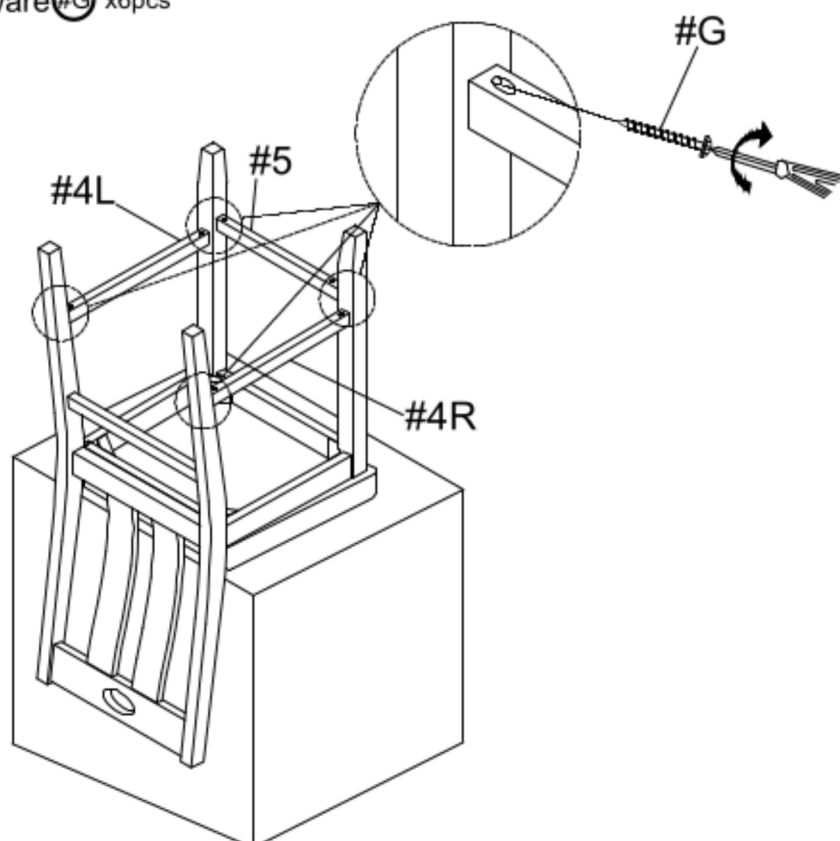

ASSEMBLY COMPLETED



Please ensure the furniture rests on an even and flat surface. If the product wobbles or feels loose, double-check all bolts and/or screws are properly tightened and secured.



Keep this handy!

Please retain this instruction manual and any order-related information for future reference.



Lift, don't drag!

To avoid damage to product please always LIFT the product when transporting or adjusting the placement.