

Let's build the

# Parker Desk

SKU 51401

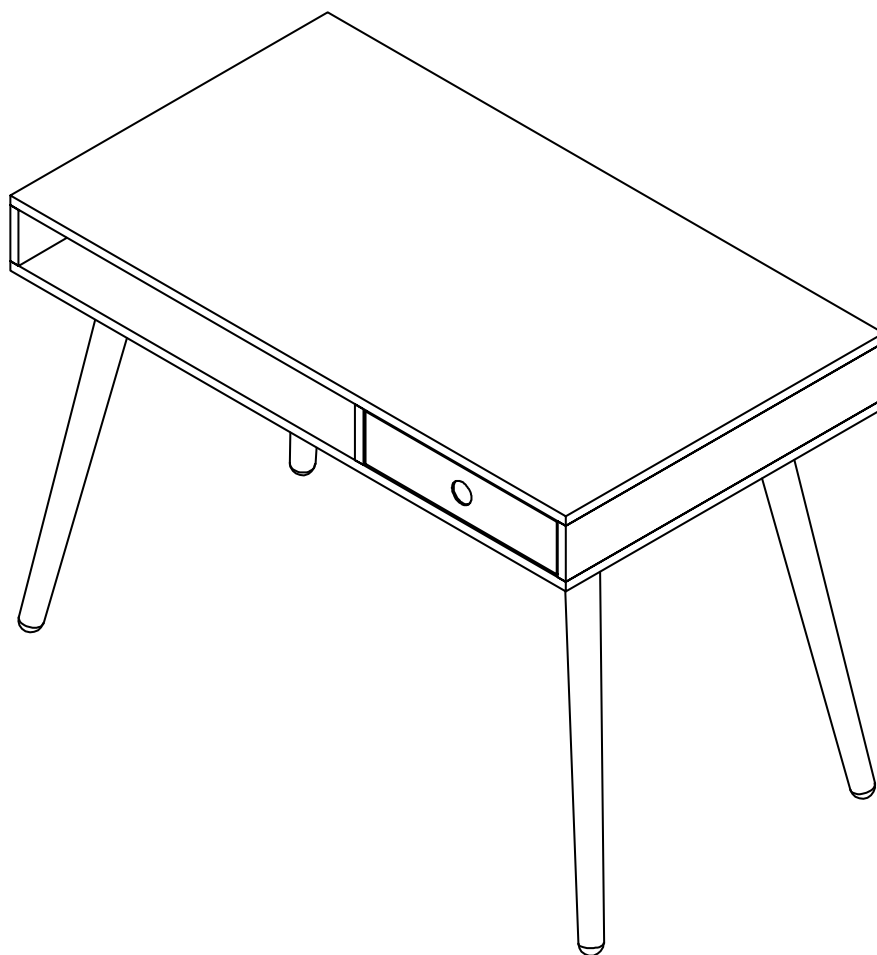

**Scan me!**

Free Lifetime  
Warranty

nathan james

25-0512

# Ok, let's get rolling

This should be easy, just follow our instructions and you will be back to Netflix in no time.

## Estimated time for assembly



15:00

## What you need

- Some of your favourite bubbly or your preferred relaxant
- Use the packaging carton as a working surface to prevent product damage during assembly
- Screwdriver
- 6mm Drill bit

## Weight Limitation

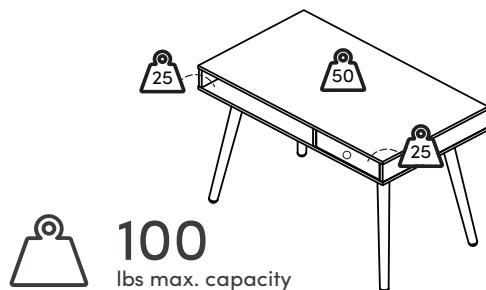

Toll-free at 1-866-619-1004  
Help@nathanjames.com  
Nathanjames.com/help

## What's included

| Description |                         | Qty |
|-------------|-------------------------|-----|
| A           | Top Panel               | 1   |
| B           | Legs                    | 4   |
| 1           | Plastic Connector       | 2   |
| 2           | Anchor                  | 2   |
| 3           | M4*38MM Screw           | 2   |
| 4           | M3.5*15MM Screw         | 2   |
| 5           | Plastic Anti-Tip Tether | 1   |
| 6           | Leveler (Extra)         | 4   |

Scan me!

Free Lifetime  
Warranty



# The goods

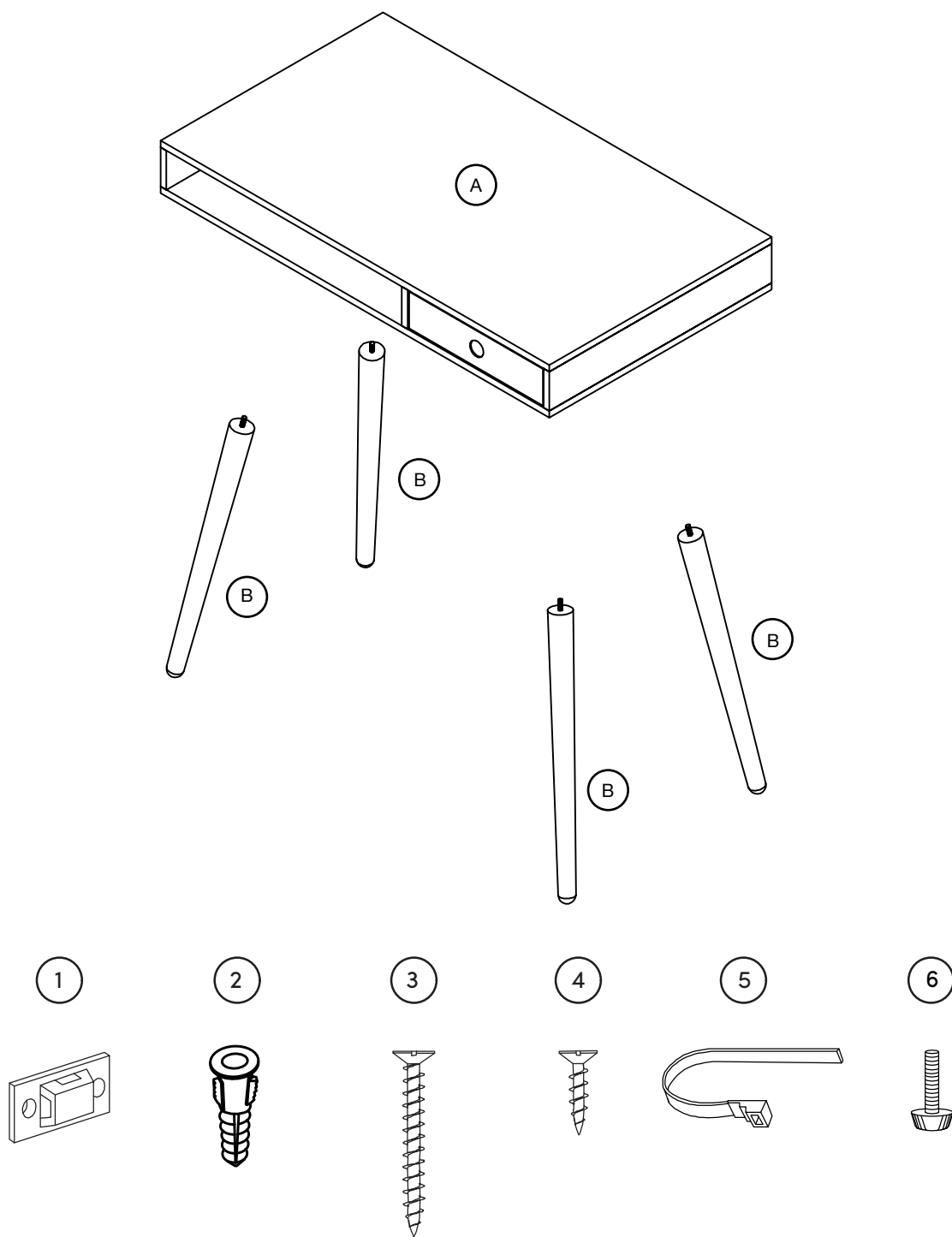

## IMPORTANT

1. Do not tighten bolts / screws completely until all bolts / screws are lined up and inserted into holes.
2. Do not over tighten screws and bolts to avoid stripping.
3. Please use hand tools to assemble this product. Do not use power tools.

# Step 1

Let's get this thing fired up! Lay down packaging carton or use carpet as a working surface.

With the desk upside down, simply twist the legs on to tighten and secure the Plastic Connector (1) to the bottom of the desk, at the back of the desk.

Don't forget: righty-tighty!

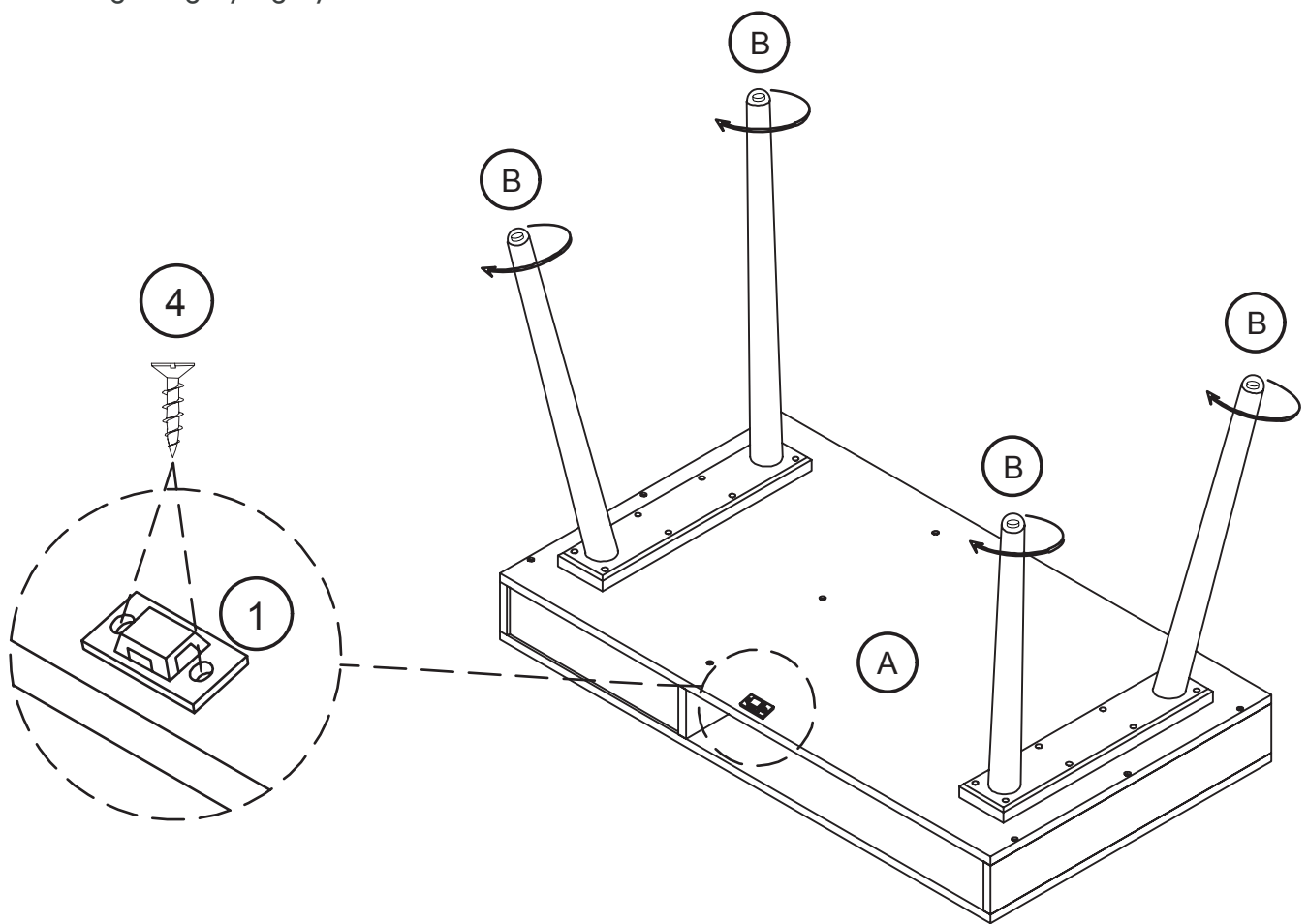

# Step 2

Grab a friend (and put the bubbly down) and carefully flip the desk over.

We told you it was going to be easy!  
All that's left to do is secure it to the wall.

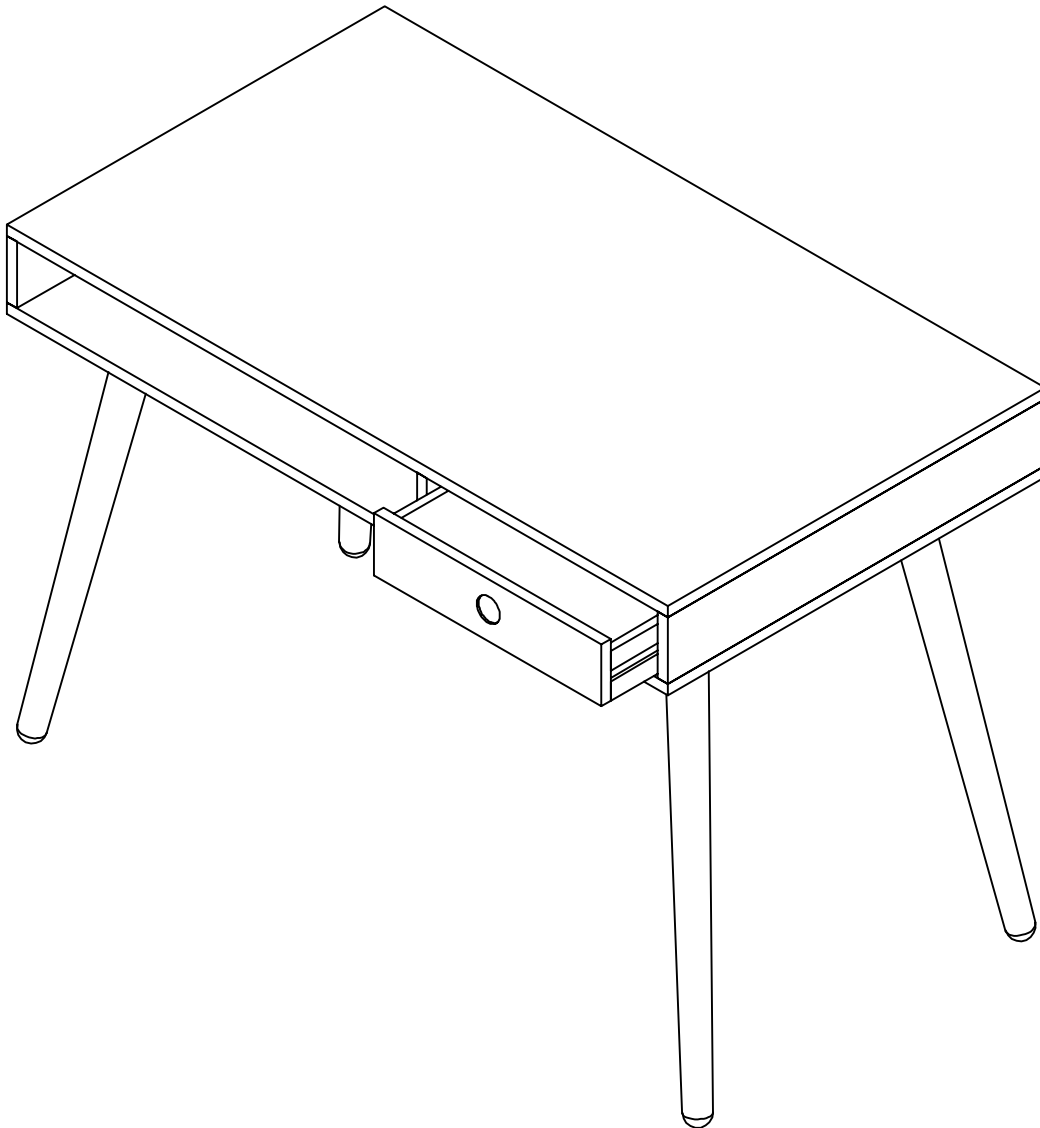

# Step 3

Now go ahead and check that your desk is level. If it's looking a little unlevel, adjust the levelers on the feet until it's nice and level.

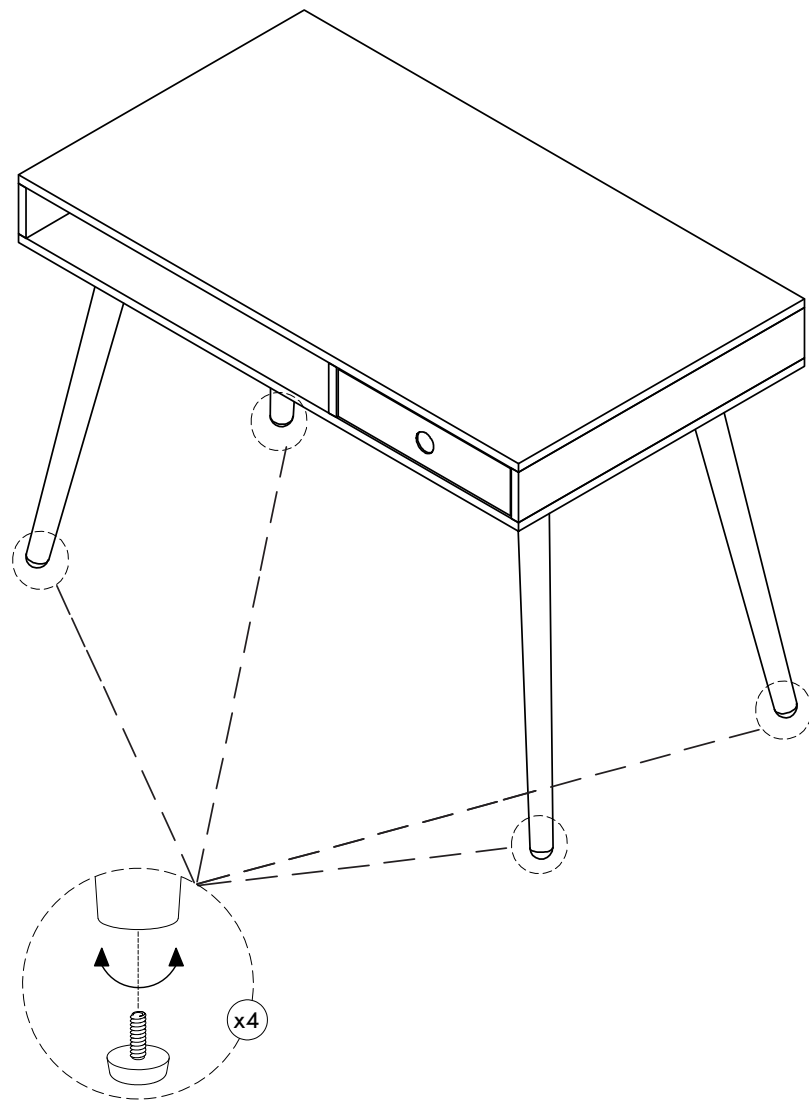

**HELPFUL TIP:**  
Adjust feet to balance Desk.

# Step 4

Mount the other Plastic Connector (1) to the wall using the provided Wall Anchors (2). We recommend using a 6mm Drill Bit.

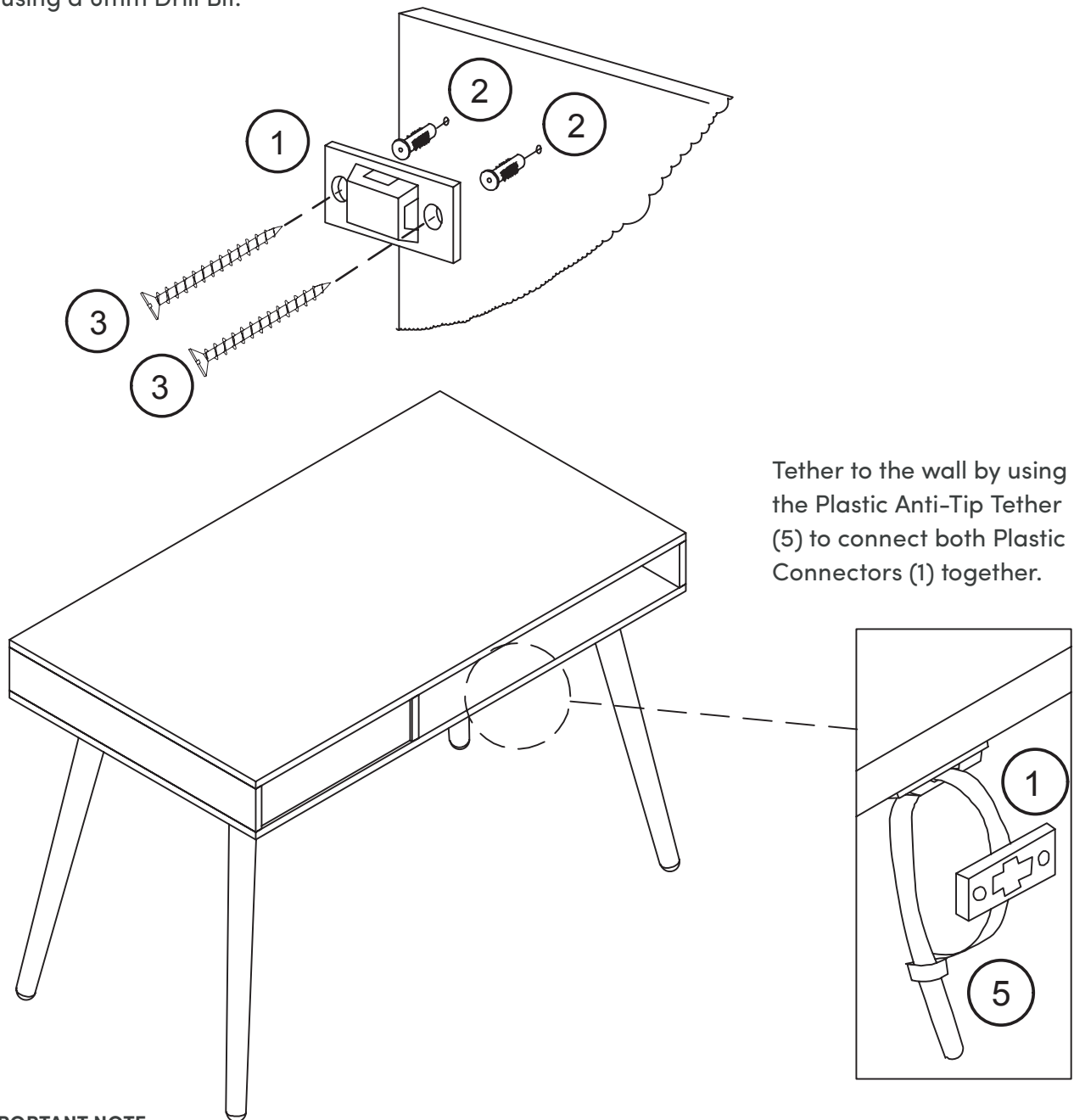

## IMPORTANT NOTE:

Young children (and/or pets) can be seriously injured by tipping furniture units.

You must install the provided anti-tip kit hardware solution, as instructed, to prevent the furniture unit(s) from tipping over - which could possibly lead to injuries or damage.

The provided anti-tip kit hardware solution is intended only as an additional safety measure & deterrent; it is not a substitute for proper adult supervision.

The provided anti-tip kit hardware solution is not an earthquake restraint. If you wish to add the extra security of earthquake restraints, they must be purchased & installed separately.

# No heartburn, when we handle the return

Give us a call **1-866-619-1004** or shoot us a message  
at **help@nathanjames.com** we will issue you a free  
replacement with **zero hassle**.

## Our way



Give us a call

---



Replacement

---



You

## Their way



Re-package item

---



Schedule pick up

---



Track package

---



Replacement

---



You

We really don't want you to go through the hassle of re-packaging your item  
and sending it back, because let's be honest...nobody has time for that.



# Safety first, fun later

We want your Parker Desk to last as long as possible, so we recommend that you tighten the screws 2 weeks after assembly and for added safety check the tightness of all screws every 2 months.

For proper care and treatment of wood please check our website at [NathanJames.com/products](http://NathanJames.com/products)

## Safe use of this product starts with you.

Use this desk responsibly with the primary concern for your safety. Follow assembly instructions carefully and inspect product upon receipt and each use.

Nathan James and its parent companies cannot be held legally responsible for any injuries or death resulted from failure to follow instructions or improper use of this product.

## Do not modify the structure of this product in any way.

Our products have been tested to meet specific safety measures as they were originally intended to be sold. Any modifications will present the risk of creating significant safety issues which NJ will not be responsible for.

## Proper use

|               |                                   |
|---------------|-----------------------------------|
| <b>DO NOT</b> | use for commercial purposes       |
| <b>DO NOT</b> | climb on table top                |
| <b>DO NOT</b> | exceed weight limit               |
| <b>DO NOT</b> | leave spilled liquid on table top |
| <b>DO NOT</b> | use if desk is damaged or broken  |
| <b>DO NOT</b> | make temporary repairs            |
| <b>DO NOT</b> | use outdoors                      |

# We are only in business if you're happy

For starters, thanks for being you.

☎ Toll-free at 1-866-619-1004

✉ Help@nathanjames.com

🌐 NathanJames.com/help

We do our best to ensure your furniture arrives without any problems, but occasionally mistakes happen—as humans we are imperfect beings. In the event that a part is damaged or missing, we will be more than happy to provide you with replacement part(s) for free.

## Warranty

This product comes with a lifetime warranty from the date of purchase. Please use your phone to scan the QR code to register your product or visit <https://goo.gl/i9dk3q>

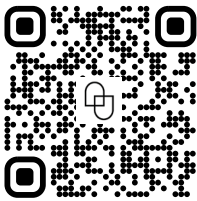

## Did we do alright? Please spread the love!

If you are happy with your product, tell your friends and family about us or even better leave us a review online. Spreading the word gives us the opportunity to make more people happy and keep our prices low for your next purchase.

*Brooke Burdon*

Founder, Nathan James