

Let's build the

# Theo Wall Shelf

SKU 65901

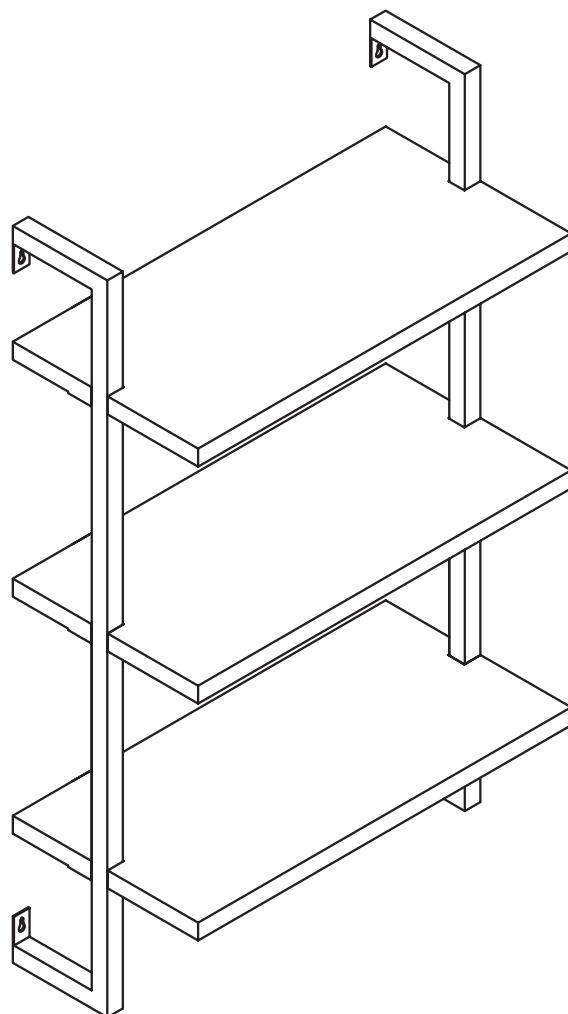

**Scan me!**

Inspiration  
Digital Instructions  
Free Lifetime Warranty

nathan james

24-0425-VN

# Ok, let's get rolling

This should be easy, just follow our instructions and you will be back to Netflix in no time.

## Estimated time for assembly



25:00

## What you need

- Some of your favourite bubbly or your preferred relaxant
- Use the packaging carton as a working surface to prevent product damage during assembly
- Phillips Screwdriver
- Drill (not included)
- 1/4" Drill Bit (not included)
- 5/16" Drill Bit (not included)

## Weight Limitation



75

lbs per shelf

Toll-free at 1-866-619-1004  
Help@nathanjames.com  
Nathanjames.com/help

## What's included

Description		Qty
A	Shelf	3
B	Side Upper Support	2
C	Side Lower Support	2
1	M6*15mm Bolt	10
2	M4.2*50mm Screw for Drywall Anchor	4
3	M4*30mm Drywall Anchor	4
4	Allen Key	1
5	M4*30mm Non-drywall Anchor	4
6	M4.2*32mm Screw for Non-drywall Anchor	4

Scan me!

Inspiration  
Digital Instructions  
Free Lifetime Warranty



# The goods

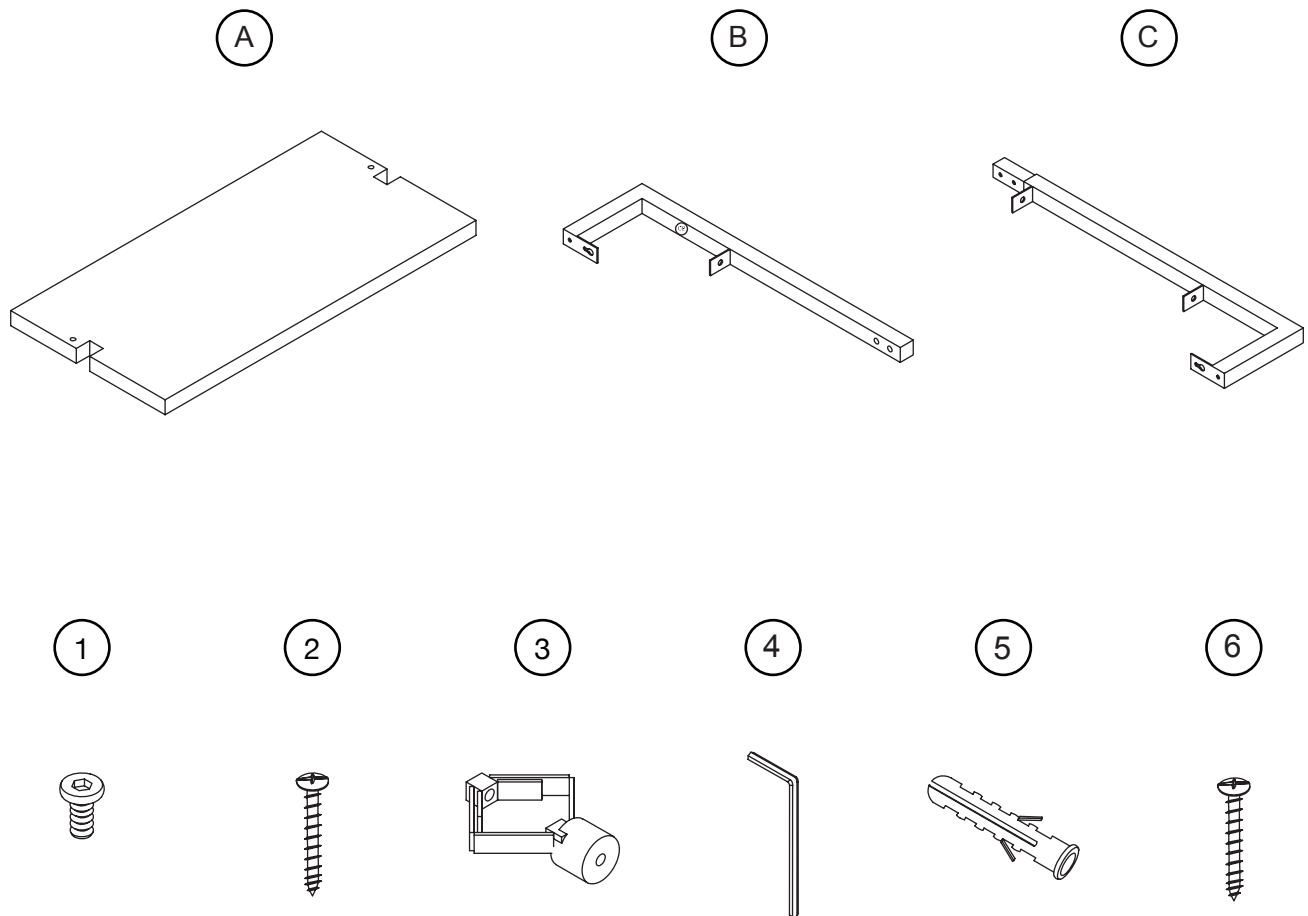

## IMPORTANT

1. Do not tighten bolts / screws completely until all bolts / screws are lined up and inserted into holes.
2. Do not over tighten screws and bolts to avoid stripping.
3. Please use hand tools to assemble this product. Do not use power tools.



# Step 1

It's as easy as it looks! Assemble the side supports.

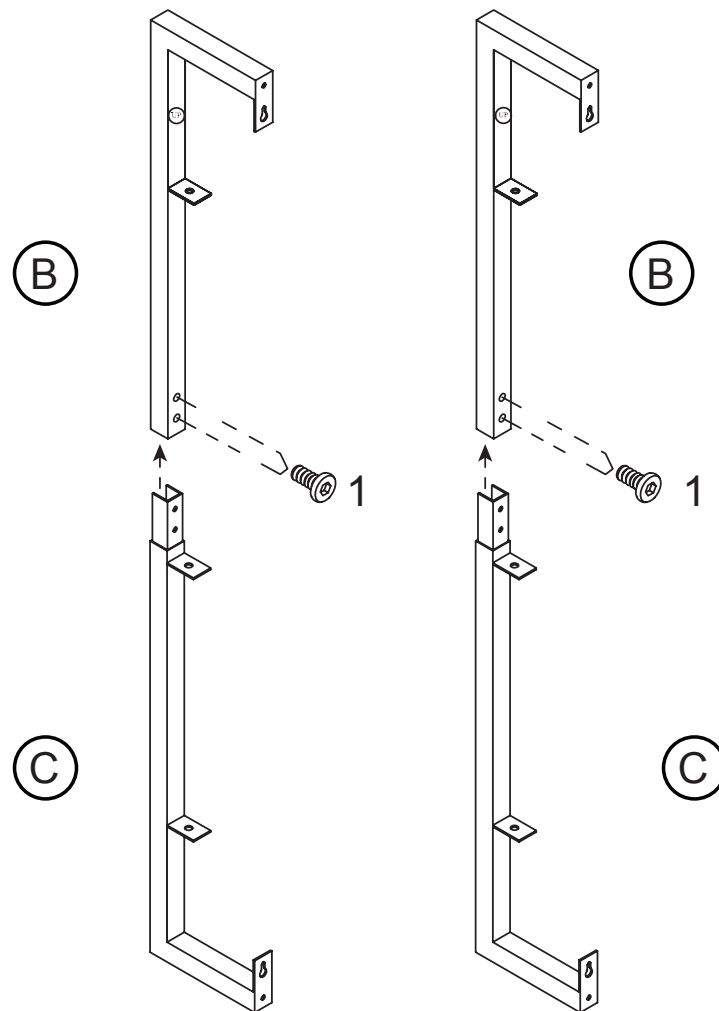

# Step 2

Let's get those shelves in place! Consider this your workout of the day.

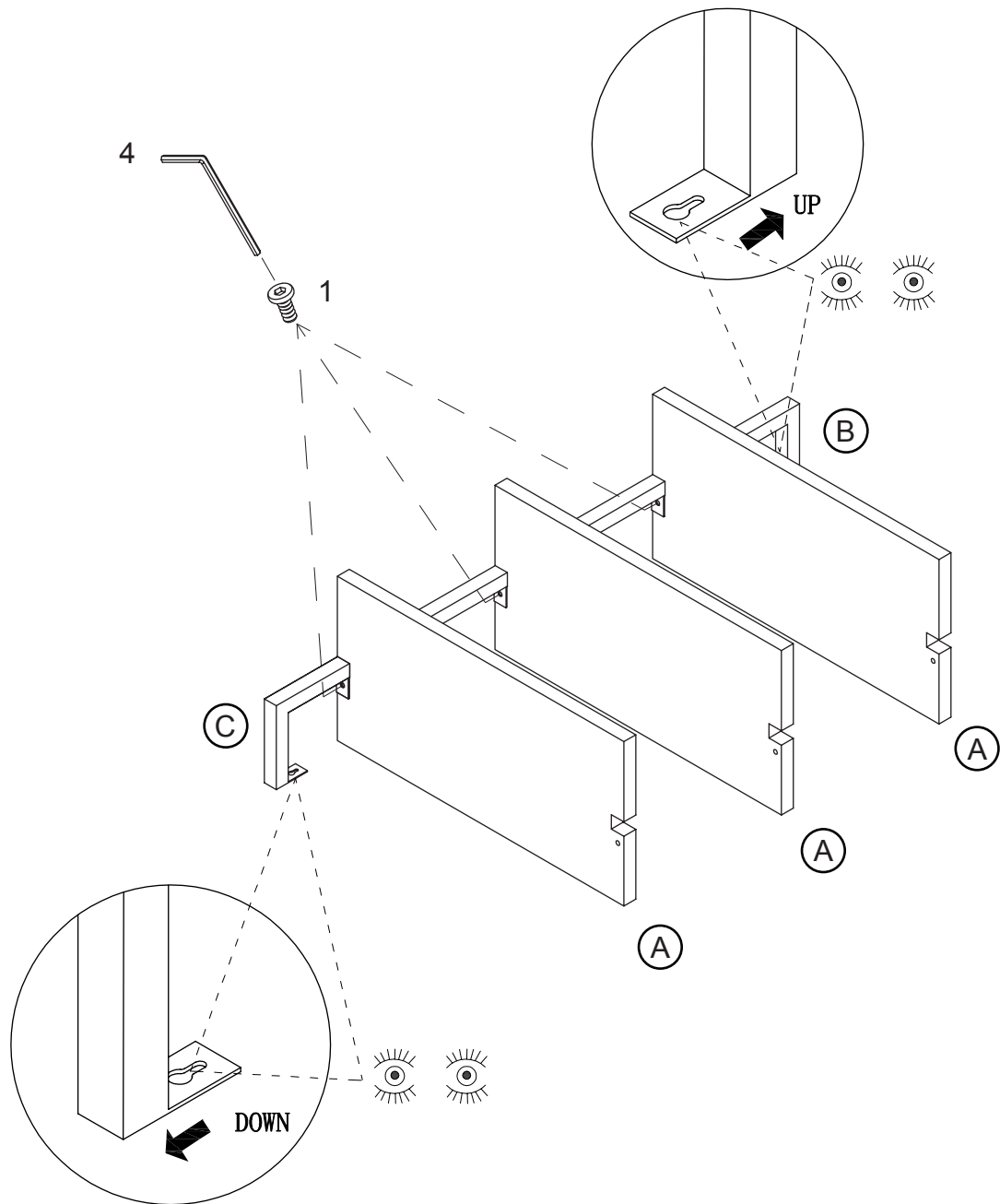

# Step 3

Attach the second side supports to the shelves. You're halfway there!

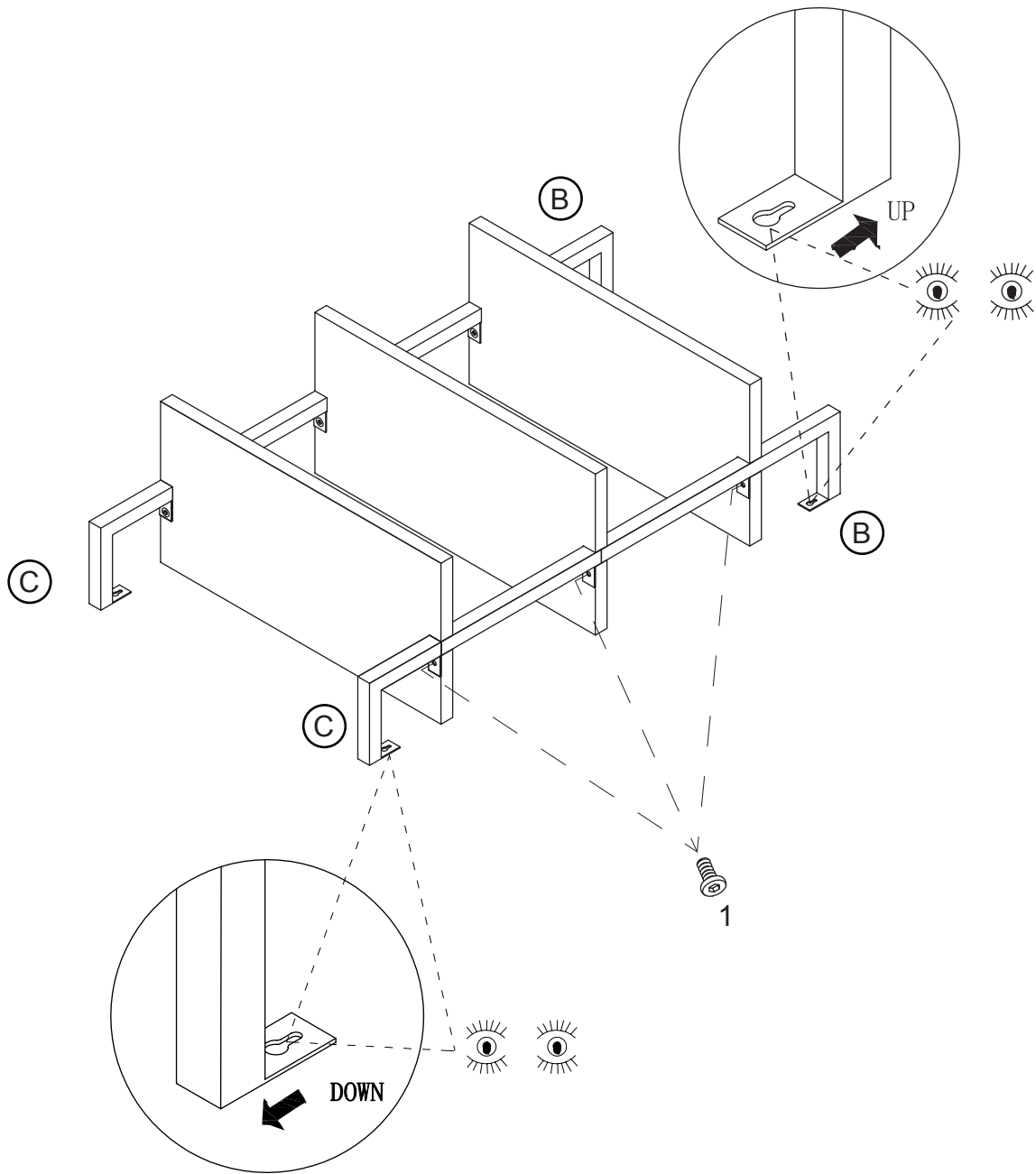

# Step 4

## Non-drywall Application

Let's get this bookshelf attached to your wall!

Note: the following steps are for non-drywall application. If you have drywall, skip to Page 9.

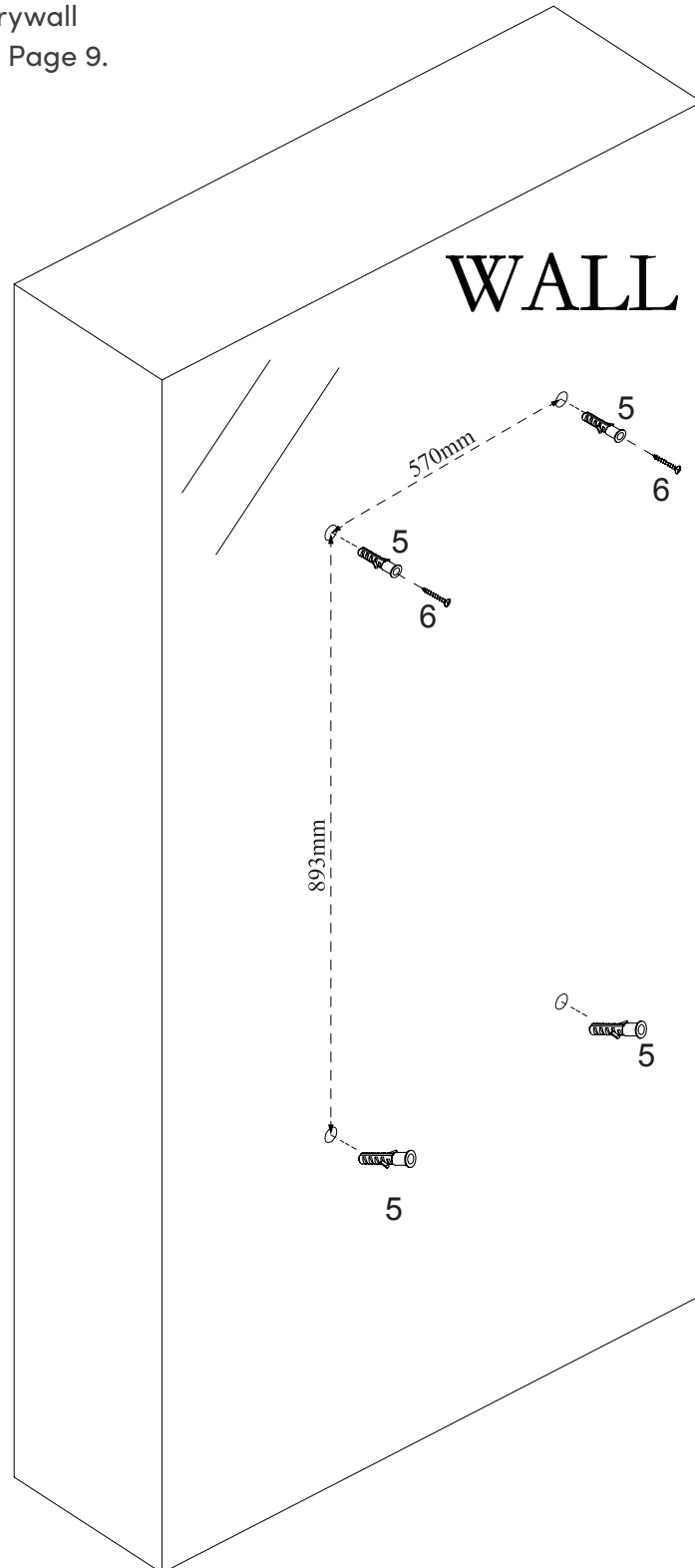

**Tip from a friend to a friend:** Tighten to about 90% and do not attach bottom screws into non-drywall anchors until the very last step!



# Step 4 (cont.)

## Non-drywall Application

### Mark it

Chose your desired location on the wall, have your friend hold the bookcase in place and use a pencil to mark where the anchor will go.

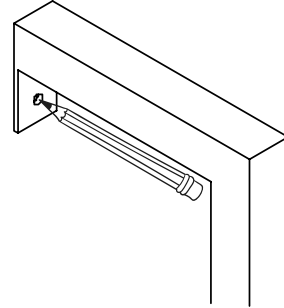

### 1/4" Drill bit

Move bookcase to the side and following the mark you just made. With a 1/4" drill bit, drill 4 holes into the wall.

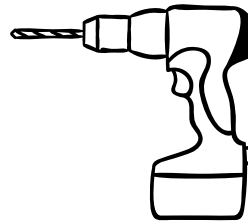

### Insert the anchors

Following the mark you just made. Using your Phillips head screw driver, screw the plastic anchors into the holes until they are flush to the wall.

*If you're feeling strong, just go ahead and push it in.*

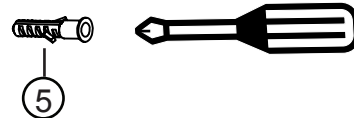

### All about the angle

Insert 1 screw through each metal bracket and into the anchor. Tilt your Phillips head screwdriver, and secure but do not over tighten.

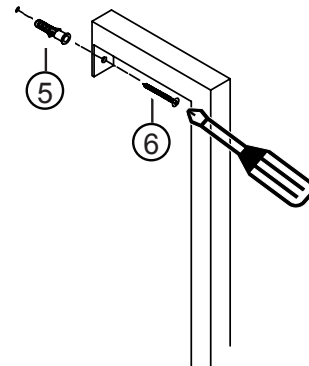



# Step 4 (cont.) Drywall Application

## Mark it

Chose your desired location on the wall, have your friend hold the bookcase in place and use a pencil to mark where the anchor will go.

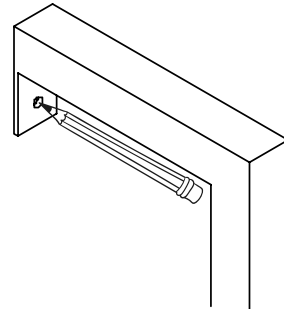

## 5/16" Drill bit

Move bookcase to the side and following the mark you just made. With a 5/16" drill bit, drill 4 holes into the wall.

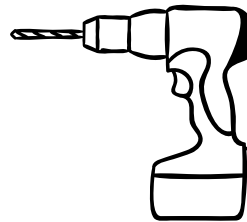

## Insert the anchors

Go ahead and tap the wall anchors into place in the new holes that you just drilled.

*If you're feeling strong, just go ahead and push it in.*

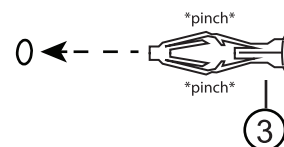

## All about the angle

Insert 1 screw through each metal bracket and into the drywall anchor. Tilt your Phillips head screwdriver, and secure but do not over tighten.

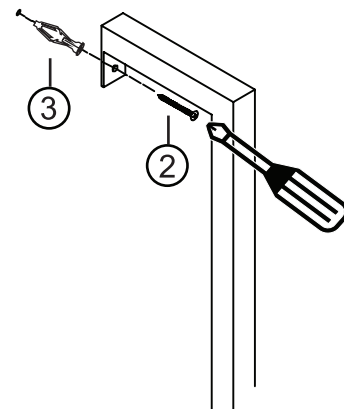

# Step 4 (cont.) Drywall Application

Let's get this bookshelf attached to your wall!  
Flip over to the next page for a closer look at  
how to use drywall anchors!

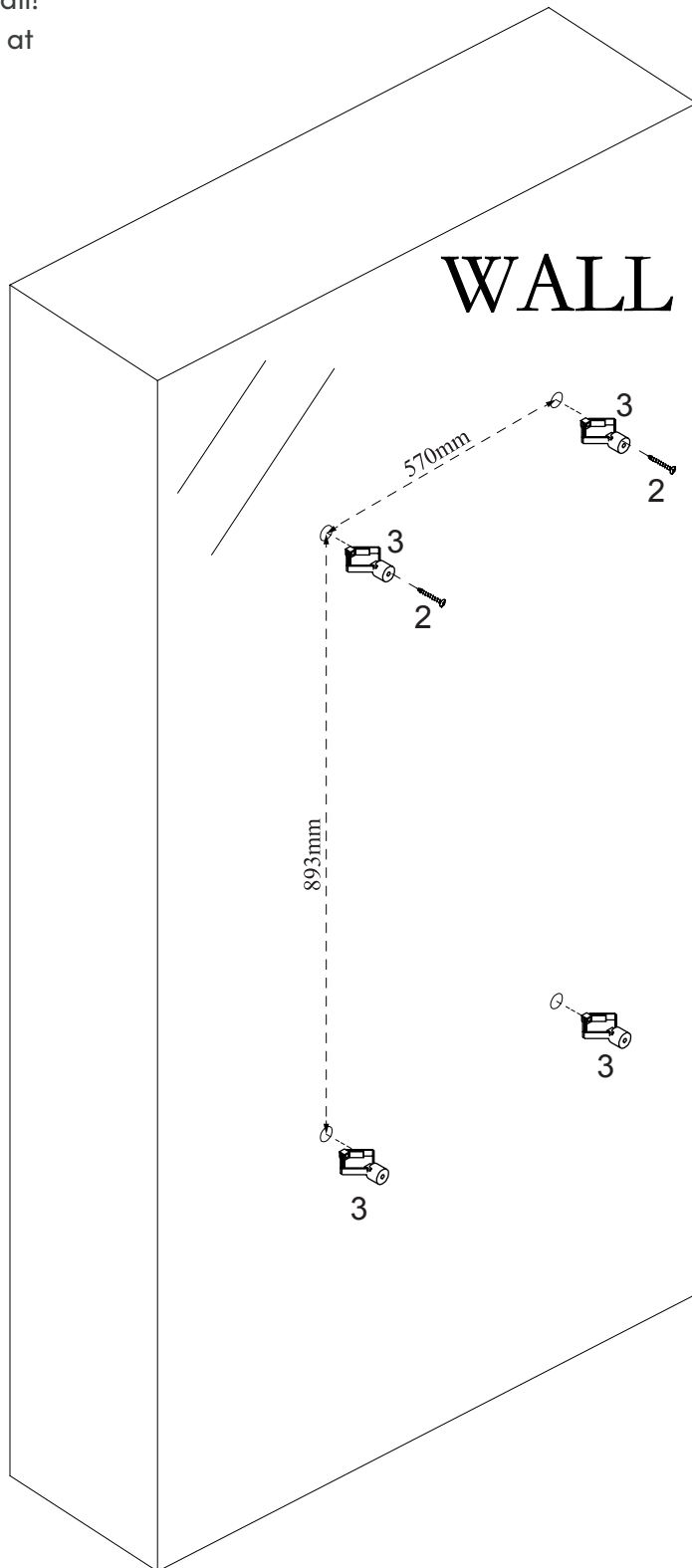

**Tip from a friend to a friend:** Tighten to about 90% and do not attach bottom screws into drywall anchors until the very last step!



# Step 4 (cont.)

## How to use drywall anchors

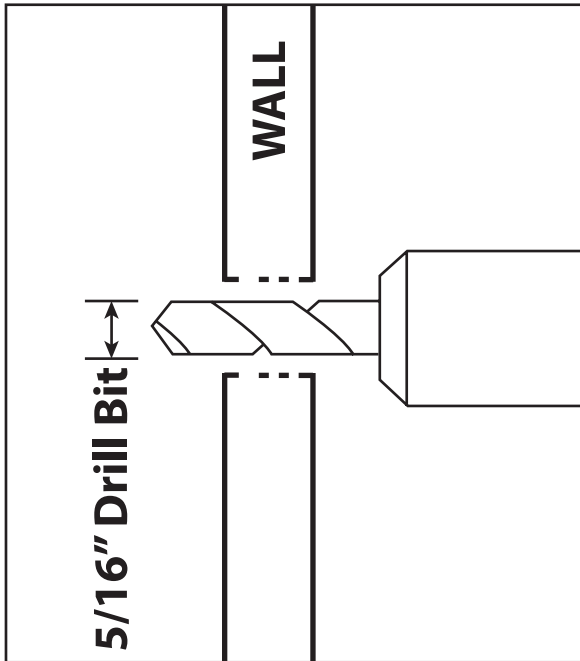

1. Drill hole with 5/16" bit

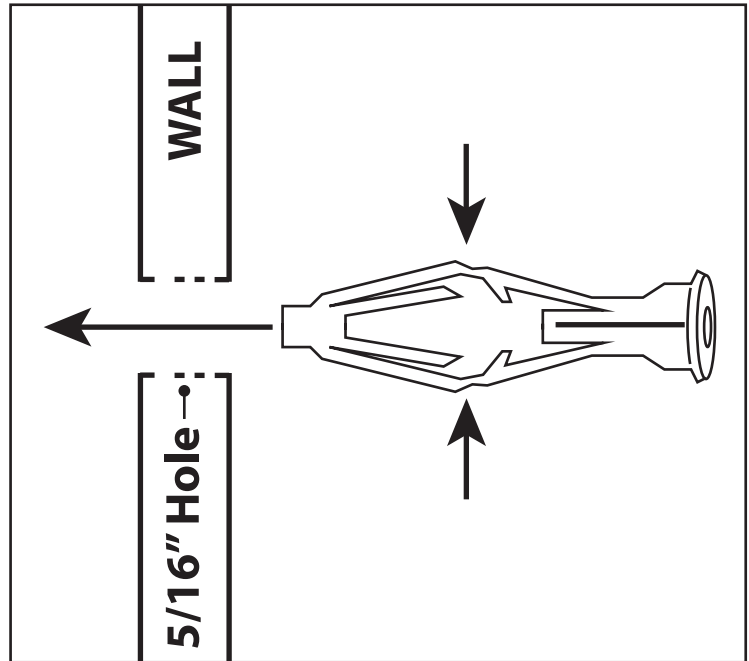

2. Pinch and insert

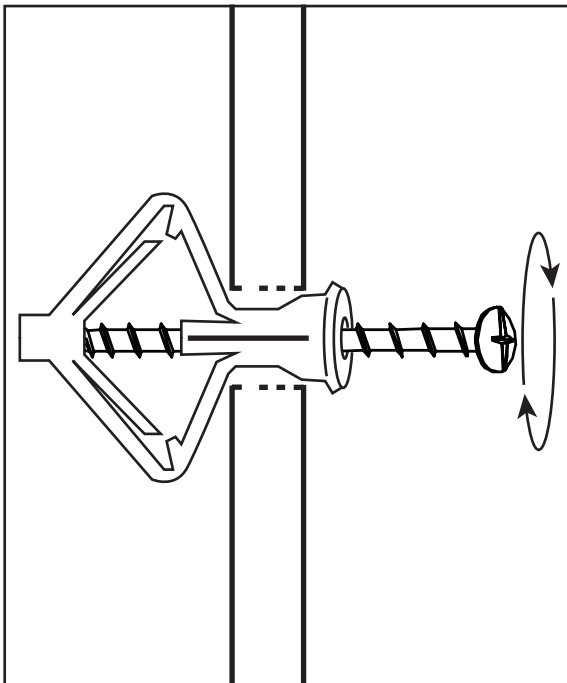

3. Begin tightening

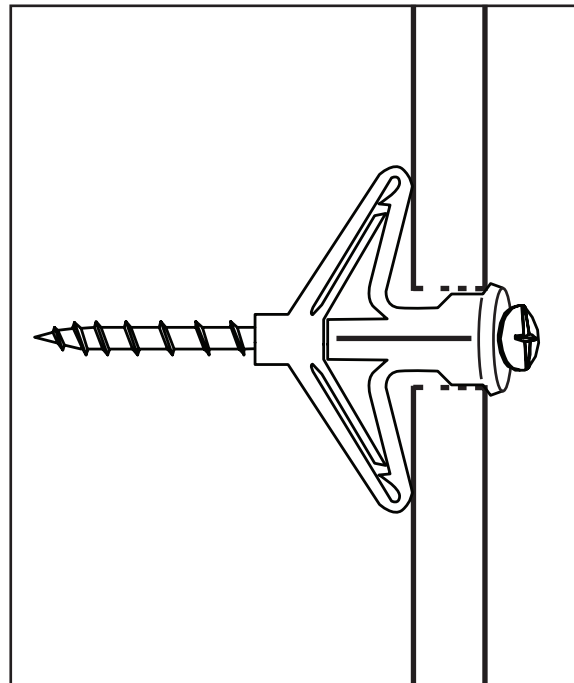

4. Tighten to 100%



# Step 5

The hard part is over! Hang your bookshelf on the top screws and tighten to 100%.

Lastly, tighten bottom screws to secure.

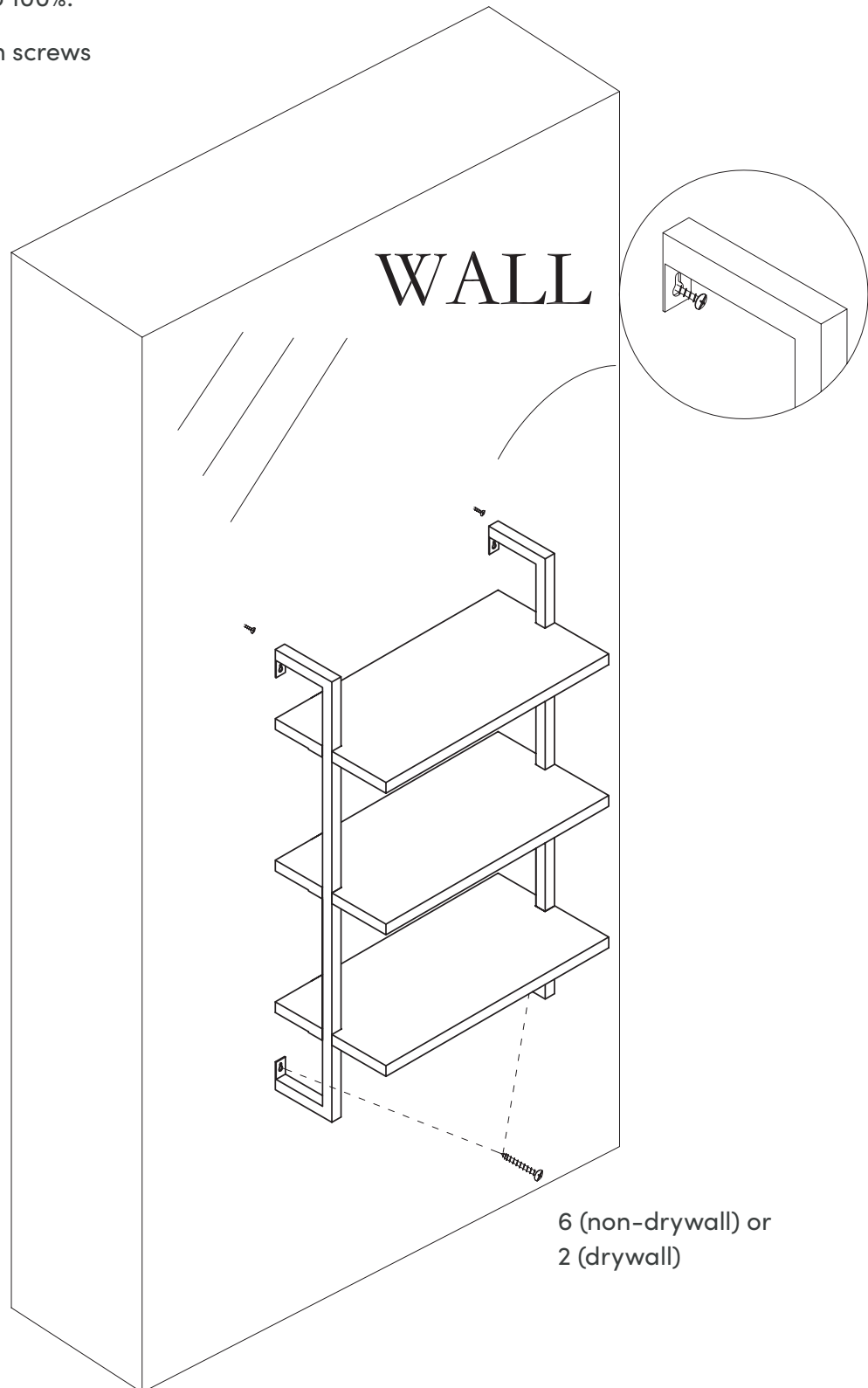

# Step 5 (cont.)

*\*Cue party music\**

You did it! Order a celebratory  
pizza, you deserve it!

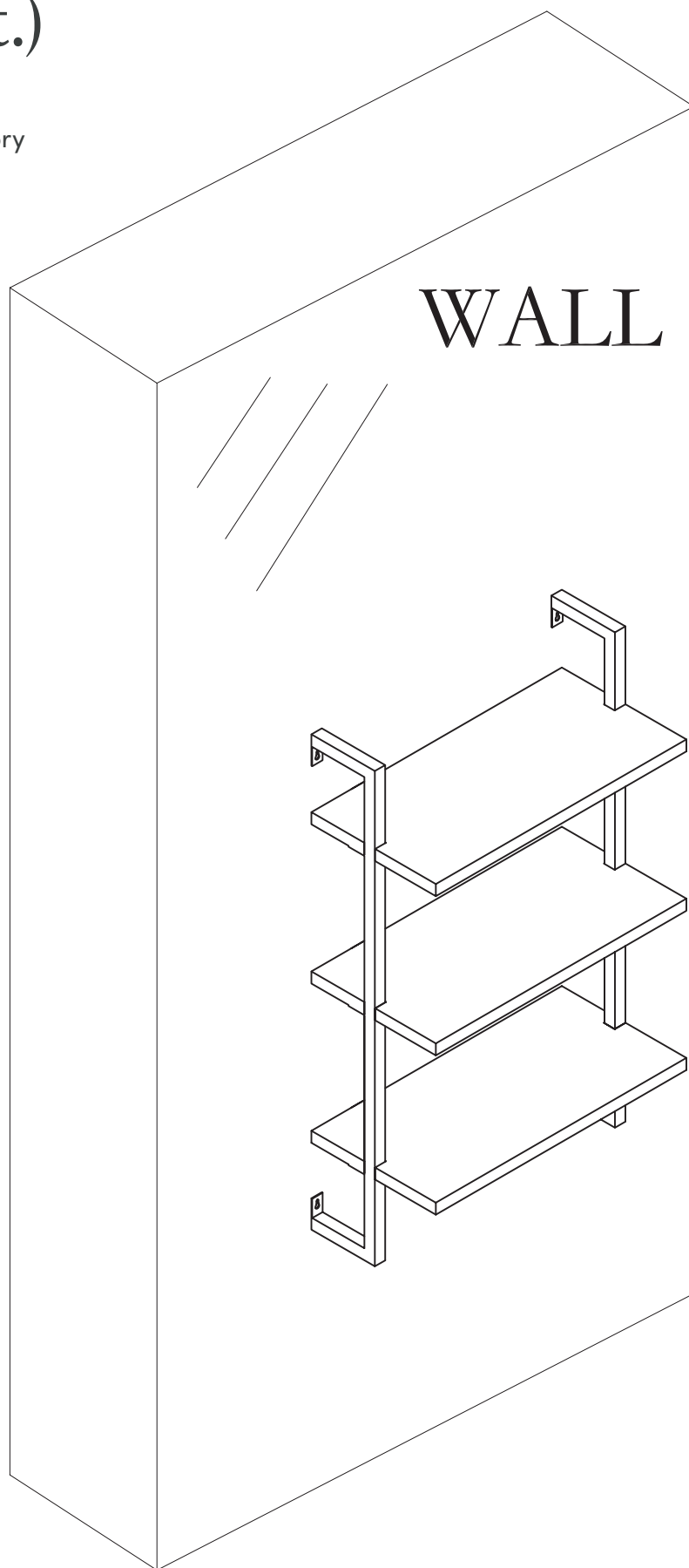

# No heartburn, when we handle the return

Give us a call **1-866-619-1004** or shoot us a message  
at **help@nathanjames.com** we will issue you a free  
replacement with **zero hassle**.

## Our way



Give us a call



Replacement



You

## Their way



Re-package item



Schedule pick up



Track package



Replacement



You

We really don't want you to go through the hassle of re-packaging your item  
and sending it back, because let's be honest...nobody has time for that.



# Safety first, fun later

We want your Theo Floating Bookcase to last as long as possible, so we recommend that you tighten the screws 2 weeks after assembly and for added safety check the tightness of all screws every 2 months.

For proper care and treatment of wood and metal please check our website at [NathanJames.com/products](http://NathanJames.com/products)

## Safe use of this product starts with you.

Use this bookcase responsibly with the primary concern for your safety. Follow assembly instructions carefully and inspect product upon receipt and each use.

Nathan James and its parent companies cannot be held legally responsible for any injuries or death resulted from failure to follow instructions or improper use of this product.

## Do not modify the structure of this product in any way.

Our products have been tested to meet specific safety measures as they were originally intended to be sold. Any modifications will present the risk of creating significant safety issues which NJ will not be responsible for.

## Proper use

- |               |   |
|---------------|---|
| <b>DO NOT</b> | use for commercial purposes                 |
| <b>DO NOT</b> | place on uneven floor or surface            |
| <b>DO NOT</b> | use as a step-stool or stand on bookcase    |
| <b>DO NOT</b> | put hot serving liquid directly on bookcase |
| <b>DO NOT</b> | leave spilled liquid on bookcase            |
| <b>DO NOT</b> | use if bookcase is damaged or broken        |
| <b>DO NOT</b> | make temporary repairs                      |
| <b>DO NOT</b> | use outdoors                                |



# We are only in business if you're happy

For starters, thanks for being you.

☎ Toll-free at 1-866-619-1004

✉ Help@nathanjames.com

🌐 NathanJames.com/help

We do our best to ensure your furniture arrives without any problems, but occasionally mistakes happen—as humans we are imperfect beings. In the event that a part is damaged or missing, we will be more than happy to provide you with replacement part(s) for free.

## Warranty

This product comes with a lifetime warranty from the date of purchase. Please use your phone to scan the QR code to register your product or visit <https://goo.gl/i9dk3q>

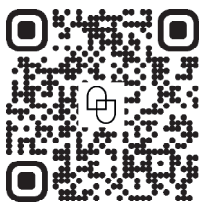

### Did we do alright? Please spread the love!

If you are happy with your product, tell your friends and family about us or even better leave us a review online. Spreading the word gives us the opportunity to make more people happy and keep our prices low for your next purchase.

*Brooklyn Burdon*

Founder, Nathan James

