

Let's build the

Jacklyn Bookcase

SKU 67201

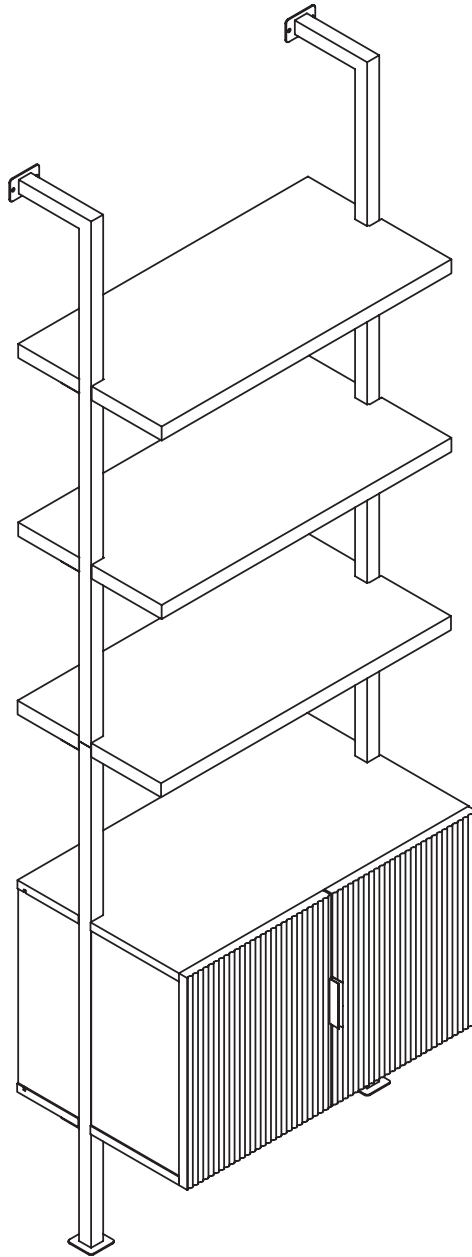

Scan me!

Free Lifetime
Warranty

nathan james

24-0404-VN

Ok, let's get rolling

This should be easy, just follow our instructions and you will be back to Netflix in no time.

Estimated time for assembly



75:00

What you need

- Some of your favorite bubbly or your preferred relaxant
- Use the packaging carton as a working surface to prevent product damage during assembly
- Phillips head screwdriver
- Drill with 5/16" or 1/4" drill bit

Weight Limitation



75

lbs shelves & cabinet top

33

lbs adjustable shelf & cabinet bottom

Toll-free at 1-866-619-1004
Help@nathanjames.com
Nathanjames.com/help

What's included

Description		Qty
A	Top Frame Support (with wall mount plate)	2
B	Bottom Frame Support	2
C	Open Shelf	3
D	Left Back Side Panel	1
E	Left Front Side Panel	1
F	Right Back Side Panel	1
G	Right Front Side Panel	1
H	Back Panel	1
I	Top Panel	1
J	Bottom Panel	1
K	Adjustable Shelf for Cabinet	1
L	Door Panel	2

Scan me!

Free Lifetime
Warranty



The goods

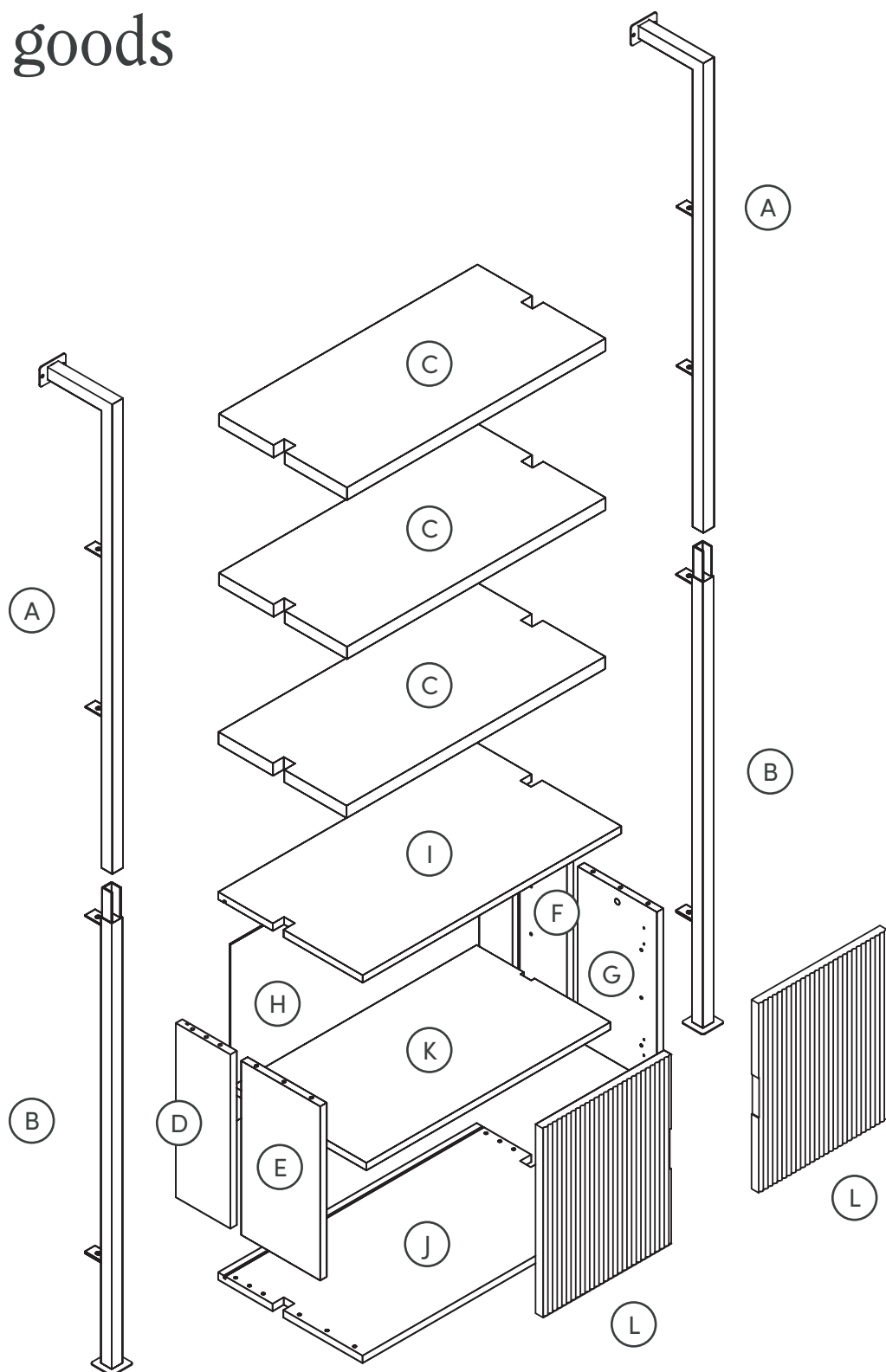

IMPORTANT

1. Do not tighten bolts / screws completely until all bolts / screws are lined up and inserted into holes.
2. Do not over tighten screws and bolts to avoid stripping.

What's included

Description		Qty
1	M6*15mm Bolt	12
2	Handle	2
3	M6*30mm Cam Bolt	4
4	15*9.5mm Cam Lock	4
5	M4*40mm Screw	4
6	M4*12mm Screw	4
7	M4.2*32mm Screw	4
8	M6*30mm Non-Drywall Anchors	4
9	8*30mm Wooden Dowel	16
10	M4*14mm Screw	16
11	Hinge	4
12	Allen Key	1
13	Shelf Pin	4
14	Drywall Anchor	4
15	M4.2*50mm Screw	4

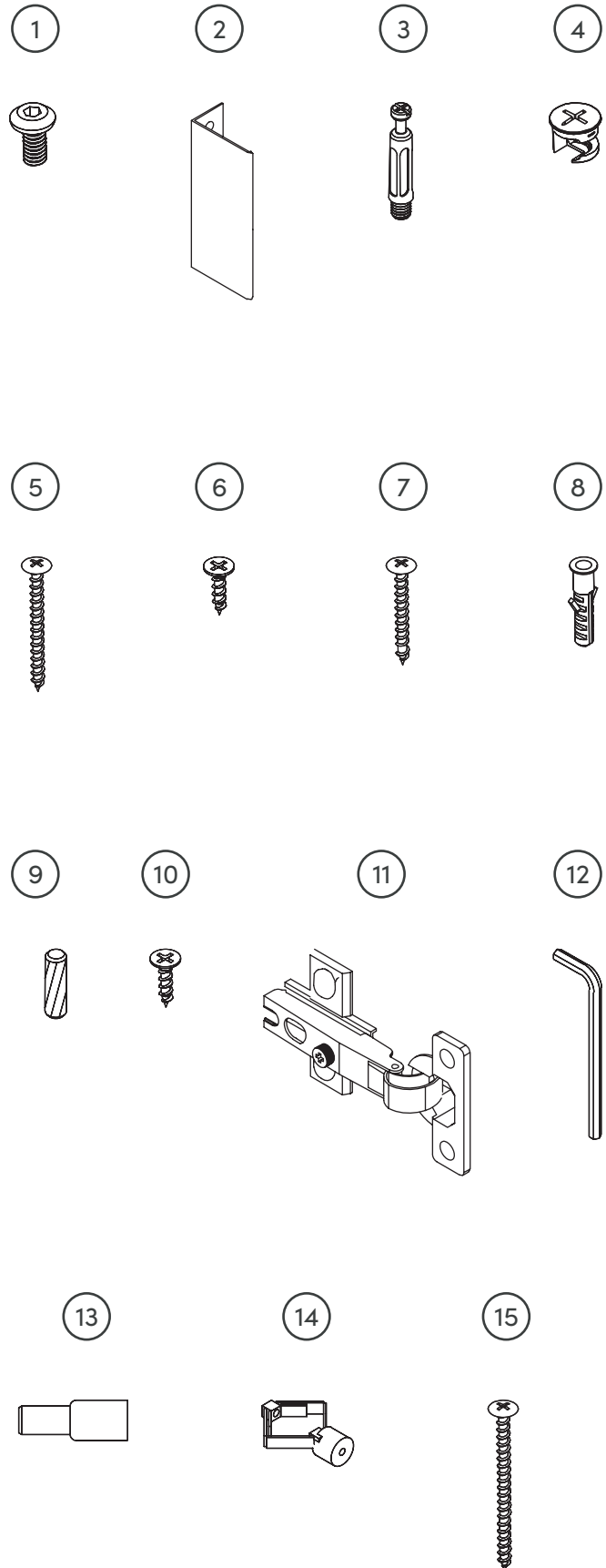

Step 1

It's as easy as it looks! Screw four M6*30mm Cam Bolts (3) into the allotted slots on the Top Panel (I).

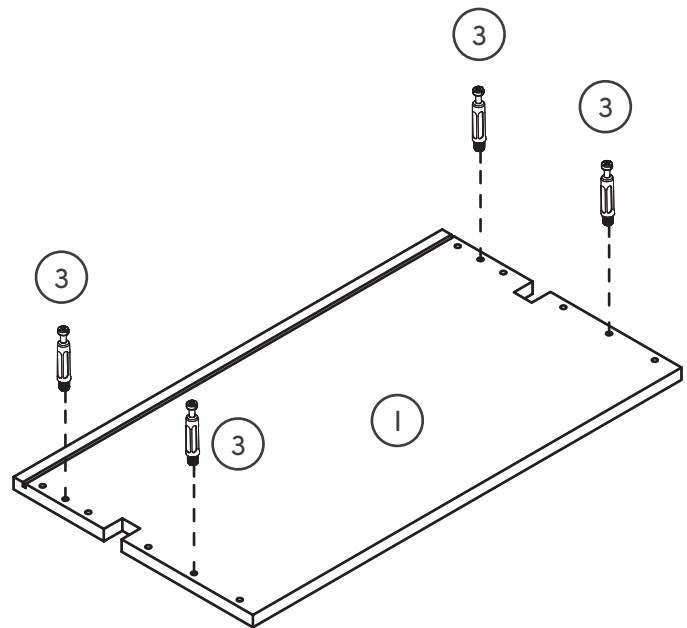
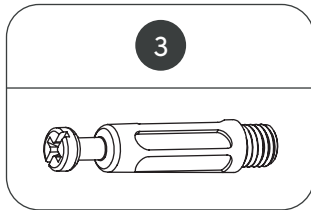

Step 2

Next, insert the 8*30mm Wooden Dowels (9) into the edges of the Left Back Side Panel (D), Left Front Side Panel (E), Right Back Side Panel (F), and Right Front Side Panel (G).

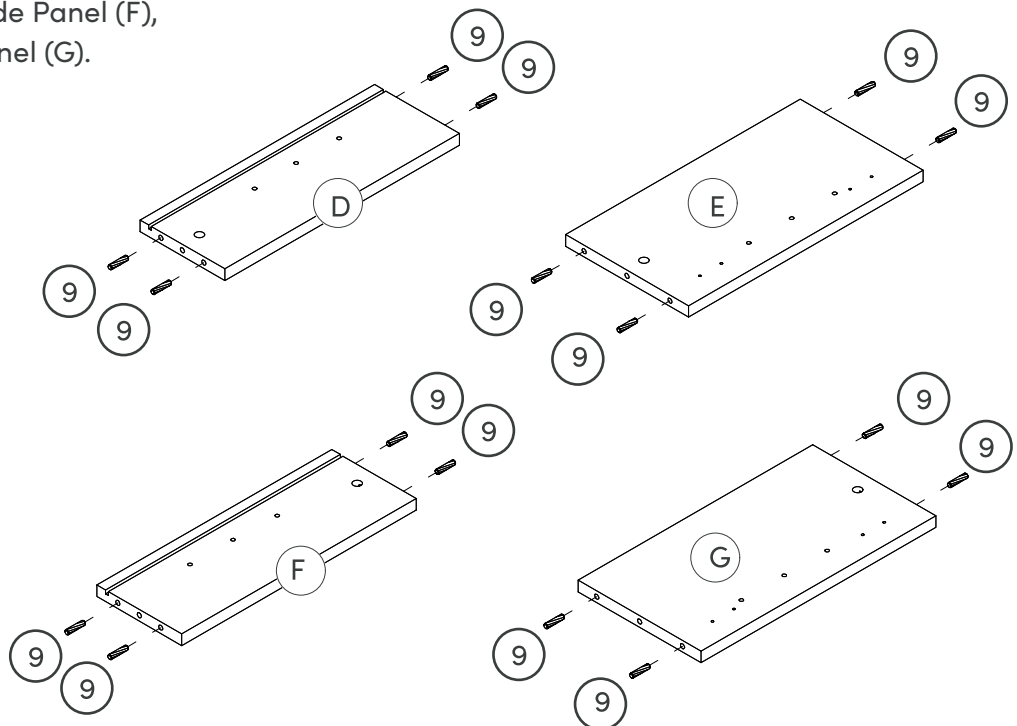
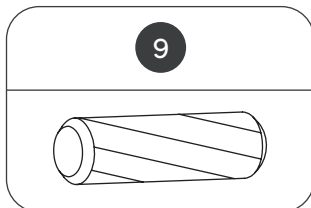

Step 3

Next, slide the Left Back Side Panel (D), Left Front Side Panel (E), Right Back Side Panel (F), and Right Front Side Panel (G) into place on the Top Panel (I) so the cam bolts align with the holes..

Once in place, insert the 15*9.5mm Cam Locks (4) into the holes and twist to lock into place.

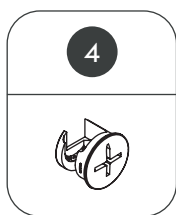

See the following page for Cam Lock Assembly Quick Guide.

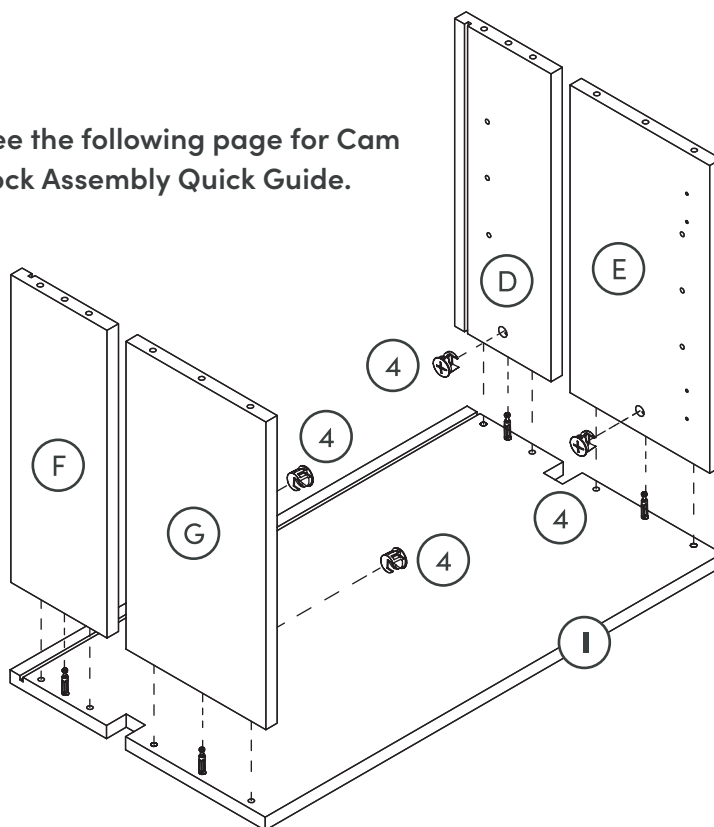

Step 4

Next, slide the Back Panel (H) in place. Once in place, secure the Bottom Panel (J) to the rest of the cabinet using the M4*40mm Screws (5).

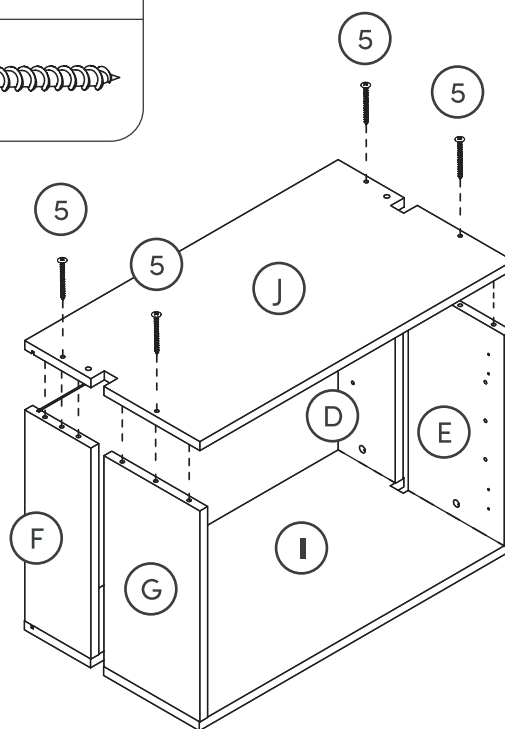
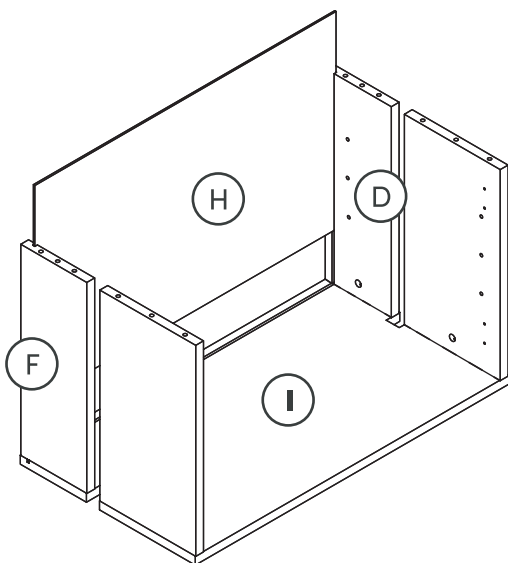
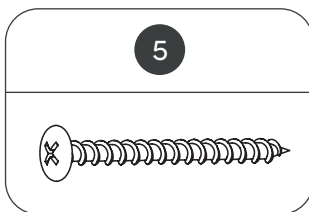

How to use cam locks

Did you know?

Cam locks are used to join two panels together, usually the edge of one to the flat side of another.

First, your cam bolt (or cam pin) will need to be properly inserted into the flat side of the board.

Important Note: Only tighten the cam bolt until it is secure. Do not over-tighten.

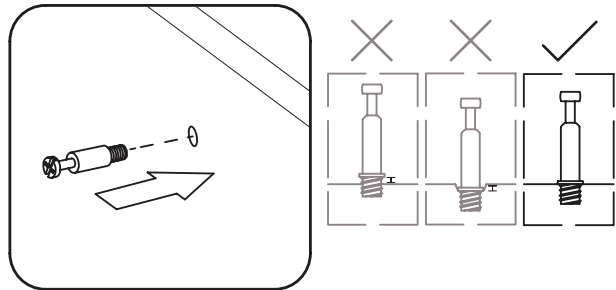

Next, you will fit the proper hole on the edge of the associated joining panel over the cam bolt.

Important Note: When installed properly, the head of the cam bolt will be visible through the larger hole on the side of the joining panel.

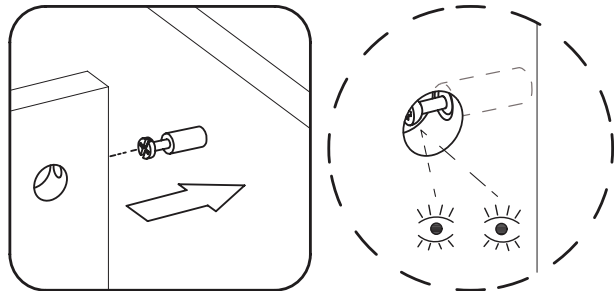

Next, you will notice the cam lock has a "C" shaped back. Commonly, an arrow on the front of the cam lock points in the same direction as the open section on back.

Using these as your cue, insert the cam lock into the large hole so the opening of the "C" fits over the head of the cam bolt.

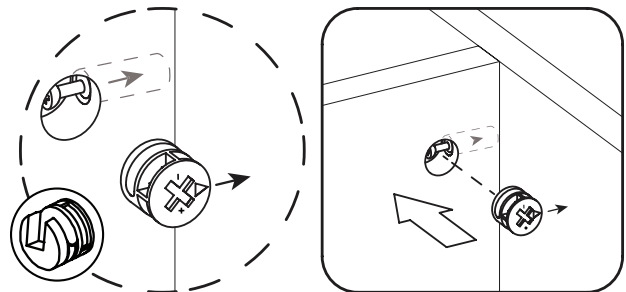

Using a screwdriver, you will turn the cam lock until it stops, usually between 130° or 180°. You will feel the panels pulling closer until they are secured.

Important Note: Only turn the cam lock until the panels are fully engaged & feel secure. Turning too far may lead to hardware failure.

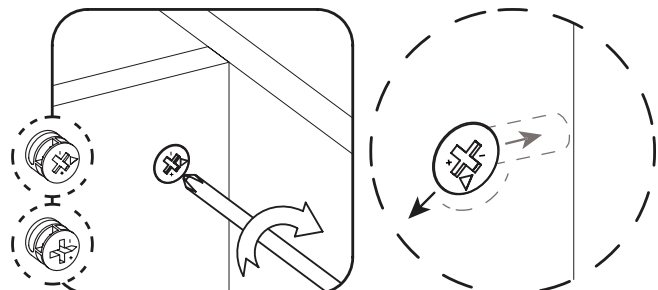

Still having issues?

If a cam lock seems to be spinning in place or is not "catching" or pulling the panels together as expected, first remove the cam lock & try again while making sure that everything is properly positioned & oriented .

If you are still having issues getting things working as expected, first remove the cam lock then unscrew the cam bolt slightly (less than 1 complete turn) to see if that helps with the alignment of the cam lock & bolt.

Step 5

Now assemble the Top Frame Supports (A) to the Bottom Frame Supports (B) by sliding them together and using the M6*15mm Bolts (1) to secure in place.

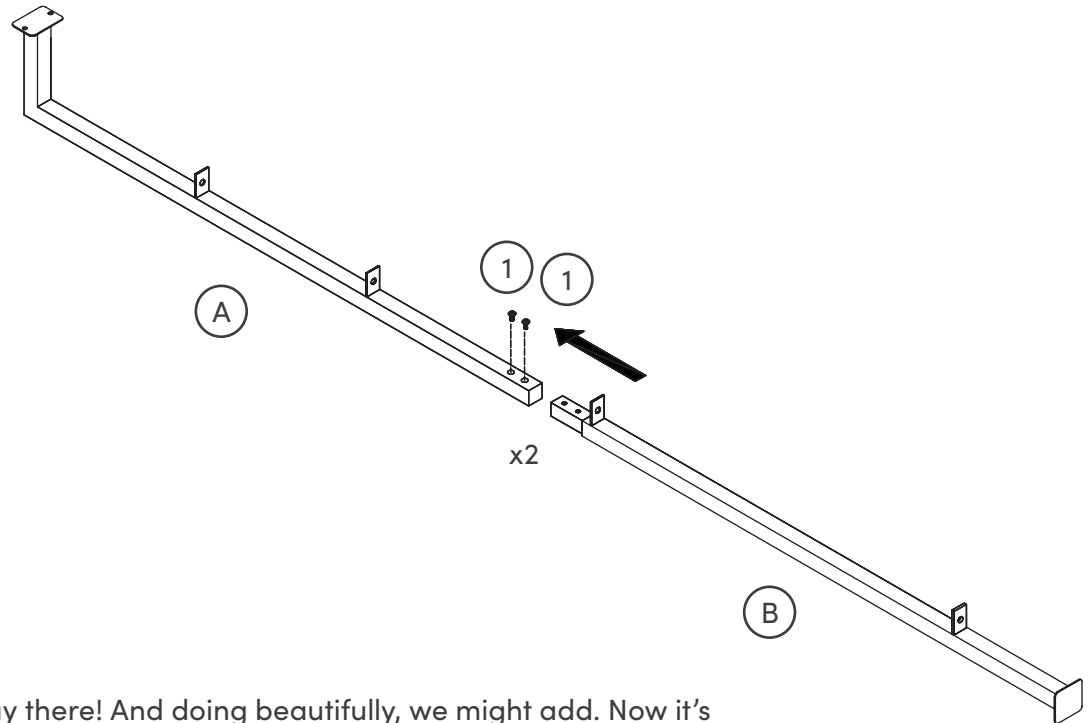
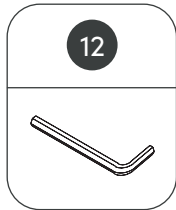
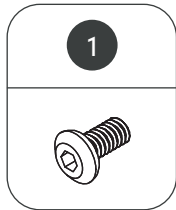

Step 6

You're over halfway there! And doing beautifully, we might add. Now it's time to slide the assembled Frame Supports (A)(B) into the notches in the cabinet and Open Shelves (C). Secure in place using the M6*15mm Bolts (1).

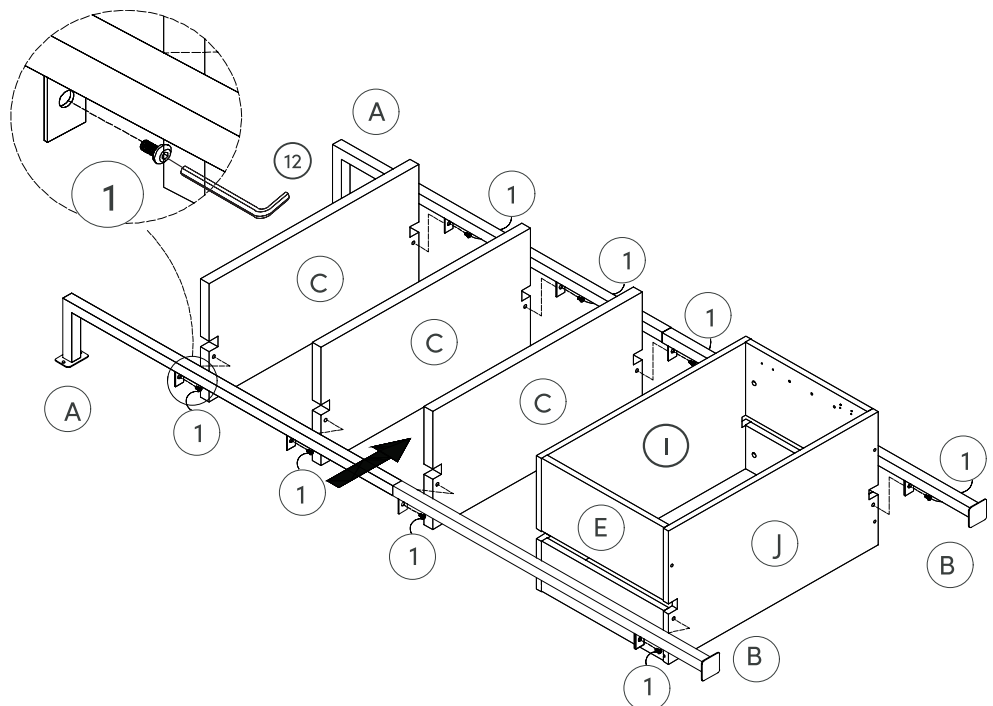
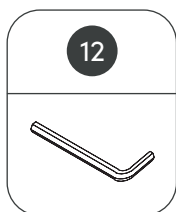
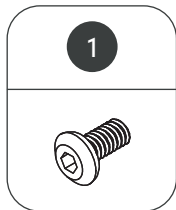

Step 7

Next, grab a friend and gently place the bookcase into an upright position.

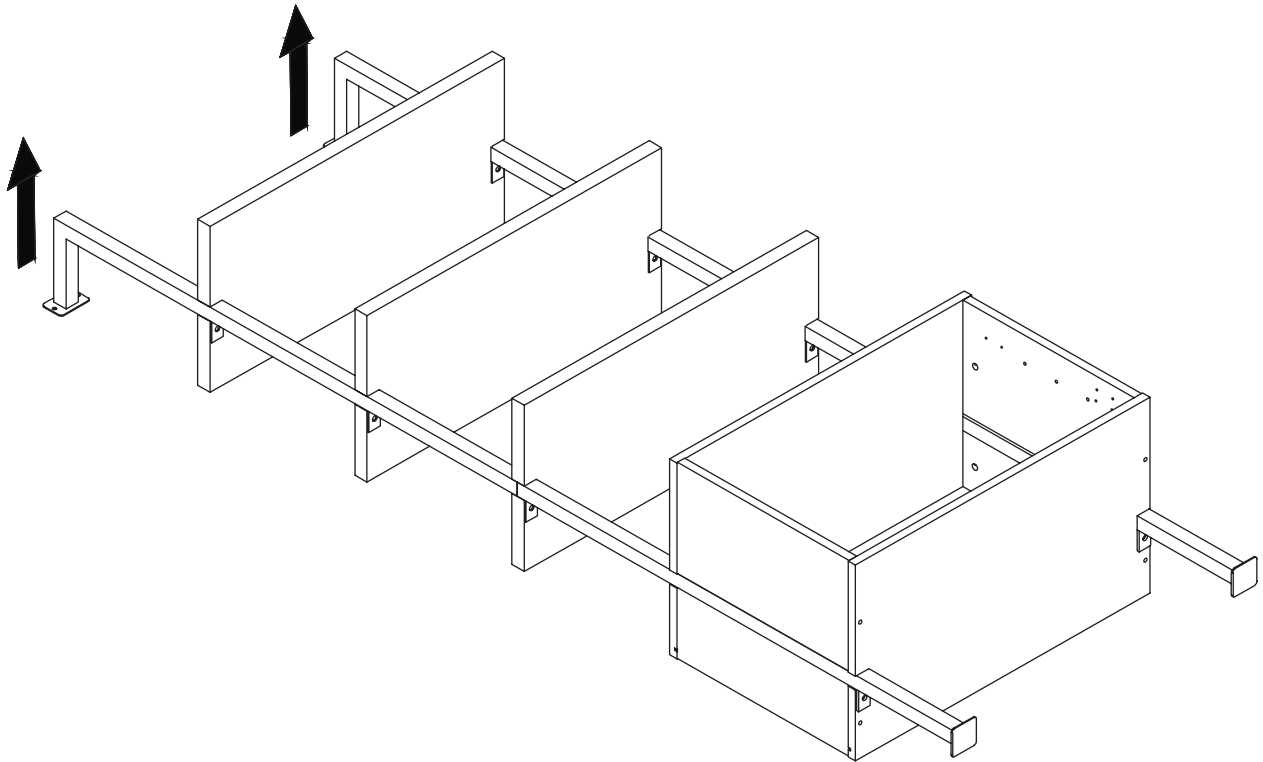

IMPORTANT TIP

To prevent parts from breaking while placing the bookcase unit upright be sure to:

- 1) Have at least 2 people grab the bookcase on each side prior to lifting to an upright position. (Do not grab & move the bookcase by the top and bottom ends)
- 2) When rotating the bookcase to an upright position, try not to use the feet as a pivot point to avoid applying stress on the components.

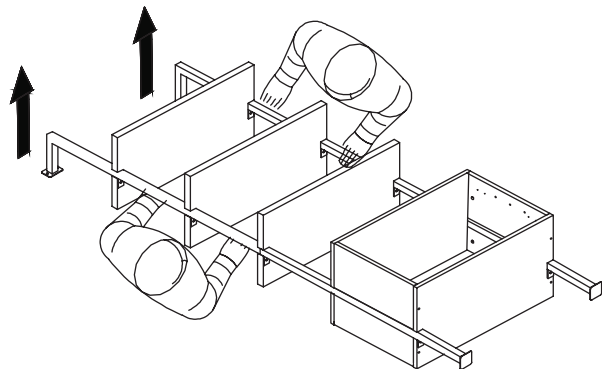

Step 8

Now it's time to secure this puppy to the wall!

If your walls are drywall, use the Drywall Anchors (14) and the M4.2*50mm Screws (15) to secure the bookcase to the wall.

If your walls aren't drywall, use the Non-Drywall Anchors (8) and the M4.2*32mm Screws (7) to secure the bookcase to the wall.

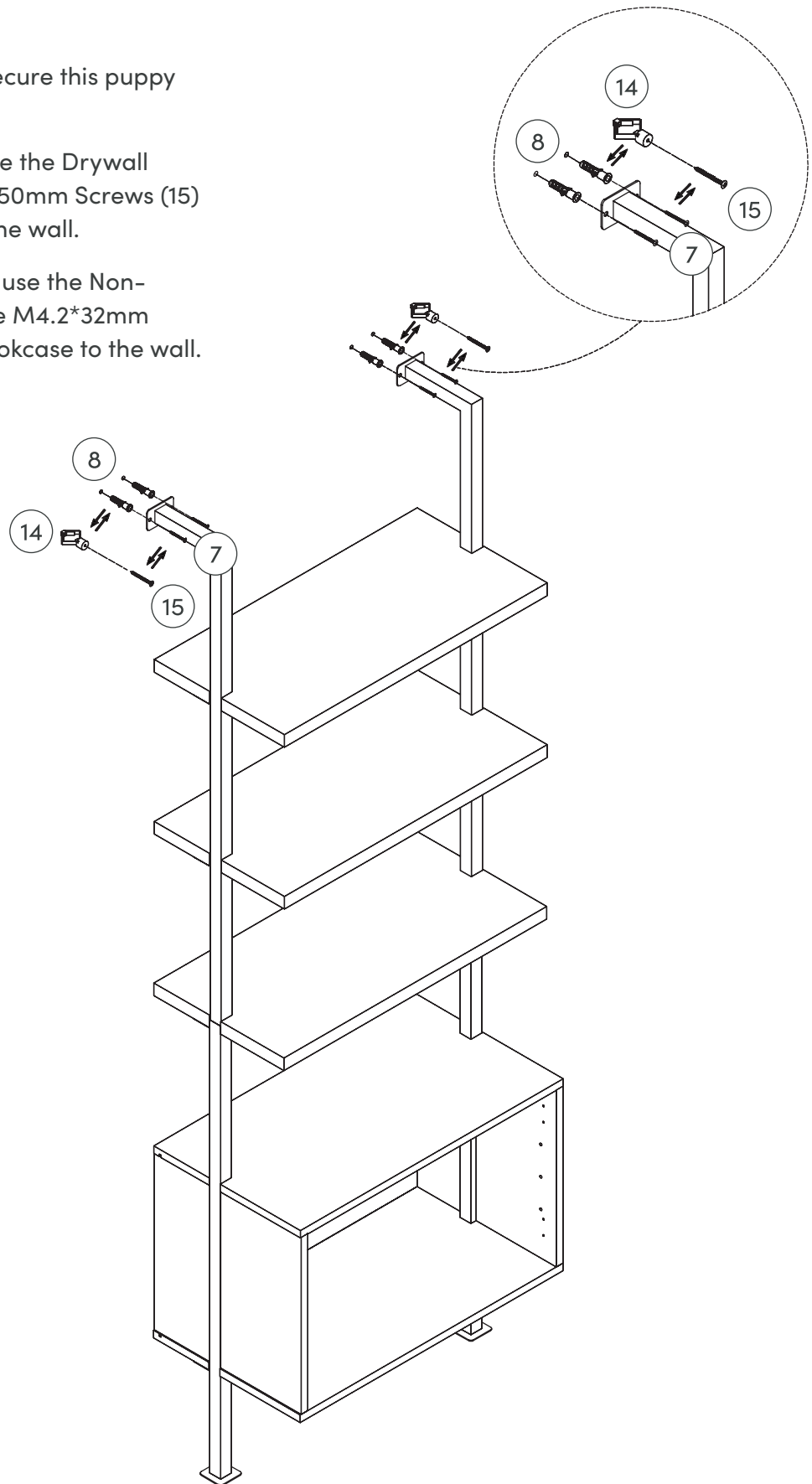

**Flip ahead to see
detailed instructions
for using wall anchors.**

Step 8 (cont.)

Non-drywall application

Mark it

Choose your desired location on the wall, have a friend hold the bookcase in place, and use a pencil to mark where the anchors will go.

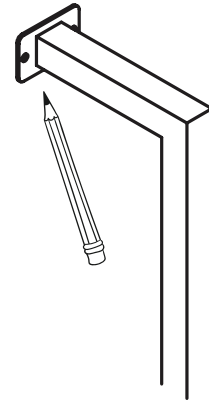

¼" Drill bit

Move the bookcase to the side and, following the marks you just made, use a ¼" drill bit to drill 2 holes into the wall.

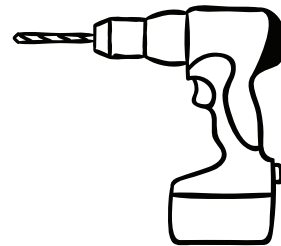

Insert the anchors

Go ahead and tap the wall anchors into place in the new holes you just drilled. If you're feeling strong, just push them into place.

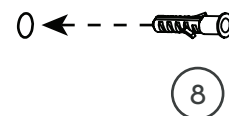

All about the angle

Insert 1 screw through each metal bracket and into the wall anchor. Tilt your Phillips head screwdriver, and secure but do not overtighten.

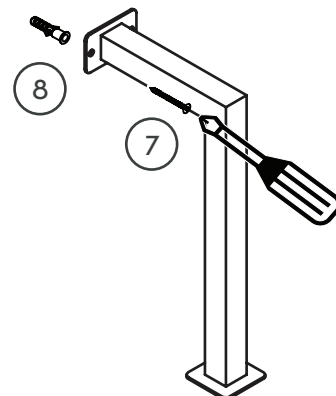

Step 8 (cont.)

Drywall application

Mark it

Choose your desired location on the wall, have a friend hold the bookcase in place, and use a pencil to mark where the anchors will go.

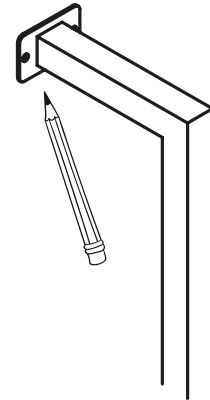

5/16" Drill bit

Move the bookcase to the side and, following the marks you just made, use a 5/16" drill bit to drill 2 holes into the wall.

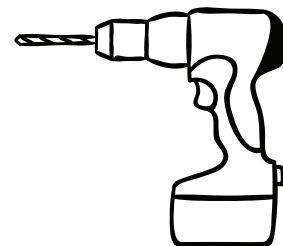

Insert the anchors

Go ahead and tap the wall anchors into place in the new holes you just drilled. If you're feeling strong, just push them into place.

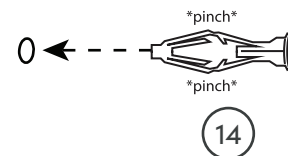

All about the angle

Insert 1 screw through each metal bracket and into the drywall anchor. Tilt your Phillips head screwdriver, and secure but do not overtighten.

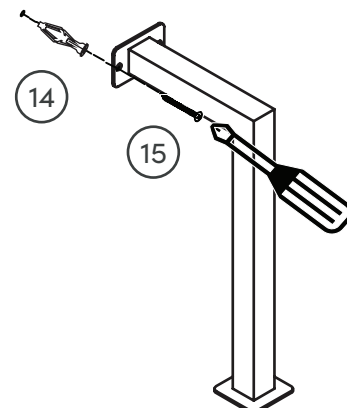

Step 8 (cont.)

How to use drywall anchors

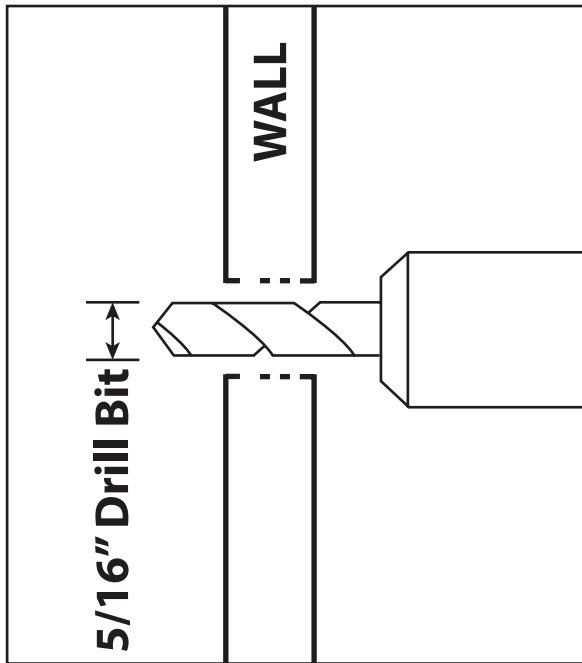

1. Drill hole with 5/16" bit

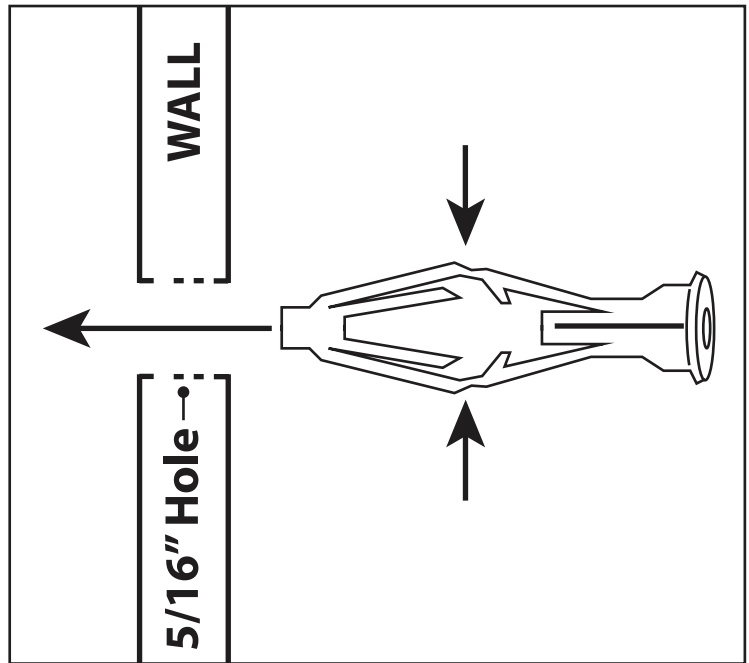

2. Pinch and insert

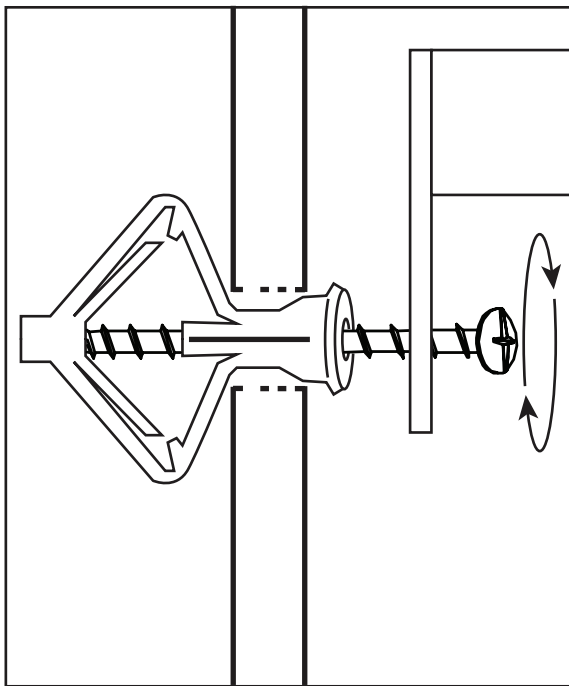

3. Begin tightening

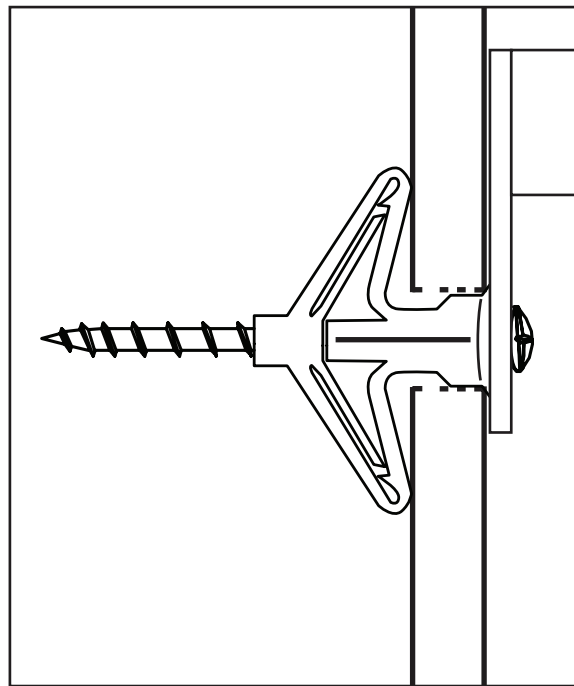

4. Tighten to 100%

Step 9

You're almost done! We made this step easy, don't worry.

Insert the Shelf Pins (13) into the desired holes in the cabinet. Once inserted, slide the Shelf (K) into place. In order to fit the shelf inside the cabinet, you will need to tilt the shelf to angle it in properly.

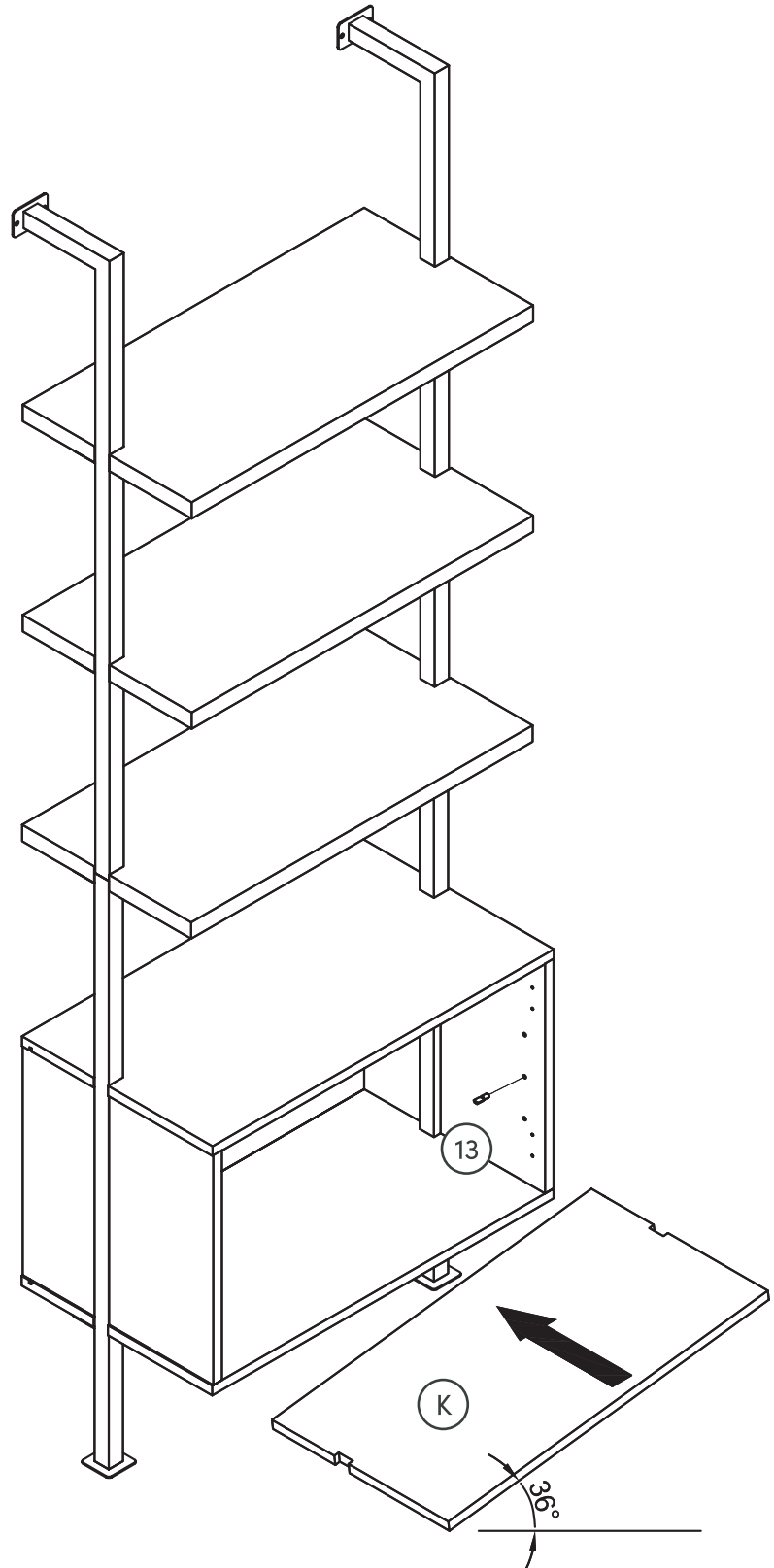
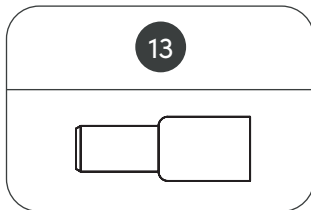

Step 10

Now it's time to assemble the doors. Place the Hinges (11) into the Door Panels (L). Secure in place using the M4*14mm Screws (10). Repeat this same process on the inside of the cabinet where the doors attach.

Then, secure the Handles (2) in place using the M4*12mm Screws (6).

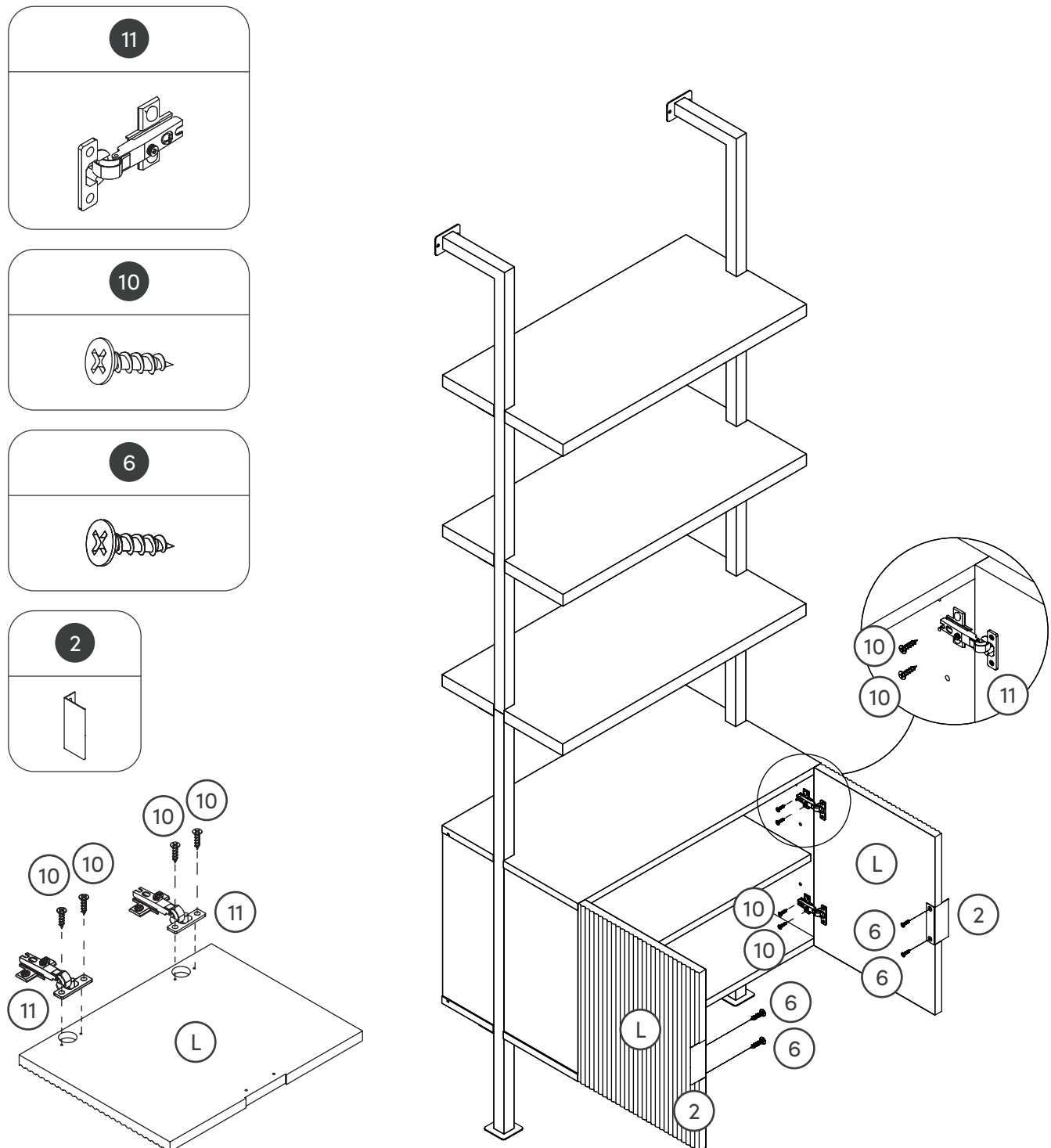

Is your cabinet door looking crooked or unevenly spaced?

Then you've come to the right place. Follow the illustrations below to get your cabinet door aligned and ready for action.

If your door is too low or too high...

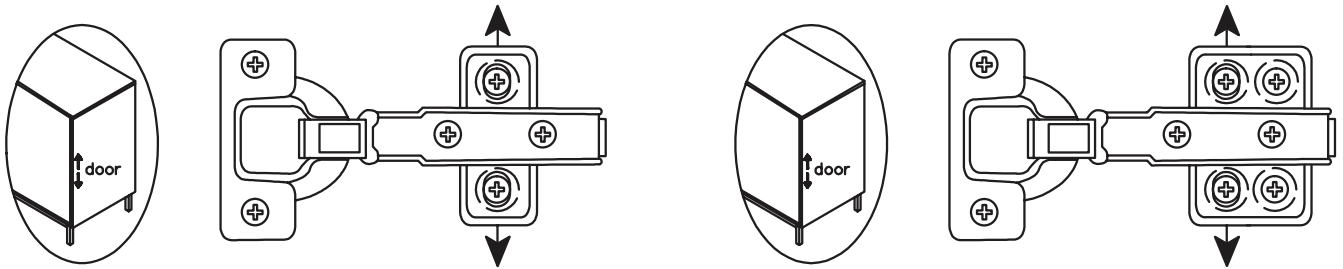

Loosen the height screws, then move the door up or down to make it level.

If the space between your doors is off...

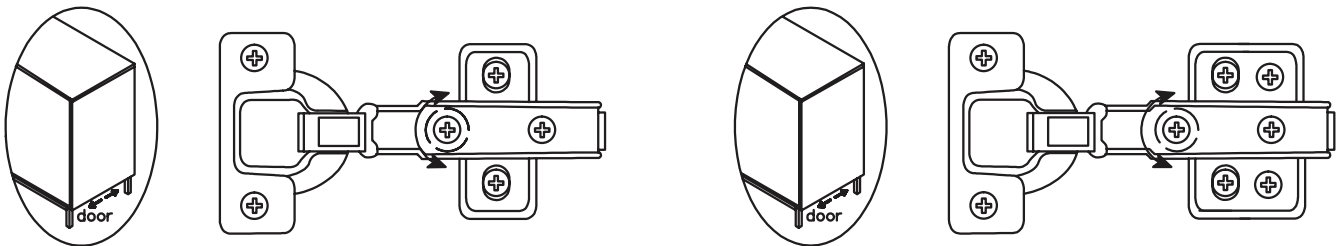

Loosen the side-to-side screws, then screw counter-clockwise to make the gap wider or clockwise to close any gaps.

If you need to adjust the depth of the doors...

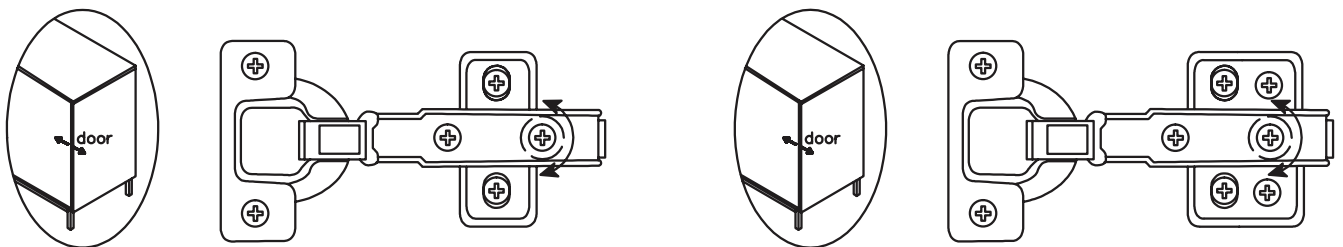

Adjust the in-and-out screws until the door is aligned with the side of the cabinet.

Step 11

To adjust the height of the cabinet shelf position, simply remove all of the metal pins on either side, move the pins to the desired hole height, and replace the shelf.

And that's it, your new bookcase is complete!

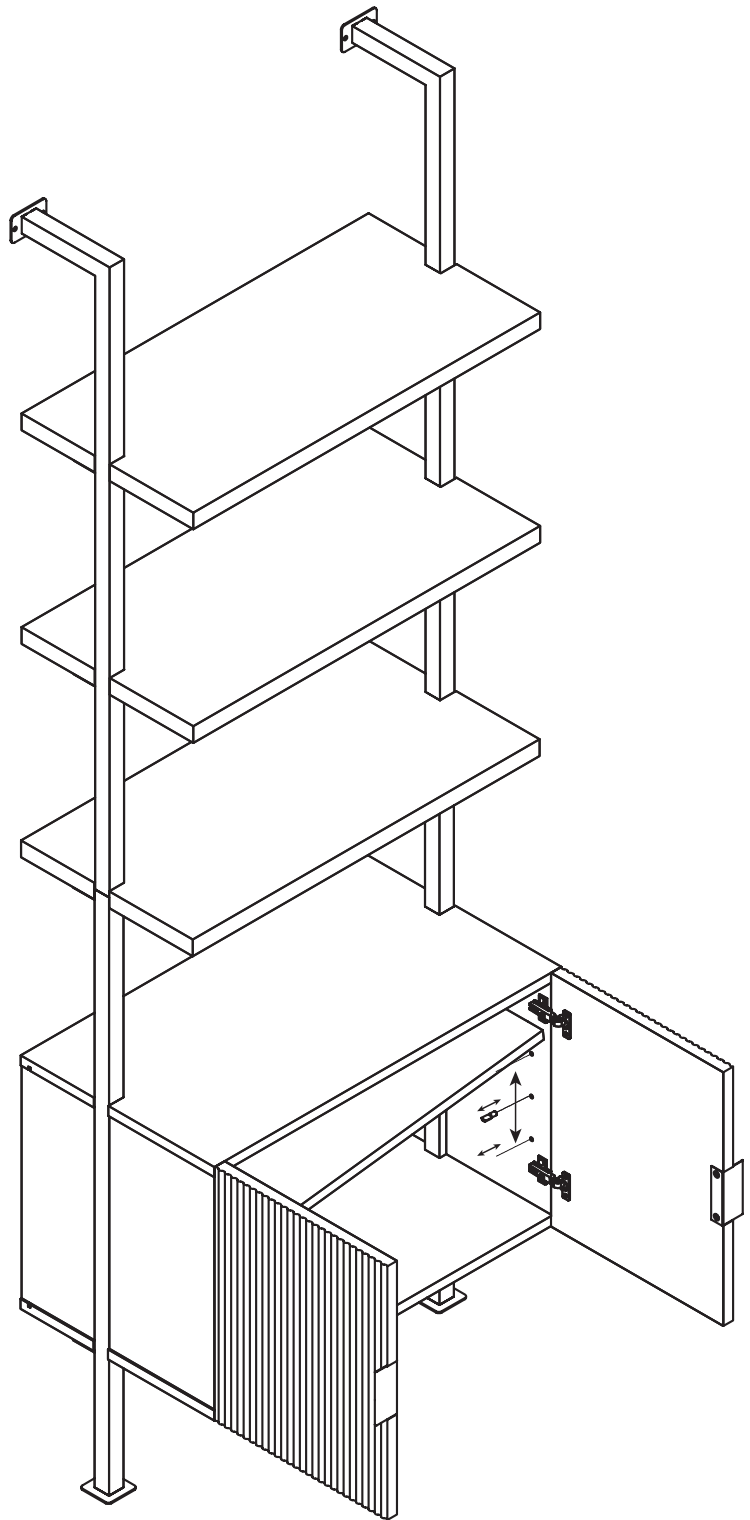

No heartburn, when we handle the return

Give us a call **1-866-619-1004** or shoot us a message
at **help@nathanjames.com** we will issue you a free
replacement with **zero hassle**.

Our way



Give us a call



Replacement



You

Their way



Re-package item



Schedule pick up



Track package



Replacement



You

We really don't want you to go through the hassle of re-packaging your item
and sending it back, because let's be honest...nobody has time for that.

Safety first, fun later

We want your product to last as long as possible, so we recommend that you tighten the screws 2 weeks after assembly and for added safety check the tightness of all screws every 2 months.

For proper care and treatment, please check our website at NathanJames.com/products

Safe use of this product starts with you.

Use this product responsibly with the primary concern for your safety. Follow assembly instructions carefully and inspect product upon receipt and each use.

Nathan James and its parent companies cannot be held legally responsible for any injuries or death resulted from failure to follow instructions or improper use of this product.

Do not modify the structure of this product in any way.

Our products have been tested to meet specific safety measures as they were originally intended to be sold. Any modifications will present the risk of creating significant safety issues which NJ will not be responsible for.

Proper use

DO NOT	use for commercial purposes
DO NOT	frolic on bookcase
DO NOT	use bookcase as foot stool
DO NOT	leave spilled liquid on bookcase
DO NOT	use bookcase if damaged
DO NOT	make temporary repairs
DO NOT	use outdoors

We are only in business if you're happy

For starters, thanks for being you.

☎ Toll-free at 1-866-619-1004

✉ Help@nathanjames.com

🌐 NathanJames.com/help

We do our best to ensure your furniture arrives without any problems, but occasionally mistakes happen—as humans we are imperfect beings. In the event that a part is damaged or missing, we will be more than happy to provide you with replacement part(s) for free.

Warranty

This product comes with a lifetime warranty from the date of purchase. Please use your phone to scan the QR code to register your product or visit <https://goo.gl/i9dk3q>

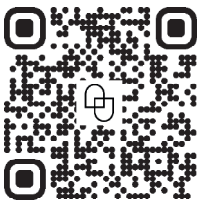

Did we do alright? Please spread the love!

If you are happy with your product, tell your friends and family about us or even better leave us a review online. Spreading the word gives us the opportunity to make more people happy and keep our prices low for your next purchase.

Brooklyn Burdon

Founder, Nathan James