

User's Manual

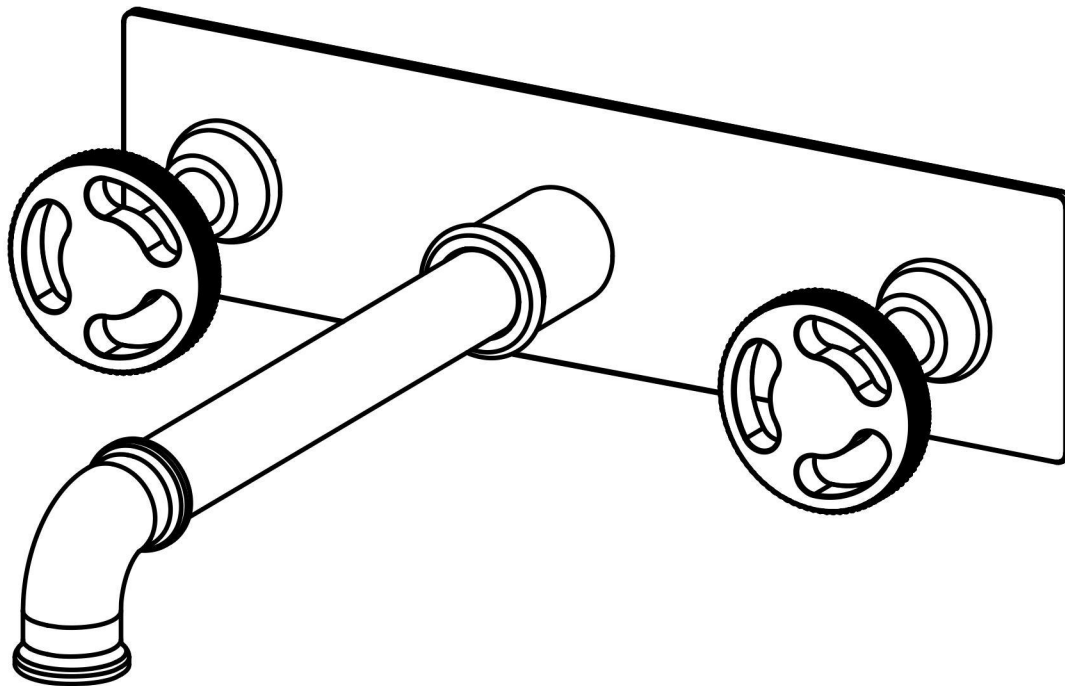

Installation Manual



5001 East Philadelphia Street, Ontario, California 91761-2816 • USA • 909-472-4100 • 909-472-4244 • www.iapmort.org



C

This certificate is not evidence of current listing. To verify listing status, visit the IAP950 R&T Product Listing Directory at pld.iapmo.org

Effective Date: December 2019 -Rev. 2/24/2020- Void After: December 2024

Issued To: Fanshi Group Inc.
Mechanical & Electrical
Industrial Zone,
Yuhuan County,
Yuhuan 317600, ZHEJIANG
China

Identification: Products shall be marked with manufacturer's name or trademark, a statement "For use with water in accessible locations only." The products shall also bear the cUPC® certification mark. Markings shall be by means of either a permanent mark on the product, a label on the product or a tag attached to the product.

Characteristics: Flexible water connectors manufactured in various sizes, lengths and metal end fittings for hot or cold water applications that consist of an inner tube, which may or may not have an outer braided cover. Connectors are to be installed for use in accessible locations only. To be installed in accordance with the manufacturer's instruction, and the latest edition of the Uniform Plumbing Code and National Plumbing Code of Canada.

Products listed on this certificate have been tested by an IAPMO R&T recognized laboratory. This recognition has been granted based upon the

Tim Collings
Chairman, Product Certification Committee

Ron Chaney
CEO, The IAPMO Group

This listing period is based upon the last date of the month indicated on the Effective Date and Void After Date shown above. Any change in material, manufacturing process, marking or design without having first obtained the approval of the Product Certification Committee, or any evidence of non-compliance with applicable codes and standards or of inferior workmanship, may be deemed sufficient cause for revocation of this listing. Production of or reference to this form for advertising purposes may be made only by specific written permission of IAPMO Research and Testing, Inc. Any alteration of this certificate must be grounds for revocation of its validity.

5001 East Philadelphia Street, Ontario, California 91761-2816 • USA • 909-472-4100 • 909-472-4244 • www.iapmort.org



C

This certificate is not evidence of current listing. To verify listing status, visit the IASMO R&T Product Listing Directory at pld.iasmo.org

Effective Date:	November 2019	Void After:	November 2024
Product:	Stocking Foots, Fittings	File No.	10639

Issued To: Aqua Gallery Co., Ltd
13th-15th A10 Block
International Ceramics
Sanitary City, 528000
Foshan,
China

Identification: Plumbing supply fittings complying with this Standard shall be marked with the manufacturer's recognized name, trademark, or other mark or, in the case of private labeling, the name, trademark or other mark of the customer for whom the fitting was manufactured. The marking shall be accomplished by use of a permanent mark or by placing a permanent label on the product. Markings on plumbing supply fittings shall be visible after installation.

Single-handle, single-control, and automatic compensating mixing bath and shower valves shall have identifiable temperature control settings in which the settings are indicated by words ("cold", "warm", "hot", etc.), by numbers, or graphically.

Packages shall be marked with the manufacturer's name, trademark, or other mark as well as the model number or, in the case of private

Tim Collings
Chairman, Product Certification Committee

Ron Cheney
CEO, The IAPMO Council

Life/period is based upon the last date of the month indicated on the Effective Date and Void After Date shown above. Any change in material, manufacturing process, marking or design without having first obtained the approval of the Product Certification Committee, or any evidence of compliance with applicable codes and standards or of interior workmanship, may be deemed sufficient cause for revocation of this listing notice or reference to this form for advertising purposes may be made only by specific written permission of IAFIRO Research and Testing, Inc. objection of this, cert@iafiro.com or by a written letter of objection to the listing. This document will be reproduced in its entirety.

5001 East Philadelphia Street, Ontario, California 91761-2816 • USA • 909-472-4100 • 909-472-4244 • www.iapmort.org



C

 IAPMO Research and Testing, Inc. is a product certification body which tests and inspects samples taken from the supplier's stock or from the market or a combination of both to verify compliance to the requirements of applicable codes and standards. This activity is coupled with periodic surveillance of the supplier's factory and warehouses as well as the assessment of the supplier's Quality Assurance System. This testing is subject to the conditions set forth in the characteristics below and is not to be construed as any recommendation, assurance or guarantee by IAPMO Research and Testing, Inc. of the product acceptance by Authorities Having Jurisdiction.

This certificate is not evidence of current listing. To verify listing status, visit the IAPMO R&T Product Listing Directory at old.iapmo.org

Effective Date: March 2019 Void After: March 2024

Issued To: Ningbo Wanhai Cartridge Technology Co., Ltd
Xiachen Zone, Chunhu
Penghua, NINGBO 315538
China

Identification: Each fitting component shall bear permanent legible markings to identify the manufacturer. This marking shall be the trade name, trademark, or other mark known to identify the manufacturer. The product shall also bear all other markings required by the standard. The marking shall be applied so as to be visible after installation. The product or packaging shall also bear the cUPC® certification mark along with the term "COMPONENT" above.

Characteristics: Plumbing fixture fitting components to be installed in accordance with the manufacturer's instructions and the requirements of the latest edition of the Uniform Plumbing Code.

Products listed on this certificate have been tested by an IAPMO R&T recognized laboratory. This recognition has been granted based upon the laboratory's compliance to the applicable requirements of ISO/IEC 17025.

Products are in compliance with the following code(s):

Tim Colberg
Chairman, Product Certification Committee

Ron Chan
CEO, The IAFMO Group



This listing period is based upon the last date of the month indicated on the Effective Date and Valid After Date shown above. Any change in material, manufacturing process, marking or design without having first obtained the approval of the Product Certification Committee, or any evidence of non-compliance with applicable codes and standards or of inferior workmanship, may be deemed sufficient cause for revocation of this listing. Production of or reference to this form for advertising purposes may be made only by specific written permission of IAPMO Research and Testing, Inc. Any alteration of this certificate may be grounds for revocation of the listing. This document shall be submitted to the relevant

INSTALLATION STEPS

This product has been inspected and debugged by the factory to the best condition. Please do not disassemble and assemble it yourself.

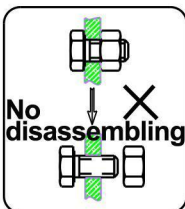

Before installing the product, please be sure to remove sundries and sludge from the water pipe to prevent sundries from blocking the product.

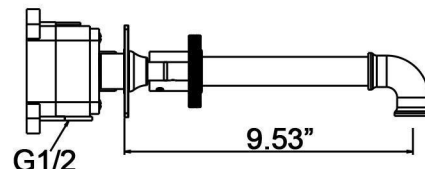
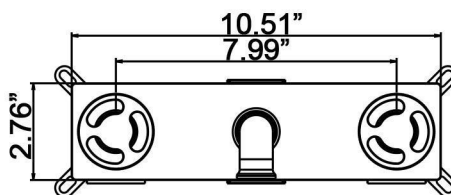
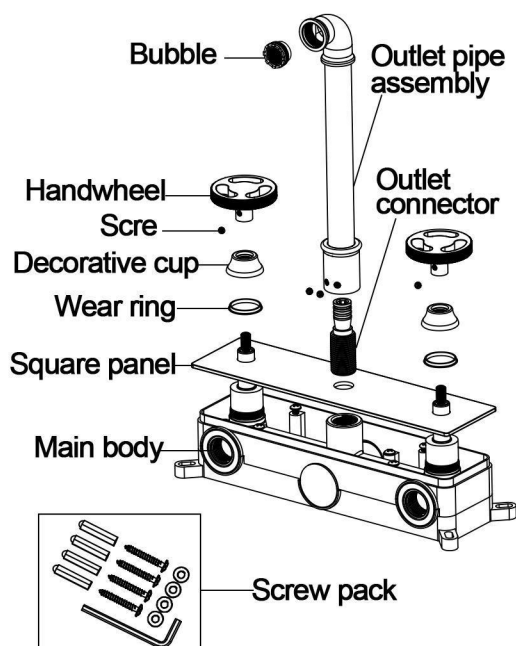

► Parameter:

Working water pressure: recommended water pressure 0.1-0.5MPa

Maximum water pressure: up to 0.8MPa

Maximum water temperature: up to 85°C

Suggested hot water temperature: 60°C

Ambient temperature: 5°C-45°C

This information is for installation masters or professionals, please give the instructions to users.

► Conditions of Use:

It cannot be used with non-pressurized heaters for indoor public health environments or other similar environments.

If the inlet water pressure exceeds 0.5Mpa, a pressure reducing valve must be installed to avoid excessive pressure in the hot and cold water pipes.

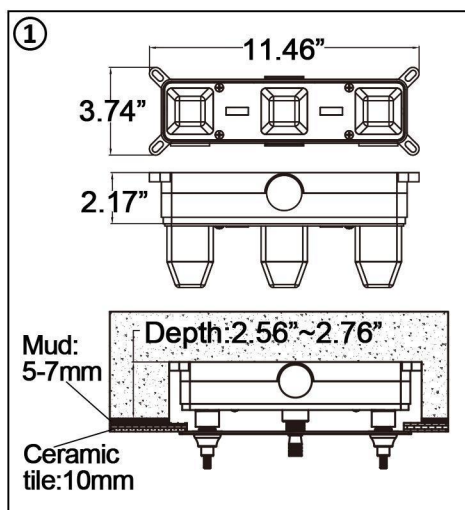

1. Determine where the concealed valve will be installed on the wall. Make a suitable hole in the wall (Figure 1).

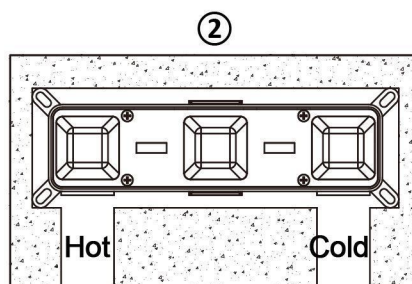

2. Install the concealed box on the wall, and connect the G1/2 hot and cold water supply pipe with the "Hot water" sign on the left (Figure 2). Note: Ensure that the center line of the valve body is perpendicular to the wall and the upper plane of the concealed box is horizontal. Keep the plastic shield on the valve body during installation.

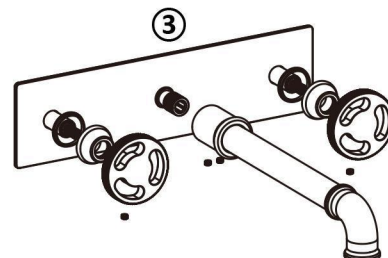

3. As shown in Figure 3 After finishing the wall decoration, Install the decorative sheet, decorative cover, spout and handle correctly.

CLEANING CARE

In order to keep the appearance of product clean, bright and good performance, please take care of the product as follows;

1. Rinse with water only and dry with soft cotton cloth;
2. Use mild liquid and colorless glass cleaner to remove surface dirt and scale film, or use polish without abrasive effect;
3. Do not use abrasive detergent, polish, emery cloth, paper towel or scraper, etc;
4. Do not use acid cleaner, or cleaner and soap with insoluble gran etc;
5. In the process of use, mud may accumulate in the bubbler and make the water flow show, The bubbler can be unscrewed, rinsed with water, and then installed back in place.



