

# INSTALLATION INSTRUCTION

A

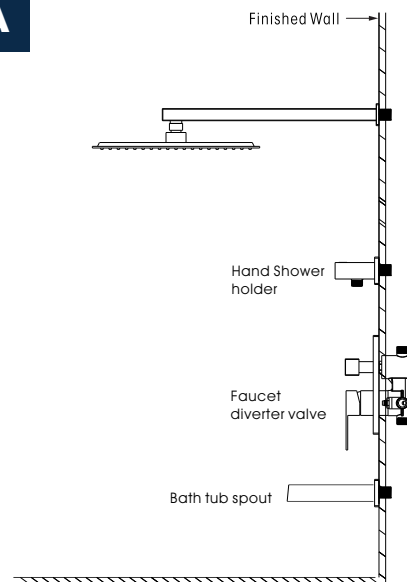

B

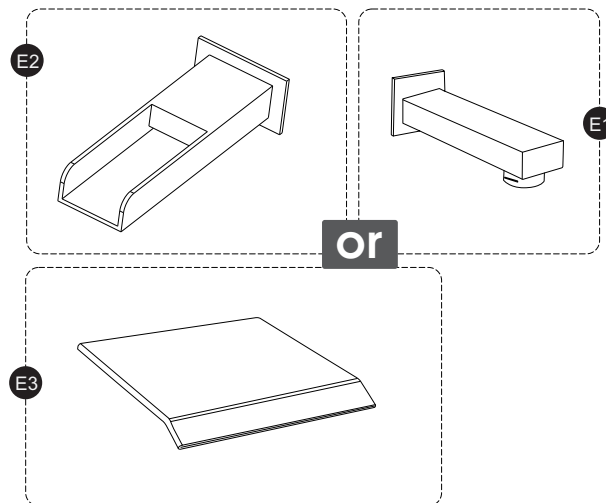
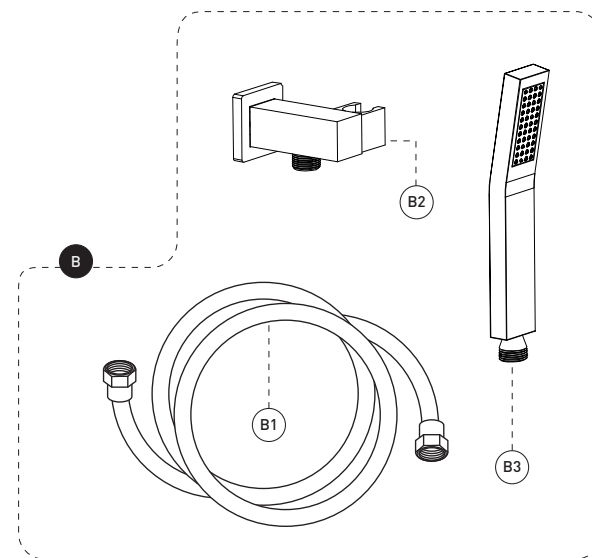
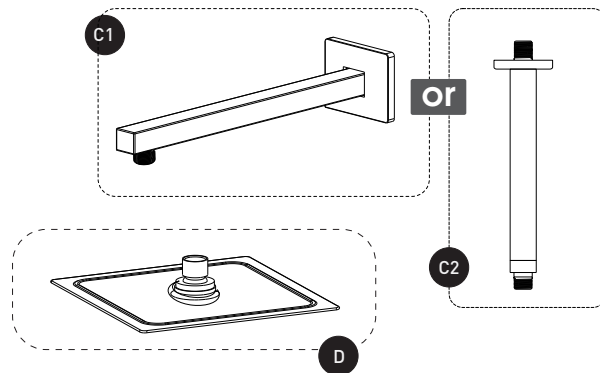
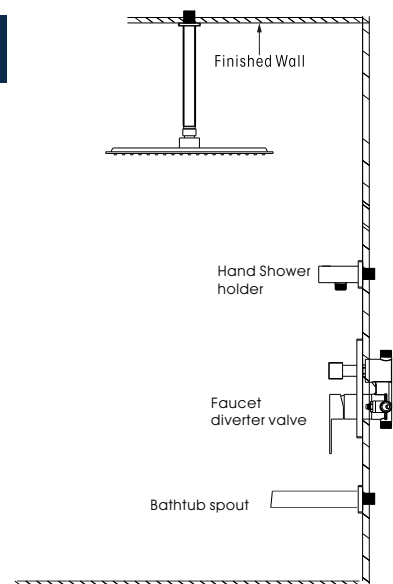

No

Description

A

Pressure balanced diverter valve

A-1

Valve

A-2

Face plate with sealjoint

A-3

Diverter kit

A-4

Fauset handle

A-5

Trim cap

A-6

Allen screw

B

Sliding bar kit withflexible hose

B-1

Flexible hose

B-2

Hand shower holder

B-3

Hand shower

C1

Shower arm and flange kit

C2

Ceiling shower arm and flange kit

D

Shower head

E1

Bathtub spout

E2

Bathtub spout waterfall

E3

Bathtub spout waterfall-plus

## RECOMMENDED TOOLS

Plumber's putty



Thread seal tape



Included

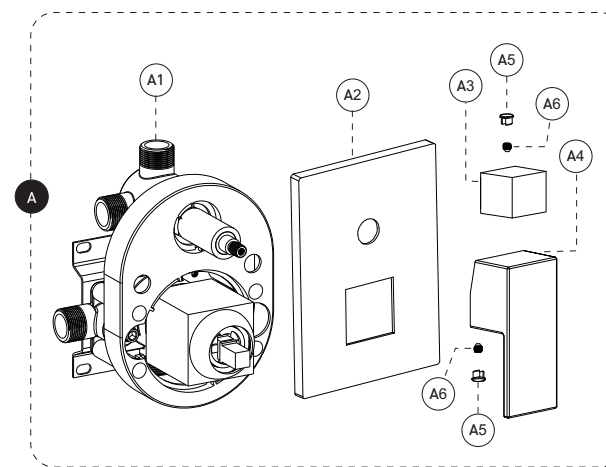
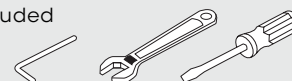

## SHOWER SYSTEM FAUCET

Installation instruction

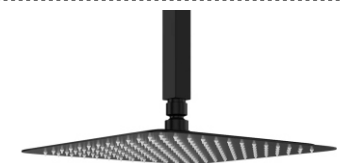

MB/BN/BG/CH/ORB

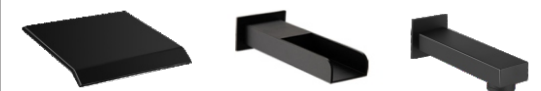

# ! IMPORTANT

We recommends using a professional plumber for all installation and repair. Please inform yourself about the canadian plumbing code`s regulations and your local municipality plumbing codes before installlation.the canadian plumbing code requires the installation of urge arresting devices to eliminate water hammering.allow an adequate opening in order to easily access connections or other plumbing devices for maintenance or repair.

## INSTALLATION STEPS

### BEFORE YOU BEGIN

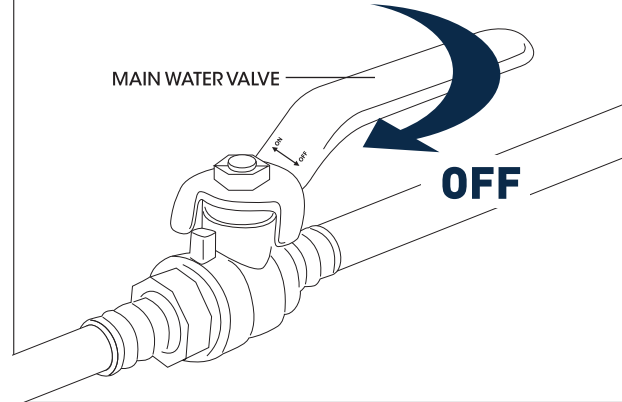

### INSTALLATION WAY

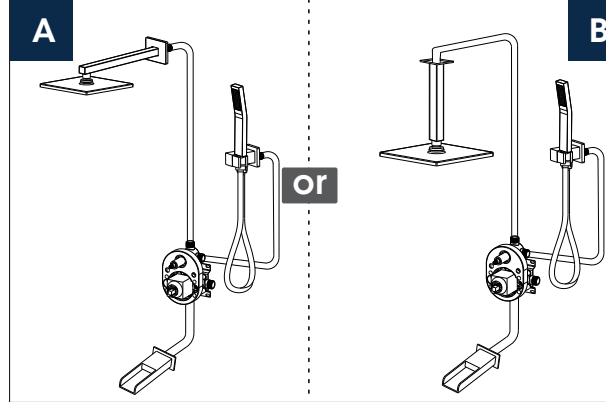

Rough-In-Installation primaire

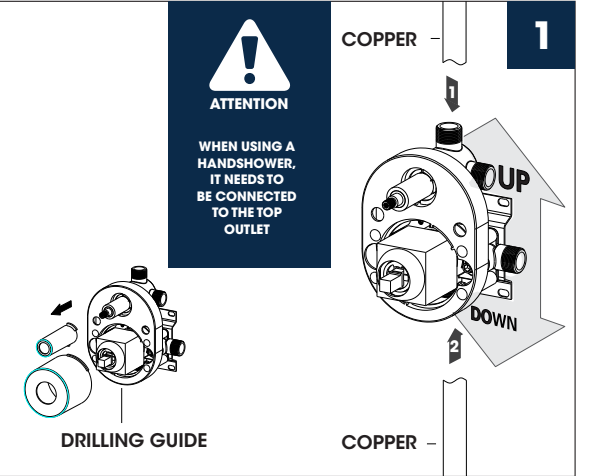

2

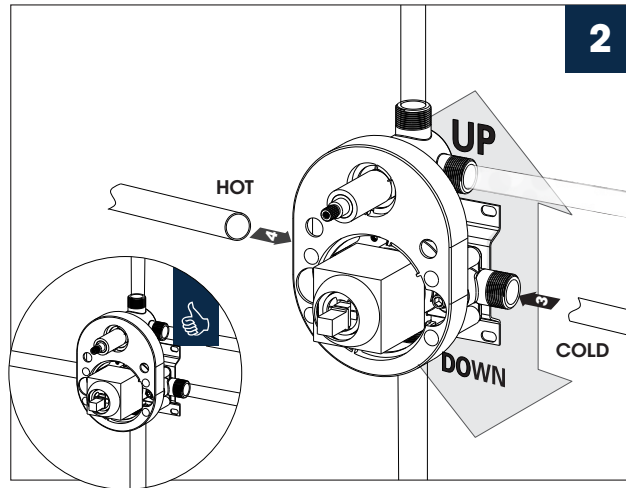

3

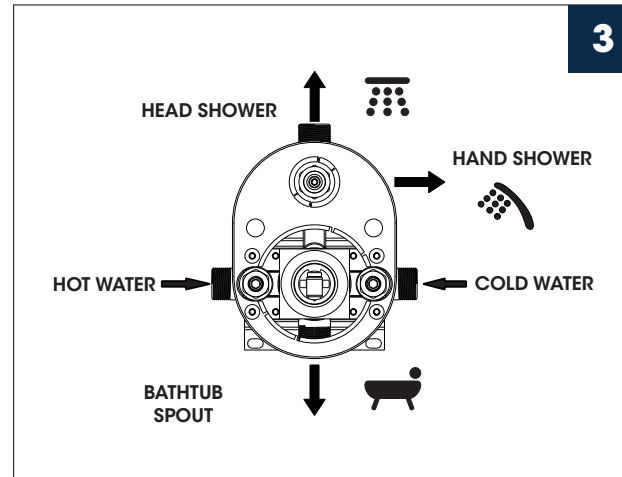

4

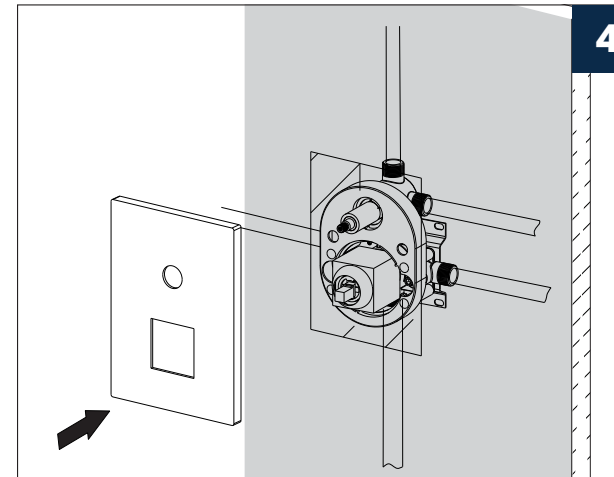

5

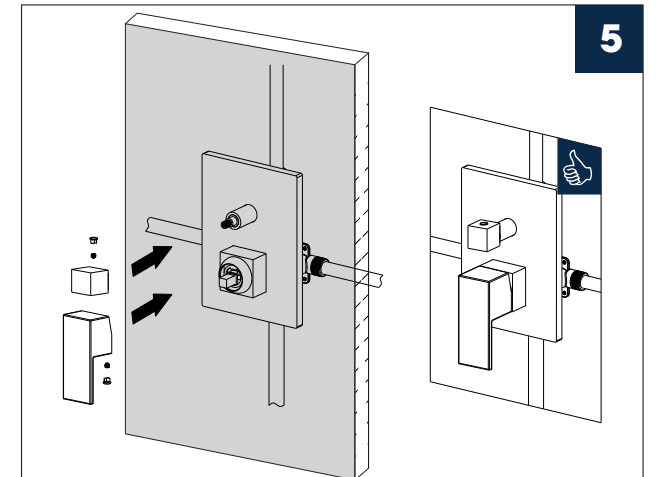

### HEAD SHOWER

6A

6B

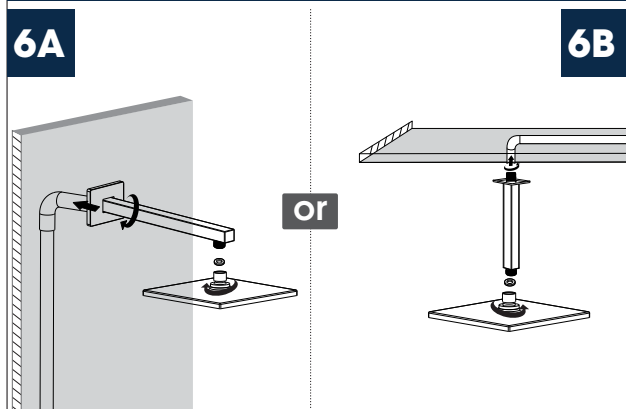

### HAND SHOWER

7

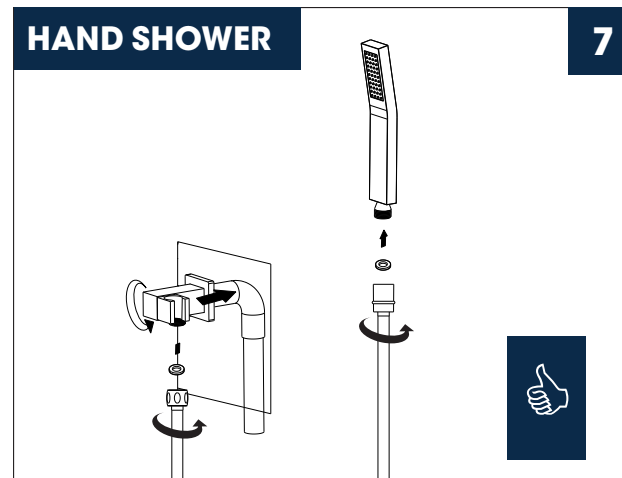

### BATH TUB

8

