

FLRL0920 RGB Corner Floor Lamp User Guide

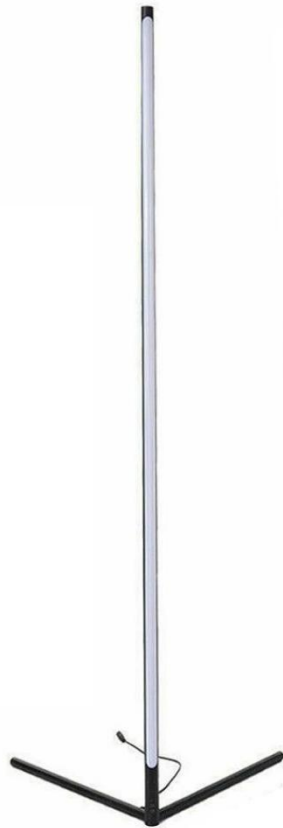

Safety Instructions

Read and follow all the safety instructions:

- The lamp is not waterproof. Avoid exposing it to splashing or dripping water.
- The operating temperature should be within -10° to 40° (14° to 104°F).
- The lamp's internal light source cannot be replaced. If it breaks, you must replace the lamp.
- Do not allow children to install the lamp alone.
- Avoid placing the lamp near heat sources.
- Do not install the lamp with a dimming driver.
- Avoid placing the lamp near potentially dangerous sources (e.g., candles, liquid-filled objects).

INTRODUCTION

Thanks for choosing EP Light's corner lamp. This floor lamp creates a soft, cozy atmosphere in your home with its wide range of choices from warm white, cool white and 16M kinds of colors. You can also select from different scene modes from our remote to achieve a unique addition to your space.

Check the installation video on EP Light's YouTube channel for more details.

[youtube.com/@eplight9334](https://www.youtube.com/@eplight9334)

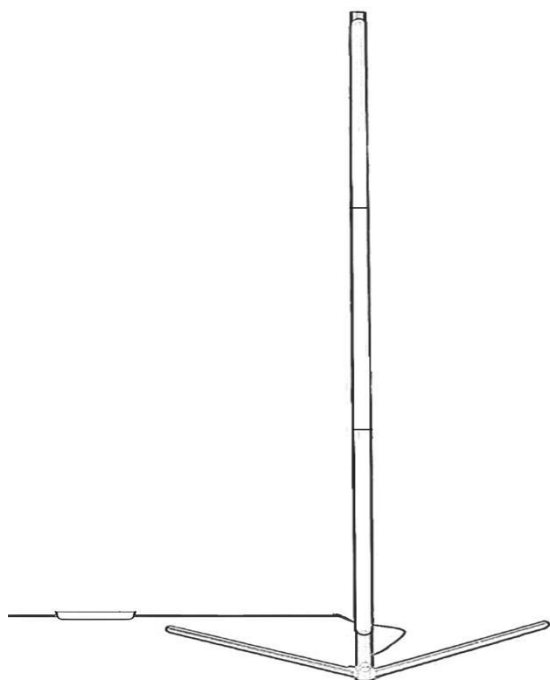

WHAT'S IN THE BOX

Pole B (with Holes)

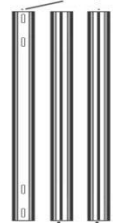

Pole A



Connecting Piece



Base A



Base B

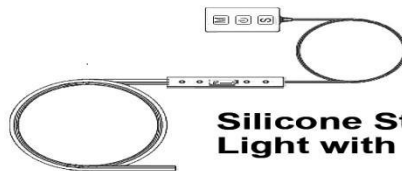

Silicone Strip Light with Power



Cap



Crosshead screws



Screwdriver



Adapter



Set Screws (Hexagonal)



Allen Wrench

Installing Steps

1. Insert a connecting piece with the end showing the holes into the pole B.
2. Connect pole A and Pole B with the connecting piece. Align its metal slots with the holes of the connecting piece. Tighten the screws with the screwdriver till the connecting piece can't move.

Note: Connect pole A to pole B using the smaller end of pole A, as there will be a slight size difference between the two ends. Otherwise, there might be a small gap between the poles.

①

Connecting Piece



Pole B

②



Screw



Pole A

Connecting Piece

Pole B

Connecting Piece

Pole A

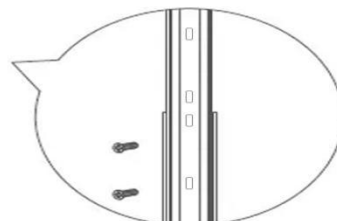

3. Press the silicone strip into the metal pole.

Note: To avoid deforming the silicone light strip, please press from the top and bottom first, and then press the middle. Caution: Do not cut the strip.

4. Connect the black tube attached to the silicone strip to the metal pole.

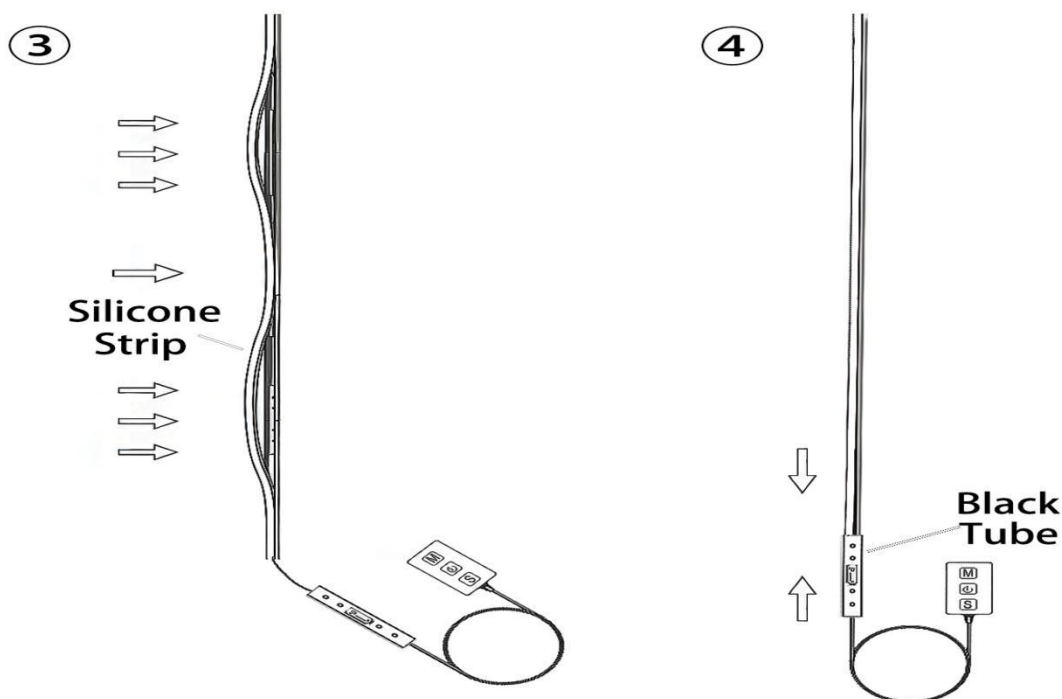

5. Install the base by connecting base B to base A, and then use an Allen wrench to tighten the set screws.

Note: There are no screw holes on the base B. Just tighten the set screws to the maximum.

6. Connect the assembled part to the base. **Note: You can change the direction of the lamp, whether facing the wall or not, by rotating the black tube below.**

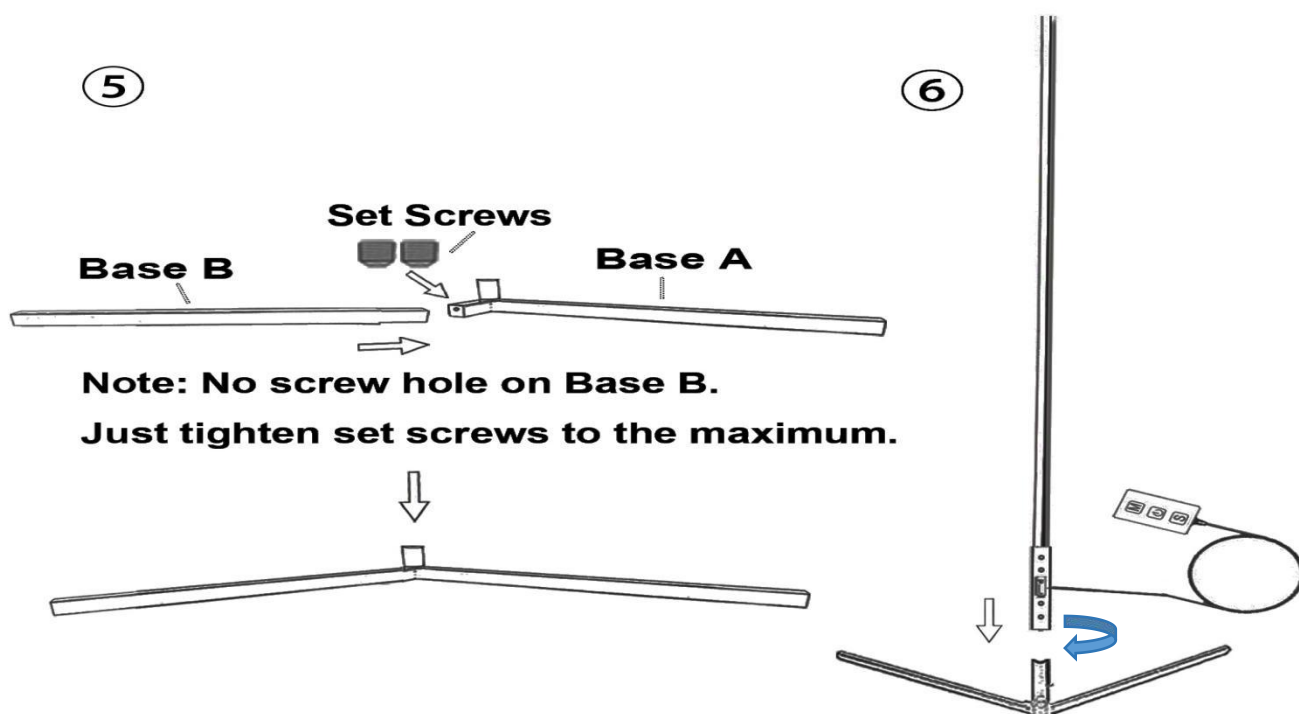

7. Tighten the securing screw at the connection point between the base and the lamp body. Place the cap on top of the lamp.

8. Connect the adapter to the cable of the lamp and plug the adapter into a power outlet.

