

Model: **K2-S18SQ**

**Cubic 18"** Fireclay Farmhouse Sink

## SPEC SHEET

### Features

- Handcrafted from fine fireclay
- Non-porous glossy surface
- Fired at above 2200 °F for 24 hours
- Resists chips, stains, cracks and scratches
- 3-1/2" Drain opening
- Bottom Grid and drain basket included
- Recommended minimum cabinet size: 21"
- UPC/cUPC compliant
- Limited lifetime warranty

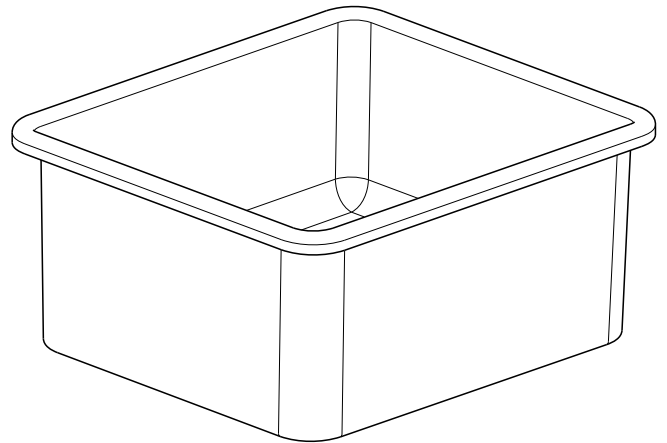

Fired at above 2200 °F



Prevents Condensation



Heat Resistant



Stain Resistant



Fade Resistant

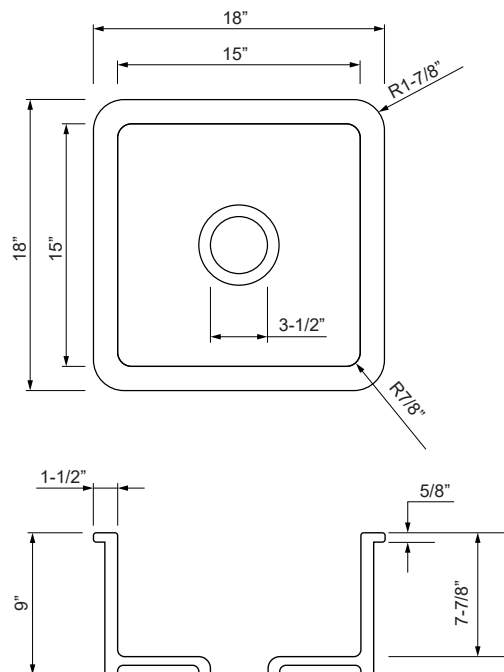

Model: **K2-S19RO**

**Crater 19"** Fireclay Farmhouse Sink

## SPEC SHEET

### Features

- Handcrafted from fine fireclay
- Non-porous glossy surface
- Fired at above 2200 °F for 24 hours
- Resists chips, stains, cracks and scratches
- 3-1/2" Drain opening
- Bottom Grid and drain basket included
- Recommended minimum cabinet size: 21"
- UPC/cUPC compliant
- Limited lifetime warranty

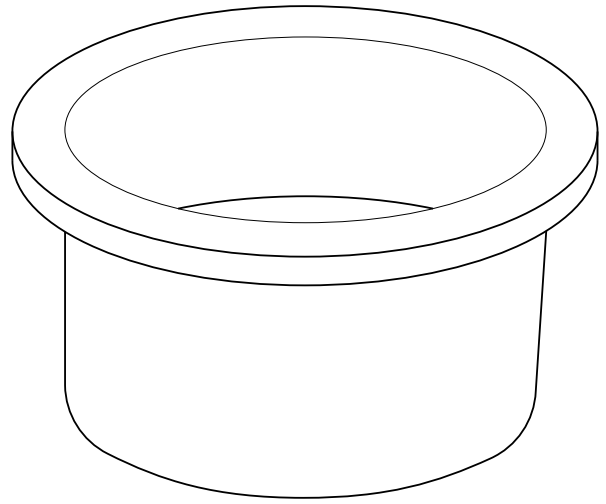

Fired at above 2200 °F



Prevents Condensation



Heat Resistant



Stain Resistant



Fade Resistant

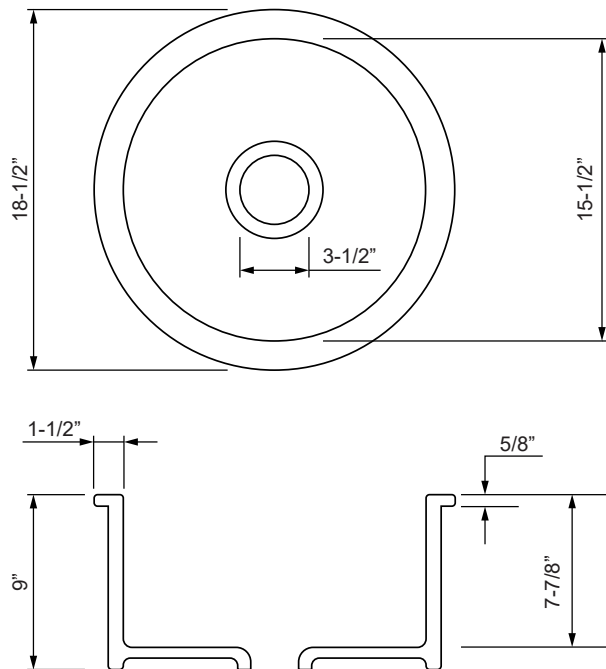

Model: **K2-SF24**

**Pure 24"** Fireclay Farmhouse Sink

## SPEC SHEET

### Features

- Handcrafted from fine fireclay
- Non-porous glossy surface
- Fired at above 2200 °F for 24 hours
- Resists chips, stains, cracks and scratches
- Apron-front visible or concealed apron
- 3-3/4" Drain opening
- Bottom Grid and drain basket included
- Recommended minimum cabinet size: 24"
- UPC/cUPC compliant
- Limited lifetime warranty

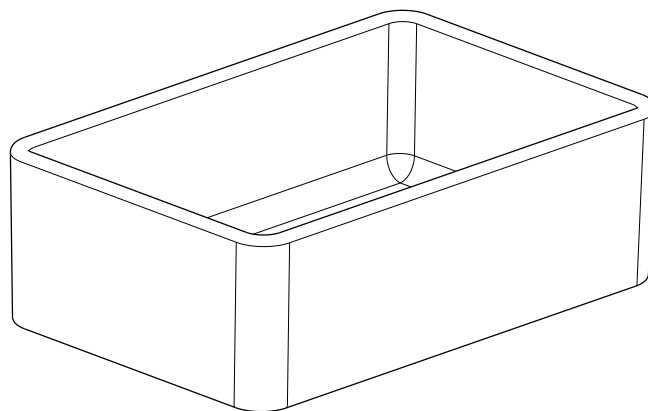

Fired at above 2200 °F



Prevents Condensation



Heat Resistant



Stain Resistant



Fade Resistant

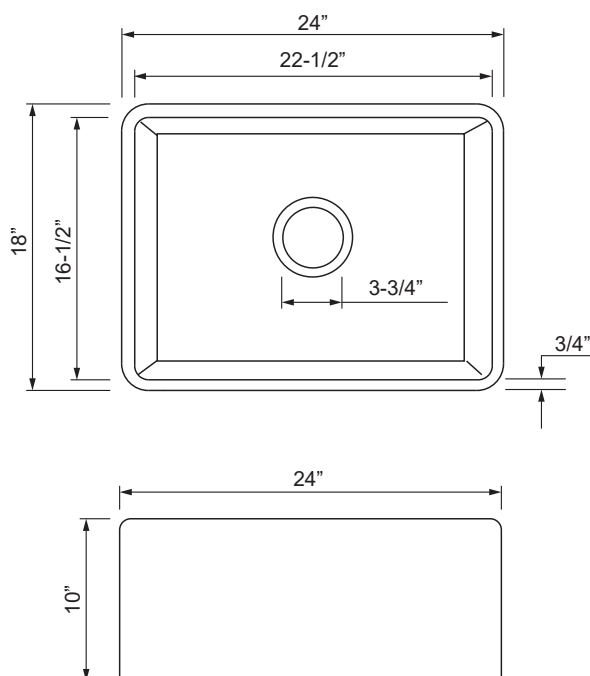

Model: **K2-S27**

**Landis 27" Fireclay Farmhouse Sink**

## SPEC SHEET

### Features

- Handcrafted from fine fireclay
- Non-porous glossy surface
- Fired at above 2200 °F for 24 hours
- Resists chips, stains, cracks and scratches
- 3-1/2" Drain opening
- Bottom Grid and drain basket included
- Recommended minimum cabinet size: 30"
- UPC/cUPC compliant
- Limited lifetime warranty

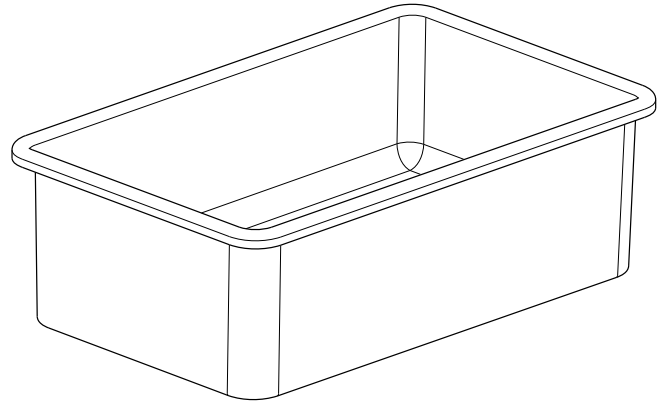

Fired at above 2200 °F



Prevents Condensation



Heat Resistant



Stain Resistant



Fade Resistant

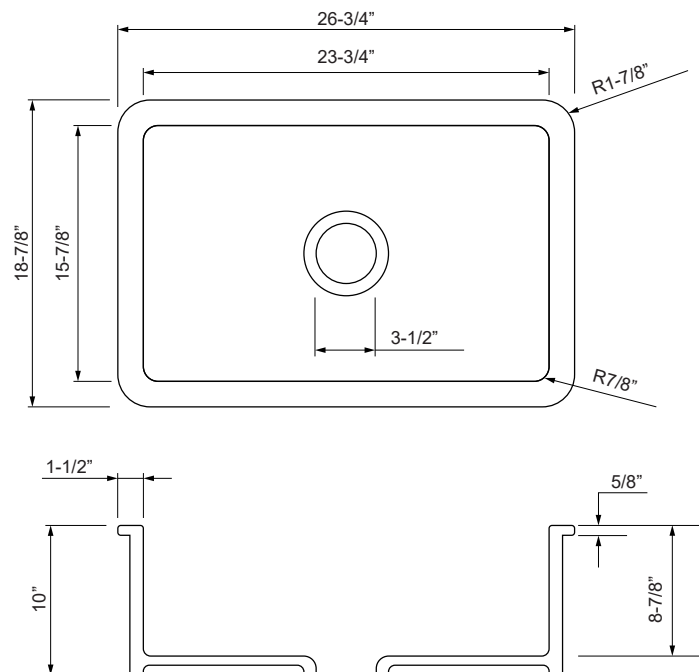

Model: **K2-SF30**

**Pure 30"** Fireclay Farmhouse Sink

## SPEC SHEET

### Features

- Handcrafted from fine fireclay
- Non-porous glossy surface
- Fired at above 2200 °F for 24 hours
- Resists chips, stains, cracks and scratches
- Apron-front visible or concealed apron
- 3-3/4" Drain opening
- Bottom Grid and drain basket included
- Recommended minimum cabinet size: 30"
- UPC/cUPC compliant
- Limited lifetime warranty

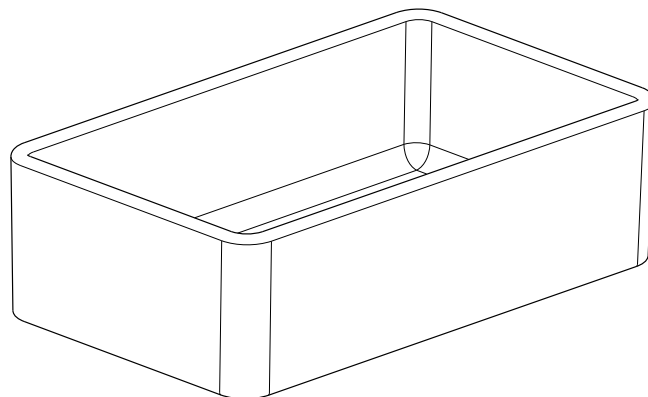

Fired at above 2200 °F



Prevents Condensation



Heat Resistant



Stain Resistant



Fade Resistant

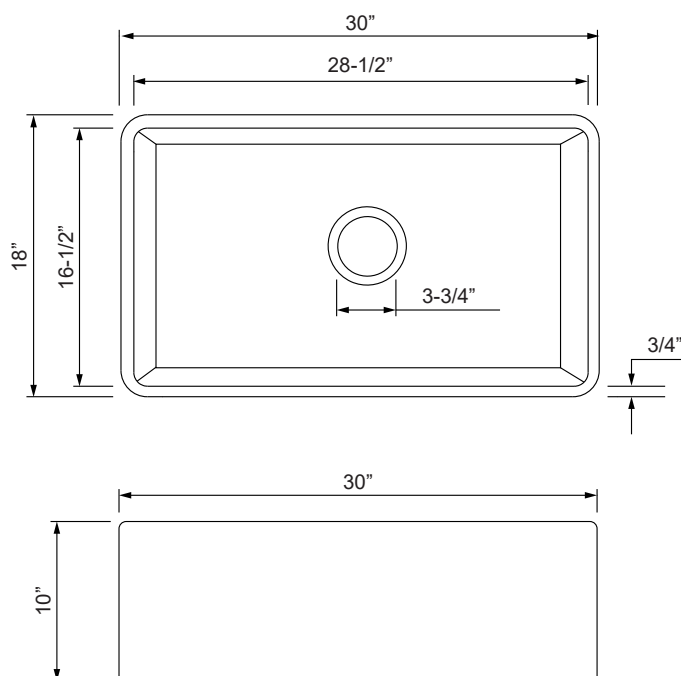

Model: **K2-SF30AR**

Arch 30" Fireclay Farmhouse Sink

## SPEC SHEET

### Features

- Handcrafted from fine fireclay
- Non-porous glossy surface
- Fired at above 2200 °F for 24 hours
- Resists chips, stains, cracks and scratches
- Apron-front visible or concealed apron
- Reversible Traditional and Contemporary Designs
- 3-3/4" Drain opening
- Bottom Grid and drain basket included
- Recommended minimum cabinet size: 30"
- UPC/cUPC compliant
- Limited lifetime warranty

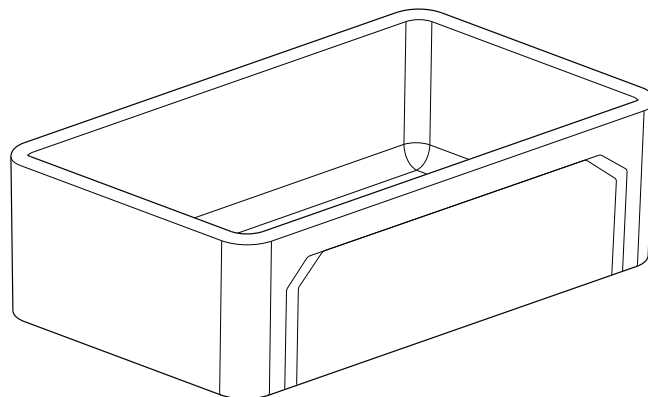

Fired at above 2200 °F



Prevents Condensation



Heat Resistant



Stain Resistant



Fade Resistant

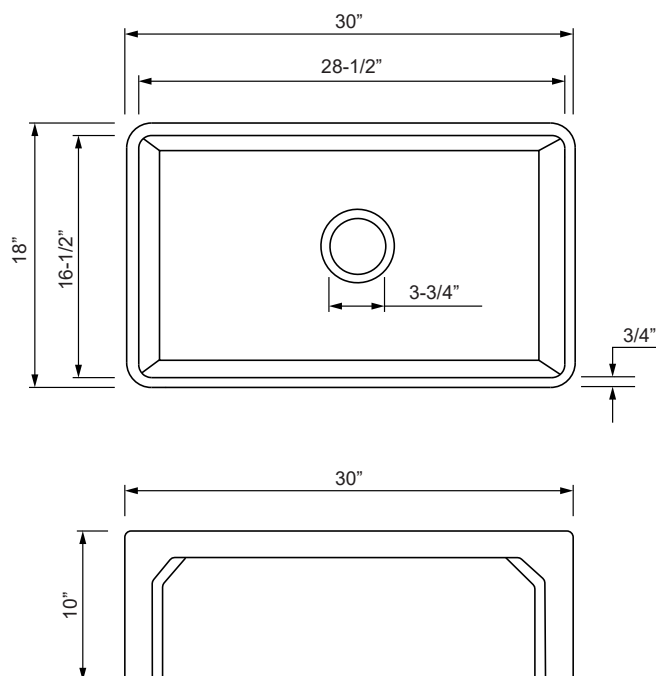

Model: **K2-SF33**

**Pure 3"** Fireclay Farmhouse Sink

## SPEC SHEET

### Features

- Handcrafted from fine fireclay
- Non-porous glossy surface
- Fired at above 2200 °F for 24 hours
- Resists chips, stains, cracks and scratches
- Apron-front visible or concealed apron
- 3-3/4" Drain opening
- Bottom Grid and drain basket included
- Recommended minimum cabinet size: 33"
- UPC/cUPC compliant
- Limited lifetime warranty

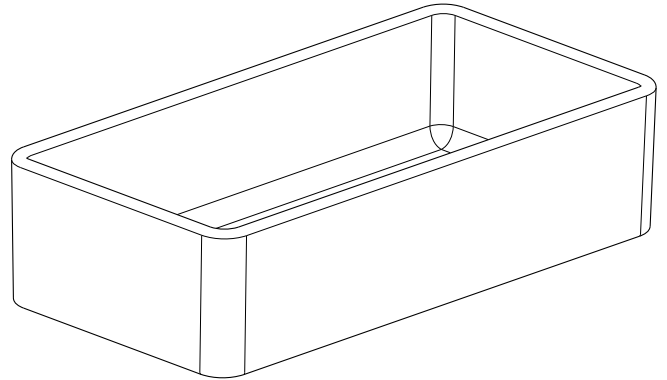

Fired at above 2200 °F



Prevents Condensation



Heat Resistant



Stain Resistant



Fade Resistant

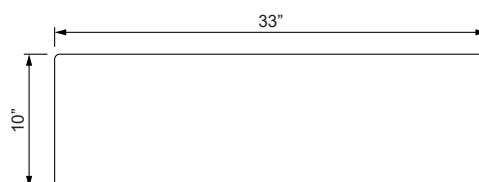
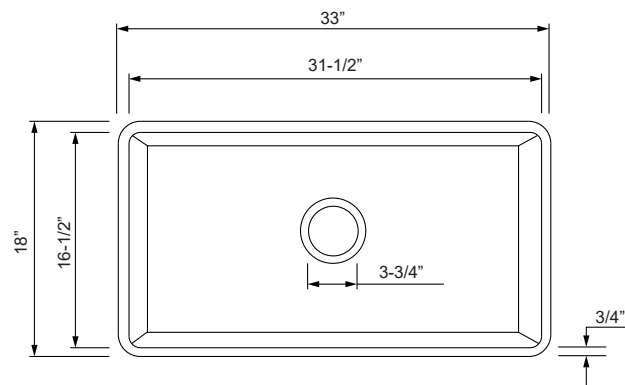

Model: **K2-SF33PI**

**Pillar 33"** Fireclay Farmhouse Sink

## SPEC SHEET

### Features

- Handcrafted from fine fireclay
- Non-porous glossy surface
- Fired at above 2200 °F for 24 hours
- Resists chips, stains, cracks and scratches
- Apron-front visible or concealed apron
- Reversible Traditional and Contemporary Designs
- 3-3/4" Drain opening
- Bottom Grid and drain basket included
- Recommended minimum cabinet size: 33"
- UPC/cUPC compliant
- Limited lifetime warranty

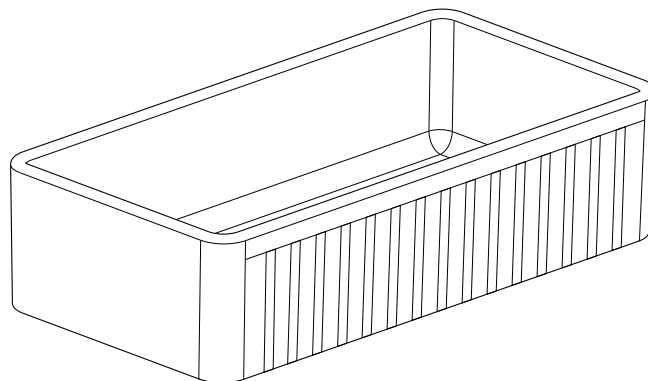

Fired at above 2200 °F



Prevents Condensation



Heat Resistant



Stain Resistant



Fade Resistant

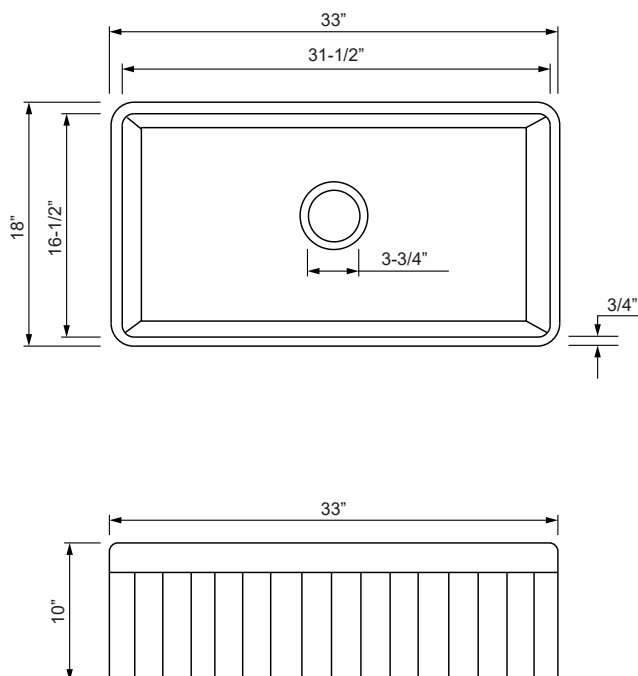



Model: **K2-DF33PI**

**Pillar 33"** Fireclay Farmhouse Sink

## SPEC SHEET

### Features

- Handcrafted from fine fireclay
- Non-porous glossy surface
- Fired at above 2200 °F for 24 hours
- Resists chips, stains, cracks and scratches
- Apron-front visible or concealed apron
- Reversible Traditional and Contemporary Designs
- 3-3/4" Drain opening
- Bottom Grid and drain basket included
- Recommended minimum cabinet size: 33"
- UPC/cUPC compliant
- Limited lifetime warranty

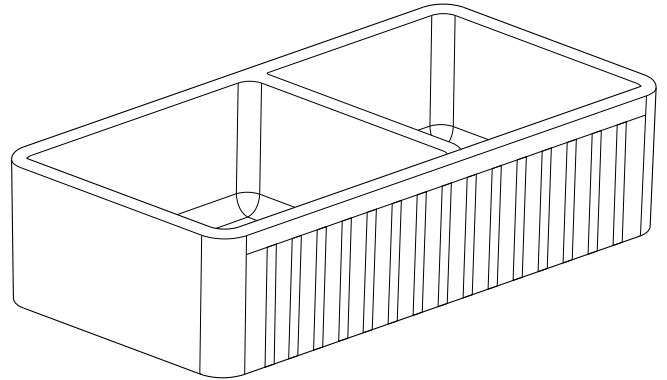

Fired at above 2200 °F



Prevents Condensation



Heat Resistant



Stain Resistant



Fade Resistant

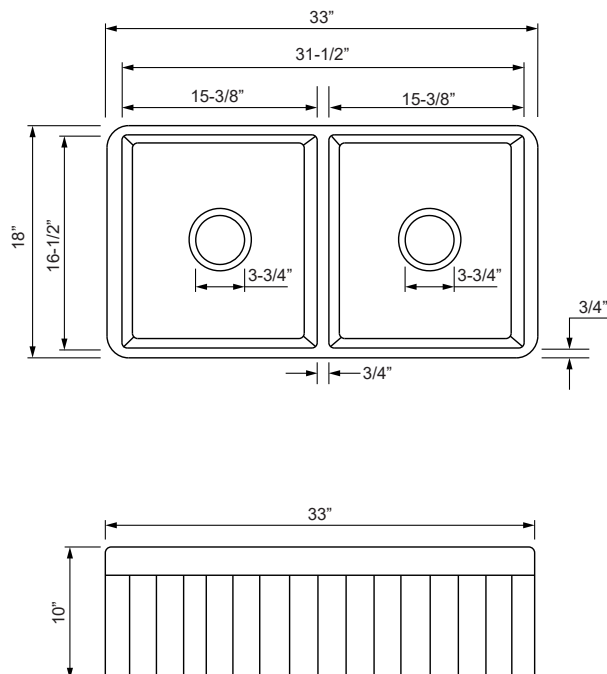

Model: **K2-SF36**

**Pure 36"** Fireclay Farmhouse Sink

## SPEC SHEET

### Features

- Handcrafted from fine fireclay
- Non-porous glossy surface
- Fired at above 2200 °F for 24 hours
- Resists chips, stains, cracks and scratches
- Apron-front visible or concealed apron
- 3-3/4" Drain opening
- Bottom Grid and drain basket included
- Recommended minimum cabinet size: 36"
- UPC/cUPC compliant
- Limited lifetime warranty

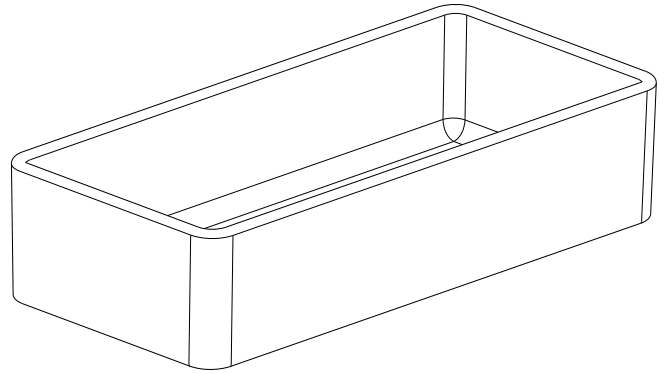

Fired at above 2200 °F



Prevents Condensation



Heat Resistant



Stain Resistant



Fade Resistant

