

ASSEMBLY INSTRUCTIONS

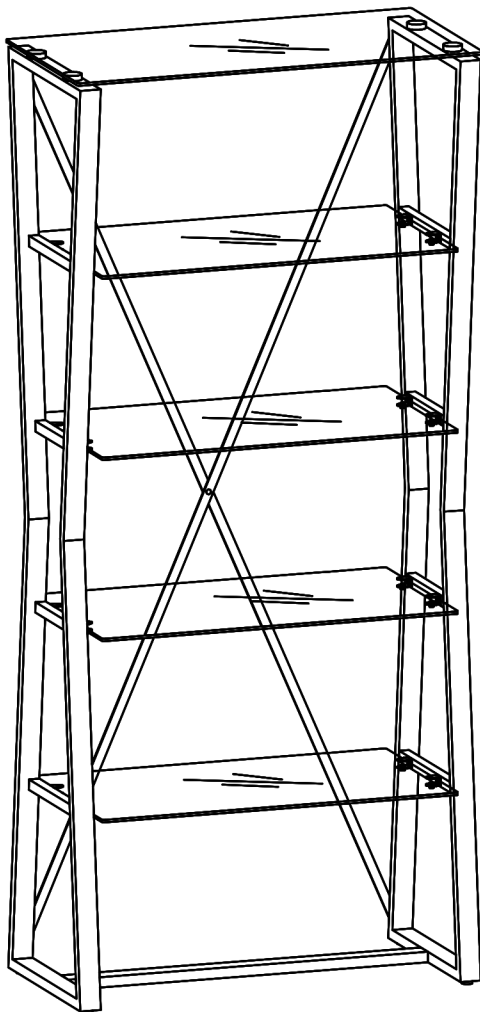

TOOLS REQUIRED



Allen Wrench

(Included)



Wrench

(Included)



2 - People
Recommended

ASSEMBLY RATING



EASY —————> DIFFICULT

The Assembly Rating is a 5-point system showing the level of effort needed to assemble a specific product.



CHECK BEFORE STARTING

☐

Are you missing anything?

Double-check all parts, hardware and accessories listed on Page 6 are accounted for.

☐

Check out our Quick Tips!

We recommend reviewing the pre-assembly handouts. Even experts need a refresher now and then!

☐

Should we send any replacements?

Are there any irregularities or flaws in the parts? We can send replacements!

☐

Prep Time!

Please review the assembly instructions and all diagrams prior to assembling. Arrange parts as recommended on Page 7 and group identical hardware together to make assembling easier.

PRE ASSEMBLY INTRODUCTION

We understand building ready-to-assemble furniture can be a challenging experience for some. To help avoid confusion, we have provided some helpful tips that may speed up the process.

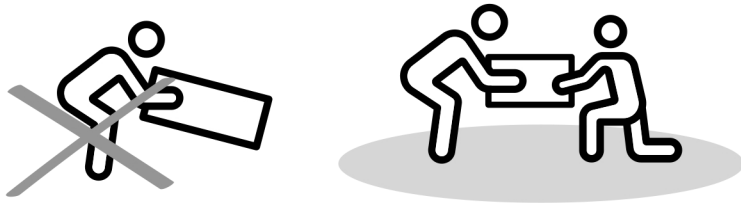

Teamwork

ALWAYS have at least two people to help with transporting and assembling the product to avoid potential injury and/or damage.

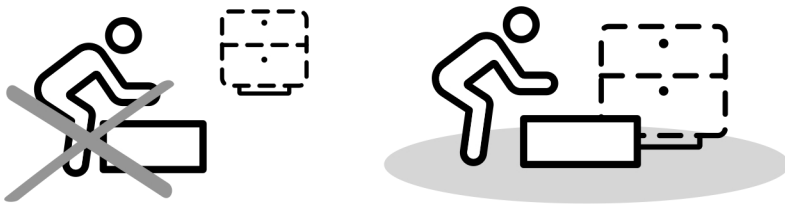

Suitable Location

Assembling near the area of the intended location is highly recommended.



Sufficient Space

Make sure you have enough space to move around during the assembly.

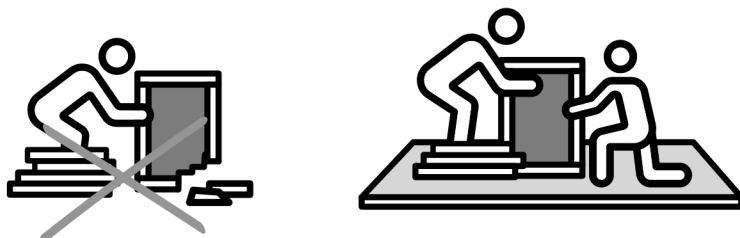

Avoid Scratches

Use cardboard, blankets or a carpeted area while assembling furniture to prevent scratches.

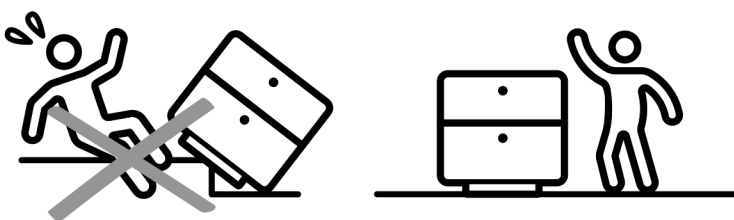

Flat Surface

Make sure the furniture rests on a flat and level surface with each leg evenly touching the floor.

ASSEMBLY AND CARE ADVICE



**FAILURE TO FOLLOW THE GUIDELINES BELOW MAY
RESULT IN INJURY AND/OR PROPERTY DAMAGE.**



Position each part correctly
and insert screws or bolts into
their respective holes.

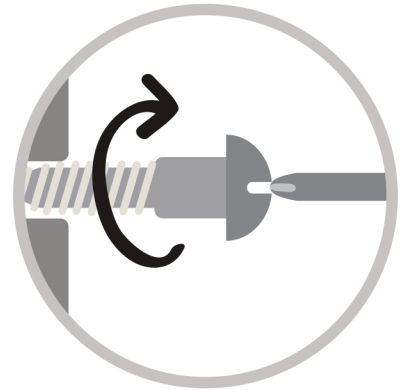

Turn clockwise to tighten and
only tighten when step is
completed or when instructed
to do so.



Save the instructions and store
any supplied tools for later
maintenance.

Use the appropriate hand tools
or power tools for assembly.
Select steps, such as tightening
screws and/or bolts, may require
hand tools to avoid causing
damage during assembly.

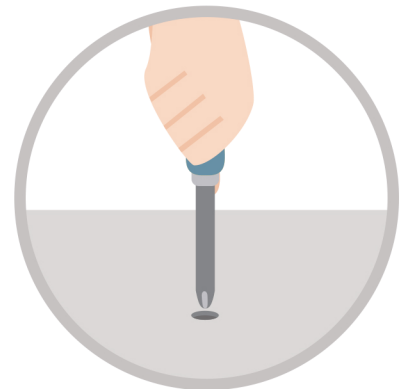

After two weeks, check and
tighten any loose hardware and
repeat again every six months
thereafter.

IT IS THE USER'S RESPONSIBILITY TO MAINTAIN THE FURNITURE. THE HARDWARE MAY LOOSEN OVER TIME AND MAY CAUSE THE FURNITURE TO BE WOBBLY AND UNABLE TO SUPPORT ITS INTENDED WEIGHT CAPACITY. THIS MAY LEAD TO COLLAPSE AND MAY CAUSE SERIOUS INJURY.

BOOKCASE



- Please keep instructions for future reference.
- Check the quantity and irregularity of parts and hardware before you start.

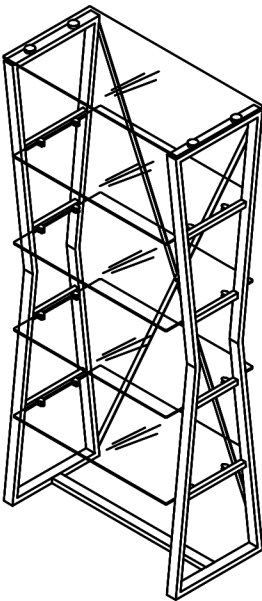

PARTS

#1 1pc

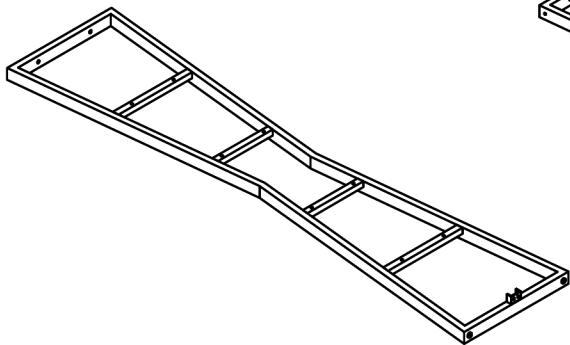

Left Frame

#2 1pc

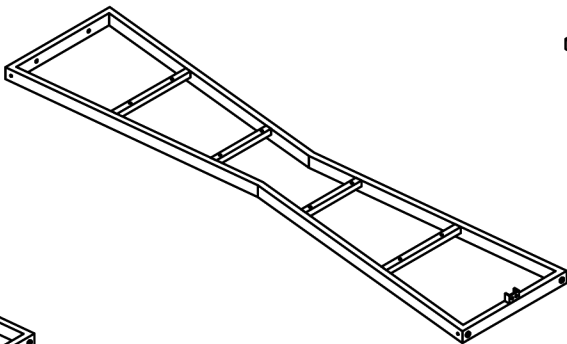

Right Frame

#3 1pc

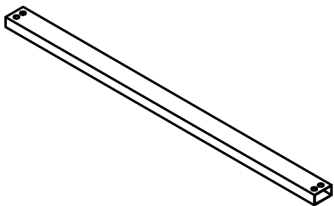

L: 710mm

Cross Frame

#4 2pcs

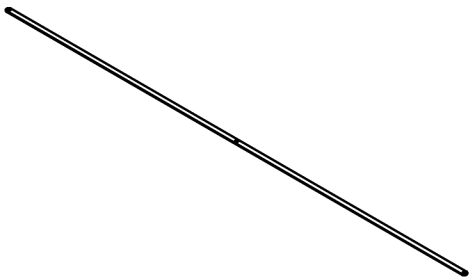

Cross Sheet

#5 1pc

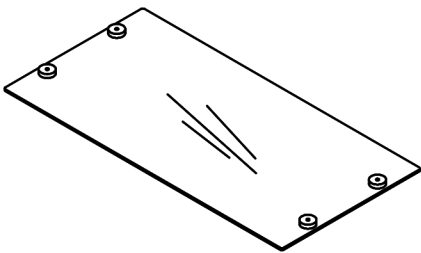

Top Glass

#6 4pcs

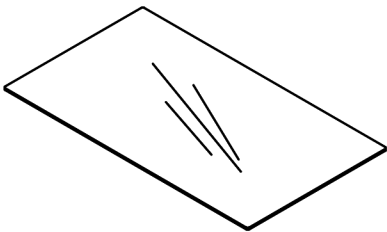

Glass

HARDWARE

#A 9pcs

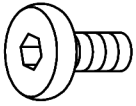

Bolt 1/4" * 12mm

#B 4pcs

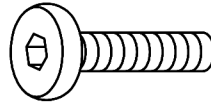

Bolt 1/4" * 28mm

#C 16pcs

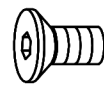

Bolt 1/4" * 12mm

#D 4pcs



Flat Washer

#E 1pc

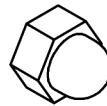

Acorn Nut

#F 4pcs

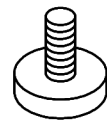

Leveler

#G 16pcs

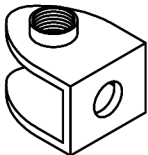

Glass Clamp

#H 16pcs



Set Screw

#I 2pcs

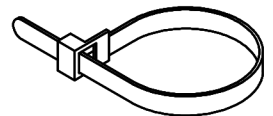

Safety Strap

#J 2pcs

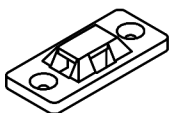

Plastic Bracket

#K 4pcs



Anchor

#L 4pcs

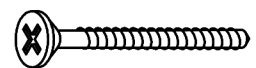

Screw

#M 1pc



Allen Wrench

#N 1pc



Wrench

ASSEMBLY INSTRUCTIONS

1

Part #1 x1pc
Part #2 x1pc
Part #3 x1pc
Hardware #A x4pcs

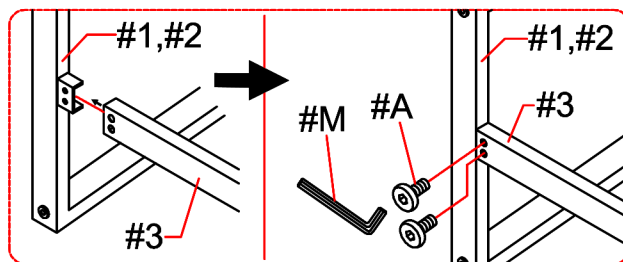

Align cross frame (#3) to left and right frames (#1,2), then secure by using bolts (#A).

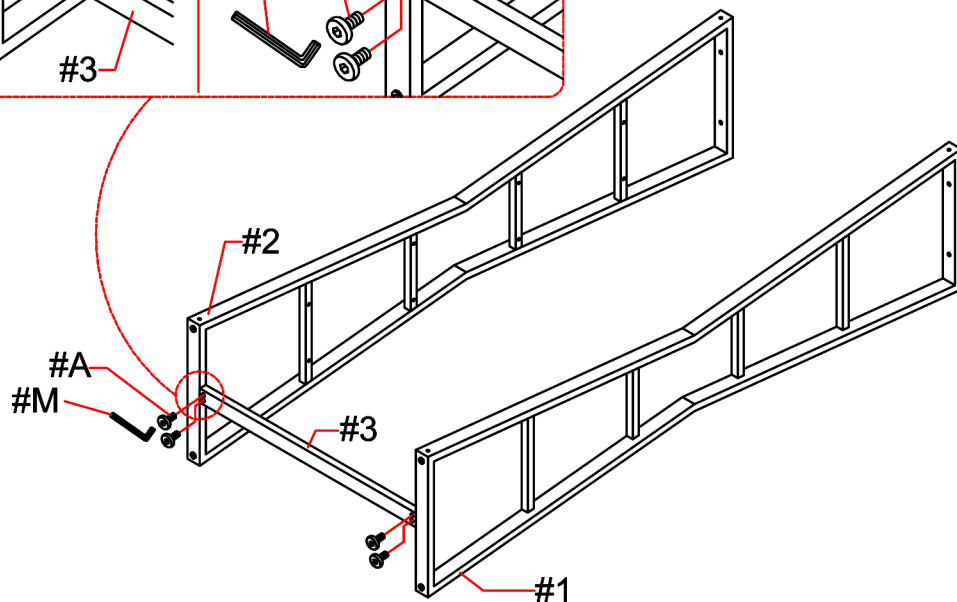

2

Part #5 x1pc
Hardware #B x4pcs
Hardware #D x4pcs

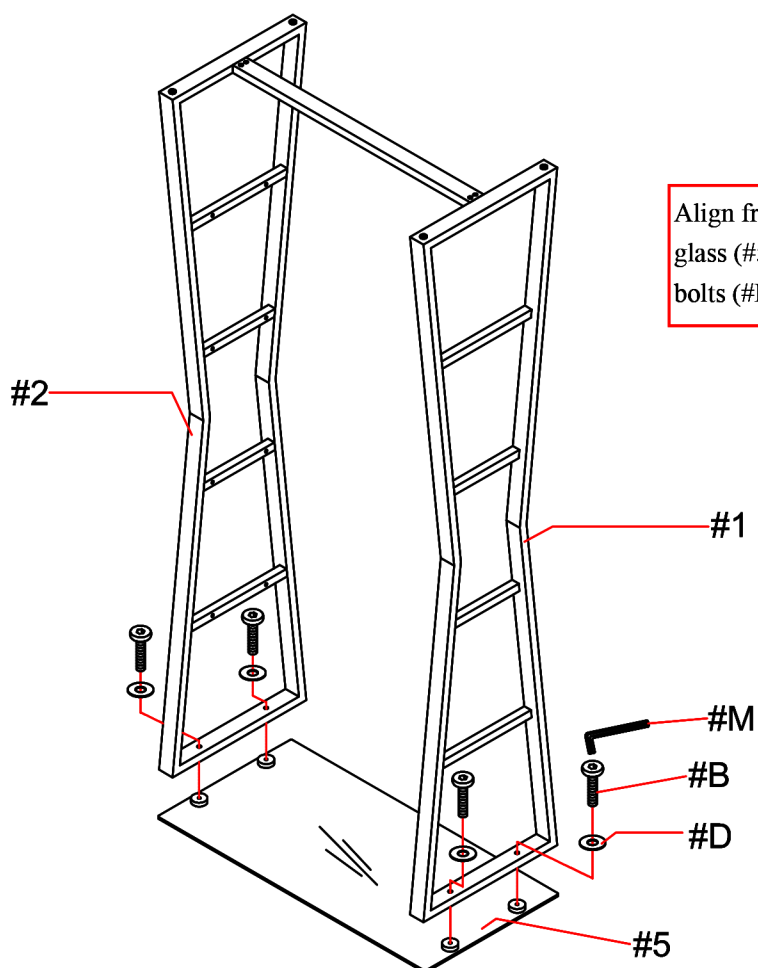

Align frames (#1,2) to the top glass (#5), then secure by using bolts (#B) with washers (#D).

ASSEMBLY INSTRUCTIONS

3

Part **#4** x2pcs
Hardware **#A** x5pcs
Hardware **#E** x1pc

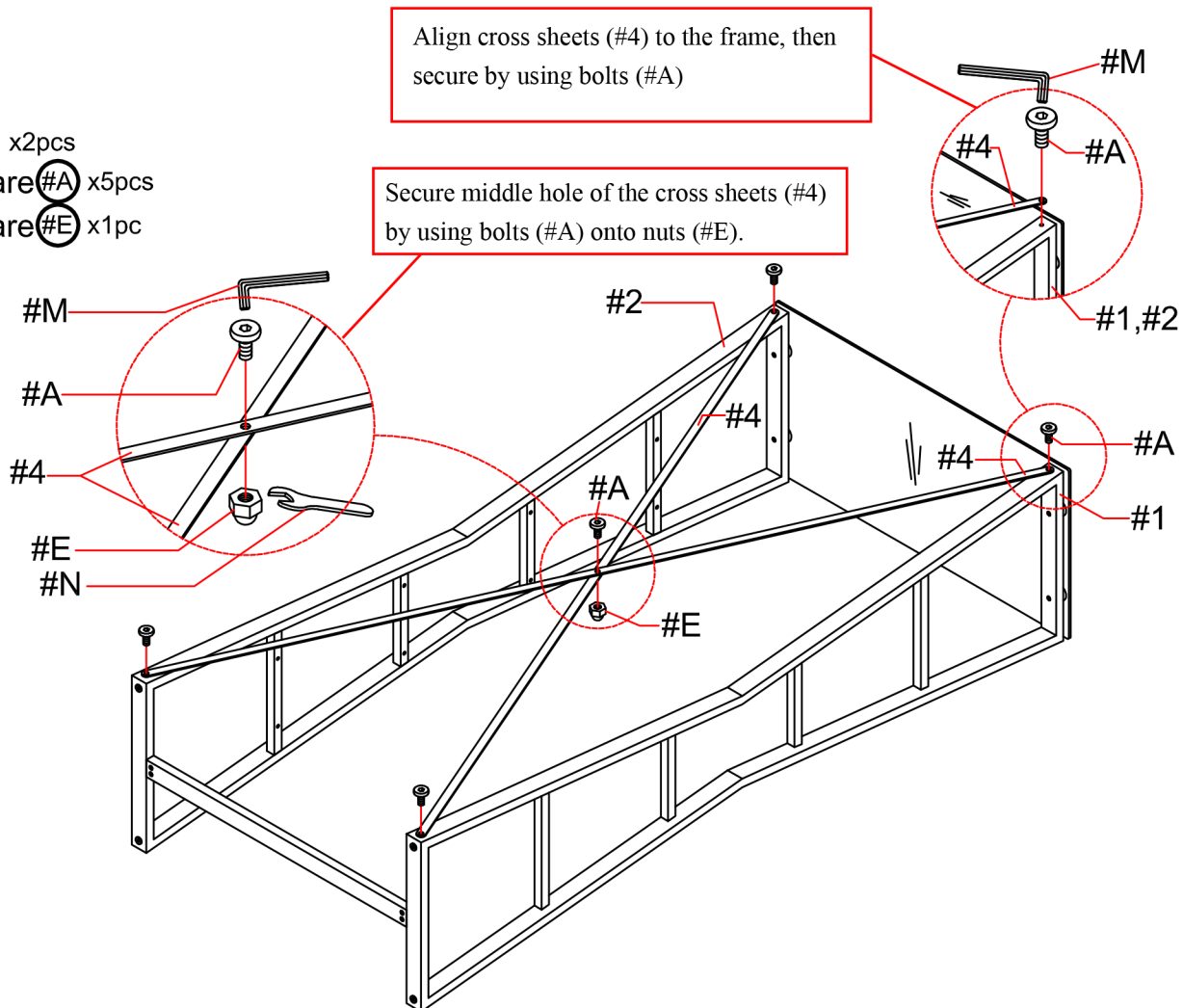

4

Hardware **#F** x4pcs

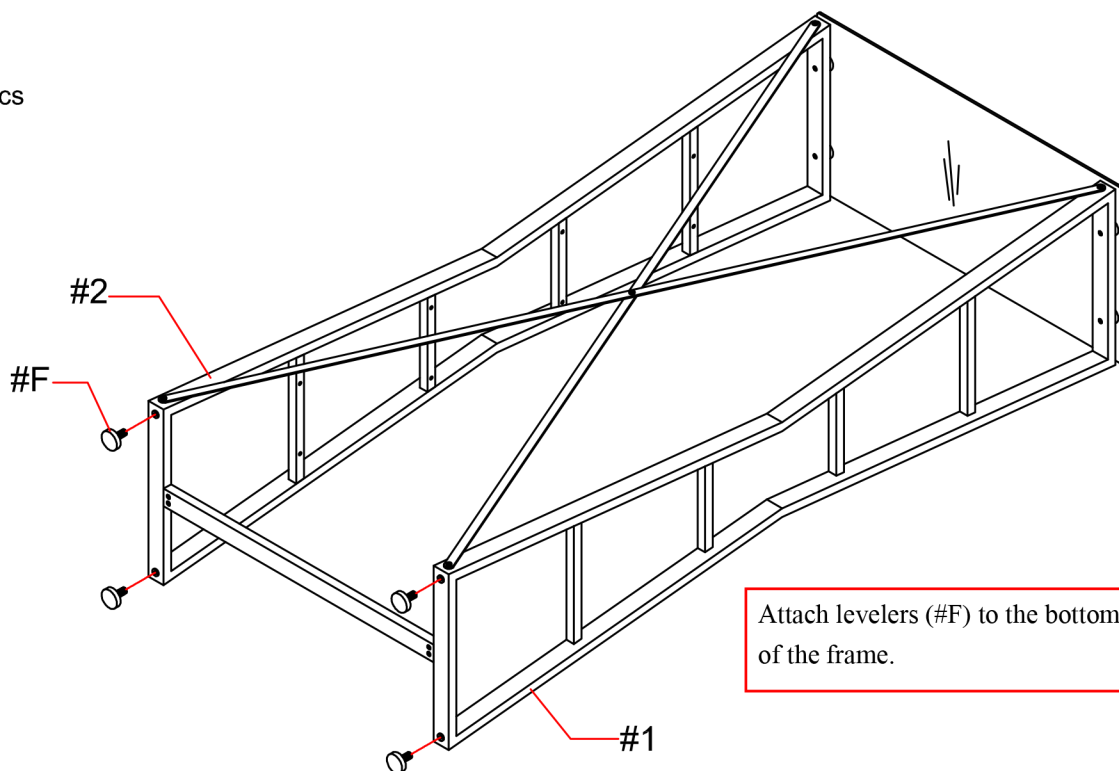

ASSEMBLY INSTRUCTIONS

5

Hardware **#C** x16pcs

Hardware **#G** x16pcs

Secure glass clamps (**#G**) to the frames by using bolts (**#C**).

#1,#2

#G

#C

#M

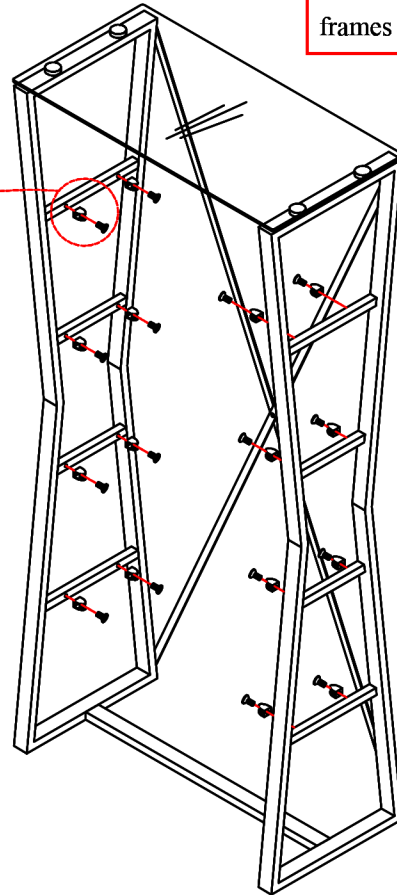

6

Part **#6** x4pcs

Hardware **#H** x16pcs

#6

#6

#6

#6

#1,#2

(B)

(A)

#6

**Align the glass(#6) on the center of the frame (#1,#2). (distance (A) = distance (B))

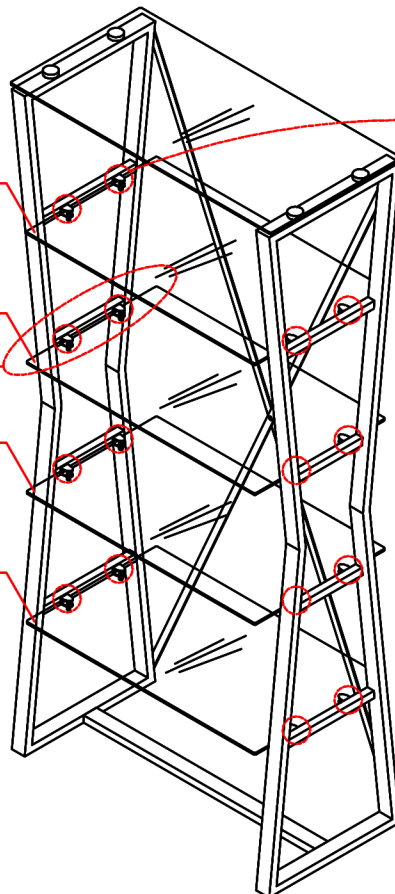

**Carefully put glass (#6) into the gap of the clamp (#G), avoid any impact between the glass and the clamp.

#1,#2

#G

#H

#M



#6

#6

#H

#M



ASSEMBLY INSTRUCTIONS

7

Hardware #I x2pcs

Hardware #J x2pcs

Hardware #K x4pcs

Hardware #L x4pcs

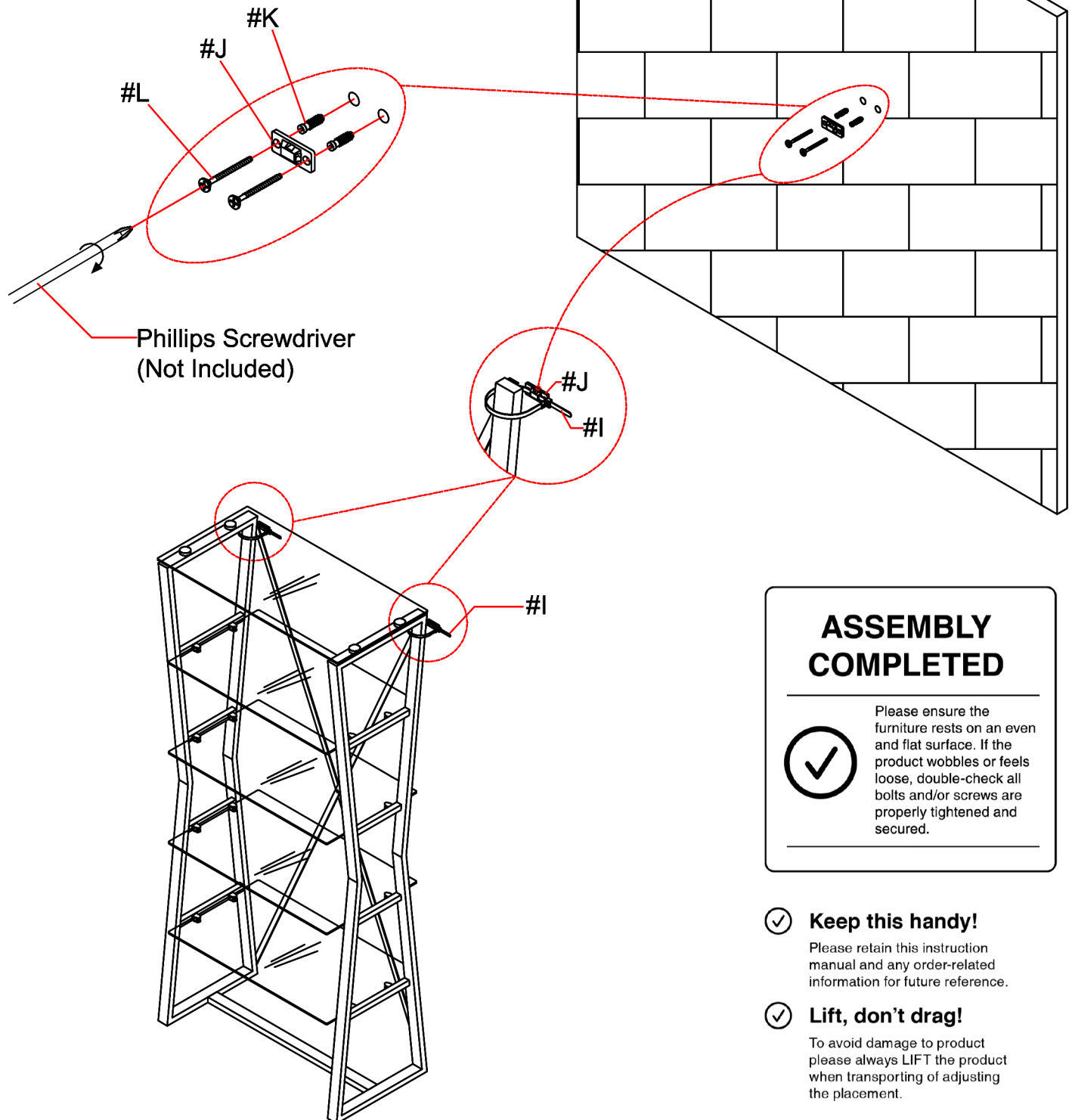

ASSEMBLY INSTRUCTIONS

Wall Mounting and Fixing

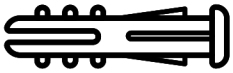

EXPANSION WALL ANCHOR

Our provided expansion wall anchors are only suitable for masonry walls, such as drywall, plaster or concrete, and are best for holding lightweight items or for anti-tip prevention. If you are unsure of the correct wall anchor to use with the product, please request professional guidance. Liability for product damage or failure due to using the incorrect anchors will fall on the installer.

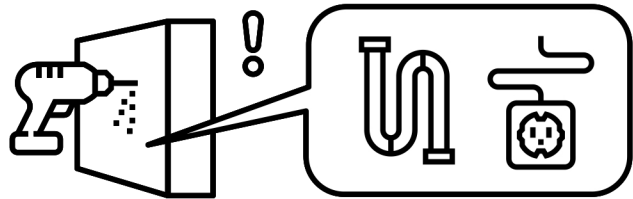

CHECK BEFORE PROCEEDING

Prior to drilling or hammering, please check for wires or pipes. We recommend using a stud finder to locate a stud, which will offer more appropriate resistance and hold more weight.

QUICK TIPS

1. If unsure of the proper size, always choose a larger screw and wall anchor.

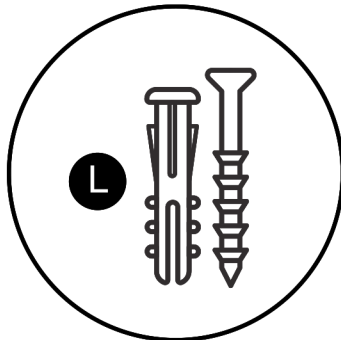

2. Match the drill bit to the wall anchor and hole size.

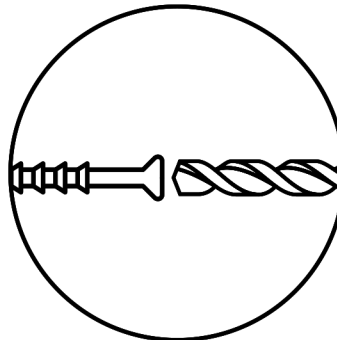

3. Only drill horizontally. Do not force the drill or enlarge the hole for the wall anchor.

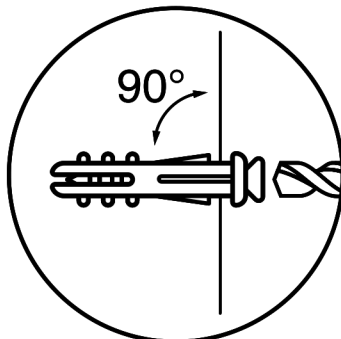

4. Take extra care when drilling into high walls or ceramic tiles. Wall anchors should be a tight fit for the hole. Never use wall anchors in ceilings.

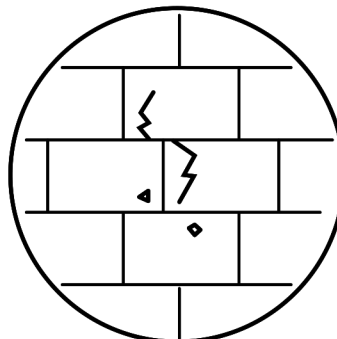

MAINTENANCE

Yearly
Check

We recommend a yearly check to see if the wall anchor or screw has loosened. If so, please remove the existing wall anchor and screw, and use a new anchor.