

ASSEMBLY INSTRUCTIONS

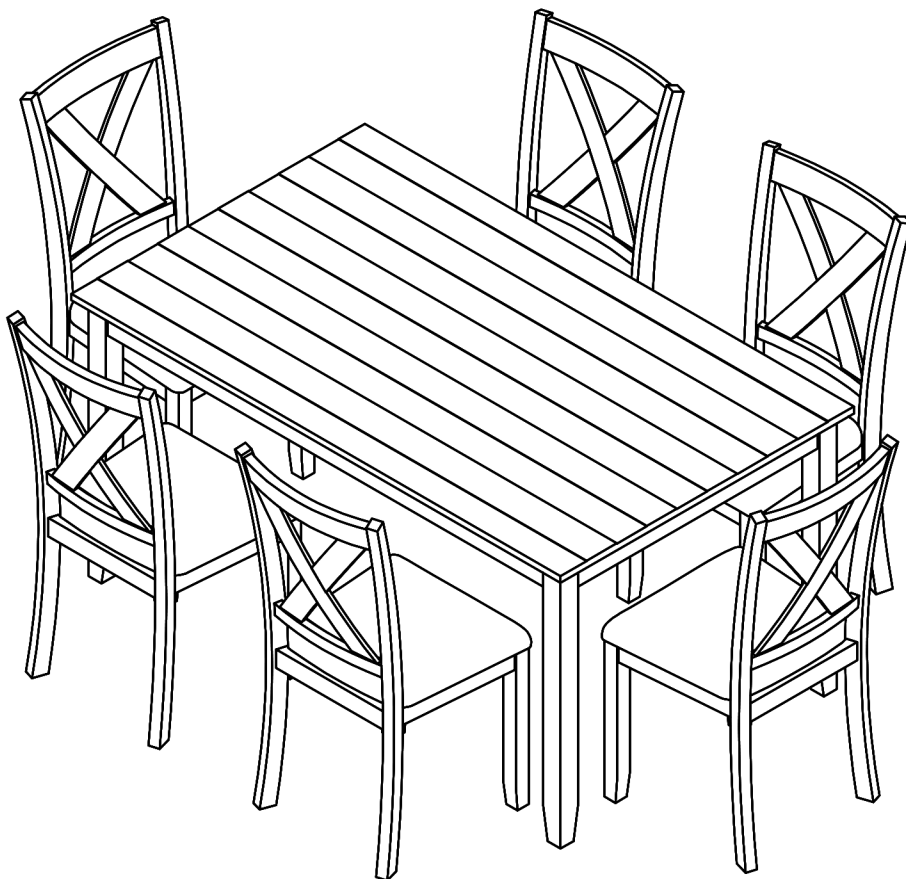

TOOLS REQUIRED



Allen Wrench

(Included)



Phillips
Screwdriver

(Not Included)

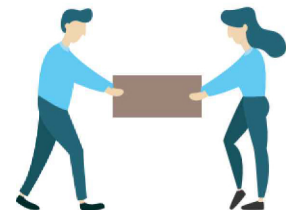

2 - People
Recommended

ASSEMBLY RATING



EASY —————> DIFFICULT

The Assembly Rating is a 5-point system showing the level of effort needed to assemble a specific product.



CHECK BEFORE STARTING

☐

Are you missing anything?

Double-check all parts, hardware and accessories listed on Page 6 are accounted for.

☐

Check out our Quick Tips!

We recommend reviewing the pre-assembly handouts. Even experts need a refresher now and then!

☐

Should we send any replacements?

Are there any irregularities or flaws in the parts? We can send replacements!

☐

Prep Time!

Please review the assembly instructions and all diagrams prior to assembling. Arrange parts as recommended on Page 7 and group identical hardware together to make assembling easier.

PRE ASSEMBLY INTRODUCTION

We understand building ready-to-assemble furniture can be a challenging experience for some. To help avoid confusion, we have provided some helpful tips that may speed up the process.

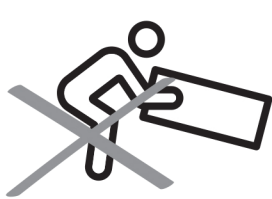

Teamwork

ALWAYS have at least two people to help with transporting and assembling the product to avoid potential injury and/or damage.

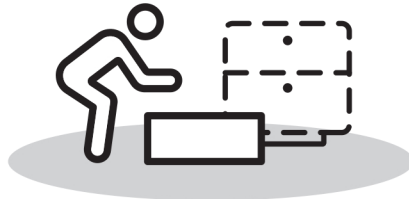

Suitable Location

Assembling near the area of the intended location is highly recommended.



Sufficient Space

Make sure you have enough space to move around during the assembly.



Avoid Scratches

Use cardboard, blankets or a carpeted area while assembling furniture to prevent scratches.

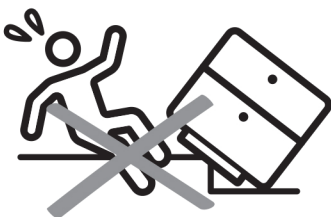

Flat Surface

Make sure the furniture rests on a flat and level surface with each leg evenly touching the floor.

ASSEMBLY AND CARE ADVICE



**FAILURE TO FOLLOW THE GUIDELINES BELOW MAY
RESULT IN INJURY AND/OR PROPERTY DAMAGE.**



Position each part correctly
and insert screws or bolts into
their respective holes.

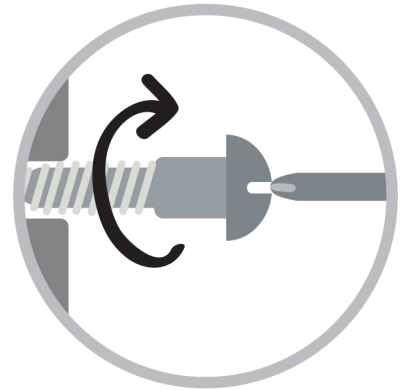

Turn clockwise to tighten and
only tighten when step is
completed or when instructed
to do so.



Save the instructions and store
any supplied tools for later
maintenance.

Use the appropriate hand tools
or power tools for assembly.
Select steps, such as tightening
screws and/or bolts, may require
hand tools to avoid causing
damage during assembly.

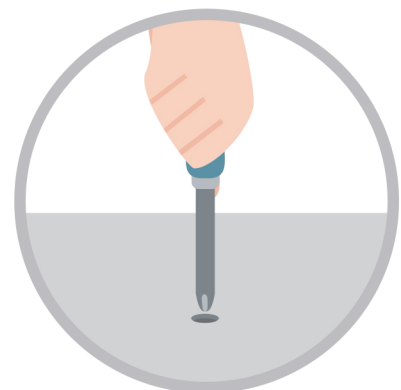

After two weeks, check and
tighten any loose hardware and
repeat again every six months
thereafter.

IT IS THE USER'S RESPONSIBILITY TO MAINTAIN THE FURNITURE. THE HARDWARE MAY LOOSEN OVER TIME AND MAY CAUSE THE FURNITURE TO BE WOBBLY AND UNABLE TO SUPPORT ITS INTENDED WEIGHT CAPACITY. THIS MAY LEAD TO COLLAPSE AND MAY CAUSE SERIOUS INJURY.

TABLE SET



- Please keep instructions for future reference.
- Check the quantity and irregularity of parts and hardware before you start.

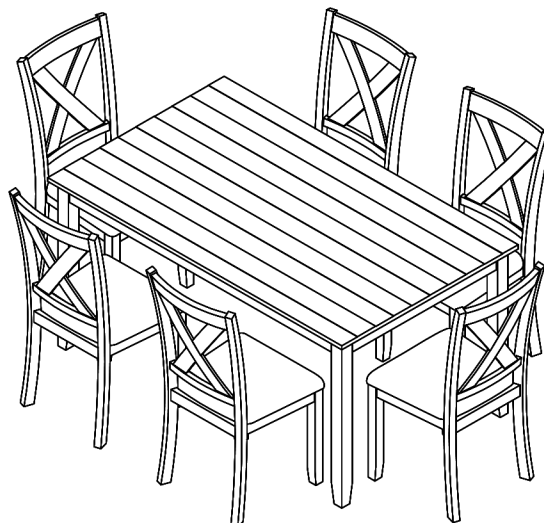

PARTS

#1 1pc

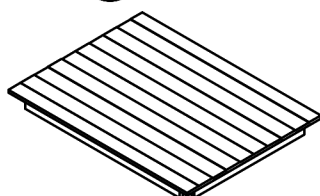

Table Top

#2 4pcs

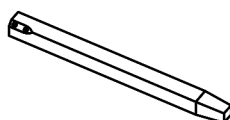
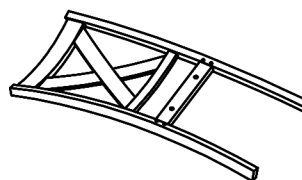

Table Leg

#3 6pcs



Chair Back

#4 6pcs

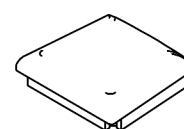

Seat

#5 12pcs

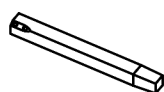

Front Leg

HARDWARE

#A 8pcs



Bolt Ø5/16"x 2-3/8"

#B 8pcs



Lock Washer Ø5/16" x 12mm

#C 8pcs

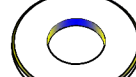

Flat Washer Ø5/16" x 19mm

#D 24pcs



Bolt Ø1/4"x 3"

#E 12pcs



Bolt Ø1/4"x 1-1/2"

#F 24pcs



Bolt Ø1/4"x 2-3/8"

#G 60pcs



Lock Washer Ø1/4" x 11mm

#H 60pcs



Flat Washer Ø1/4" x 19mm

#J 4pcs



Allen Wrench 4mm

Exploded View

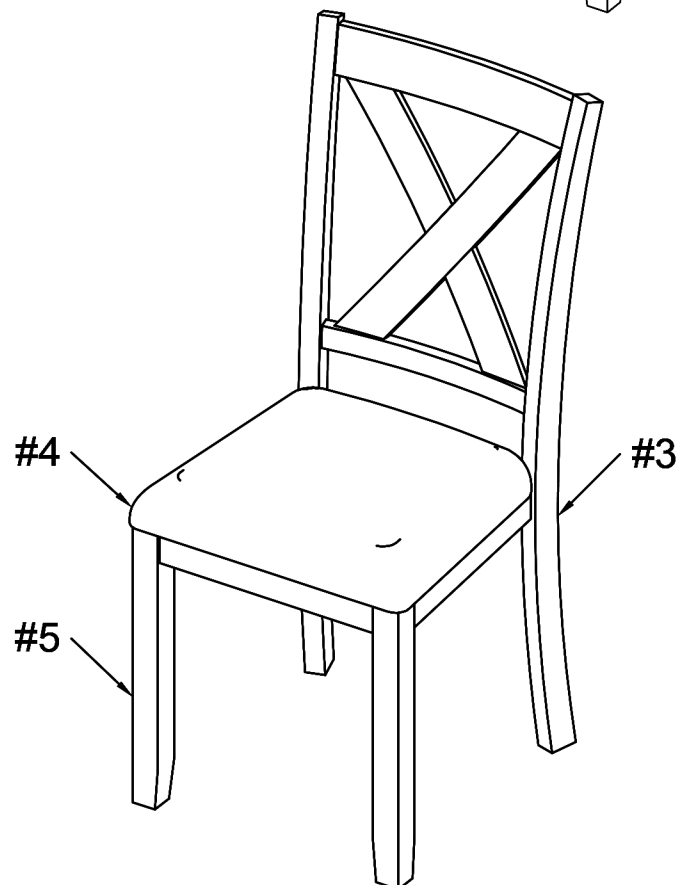
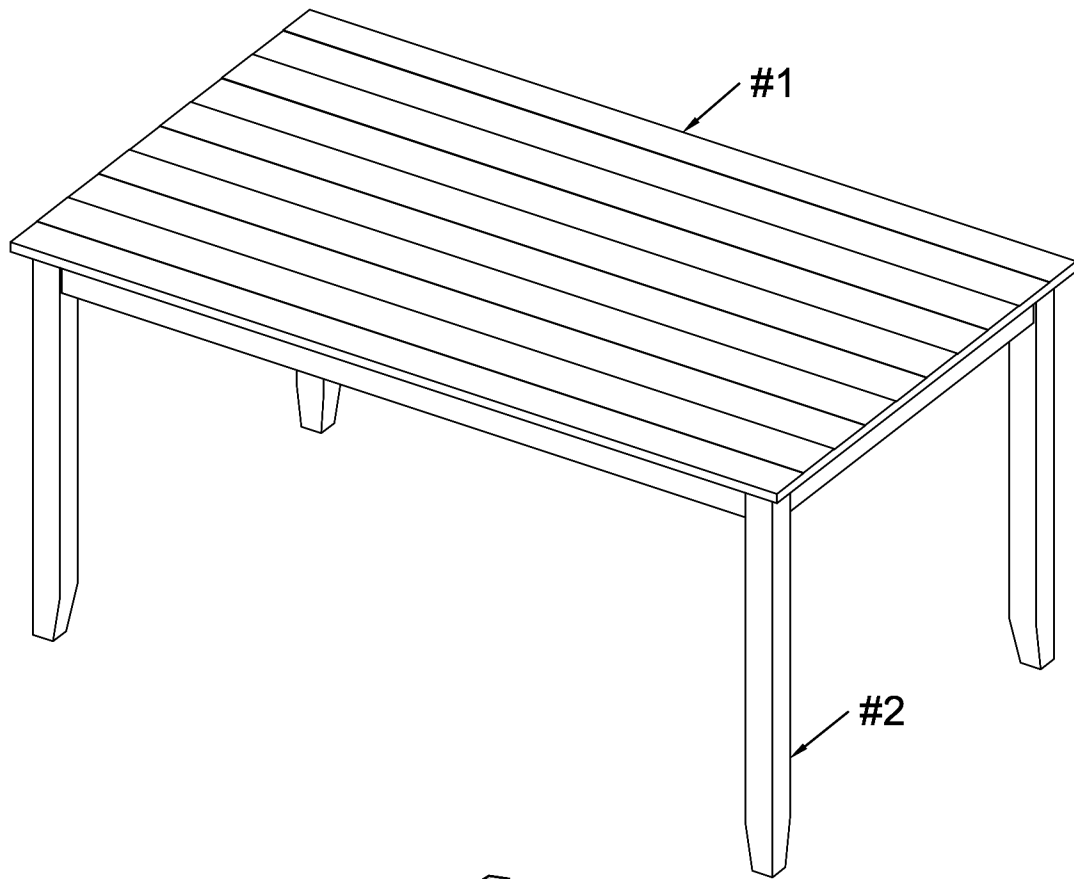

x6

ASSEMBLY INSTRUCTIONS

1

Part **#1** x 1pc
 Part **#2** x 4pcs
 Hardware **#A** x 8pcs
 Hardware **#B** x 8pcs
 Hardware **#C** x 8pcs

Align table legs (#2) to the table top (#1), then secure by using bolts (#A) with washers (#B,C).

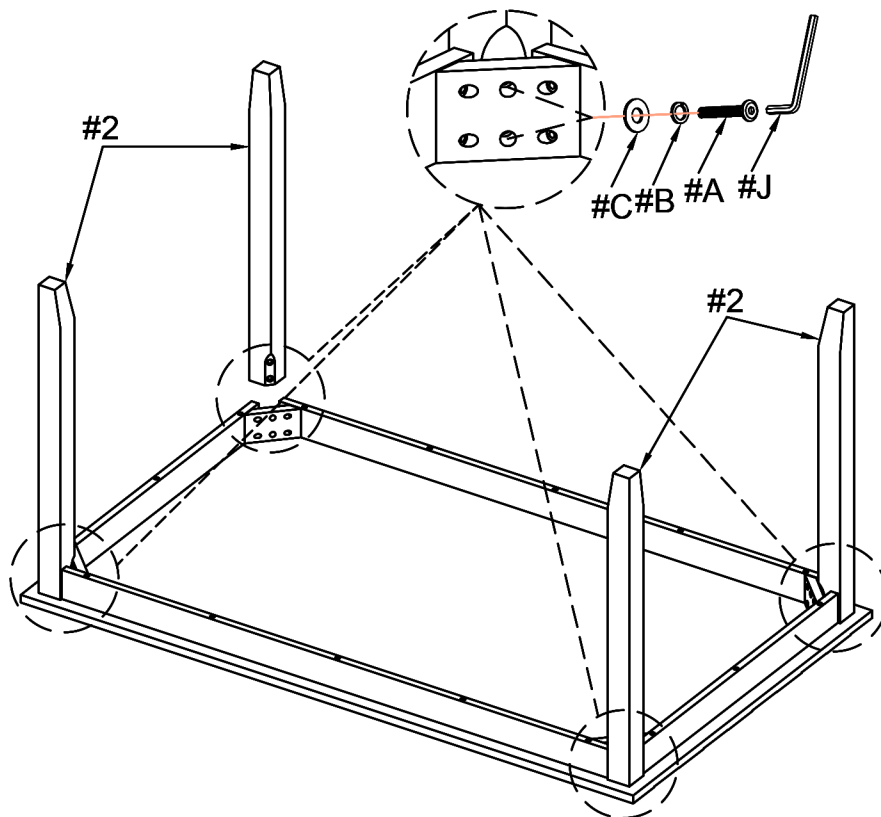

2

Part **#4** x 6pcs
 Part **#5** x 12pcs
 Hardware **#F** x 24pcs
 Hardware **#G** x 24pcs
 Hardware **#H** x 24pcs

Align front chair legs (#5) to the seat (#4), then secure by using bolts (#F) with washers (#G,H).

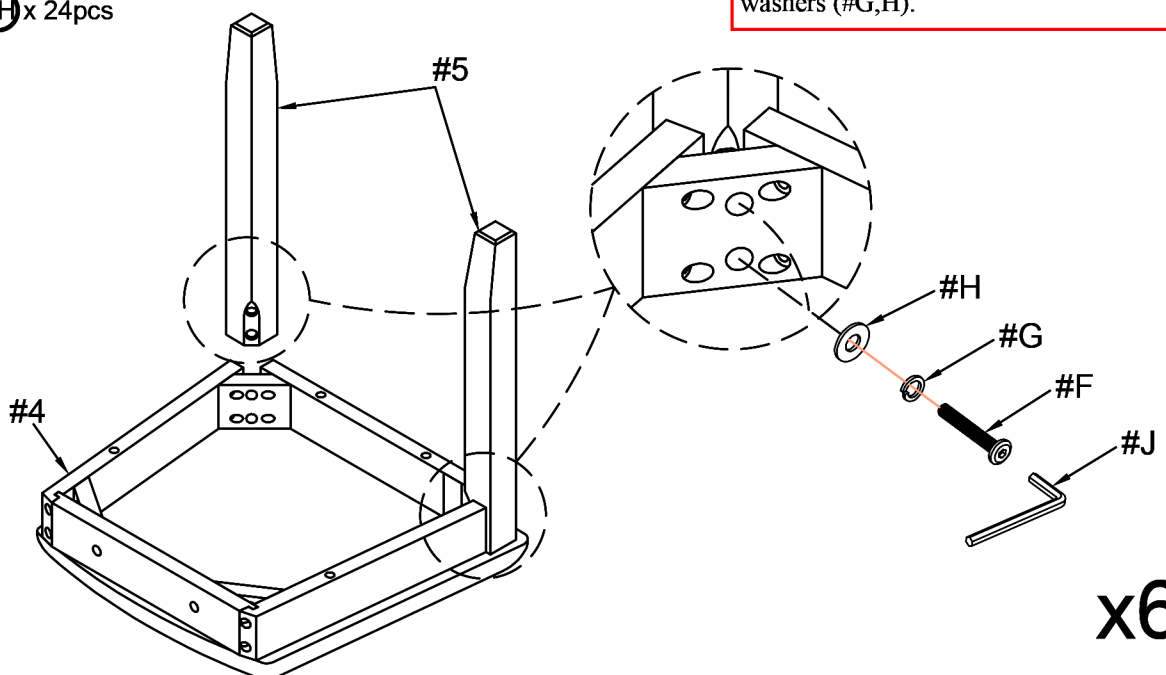

x6

ASSEMBLY INSTRUCTIONS

3

Part #3 x 6pcs
Hardware #E x 12pcs
Hardware #G x 12pcs
Hardware #H x 12pcs

Align seat (#4) to the chair back (#3), then secure by using bolts (#E) with washers (#G,H).

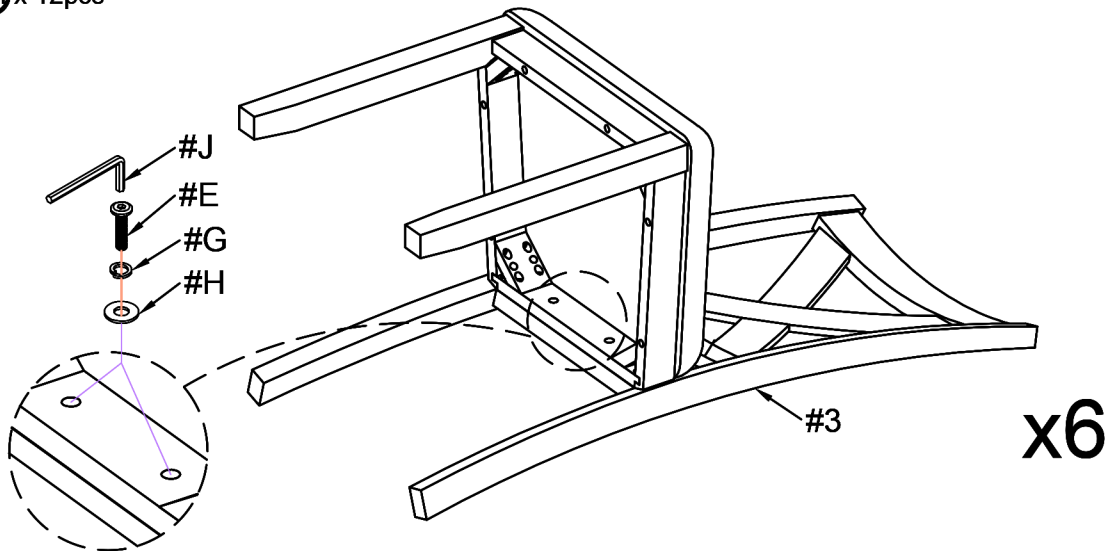

4

Hardware #D x 24pcs
Hardware #G x 24pcs
Hardware #H x 24pcs

Secure seat (#4) onto chair back (#3) by using bolts (#D) with washers (#G,H).

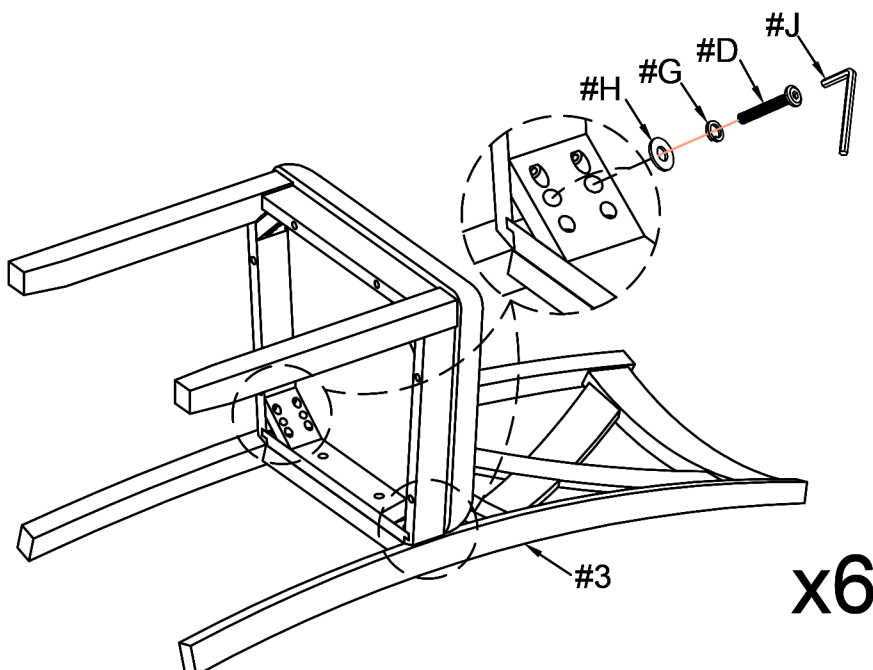

ASSEMBLY COMPLETED



Please ensure the furniture rests on an even and flat surface. If the product wobbles or feels loose, double-check all bolts and/or screws are properly tightened and secured.



Keep this handy!

Please retain this instruction manual and any order-related information for future reference.



Lift, don't drag!

To avoid damage to product please always LIFT the product when transporting or adjusting the placement.