

ASSEMBLY INSTRUCTIONS

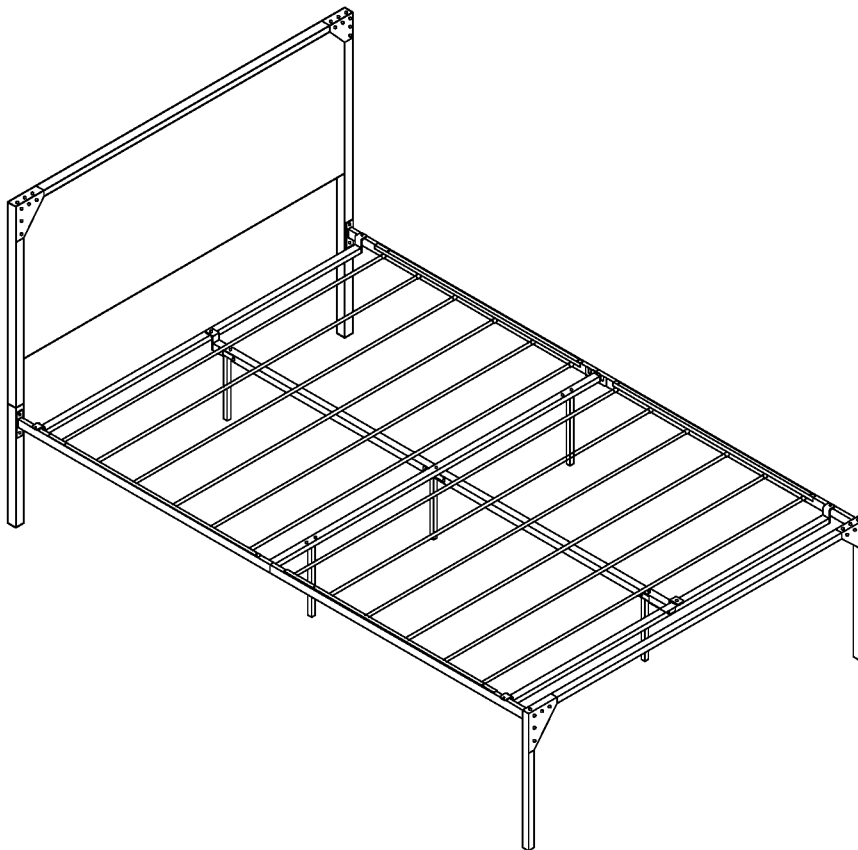

TOOLS REQUIRED



Allen Wrench

(Included)



2 - People
Recommended

ASSEMBLY RATING



EASY —————> DIFFICULT

The Assembly Rating is a 5-point system showing the level of effort needed to assemble a specific product.



CHECK BEFORE STARTING

☐

Are you missing anything?

Double-check all parts, hardware and accessories listed on Page 6 are accounted for.

☐

Check out our Quick Tips!

We recommend reviewing the pre-assembly handouts. Even experts need a refresher now and then!

☐

Should we send any replacements?

Are there any irregularities or flaws in the parts? We can send replacements!

☐

Prep Time!

Please review the assembly instructions and all diagrams prior to assembling. Arrange parts as recommended on Page 7 and group identical hardware together to make assembling easier.

PRE ASSEMBLY INTRODUCTION

We understand building ready-to-assemble furniture can be a challenging experience for some. To help avoid confusion, we have provided some helpful tips that may speed up the process.



Teamwork

ALWAYS have at least two people to help with transporting and assembling the product to avoid potential injury and/or damage.



Suitable Location

Assembling near the area of the intended location is highly recommended.



Sufficient Space

Make sure you have enough space to move around during the assembly.



Avoid Scratches

Use cardboard, blankets or a carpeted area while assembling furniture to prevent scratches.

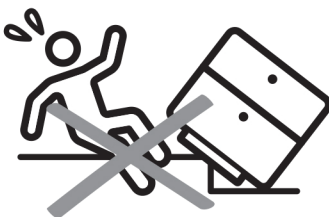

Flat Surface

Make sure the furniture rests on a flat and level surface with each leg evenly touching the floor.

ASSEMBLY AND CARE ADVICE



**FAILURE TO FOLLOW THE GUIDELINES BELOW MAY
RESULT IN INJURY AND/OR PROPERTY DAMAGE.**



Position each part correctly
and insert screws or bolts into
their respective holes.

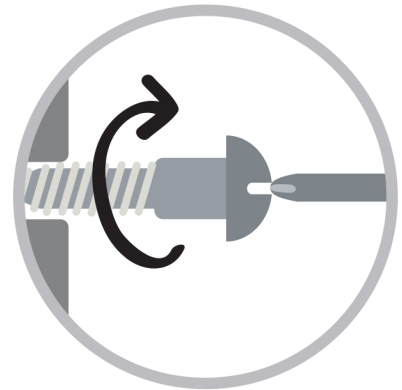

Turn clockwise to tighten and
only tighten when step is
completed or when instructed
to do so.



Save the instructions and store
any supplied tools for later
maintenance.

Use the appropriate hand tools
or power tools for assembly.
Select steps, such as tightening
screws and/or bolts, may require
hand tools to avoid causing
damage during assembly.

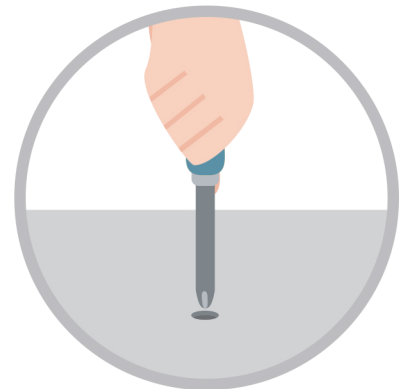

After two weeks, check and
tighten any loose hardware and
repeat again every six months
thereafter.

IT IS THE USER'S RESPONSIBILITY TO MAINTAIN THE FURNITURE. THE HARDWARE MAY LOOSEN OVER TIME AND MAY CAUSE THE FURNITURE TO BE WOBBLY AND UNABLE TO SUPPORT ITS INTENDED WEIGHT CAPACITY. THIS MAY LEAD TO COLLAPSE AND MAY CAUSE SERIOUS INJURY.

BED



- Please keep instructions for future reference.
- Check the quantity and irregularity of parts and hardware before you start.

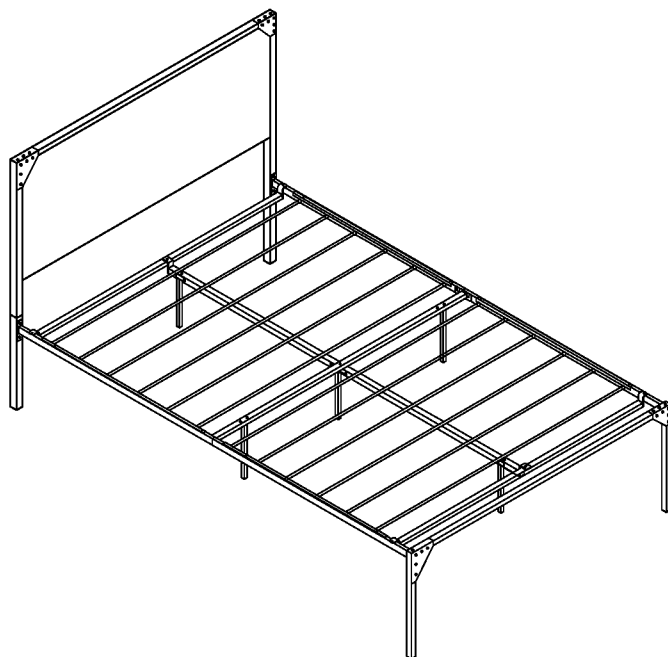

PARTS

#1 1pc

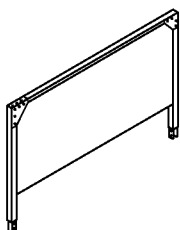

Bedboard Panel

#2 1pc

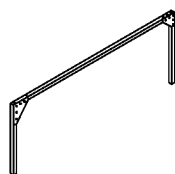

Footboard

#3 1pc



Bedboard Leg (L)

#4 1pc



Bedboard Leg (R)

#5 1pc



Rail A

#6 1pc

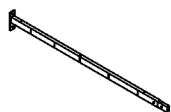

Rail B

#7 1pc



Rail C

#8 1pc

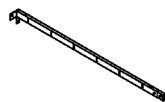

Rail D

#9 1pc



Center Rail

#10 2pcs



Support Rail A

#11 1pc



Support Rail B

#12 2pcs



Support Leg

#13 12pcs



Slat

#14 4pcs



Rail Top Panel

HARDWARE

#A 38pcs



Bolt 1/4" x 1/2"

#B 4pcs



Bolt 1/4" x 1"

#C 2pcs



Bolt 1/4" x 1-3/8"

#D 1pc

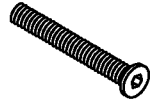

Bolt 1/4" x 2"

#E 4pcs



Bolt M8 x 1/2"

#F 1pc



Allen Wrench M4

#G 1pc



Allen Wrench M5

ASSEMBLY INSTRUCTIONS

1

Part (#1) × 1pc

Part (#3) × 1pc

Part (#4) × 1pc

Hardware (#A) × 8pcs

Align HB legs (#3,4) to the headboard (#1), then secure by using bolts (#A).

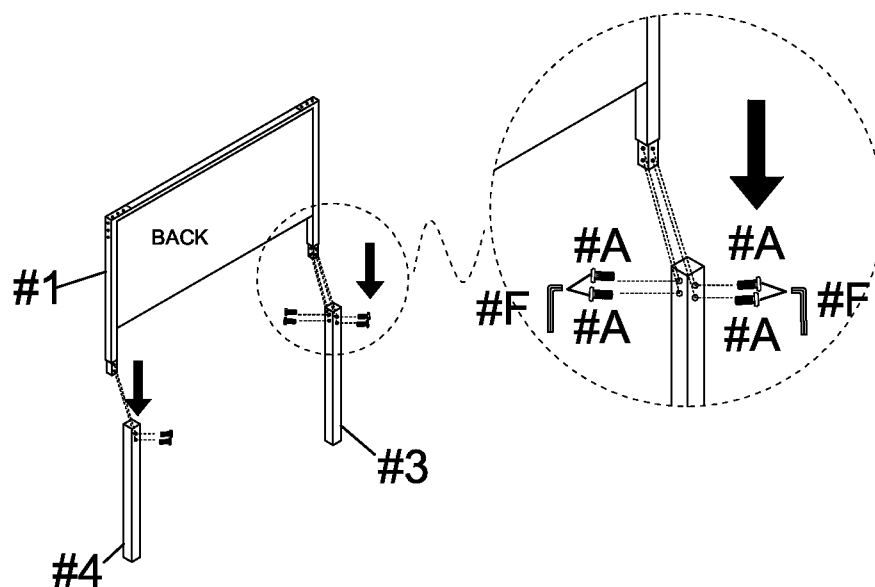

2

Part (#5) × 1pc

Part (#6) × 1pc

Hardware (#A) × 4pcs

Align rails (#5,6) to the headboard, then secure by using bolts (#A).

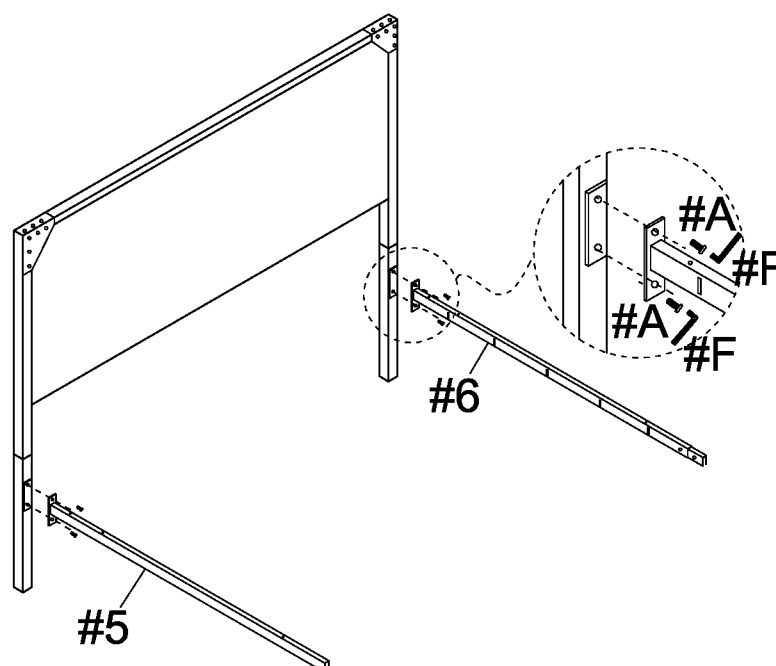

ASSEMBLY INSTRUCTIONS

3

Part #2 × 1pc

Part #7 × 1pc

Part #8 × 1pc

Hardware #A × 8pcs

Align rails (#7,8) to the footboard (#2), then secure by using bolts (#A).

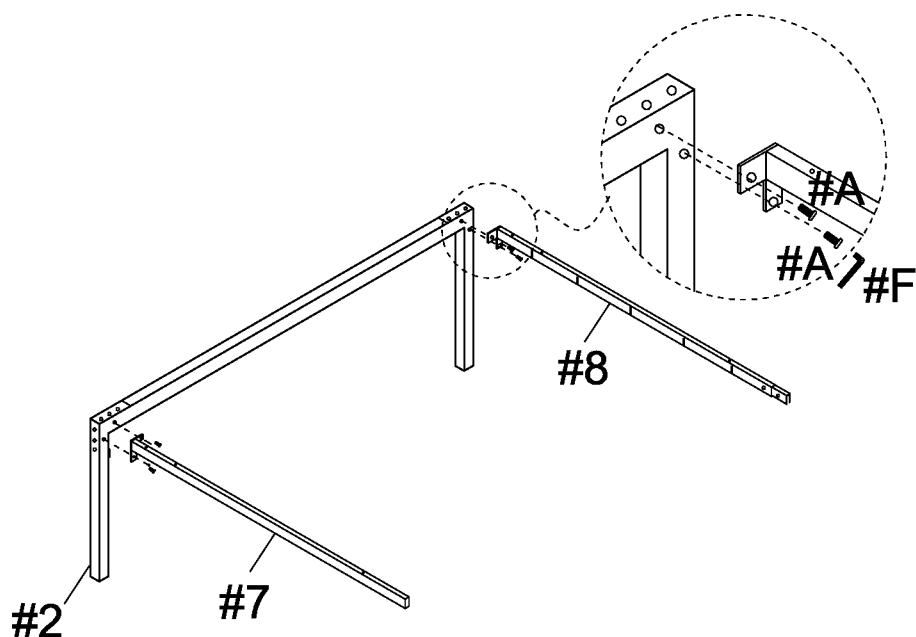

4

Connect the side rails together.

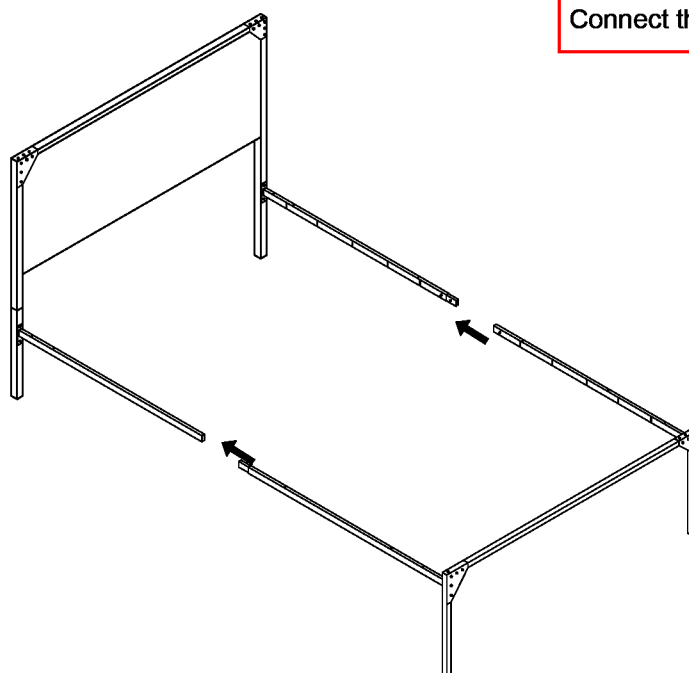

ASSEMBLY INSTRUCTIONS

5

Part #10 ×2pcs

Hardware #A ×4pcs

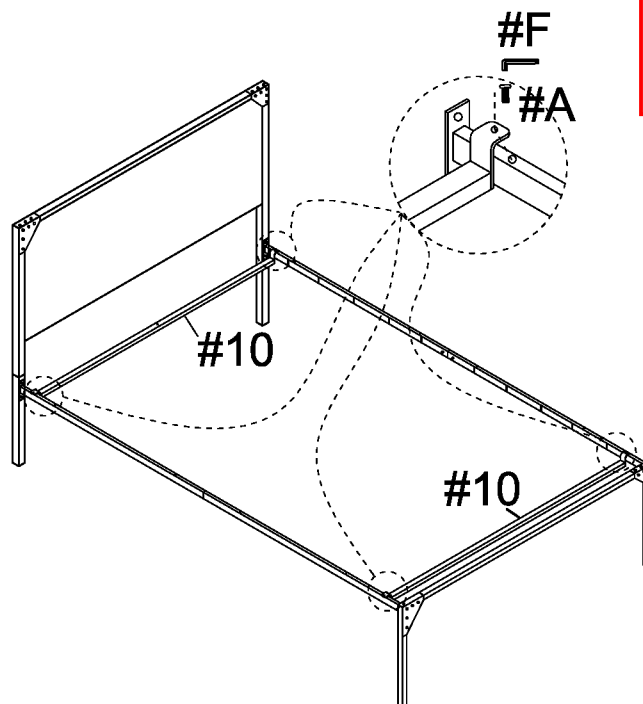

Align support rails (#10) to the side rails, then secure by using bolts (#A).

6

Part #9 ×1pc

Hardware #A ×2pcs

Hardware #C ×2pcs

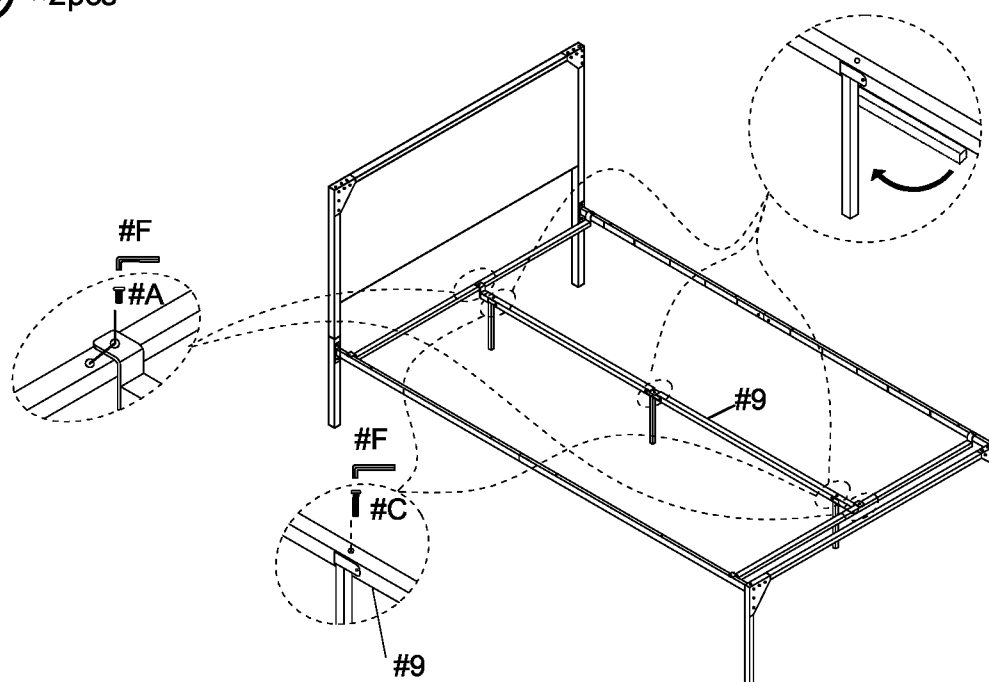

Align center rail (#9) to the support rails, then secure by using bolts (#A). Extend support legs of the center rail (#9), then secure by using bolts (#C).

ASSEMBLY INSTRUCTIONS

7

Part #11 × 1pc

Hardware #D × 1pc

Hardware #E × 4pcs

Align support rail (#11) to the center rail (#9), then secure by using bolts (#D).

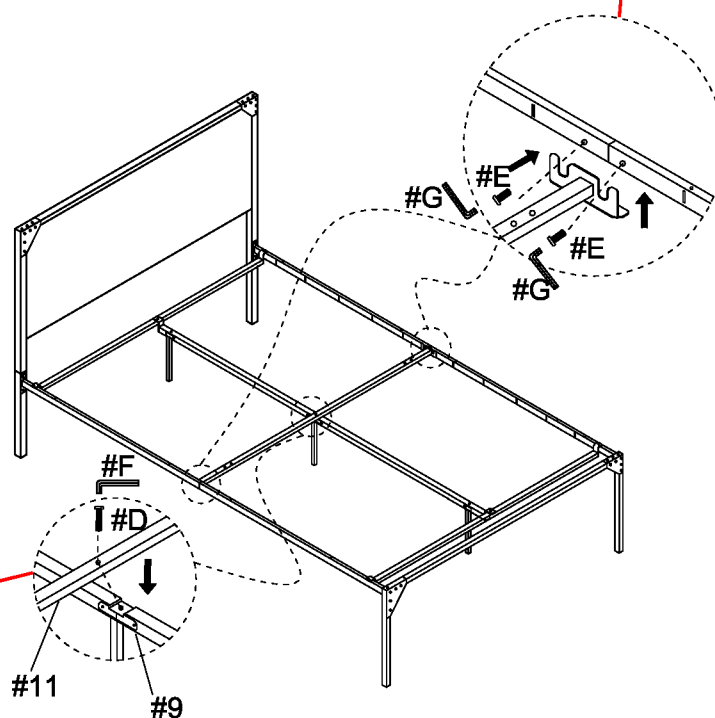

8

Part #12 × 2pcs

Hardware #B × 4pcs

Align support legs (#12) to the support rail, then secure by using bolts (#B).

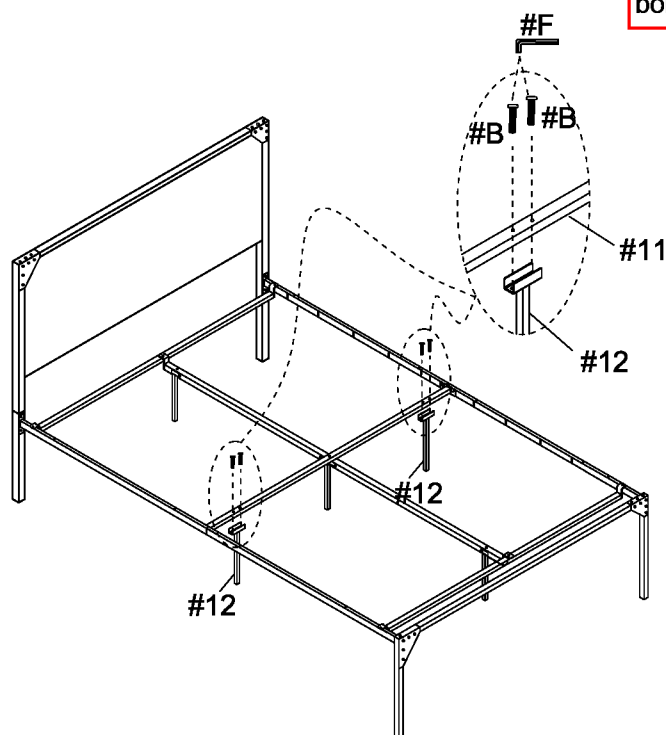

ASSEMBLY INSTRUCTIONS

Attach slats (#13) to the side rails.

9

Part #13 ×12pcs

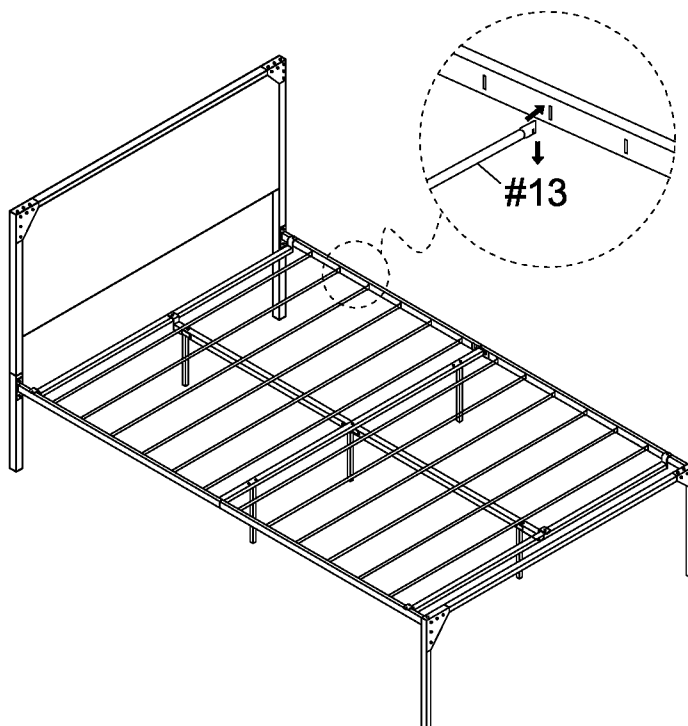

10

Part #14 ×4pcs

Hardware #A ×12pcs

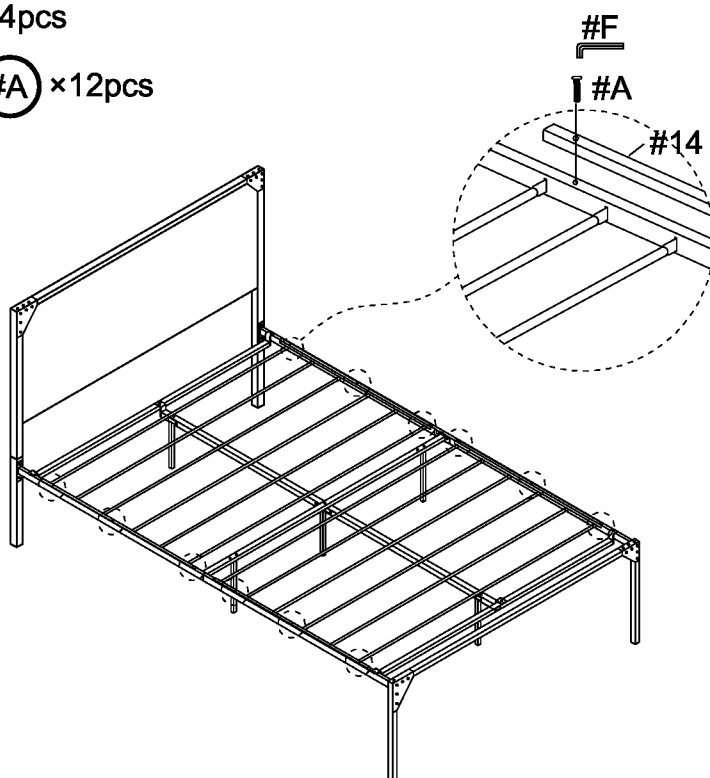

Align rail top (#14) to the side rails, then secure by using bolts (#A).

ASSEMBLY COMPLETED



Please ensure the furniture rests on an even and flat surface. If the product wobbles or feels loose, double-check all bolts and/or screws are properly tightened and secured.



Keep this handy!

Please retain this instruction manual and any order-related information for future reference.



Lift, don't drag!

To avoid damage to product please always LIFT the product when transporting or adjusting the placement.