

ASSEMBLY INSTRUCTIONS

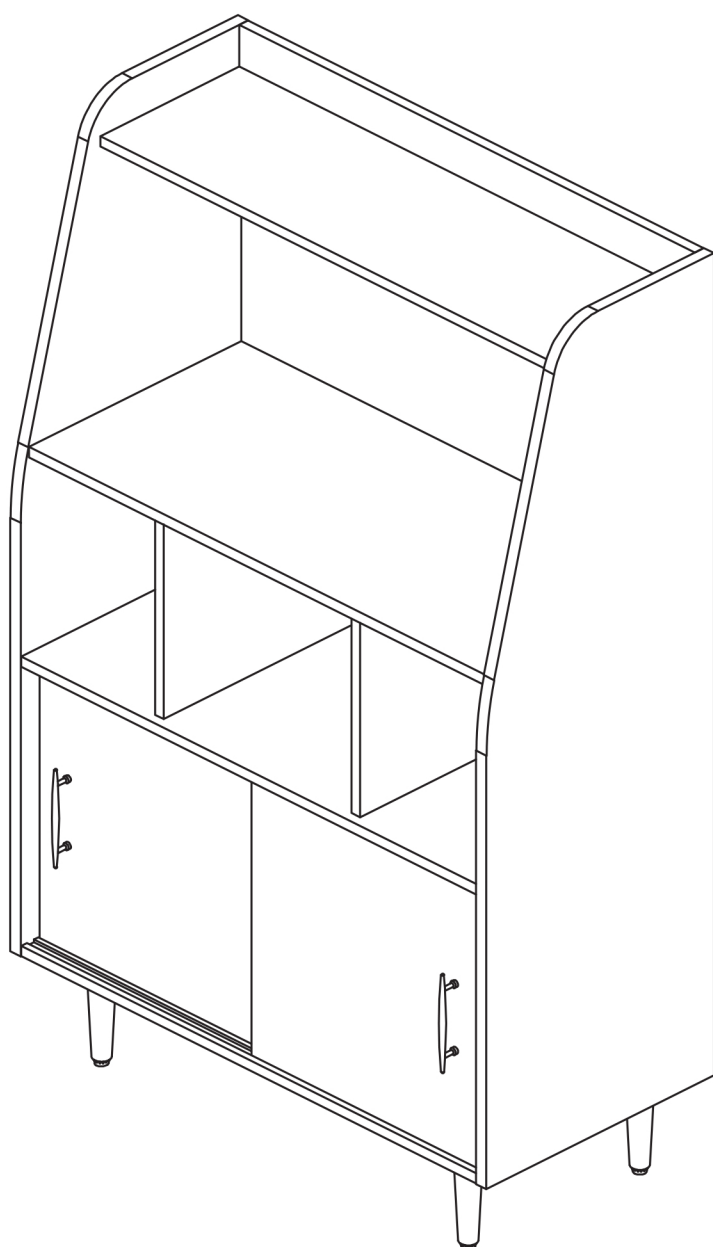

TOOLS REQUIRED



Hammer

(Not Included)



Philips Screwdriver

(Not Included)



**2 - Persons
Recommended**

ASSEMBLY RATING



EASY —————> DIFFICULT

The Assembly Rating is a 5-point system showing the level of effort needed to assemble a specific product.



CHECK BEFORE STARTING

☐

Are you missing anything?

Double-check all parts, hardware and accessories listed on Page 6 are accounted for.

☐

Check out our Quick Tips!

We recommend reviewing the pre-assembly handouts. Even experts need a refresher now and then!

☐

Should we send any replacements?

Are there any irregularities or flaws in the parts? We can send replacements!

☐

Prep Time!

Please review the assembly instructions and all diagrams prior to assembling. Arrange parts as recommended on Page 7 and group identical hardware together to make assembling easier.

PRE ASSEMBLY INTRODUCTION

We understand building ready-to-assemble furniture can be a challenging experience for some. To help avoid confusion, we have provided some helpful tips that may speed up the process.

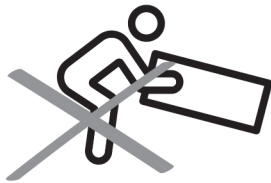

Teamwork

ALWAYS have at least two people to help with transporting and assembling the product to avoid potential injury and/or damage.

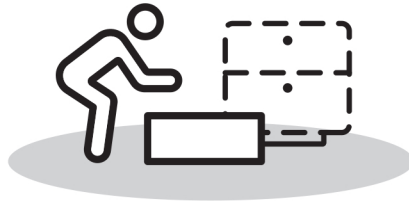
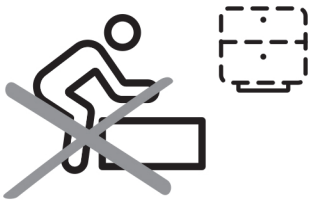

Suitable Location

Assembling near the area of the intended location is highly recommended.



Sufficient Space

Make sure you have enough space to move around during the assembly.

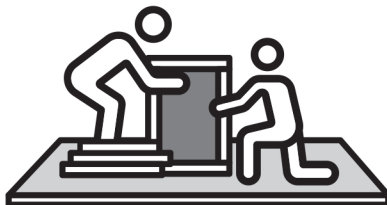

Avoid Scratches

Use cardboard, blankets or a carpeted area while assembling furniture to prevent scratches.

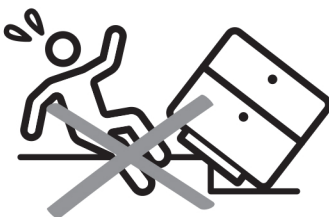

Flat Surface

Make sure the furniture rests on a flat and level surface with each leg evenly touching the floor.

ASSEMBLY AND CARE ADVICE



**FAILURE TO FOLLOW THE GUIDELINES BELOW MAY
RESULT IN INJURY AND/OR PROPERTY DAMAGE.**



Position each part correctly
and insert screws or bolts into
their respective holes.

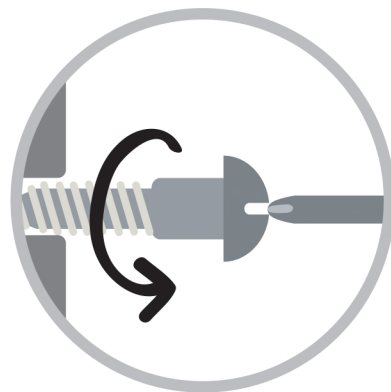

Turn clockwise to tighten and
only tighten when step is
completed or when instructed
to do so.



Save the instructions and store
any supplied tools for later
maintenance.

Use the appropriate hand tools
or power tools for assembly.
Select steps, such as tightening
screws and/or bolts, may require
hand tools to avoid causing
damage during assembly.

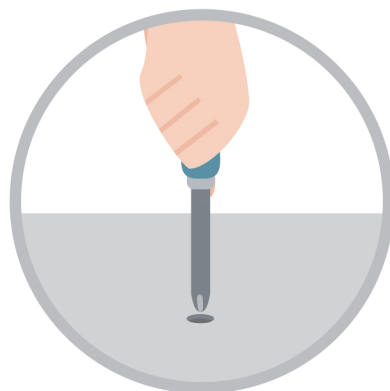

After two weeks, check and
tighten any loose hardware and
repeat again every six months
thereafter.

IT IS THE USER'S RESPONSIBILITY TO MAINTAIN THE FURNITURE. THE HARDWARE MAY LOOSEN OVER TIME AND MAY CAUSE THE FURNITURE TO BE WOBBLY AND UNABLE TO SUPPORT ITS INTENDED WEIGHT CAPACITY. THIS MAY LEAD TO COLLAPSE AND MAY CAUSE SERIOUS INJURY.

CAM LOCK FASTENER ASSEMBLY INSTRUCTIONS

Note :

Every cam lock bolt must have a cam lock connector in order to fasten the parts together.

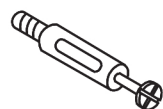

cam bolt



cam lock

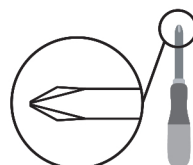

screwdriver

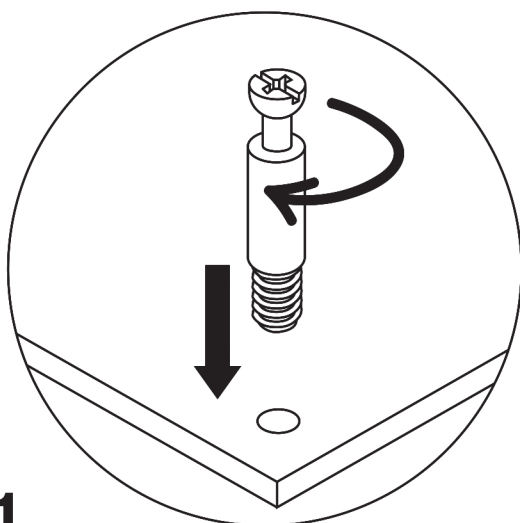

1

Screw the cam bolt into panel.

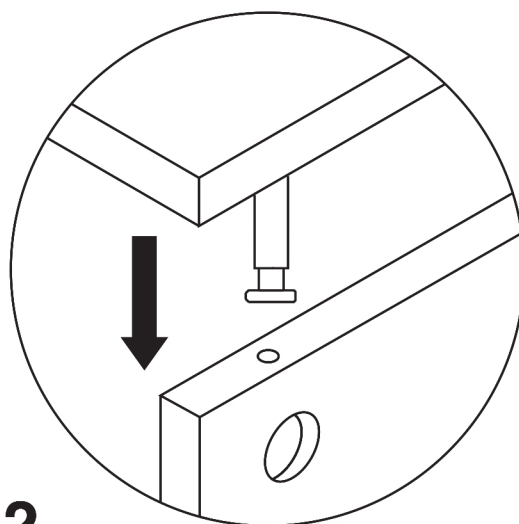

2

Insert the cam bolt into the bolt hole of joint panel.

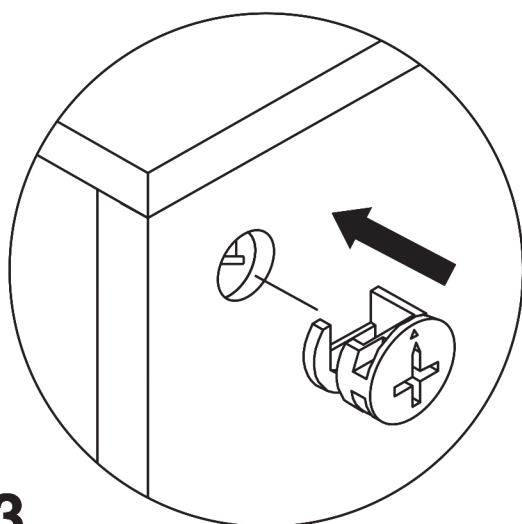

3

Align the cam lock with its side opening (or arrow) pointing to cam bolt.

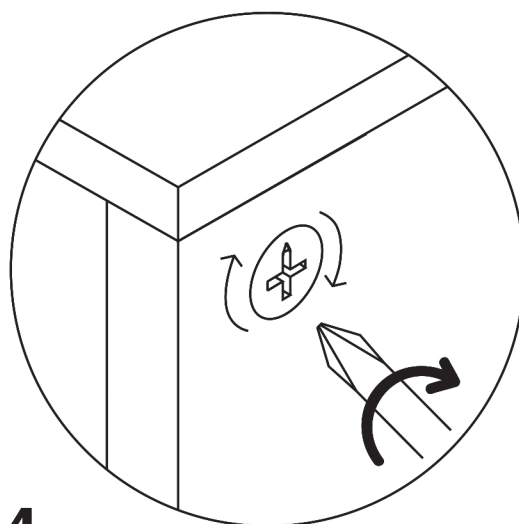

4

Turn the cam lock clockwise gently until it will not turn any more.

Buffet



- Please keep instructions for future reference.
- Check the quantity and irregularity of parts and hardware before you start.

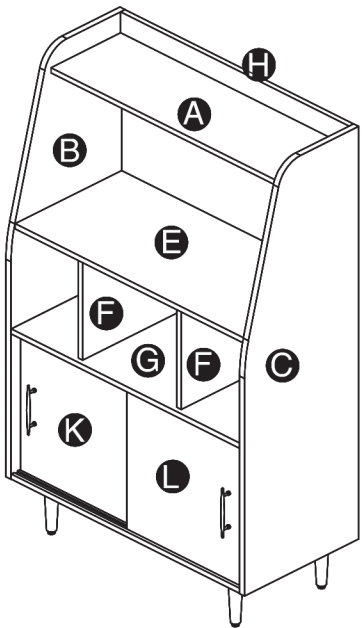

PARTS

A1PC



B1PC



C1PC



D1PC

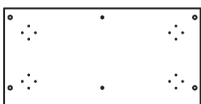

E1PC



F2PCS



G1PC

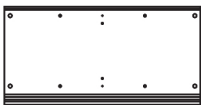

H1PC

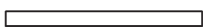

I1PC

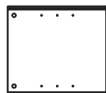

J1PC

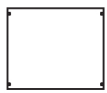

K1PC

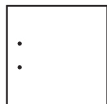

L1PC

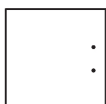

M1PC



N1PC



O2PCS



HARDWARE

① 24PCS

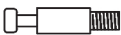

② 24PCS

0.47"



③ 37PCS

0.98"



④ 6PCS

1.49"



⑤ 4PCS



⑥ 10Sets



ACCESSORIES

A1 4PCS



A2 2PCS



A3 16PCS



A4 4PCS



A5 4PCS



A6 4PCS



A7 2PCS



A8 8PCS



A9 1PC



A10 1PC

1.26"



A11 1PC



A12 1PC



A13 2PCS



A14 1PC



A15 1PC



GET READY

Please group boards as below.

A1PC

H1PC

E1PC

F2PCS

G1PC

I1PC

D1PC

O1PC

B1PC

M1PC

N1PC

O1PC

C1PC

J1PC

K1PC

L1PC

Body

Doors/Shelf

ASSEMBLY INSTRUCTIONS

1

Hardware ① x 24PCS

Hardware ③ x 24PCS

Accessory **A7** x 1PC

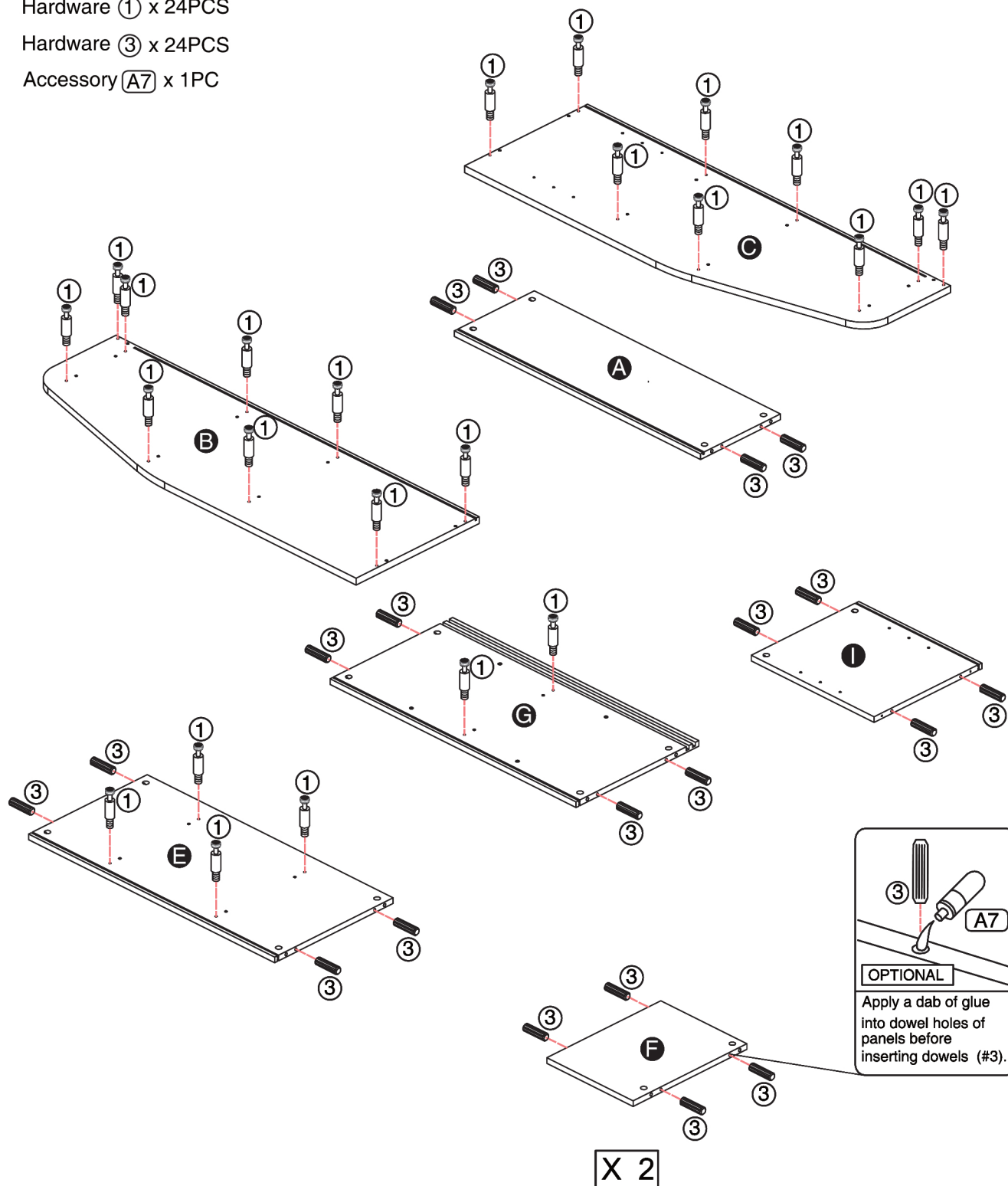

ASSEMBLY INSTRUCTIONS

2

Hardware ③ x 13PCS

Accessory A1 x 4PCS

Accessory A2 x 2PCS

Accessory A3 x 16PCS

Accessory A4 x 4PCS

Accessory A7 x 1PC

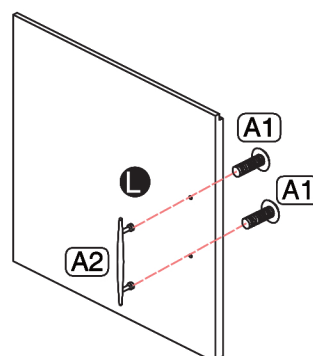
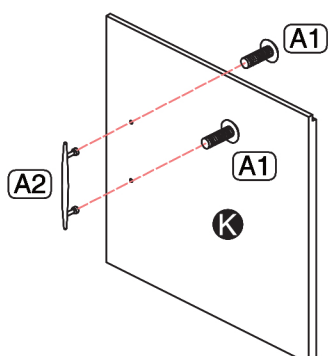
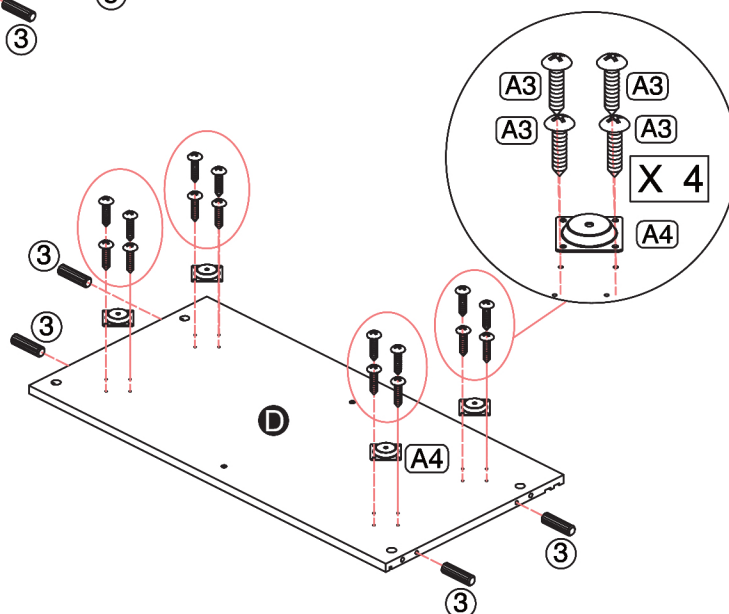
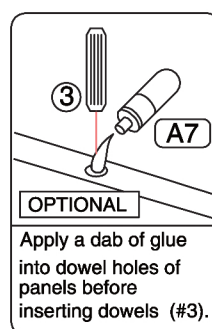
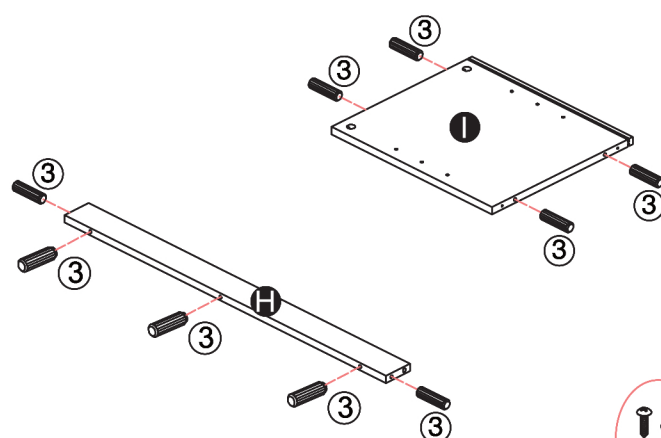

ASSEMBLY INSTRUCTIONS

3

Part **H** x1PC

Part **A** x1PC

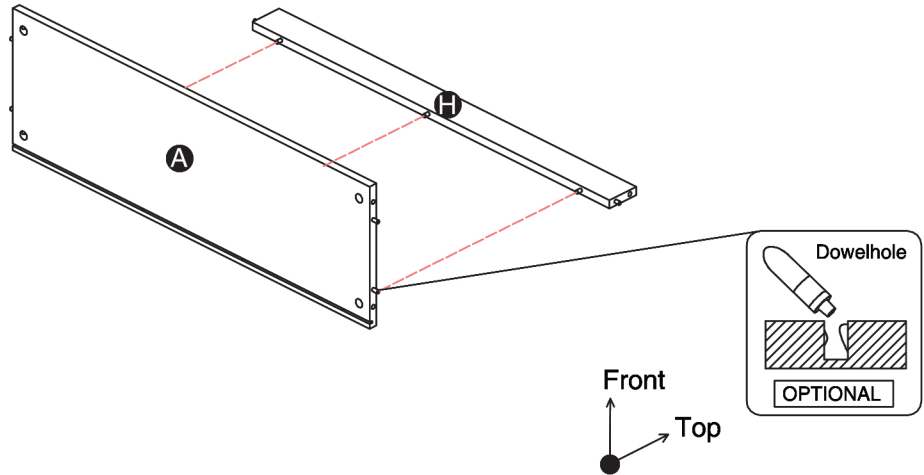

4

Part **E** x1PC

Part **F** x2PCS

Hardware **②** x 4PCS

Accessory **A8** x 4PCS

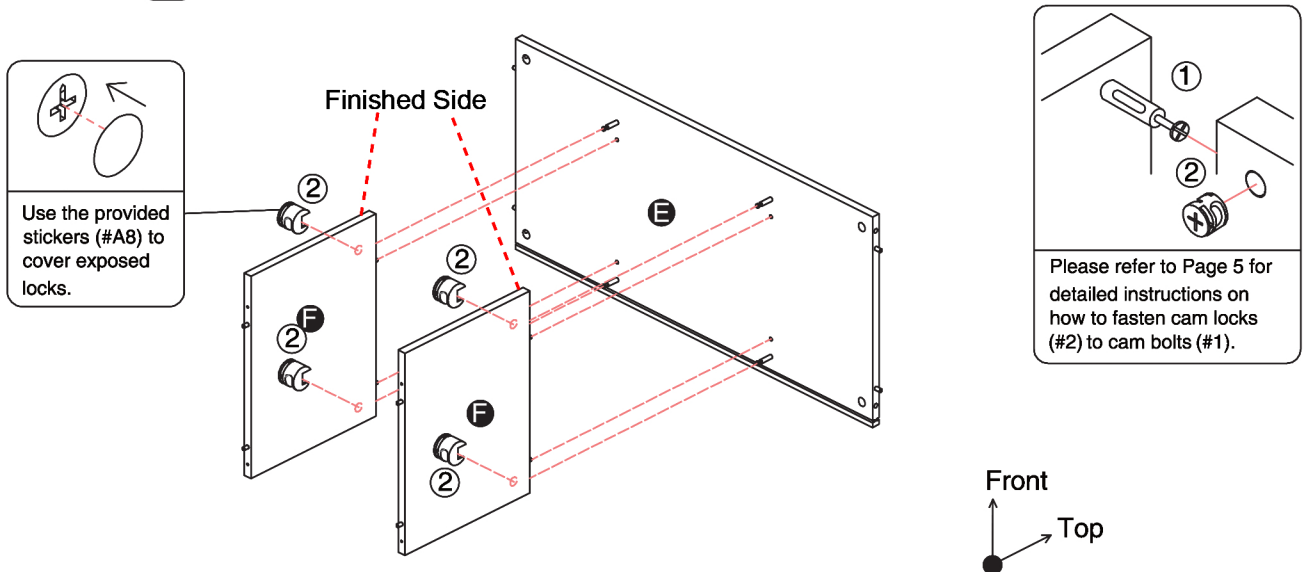

ASSEMBLY INSTRUCTIONS

5

Part **G** x1PC

Hardware **④** x 4PCS

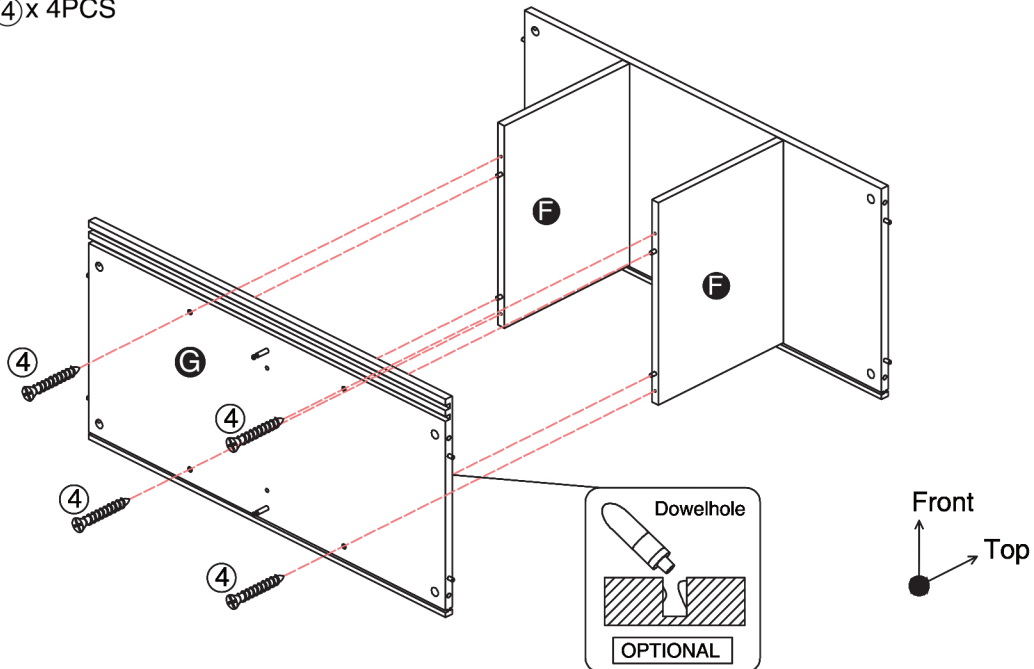

6

Part **I** x1PC

Hardware **②** x 3PCS

Accessory **A8** x 2PCS

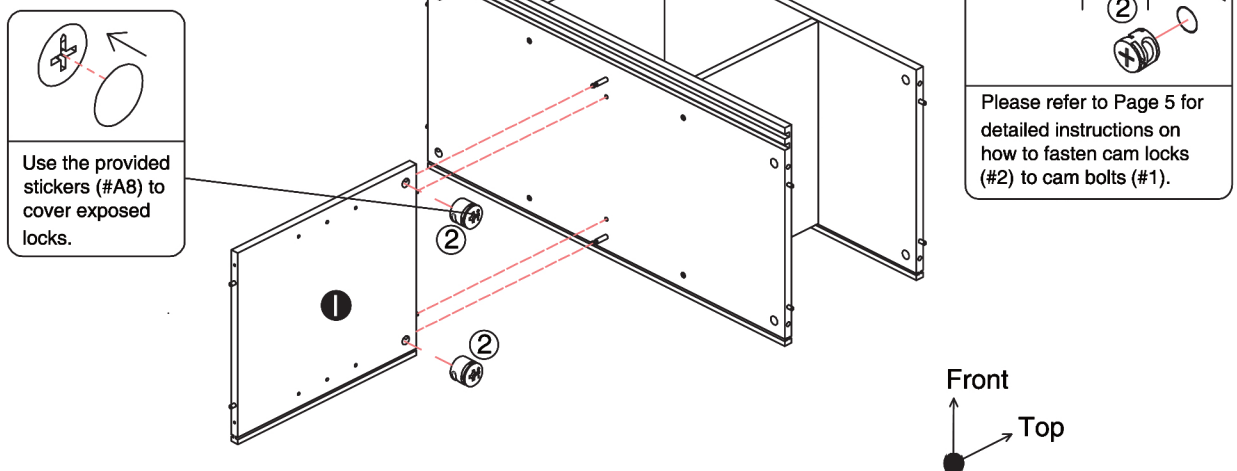

ASSEMBLY INSTRUCTIONS

7

Part **D** x1PC

Hardware **4** x 2PCS

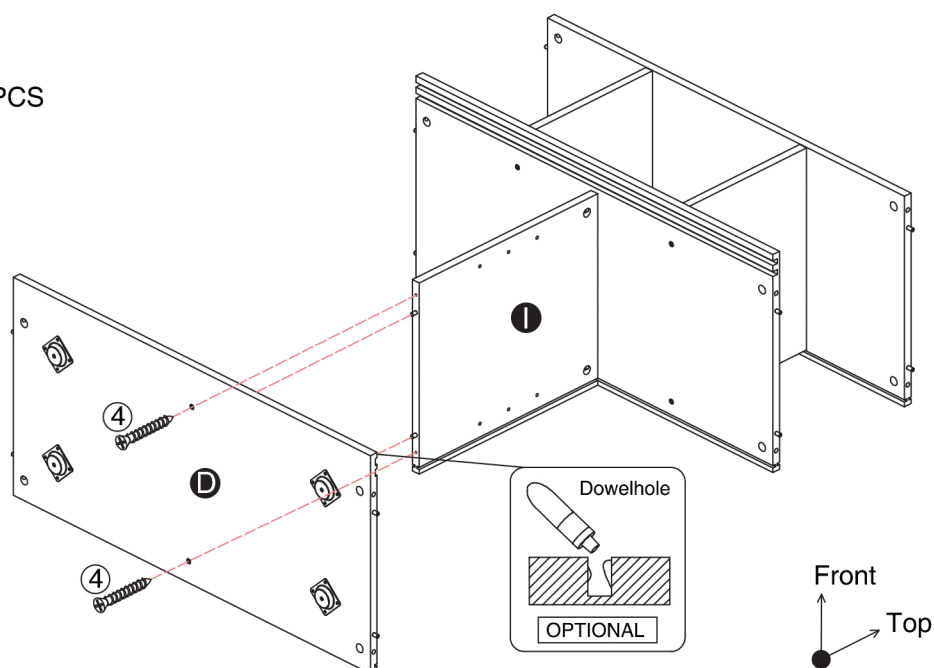

8

Part **C** x1PC

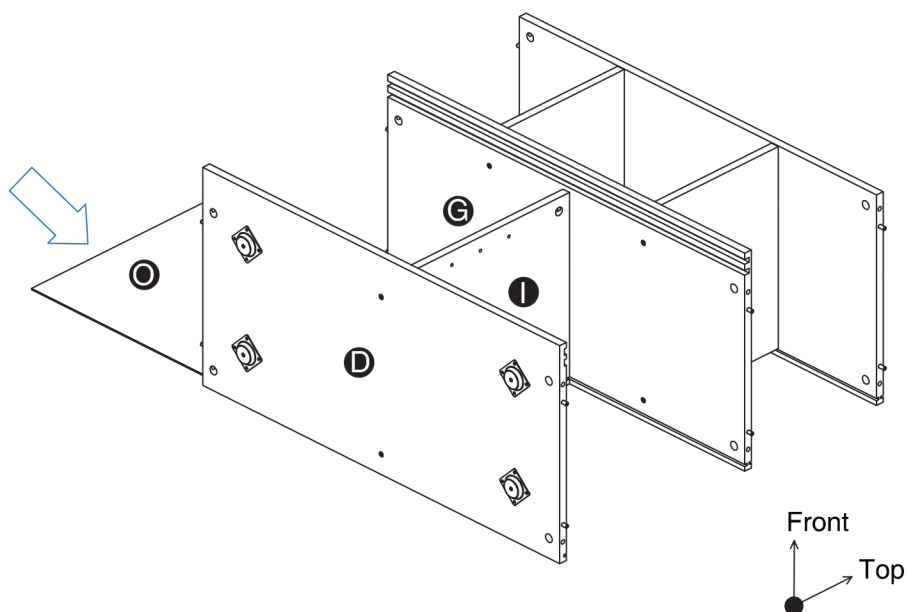

ASSEMBLY INSTRUCTIONS

9

Part **B** x 1PC

Hardware **2** x 9PCS

Accessory **A8** x 1PC

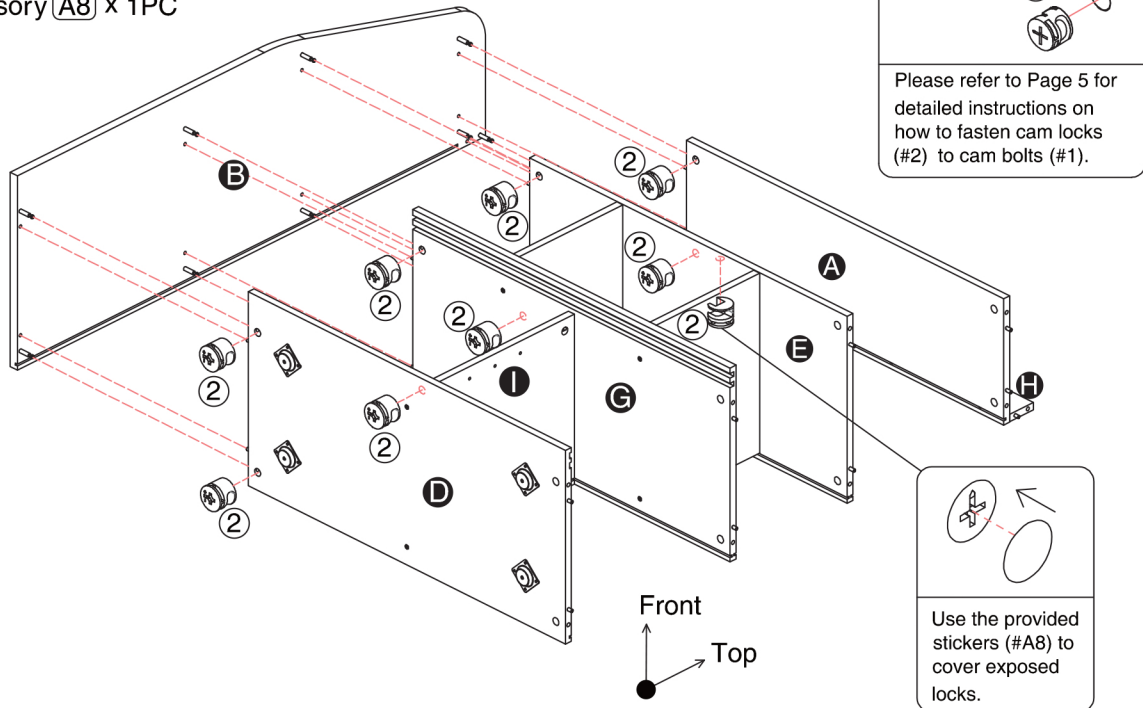

10

Part **M** x 1PC

Part **N** x 1PC

Part **O** x 1PC

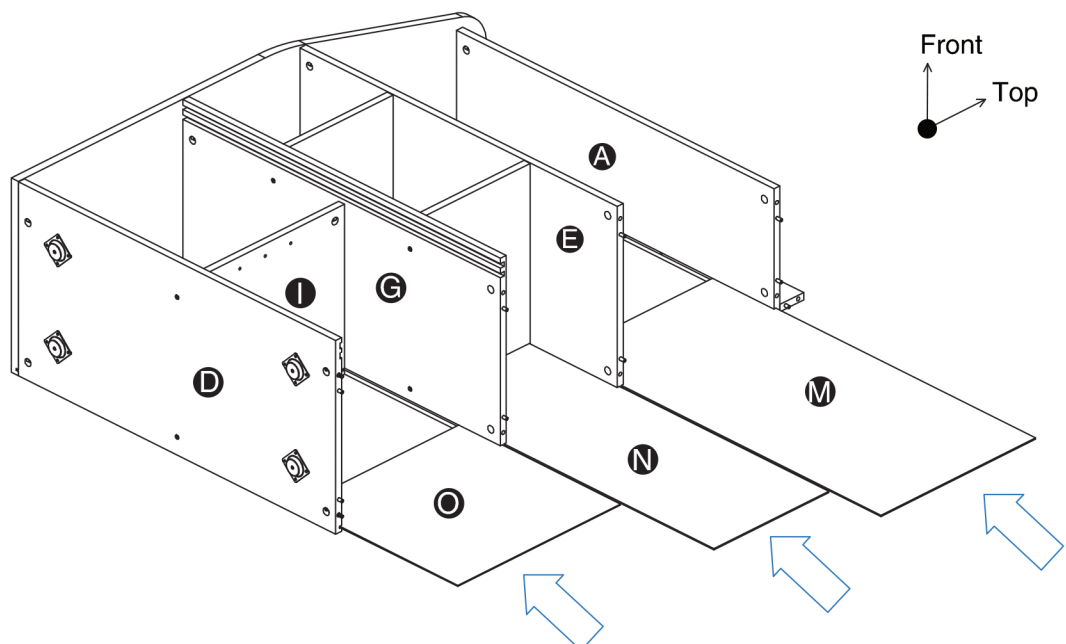

ASSEMBLY INSTRUCTIONS

11

Part **C** x1PC

Hardware **2** x 9PCS

Accessory **A8** x 1PC

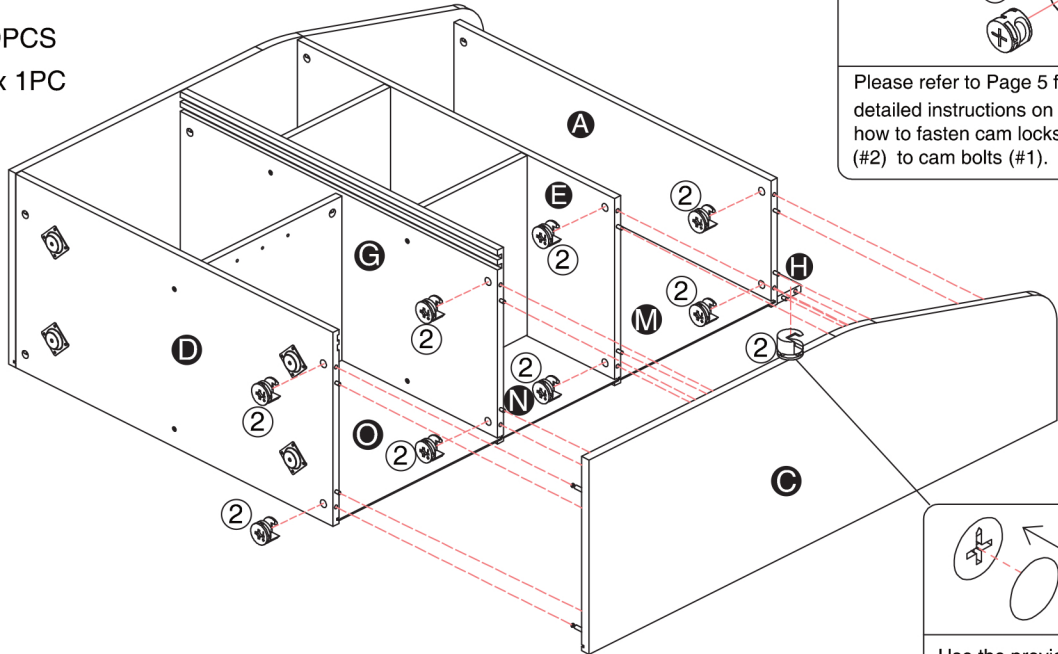
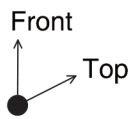

Please refer to Page 5 for detailed instructions on how to fasten cam locks (#2) to cam bolts (#1).

Use the provided stickers (#A8) to cover exposed locks.

12

Accessory **A5** x 4PCS

Accessory **A6** x 4PCS

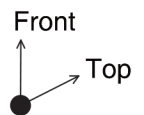
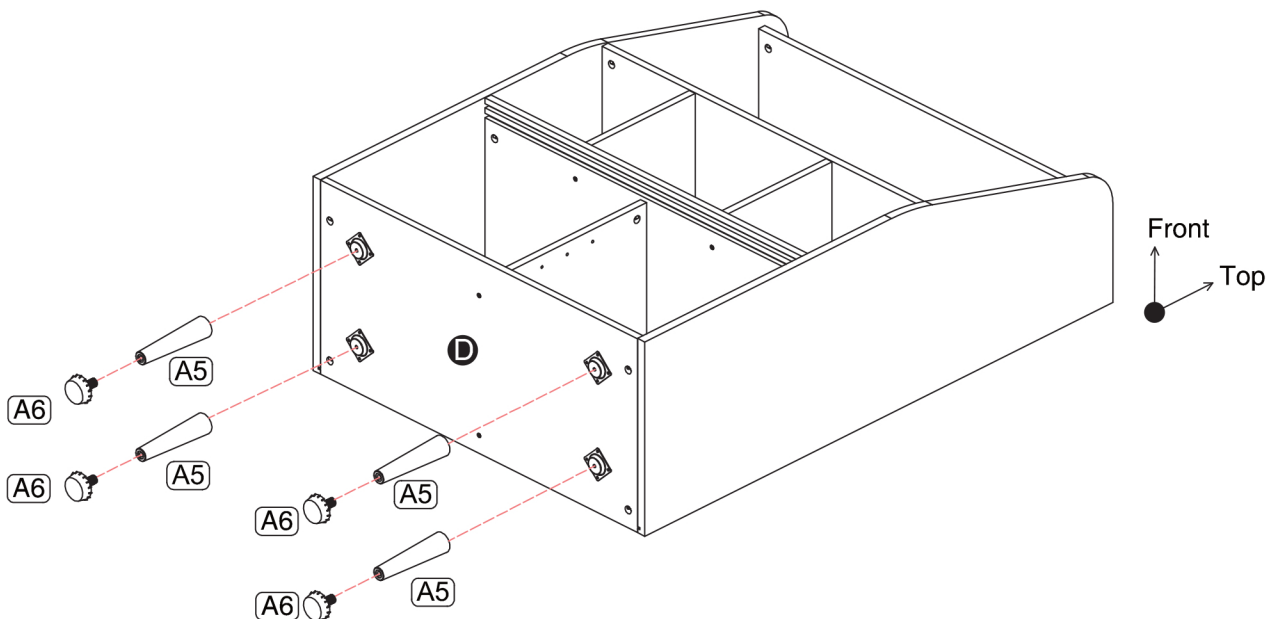

ASSEMBLY INSTRUCTIONS

13

Part **J** x1PC

Hardware **5** x 4PCS

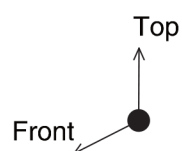
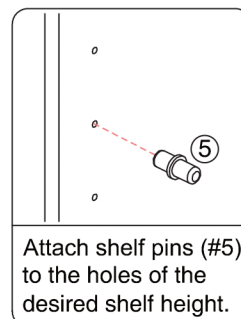
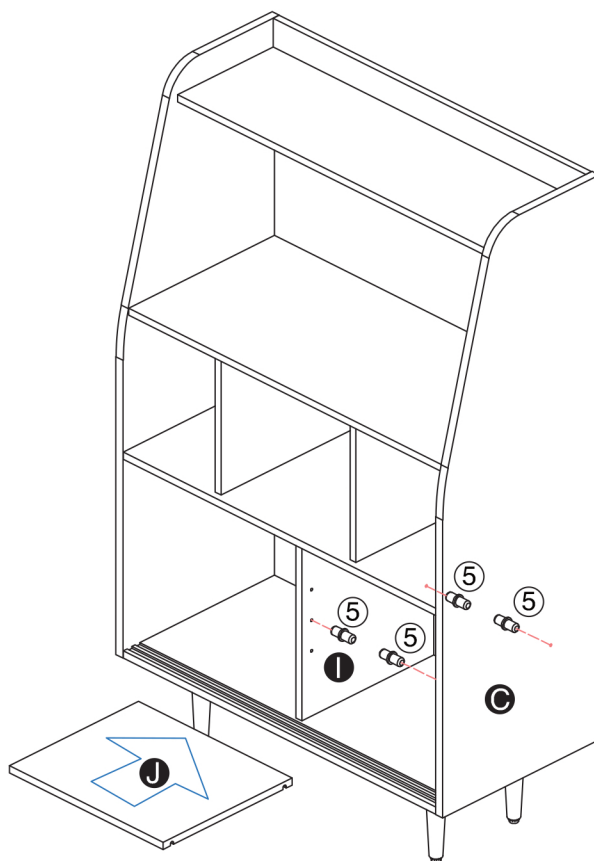

14

Part **K** x1PC

Part **L** x1PC

Insert upper side of panels (#K,L) first before inserting the bottom side.

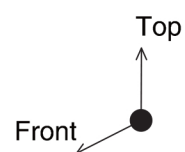
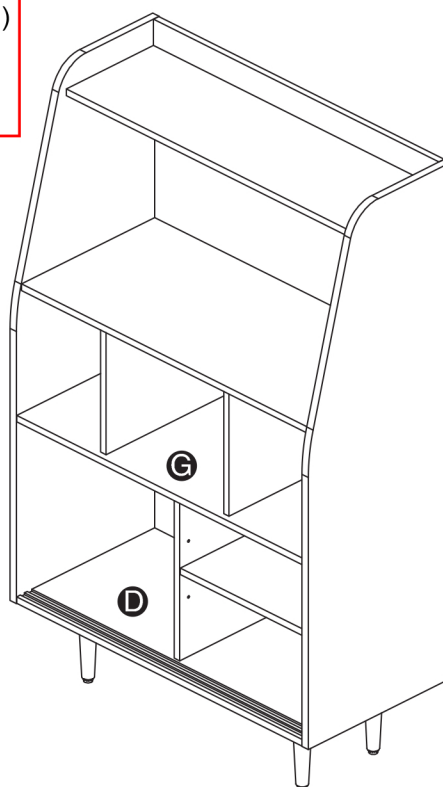
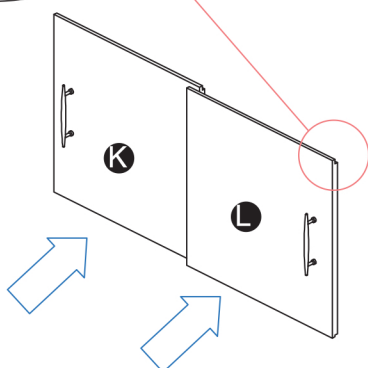
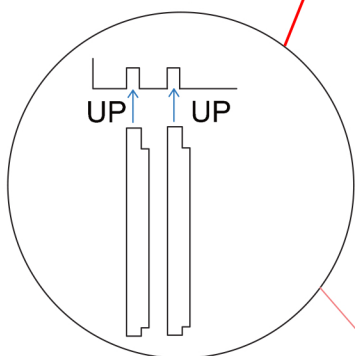

ASSEMBLY INSTRUCTIONS

15

Hardware ⑥ x 10Sets

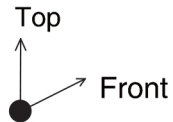
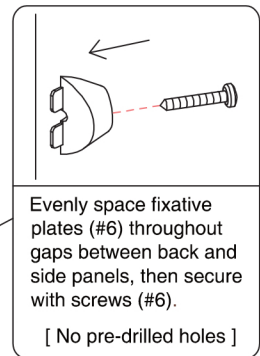
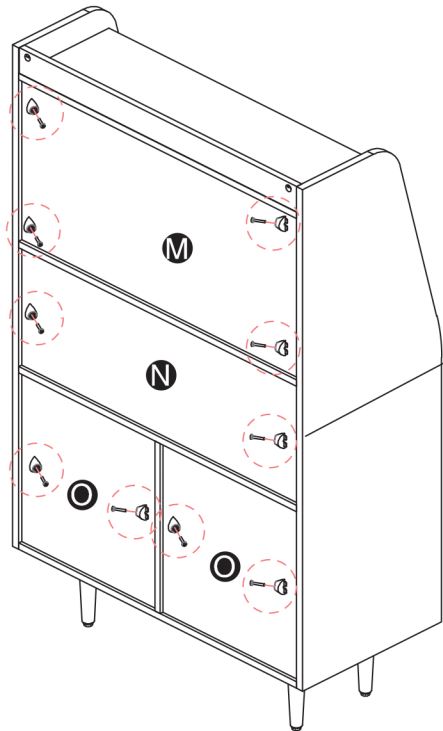

16

Accessory A9 x 1PC

Accessory A10 x 1PC

Accessory A11 x 1PC

Accessory A12 x 1PC

Accessory A13 x 2PCS

Accessory A14 x 1PC

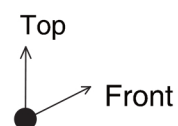
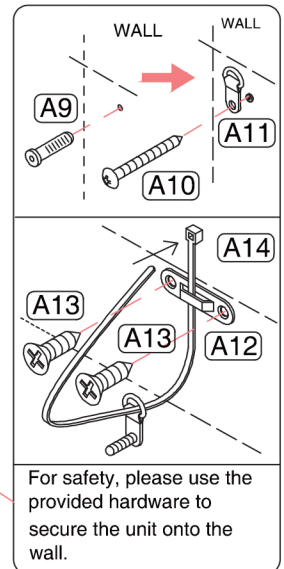
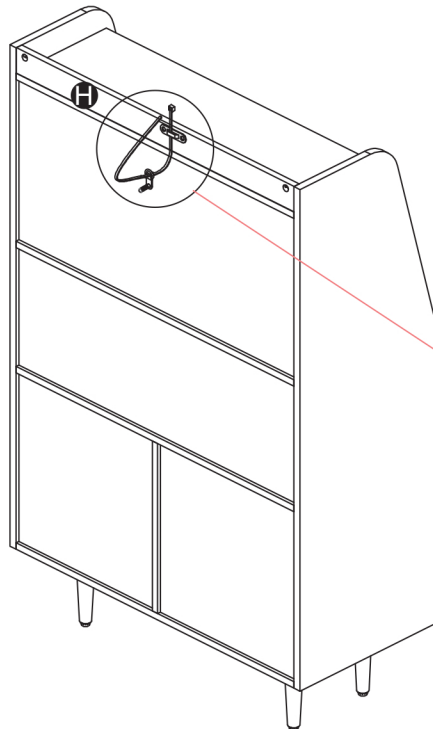

ASSEMBLY INSTRUCTIONS

17

ASSEMBLY COMPLETED



Please ensure the furniture rests on an even and flat surface. If the product wobbles or feels loose, double-check all bolts and/or screws are properly tightened and secured.



Keep this handy!

Please retain this instruction manual and any order-related information for future reference.



Moving The Furniture

Please have 2 people help lift the product during transport to the designated area.

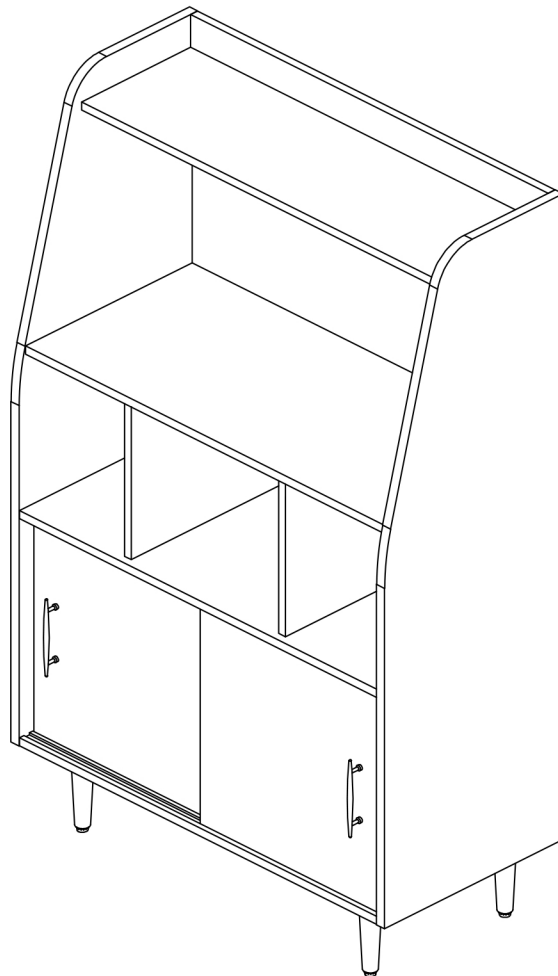

ASSEMBLY INSTRUCTIONS

Wall Mounting and Fixing



EXPANSION WALL ANCHOR

Our provided expansion wall anchors are only suitable for masonry walls, such as drywall, plaster or concrete, and are best for holding lightweight items or for anti-tip prevention. If you are unsure of the correct wall anchor to use with the product, please request professional guidance. Liability for product damage or failure due to using the incorrect anchors will fall on the installer.

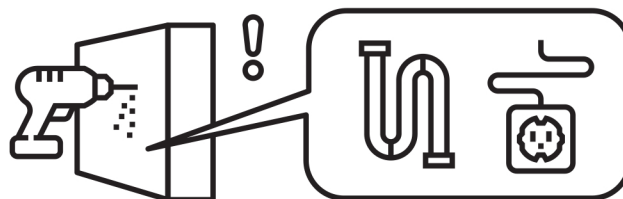

CHECK BEFORE PROCEEDING

Prior to drilling or hammering, please check for wires or pipes. We recommend using a stud finder to locate a stud, which will offer more appropriate resistance and hold more weight.

QUICK TIPS

1. If unsure of the proper size, always choose a larger screw and wall anchor.

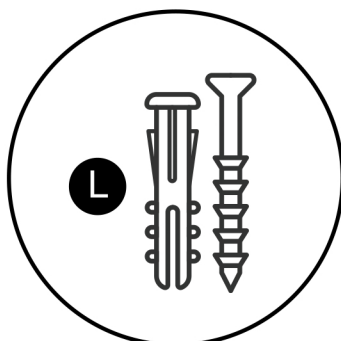

2. Match the drill bit to the wall anchor and hole size.

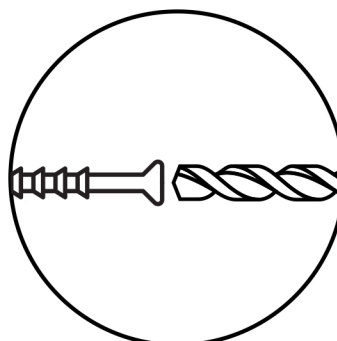

3. Only drill horizontally. Do not force the drill or enlarge the hole for the wall anchor.

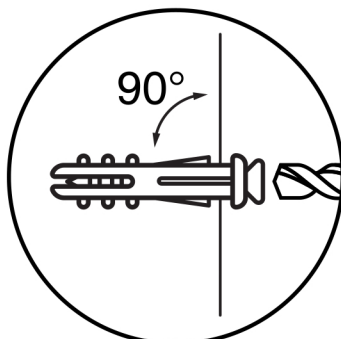

4. Take extra care when drilling into high walls or ceramic tiles. Wall anchors should be a tight fit for the hole. Never use wall anchors in ceilings.

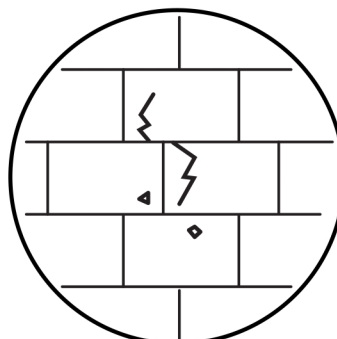

MAINTENANCE



We recommend a yearly check to see if the wall anchor or screw has loosened. If so, please remove the existing wall anchor and screw, and use a new anchor.