



**Liberty Furniture**  
INDUSTRIES, INC

# LIBERTY FURNITURE

## ASSEMBLY INSTRUCTION

ITEM # 607/507/407-BR01/BR02/BR90

607/507/407-BR03/BR04/BR90 DESCRIPTION Poster Bed

Thank you for purchasing this quality product. Be sure to check all packing materials carefully for small parts which may have come loose inside the carton during shipment. Identify and count all parts and compare with the parts List Below.

### Assembly steps:

Step 1. Assemble Footboard Leg (D) to Footboard (C).

Step 2. Assemble Finial (I) to Footboard (D) and Headboard (A).

Step 3. Assemble the Cross bar (H) to the Posts (L/R) (B) using Bolt (e), spring washer (f), flat washer (g) and allen key (h).

Step 4. Assemble the Posts (B) to the Headboard (A) using Bolt (e), spring washer (f), flat washer (g) and allen key (h).

Step 5. Assemble the Side rails (E) to the Posts (B) and Footboard (C) using set-screw (a), washer (b), nut (c) and wrench (d).

Step 6. Attach the Slat support (G) to the Slat (F)

Step 7. Screw slats (F) in place using screws (j).

### PARTS LIST

NO.	SKETCH	DESCRIPTION	Q'TY
A		Headboard	1pc
B		Post (L/R)	2pcs
C		Footboard	1pc
D		Footboard leg	2pcs
E		Side Rails	2pcs
F		Slats	Queen King 3pcs
G		Slat support	Queen King 3pcs 6pcs
H		Cross bar	1pc
I		Finial	4pcs

### HARDWARE LIST

NO.	SKETCH	HARDWARE	Q'TY
a		5/16"x18x2-3/4"	8pcs
b			8pcs
c		5/16"	8pcs
d		12 mm	1pc
e		5/16"x18x1-3/4	8pcs
f		5/16"x12 mm	8pcs
g		5/16"x19 mm	8pcs
h		4 mm	1pc
i		Ø8x30 mm	4pcs
j		#8x1"	6pcs

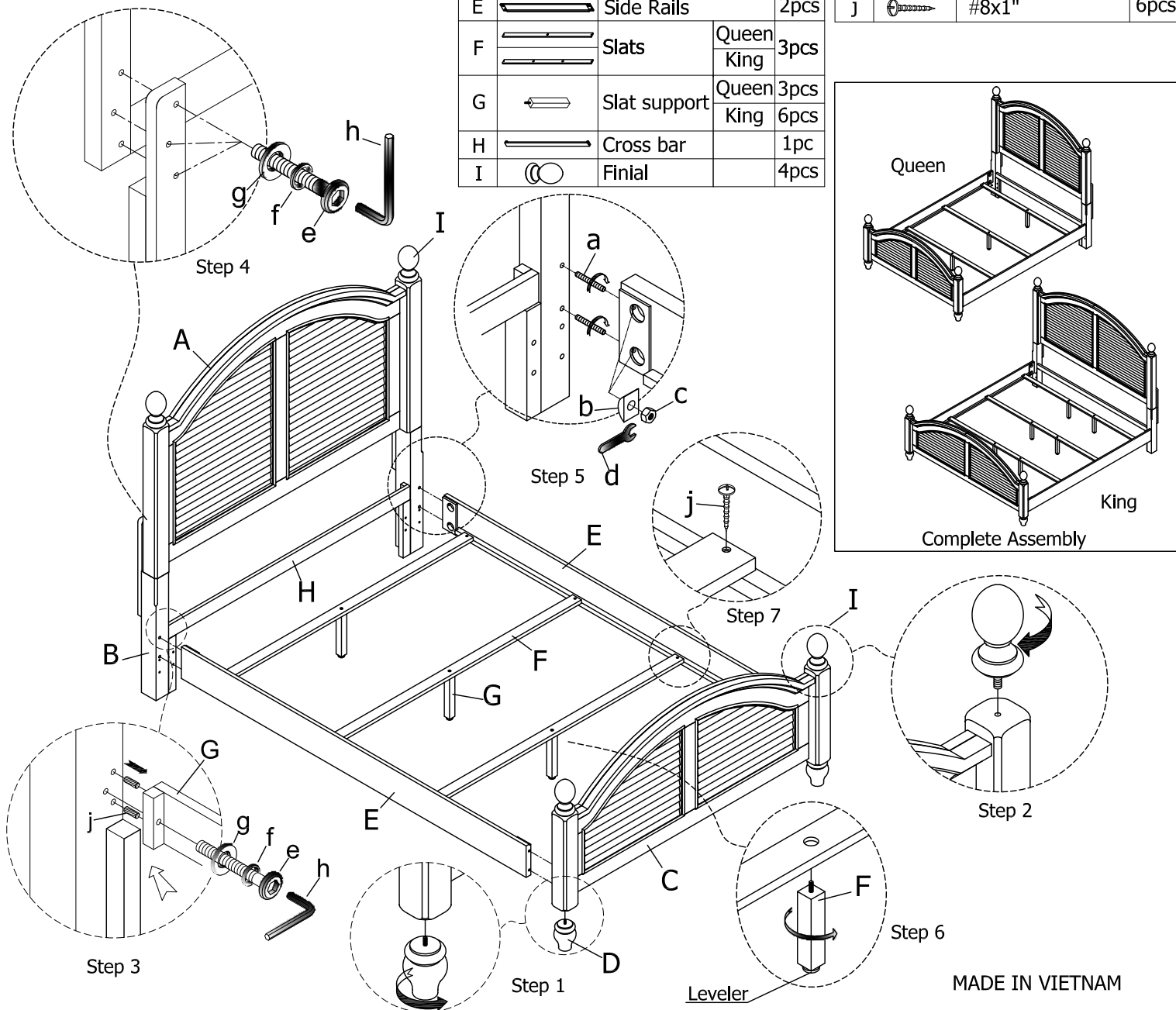

MADE IN VIETNAM