

ASSEMBLY INSTRUCTIONS

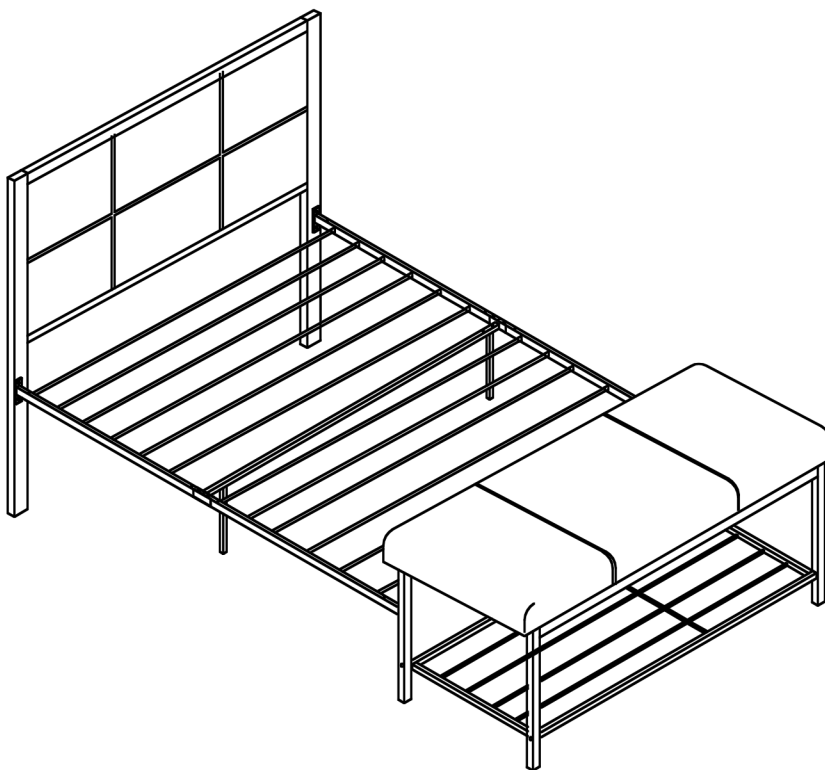

TOOLS REQUIRED



Allen Wrench

(Included)



Phillips
Screwdriver

(Not Included)



2 - Persons
Recommended

ASSEMBLY RATING



EASY ————— DIFFICULT

The Assembly Rating is a 5-point system showing the level of effort needed to assemble a specific product.



CHECK BEFORE STARTING

☐

Are you missing anything?

Double-check all parts, hardware and accessories listed on Page 6 are accounted for.

☐

Check out our Quick Tips!

We recommend reviewing the pre-assembly handouts. Even experts need a refresher now and then!

☐

Should we send any replacements?

Are there any irregularities or flaws in the parts? We can send replacements!

☐

Prep Time!

Please review the assembly instructions and all diagrams prior to assembling. Arrange parts as recommended on Page 7 and group identical hardware together to make assembling easier.

PRE ASSEMBLY INTRODUCTION

We understand building ready-to-assemble furniture can be a challenging experience for some. To help avoid confusion, we have provided some helpful tips that may speed up the process.

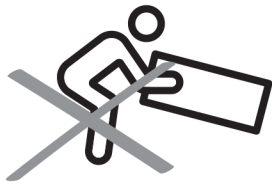

Teamwork

ALWAYS have at least two people to help with transporting and assembling the product to avoid potential injury and/or damage.

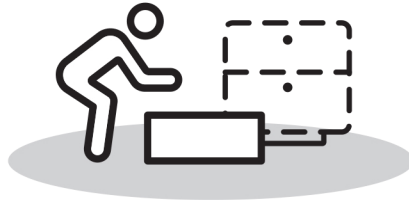
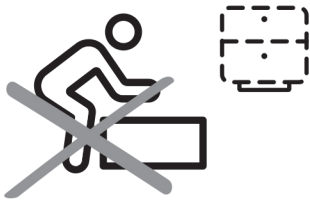

Suitable Location

Assembling near the area of the intended location is highly recommended.



Sufficient Space

Make sure you have enough space to move around during the assembly.



Avoid Scratches

Use cardboard, blankets or a carpeted area while assembling furniture to prevent scratches.

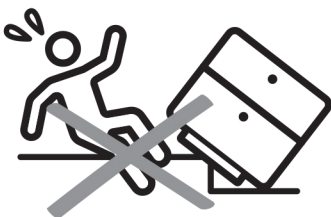

Flat Surface

Make sure the furniture rests on a flat and level surface with each leg evenly touching the floor.

ASSEMBLY AND CARE ADVICE



**FAILURE TO FOLLOW THE GUIDELINES BELOW MAY
RESULT IN INJURY AND/OR PROPERTY DAMAGE.**



Position each part correctly
and insert screws or bolts into
their respective holes.

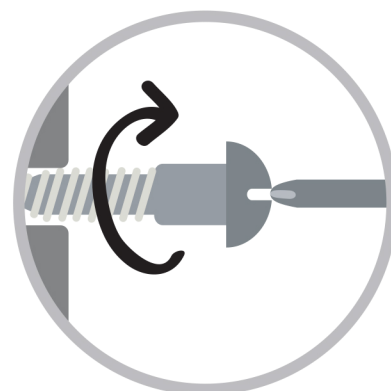

Turn clockwise to tighten and
only tighten when step is
completed or when instructed
to do so.



Use the appropriate hand tools
or power tools for assembly.
Select steps, such as tightening
screws and/or bolts, may require
hand tools to avoid causing
damage during assembly.



Save the instructions and store
any supplied tools for later
maintenance.

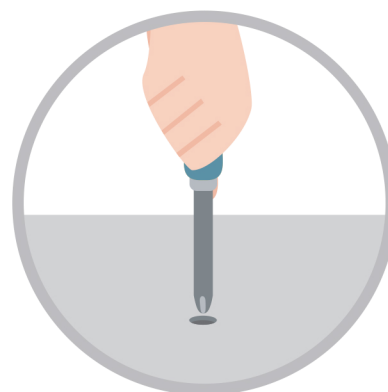

After two weeks, check and
tighten any loose hardware and
repeat again every six months
thereafter.

IT IS THE USER'S RESPONSIBILITY TO MAINTAIN THE FURNITURE. THE HARDWARE MAY LOOSEN OVER TIME AND MAY CAUSE THE FURNITURE TO BE WOBBLY AND UNABLE TO SUPPORT ITS INTENDED WEIGHT CAPACITY. THIS MAY LEAD TO COLLAPSE AND MAY CAUSE SERIOUS INJURY.

BED



- Please keep instructions for future reference.
- Check the quantity and irregularity of parts and hardware before you start.

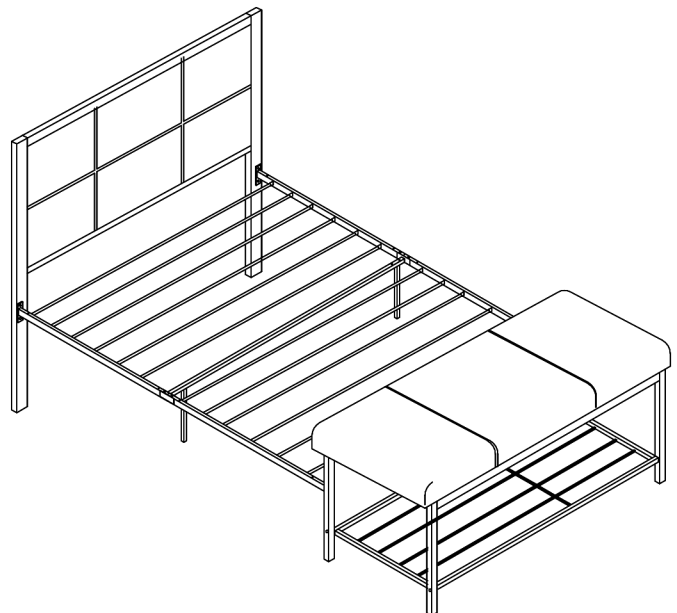

PARTS

#1 1pc



Headboard
Left Support

#2 1pc



Headboard
Right Support

#3 2pcs

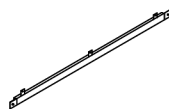

Headboard
Cross-bar

#4 2pcs

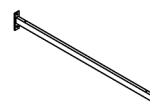

Bed Rail A

#5 2pcs

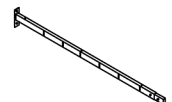

Bed Rail B

#6 1pc



Bench Leg A

#7 1pc



Bench Leg B

#8 1pc



Bench Leg C

#9 1pc



Bench Leg D

#10 1pc



Shelf frame

#11 1pc

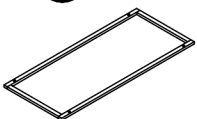

Seat support frame

#12 1pc

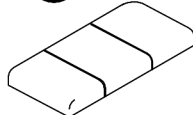

Seat Cushion

#13 1pc



Rail Center Support

#14 2pcs



Support Leg

#15 12pcs



Bed Slat

#16 4pcs

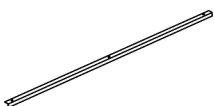

Rail Reinforce

#17 1pc

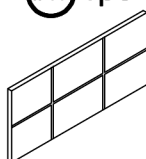

Headboard Panel

BED



- Please keep instructions for future reference.
- Check the quantity and irregularity of parts and hardware before you start.

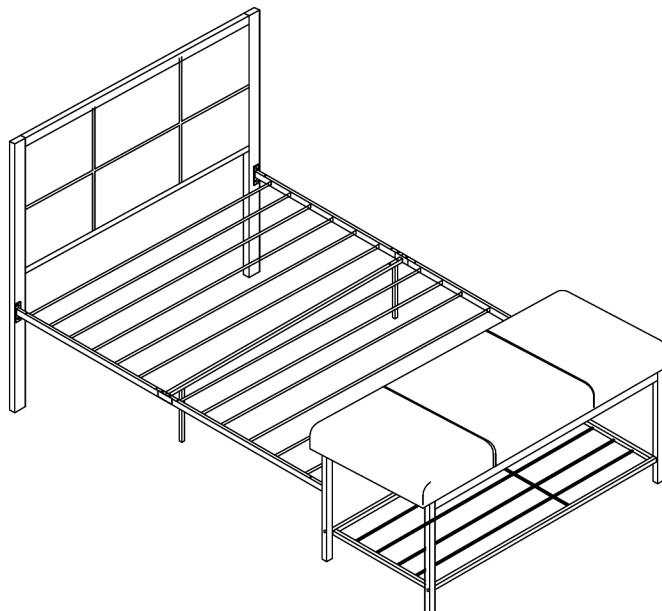

HARDWARE

#A 36pcs



Bolt 1/4" x 3/8"

#B 4pcs



Bolt 1/4" x 1"

#C 4pcs



Bolt 1/4" x 2"

#D 4pcs



Bolt M8 x 2"

#E 6pcs



Bolt M6 x 3/4"

#F 6pcs

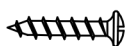

Screw M5X1- 1/4"

#G 4pcs



Nut M8

#H 1pc



Allen Wrench M4

#I 1pc



Allen Wrench M5

#J 1pc

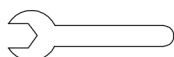

Wrench M5

ASSEMBLY INSTRUCTIONS

1

- Part #1 × 1pc
- Part #2 × 1pc
- Part #3 × 2pcs
- Hardware #A × 8pcs

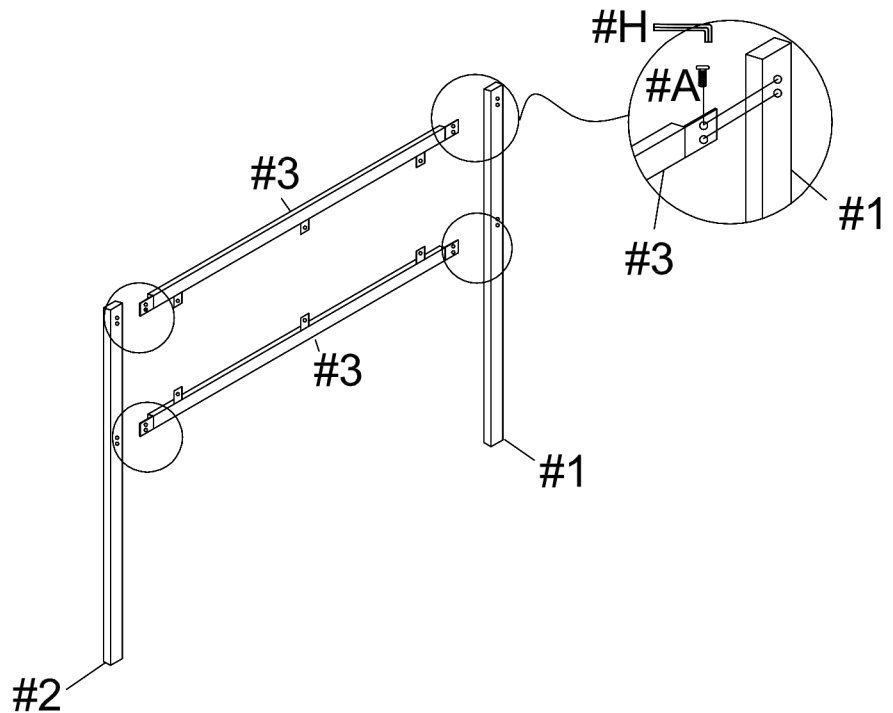

2

- Part #19 × 1pc
- Hardware #E × 6pcs

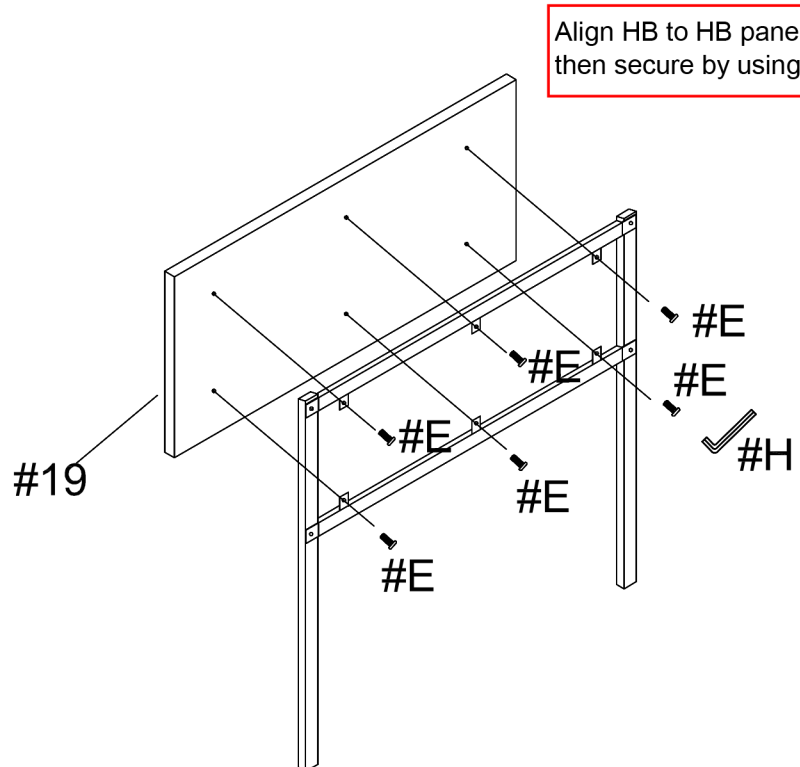

ASSEMBLY INSTRUCTIONS

3

Part (#4) × 1pc

Part (#5) × 1pc

Hardware (#A) × 4pcs

Align bed rails (#4,5) to the headboard, then secure by using bolts (#A).

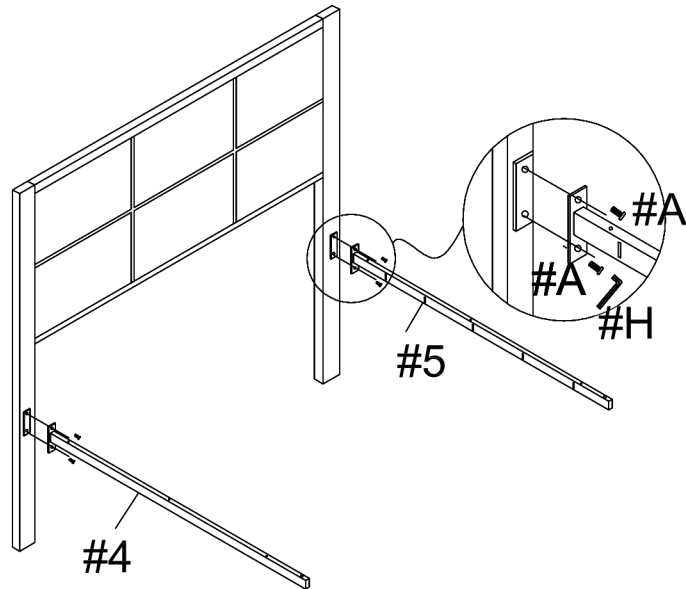

4

Part (#6) × 1pc

Part (#7) × 1pc

Part (#8) × 1pc

Part (#9) × 1pc

Part (#11) × 1pc

Hardware (#A) × 8pcs

Align bench legs (#6,7,8,9) to the seat support frame (#11) just like how it's shown in the diagram. Secure by using bolts (#A).

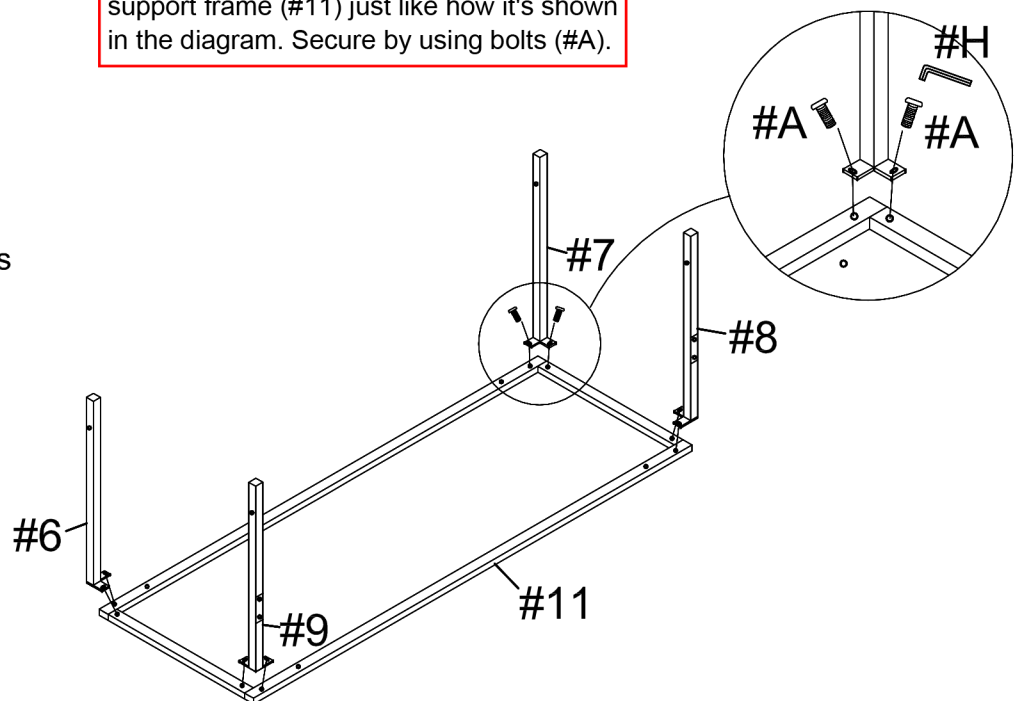

ASSEMBLY INSTRUCTIONS

5

Part #10 ×1pc

Hardware #C ×4pcs

Align shelf frame (#10) to the legs, then secure by using bolts (#C).

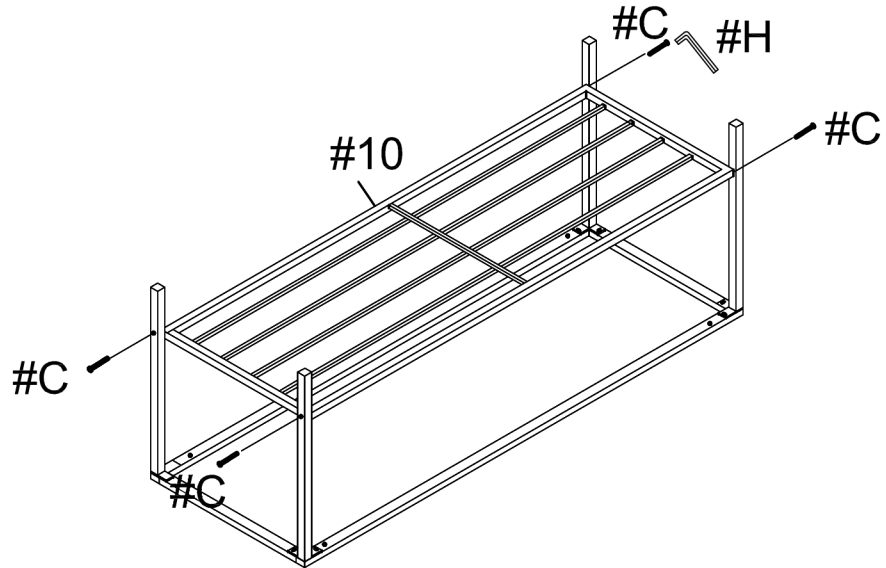

6

Part #12 ×1pc

Hardware #F ×6pcs

Align bench frame to seat cushion (#12), then secure by using screws (#F). There will be no pre-drilled holes of the seat cushion (#12).

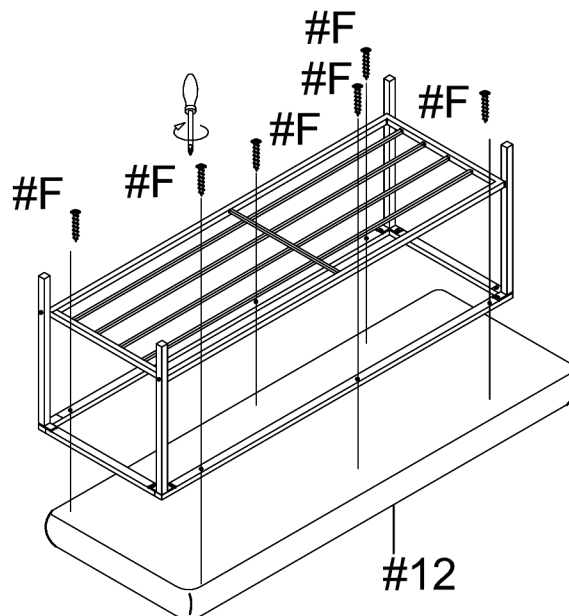

ASSEMBLY INSTRUCTIONS

7

Part #4 ×1pc

Part #5 ×1pc

Hardware #A ×4pcs

Align bed rails (#4,5) to the bench, then secure by using bolts (#A).

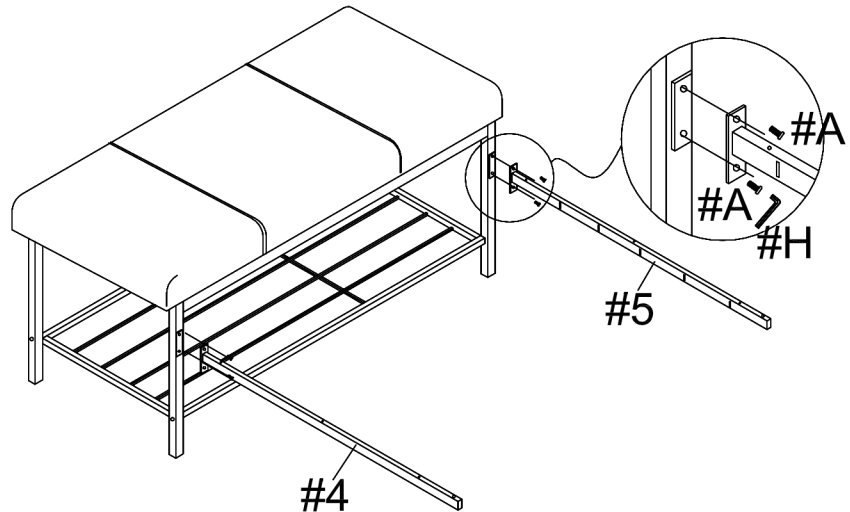

8

Part #13 ×1pc

Part #14 ×2pcs

Hardware #B ×4pcs

Align support legs (#14) to the rail support (#13), then secure by using bolts (#B).

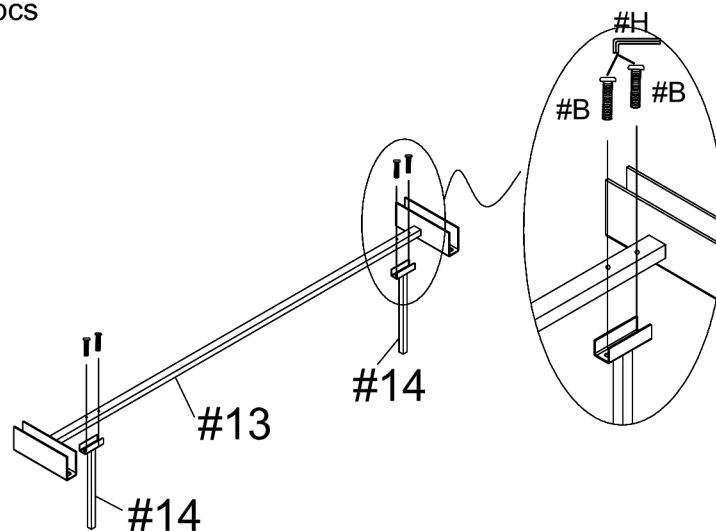

ASSEMBLY INSTRUCTIONS

9

Hardware (#D) × 2pcs

Hardware (#G) × 2pcs

Hardware (#I) × 1pc

Hardware (#J) × 1pc

Align rail support to the bed rails, then secure by using bolts (#D) to nuts (#G).

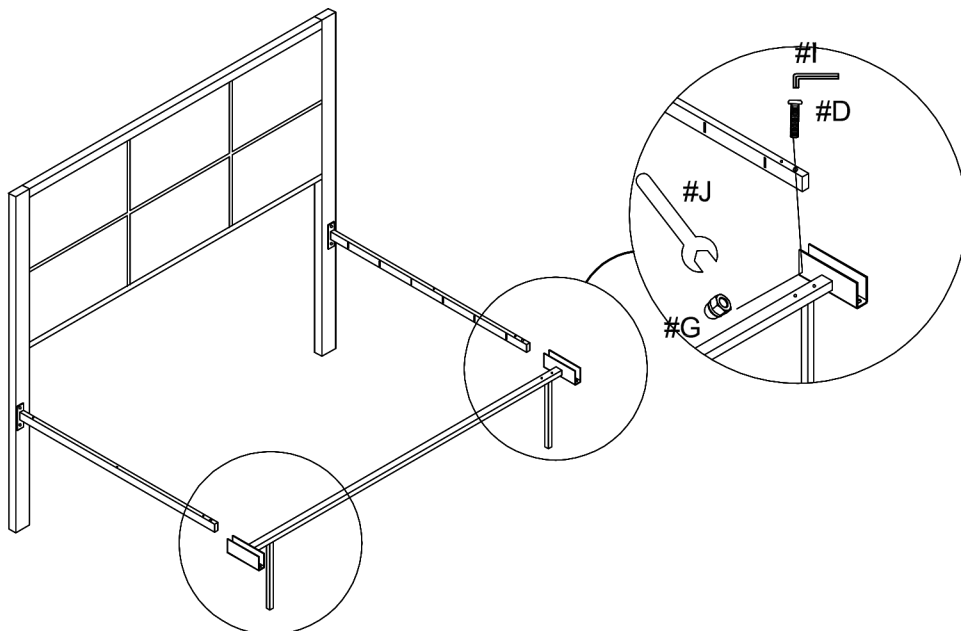

10

Hardware (#D) × 2pcs

Hardware (#G) × 2pcs

Hardware (#I) × 1pc

Hardware (#J) × 1pc

Align bed rails to rail supports, then secure by using bolts (#D) to nuts (#G).

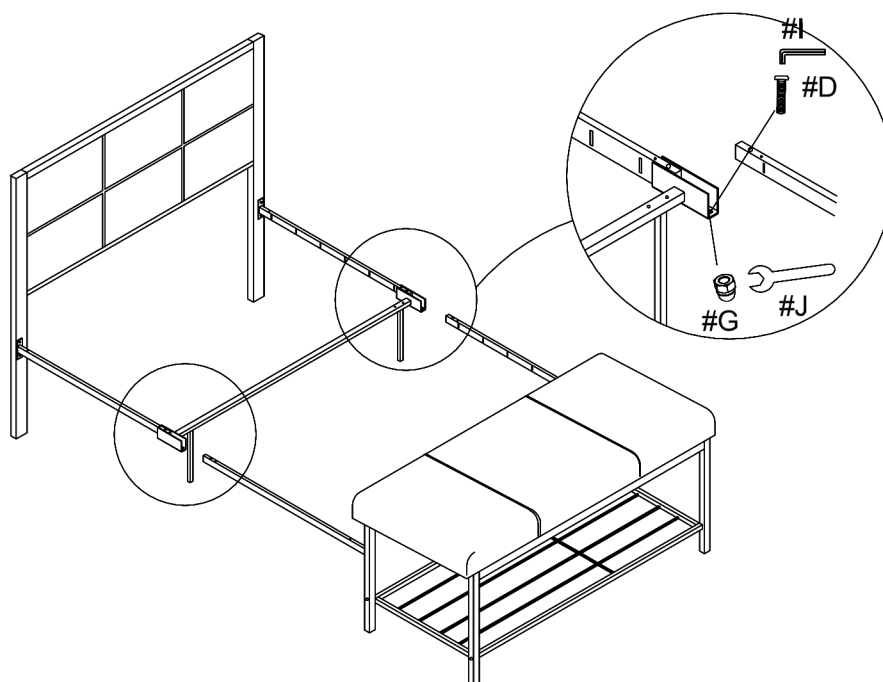

ASSEMBLY INSTRUCTIONS

Align and attach slats (#15) to bed rails.

11

Part #15 × 12 pcs

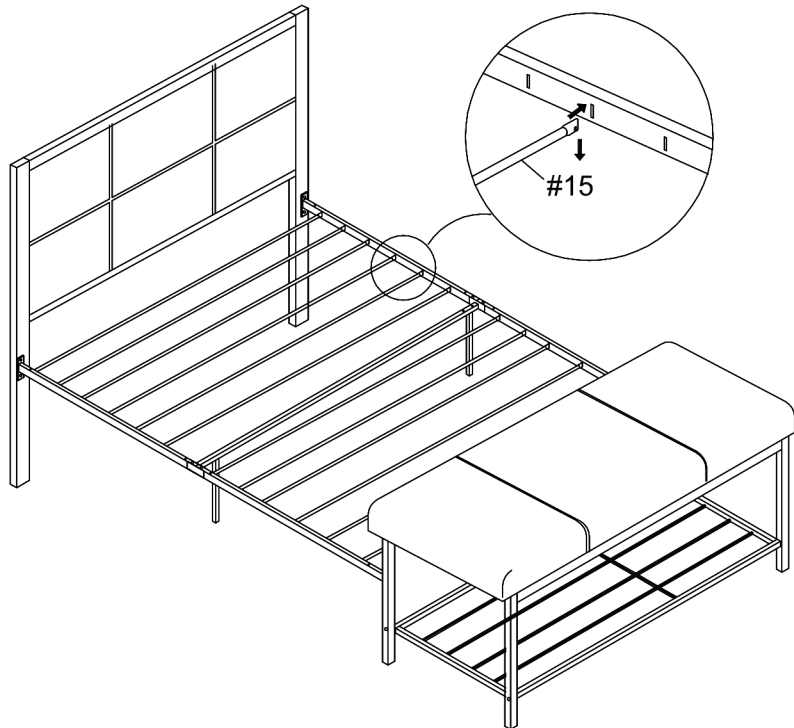

12

Part #16 × 4 pcs

Hardware #A × 12 pcs

Align rail reinforce (#16) to the bed rails, then secure by using bolts (#A).

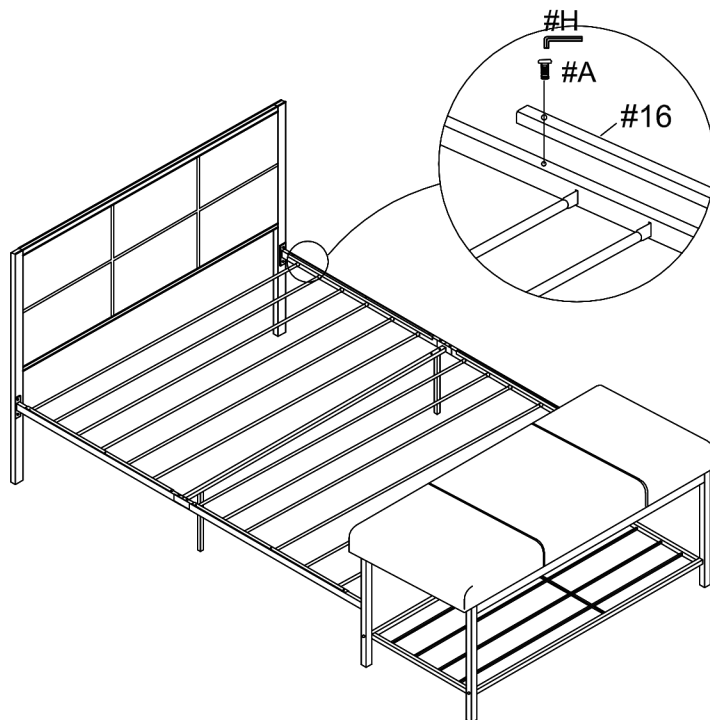

ASSEMBLY COMPLETED



Please ensure the furniture rests on an even and flat surface. If the product wobbles or feels loose, double-check all bolts and/or screws are properly tightened and secured.



Keep this handy!

Please retain this instruction manual and any order-related information for future reference.