



MANHATTAN
COMFORT

888-230-2225

help@manhattancomfort.com



Astor Panel 70.86

Model # 223BMC1, 223BMC12, 223BMC2, 223BMC21,
223BMC6, 223BMC8, 223BMC9, 223BMC94

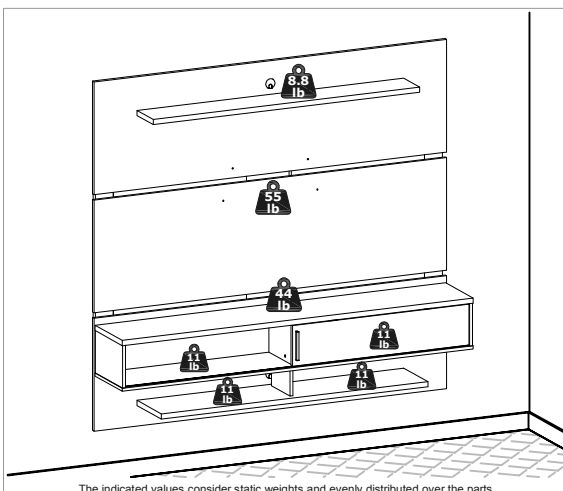

INCLUDED IN THE PACKAGE

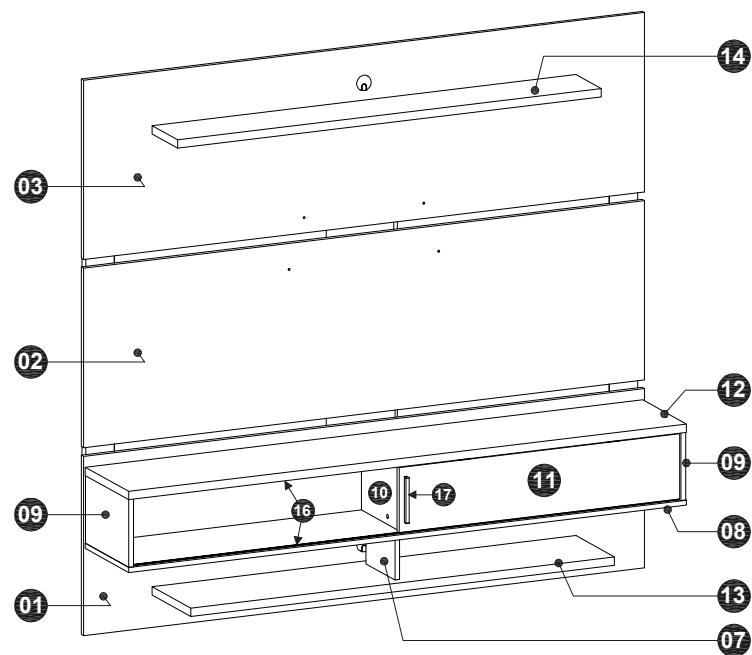

REAR VIEW

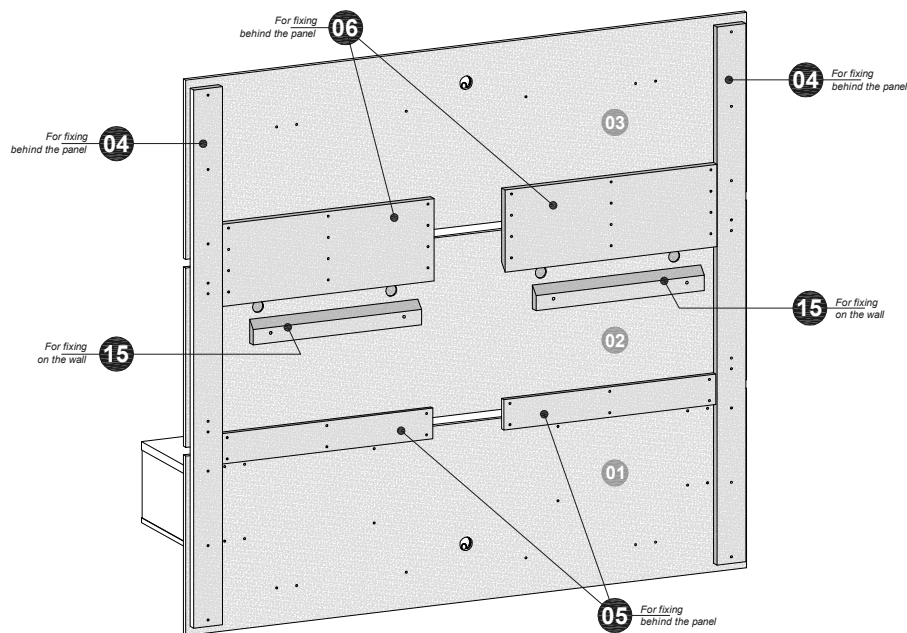

n.° ID	Parts Identification (Description)	Quantity
01	Lower Panel	1
02	Middle Panel	1
03	Upper Panel	1
04	Rear Column	2
05	Lower Rear Bar	2
06	Upper Rear Bar	2
07	Lower Support	1
08	Base of the niche	1
09	Side Panel of the niche	2
10	Partition of the niche	1
11	Sliding Door	1
12	Middle Shelf	1
13	Lower Shelf	1
14	Upper Shelf	1
15	Bar for wall	2
16	Plastic rail profile 1755mm	2
17	Handle 128mm	1

TOOLS NEEDED

Simple and phillips screwdriver.



Simple hammer.



Measuring tape.



Level indicator.



Drilling machine and electric screwdriver with drill bit Ø1/2 inch and phillips tips.



! IMPORTANT! Two people are needed to assemble this product.

INCLUDED IN THE PACKAGE

A 30x



B 40x

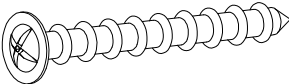

C 12x

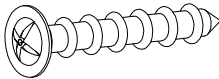

D 18x

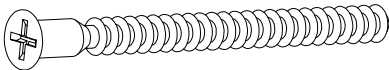

E 6x

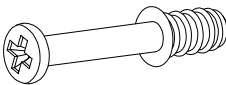

F 6x

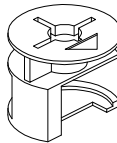

G 6x

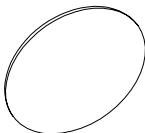

H 4x

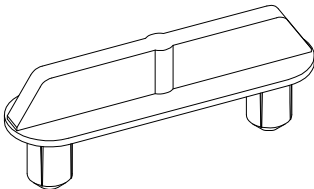

I 2x



J 2x

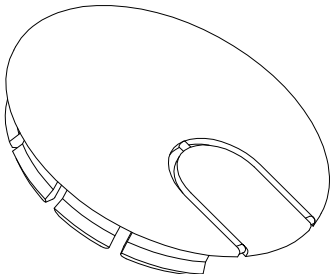

K 4x

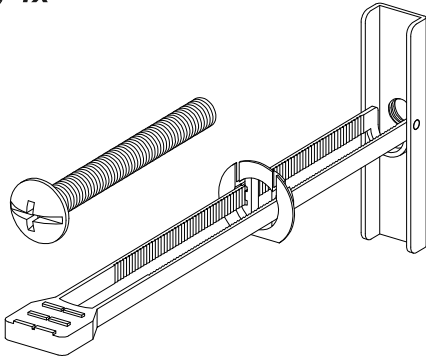

STEP 1

- Line the floor with the foam mantle of the packing to protect the parts and arrange the Panels (01), (02) and (03) with the rear face upwards, correctly checking the position of each according the holes and as shown in the drawing.

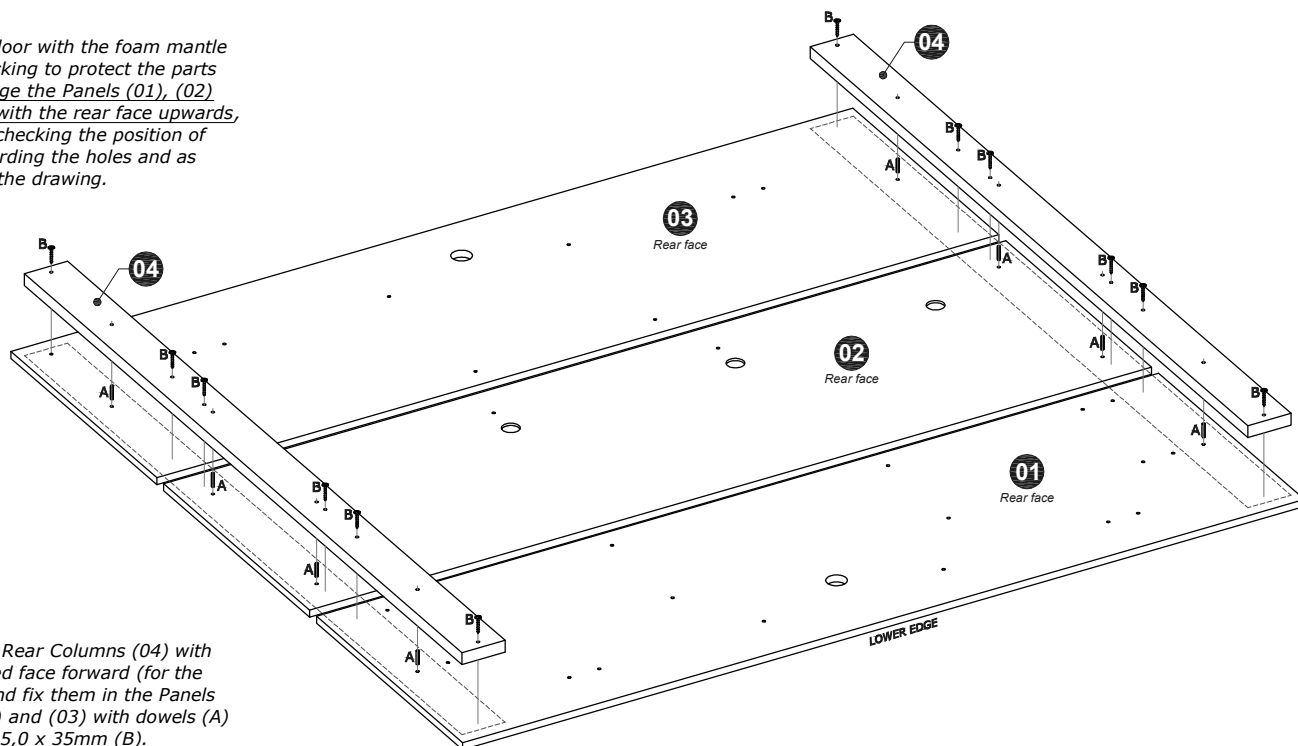

- Place the Rear Columns (04) with the painted face forward (for the panels) and fix them in the Panels (01), (02) and (03) with dowels (A) and bolts 5,0 x 35mm (B).

STEP 2

- Fix the Upper Rear Bars (06) behind the Panels (02) and (03) with bolts 5.0 x 35mm (B) in the positions shown in the drawing and with the beveled edge down and forward.

- Fix the Lower Rear Bars (05) behind the Panels (01) and (02) with bolts 5.0 x 25mm (C) in the positions shown in the drawing and with the painted face forward.

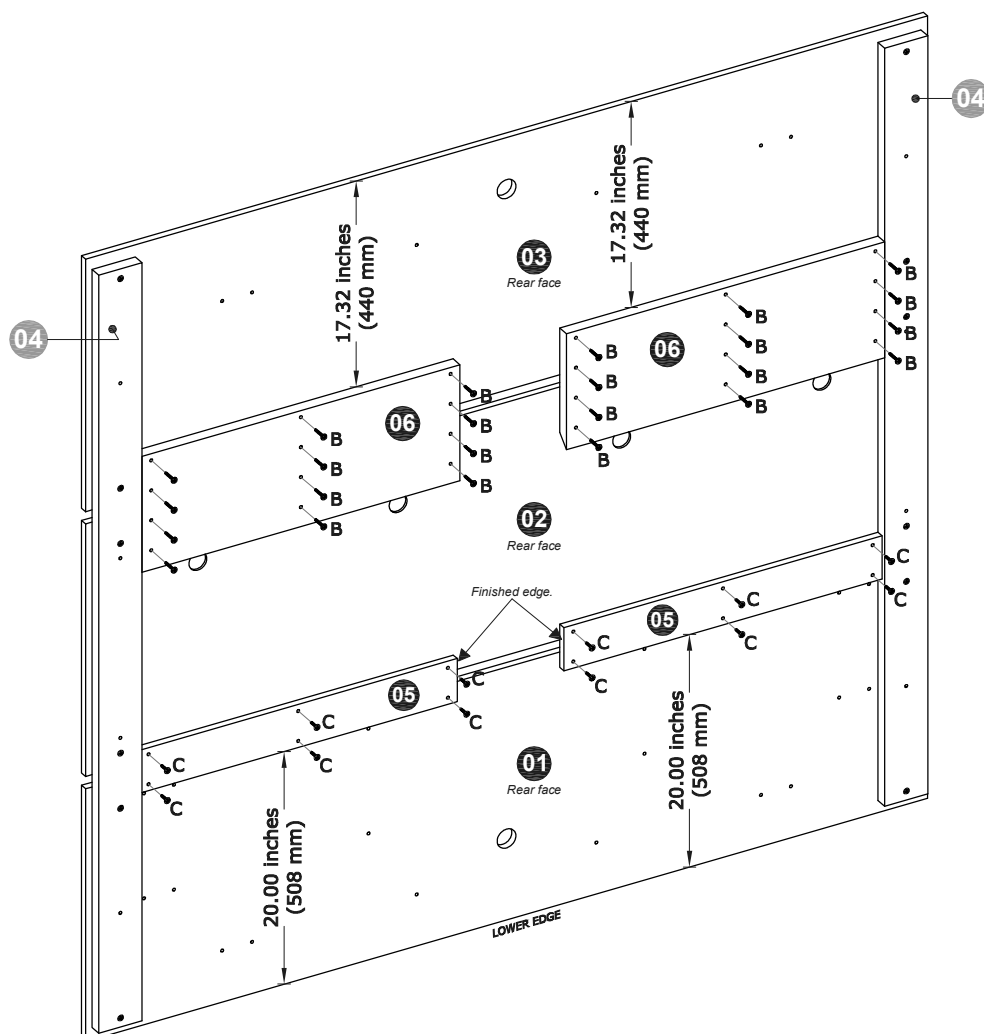

STEP 3

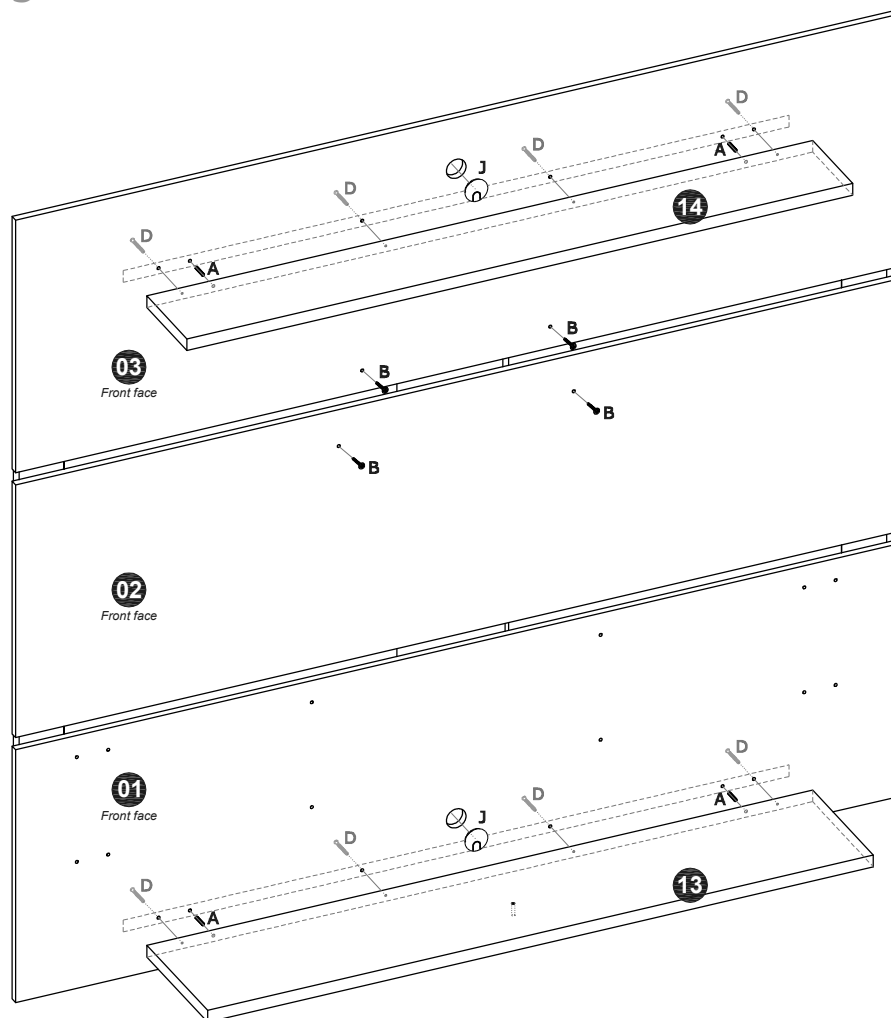

- Finish the fixing of the Upper Rear Bars (06) in the Panels (02) and (03) applying the four bolts (B) shown in the drawing.
- Fix the Lower Shelf (13) in the Lower Panel (01) with dowels (A) and bolts 5.0 x 50mm (D).
- Fix the Upper Shelf (14) in the Upper Panel (03) with dowels (A) and bolts 5.0 x 50mm (D).
- Insert the plastic cover (J) into the holes for pass wires in the Lower Panel (01) and in the Upper Panel (03).

STEP 4

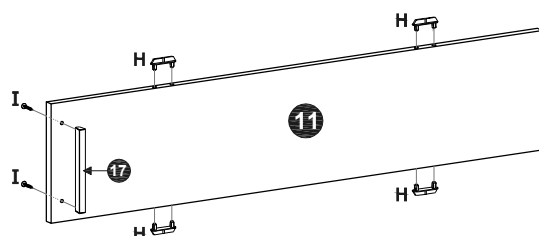

Preparing the Sliding Door (11):

- Apply the plastic guides (H).
- Choose the outer face of the Door (11) and fix the handle (17) with bolts 3.5 x 25mm (I).

STEP 5

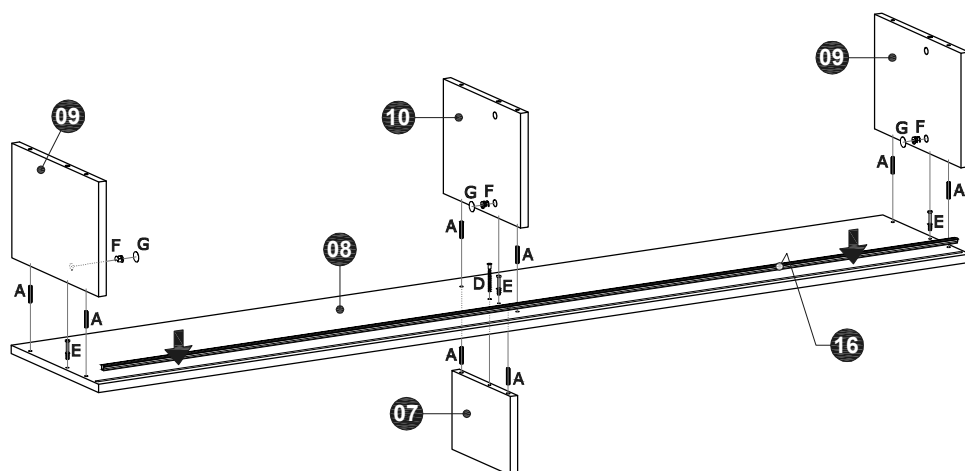

Preparing/Fixing the parts (07), (08), (09) and (10):

- Fix the Lower Support (07) under the Base of the niche (08) with dowels (A) and bolt 5.0x50mm (D).
- Fix the Side Panels (09) and the Partition (10) on the Base of the niche (08) with dowels (A) and Minifix hardware (E + F). At the end of the fixing, apply the adhesive covers (G).
- Insert the plastic rail (16) into the channel in the Base (08).

STEP 6

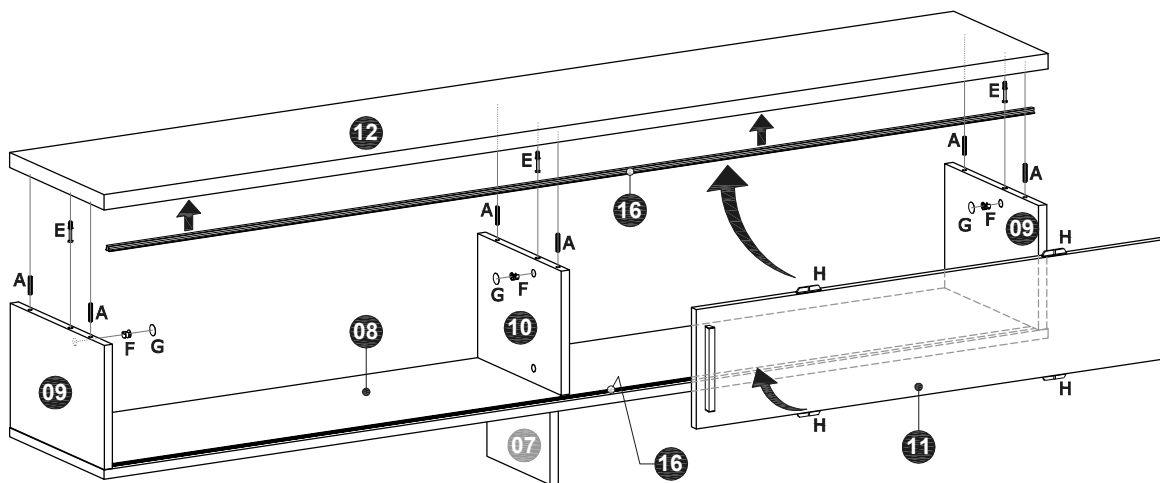

Installing the Sliding Door (11) and fixing the Middle Shelf (12):

- Insert the plastic rail (16) into the channel under the Middle Shelf (12).
- Insert the dowels (A) in the Side Panels (09) and in the Partition (10) and the Minifix bolts (E) in the Middle Shelf (12).
After that, fit the parts together.
- Install the Sliding Door (11) by attaching the guides (H) in the rails (16) in the Base (08) and in the Middle Shelf (12).
- Finish the fixing the Middle Shelf (12) to the Side Panels (09) and to the Partition (10) with dowels (A) and Minifix hardware (E + F), and finally apply the adhesive covers (G).

STEP 7

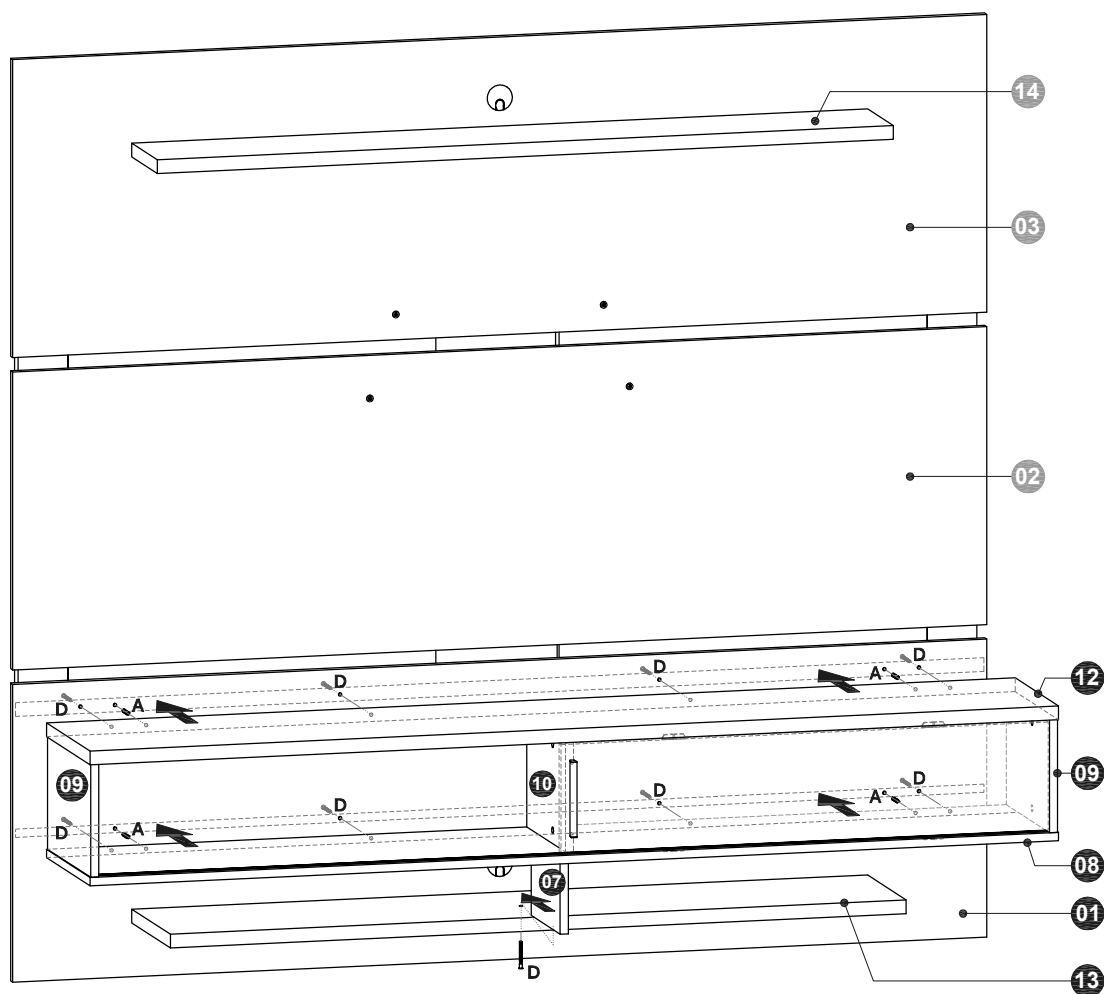

- *Install the niche [parts (07), (08), (09), (10), (11) and (12), assembled in the STEP 6], positioning it on the Lower Shelf (13) and fixing the Base (08) on the Middle Shelf (12) on the Lower Panel (01) with dowels (A) and bolts (D).*
- *Apply bolt (D) to fix the Lower Shelf (13) in the Lower Support (07).*

STEP 8

ATTENTION!

Before installing the panel, check the conditions of the wall for strength to properly support and anchor the weight of the suspended furniture, including equipment and objects that may be fixed to the panel.

The Kap Toggle bushings (K) supplied with the product are for hollow walls or dry wall type.

Check the type of wall on which the installation will be made and, if necessary, look for more suitable bushings or fastening systems.

To mark the position and fix the Bars (15) on the wall, check the level of the parts.

- Mark the position of the holes on the wall to fix the Bars (15), as shown in the drawing and using the bars themselves as reference.

- With drilling machine and drill bit $\varnothing 1/2$ inch, make the holes in the wall.

- Apply the bushings (K) into the holes in the wall and fix the Bars (15) with the bevelled edge facing up and to the wall, applying the bolts $1/4 \times 2.1/4$ " as indicated in the drawing.

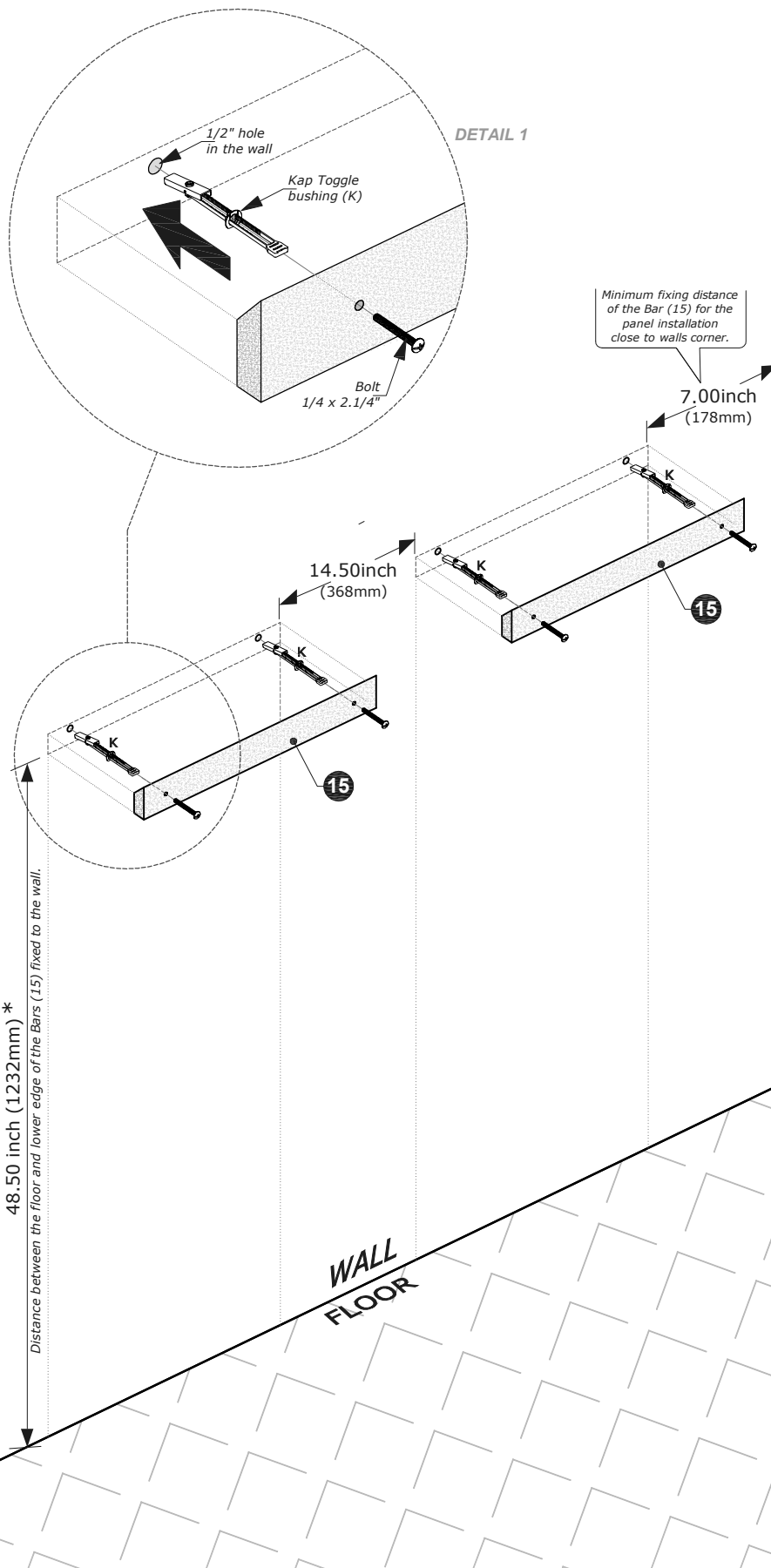

*The height of 48.50 inches (1232mm) indicated in the drawing, between the floor and the lower edge of the Bar (15) is only suggestive to install the Panel with its lower edge at approximately 11.60 inches (295mm) from the floor.

STEP 9

- With the Panel already assembled, fit the Bars (06) fixed behind the panel in the Bars (15) fixed on the wall.

IMPORTANT!

To remove the panel from wall, move it upwards slightly so as to disengage the beveled edges of the rear bars (06) and (15) fixed behind the panel and on the wall. Before moving the panel, remove TV or other equipments or objects placed on the panel or ensure that the entire set is safe, preventing falls and damage to the furniture and to the equipments or objects .

