

ASSEMBLY INSTRUCTIONS

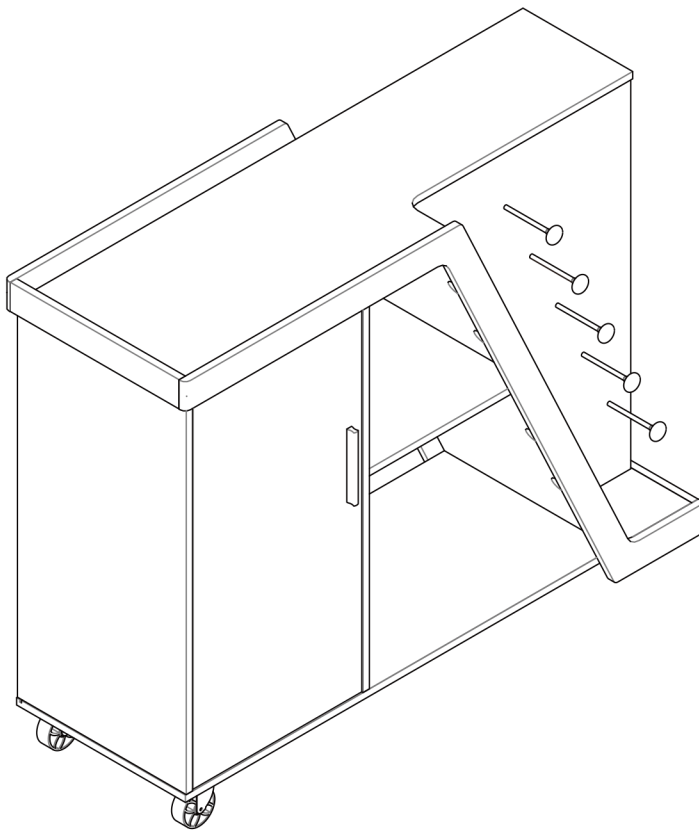

TOOLS REQUIRED



**Phillips
Screwdriver**

(Not Included)



**2 - Persons
Recommended**

ASSEMBLY RATING



EASY —————> DIFFICULT

The Assembly Rating is a 5-point system showing the level of effort needed to assemble a specific product.



CHECK BEFORE STARTING

☐

Are you missing anything?

Double-check all parts, hardware and accessories listed on Page 6 are accounted for.

☐

Check out our Quick Tips!

We recommend reviewing the pre-assembly handouts. Even experts need a refresher now and then!

☐

Should we send any replacements?

Are there any irregularities or flaws in the parts? We can send replacements!

☐

Prep Time!

Please review the assembly instructions and all diagrams prior to assembling. Arrange parts as recommended on Page 7 and group identical hardware together to make assembling easier.

PRE ASSEMBLY INTRODUCTION

We understand building ready-to-assemble furniture can be a challenging experience for some. To help avoid confusion, we have provided some helpful tips that may speed up the process.

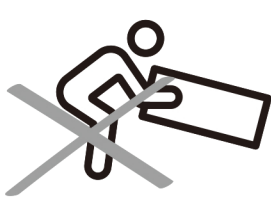

Teamwork

ALWAYS have at least two people to help with transporting and assembling the product to avoid potential injury and/or damage.

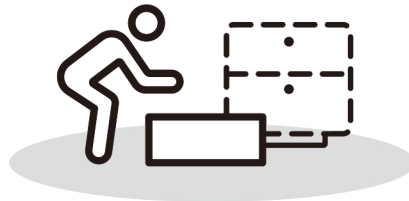

Suitable Location

Assembling near the area of the intended location is highly recommended.



Sufficient Space

Make sure you have enough space to move around during the assembly.



Avoid Scratches

Use cardboard, blankets or a carpeted area while assembling furniture to prevent scratches.

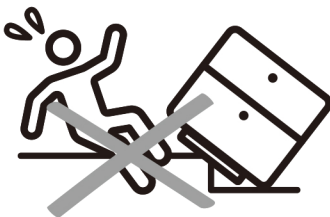

Flat Surface

Make sure the furniture rests on a flat and level surface with each leg evenly touching the floor.

ASSEMBLY AND CARE ADVICE



**FAILURE TO FOLLOW THE GUIDELINES BELOW MAY
RESULT IN INJURY AND/OR PROPERTY DAMAGE.**



Position each part correctly
and insert screws or bolts into
their respective holes.

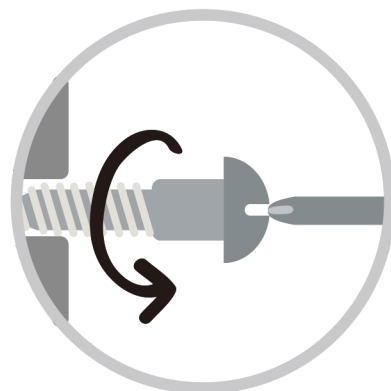

Turn clockwise to tighten and
only tighten when step is
completed or when instructed
to do so.



Save the instructions and store
any supplied tools for later
maintenance.

Use the appropriate hand tools
or power tools for assembly.
Select steps, such as tightening
screws and/or bolts, may require
hand tools to avoid causing
damage during assembly.

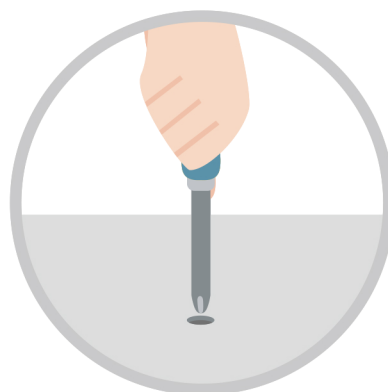

After two weeks, check and
tighten any loose hardware and
repeat again every six months
thereafter.

IT IS THE USER'S RESPONSIBILITY TO MAINTAIN THE FURNITURE. THE HARDWARE MAY LOOSEN OVER TIME AND MAY CAUSE THE FURNITURE TO BE WOBBLY AND UNABLE TO SUPPORT ITS INTENDED WEIGHT CAPACITY. THIS MAY LEAD TO COLLAPSE AND MAY CAUSE SERIOUS INJURY.

CAM LOCK FASTENER ASSEMBLY INSTRUCTIONS

Note :

Every cam lock bolt must have a cam lock connector in order to fasten the parts together.

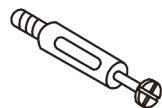

cam bolt



cam lock

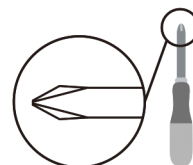

screwdriver

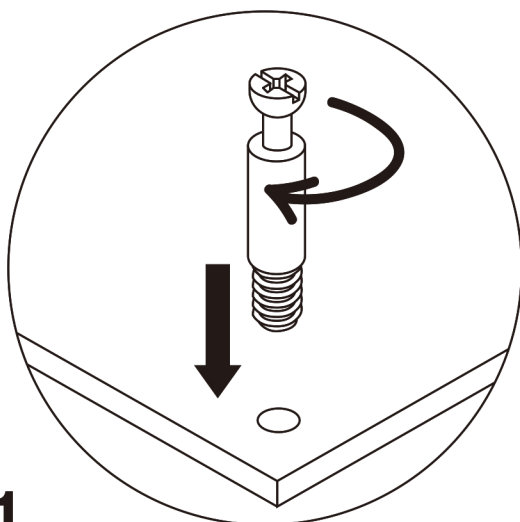

1

Screw the cam bolt into panel.

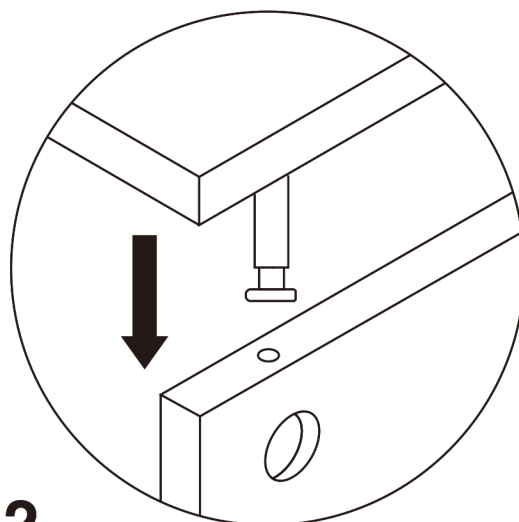

2

Insert the cam bolt into the bolt hole of joint panel.

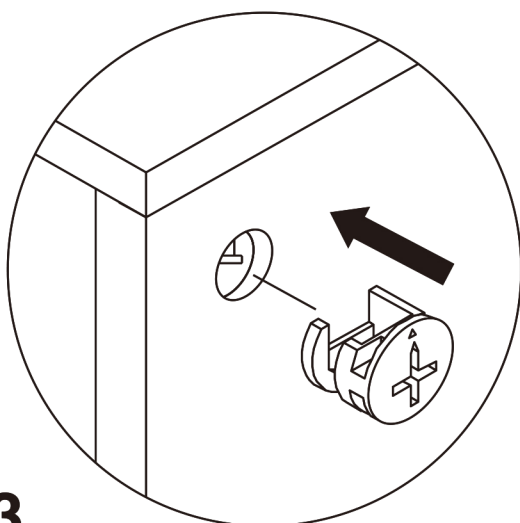

3

Align the cam lock with its side opening (or arrow) pointing to cam bolt.

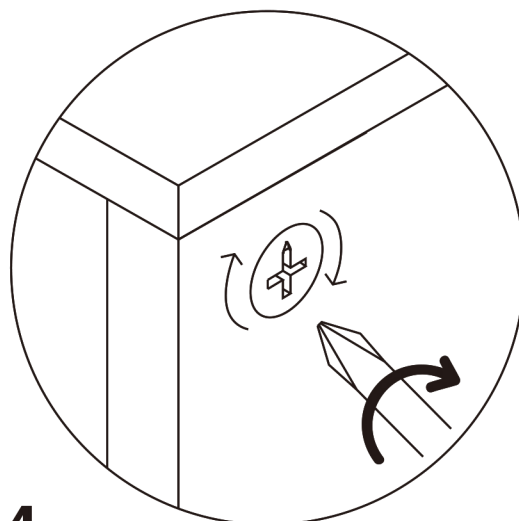

4

Turn the cam lock clockwise gently until it will not turn any more.

BUFFET TABLE

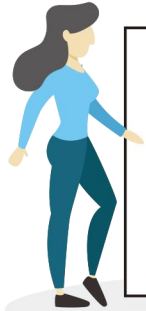

- Please keep instructions for future reference.
- Check the quantity and irregularity of parts and hardware before you start.

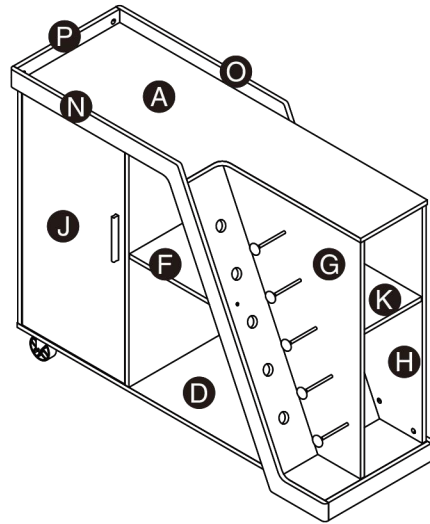

PARTS

A 1PC

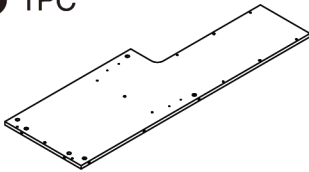

E 1PC

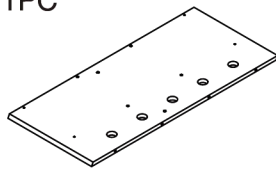

I 1PC



M 1PC

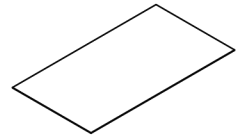

B 1PC

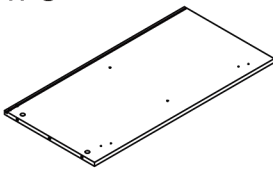

F 1PC

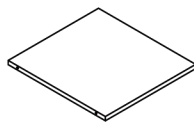

J 1PC

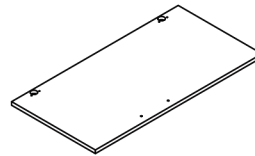

N 1PC

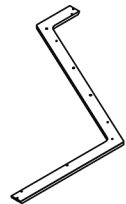

C 1PC

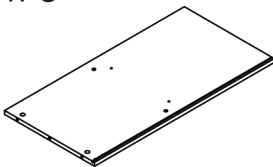

G 1PC

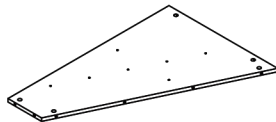

K 1PC

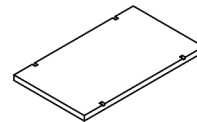

O 1PC



D 1PC

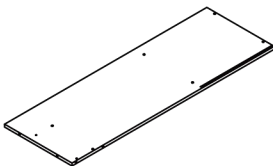

H 1PC

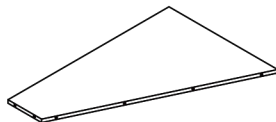

L 1PC

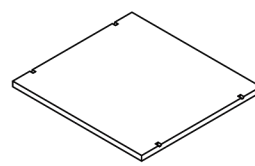

P 2PCS

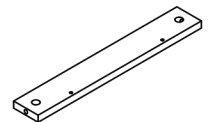

HARDWARE

① 32PCS ② 32PCS ③ 22PCS ④ 2PCS ⑤ 6PCS

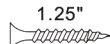
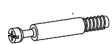

⑥ 8PCS ⑦ 2PCS ⑧ 8PCS ⑨ 5PCS ⑩ 5PCS



⑪ 5PCS ⑫ 5PCS ⑬ 4PCS ⑭ 4PCS



ACCESSORIES

A1 1PC A2 2PCS A3 1PC A4 4PCS



A5 5PCS A6 20PCS A7 1PC A8 12PCS



A9 4PCS A10 1PC



(Black)

GET READY

Please group boards as below.

Ⓐ 1PC

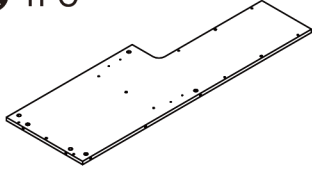

Ⓔ 1PC

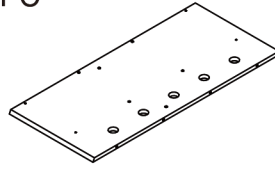

Ⓖ 1PC

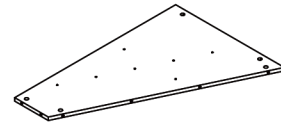

Ⓕ 1PC

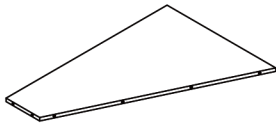

Ⓟ 1PC

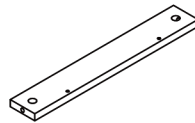

Ⓑ 1PC

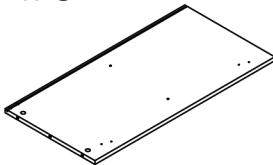

Ⓒ 1PC

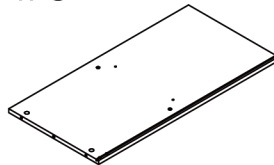

Ⓕ 1PC

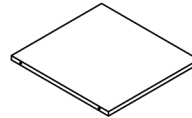

Ⓖ 1PC



Ⓓ 1PC

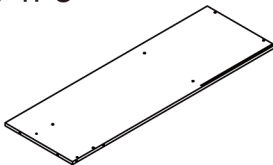

Ⓜ 1PC

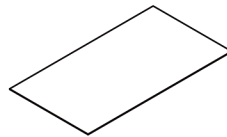

Ⓟ 1PC

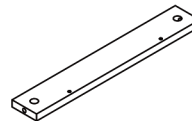

Ⓝ 1PC

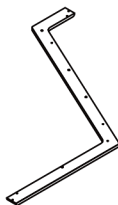

Ⓞ 1PC



Body

Ⓙ 1PC

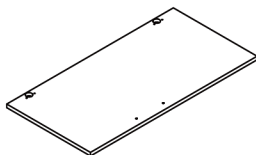

Ⓚ 1PC

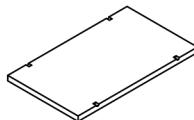

Ⓛ 1PC

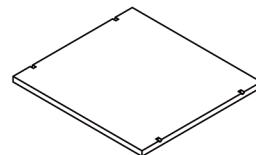

Doors
/Shelf

ASSEMBLY INSTRUCTIONS

1

Hardware ① x12PCS

Hardware ③ x8PCS

Accessory A3 x1PC

Accessory A4 x4PCS

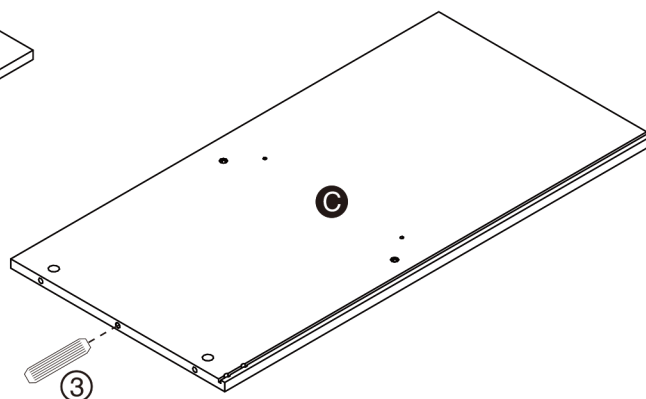
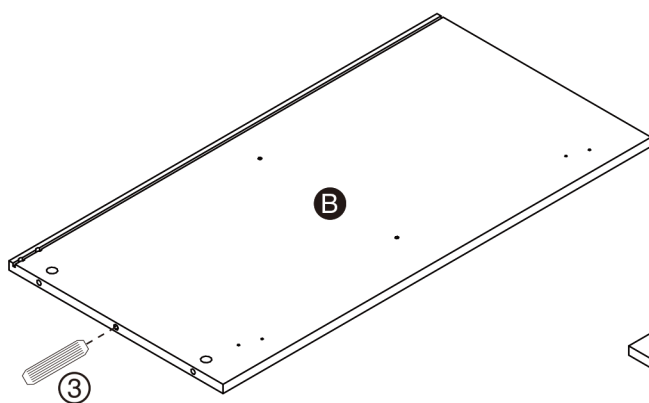
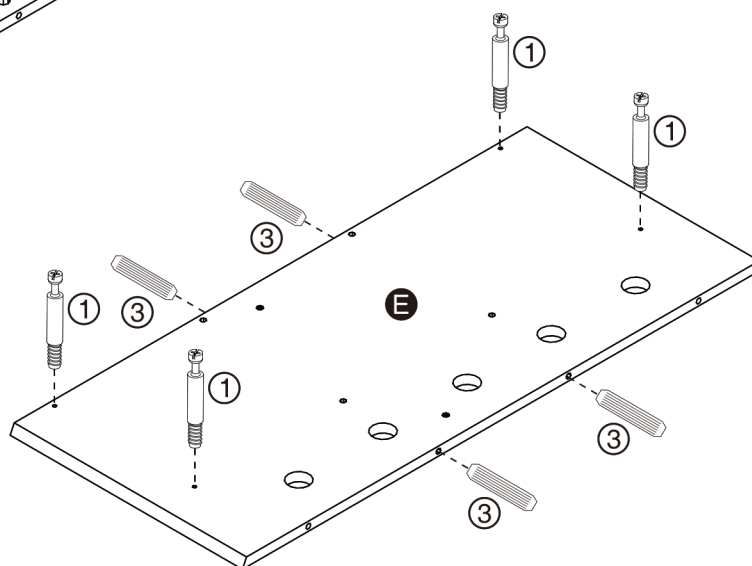
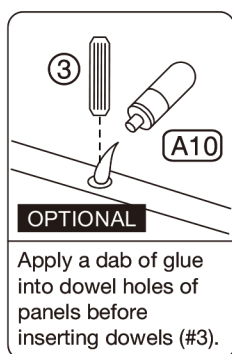
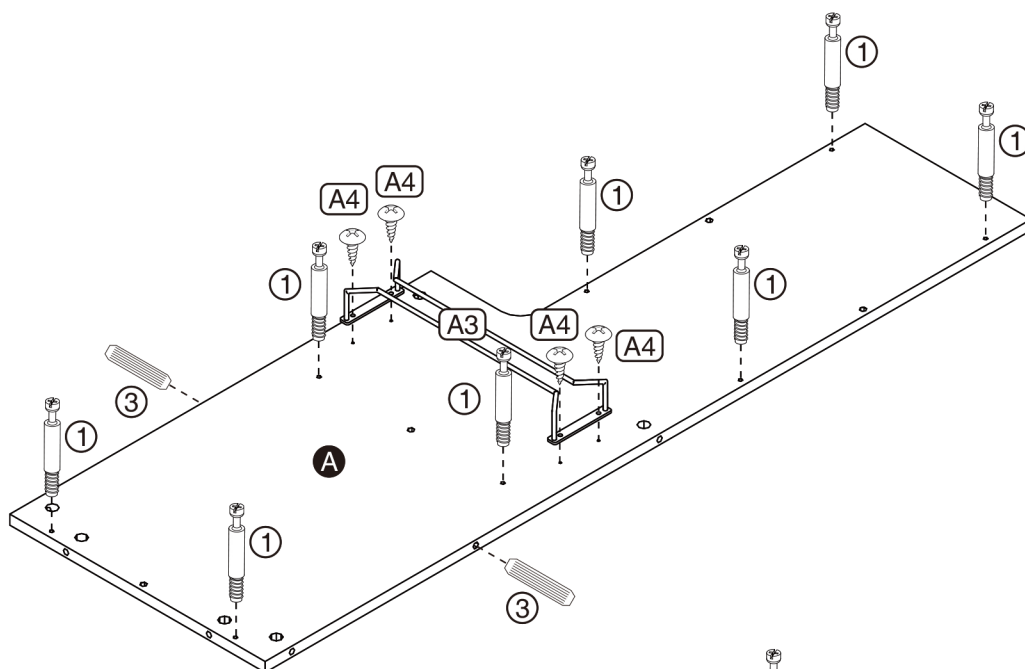

ASSEMBLY INSTRUCTIONS

3

Hardware ① x18PCS

Hardware ⑦ x2PCS

Hardware ⑧ x4PCS

Accessory [A1] x1PC

Accessory [A2] x2PCS

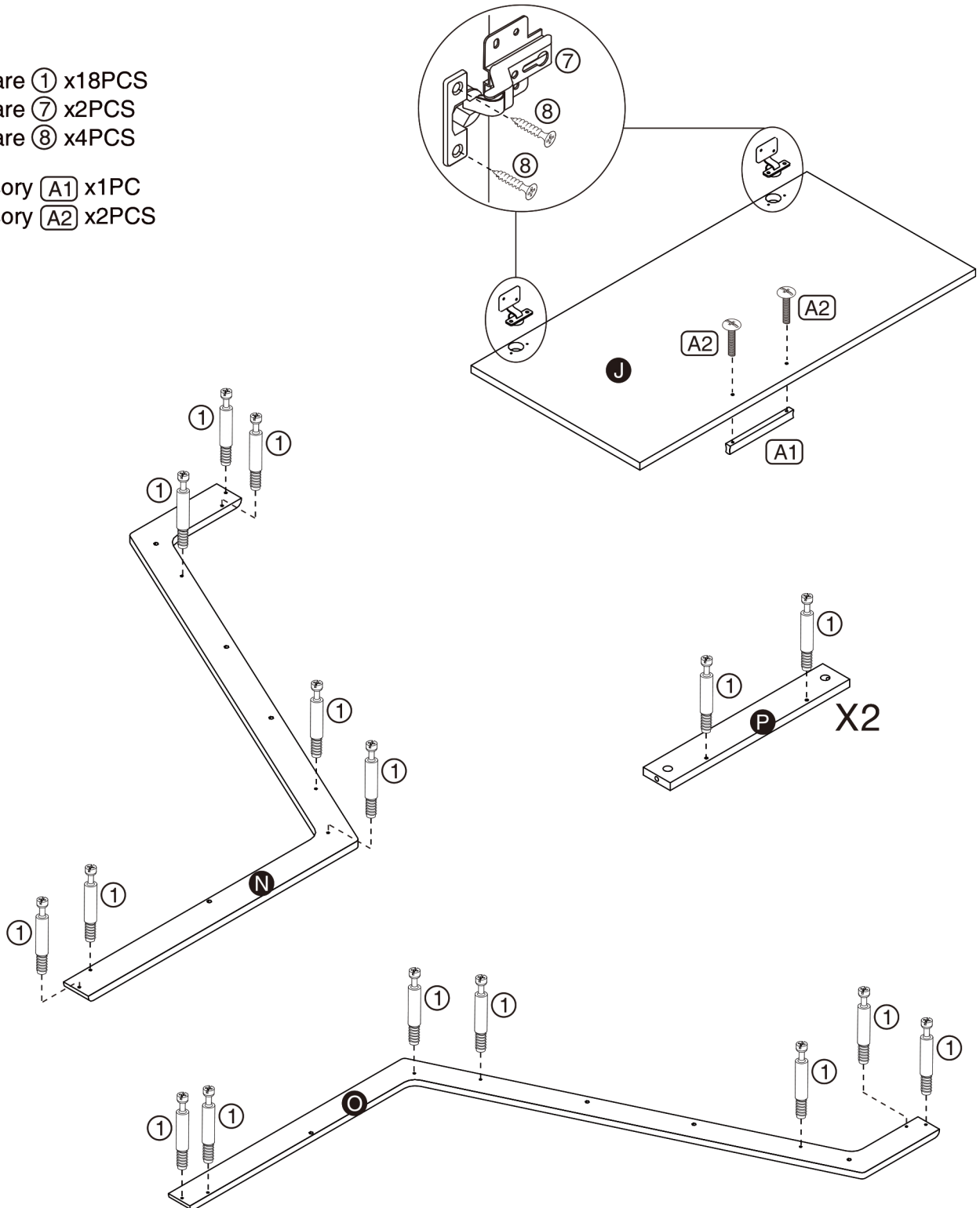

ASSEMBLY INSTRUCTIONS

2

Hardware ① x2PCS
Hardware ③ x14PCS

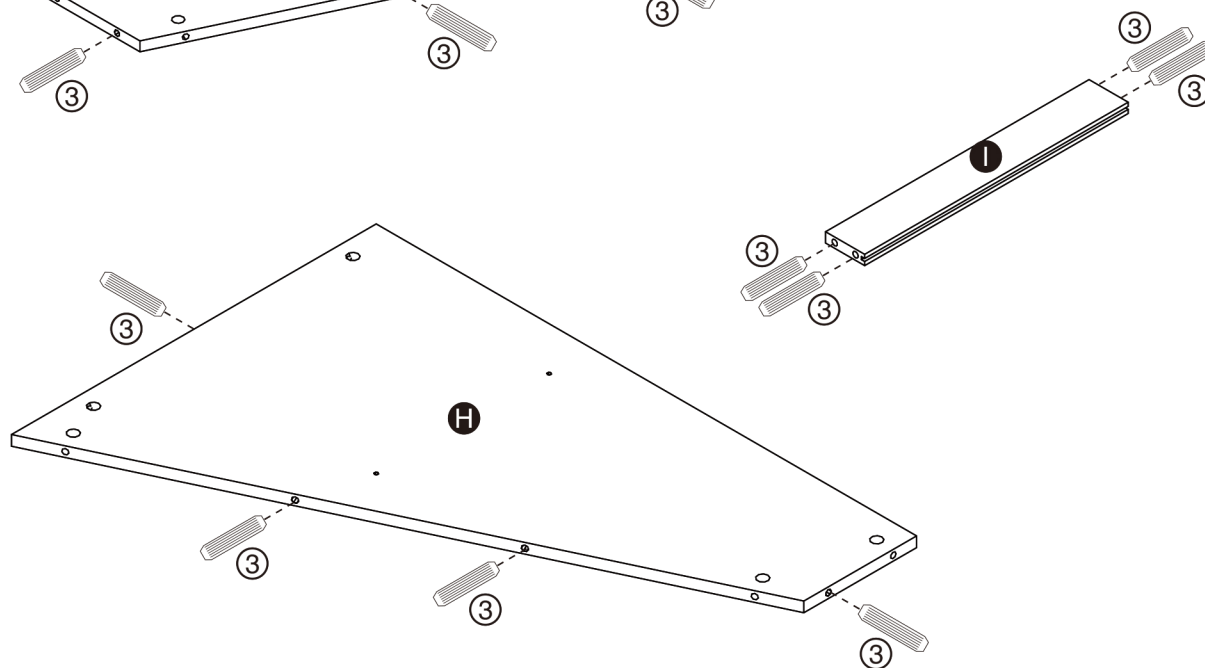
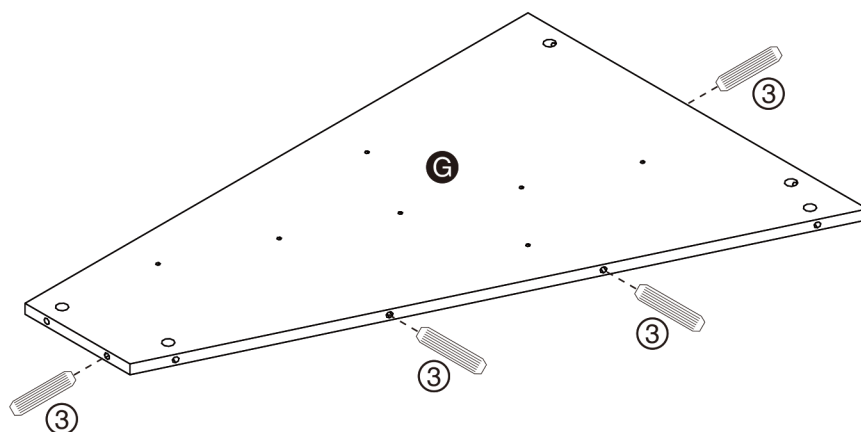
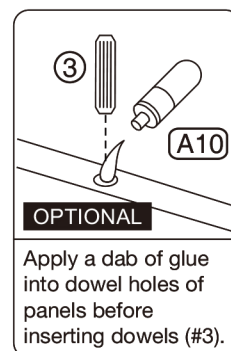
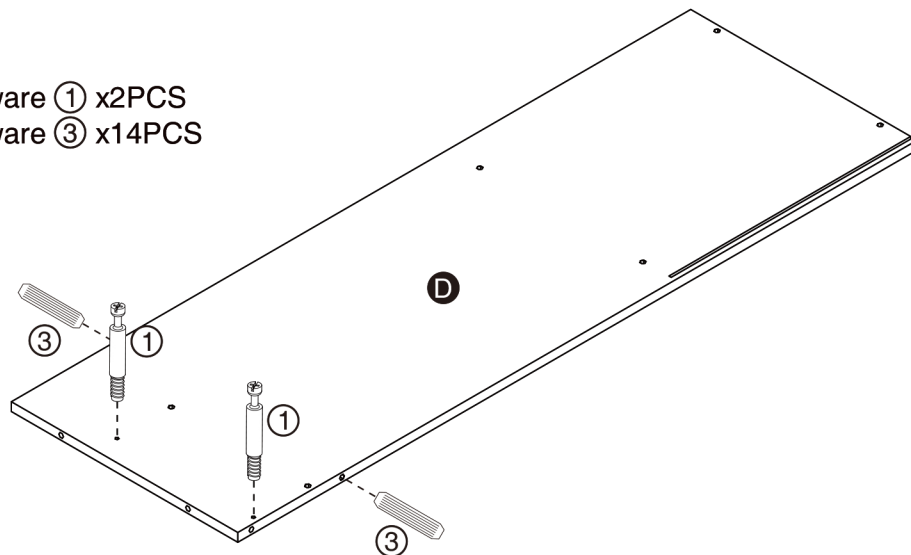

ASSEMBLY INSTRUCTIONS

4

Part **E** x1PC

Part **H** x1PC

Hardware **②** x2PCS

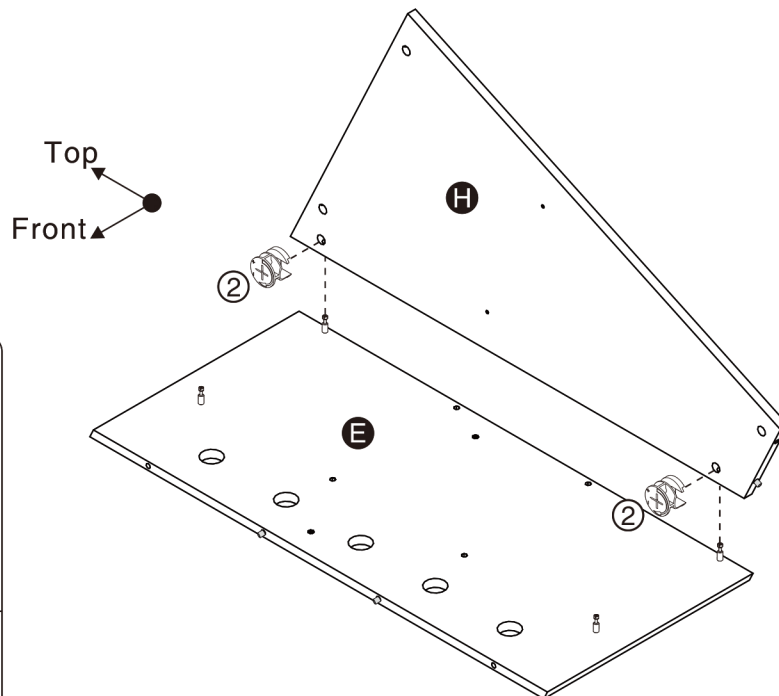
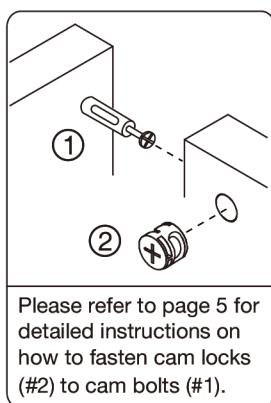

5

Part **G** x1PC

Hardware **②** x2PCS

Accessory **A8** x4PCS

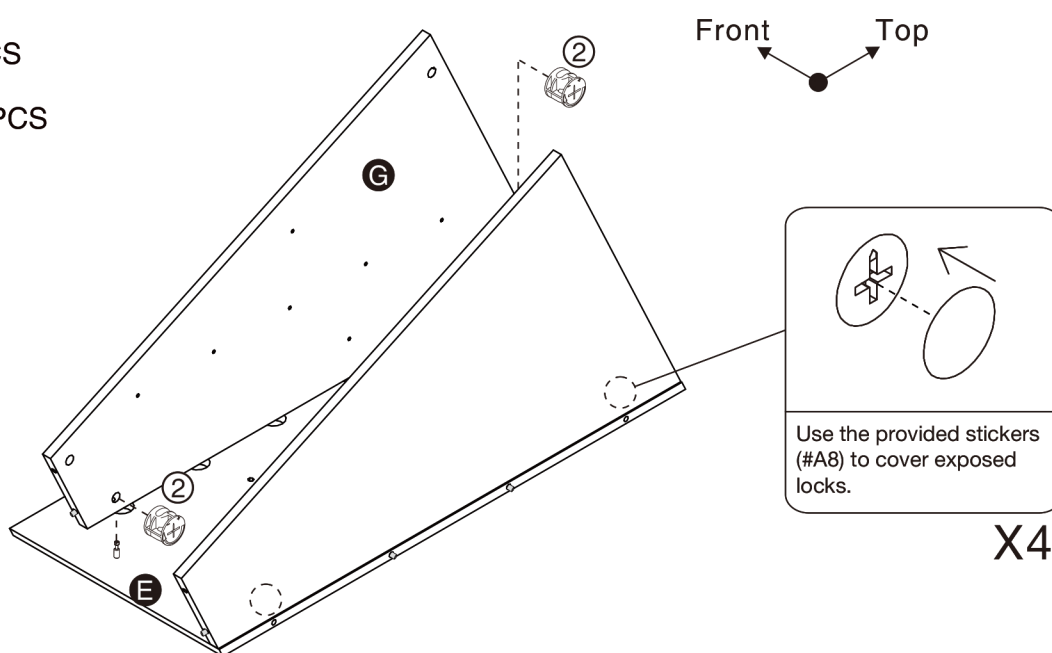

ASSEMBLY INSTRUCTIONS

6

Part **A** x1PC

Hardware **②** x4PCS

Accessory **A8** x4PCS

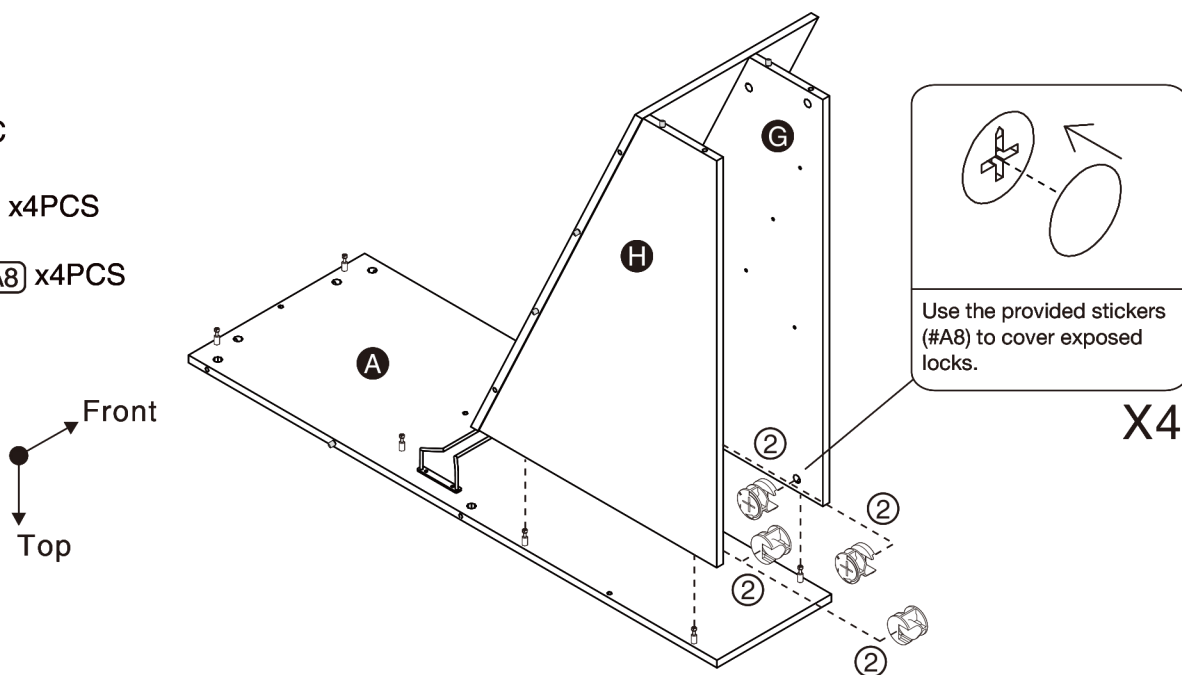

7

Part **P** x1PC

Hardware **②** x2PCS

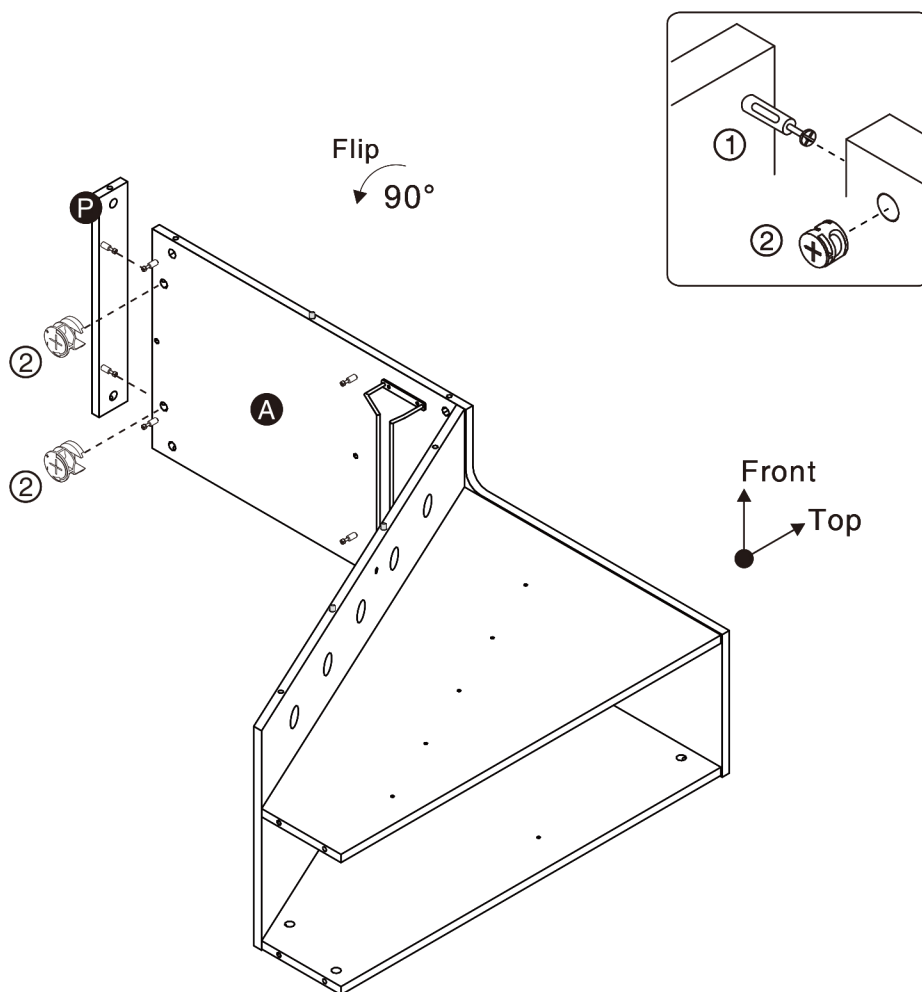

ASSEMBLY INSTRUCTIONS

8

- Part **B** x1PC
- Part **C** x1PC
- Part **I** x1PC

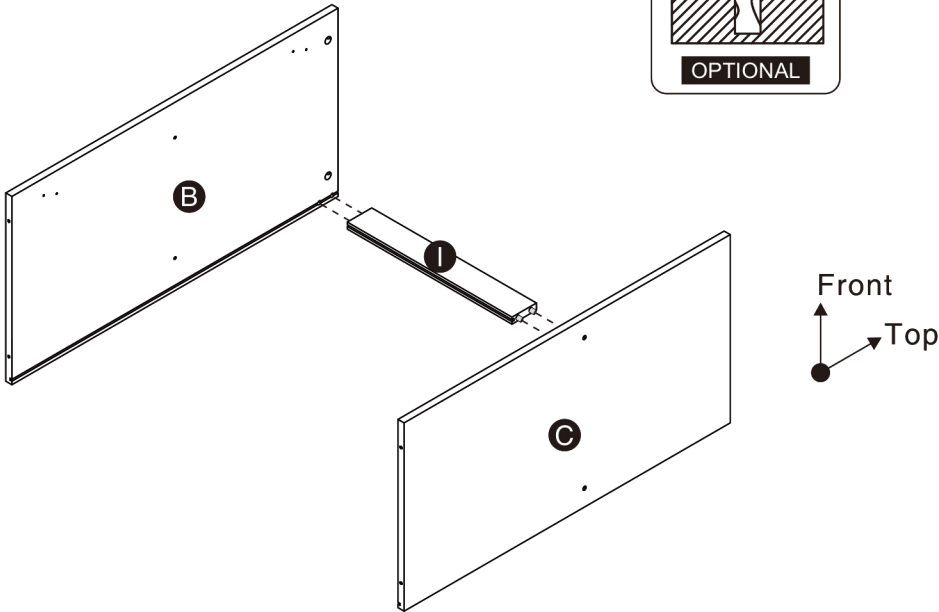
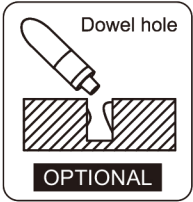

9

- Hardware **2** x4PCS

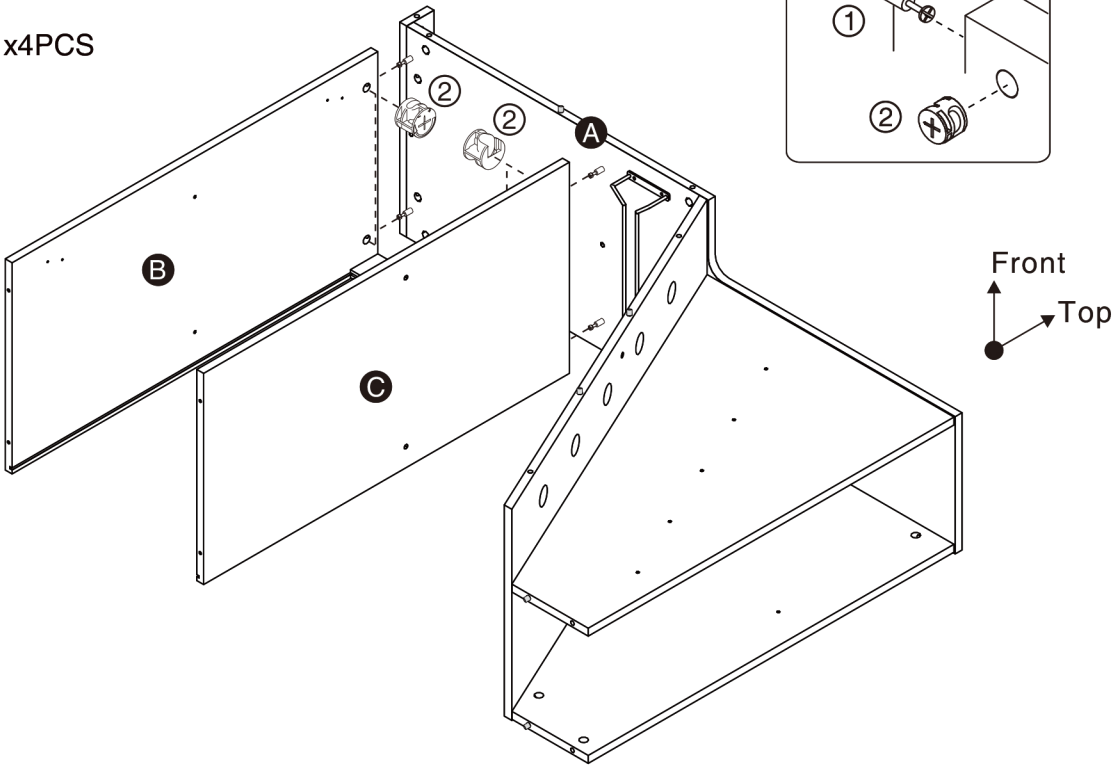
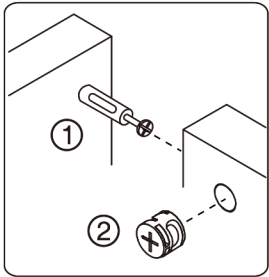

ASSEMBLY INSTRUCTIONS

10

Part **F** x1PC

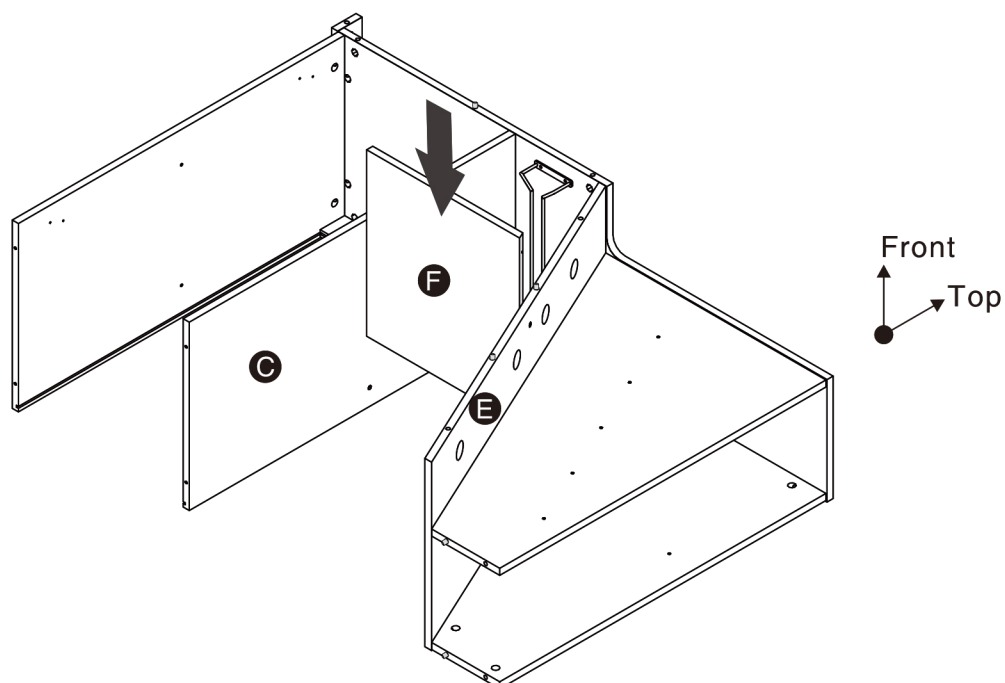

11

Hardware **④** x2PCS

Hardware **⑤** x2PCS

Accessory **A7** x1PC

Accessory **A8** x2PCS

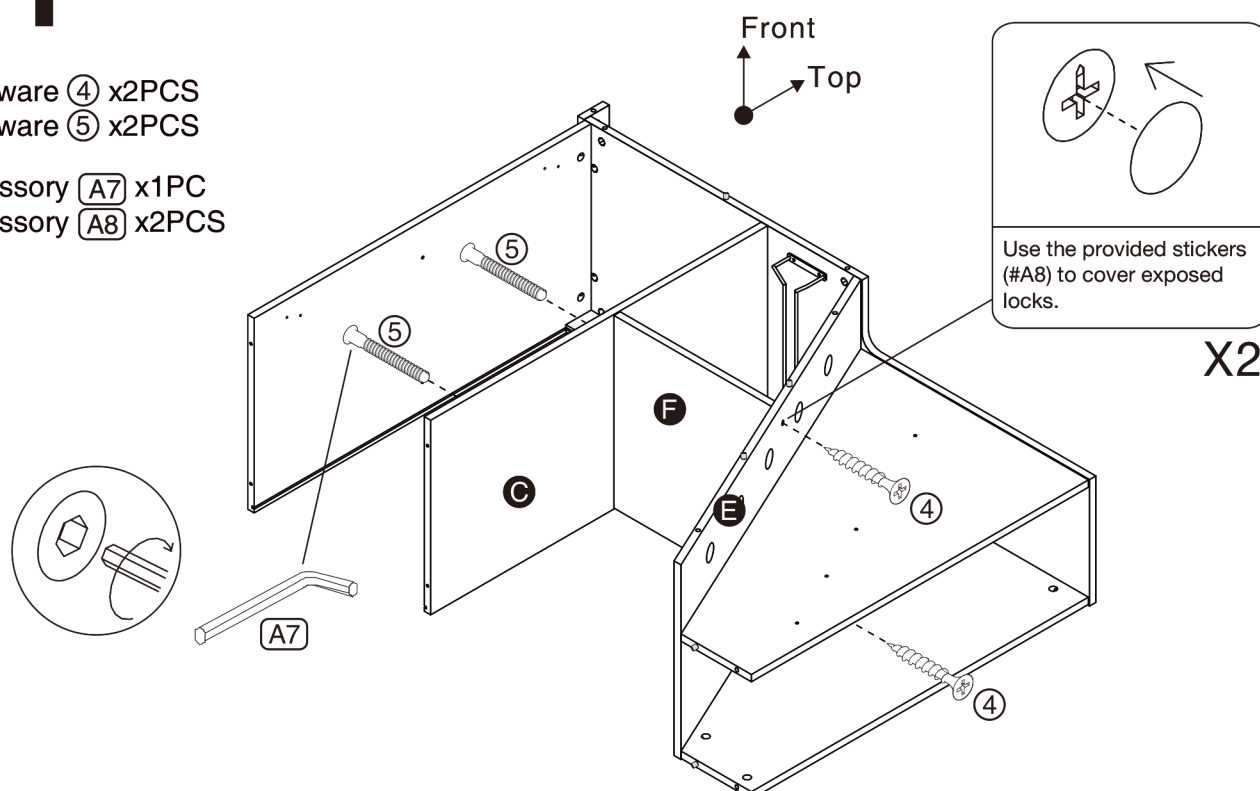

ASSEMBLY INSTRUCTIONS

12

Part **D** x1PC

Part **P** x1PC

Hardware **②** x2PCS

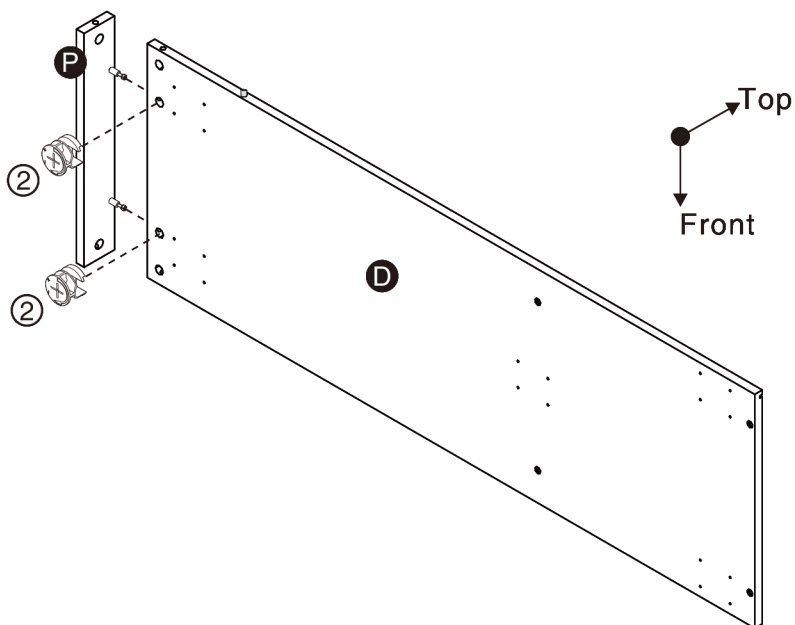
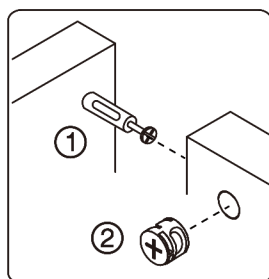

13

Part **M** x1PC

Hardware **②** x2PCS

Hardware **⑤** x4PCS

Accessory **A7** x1PC

Accessory **A8** x2PCS

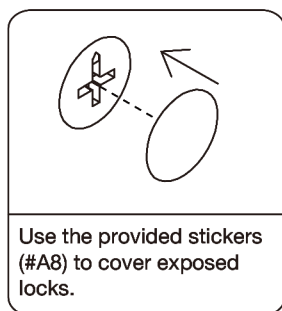

X2

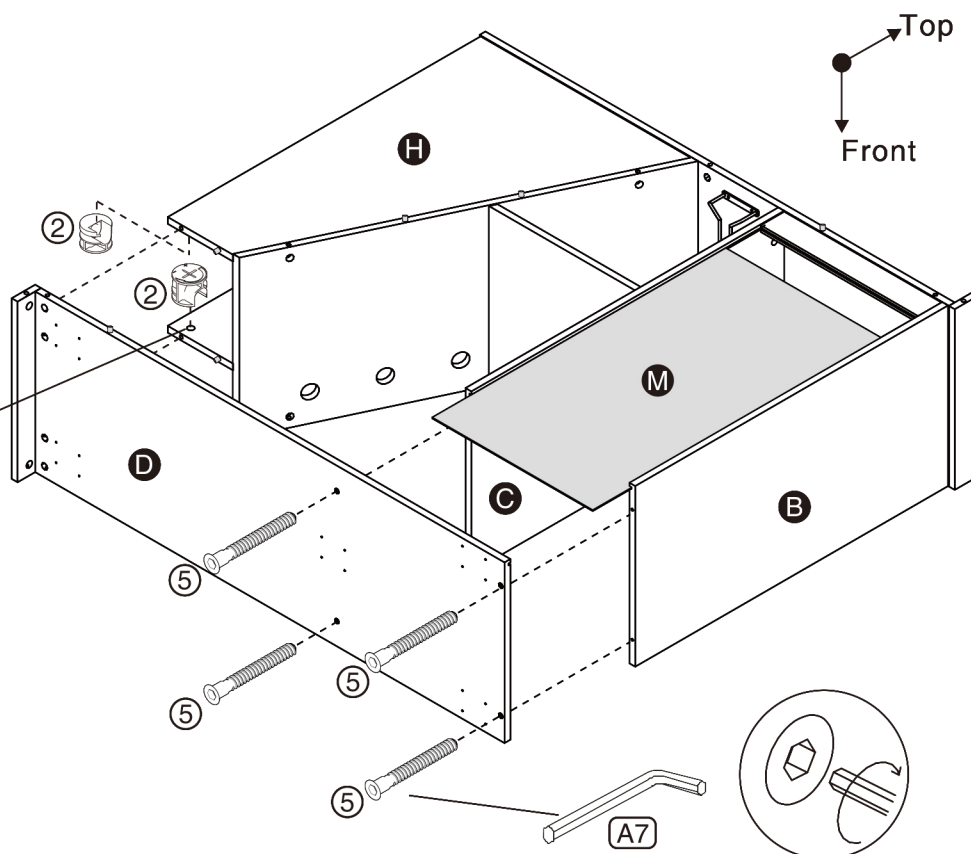

ASSEMBLY INSTRUCTIONS

14

Part **O** x1PC

Hardware **②** x7PCS

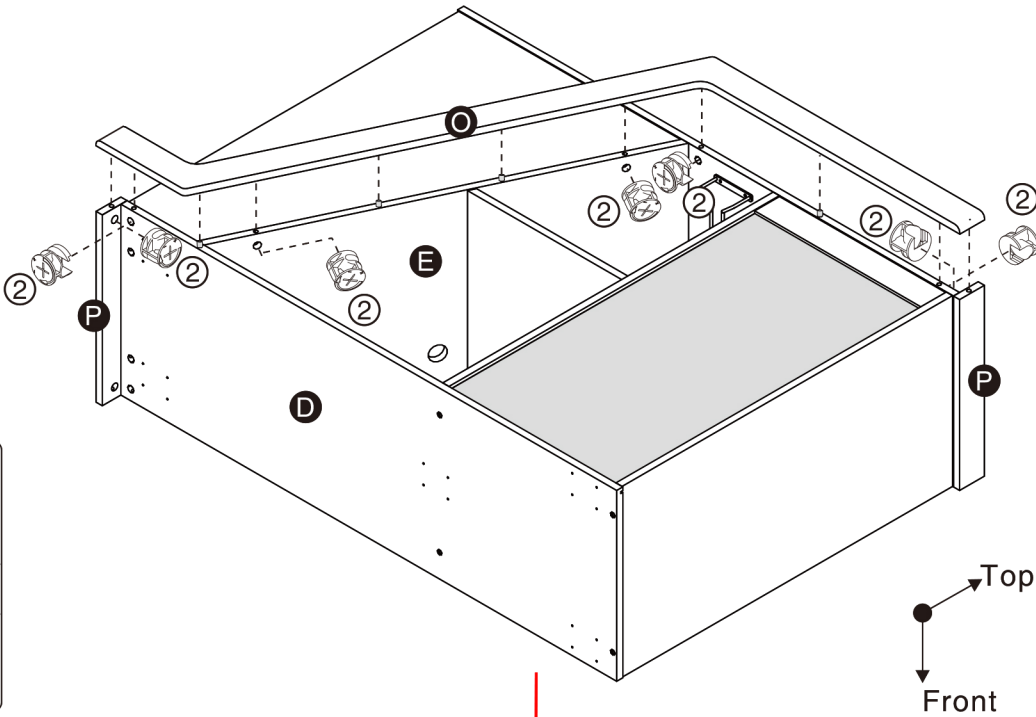
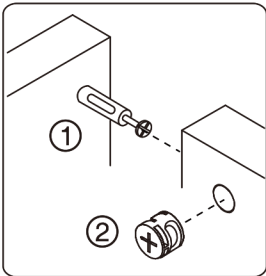

15

Part **N** x1PC

Hardware **②** x7PCS

Accessory **A9** x4PCS

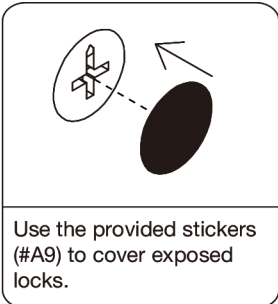

X4

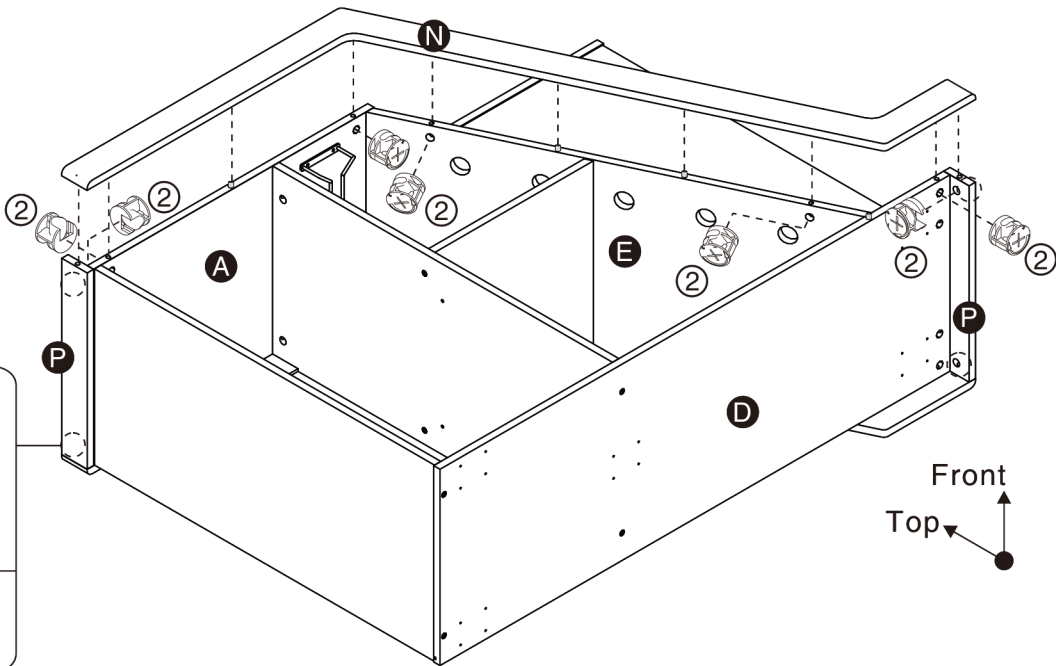

ASSEMBLY INSTRUCTIONS

16

Accessory **A5** x5PCS
Accessory **A6** x20PCS

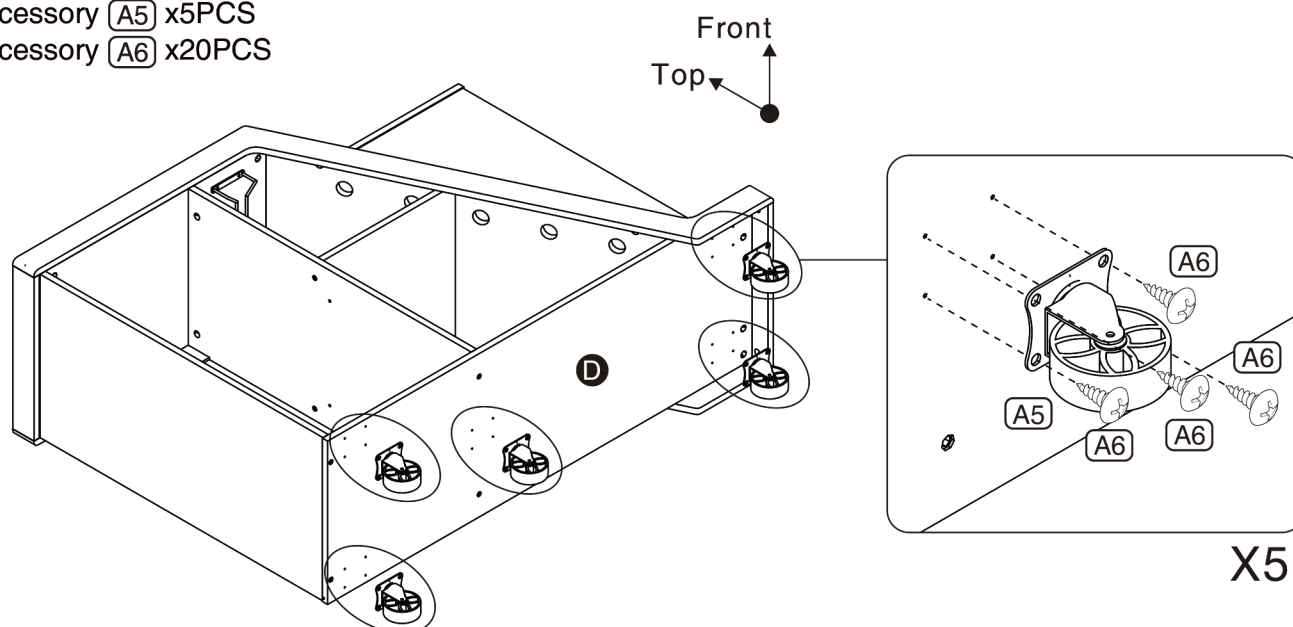

17

Hardware **9** x5PCS
Hardware **10** x5PCS
Hardware **11** x5PCS
Hardware **12** x5PCS

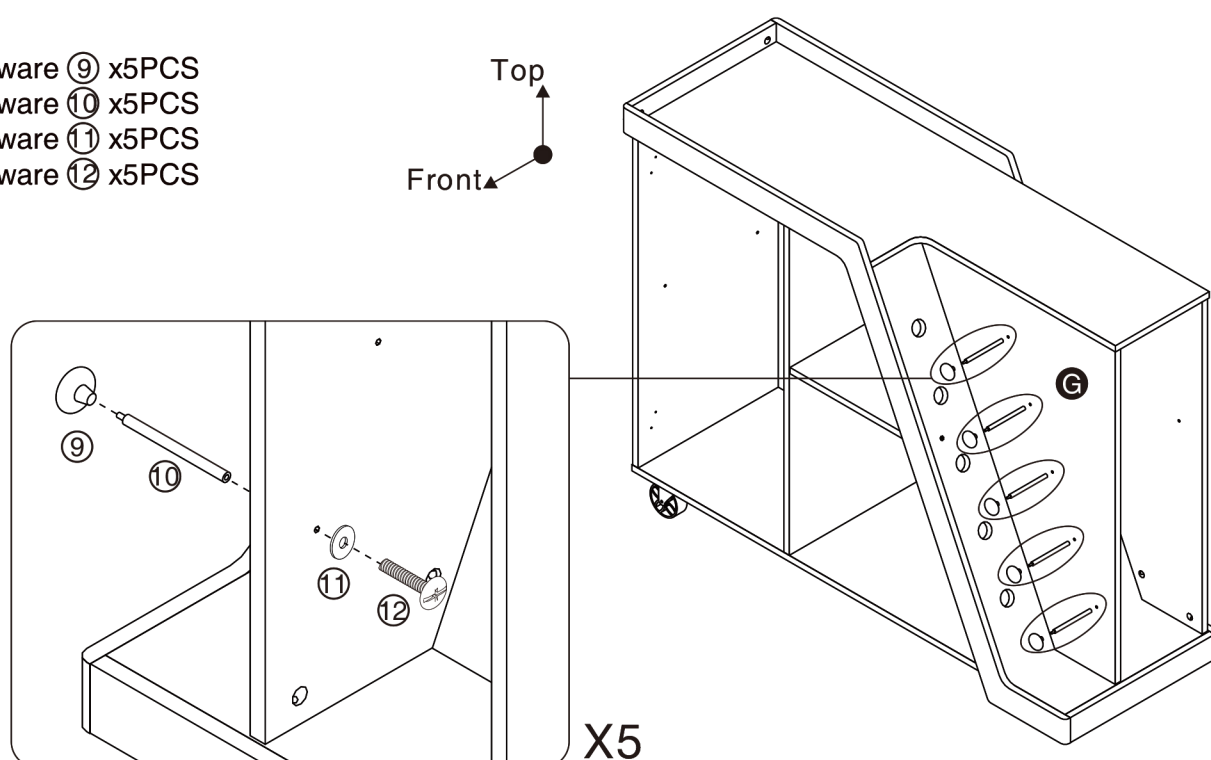

ASSEMBLY INSTRUCTIONS

18

Part **K** x1PC
Part **L** x1PC

Hardware **⑥** x8PCS

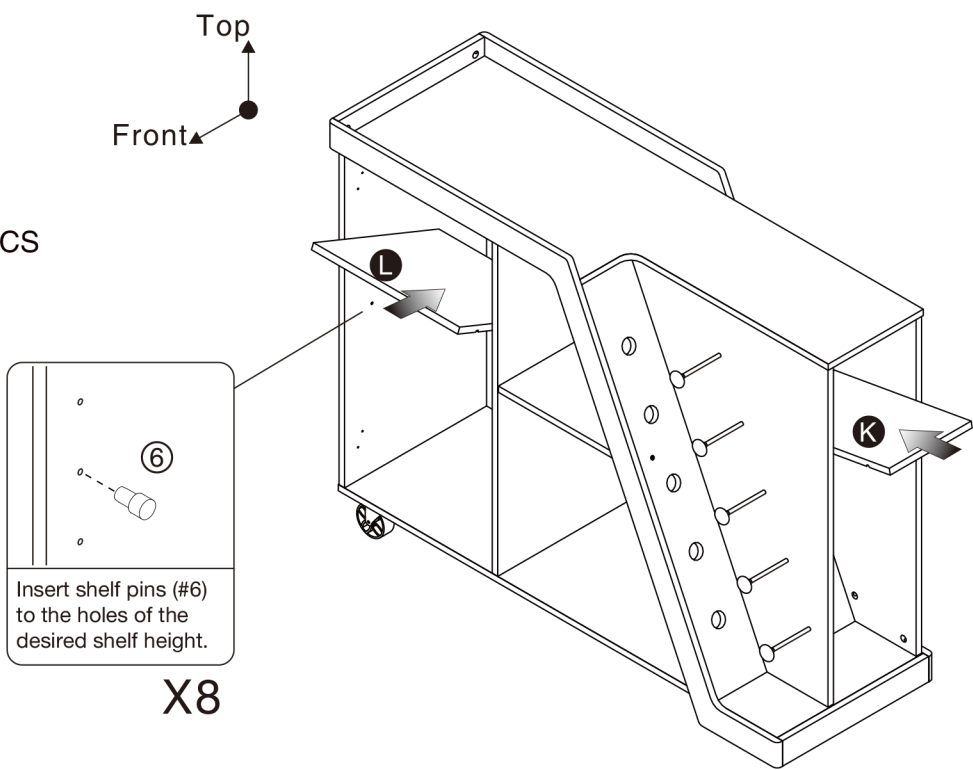

19

Part **J** x1PC

Hardware **⑧** x4PCS

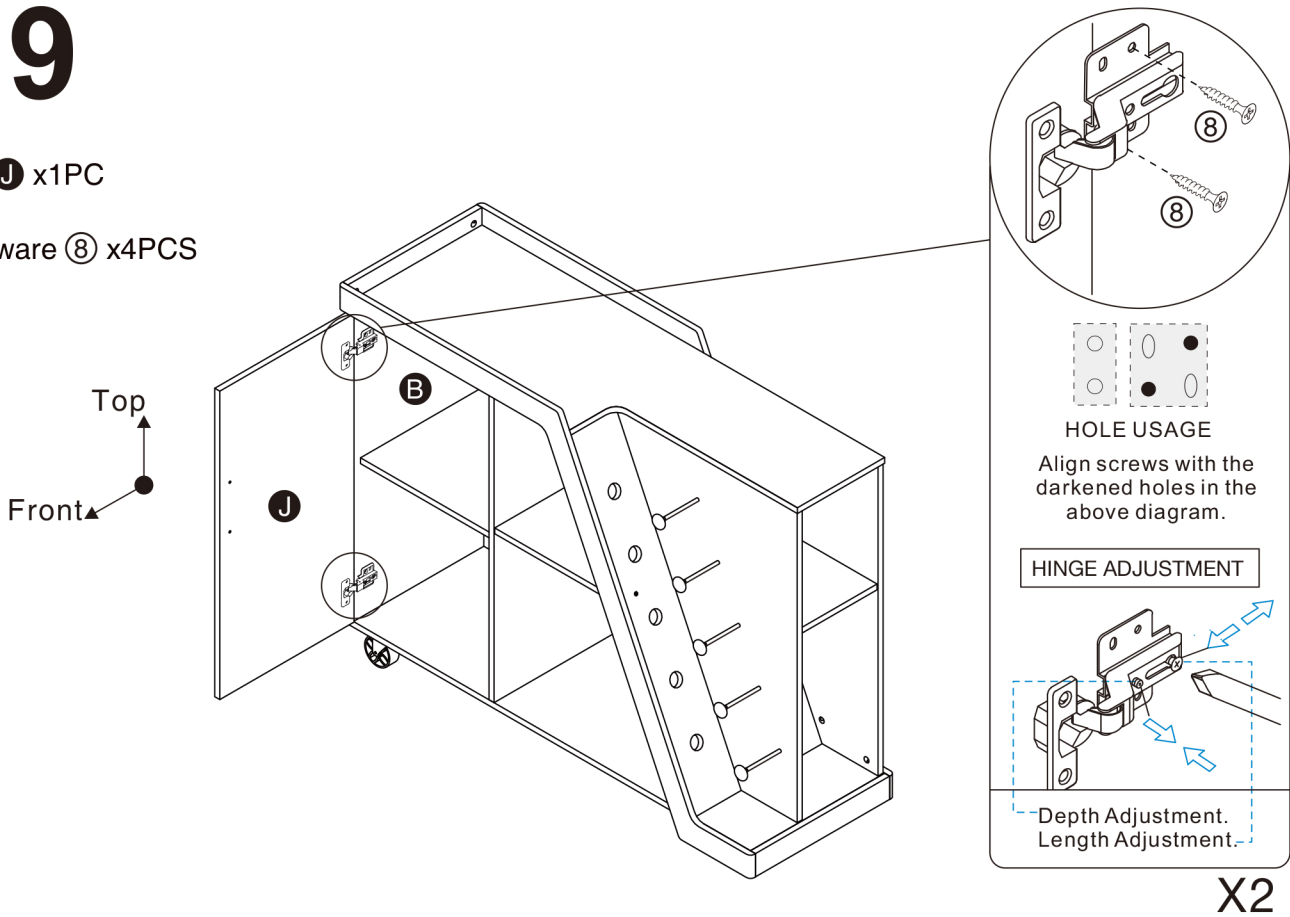

ASSEMBLY INSTRUCTIONS

20

Hardware ⑬ x4PCS

Hardware ⑭ x4PCS

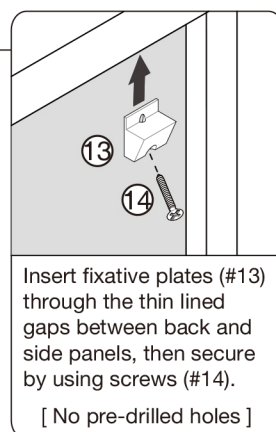
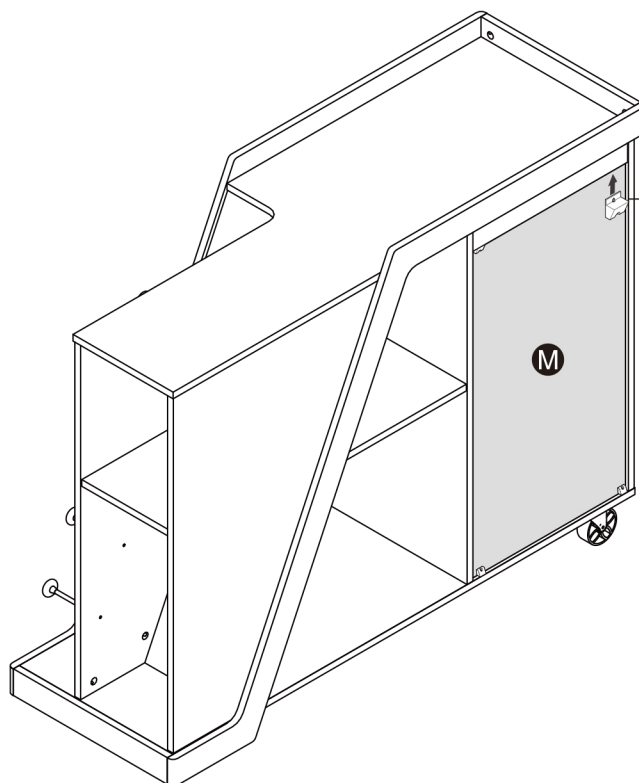
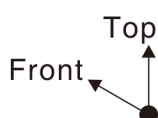

X4

21

ASSEMBLY COMPLETED



Please ensure the furniture rests on an even and flat surface. If the product wobbles or feels loose, double-check all bolts and/or screws are properly tightened and secured.

✓ Keep this handy!

Please retain this instruction manual and any order-related information for future reference.

