

ASSEMBLY INSTRUCTION

ITEM : 80016-511 QB

NO	PART LIST	QTY
1	HEADBOARD CUSHION	1PC
2	RIGHT HEADBOARD LEG WITH 'R' LABEL	1PC
3	LEFT HEADBOARD LEG WITH 'L' LABEL	1PC
4	WINGS (L/R)	2PCS
5	FOOTBOARD CUSHION	1PC
6	FOOTBOARD LEGS	2PCS
7	SIDE RAIL (L)	2PCS
8	SIDE RAIL (R)	2PCS
9	SIDE RAIL SUPPORT LEG	2PCS
10	SLATS	4PCS
11	SUPPORT LEGS WITH ADJUSTABLE FEET	4PCS
NO	HARDWARE LIST	QTY
A	JCBB SCREW M8 X 20	8PCS
B	JCBC SCREW M6 X 25	8PCS
C	JCBC SCREW M6 X 35	16PCS
D	JCBC SCREW M6 X 70	2PCS
E	WOOD DOWEL	2PCS
F	SPRING WASHER	20PCS
G	FLAT WASHER	20PCS
H	SCREW M4 X 32mm	8PCS
I	SCREW M4 X 38mm	4PCS
J	L - KEY M5 X 65mm	1PC
K	L - KEY M4 X 65mm	1PC

STEP 1

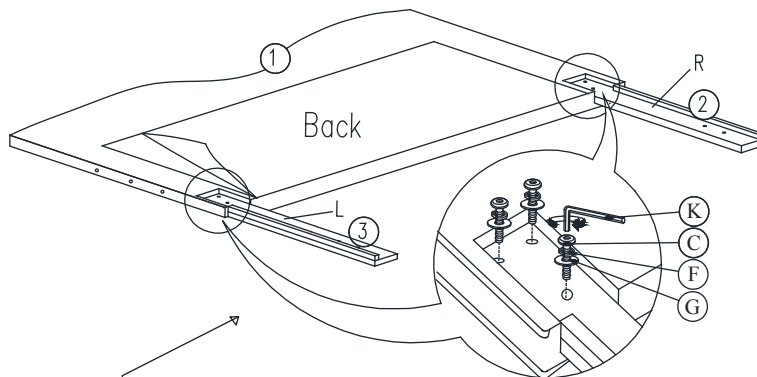

Make sure the cleat is on outside edge

STEP 3

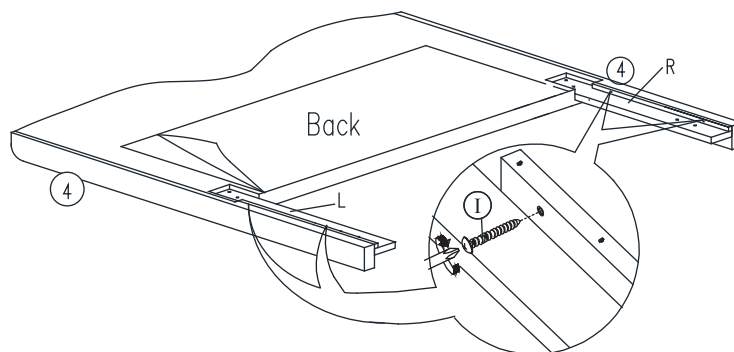

STEP 2

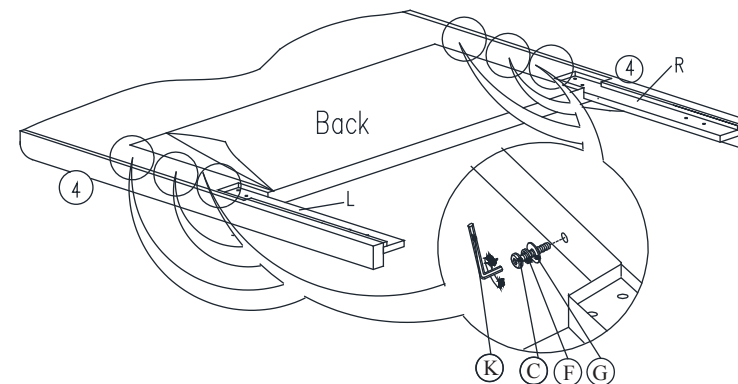

STEP 4

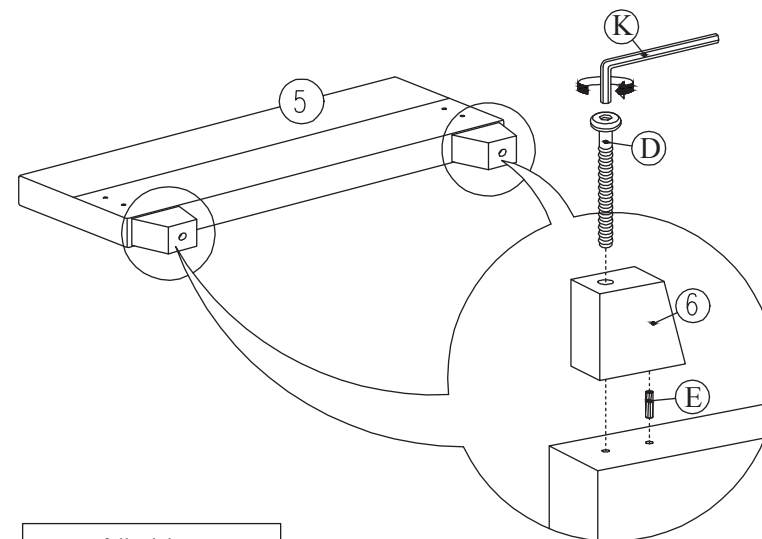

Do not fully tighten screws until assembly is complete and the bed is level

ASSEMBLY INSTRUCTION

STEP 5

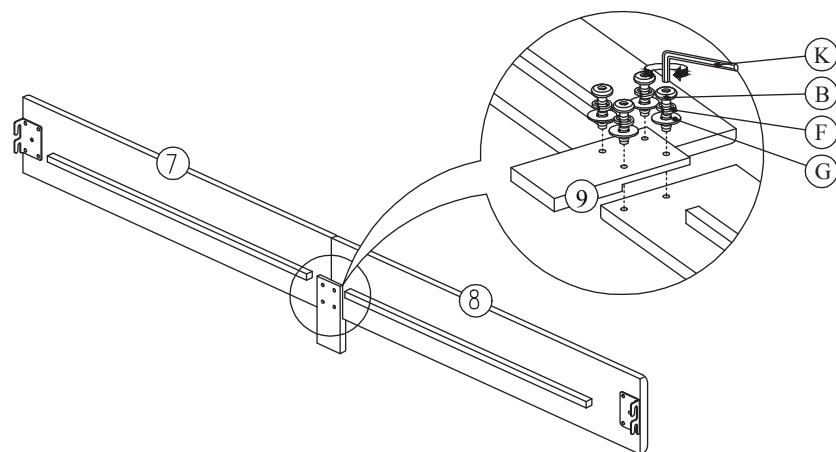

Do not fully tighten screws until assembly is complete and the bed is level

STEP 6

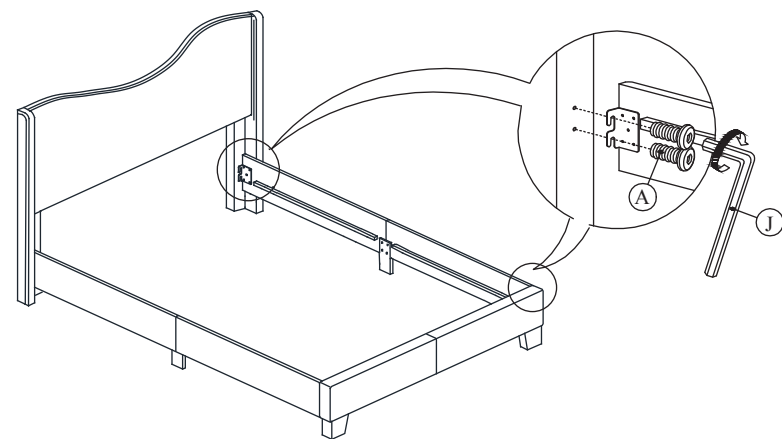

STEP 7

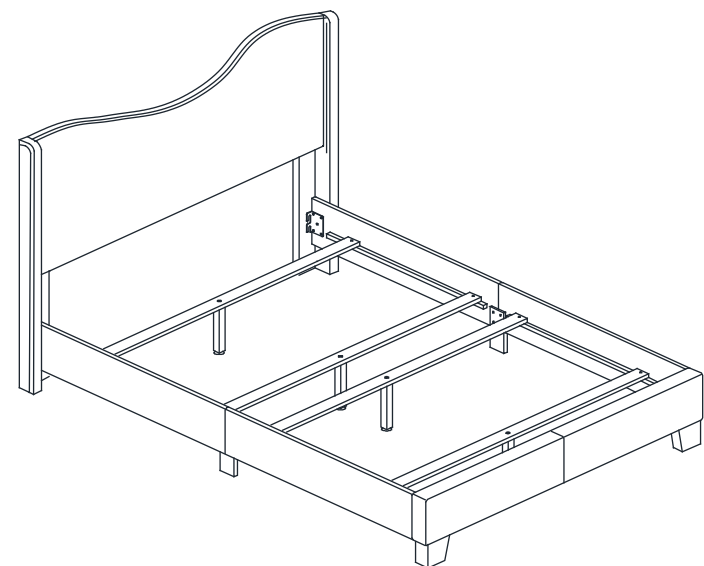
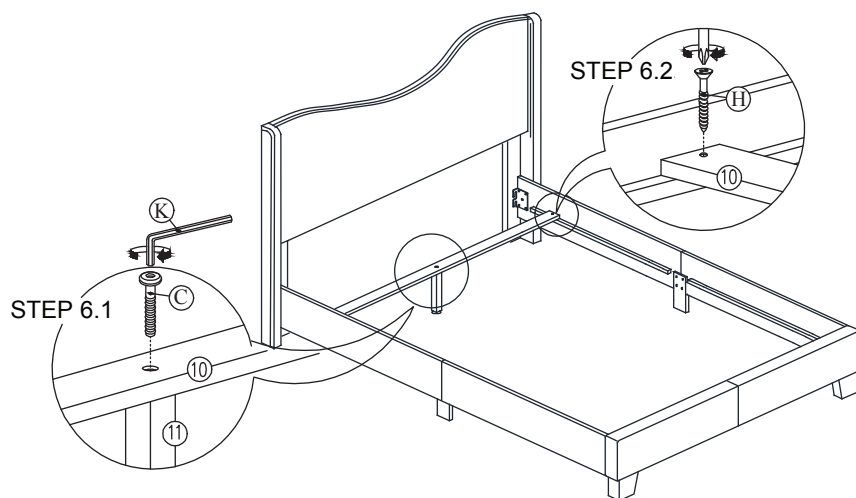

ASSEMBLY
COMPLETED