

# ASSEMBLY INSTRUCTIONS

---

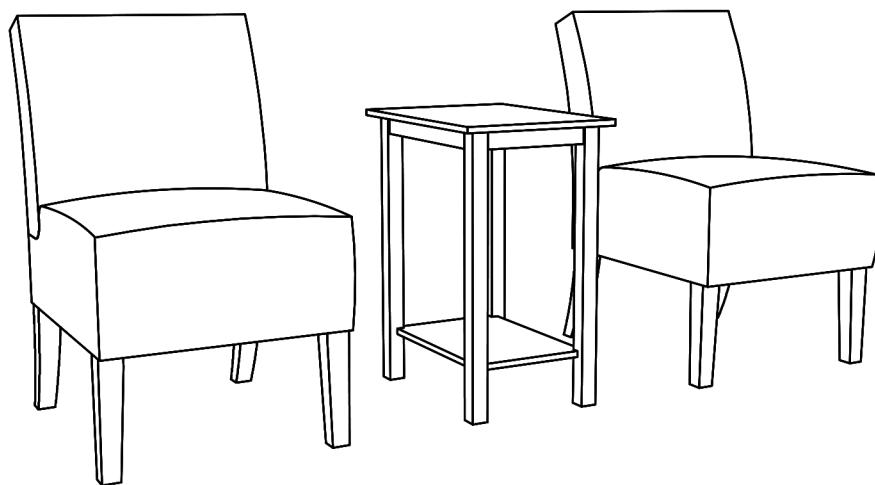

## TOOLS REQUIRED



Allen Wrench

(Included)



Phillips  
Screwdriver

(Not Included)



2 - Persons  
Recommended

## ASSEMBLY RATING



EASY —————> DIFFICULT

The Assembly Rating is a 5-point system showing the level of effort needed to assemble a specific product.



## CHECK BEFORE STARTING

☐

### Are you missing anything?

Double-check all parts, hardware and accessories listed on Page 6 are accounted for.

☐

### Check out our Quick Tips!

We recommend reviewing the pre-assembly handouts. Even experts need a refresher now and then!

☐

### Should we send any replacements?

Are there any irregularities or flaws in the parts? We can send replacements!

☐

### Prep Time!

Please review the assembly instructions and all diagrams prior to assembling. Arrange parts as recommended on Page 7 and group identical hardware together to make assembling easier.

# PRE ASSEMBLY INTRODUCTION

We understand building ready-to-assemble furniture can be a challenging experience for some. To help avoid confusion, we have provided some helpful tips that may speed up the process.



## Teamwork

ALWAYS have at least two people to help with transporting and assembling the product to avoid potential injury and/or damage.

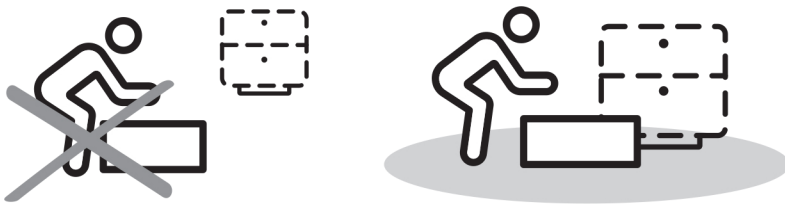

## Suitable Location

Assembling near the area of the intended location is highly recommended.



## Sufficient Space

Make sure you have enough space to move around during the assembly.

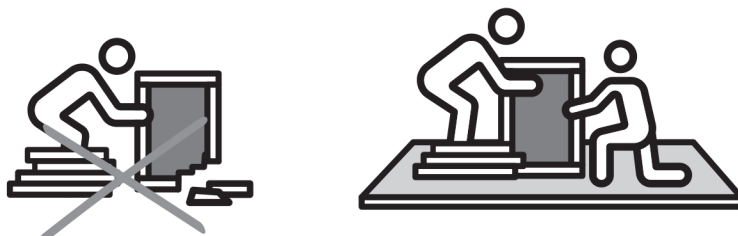

## Avoid Scratches

Use cardboard, blankets or a carpeted area while assembling furniture to prevent scratches.

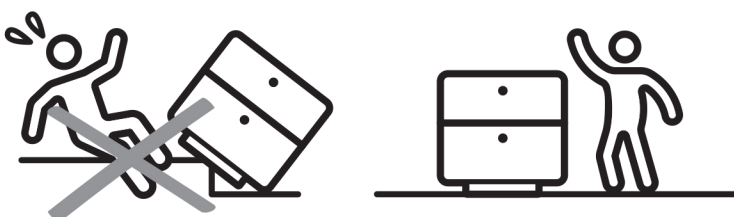

## Flat Surface

Make sure the furniture rests on a flat and level surface with each leg evenly touching the floor.

# ASSEMBLY AND CARE ADVICE



**FAILURE TO FOLLOW THE GUIDELINES BELOW MAY  
RESULT IN INJURY AND/OR PROPERTY DAMAGE.**



Position each part correctly  
and insert screws or bolts into  
their respective holes.

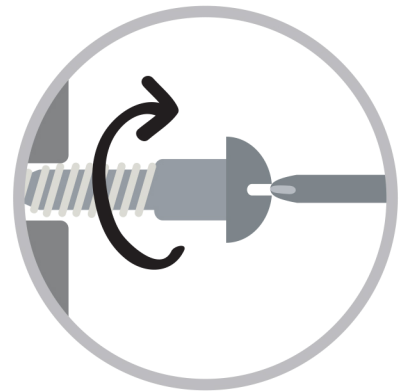

Turn clockwise to tighten and  
only tighten when step is  
completed or when instructed  
to do so.



Save the instructions and store  
any supplied tools for later  
maintenance.

Use the appropriate hand tools  
or power tools for assembly.  
Select steps, such as tightening  
screws and/or bolts, may require  
hand tools to avoid causing  
damage during assembly.

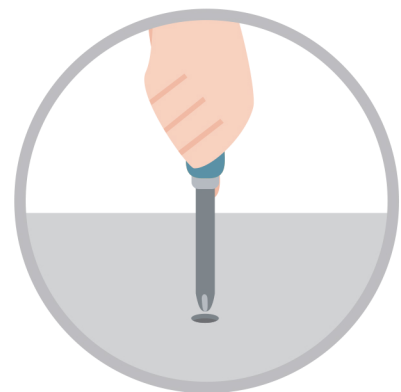

After two weeks, check and  
tighten any loose hardware and  
repeat again every six months  
thereafter.

**IT IS THE USER'S RESPONSIBILITY TO MAINTAIN THE FURNITURE. THE HARDWARE MAY LOOSEN OVER TIME AND MAY CAUSE THE FURNITURE TO BE WOBBLY AND UNABLE TO SUPPORT ITS INTENDED WEIGHT CAPACITY. THIS MAY LEAD TO COLLAPSE AND MAY CAUSE SERIOUS INJURY.**

# TABLE&CHAIR

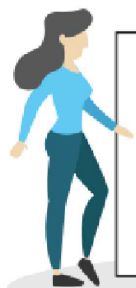

- Please keep instructions for future reference.
- Check the quantity and irregularity of parts and hardware before you start.

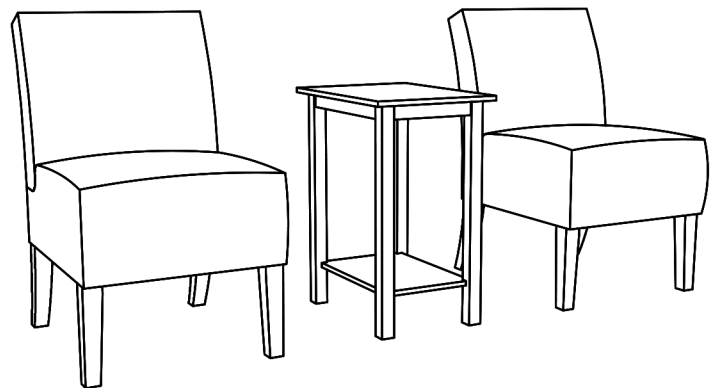

## PARTS

#1 1pc

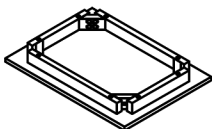

Table Top

#2 1pc

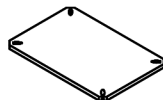

Table Shelf

#3 4pcs

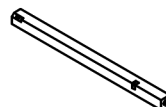
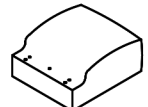

Table Leg

#4 1pc x2



Seat

#5 1pc x2



Backrest

#6 2pcs x2

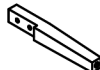

Front Leg

#7 2pcs x2

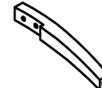

Back Leg (L&R)

## HARDWARE

#A 30pcs



Bolt Ø1/4" x 2"

#B 30pcs



Lock Washer Ø1/4"

#C 30pcs



Flat Washer Ø1/4"

#D 4pcs

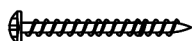

Screw #8 x 25mm

#E 1pc



Allen Wrench 4mm

# Exploded View

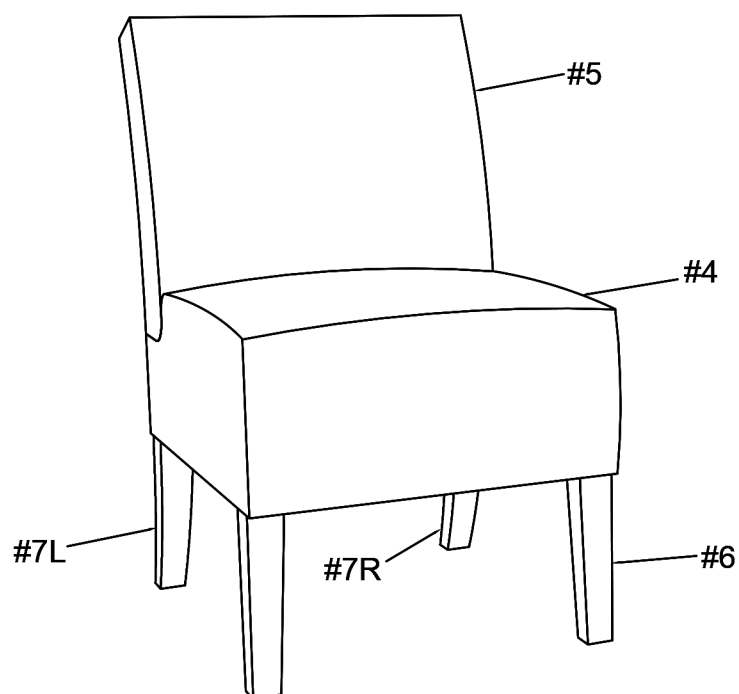
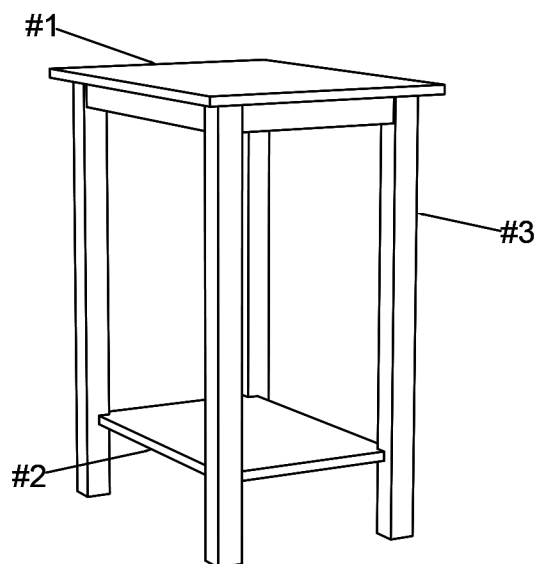

x 2

# ASSEMBLY INSTRUCTIONS

## 1

Part #1 x1pc

Part #2 x1pc

Part #3 x4pcs

Hardware #A x4pcs

Hardware #B x4pcs

Hardware #C x4pcs

Hardware #D x4pcs

Align legs (#3) to the shelf (#2) and top (#1).  
Secure top (#1) to legs (#3) by using bolts (#A)  
with washers (#B,C). Secure shelf (#2) to legs  
(#3) by using screws (#D).

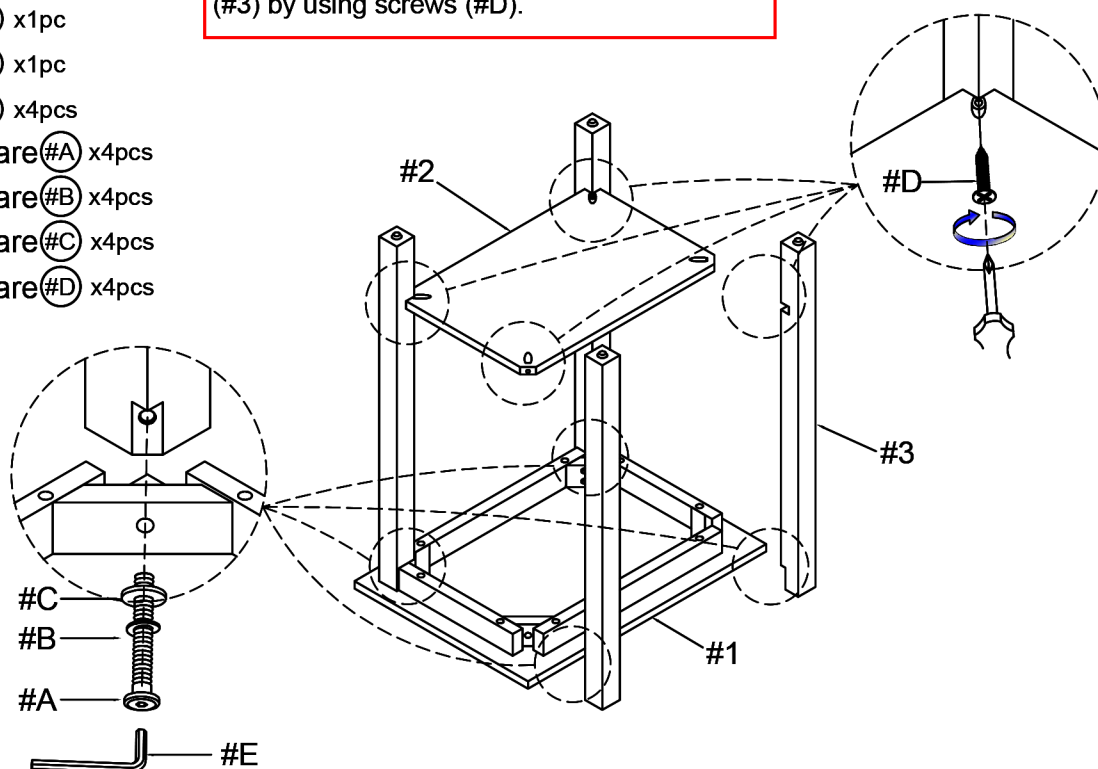

## 2

Part #4 x1pc

Part #5 x1pc

Hardware #A x5pcs

Hardware #B x5pcs

Hardware #C x5pcs

Align seat (#4) to back (#5), then secure by using  
bolts (#A) with washers (#B,C).

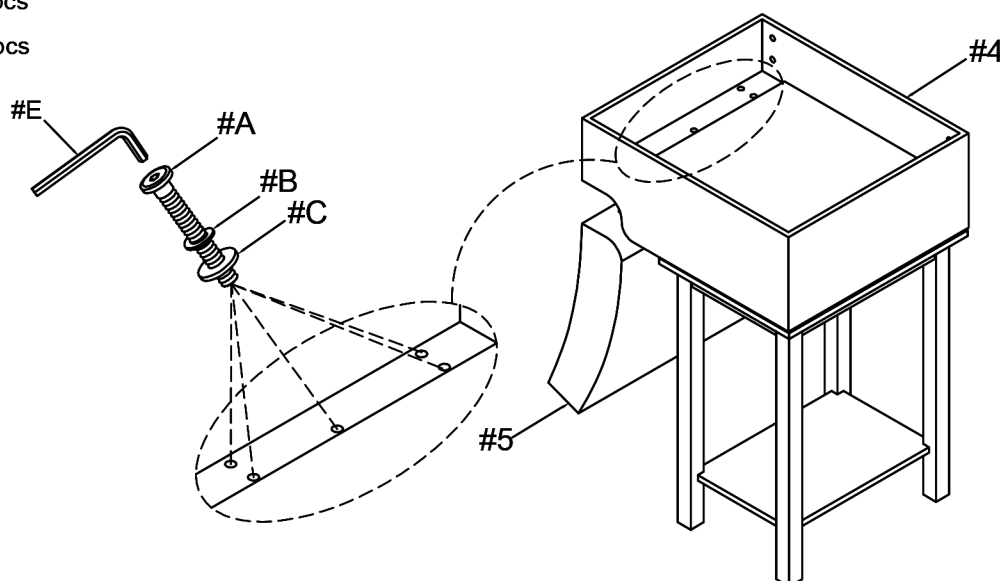

# ASSEMBLY INSTRUCTIONS

## 3

Part **#6** x2pcs

Part **#7** x2pcs

Hardware **#A** x8pcs

Hardware **#B** x8pcs

Hardware **#C** x8pcs

Align front legs (**#6**) and back legs (**#7L/R**) to the seat, then secure by using bolts (**#A**) with washers (**#B,C**).

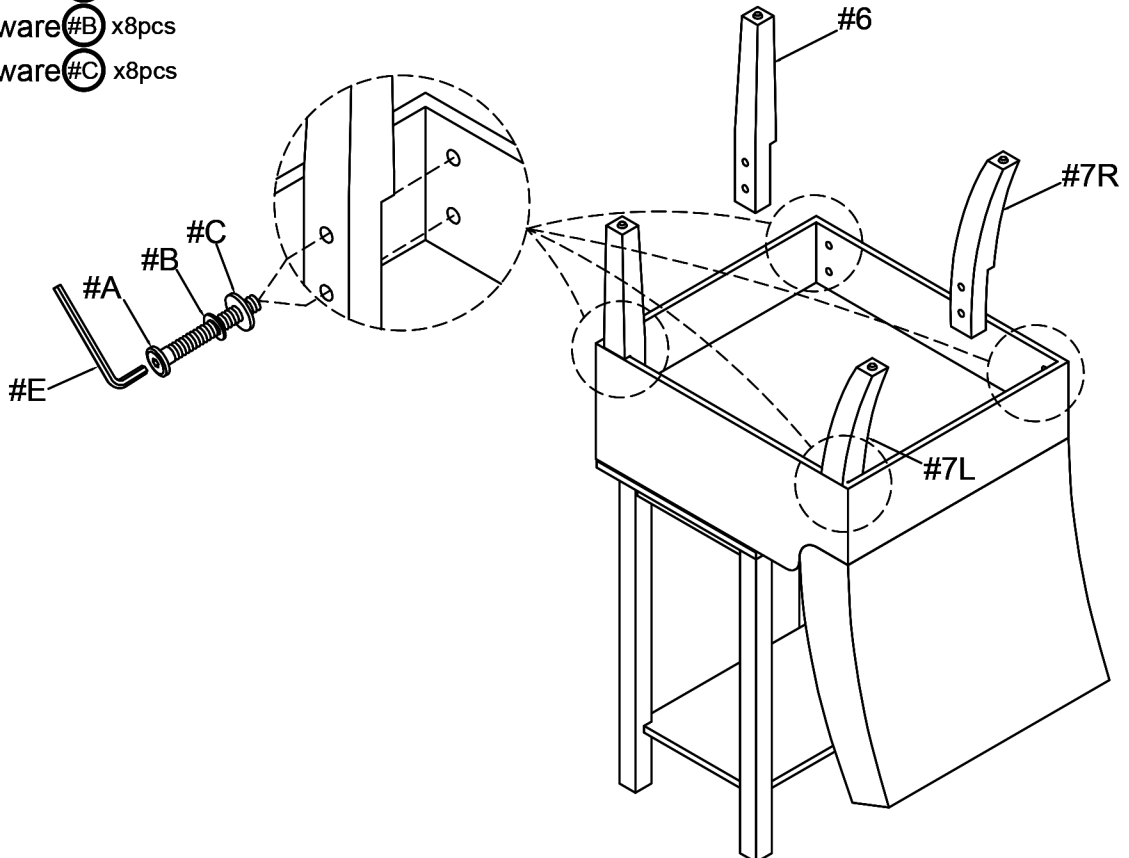

## 4

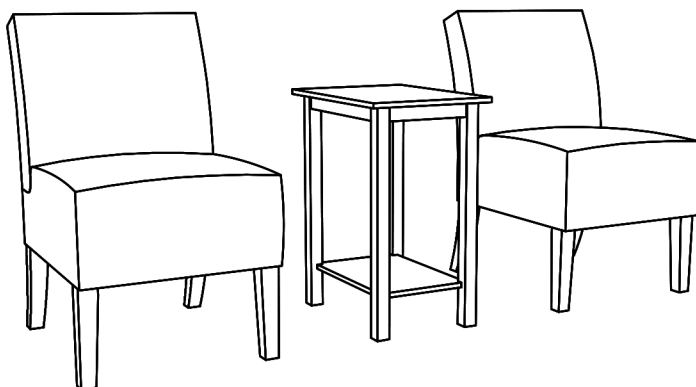

## ASSEMBLY COMPLETED



Please ensure the furniture rests on an even and flat surface. If the product wobbles or feels loose, double-check all bolts and/or screws are properly tightened and secured.



### Keep this handy!

Please retain this instruction manual and any order-related information for future reference.