

ASSEMBLY INSTRUCTION

LINEN LOVESEAT

A Seat Frame

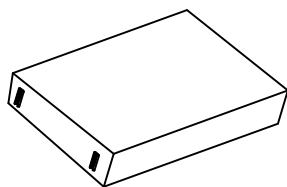

1pc

B Back Frame

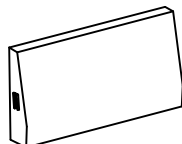

1pc

C Left Panel

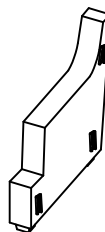

1pc

D Right Panel

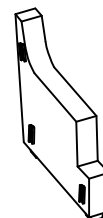

1pc

E Left Seat Cushion



1pc

F Right Seat Cushion

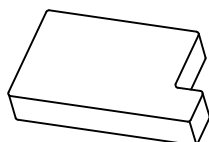

1pc

G Back Cushion

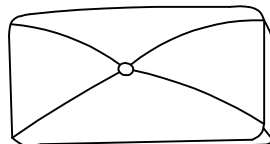

2pcs

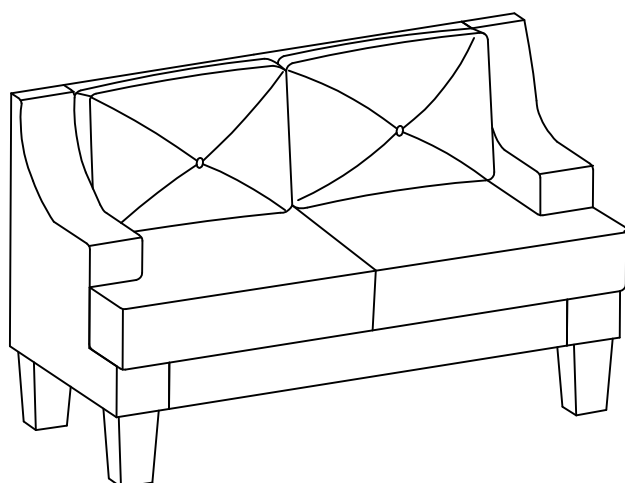

This page lists all the contents included in the box. As you unpack and prepare for assembly, place the contents on a carpeted or padded area to protect them from damage.

1

Hook on the Left Panel (C) & Right Panel (D) to Seat Frame (A) properly.

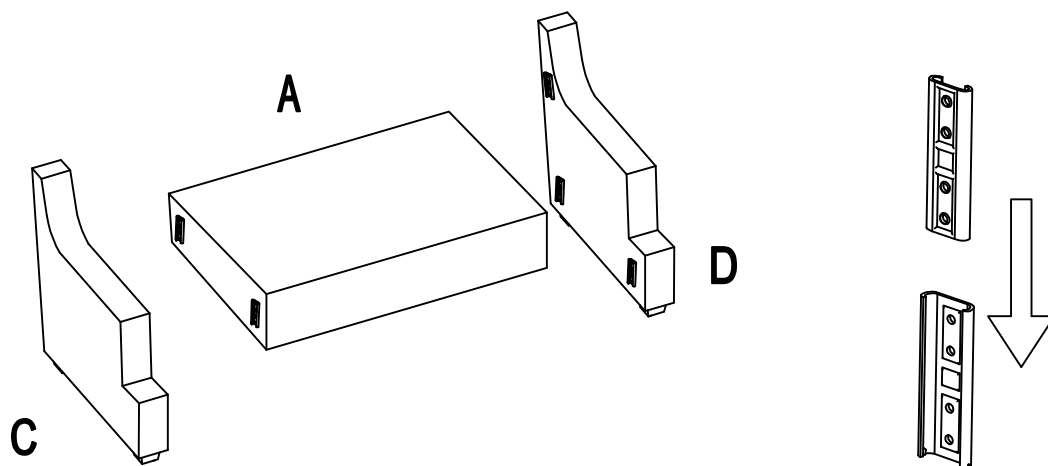

2

Hook on the Back Frame (B) to Left Panel (C) & Right Panel (D) properly.

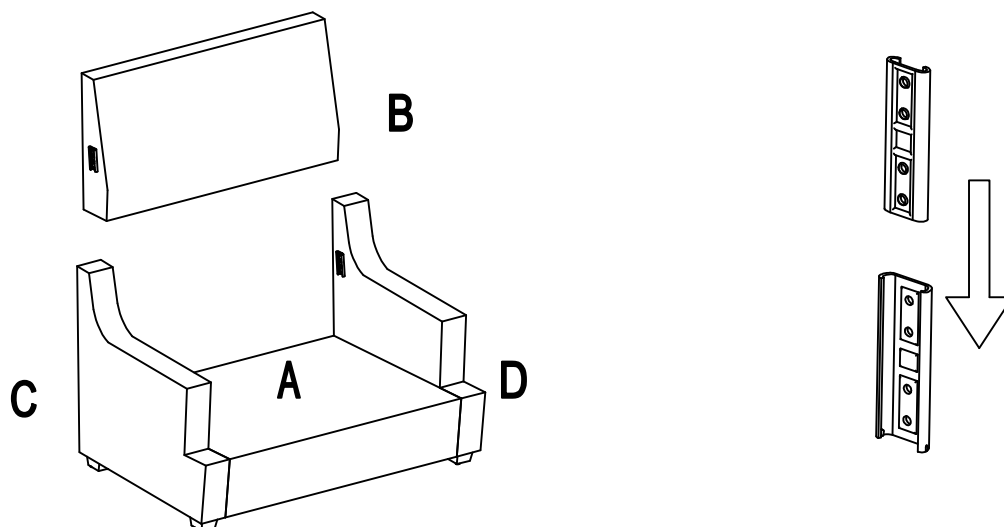

3

Place Left Seat Cushion (E), Right Seat Cushion (F) and Back Cushion (G) on the chair properly. The assembly is complete.

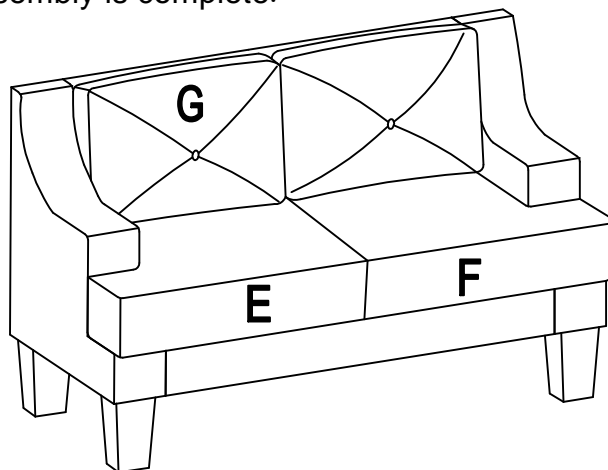

Cleaning & Care

Treat surface with care. Surface is resistant to scratches but is not scratch resistant. Clean surfaces with a dry or damp soft cloth. Do not use abrasive cleaners.